

**Amended Acknowledgment and
Amended Notice of Acknowledgment
of Acceptance of R.S. 2477
Right-of-Way Grant**

THE STATE OF UTAH

TO ALL WHOM THESE PRESENTS SHALL COME, Greeting:

Know ye, This is an Amended Acknowledgment and Amended Notice of Acknowledgment made under Utah Code Sections 72-5-309 through 310 inclusive, that the grant of the United States of America of "the right of way for the construction of highways over public lands, not reserved for public uses" under United States Revised Statutes 2477 (43 U.S.C. Section 932 (repealed October 21, 1976, with proviso recognizing the validity of rights-of-way already established)) was accepted for and on behalf of the State of Utah and its political subdivision Box Elder County as it pertains to the highway located in Box Elder County known as Bedke Spring Road; County Road Number: 43; State Geographic Information Database (SGID) Road Identification Number: RD020094. Total road length is 4.01 miles more or less.

This Amended Acknowledgment and Amended Notice of Acknowledgment supersedes the information contained in the Acknowledgment recorded at Ent 238517, Bk 988, Beg Pg 681.

The reason for this Amended Acknowledgment and Amended Notice of Acknowledgment includes, but is not limited to, the fact that the road was constructed, mechanically, or by continuous use as a public highway for a period of at least ten years, over public lands not reserved for public uses, prior to the earlier of (a) the October 21, 1976 repeal of R.S. 2477 or (b) the date the servient estate was reserved for public uses.

This Amended Acknowledgment and Amended Notice of Acknowledgment applies only to the segments of the road that traverse land owned by the Bureau of Land Management, United States Department of the Interior, and does not apply to segments of the road that traverse land owned by any other person or entity. The State of Utah and its political subdivisions reserve the right to make further acknowledgments and notices of acknowledgment with regard to road segments that traverse land owned by other entities, including the United States of America, through one or more of its agencies.

A printed copy of a map showing the location of the road in said county is appended hereto as "Attachment 1," a printed copy of representative photos of the road is appended hereto as "Attachment 2," a printed copy of a description of the beginning and ending points of the entire road together with a list of Townships, Ranges and Sections that may be traversed by the road in said county is appended hereto as "Attachment 3," and a printed copy of the Road Centerline Description Cover Page(s) is appended hereto as "Attachment 4." The Appendices listed in "Attachment 4" that contain the actual road centerline descriptions are incorporated herein by reference.

A printed copy of this Amended Acknowledgment and Amended Notice of Acknowledgment, together with its Attachments and Appendices, may be viewed and/or obtained at the office of the Utah State Archives.

An electronic copy of this Amended Acknowledgment and Amended Notice of Acknowledgment, together with its Attachments and Appendices, may be viewed and/or downloaded as read-only PDF (Portable Document Format) files via the Internet at <http://recorded2477roads.utah.gov>.

The owner of the servient estate in the land underlying the road-segments subject to this Amended Acknowledgment and Amended Notice is believed to be the United States of America through one or more of its agencies. Any of such agencies or any other person with a servient ownership claim or a competing dominant estate right-of-way ownership claim, may file a petition in the State District Court for Salt Lake County for a decision regarding the correctness of this Amended Acknowledgment. A claimant shall file a petition within sixty (60) days after receipt of this Notice.

In Witness Whereof, I, John Harja, the official designee of the Governor of the State of Utah, in conformity to the laws of the State (Utah Code Sections 72-5-308 through 310 inclusive), have caused this Amended Acknowledgment and Amend Notice of Acknowledgment to be made.

Signed by my hand in Salt Lake City, Utah, the 15th day of November, 2007.

By the Governor's Designee

John Harja

CERTIFICATION

State of Utah)
 : ss
County of Salt Lake)

I hereby certify that the signer of the foregoing document, John Harja, is personally known by me, has made a voluntary signature and taken an oath stating that he is the official designee of the Governor of the State of Utah and is authorized to sign this document on the Governor's behalf pursuant to Utah Code Section 72-5-309. He further vouched that, based upon information and belief, the facts alleged therein are true.

Dated this 15th day of November, 2007.



Notary Public

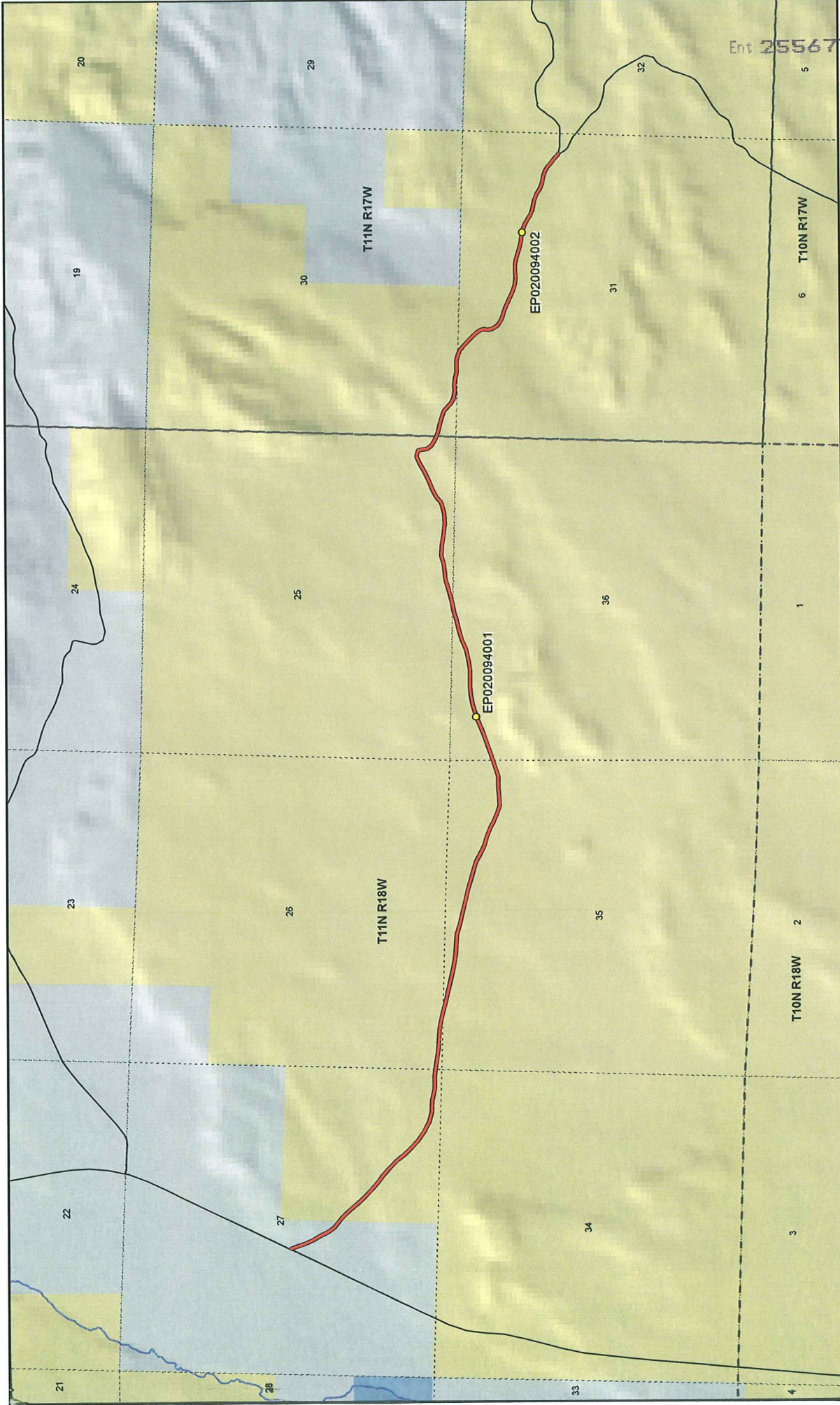

Bedke Spring Road - Box Elder County
SGID RD_ID RD020094

Land Ownership Categories

- BLM
- Private
- SITLA, State Trust Land
- USFS, National Forest
- State Parks and Recreation
- Tribal, Indian Reservation
- NPS, National Park

Transportation Network

- Bedke Spring Road
- Other Roads
- Title V, Issued Or Under Consideration By BLM Or County
- Photo Event Point

Wilderness

- UDWR Wildlife Reserve
- DOD, Military
- State Sovereign Land
- National Recreation Area
- USFWS, Natl. Wildlife Refuge

Map prepared by the State of Utah
Automated Geographic Reference Center
Room 5130 State Office Building
Salt Lake City, Utah 84114
Nov 13, 2006

Ent 255677 Bk 1030 022

1:27,304
1 inch equals 0.4 miles

UTAH
AGRC



EP020094001



EP020094002

EP000000000

EP000000000

EP000000000

EP000000000

Bedke Spring Road - Box Elder County
SGID RD_ID RD020094

Map prepared by the State of Utah
 Automated Geographic Reference Center
 Room 5130 State Office Building
 Salt Lake City, Utah 84114
 November 9, 2006



Attachment 3

Beginning & Ending Points and Township, Range, and Section References For:

Popular Name: Bedke Spring Road

County: Box Elder

County Road Number: 43

State Geographic Information Database (SGID) Road Identification Number: RD020094.

Total Road Length: 4.01 miles more or less.

Beginning at a point on the road centerline located at 41 degrees 38 minutes 46.08 seconds North Latitude and -113 degrees 53 minutes 59.27 seconds West Longitude, which can be converted to mapping accuracy State Plane Utah North Zone NAD 83 feet coordinates of X = 984,599.3 feet and Y = 3,768,201.5 feet based on the US Survey Foot conversion.

Ending at a point on the road centerline located at 41 degrees 38 minutes 05.39 seconds North Latitude and -113 degrees 49 minutes 51.89 seconds West Longitude, which can be converted to mapping accuracy State Plane Utah North Zone NAD 83 feet coordinates of X = 1,003,263.3 feet and Y = 3,763,572.9 feet based on the US Survey Foot conversion.

This road may traverse:

Township 11 North Range 17 West, Section(s) 30,31, Salt Lake Base & Meridian

Township 11 North Range 18 West, Section(s) 25,26,27,35,36, Salt Lake Base & Meridian

See Attachment 1 above for a cartographic depiction of the course of this road.

Attachment 4 **Road Centerline Description Cover Page(s)**

Popular Name: Bedke Spring Road

County: Box Elder

County Road Number: 43

State Geographic Information Database (SGID) Road Identification Number: RD020094.

Total Road Length: 4.01 miles more or less.

Centerline Descriptions Of Road-Segments That Cross Over Federally Owned Land, Derived From Global Positioning System Data And Cross-checked against USGS Digital Orthophoto Quadrangles Compiled By The Utah Automated Geographic Reference Center And Entered Into The State Geographic Information Database (SGID).

Road-Segments Listed by SGID Road Identification Number (RD ID)	Road-Segment Numbers	Believed Ownership Of Servient Estate	Approximate Segment Length	See Attached Appendix
RD020094	001	PVT	0.19 Miles	(not shown)
RD020094	002	BLM	3.82 Miles	A
		Total Road Length	4.01	_____

* Indicates that a Title V permit will be requested, is in process, or has been issued.

† Indicates that road-segments crossing Forest Service land are under consideration by the state and county as of the date of this Amended Acknowledgment and Amended Notice of Acknowledgment.

Appendix A to Attachment 4

Popular Name: Bedke Spring Road

County: Box Elder

County Road Number: 43

State Geographic Information Database (SGID) Road Identification Number: RD020094.

Road-Segment Number: 002

Road-Segment Length: 3.82 miles more or less.

Believed owner of the land underlying this road-segment is: Bureau of Land Management.

The following description is based upon the geographic coordinate system using the NAD83 Datum. The source is GPS mapping grade data as indicated in the metadata and/or the transportation data model of the State of Utah Geographic Information Database (SGID).

The road-segment itself is the monument that is identified by its physical presence on the land. The location of said physical presence is closely approximated by mapping grade Global Positioning System (GPS) data. Said data are checked against the corresponding gray-scale 1-meter Digital Orthophoto Quadrangles published by the United States Geological Survey (USGS) to verify a reasonable degree of accuracy. In circumstances where accurate satellite signal acquisition is not possible, such as deep, narrow canyons or under a canopy of dense foliage, or where very sharp curves in the road make accuracy questionable, such portions of the road were digitized from the corresponding gray-scale 1-meter Digital Orthophoto Quadrangles published by the United States Geological Survey (USGS).

This road-segment may traverse:

Township 11 North Range 17 West, Section(s) 30,31, Salt Lake Base & Meridian

Township 11 North Range 18 West, Section(s) 25,26,27,35,36, Salt Lake Base & Meridian

The following description closely approximates the location of the centerline of the physical monument (Bedke Spring Road)-- Segment 002 based on mapping grade Global Positioning System (GPS) data as defined above:

Beginning at a point on the road center line located at 41 degrees 38 minutes 37.96 seconds North Latitude and -113 degrees 53 minutes 52.69 seconds West Longitude, which can be converted to mapping accuracy State Plane Utah North Zone NAD 83 feet coordinates of X = 985,076.2 feet and Y = 3,767,366.1 feet; thence the following courses along the said road center line:

thence South 49 Degrees 08 Minutes 38 Seconds East	101.7 feet
thence South 42 Degrees 19 Minutes 57 Seconds East	114.7 feet
thence South 41 Degrees 02 Minutes 27 Seconds East	129.8 feet
thence South 41 Degrees 50 Minutes 03 Seconds East	140.1 feet
thence South 42 Degrees 28 Minutes 26 Seconds East	148.1 feet
thence South 46 Degrees 54 Minutes 44 Seconds East	152.7 feet
thence South 50 Degrees 37 Minutes 04 Seconds East	153.9 feet
thence South 52 Degrees 24 Minutes 23 Seconds East	154.7 feet
thence South 48 Degrees 55 Minutes 18 Seconds East	156.1 feet
thence South 46 Degrees 32 Minutes 07 Seconds East	156.3 feet
thence South 39 Degrees 00 Minutes 18 Seconds East	161.7 feet

thence South 43 Degrees 31 Minutes 37 Seconds East	175.4 feet
thence South 46 Degrees 03 Minutes 09 Seconds East	187.9 feet
thence South 55 Degrees 34 Minutes 44 Seconds East	184.1 feet
thence South 63 Degrees 41 Minutes 11 Seconds East	179.1 feet
thence South 74 Degrees 08 Minutes 10 Seconds East	176.2 feet
thence South 88 Degrees 21 Minutes 24 Seconds East	189 feet
thence South 79 Degrees 26 Minutes 36 Seconds East	216.8 feet
thence South 89 Degrees 05 Minutes 27 Seconds East	224.7 feet
thence South 82 Degrees 07 Minutes 03 Seconds East	100 feet
thence South 82 Degrees 07 Minutes 02 Seconds East	117.7 feet
thence South 81 Degrees 55 Minutes 30 Seconds East	201.6 feet
thence South 85 Degrees 50 Minutes 49 Seconds East	188.2 feet
thence South 86 Degrees 33 Minutes 22 Seconds East	198.5 feet
thence South 77 Degrees 31 Minutes 19 Seconds East	221.7 feet
thence South 76 Degrees 12 Minutes 52 Seconds East	52.4 feet
thence South 76 Degrees 12 Minutes 53 Seconds East	189.4 feet
thence South 76 Degrees 12 Minutes 33 Seconds East	228.3 feet
thence South 76 Degrees 19 Minutes 55 Seconds East	196.4 feet
thence South 79 Degrees 04 Minutes 30 Seconds East	184.6 feet
thence South 81 Degrees 02 Minutes 35 Seconds East	192.8 feet
thence South 86 Degrees 19 Minutes 01 Seconds East	186.8 feet
thence South 86 Degrees 34 Minutes 47 Seconds East	179.8 feet
thence South 73 Degrees 38 Minutes 09 Seconds East	182.5 feet
thence South 76 Degrees 24 Minutes 07 Seconds East	196 feet
thence South 74 Degrees 36 Minutes 47 Seconds East	193.5 feet
thence South 76 Degrees 25 Minutes 41 Seconds East	190.9 feet
thence South 74 Degrees 50 Minutes 54 Seconds East	184.1 feet
thence South 74 Degrees 12 Minutes 44 Seconds East	165.2 feet
thence South 72 Degrees 17 Minutes 04 Seconds East	158.7 feet
thence South 64 Degrees 29 Minutes 19 Seconds East	154.2 feet
thence South 63 Degrees 53 Minutes 10 Seconds East	158.3 feet
thence South 72 Degrees 47 Minutes 05 Seconds East	163.1 feet
thence South 69 Degrees 26 Minutes 13 Seconds East	156.2 feet
thence South 61 Degrees 26 Minutes 29 Seconds East	133 feet
thence South 63 Degrees 53 Minutes 51 Seconds East	142.9 feet
thence South 72 Degrees 02 Minutes 11 Seconds East	140.9 feet
thence North 85 Degrees 42 Minutes 02 Seconds East	142.7 feet
thence North 86 Degrees 14 Minutes 30 Seconds East	165.3 feet
thence North 88 Degrees 43 Minutes 02 Seconds East	200.4 feet
thence North 71 Degrees 26 Minutes 03 Seconds East	194.1 feet
thence North 70 Degrees 00 Minutes 04 Seconds East	87.5 feet
thence North 70 Degrees 00 Minutes 03 Seconds East	97.8 feet
thence North 69 Degrees 27 Minutes 01 Seconds East	181.4 feet
thence North 69 Degrees 14 Minutes 14 Seconds East	158.9 feet
thence North 69 Degrees 07 Minutes 45 Seconds East	145 feet
thence North 68 Degrees 04 Minutes 37 Seconds East	124.9 feet
thence North 68 Degrees 56 Minutes 26 Seconds East	83.5 feet
thence North 65 Degrees 12 Minutes 39 Seconds East	7.9 feet
thence South 31 Degrees 18 Minutes 31 Seconds East	1.9 feet

thence North 69 Degrees 50 Minutes 50 Seconds East	82.3 feet
thence North 75 Degrees 02 Minutes 42 Seconds East	143 feet
thence North 79 Degrees 41 Minutes 59 Seconds East	144.2 feet
thence North 83 Degrees 22 Minutes 16 Seconds East	146.8 feet
thence South 89 Degrees 43 Minutes 05 Seconds East	149.9 feet
thence North 89 Degrees 39 Minutes 17 Seconds East	155.1 feet
thence North 81 Degrees 02 Minutes 21 Seconds East	164.2 feet
thence North 75 Degrees 45 Minutes 07 Seconds East	170.6 feet
thence North 66 Degrees 29 Minutes 54 Seconds East	175.1 feet
thence North 71 Degrees 39 Minutes 39 Seconds East	175.2 feet
thence North 75 Degrees 49 Minutes 52 Seconds East	171.6 feet
thence North 74 Degrees 26 Minutes 25 Seconds East	162.5 feet
thence North 79 Degrees 04 Minutes 23 Seconds East	88.8 feet
thence North 79 Degrees 04 Minutes 24 Seconds East	63 feet
thence North 77 Degrees 03 Minutes 17 Seconds East	142.8 feet
thence North 72 Degrees 51 Minutes 58 Seconds East	140.8 feet
thence North 73 Degrees 39 Minutes 03 Seconds East	132 feet
thence North 82 Degrees 36 Minutes 04 Seconds East	130.9 feet
thence North 85 Degrees 43 Minutes 12 Seconds East	124.3 feet
thence North 71 Degrees 55 Minutes 45 Seconds East	150.8 feet
thence South 87 Degrees 44 Minutes 33 Seconds East	180.6 feet
thence South 80 Degrees 14 Minutes 17 Seconds East	186.9 feet
thence South 83 Degrees 43 Minutes 27 Seconds East	184.9 feet
thence North 88 Degrees 28 Minutes 29 Seconds East	175.2 feet
thence North 74 Degrees 07 Minutes 05 Seconds East	158 feet
thence North 61 Degrees 25 Minutes 22 Seconds East	55.5 feet
thence North 51 Degrees 29 Minutes 51 Seconds East	87.6 feet
thence North 46 Degrees 46 Minutes 33 Seconds East	31.3 feet
thence North 62 Degrees 03 Minutes 48 Seconds East	131 feet
thence North 68 Degrees 20 Minutes 56 Seconds East	176 feet
thence North 63 Degrees 20 Minutes 52 Seconds East	162.8 feet
thence North 60 Degrees 46 Minutes 32 Seconds East	156.2 feet
thence North 66 Degrees 22 Minutes 55 Seconds East	132.8 feet
thence South 74 Degrees 30 Minutes 25 Seconds East	96.1 feet
thence South 15 Degrees 16 Minutes 35 Seconds East	81.5 feet
thence South 10 Degrees 46 Minutes 15 Seconds East	83.4 feet
thence South 39 Degrees 28 Minutes 03 Seconds East	95.1 feet
thence South 58 Degrees 47 Minutes 37 Seconds East	109.7 feet
thence South 67 Degrees 34 Minutes 13 Seconds East	61 feet
thence South 67 Degrees 34 Minutes 11 Seconds East	78.8 feet
thence South 77 Degrees 56 Minutes 33 Seconds East	145.1 feet
thence South 74 Degrees 31 Minutes 00 Seconds East	132.3 feet
thence South 66 Degrees 16 Minutes 22 Seconds East	104.5 feet
thence South 49 Degrees 31 Minutes 19 Seconds East	82.8 feet
thence South 46 Degrees 56 Minutes 10 Seconds East	83.5 feet
thence South 60 Degrees 16 Minutes 03 Seconds East	98.2 feet
thence South 79 Degrees 54 Minutes 42 Seconds East	117.7 feet
thence North 85 Degrees 41 Minutes 36 Seconds East	118.7 feet
thence South 83 Degrees 15 Minutes 49 Seconds East	106.4 feet

thence South 76 Degrees 36 Minutes 59 Seconds East	103.7 feet
thence South 88 Degrees 26 Minutes 31 Seconds East	98.8 feet
thence North 87 Degrees 02 Minutes 40 Seconds East	108 feet
thence South 74 Degrees 27 Minutes 12 Seconds East	83 feet
thence South 74 Degrees 27 Minutes 16 Seconds East	12.9 feet
thence South 64 Degrees 43 Minutes 46 Seconds East	79.7 feet
thence South 52 Degrees 57 Minutes 11 Seconds East	64.8 feet
thence South 48 Degrees 19 Minutes 45 Seconds East	49 feet
thence South 45 Degrees 37 Minutes 48 Seconds East	93.2 feet
thence South 44 Degrees 59 Minutes 04 Seconds East	110.6 feet
thence South 41 Degrees 54 Minutes 59 Seconds East	100.8 feet
thence South 35 Degrees 43 Minutes 10 Seconds East	80.4 feet
thence South 12 Degrees 54 Minutes 30 Seconds East	58.8 feet
thence South 07 Degrees 32 Minutes 17 Seconds West	64.6 feet
thence South 11 Degrees 51 Minutes 59 Seconds East	87 feet
thence South 29 Degrees 51 Minutes 23 Seconds East	99.9 feet
thence South 53 Degrees 17 Minutes 04 Seconds East	78.9 feet
thence South 64 Degrees 29 Minutes 27 Seconds East	82.7 feet
thence South 74 Degrees 49 Minutes 14 Seconds East	91.9 feet
thence South 71 Degrees 09 Minutes 27 Seconds East	94.8 feet
thence South 65 Degrees 44 Minutes 11 Seconds East	94.5 feet
thence South 64 Degrees 06 Minutes 12 Seconds East	103.8 feet
thence South 64 Degrees 12 Minutes 11 Seconds East	119.1 feet
thence South 71 Degrees 19 Minutes 09 Seconds East	110.7 feet
thence South 86 Degrees 05 Minutes 22 Seconds East	110.5 feet
thence North 88 Degrees 51 Minutes 09 Seconds East	117.1 feet
thence North 89 Degrees 39 Minutes 18 Seconds East	103.3 feet
thence South 84 Degrees 54 Minutes 53 Seconds East	86.6 feet
thence South 70 Degrees 50 Minutes 02 Seconds East	88.4 feet
thence South 72 Degrees 21 Minutes 27 Seconds East	79.7 feet
thence South 74 Degrees 23 Minutes 58 Seconds East	71.6 feet
thence South 79 Degrees 04 Minutes 43 Seconds East	83.9 feet
thence South 82 Degrees 26 Minutes 15 Seconds East	71.5 feet
thence South 80 Degrees 40 Minutes 17 Seconds East	58.6 feet
thence South 75 Degrees 17 Minutes 54 Seconds East	31.6 feet
thence North 48 Degrees 13 Minutes 53 Seconds East	7.4 feet
thence South 71 Degrees 24 Minutes 21 Seconds East	70.7 feet
thence South 65 Degrees 48 Minutes 55 Seconds East	90.9 feet
thence South 60 Degrees 51 Minutes 06 Seconds East	83.3 feet
thence South 58 Degrees 44 Minutes 14 Seconds East	75.1 feet
thence South 65 Degrees 41 Minutes 33 Seconds East	74.7 feet
thence South 73 Degrees 49 Minutes 57 Seconds East	86.5 feet
thence South 77 Degrees 56 Minutes 26 Seconds East	114.5 feet
thence South 67 Degrees 51 Minutes 35 Seconds East	107.2 feet
thence South 58 Degrees 02 Minutes 06 Seconds East	98.2 feet
thence South 68 Degrees 42 Minutes 01 Seconds East	111.2 feet
thence South 80 Degrees 44 Minutes 22 Seconds East	108.1 feet
thence South 71 Degrees 15 Minutes 29 Seconds East	100.3 feet
thence South 56 Degrees 15 Minutes 08 Seconds East	90.7 feet

thence South 49 Degrees 56 Minutes 41 Seconds East 81 feet
thence South 53 Degrees 41 Minutes 37 Seconds East 68.7 feet
thence South 51 Degrees 00 Minutes 15 Seconds East 51.7 feet
thence South 43 Degrees 34 Minutes 23 Seconds East 45 feet
thence South 41 Degrees 58 Minutes 41 Seconds East 19.7 feet
thence South 50 Degrees 32 Minutes 21 Seconds East 7.7 feet
thence South 70 Degrees 41 Minutes 27 Seconds East 9.8 feet
thence South 66 Degrees 32 Minutes 19 Seconds East 12.2 feet more or less to **the ending**

point at: 41 degrees 38 minutes 05.39 seconds North Latitude and -113 degrees 49 minutes 51.89 seconds West Longitude, which can be converted to mapping accuracy State Plane Utah North Zone NAD 83 feet coordinates of X = 1,003,263.3 feet and Y = 3,763,572.9 feet.