

**Acknowledgment and  
Notice of Acknowledgment  
of Acceptance of R.S. 2477  
Right-of-Way Grant**

Ent 251335 Bk 429 Pg 408  
Date: 09-MAY-2008 1:16PM  
Fee: None  
Filed By: CT  
LES BARKER, Recorder  
GARFIELD COUNTY CORPORATION  
For: GOVERNOR/STATE OF UTAH

**THE STATE OF UTAH**

**TO ALL WHOM THESE PRESENTS SHALL COME, Greeting:**

**Know ye,** This is an Acknowledgment and Notice of Acknowledgment made under Utah Code Sections 72-5-309 through 310 inclusive, that the grant of the United States of America of “the right of way for the construction of highways over public lands, not reserved for public uses” under United States Revised Statutes 2477 (43 U.S.C. Section 932 (repealed October 21, 1976, with proviso recognizing the validity of rights-of-way already established)) was accepted for and on behalf of the State of Utah and its political subdivision Garfield County as it pertains to the highway located in Garfield County known as SOUTH HANSEN CREEK ROAD; County Road Number: 0026D; State Geographic Information Database (SGID) Road Identification Number: RD090008. Total road length is 1.49 miles more or less.

The reason for this Acknowledgment and Notice of Acknowledgment includes, but is not limited to, the fact that the road was constructed, mechanically, or by continuous use as a public highway for a period of at least ten years, over public lands not reserved for public uses, prior to the earlier of (a) the October 21, 1976 repeal of R.S. 2477 or (b) the date the servient estate was reserved for public uses.

This Acknowledgment and Notice of Acknowledgment applies only to the segments of the road that traverse land owned by the Bureau of Land Management, United States Department of the Interior, and does not apply to segments of the road that traverse land owned by any other person or entity. The State of Utah and its political subdivisions reserve the right to make further acknowledgments and notices of acknowledgment with regard to road segments that traverse land owned by other entities, including the United States of America, through one or more of its agencies.

A printed copy of a map showing the location of the road in said county is appended hereto as “Attachment 1,” a printed copy of representative photos of the road is appended hereto as “Attachment 2,” a printed copy of a description of the beginning and ending points of the entire road together with a list of Townships, Ranges and Sections that may be traversed by the road in said county is appended hereto as “Attachment 3,” and a printed copy of the Road Centerline Description Cover Page(s) is appended hereto as “Attachment 4.” The Appendices listed in “Attachment 4” that contain the actual road centerline descriptions are incorporated herein by reference. Affidavits provided by individuals familiar with the road are appended hereto as “Attachment 5.”

A printed copy of this Acknowledgment and Notice of Acknowledgment, together with its Attachments and Appendices, may be viewed and/or obtained at the office of the Utah State Archives.

An electronic copy of this Acknowledgment and Notice of Acknowledgment, together with its Attachments and Appendices, may be viewed and/or downloaded as read-only PDF (Portable Document Format) files via the

Internet at <http://recorded2477roads.utah.gov>.

The owner of the servient estate in the land underlying the road-segments subject to this Acknowledgment and Notice is believed to be the United States of America through one or more of its agencies. Any of such agencies or any other person with a servient ownership claim or a competing dominant estate right-of-way ownership claim, may file a petition in the State District Court for Salt Lake County for a decision regarding the correctness of this Acknowledgment. A claimant shall file a petition within sixty (60) days after receipt of this Notice.

**In Witness Whereof**, I, John Harja, the official designee of the Governor of the State of Utah, in conformity to the laws of the State (Utah Code Sections 72-5-308 through 310 inclusive), have caused this Acknowledgment and Notice of Acknowledgment to be made.

Signed by my hand in Salt Lake City, Utah, the 24<sup>th</sup> day of April, 2008.

By the Governor's Designee

  
\_\_\_\_\_  
John Harja

### CERTIFICATION

State of Utah                    )  
  : ss  
County of Salt Lake         )

I hereby certify that the signer of the foregoing document, John Harja, is personally known by me, has made a voluntary signature and taken an oath stating that he is the official designee of the Governor of the State of Utah and is authorized to sign this document on the Governor's behalf pursuant to Utah Code Section 72-5-309. He further vouched that, based upon information and belief, the facts alleged therein are true.



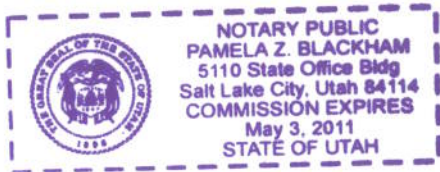

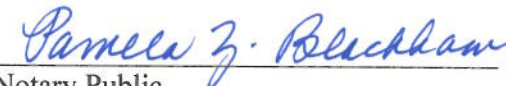
Dated this 24<sup>th</sup> day of April, 2008.

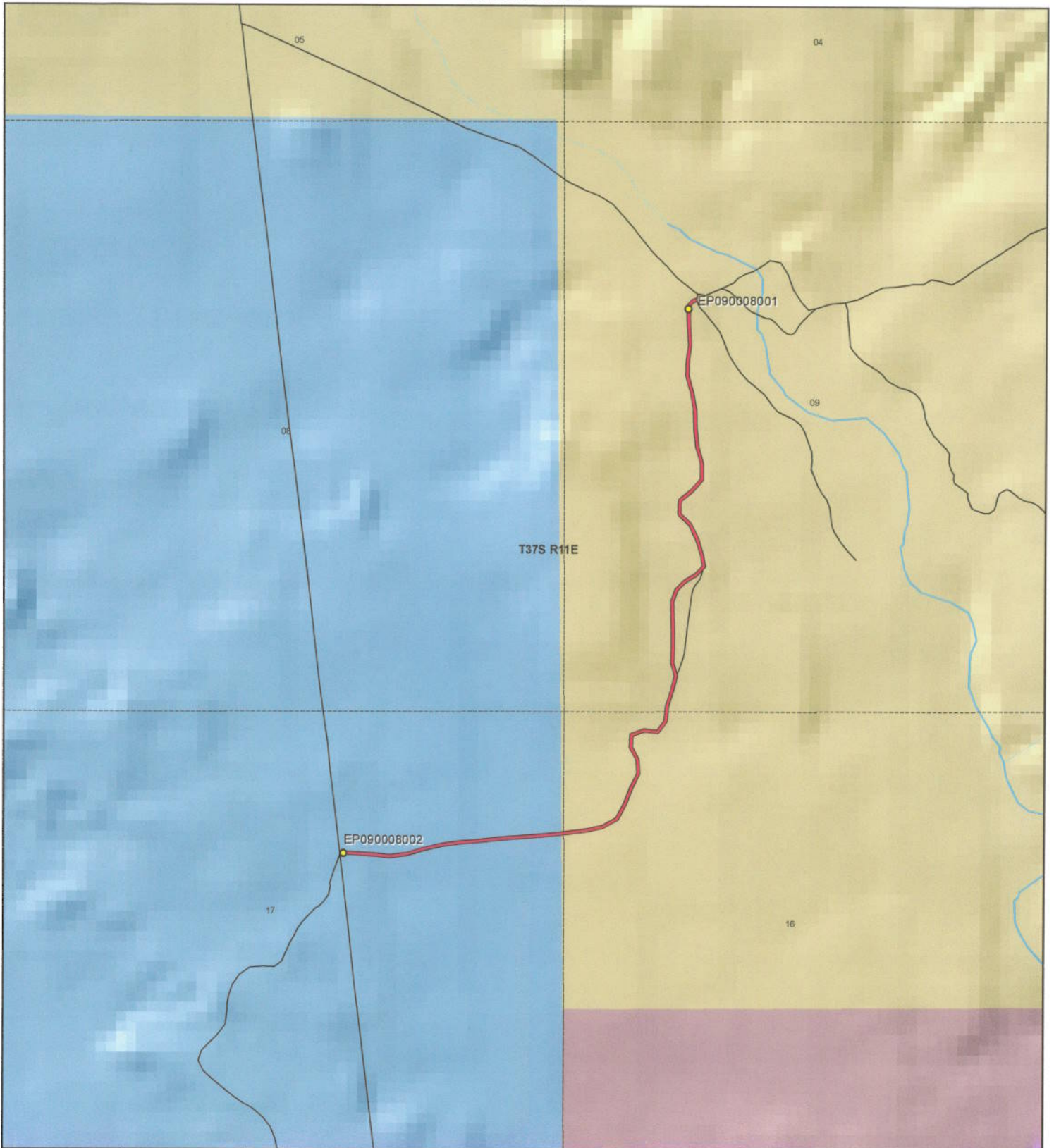

  
\_\_\_\_\_  
Notary Public





 <p>1:13,930 1 inch equals 0.2 miles</p>		<p align="center"><b>SOUTH HANSEN CREEK ROAD - Garfield County</b> <b>SGID RD_ID RD090008</b></p> <table border="0"> <tr> <td colspan="2"><b>Land Ownership Categories</b></td> <td colspan="2"><b>Transportation Network</b></td> </tr> <tr> <td> BLM</td> <td> Wilderness</td> <td> SOUTH HANSEN CREEK ROAD</td> <td> Title V: Issued Or Under Consideration By BLM Or County</td> </tr> <tr> <td> Private</td> <td> UDWR Wildlife Reserve</td> <td> Other Roads</td> <td> Photo Event Point</td> </tr> <tr> <td> SITLA, State Trust Land</td> <td> DOD, Military</td> <td> Section = 1 Mile</td> <td></td> </tr> <tr> <td> USFS, National Forest</td> <td> State Sovereign Land</td> <td></td> <td></td> </tr> <tr> <td> State Parks and Recreation</td> <td> National Recreation Area</td> <td></td> <td></td> </tr> <tr> <td> Tribal, Indian Reservation</td> <td> USFWS, Natl. Wildlife Refuge</td> <td></td> <td></td> </tr> <tr> <td> NPS, National Park</td> <td></td> <td></td> <td></td> </tr> </table>	<b>Land Ownership Categories</b>		<b>Transportation Network</b>		BLM	Wilderness	SOUTH HANSEN CREEK ROAD	Title V: Issued Or Under Consideration By BLM Or County	Private	UDWR Wildlife Reserve	Other Roads	Photo Event Point	SITLA, State Trust Land	DOD, Military	Section = 1 Mile		USFS, National Forest	State Sovereign Land			State Parks and Recreation	National Recreation Area			Tribal, Indian Reservation	USFWS, Natl. Wildlife Refuge			NPS, National Park				<p>Map prepared by the State of Utah Automated Geographic Reference Center Room 5130 State Office Building Salt Lake City, Utah 84114 Feb 27, 2008</p>  
<b>Land Ownership Categories</b>		<b>Transportation Network</b>																																	
BLM	Wilderness	SOUTH HANSEN CREEK ROAD	Title V: Issued Or Under Consideration By BLM Or County																																
Private	UDWR Wildlife Reserve	Other Roads	Photo Event Point																																
SITLA, State Trust Land	DOD, Military	Section = 1 Mile																																	
USFS, National Forest	State Sovereign Land																																		
State Parks and Recreation	National Recreation Area																																		
Tribal, Indian Reservation	USFWS, Natl. Wildlife Refuge																																		
NPS, National Park																																			

Attachment 2



EP090008001



EP090008002

EP000000000

EP000000000

EP000000000

EP000000000

**SOUTH HANSEN CREEK ROAD - Garfield County**  
**SGID RD\_ID RD090008**



Map prepared by the State of Utah  
Automated Geographic Reference Center  
Room 5130 State Office Building  
Salt Lake City, Utah 84114  
February 29, 2008



### Attachment 3

#### Beginning & Ending Points and Township, Range, and Section References For:

**Popular Name: SOUTH HANSEN CREEK ROAD**

**County: Garfield**

**County Road Number: 0026D**

**State Geographic Information Database (SGID) Road Identification Number: RD090008.**

**Total Road Length: 1.49 miles more or less.**

**Beginning at a point** on the road centerline located at 37 degrees 35 minutes 42.25 seconds North Latitude and -110 degrees 43 minutes 01.36 seconds West Longitude, which can be converted to mapping accuracy State Plane Utah South Zone NAD 83 feet coordinates of X = 1,867,258.7 feet and Y = 10,181,496.4 feet based on the US Survey Foot conversion.

**Ending at a point** on the road centerline located at 37 degrees 36 minutes 31.62 seconds North Latitude and -110 degrees 42 minutes 021.1 seconds West Longitude, which can be converted to mapping accuracy State Plane Utah South Zone NAD 83 feet coordinates of X = 1,870,456.0 feet and Y = 10,186,517.3 feet based on the US Survey Foot conversion.

This road may traverse:

Township 37 South Range 11 East, Section(s) 9,16,17, Salt Lake Base & Meridian  
See Attachment 1 above for a cartographic depiction of the course of this road.



**Attachment 4  
Road Centerline Description Cover Page(s)**

**Popular Name: SOUTH HANSEN CREEK ROAD**

**County: Garfield**

**County Road Number: 0026D**

**State Geographic Information Database (SGID) Road Identification Number: RD090008.**

**Total Road Length: 1.49 miles more or less.**

**Centerline Descriptions Of Road-Segments That Cross Over Federally Owned Land, Derived From Global Positioning System Data And Cross-checked against USGS Digital Orthophoto Quadrangles Compiled By The Utah Automated Geographic Reference Center And Entered Into The State Geographic Information Database (SGID).**

<b>Road-Segments Listed by SGID Road Identification Number (RD ID)</b>	<b>Road-Segment Numbers</b>	<b>Believed Ownership Of Servient Estate</b>	<b>Approximate Segment Length</b>	<b>See Attached Appendix</b>
<b>RD090008</b>	<b>001</b>	<b>ST</b>	<b>0.37 Miles</b>	<b>(not shown)</b>
<b>RD090008</b>	<b>002</b>	<b>BLM</b>	<b>1.12 Miles</b>	<b>A</b>
		<b>Total Road Length</b>	<b>1.49</b>	<b>_____</b>

\* Indicates that a Title V permit will be requested, is in process, or has been issued.

† Indicates that road-segments crossing Forest Service land are under consideration by the state and county as of the date of this Acknowledgment and Notice of Acknowledgment.

## Attachment 5

**AFFIDAVIT OF FREELAND ALVEY**  
**SOUTH HANSEN CREEK ROAD**  
**GARFIELD COUNTY, UTAH**  
**ROAD NUMBER 0026D**

State of Utah                    )  
  : ss.  
County of Garfield            )

FREELAND ALVEY, being first duly sworn, deposes and states as follows:

1. I am an adult competent to testify about the matters set forth below based upon my personal knowledge. I currently reside in Escalante, Garfield County, Utah. I was born and raised in Garfield County and have lived in the county for 74 years. I worked for the Garfield County Roads Department for twelve years from the early 1950s to the mid 1960s.

2. I have traveled and am familiar with a road in Garfield County known as South Hansen Creek Road. I am also familiar with the land the road traverses. When I first used and observed the road in the early 1950s it followed the same route as in the mid 1960s when I last observed it. Attached is a Garfield County map showing South Hansen Creek Road. To the best of my knowledge and based upon my use of and familiarity with this road and the land it traverses, the location and route of the road are correctly illustrated on the attached map.

3. The County also identifies this road according to the road number listed above.

4. I have observed that the road has been open to the public for all to use, to come and go as they pleased, since at least as early as the early 1950s and continuing through the mid 1960s. Throughout this time period I observed travel on the road by means of cars, trucks, pickup trucks. During this time period, the road was used daily, weather permitting, for more than ten continuous years prior to 1976.

5. Throughout the time period from the early 1950s to the mid 1960s, I used the road myself for county road maintenance and travel in and through the area.



6. Throughout the time period described in the previous paragraph, I have observed other vehicles from the general public using the road at various times for the uses described in the previous paragraph plus livestock operations, hunting, recreation, sightseeing, prospecting for minerals and oil and gas exploration.

7. It is also the reputation in the community that this road has been open to the public for all to use, to come and go as they pleased, since at least as early as the early 1900s and continuing through 1976 to the present, for the uses described in the previous paragraphs.

8. Prior to 1976, I personally graded and performed maintenance and construction work on the road.

DATED this 11 day of July, 2007.

  
FREELAND ALVEY

SUBSCRIBED AND SWORN to before me this 11th day of July, 2007.

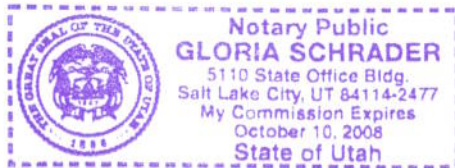

  
NOTARY PUBLIC

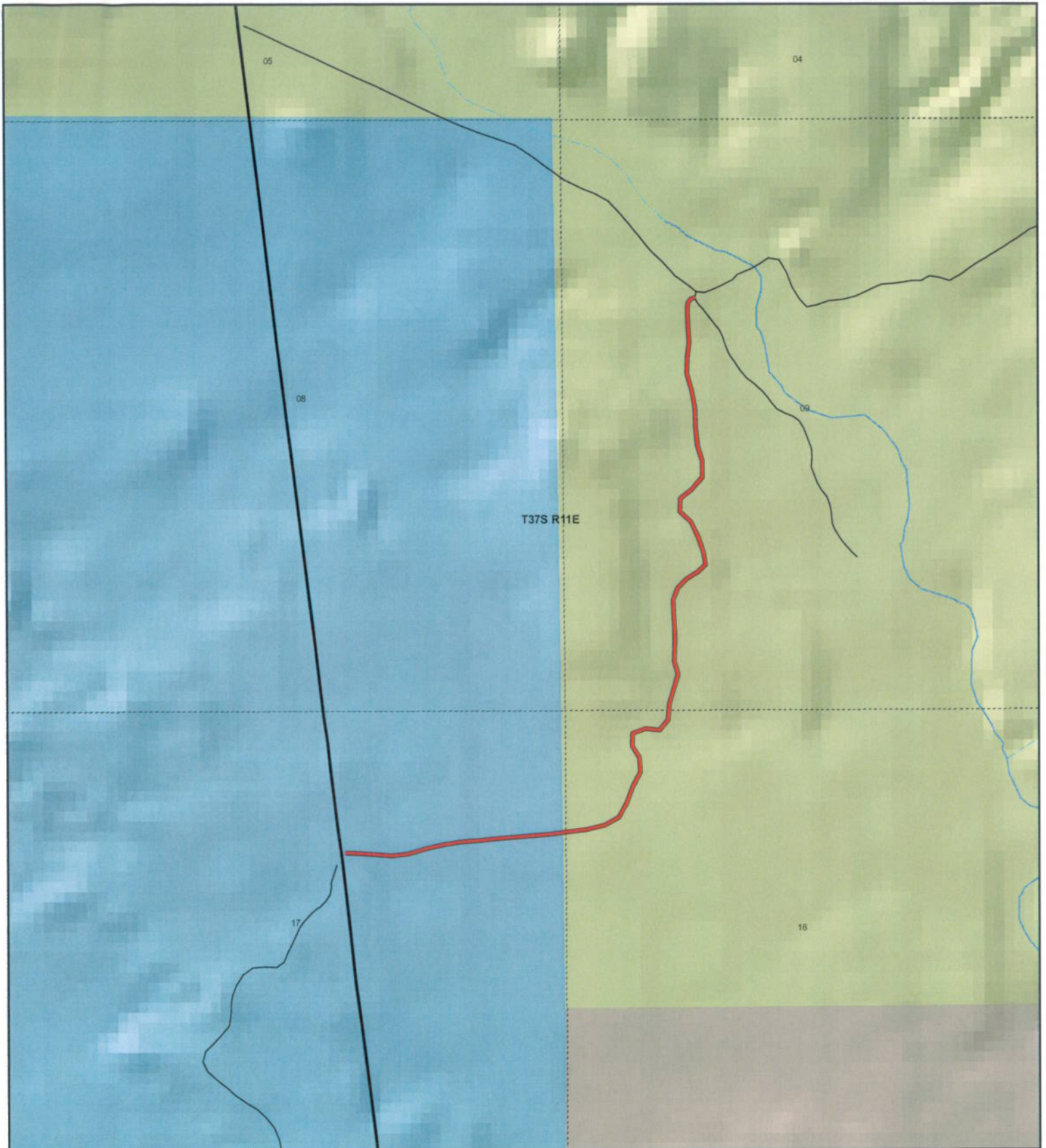

**SOUTH HANSEN CREEK RD**  
**County Unique - 0026D**

- Land Ownership Categories**
- BLM
  - Private
  - SITLA, State Trust Land
  - USFS, National Forest
  - Wildlife Reserve
  - National Park/Monument (NPS)
  - National Rec. Area
  - Wilderness
  - State Park

- Transportation Network**
- SOUTH HANSEN CREEK RD
  - State / U.S. Highway
  - Local Roads
- Misc**
- City / Town
  - Municipalities
  - Section = 1 Mile
  - Monument Boundary



1:13,746  
 1 inch equals 0.2 miles

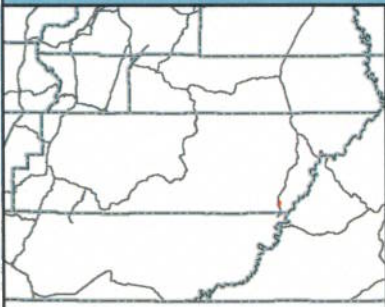

Map prepared by the State of Utah  
 AGRC  
 Room 5130 State Office Building  
 Salt Lake City, Utah 84114  
 Jul 05, 2007





## Appendix A to Attachment 4

**Popular Name: SOUTH HANSEN CREEK ROAD**

**County: Garfield**

**County Road Number: 0026D**

**State Geographic Information Database (SGID) Road Identification Number: RD090008.**

**Road-Segment Number: 002**

**Road-Segment Length: 1.12 miles more or less.**

**Believed owner of the land underlying this road-segment is: Bureau of Land Management.**

*The following description is based upon the geographic coordinate system using the NAD83 Datum. The source is GPS mapping grade data as indicated in the metadata and/or the transportation data model of the State of Utah Geographic Information Database (SGID).*

The road-segment itself is the monument that is identified by its physical presence on the land. The location of said physical presence is closely approximated by mapping grade Global Positioning System (GPS) data. Said data are checked against the corresponding gray-scale 1-meter Digital Orthophoto Quadrangles published by the United States Geological Survey (USGS) to verify a reasonable degree of accuracy. In circumstances where accurate satellite signal acquisition is not possible, such as deep, narrow canyons or under a canopy of dense foliage, or where very sharp curves in the road make accuracy questionable, such portions of the road were digitized from the corresponding gray-scale 1-meter Digital Orthophoto Quadrangles published by the United States Geological Survey (USGS).

This road-segment may traverse:

Township 37 South Range 11 East, Section(s) 9,16, Salt Lake Base & Meridian

The following description closely approximates the location of the centerline of the physical monument (SOUTH HANSEN CREEK ROAD)-- Segment 002 based on mapping grade Global Positioning System (GPS) data as defined above:

**Beginning at a point** on the road center line located at 37 degrees 35 minutes 44 seconds North Latitude and -110 degrees 42 minutes 37.15 seconds West Longitude, which can be converted to mapping accuracy State Plane Utah South Zone NAD 83 feet coordinates of X = 1,869,205.0 feet and Y = 10,181,690.0 feet; thence the following courses along the said road center line:

thence North 82 Degrees 47 Minutes 44 Seconds East 25 feet  
thence North 82 Degrees 47 Minutes 44 Seconds East 23.8 feet  
thence North 82 Degrees 00 Minutes 10 Seconds East 169.2 feet  
thence North 77 Degrees 08 Minutes 18 Seconds East 160 feet  
thence North 59 Degrees 46 Minutes 29 Seconds East 148.1 feet  
thence North 28 Degrees 55 Minutes 25 Seconds East 145.2 feet  
thence North 20 Degrees 38 Minutes 38 Seconds East 156 feet  
thence North 26 Degrees 53 Minutes 45 Seconds East 145 feet  
thence North 05 Degrees 27 Minutes 41 Seconds West 127.9 feet  
thence North 29 Degrees 43 Minutes 52 Seconds West 123.6 feet  
thence North 01 Degrees 41 Minutes 47 Seconds East 112.6 feet



thence North 70 Degrees 42 Minutes 13 Seconds East 118 feet  
 thence South 85 Degrees 42 Minutes 55 Seconds East 127.1 feet  
 thence North 38 Degrees 25 Minutes 40 Seconds East 117 feet  
 thence North 05 Degrees 09 Minutes 53 Seconds East 86.9 feet  
 thence North 05 Degrees 09 Minutes 52 Seconds East 54.3 feet  
 thence North 16 Degrees 44 Minutes 25 Seconds East 150 feet  
 thence North 15 Degrees 15 Minutes 22 Seconds East 128.4 feet  
 thence North 16 Degrees 02 Minutes 05 Seconds West 118.7 feet  
 thence North 01 Degrees 38 Minutes 37 Seconds East 135 feet  
 thence North 00 Degrees 50 Minutes 15 Seconds West 141.8 feet  
 thence North 02 Degrees 33 Minutes 57 Seconds West 141.6 feet  
 thence North 02 Degrees 06 Minutes 35 Seconds West 135.6 feet  
 thence North 20 Degrees 50 Minutes 37 Seconds East 107.3 feet  
 thence North 42 Degrees 32 Minutes 43 Seconds East 111.5 feet  
 thence North 58 Degrees 07 Minutes 02 Seconds East 116 feet  
 thence North 46 Degrees 25 Minutes 14 Seconds East 100.1 feet  
 thence North 10 Degrees 46 Minutes 20 Seconds West 104.8 feet  
 thence North 17 Degrees 54 Minutes 18 Seconds West 156.3 feet  
 thence North 26 Degrees 23 Minutes 15 Seconds West 138.9 feet  
 thence North 46 Degrees 05 Minutes 11 Seconds West 136.5 feet  
 thence North 02 Degrees 16 Minutes 24 Seconds East 116.6 feet  
 thence North 49 Degrees 34 Minutes 50 Seconds East 133.5 feet  
 thence North 40 Degrees 13 Minutes 16 Seconds East 139.9 feet  
 thence North 00 Degrees 13 Minutes 19 Seconds East 142.1 feet  
 thence North 16 Degrees 25 Minutes 43 Seconds West 146.6 feet  
 thence North 06 Degrees 24 Minutes 52 Seconds West 169.7 feet  
 thence North 02 Degrees 18 Minutes 17 Seconds West 169.5 feet  
 thence North 10 Degrees 11 Minutes 34 Seconds West 160.6 feet  
 thence North 16 Degrees 17 Minutes 10 Seconds West 152.6 feet  
 thence North 01 Degrees 23 Minutes 20 Seconds East 144.1 feet  
 thence North 06 Degrees 47 Minutes 03 Seconds East 138.2 feet  
 thence North 03 Degrees 26 Minutes 50 Seconds West 131.8 feet  
 thence North 03 Degrees 45 Minutes 53 Seconds West 108.8 feet  
 thence North 00 Degrees 33 Minutes 34 Seconds West 74.5 feet  
 thence North 08 Degrees 38 Minutes 17 Seconds East 35.9 feet  
 thence North 39 Degrees 33 Minutes 00 Seconds East 46.6 feet  
 thence North 55 Degrees 02 Minutes 22 Seconds East 48 feet  
 thence North 70 Degrees 32 Minutes 40 Seconds East 83 feet more or less to **the ending point**

**at:** 37 degrees 36 minutes 31.62 seconds North Latitude and -110 degrees 42 minutes 021.1 seconds West Longitude, which can be converted to mapping accuracy State Plane Utah South Zone NAD 83 feet coordinates of X = 1,870,456.0 feet and Y = 10,186,517.3 feet.

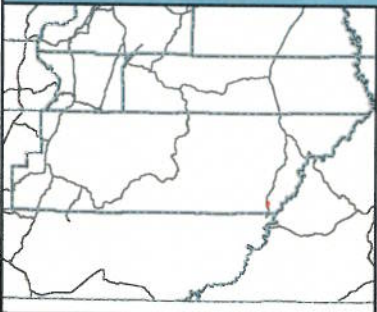
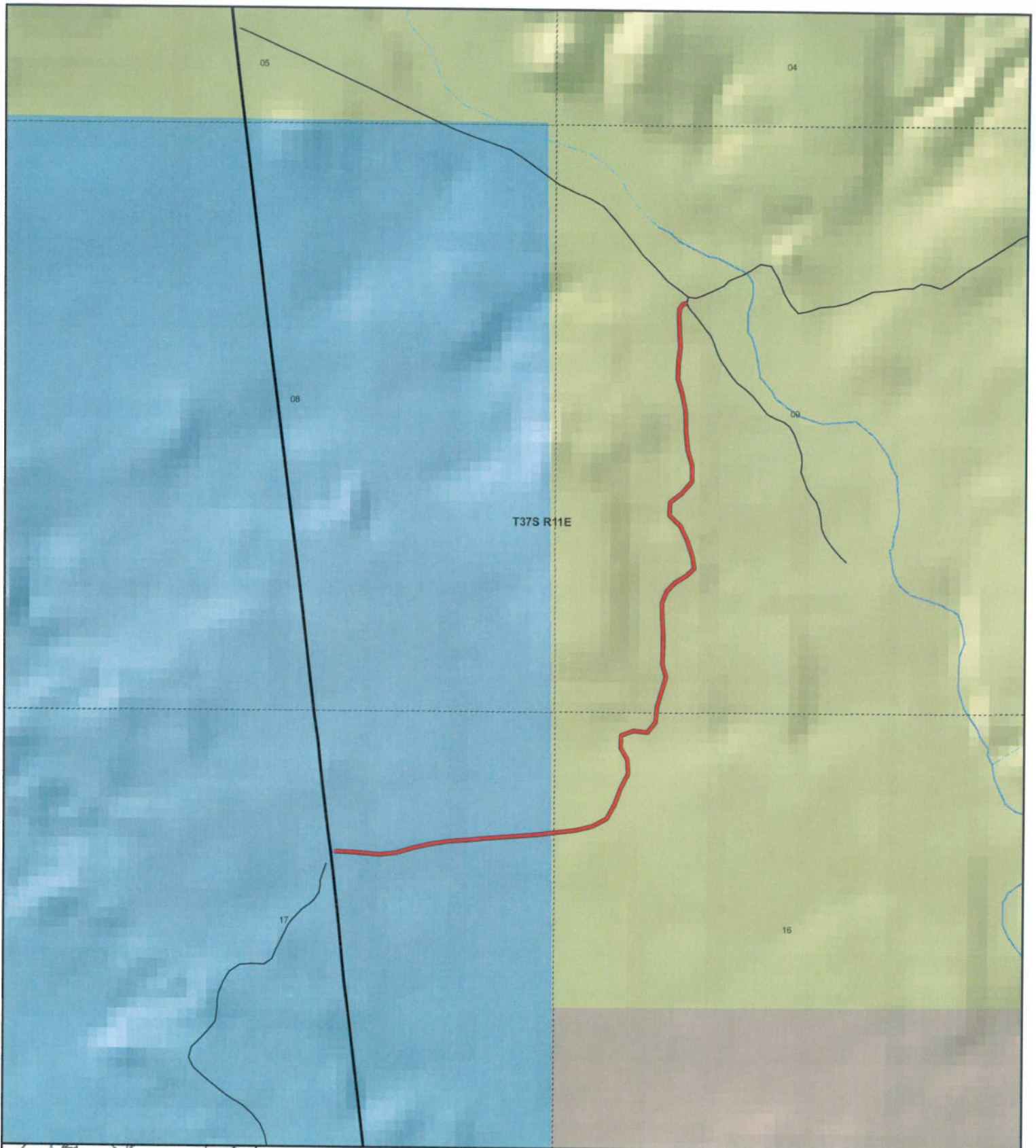

**SOUTH HANSEN CREEK RD**  
**County Unique - 0026D**

**Land Ownership Categories**

- BLM
- Private
- ◆ SITLA, State Trust Land
- ◆ USFS, National Forest
- ◆ Wildlife Reserve
- ◆ National Park/Monument (NPS)
- ◆ National Rec. Area
- ◆ Wilderness
- ◆ State Park

**Transportation Network**

- SOUTH HANSEN CREEK RD
- State / U.S. Highway
- Local Roads

**Misc**

- City / Town
- Municipalities
- Section = 1 Mile
- Monument Boundary



1:13,746  
 1 inch equals 0.2 miles



Map prepared by the State of Utah  
 AGRC  
 Room 5130 State Office Building  
 Salt Lake City, Utah 84114  
 Jul 05, 2007

