

**Acknowledgment and
Notice of Acknowledgment
of Acceptance of R.S. 2477
Right-of-Way Grant**

Ent 251340 Bk 429 Pg 463
Date: 09-MAY-2008 1:28PM
Fee: None
Filed By: CT
LES BARKER, Recorder
GARFIELD COUNTY CORPORATION
For: GOVERNOR/STATE OF UTAH

THE STATE OF UTAH

TO ALL WHOM THESE PRESENTS SHALL COME, Greeting:

Know ye, This is an Acknowledgment and Notice of Acknowledgment made under Utah Code Sections 72-5-309 through 310 inclusive, that the grant of the United States of America of “the right of way for the construction of highways over public lands, not reserved for public uses” under United States Revised Statutes 2477 (43 U.S.C. Section 932 (repealed October 21, 1976, with proviso recognizing the validity of rights-of-way already established)) was accepted for and on behalf of the State of Utah and its political subdivision Garfield County as it pertains to the highway located in Garfield County known as PINE SPRING ROAD; County Road Number: 0034; State Geographic Information Database (SGID) Road Identification Number: RD090013. Total road length is 1.95 miles more or less.

The reason for this Acknowledgment and Notice of Acknowledgment includes, but is not limited to, the fact that the road was constructed, mechanically, or by continuous use as a public highway for a period of at least ten years, over public lands not reserved for public uses, prior to the earlier of (a) the October 21, 1976 repeal of R.S. 2477 or (b) the date the servient estate was reserved for public uses.

This Acknowledgment and Notice of Acknowledgment applies only to the segments of the road that traverse land owned by the Bureau of Land Management, United States Department of the Interior, and does not apply to segments of the road that traverse land owned by any other person or entity. The State of Utah and its political subdivisions reserve the right to make further acknowledgments and notices of acknowledgment with regard to road segments that traverse land owned by other entities, including the United States of America, through one or more of its agencies.

A printed copy of a map showing the location of the road in said county is appended hereto as “Attachment 1,” a printed copy of representative photos of the road is appended hereto as “Attachment 2,” a printed copy of a description of the beginning and ending points of the entire road together with a list of Townships, Ranges and Sections that may be traversed by the road in said county is appended hereto as “Attachment 3,” and a printed copy of the Road Centerline Description Cover Page(s) is appended hereto as “Attachment 4.” The Appendices listed in “Attachment 4” that contain the actual road centerline descriptions are incorporated herein by reference. Affidavits provided by individuals familiar with the road are appended hereto as “Attachment 5.”

A printed copy of this Acknowledgment and Notice of Acknowledgment, together with its Attachments and Appendices, may be viewed and/or obtained at the office of the Utah State Archives.

An electronic copy of this Acknowledgment and Notice of Acknowledgment, together with its Attachments and Appendices, may be viewed and/or downloaded as read-only PDF (Portable Document Format) files via the

Internet at <http://recorded2477roads.utah.gov>.

The owner of the servient estate in the land underlying the road-segments subject to this Acknowledgment and Notice is believed to be the United States of America through one or more of its agencies. Any of such agencies or any other person with a servient ownership claim or a competing dominant estate right-of-way ownership claim, may file a petition in the State District Court for Salt Lake County for a decision regarding the correctness of this Acknowledgment. A claimant shall file a petition within sixty (60) days after receipt of this Notice.

In Witness Whereof, I, John Harja, the official designee of the Governor of the State of Utah, in conformity to the laws of the State (Utah Code Sections 72-5-308 through 310 inclusive), have caused this Acknowledgment and Notice of Acknowledgment to be made.

Signed by my hand in Salt Lake City, Utah, the 23rd day of APRIL, 2008.

By the Governor's Designee



John Harja

CERTIFICATION

State of Utah)
 : ss
County of Salt Lake)

I hereby certify that the signer of the foregoing document, John Harja, is personally known by me, has made a voluntary signature and taken an oath stating that he is the official designee of the Governor of the State of Utah and is authorized to sign this document on the Governor's behalf pursuant to Utah Code Section 72-5-309. He further vouched that, based upon information and belief, the facts alleged therein are true.

Dated this 23rd day of April, 2008.

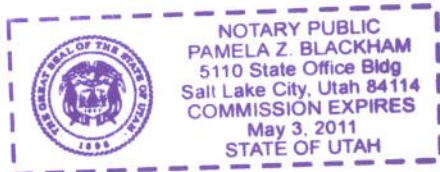



Notary Public

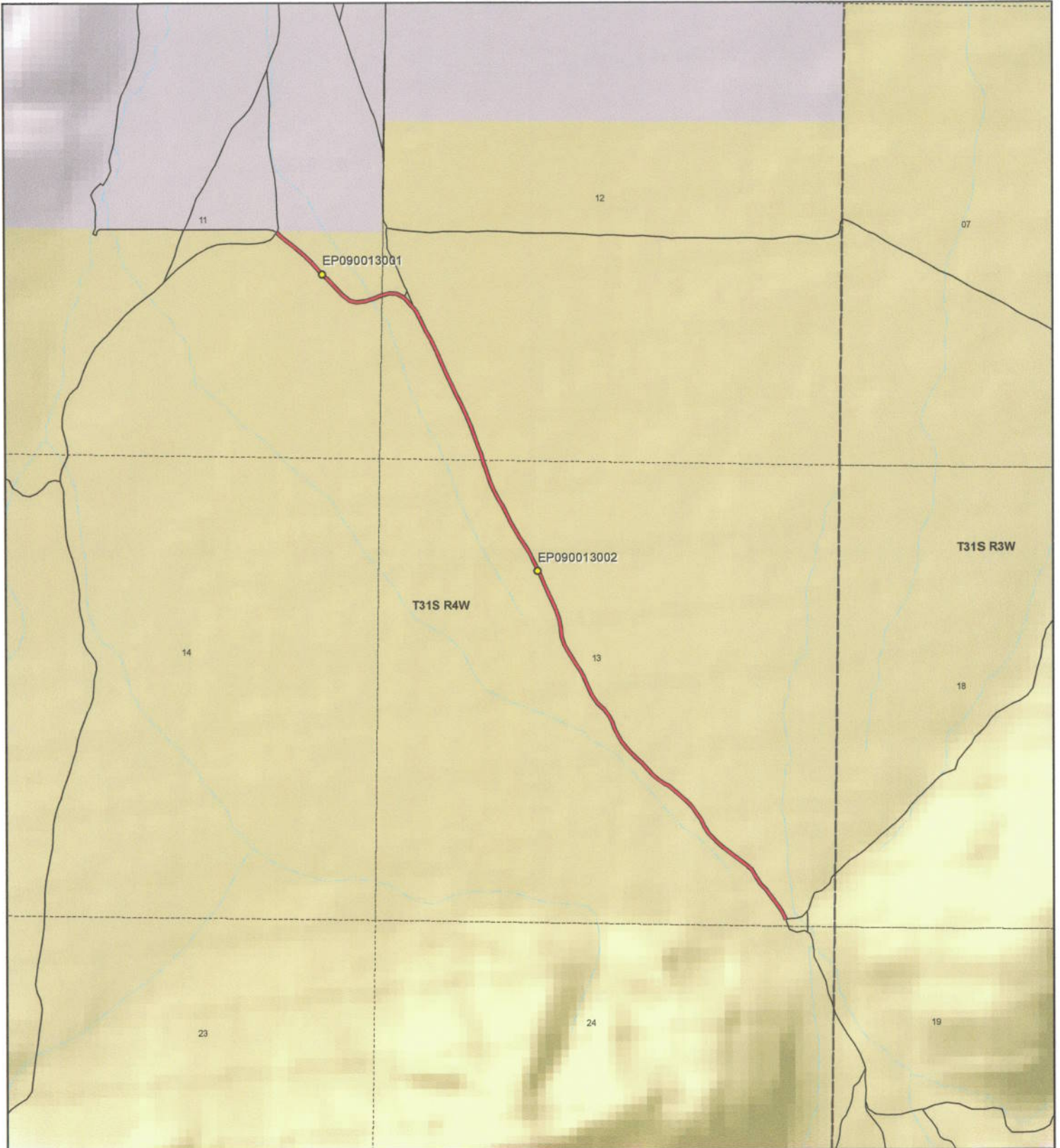

 <p>1:17,886 1 inch equals 0.3 miles</p>		<p style="text-align: center;">PINE SPRING ROAD - Garfield County SGID RD_ID RD090013</p> <table border="0"> <tr> <td colspan="2">Land Ownership Categories</td> <td colspan="2">Transportation Network</td> </tr> <tr> <td> BLM</td> <td> Wilderness</td> <td> PINE SPRING ROAD</td> <td> Title V: Issued Or Under Consideration By BLM Or County</td> </tr> <tr> <td> Private</td> <td> UDWR Wildlife Reserve</td> <td> Other Roads</td> <td> Photo Event Point</td> </tr> <tr> <td> SITLA, State Trust Land</td> <td> DOD, Military</td> <td> Section = 1 Mile</td> <td></td> </tr> <tr> <td> USFS, National Forest</td> <td> State Sovereign Land</td> <td></td> <td></td> </tr> <tr> <td> State Parks and Recreation</td> <td> National Recreation Area</td> <td></td> <td></td> </tr> <tr> <td> Tribal, Indian Reservation</td> <td> USFWS, Natl. Wildlife Refuge</td> <td></td> <td></td> </tr> <tr> <td> NPS, National Park</td> <td></td> <td></td> <td></td> </tr> </table>	Land Ownership Categories		Transportation Network		BLM	Wilderness	PINE SPRING ROAD	Title V: Issued Or Under Consideration By BLM Or County	Private	UDWR Wildlife Reserve	Other Roads	Photo Event Point	SITLA, State Trust Land	DOD, Military	Section = 1 Mile		USFS, National Forest	State Sovereign Land			State Parks and Recreation	National Recreation Area			Tribal, Indian Reservation	USFWS, Natl. Wildlife Refuge			NPS, National Park				<p>Map prepared by the State of Utah Automated Geographic Reference Center Room 5130 State Office Building Salt Lake City, Utah 84114 Feb 27, 2008</p> 
Land Ownership Categories		Transportation Network																																	
BLM	Wilderness	PINE SPRING ROAD	Title V: Issued Or Under Consideration By BLM Or County																																
Private	UDWR Wildlife Reserve	Other Roads	Photo Event Point																																
SITLA, State Trust Land	DOD, Military	Section = 1 Mile																																	
USFS, National Forest	State Sovereign Land																																		
State Parks and Recreation	National Recreation Area																																		
Tribal, Indian Reservation	USFWS, Natl. Wildlife Refuge																																		
NPS, National Park																																			

Attachment 2



EP090013001



EP090013002

EP000000000

EP000000000

EP000000000

EP000000000

PINE SPRING ROAD - Garfield County
SGID RD_ID RD090013

Map prepared by the State of Utah
Automated Geographic Reference Center
Room 5130 State Office Building
Salt Lake City, Utah 84114
February 29, 2008



Attachment 3

Beginning & Ending Points and Township, Range, and Section References For:

Popular Name: PINE SPRING ROAD

County: Garfield

County Road Number: 0034

State Geographic Information Database (SGID) Road Identification Number: RD090013.

Total Road Length: 1.95 miles more or less.

Beginning at a point on the road centerline located at 38 degrees 06 minutes 34.53 seconds North Latitude and -112 degrees 14 minutes 57.99 seconds West Longitude, which can be converted to mapping accuracy State Plane Utah South Zone NAD 83 feet coordinates of X = 1,424,785.5 feet and Y = 10,368,767.3 feet based on the US Survey Foot conversion.

Ending at a point on the road centerline located at 38 degrees 07 minutes 51.74 seconds North Latitude and -112 degrees 16 minutes 12.04 seconds West Longitude, which can be converted to mapping accuracy State Plane Utah South Zone NAD 83 feet coordinates of X = 1,418,932.3 feet and Y = 10,376,625.0 feet based on the US Survey Foot conversion.

This road may traverse:

Township 31 South Range 4 West, Section(s) 11,12,13, Salt Lake Base & Meridian
See Attachment 1 above for a cartographic depiction of the course of this road.

**Attachment 4
Road Centerline Description Cover Page(s)**

Popular Name: PINE SPRING ROAD

County: Garfield

County Road Number: 0034

State Geographic Information Database (SGID) Road Identification Number: RD090013.

Total Road Length: 1.95 miles more or less.

Centerline Descriptions Of Road-Segments That Cross Over Federally Owned Land, Derived From Global Positioning System Data And Cross-checked against USGS Digital Orthophoto Quadrangles Compiled By The Utah Automated Geographic Reference Center And Entered Into The State Geographic Information Database (SGID).

Road-Segments Listed by SGID Road Identification Number (RD_ID)	Road-Segment Numbers	Believed Ownership Of Servient Estate	Approximate Segment Length	See Attached Appendix
RD090013	001	BLM	1.95 Miles	A
		Total Road Length	1.95	_____

* Indicates that a Title V permit will be requested, is in process, or has been issued.

† Indicates that road-segments crossing Forest Service land are under consideration by the state and county as of the date of this Acknowledgment and Notice of Acknowledgment.

Attachment 5

AFFIDAVIT OF RUSSELL BULKLEY

PINE SPRING ROAD

GARFIELD COUNTY, UTAH

ROAD NUMBER 0034

State of Utah)
 : ss.
County of Garfield)

RUSSELL BULKLEY, being first duly sworn, deposes and states as follows:

1. I am an adult competent to testify about the matters set forth below based upon my personal knowledge. I currently reside in Panguitch, Garfield County, Utah. I have lived in Garfield County since 1959. In 1971 and 1972 I worked for the Utah Department of Transportation on roads and from 1973 to 1975 I worked for the Utah Division of Wildlife Resources.

2. I have traveled and am familiar with a road in Garfield County known as Pine Spring Road. I am also familiar with the land the road traverses. When I first used and observed the road in the early 1960s it followed the same route as in 2005 when I last observed it. Attached is a Garfield County map showing Pine Spring Road. To the best of my knowledge and based upon my use of and familiarity with this road and the land it traverses, the location and route of the road are correctly illustrated on the attached map.

3. The County also identifies this road according to the road number listed above.

4. I have observed that the road has been open to the public for all to use, to come and go as they pleased, since at least as early as the early 1960s and continuing through 2005. Throughout this time period I observed travel on the road by means of cars, trucks, pickup trucks and ATVs. During this time period, the road was used weekly, weather permitting, for more than ten continuous years prior to 1976 and was so used in 2005.

5. Throughout the time period from the early 1960s to 2005, I used the road myself for hunting, sightseeing and travel in and through the area.

6. Throughout the time period described in the previous paragraph, I have observed other vehicles from the general public using the road at various times for the uses described in the previous paragraph plus livestock operations and recreation.

7. It is also the reputation in the community that this road has been open to the public for all to use, to come and go as they pleased, since at least as early as the early 1900s and continuing through 1976 to the present, for the uses described in the previous paragraphs.

8. Prior to 1976, I observed the graded surface of the road and other evidence of maintenance and construction activities such as berms along the side of the road.

DATED this 12 day of July, 2007.



RUSSELL BULKLEY

SUBSCRIBED AND SWORN to before me this 12th day of July, 2007.

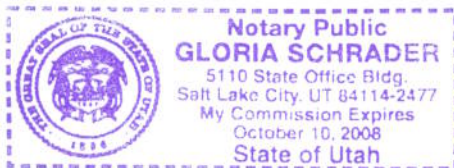



NOTARY PUBLIC

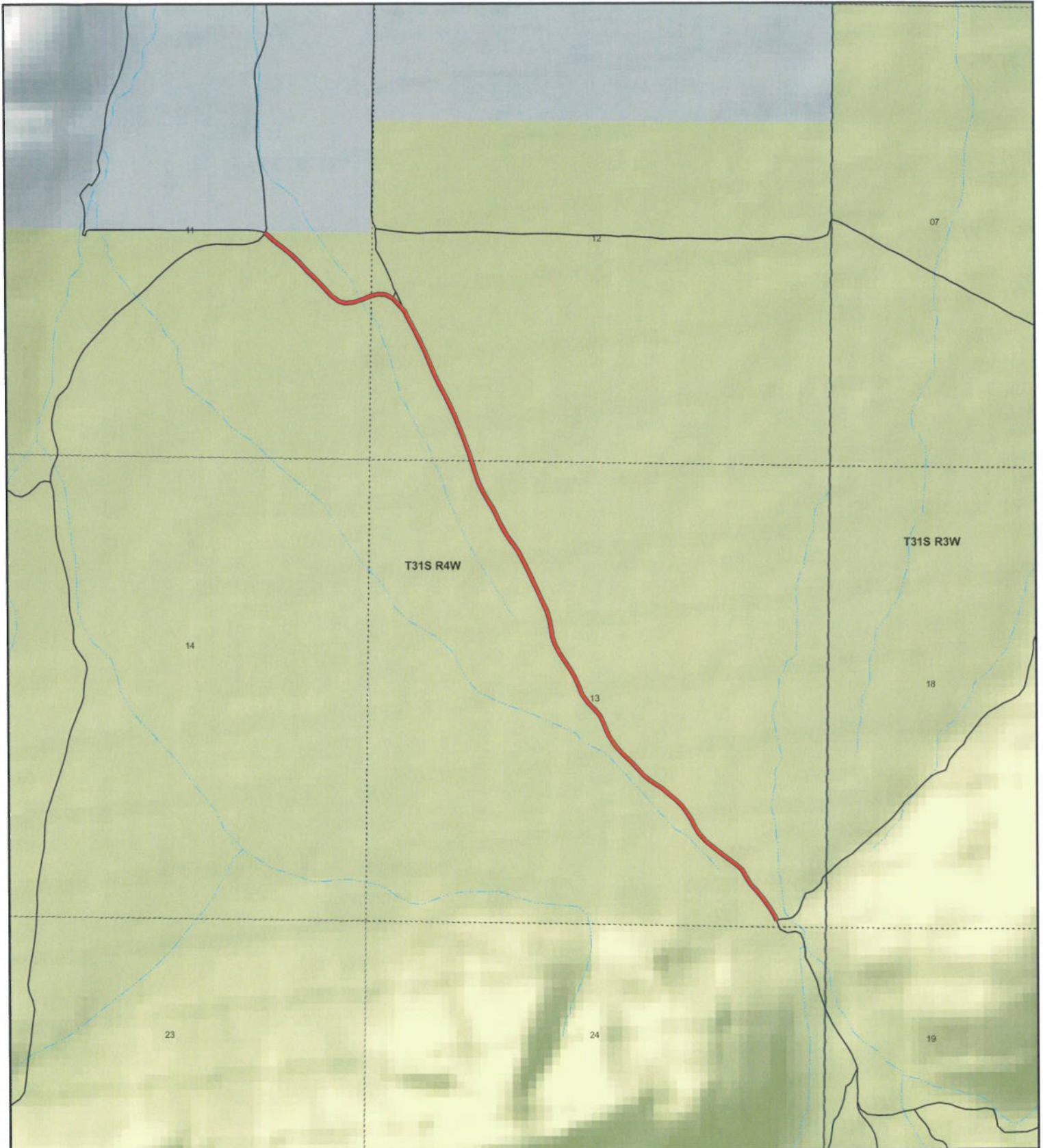

PINE SPRING RD
County Unique - 0034

Land Ownership Categories

- BLM
- Private
- SITLA, State Trust Land
- USFS, National Forest
- Wildlife Reserve
- National Park/Monument (NPS)
- National Rec. Area
- Wildemess
- State Park

Transportation Network

- PINE SPRING RD
- State / U.S. Highway
- Local Roads

Misc

- City / Town
- Municipalities
- Section = 1 Mile
- Monument Boundary



1:17,649
 1 inch equals 0.3 miles



Map prepared by the State of Utah
 AGRC
 Room 5130 State Office Building
 Salt Lake City, Utah 84114
 Jul 05, 2007



AFFIDAVIT OF D. MALOY DODDS

PINE SPRING ROAD

GARFIELD COUNTY, UTAH

ROAD NUMBER 0034

State of Utah)
 : ss.
County of Garfield)

D. MALOY DODDS, being first duly sworn, deposes and states as follows:

1. I am an adult competent to testify about the matters set forth below based upon my personal knowledge. I currently reside in Panguitch, Garfield County, Utah. I have lived in Garfield County for 76 years. I have been a Garfield County Commissioner for 12 years.

2. I have traveled and am familiar with a road in Garfield County known as Pine Spring Road. I am also familiar with the land the road traverses. When I first used and observed the road in the early 1960s it followed the same route as in 1990 when I last observed it. Attached is a Garfield County map showing Pine Spring Road. To the best of my knowledge and based upon my use of and familiarity with this road and the land it traverses, the location and route of the road are correctly illustrated on the attached map.

3. I am informed that the County also identifies this road according to the road number listed above.

4. I have observed that the road has been open to the public for all to use, to come and go as they pleased, since at least as early as the early 1960s and continuing through 1976 to 1990. Throughout this time period I have observed travel on the road by means of cars, trucks, ATVs and pickup trucks. Throughout this time period, the road has been used weekly, for more than ten continuous years prior to 1976, and was so used in 1990.

5. Throughout the time period from the early 1960s to 1990, I have used the road myself for hunting, recreation and travel in and through the area.

6. Throughout the time period described in the previous paragraph, I have observed other vehicles from the general public using the road at various times for the uses described in the previous paragraph plus livestock operations.

7. It is also the reputation in the community that this road has been open to the public for all to use, to come and go as they pleased, since at least as early as the early 1900s and continuing through 1976 to the present, for the uses described in the previous paragraphs.

8. Prior to 1976, I observed the graded surface of the road and other evidence of maintenance and construction activities such as berms along the side of the road.

DATED this 9 day of July, 2007.



D. MALOY DODDS

SUBSCRIBED AND SWORN to before me this 9th day of July, 2007.

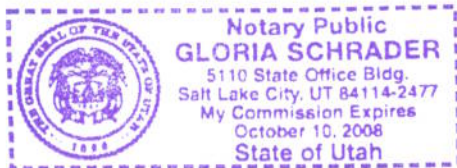



NOTARY PUBLIC

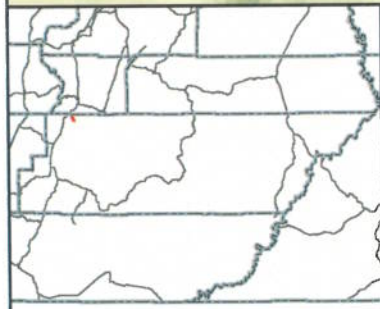
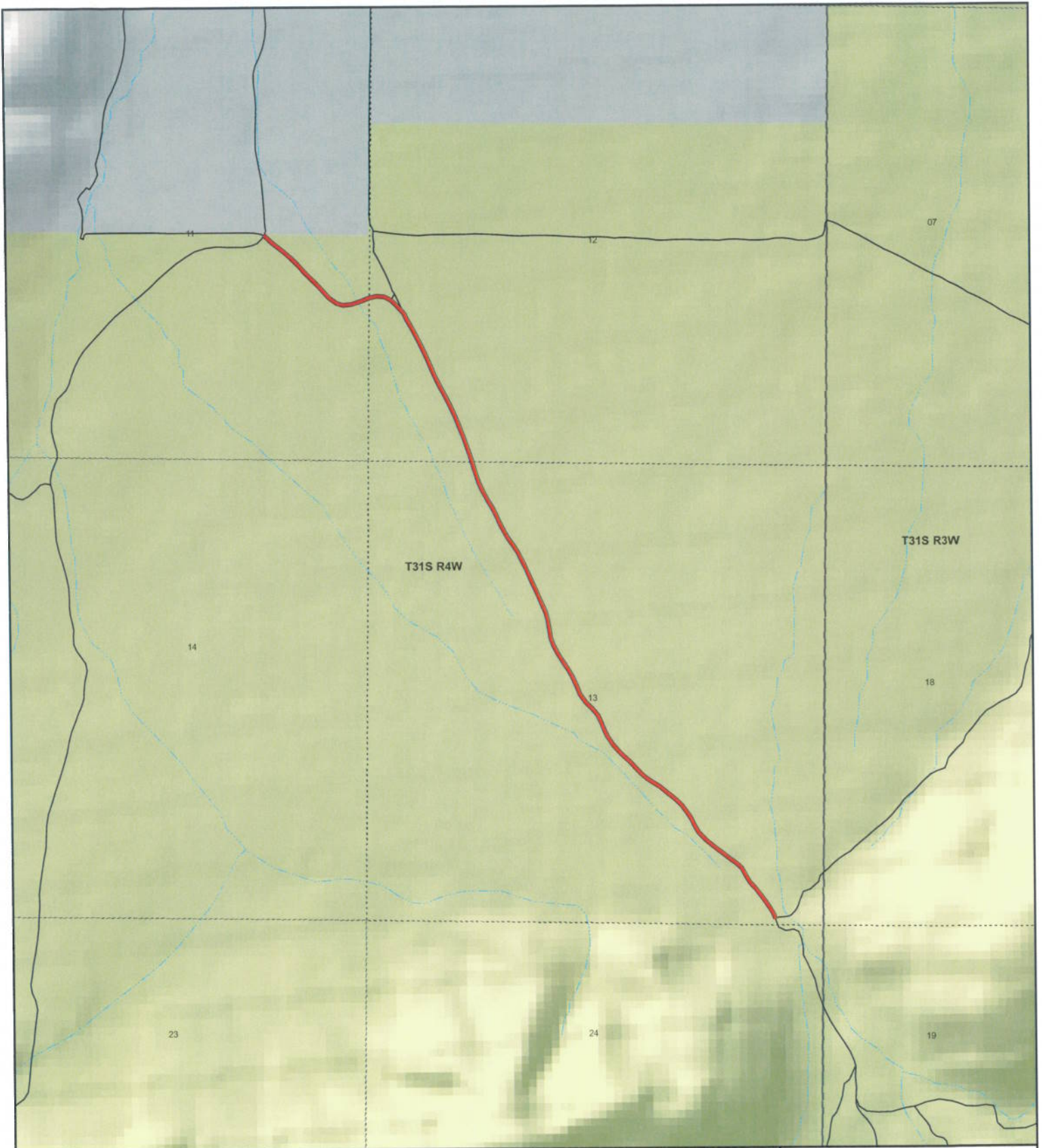

PINE SPRING RD
County Unique - 0034

Land Ownership Categories

- BLM
- Private
- SITLA, State Trust Land
- USFS, National Forest
- Wildlife Reserve
- National Park/Monument (NPS)
- National Rec. Area
- Wilderness
- State Park

Transportation Network

- PINE SPRING RD
- State / U.S. Highway
- Local Roads

Misc

- City / Town
- Municipalities
- Section = 1 Mile
- Monument Boundary



1:17,649

1 inch equals 0.3 miles



Map prepared by the State of Utah
AGRC
Room 5130 State Office Building
Salt Lake City, Utah 84114
July 05, 2007



Appendix A to Attachment 4

Popular Name: PINE SPRING ROAD

County: Garfield

County Road Number: 0034

State Geographic Information Database (SGID) Road Identification Number: RD090013.

Road-Segment Number: 001

Road-Segment Length: 1.95 miles more or less.

Believed owner of the land underlying this road-segment is: Bureau of Land Management.

The following description is based upon the geographic coordinate system using the NAD83 Datum. The source is GPS mapping grade data as indicated in the metadata and/or the transportation data model of the State of Utah Geographic Information Database (SGID).

The road-segment itself is the monument that is identified by its physical presence on the land. The location of said physical presence is closely approximated by mapping grade Global Positioning System (GPS) data. Said data are checked against the corresponding gray-scale 1-meter Digital Orthophoto Quadrangles published by the United States Geological Survey (USGS) to verify a reasonable degree of accuracy. In circumstances where accurate satellite signal acquisition is not possible, such as deep, narrow canyons or under a canopy of dense foliage, or where very sharp curves in the road make accuracy questionable, such portions of the road were digitized from the corresponding gray-scale 1-meter Digital Orthophoto Quadrangles published by the United States Geological Survey (USGS).

This road-segment may traverse:

Township 31 South Range 4 West, Section(s) 11,12,13, Salt Lake Base & Meridian

The following description closely approximates the location of the centerline of the physical monument (PINE SPRING ROAD)-- Segment 001 based on mapping grade Global Positioning System (GPS) data as defined above:

Beginning at a point on the road center line located at 38 degrees 06 minutes 34.53 seconds North Latitude and -112 degrees 14 minutes 57.99 seconds West Longitude, which can be converted to mapping accuracy State Plane Utah South Zone NAD 83 feet coordinates of X = 1,424,785.5 feet and Y = 10,368,767.3 feet; thence the following courses along the said road center line:

thence North 18 Degrees 02 Minutes 22 Seconds West 42 feet
thence North 29 Degrees 38 Minutes 06 Seconds West 88.4 feet
thence North 35 Degrees 34 Minutes 17 Seconds West 86.4 feet
thence North 36 Degrees 31 Minutes 17 Seconds West 91.1 feet
thence North 37 Degrees 40 Minutes 23 Seconds West 99.5 feet
thence North 43 Degrees 22 Minutes 53 Seconds West 103.3 feet
thence North 33 Degrees 13 Minutes 02 Seconds West 99.7 feet
thence North 29 Degrees 04 Minutes 46 Seconds West 95.5 feet
thence North 48 Degrees 53 Minutes 18 Seconds West 74.4 feet
thence North 53 Degrees 01 Minutes 45 Seconds West 100.2 feet
thence North 52 Degrees 29 Minutes 39 Seconds West 115.1 feet

thence North 53 Degrees 30 Minutes 32 Seconds West 112.3 feet
thence North 50 Degrees 12 Minutes 17 Seconds West 119.7 feet
thence North 43 Degrees 50 Minutes 35 Seconds West 117.7 feet
thence North 30 Degrees 09 Minutes 28 Seconds West 92.3 feet
thence North 26 Degrees 58 Minutes 19 Seconds West 88.5 feet
thence North 34 Degrees 07 Minutes 01 Seconds West 90.8 feet
thence North 36 Degrees 02 Minutes 01 Seconds West 95 feet
thence North 45 Degrees 34 Minutes 16 Seconds West 102.6 feet
thence North 49 Degrees 53 Minutes 09 Seconds West 116.4 feet
thence North 50 Degrees 14 Minutes 29 Seconds West 99.9 feet
thence North 54 Degrees 38 Minutes 49 Seconds West 34.3 feet
thence North 57 Degrees 57 Minutes 15 Seconds West 50.9 feet
thence North 56 Degrees 24 Minutes 21 Seconds West 96.5 feet
thence North 49 Degrees 41 Minutes 18 Seconds West 91.2 feet
thence North 42 Degrees 55 Minutes 34 Seconds West 89.2 feet
thence North 44 Degrees 11 Minutes 59 Seconds West 95.6 feet
thence North 46 Degrees 22 Minutes 58 Seconds West 99.3 feet
thence North 45 Degrees 38 Minutes 09 Seconds West 82.1 feet
thence North 43 Degrees 47 Minutes 04 Seconds West 69.6 feet
thence North 36 Degrees 23 Minutes 17 Seconds West 28.4 feet
thence North 35 Degrees 50 Minutes 59 Seconds West 42.3 feet
thence North 33 Degrees 39 Minutes 10 Seconds West 74.6 feet
thence North 24 Degrees 26 Minutes 40 Seconds West 89.9 feet
thence North 22 Degrees 06 Minutes 48 Seconds West 86.6 feet
thence North 27 Degrees 44 Minutes 53 Seconds West 86.9 feet
thence North 38 Degrees 48 Minutes 46 Seconds West 92.2 feet
thence North 45 Degrees 26 Minutes 21 Seconds West 104.7 feet
thence North 36 Degrees 28 Minutes 48 Seconds West 117.9 feet
thence North 22 Degrees 15 Minutes 55 Seconds West 115 feet
thence North 24 Degrees 15 Minutes 23 Seconds West 105.9 feet
thence North 29 Degrees 22 Minutes 00 Seconds West 87.8 feet
thence North 33 Degrees 07 Minutes 52 Seconds West 107.8 feet
thence North 33 Degrees 42 Minutes 43 Seconds West 125.8 feet
thence North 29 Degrees 48 Minutes 31 Seconds West 103.3 feet
thence North 18 Degrees 22 Minutes 21 Seconds West 95.3 feet
thence North 08 Degrees 51 Minutes 36 Seconds West 108.2 feet
thence North 08 Degrees 52 Minutes 15 Seconds West 99.2 feet
thence North 17 Degrees 00 Minutes 41 Seconds West 99.4 feet
thence North 23 Degrees 44 Minutes 27 Seconds West 118 feet
thence North 25 Degrees 34 Minutes 25 Seconds West 116.1 feet
thence North 26 Degrees 16 Minutes 58 Seconds West 113.2 feet
thence North 23 Degrees 48 Minutes 38 Seconds West 107 feet
thence North 24 Degrees 28 Minutes 07 Seconds West 108.3 feet
thence North 28 Degrees 16 Minutes 12 Seconds West 96.6 feet
thence North 27 Degrees 24 Minutes 13 Seconds West 95.8 feet
thence North 33 Degrees 15 Minutes 19 Seconds West 97.8 feet
thence North 33 Degrees 40 Minutes 18 Seconds West 110.4 feet
thence North 32 Degrees 06 Minutes 53 Seconds West 88.4 feet
thence North 28 Degrees 30 Minutes 40 Seconds West 87.5 feet

thence North 24 Degrees 34 Minutes 49 Seconds West 106.2 feet
 thence North 27 Degrees 11 Minutes 33 Seconds West 106.7 feet
 thence North 30 Degrees 57 Minutes 46 Seconds West 103 feet
 thence North 29 Degrees 46 Minutes 29 Seconds West 107.4 feet
 thence North 23 Degrees 28 Minutes 05 Seconds West 116 feet
 thence North 18 Degrees 50 Minutes 47 Seconds West 119.8 feet
 thence North 16 Degrees 53 Minutes 46 Seconds West 109.2 feet
 thence North 16 Degrees 38 Minutes 07 Seconds West 20.3 feet
 thence North 16 Degrees 38 Minutes 07 Seconds West 75.5 feet
 thence North 19 Degrees 31 Minutes 49 Seconds West 98.7 feet
 thence North 22 Degrees 03 Minutes 49 Seconds West 139.9 feet
 thence North 19 Degrees 45 Minutes 08 Seconds West 118.3 feet
 thence North 22 Degrees 38 Minutes 44 Seconds West 131.3 feet
 thence North 25 Degrees 11 Minutes 54 Seconds West 130.2 feet
 thence North 26 Degrees 05 Minutes 10 Seconds West 127.5 feet
 thence North 27 Degrees 08 Minutes 19 Seconds West 128.7 feet
 thence North 26 Degrees 04 Minutes 38 Seconds West 136.6 feet
 thence North 23 Degrees 15 Minutes 32 Seconds West 137.2 feet
 thence North 23 Degrees 22 Minutes 08 Seconds West 139.1 feet
 thence North 25 Degrees 49 Minutes 44 Seconds West 136.4 feet
 thence North 27 Degrees 43 Minutes 32 Seconds West 109.1 feet
 thence North 28 Degrees 10 Minutes 19 Seconds West 103.9 feet
 thence North 27 Degrees 45 Minutes 07 Seconds West 96.1 feet
 thence North 25 Degrees 20 Minutes 53 Seconds West 60.5 feet
 thence North 35 Degrees 51 Minutes 00 Seconds West 25.4 feet
 thence North 41 Degrees 39 Minutes 36 Seconds West 54.6 feet
 thence North 43 Degrees 25 Minutes 08 Seconds West 56.2 feet
 thence North 43 Degrees 19 Minutes 20 Seconds West 60.1 feet
 thence North 47 Degrees 48 Minutes 07 Seconds West 26.7 feet
 thence North 66 Degrees 20 Minutes 59 Seconds West 12.9 feet
 thence North 62 Degrees 33 Minutes 14 Seconds West 70.5 feet
 thence North 86 Degrees 51 Minutes 54 Seconds West 81.9 feet
 thence South 74 Degrees 41 Minutes 33 Seconds West 89.5 feet
 thence South 74 Degrees 41 Minutes 28 Seconds West 5.6 feet
 thence South 67 Degrees 59 Minutes 32 Seconds West 98.5 feet
 thence South 73 Degrees 09 Minutes 49 Seconds West 102.7 feet
 thence South 82 Degrees 02 Minutes 33 Seconds West 98.7 feet
 thence North 74 Degrees 51 Minutes 04 Seconds West 80 feet
 thence North 51 Degrees 47 Minutes 33 Seconds West 104.9 feet
 thence North 43 Degrees 58 Minutes 48 Seconds West 129.7 feet
 thence North 44 Degrees 12 Minutes 17 Seconds West 132.1 feet
 thence North 43 Degrees 58 Minutes 31 Seconds West 129.3 feet
 thence North 41 Degrees 57 Minutes 29 Seconds West 126.9 feet
 thence North 45 Degrees 32 Minutes 07 Seconds West 119.3 feet
 thence North 49 Degrees 29 Minutes 50 Seconds West 133.5 feet
 thence North 52 Degrees 23 Minutes 49 Seconds West 122.3 feet
 thence North 48 Degrees 38 Minutes 55 Seconds West 103.7 feet
 thence North 48 Degrees 21 Minutes 39 Seconds West 39.3 feet more or less to **the ending**

point at: 38 degrees 07 minutes 51.74 seconds North Latitude and -112 degrees 16 minutes 12.04 seconds

West Longitude, which can be converted to mapping accuracy State Plane Utah South Zone NAD 83 feet coordinates of X = 1,418,932.3 feet and Y = 10,376,625.0 feet.