

**Acknowledgment and  
Notice of Acknowledgment  
of Acceptance of R.S. 2477  
Right-of-Way Grant**

Ent 251341 Bk 429 Pg 476  
Date: 09-MAY-2008 1:30PM  
Fee: None  
Filed By: CT  
LES BARKER, Recorder  
GARFIELD COUNTY CORPORATION  
For: GOVERNOR/STATE OF UTAH

**THE STATE OF UTAH**

**TO ALL WHOM THESE PRESENTS SHALL COME, Greeting:**

**Know ye,** This is an Acknowledgment and Notice of Acknowledgment made under Utah Code Sections 72-5-309 through 310 inclusive, that the grant of the United States of America of “the right of way for the construction of highways over public lands, not reserved for public uses” under United States Revised Statutes 2477 (43 U.S.C. Section 932 (repealed October 21, 1976, with proviso recognizing the validity of rights-of-way already established)) was accepted for and on behalf of the State of Utah and its political subdivision Garfield County as it pertains to the highway located in Garfield County known as EAST HORSE VALLEY PEAK ROAD; County Road Number: 0038; State Geographic Information Database (SGID) Road Identification Number: RD090014. Total road length is 2.27 miles more or less.

The reason for this Acknowledgment and Notice of Acknowledgment includes, but is not limited to, the fact that the road was constructed, mechanically, or by continuous use as a public highway for a period of at least ten years, over public lands not reserved for public uses, prior to the earlier of (a) the October 21, 1976 repeal of R.S. 2477 or (b) the date the servient estate was reserved for public uses.

This Acknowledgment and Notice of Acknowledgment applies only to the segments of the road that traverse land owned by the Bureau of Land Management, United States Department of the Interior, and does not apply to segments of the road that traverse land owned by any other person or entity. The State of Utah and its political subdivisions reserve the right to make further acknowledgments and notices of acknowledgment with regard to road segments that traverse land owned by other entities, including the United States of America, through one or more of its agencies.

A printed copy of a map showing the location of the road in said county is appended hereto as “Attachment 1,” a printed copy of representative photos of the road is appended hereto as “Attachment 2,” a printed copy of a description of the beginning and ending points of the entire road together with a list of Townships, Ranges and Sections that may be traversed by the road in said county is appended hereto as “Attachment 3,” and a printed copy of the Road Centerline Description Cover Page(s) is appended hereto as “Attachment 4.” The Appendices listed in “Attachment 4” that contain the actual road centerline descriptions are incorporated herein by reference. Affidavits provided by individuals familiar with the road are appended hereto as “Attachment 5.”

A printed copy of this Acknowledgment and Notice of Acknowledgment, together with its Attachments and Appendices, may be viewed and/or obtained at the office of the Utah State Archives.

An electronic copy of this Acknowledgment and Notice of Acknowledgment, together with its Attachments and Appendices, may be viewed and/or downloaded as read-only PDF (Portable Document Format) files via the

Internet at <http://recorded2477roads.utah.gov>.

The owner of the servient estate in the land underlying the road-segments subject to this Acknowledgment and Notice is believed to be the United States of America through one or more of its agencies. Any of such agencies or any other person with a servient ownership claim or a competing dominant estate right-of-way ownership claim, may file a petition in the State District Court for Salt Lake County for a decision regarding the correctness of this Acknowledgment. A claimant shall file a petition within sixty (60) days after receipt of this Notice.

**In Witness Whereof**, I, John Harja, the official designee of the Governor of the State of Utah, in conformity to the laws of the State (Utah Code Sections 72-5-308 through 310 inclusive), have caused this Acknowledgment and Notice of Acknowledgment to be made.

Signed by my hand in Salt Lake City, Utah, the 23<sup>rd</sup> day of April, 2008.

By the Governor's Designee

  
\_\_\_\_\_  
John Harja

**CERTIFICATION**

State of Utah                    )  
  : ss  
County of Salt Lake         )

I hereby certify that the signer of the foregoing document, John Harja, is personally known by me, has made a voluntary signature and taken an oath stating that he is the official designee of the Governor of the State of Utah and is authorized to sign this document on the Governor's behalf pursuant to Utah Code Section 72-5-309. He further vouched that, based upon information and belief, the facts alleged therein are true.



Dated this 23<sup>rd</sup> day of April, 2008.

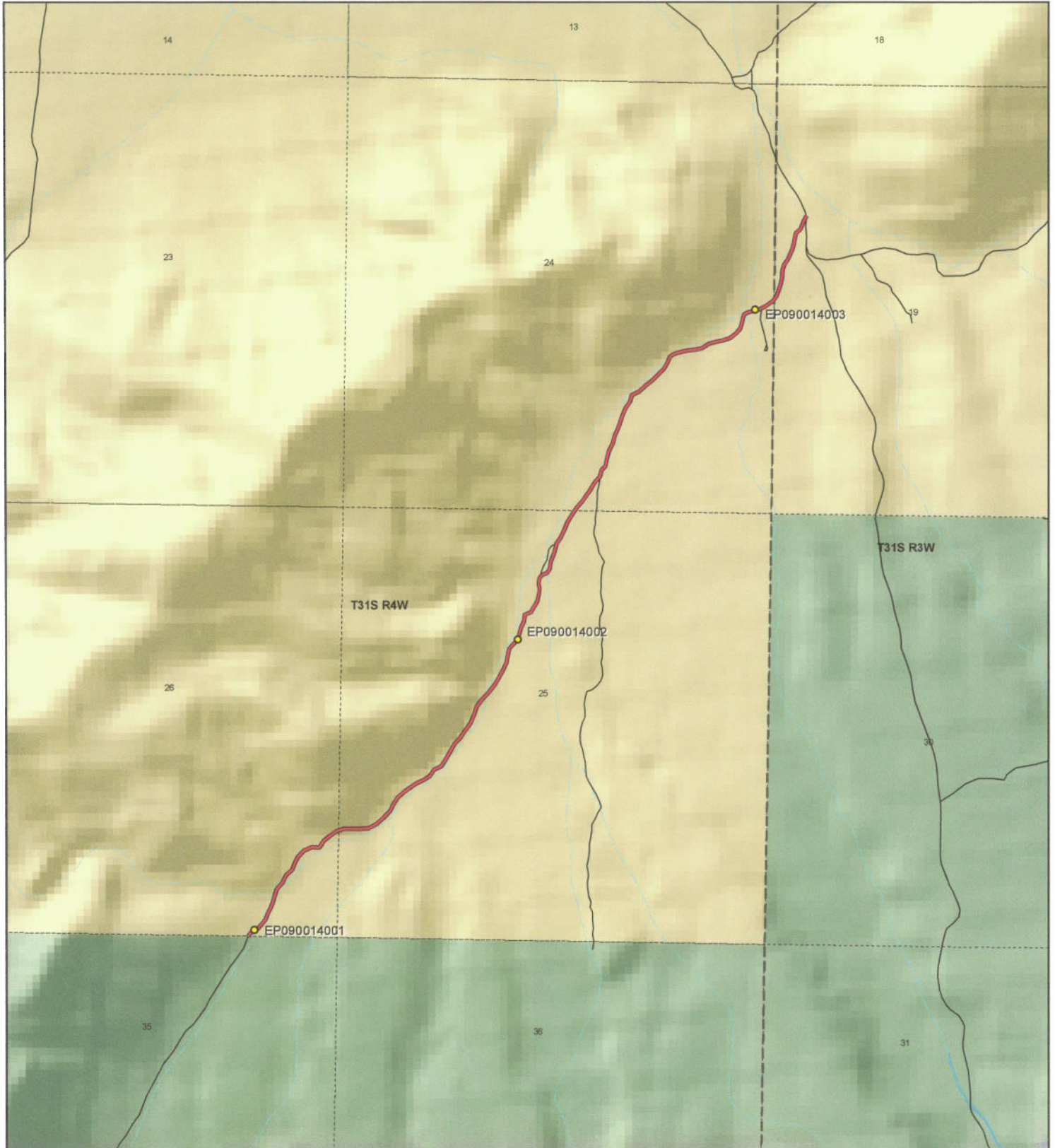

  
\_\_\_\_\_  
Notary Public

Attachment 1



 <p>1:19,162 1 inch equals 0.3 miles</p>		<p align="center"><b>EAST HORSE VALLEY PEAK ROAD - Garfield County</b> <b>SGID RD_ID RD090014</b></p> <table border="0"> <tr> <td><b>Land Ownership Categories</b></td> <td> <ul style="list-style-type: none"> <li><span style="color: yellow;">●</span> BLM</li> <li><span style="color: lightgrey;">●</span> Private</li> <li><span style="color: lightblue;">●</span> SITLA, State Trust Land</li> <li><span style="color: green;">●</span> USFS, National Forest</li> <li><span style="color: blue;">●</span> State Parks and Recreation</li> <li><span style="color: orange;">●</span> Tribal, Indian Reservation</li> <li><span style="color: lightgreen;">●</span> NPS, National Park</li> </ul> </td> <td> <ul style="list-style-type: none"> <li><span style="color: darkgreen;">◆</span> Wilderness</li> <li><span style="color: brown;">◆</span> UDWR Wildlife Reserve</li> <li><span style="color: grey;">◆</span> DOD, Military</li> <li><span style="color: lightblue;">◆</span> State Sovereign Land</li> <li><span style="color: pink;">◆</span> National Recreation Area</li> <li><span style="color: olive;">◆</span> USFWS, Natl. Wildlife Refuge</li> </ul> </td> <td> <table border="0"> <tr> <td><b>Transportation Network</b></td> <td> <ul style="list-style-type: none"> <li><span style="color: red;">—</span> EAST HORSE VALLEY PEAK RD</li> <li><span style="color: red;">—</span> Title V: Issued Or Under Consideration By BLM Or County</li> <li><span style="color: black;">—</span> Other Roads</li> <li><span style="color: yellow;">●</span> Photo Event Point</li> <li><span style="border: 1px dashed black; border-radius: 50%; padding: 2px;"> </span> Section = 1 Mile</li> </ul> </td> </tr> </table> </td> </tr> </table>	<b>Land Ownership Categories</b>	<ul style="list-style-type: none"> <li><span style="color: yellow;">●</span> BLM</li> <li><span style="color: lightgrey;">●</span> Private</li> <li><span style="color: lightblue;">●</span> SITLA, State Trust Land</li> <li><span style="color: green;">●</span> USFS, National Forest</li> <li><span style="color: blue;">●</span> State Parks and Recreation</li> <li><span style="color: orange;">●</span> Tribal, Indian Reservation</li> <li><span style="color: lightgreen;">●</span> NPS, National Park</li> </ul>	<ul style="list-style-type: none"> <li><span style="color: darkgreen;">◆</span> Wilderness</li> <li><span style="color: brown;">◆</span> UDWR Wildlife Reserve</li> <li><span style="color: grey;">◆</span> DOD, Military</li> <li><span style="color: lightblue;">◆</span> State Sovereign Land</li> <li><span style="color: pink;">◆</span> National Recreation Area</li> <li><span style="color: olive;">◆</span> USFWS, Natl. Wildlife Refuge</li> </ul>	<table border="0"> <tr> <td><b>Transportation Network</b></td> <td> <ul style="list-style-type: none"> <li><span style="color: red;">—</span> EAST HORSE VALLEY PEAK RD</li> <li><span style="color: red;">—</span> Title V: Issued Or Under Consideration By BLM Or County</li> <li><span style="color: black;">—</span> Other Roads</li> <li><span style="color: yellow;">●</span> Photo Event Point</li> <li><span style="border: 1px dashed black; border-radius: 50%; padding: 2px;"> </span> Section = 1 Mile</li> </ul> </td> </tr> </table>	<b>Transportation Network</b>	<ul style="list-style-type: none"> <li><span style="color: red;">—</span> EAST HORSE VALLEY PEAK RD</li> <li><span style="color: red;">—</span> Title V: Issued Or Under Consideration By BLM Or County</li> <li><span style="color: black;">—</span> Other Roads</li> <li><span style="color: yellow;">●</span> Photo Event Point</li> <li><span style="border: 1px dashed black; border-radius: 50%; padding: 2px;"> </span> Section = 1 Mile</li> </ul>	<p>Map prepared by the State of Utah Automated Geographic Reference Center Room 5130 State Office Building Salt Lake City, Utah 84114 Feb 27, 2008</p> 
<b>Land Ownership Categories</b>	<ul style="list-style-type: none"> <li><span style="color: yellow;">●</span> BLM</li> <li><span style="color: lightgrey;">●</span> Private</li> <li><span style="color: lightblue;">●</span> SITLA, State Trust Land</li> <li><span style="color: green;">●</span> USFS, National Forest</li> <li><span style="color: blue;">●</span> State Parks and Recreation</li> <li><span style="color: orange;">●</span> Tribal, Indian Reservation</li> <li><span style="color: lightgreen;">●</span> NPS, National Park</li> </ul>	<ul style="list-style-type: none"> <li><span style="color: darkgreen;">◆</span> Wilderness</li> <li><span style="color: brown;">◆</span> UDWR Wildlife Reserve</li> <li><span style="color: grey;">◆</span> DOD, Military</li> <li><span style="color: lightblue;">◆</span> State Sovereign Land</li> <li><span style="color: pink;">◆</span> National Recreation Area</li> <li><span style="color: olive;">◆</span> USFWS, Natl. Wildlife Refuge</li> </ul>	<table border="0"> <tr> <td><b>Transportation Network</b></td> <td> <ul style="list-style-type: none"> <li><span style="color: red;">—</span> EAST HORSE VALLEY PEAK RD</li> <li><span style="color: red;">—</span> Title V: Issued Or Under Consideration By BLM Or County</li> <li><span style="color: black;">—</span> Other Roads</li> <li><span style="color: yellow;">●</span> Photo Event Point</li> <li><span style="border: 1px dashed black; border-radius: 50%; padding: 2px;"> </span> Section = 1 Mile</li> </ul> </td> </tr> </table>	<b>Transportation Network</b>	<ul style="list-style-type: none"> <li><span style="color: red;">—</span> EAST HORSE VALLEY PEAK RD</li> <li><span style="color: red;">—</span> Title V: Issued Or Under Consideration By BLM Or County</li> <li><span style="color: black;">—</span> Other Roads</li> <li><span style="color: yellow;">●</span> Photo Event Point</li> <li><span style="border: 1px dashed black; border-radius: 50%; padding: 2px;"> </span> Section = 1 Mile</li> </ul>				
<b>Transportation Network</b>	<ul style="list-style-type: none"> <li><span style="color: red;">—</span> EAST HORSE VALLEY PEAK RD</li> <li><span style="color: red;">—</span> Title V: Issued Or Under Consideration By BLM Or County</li> <li><span style="color: black;">—</span> Other Roads</li> <li><span style="color: yellow;">●</span> Photo Event Point</li> <li><span style="border: 1px dashed black; border-radius: 50%; padding: 2px;"> </span> Section = 1 Mile</li> </ul>								

Attachment 2



EP090014001



EP090014002



EP090014003

EP000000000

EP000000000

EP000000000

**EAST HORSE VALLEY PEAK ROAD - Garfield County**  
**SGID RD\_ID RD090014**



Map prepared by the State of Utah  
Automated Geographic Reference Center  
Room 5130 State Office Building  
Salt Lake City, Utah 84114  
February 29, 2008



### Attachment 3

#### Beginning & Ending Points and Township, Range, and Section References For:

**Popular Name: EAST HORSE VALLEY PEAK ROAD**

**County: Garfield**

**County Road Number: 0038**

**State Geographic Information Database (SGID) Road Identification Number: RD090014.**

**Total Road Length: 2.27 miles more or less.**

**Beginning at a point** on the road centerline located at 38 degrees 04 minutes 49.69 seconds North Latitude and -112 degrees 16 minutes 10.75 seconds West Longitude, which can be converted to mapping accuracy State Plane Utah South Zone NAD 83 feet coordinates of X = 1,418,884.0 feet and Y = 10,358,209.5 feet based on the US Survey Foot conversion.

**Ending at a point** on the road centerline located at 38 degrees 06 minutes 17.87 seconds North Latitude and -112 degrees 14 minutes 46.27 seconds West Longitude, which can be converted to mapping accuracy State Plane Utah South Zone NAD 83 feet coordinates of X = 1,425,709.3 feet and Y = 10,367,074.1 feet based on the US Survey Foot conversion.

This road may traverse:

Township 31 South Range 3 West, Section(s) 19, Salt Lake Base & Meridian

Township 31 South Range 4 West, Section(s) 24,25,26,35, Salt Lake Base & Meridian

See Attachment 1 above for a cartographic depiction of the course of this road.

**Attachment 4  
Road Centerline Description Cover Page(s)**

**Popular Name: EAST HORSE VALLEY PEAK ROAD**

**County: Garfield**

**County Road Number: 0038**

**State Geographic Information Database (SGID) Road Identification Number: RD090014.**

**Total Road Length: 2.27 miles more or less.**

**Centerline Descriptions Of Road-Segments That Cross Over Federally Owned Land, Derived From Global Positioning System Data And Cross-checked against USGS Digital Orthophoto Quadrangles Compiled By The Utah Automated Geographic Reference Center And Entered Into The State Geographic Information Database (SGID).**

<b>Road-Segments Listed by SGID Road Identification Number (RD_ID)</b>	<b>Road-Segment Numbers</b>	<b>Believed Ownership Of Servient Estate</b>	<b>Approximate Segment Length</b>	<b>See Attached Appendix</b>
<b>RD090014</b>	<b>001</b>	<b>FS</b>	<b>0 Miles</b>	<b>†(pending)</b>
<b>RD090014</b>	<b>002</b>	<b>BLM</b>	<b>2.27 Miles</b>	<b>A</b>
		<b>Total Road Length</b>	<b>2.27</b>	<b>_____</b>

\* Indicates that a Title V permit will be requested, is in process, or has been issued.

† Indicates that road-segments crossing Forest Service land are under consideration by the state and county as of the date of this Acknowledgment and Notice of Acknowledgment.

## Attachment 5

**AFFIDAVIT OF RUSSELL BULKLEY**  
**EAST HORSE VALLEY PEAK ROAD**  
**GARFIELD COUNTY, UTAH**  
**ROAD NUMBER 0038**

State of Utah                    )  
  : ss.  
County of Garfield            )

RUSSELL BULKLEY, being first duly sworn, deposes and states as follows:

1.       I am an adult competent to testify about the matters set forth below based upon my personal knowledge. I currently reside in Panguitch, Garfield County, Utah. I have lived in Garfield County since 1959. In 1971 and 1972 I worked for the Utah Department of Transportation on roads and from 1973 to 1975 I worked for the Utah Division of Wildlife Resources.

2.       I have traveled and am familiar with a road in Garfield County known as East Horse Valley Peak Road. I am also familiar with the land the road traverses. When I first used and observed the road in the early 1960s it followed the same route as in 2005 when I last observed it. Attached is a Garfield County map showing East Horse Valley Peak Road. To the best of my knowledge and based upon my use of and familiarity with this road and the land it traverses, the location and route of the road are correctly illustrated on the attached map.

3.       The County also identifies this road according to the road number listed above.

4.       I have observed that the road has been open to the public for all to use, to come and go as they pleased, since at least as early as the early 1960s and continuing through 2005. Throughout this time period I observed travel on the road by means of cars, trucks, pickup trucks and ATVs. During this time period, the road was used weekly, weather permitting, for more than ten continuous years prior to 1976 and was so used in 2005.



5. Throughout the time period from the early 1960s to 2005, I used the road myself for hunting, sightseeing and travel in and through the area.

6. Throughout the time period described in the previous paragraph, I have observed other vehicles from the general public using the road at various times for the uses described in the previous paragraph plus livestock operations and recreation.

7. It is also the reputation in the community that this road has been open to the public for all to use, to come and go as they pleased, since at least as early as the early 1900s and continuing through 1976 to the present, for the uses described in the previous paragraphs.

8. Prior to 1976, I observed the graded surface of the road and other evidence of maintenance and construction activities such as berms along the side of the road.

DATED this 12 day of July, 2007.

  
\_\_\_\_\_  
RUSSELL BULKLEY

SUBSCRIBED AND SWORN to before me this 12<sup>th</sup> day of July, 2007.

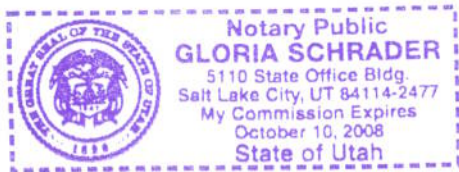

  
\_\_\_\_\_  
NOTARY PUBLIC

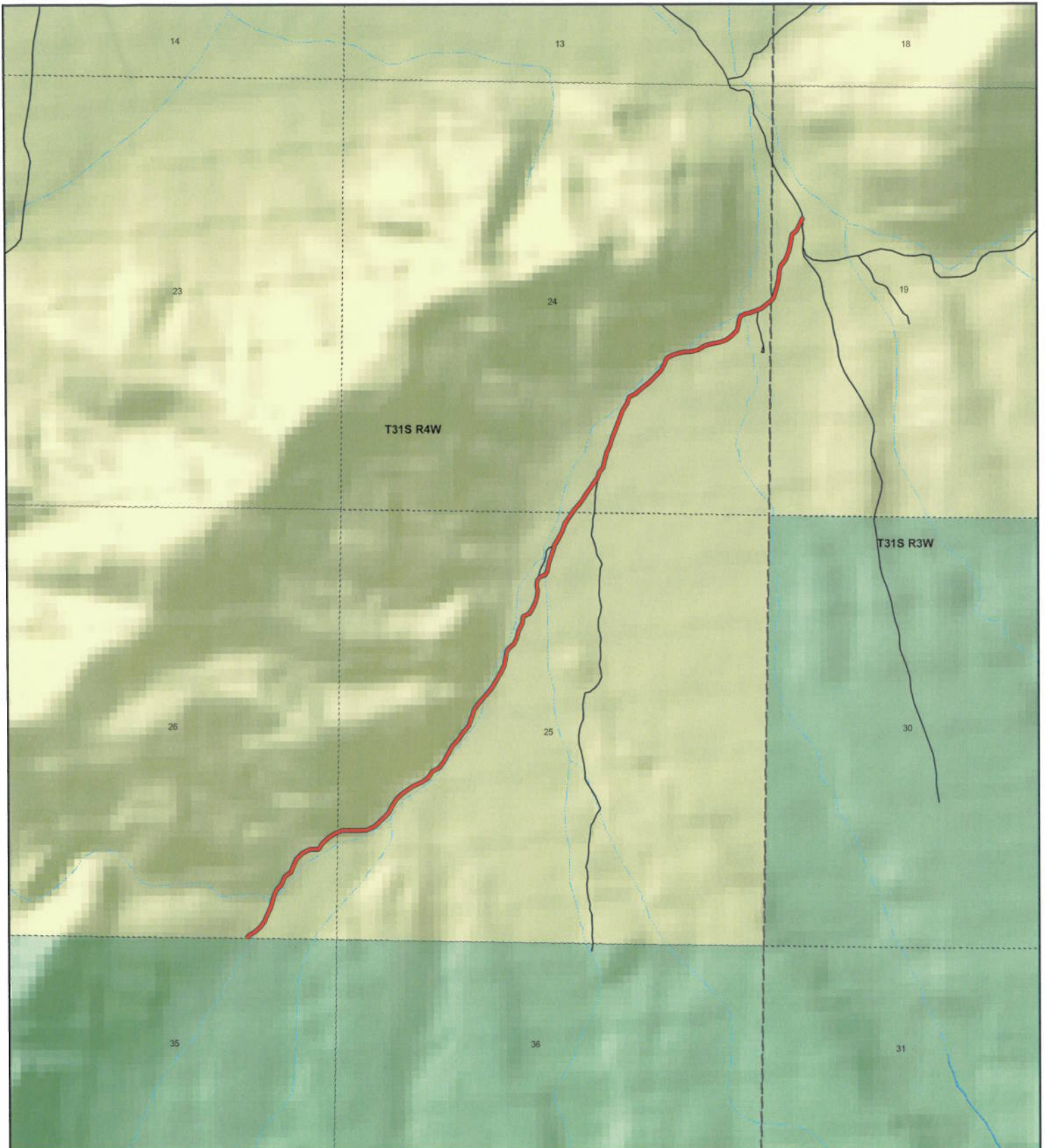

**EAST HORSE VALLEY PEAK RD**  
**County Unique - 0038**

**Land Ownership Categories**

- BLM
- Private
- SITLA, State Trust Land
- USFS, National Forest
- Wildlife Reserve
- National Park/Monument (NPS)
- National Rec. Area
- Wilderness
- State Park

**Transportation Network**

- EAST HORSE VALLEY PEAK RD
- State / U.S. Highway
- Local Roads

**Misc**

- City / Town
- Municipalities
- Section = 1 Mile
- Monument Boundary



1:18,909  
 1 inch equals 0.3 miles

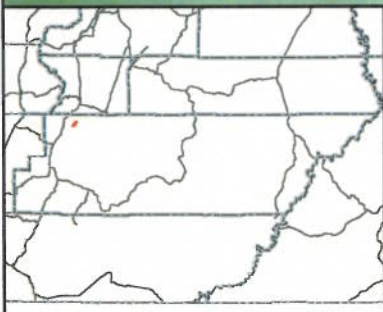

Map prepared by the State of Utah  
 AGRC  
 Room 5130 State Office Building  
 Salt Lake City, Utah 84114  
 Jul 05, 2007



**AFFIDAVIT OF D. MALOY DODDS**  
**EAST HORSE VALLEY PEAK ROAD**  
**GARFIELD COUNTY, UTAH**

**ROAD NUMBER 0038**

State of Utah                    )  
  : ss.  
County of Garfield            )

D. MALOY DODDS, being first duly sworn, deposes and states as follows:

1. I am an adult competent to testify about the matters set forth below based upon my personal knowledge. I currently reside in Panguitch, Garfield County, Utah. I have lived in Garfield County for 76 years. I have been a Garfield County Commissioner for 12 years.

2. I have traveled and am familiar with a road in Garfield County known as East Horse Valley Peak Road. I am also familiar with the land the road traverses. When I first used and observed the road in the early 1960s it followed the same route as in 1990 when I last observed it. Attached is a Garfield County map showing East Horse Valley Peak Road. To the best of my knowledge and based upon my use of and familiarity with this road and the land it traverses, the location and route of the road are correctly illustrated on the attached map.

3. I am informed that the County also identifies this road according to the road number listed above.

4. I have observed that the road has been open to the public for all to use, to come and go as they pleased, since at least as early as the early 1960s and continuing through 1976 to 1990. Throughout this time period I have observed travel on the road by means of cars, trucks, ATVs and pickup trucks. Throughout this time period, the road has been used weekly, for more than ten continuous years prior to 1976, and was so used in 1990.

5. Throughout the time period from the early 1960s to 1990, I have used the road myself for hunting, recreation and travel in and through the area.

6. Throughout the time period described in the previous paragraph, I have observed other vehicles from the general public using the road at various times for the uses described in the previous paragraph plus livestock operations.

7. It is also the reputation in the community that this road has been open to the public for all to use, to come and go as they pleased, since at least as early as the early 1900s and continuing through 1976 to the present, for the uses described in the previous paragraphs.

8. Prior to 1976, I observed the graded surface of the road and other evidence of maintenance and construction activities such as berms along the side of the road.

DATED this 9 day of July, 2007.

  
D. MALOY DODDS

SUBSCRIBED AND SWORN to before me this 9th day of July, 2007.

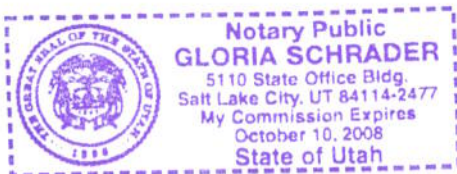

  
NOTARY PUBLIC

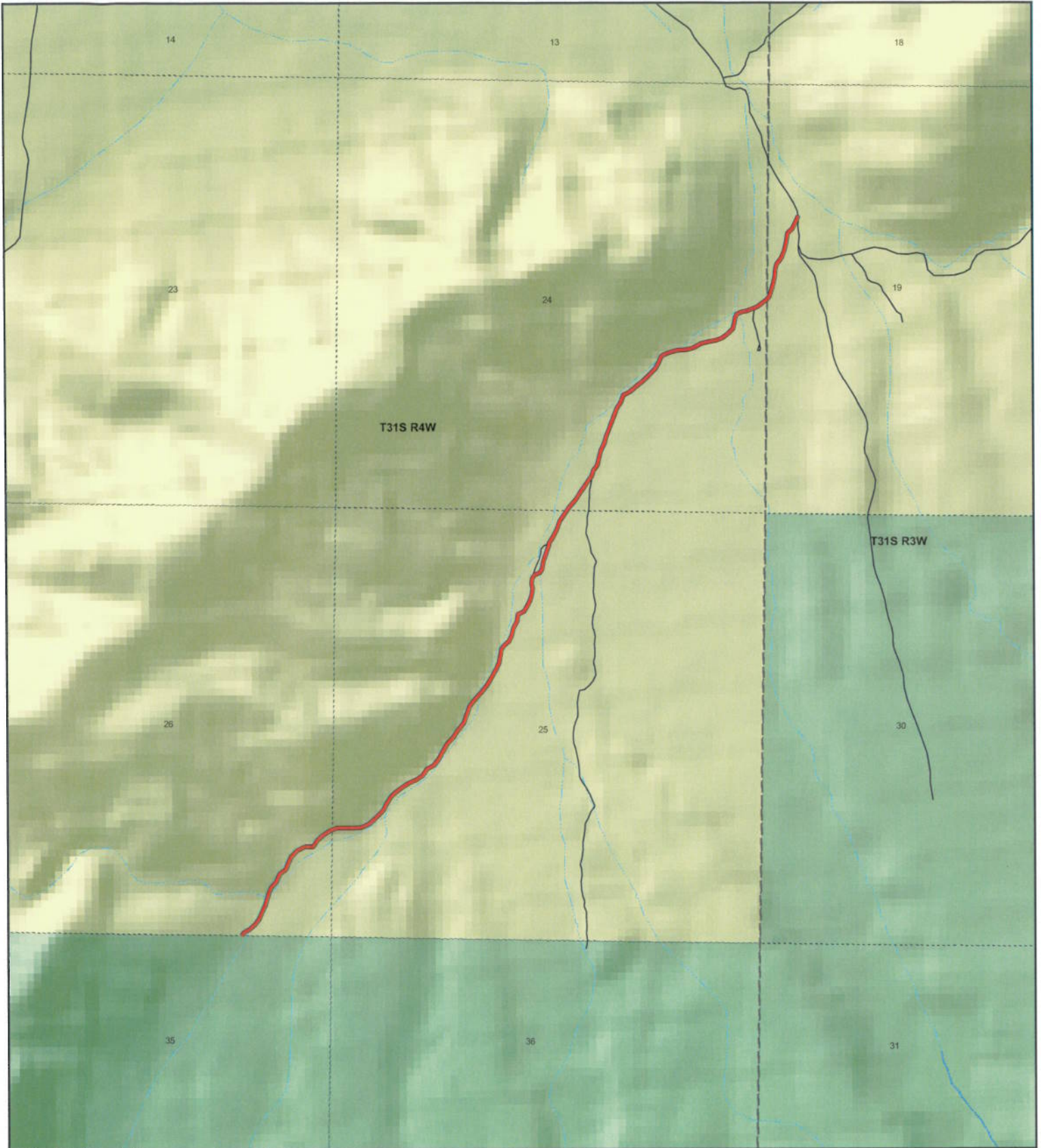

**EAST HORSE VALLEY PEAK RD**  
**County Unique - 0038**

**Land Ownership Categories**

- BLM
- Private
- SITLA, State Trust Land
- USFS, National Forest
- Wildlife Reserve
- National Park/Monument (NPS)
- National Rec. Area
- Wilderness
- State Park

**Transportation Network**

- EAST HORSE VALLEY PEAK RD
- State / U.S. Highway
- Local Roads

**Misc**

- City / Town
- Municipalities
- Section = 1 Mile
- Monument Boundary



1:18,909  
 1 inch equals 0.3 miles

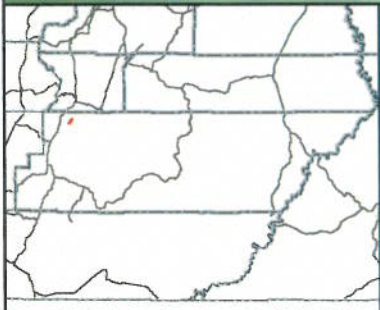

Map prepared by the State of Utah  
 AGRC  
 Room 5130 State Office Building  
 Salt Lake City, Utah 84114  
 Jul 05, 2007



## Appendix A to Attachment 4

**Popular Name: EAST HORSE VALLEY PEAK ROAD**

**County: Garfield**

**County Road Number: 0038**

**State Geographic Information Database (SGID) Road Identification Number: RD090014.**

**Road-Segment Number: 002**

**Road-Segment Length: 2.27 miles more or less.**

**Believed owner of the land underlying this road-segment is: Bureau of Land Management.**

*The following description is based upon the geographic coordinate system using the NAD83 Datum. The source is GPS mapping grade data as indicated in the metadata and/or the transportation data model of the State of Utah Geographic Information Database (SGID).*

The road-segment itself is the monument that is identified by its physical presence on the land. The location of said physical presence is closely approximated by mapping grade Global Positioning System (GPS) data. Said data are checked against the corresponding gray-scale 1-meter Digital Orthophoto Quadrangles published by the United States Geological Survey (USGS) to verify a reasonable degree of accuracy. In circumstances where accurate satellite signal acquisition is not possible, such as deep, narrow canyons or under a canopy of dense foliage, or where very sharp curves in the road make accuracy questionable, such portions of the road were digitized from the corresponding gray-scale 1-meter Digital Orthophoto Quadrangles published by the United States Geological Survey (USGS).

This road-segment may traverse:

Township 31 South Range 3 West, Section(s) 19, Salt Lake Base & Meridian

Township 31 South Range 4 West, Section(s) 24,25,26, Salt Lake Base & Meridian

The following description closely approximates the location of the centerline of the physical monument (EAST HORSE VALLEY PEAK ROAD)-- Segment 002 based on mapping grade Global Positioning System (GPS) data as defined above:

**Beginning at a point** on the road center line located at 38 degrees 04 minutes 49.71 seconds North Latitude and -112 degrees 16 minutes 10.73 seconds West Longitude, which can be converted to mapping accuracy State Plane Utah South Zone NAD 83 feet coordinates of X = 1,418,885.5 feet and Y = 10,358,211.5 feet; thence the following courses along the said road center line:

thence North 36 Degrees 56 Minutes 37 Seconds East	26.7 feet
thence North 43 Degrees 22 Minutes 35 Seconds East	30.4 feet
thence North 59 Degrees 42 Minutes 24 Seconds East	78.8 feet
thence North 46 Degrees 52 Minutes 44 Seconds East	85 feet
thence North 37 Degrees 22 Minutes 57 Seconds East	82.1 feet
thence North 20 Degrees 11 Minutes 08 Seconds East	75 feet
thence North 26 Degrees 45 Minutes 21 Seconds East	83.7 feet
thence North 18 Degrees 07 Minutes 23 Seconds East	22.8 feet
thence North 19 Degrees 13 Minutes 30 Seconds East	21.6 feet
thence North 16 Degrees 08 Minutes 54 Seconds East	120.4 feet

thence North 20 Degrees 08 Minutes 16 Seconds East 82.7 feet  
thence North 42 Degrees 54 Minutes 27 Seconds East 89.6 feet  
thence North 25 Degrees 04 Minutes 52 Seconds East 114.8 feet  
thence North 53 Degrees 47 Minutes 04 Seconds East 89.5 feet  
thence North 20 Degrees 53 Minutes 51 Seconds East 94.3 feet  
thence North 24 Degrees 55 Minutes 33 Seconds East 82.4 feet  
thence North 43 Degrees 48 Minutes 25 Seconds East 105.6 feet  
thence North 64 Degrees 19 Minutes 30 Seconds East 105 feet  
thence South 88 Degrees 31 Minutes 40 Seconds East 94.9 feet  
thence North 34 Degrees 02 Minutes 33 Seconds East 94.2 feet  
thence North 48 Degrees 32 Minutes 30 Seconds East 89.8 feet  
thence North 55 Degrees 50 Minutes 53 Seconds East 104.3 feet  
thence North 68 Degrees 04 Minutes 26 Seconds East 32.3 feet  
thence North 68 Degrees 04 Minutes 24 Seconds East 61.2 feet  
thence South 89 Degrees 53 Minutes 52 Seconds East 90.9 feet  
thence South 89 Degrees 57 Minutes 40 Seconds East 107.3 feet  
thence North 86 Degrees 11 Minutes 56 Seconds East 107.8 feet  
thence North 63 Degrees 30 Minutes 37 Seconds East 108.6 feet  
thence North 48 Degrees 41 Minutes 41 Seconds East 119.6 feet  
thence North 43 Degrees 30 Minutes 05 Seconds East 123.2 feet  
thence North 25 Degrees 15 Minutes 20 Seconds East 101.1 feet  
thence North 32 Degrees 52 Minutes 27 Seconds East 82.7 feet  
thence North 47 Degrees 39 Minutes 58 Seconds East 80.4 feet  
thence North 54 Degrees 22 Minutes 37 Seconds East 19.3 feet  
thence North 53 Degrees 04 Minutes 34 Seconds East 87.5 feet  
thence North 55 Degrees 21 Minutes 29 Seconds East 97.8 feet  
thence North 66 Degrees 09 Minutes 00 Seconds East 94.5 feet  
thence North 57 Degrees 38 Minutes 27 Seconds East 95.2 feet  
thence North 32 Degrees 47 Minutes 33 Seconds East 97.9 feet  
thence North 62 Degrees 46 Minutes 46 Seconds East 97.9 feet  
thence North 36 Degrees 48 Minutes 18 Seconds East 91.4 feet  
thence North 29 Degrees 23 Minutes 26 Seconds East 109.9 feet  
thence North 27 Degrees 36 Minutes 10 Seconds East 112.2 feet  
thence North 45 Degrees 22 Minutes 07 Seconds East 97.7 feet  
thence North 32 Degrees 46 Minutes 23 Seconds East 103.4 feet  
thence North 38 Degrees 09 Minutes 56 Seconds East 128.7 feet  
thence North 20 Degrees 32 Minutes 05 Seconds East 106 feet  
thence North 16 Degrees 27 Minutes 17 Seconds East 106.9 feet  
thence North 36 Degrees 49 Minutes 22 Seconds East 113.6 feet  
thence North 44 Degrees 41 Minutes 17 Seconds East 119.3 feet  
thence North 37 Degrees 38 Minutes 13 Seconds East 111.5 feet  
thence North 28 Degrees 52 Minutes 36 Seconds East 109 feet  
thence North 29 Degrees 48 Minutes 52 Seconds East 104 feet  
thence North 25 Degrees 43 Minutes 48 Seconds East 96.4 feet  
thence North 10 Degrees 13 Minutes 22 Seconds East 95.1 feet  
thence North 09 Degrees 46 Minutes 07 Seconds East 75 feet  
thence North 34 Degrees 11 Minutes 48 Seconds East 31.9 feet  
thence North 42 Degrees 02 Minutes 44 Seconds East 15.1 feet  
thence North 45 Degrees 00 Minutes 43 Seconds East 82.1 feet

thence North 28 Degrees 17 Minutes 55 Seconds East 82.2 feet  
 thence North 12 Degrees 30 Minutes 05 Seconds East 93.2 feet  
 thence North 26 Degrees 30 Minutes 43 Seconds East 97.4 feet  
 thence North 08 Degrees 13 Minutes 08 Seconds East 86.3 feet  
 thence North 66 Degrees 20 Minutes 15 Seconds East 81.1 feet  
 thence North 31 Degrees 40 Minutes 02 Seconds East 76.2 feet  
 thence North 26 Degrees 02 Minutes 12 Seconds East 77.6 feet  
 thence North 17 Degrees 06 Minutes 55 Seconds East 76.7 feet  
 thence North 09 Degrees 52 Minutes 56 Seconds East 76 feet  
 thence North 16 Degrees 27 Minutes 56 Seconds West 49.5 feet  
 thence North 00 Degrees 41 Minutes 04 Seconds East 37.7 feet  
 thence North 05 Degrees 41 Minutes 50 Seconds East 37.6 feet  
 thence North 34 Degrees 27 Minutes 00 Seconds East 53.5 feet  
 thence North 66 Degrees 05 Minutes 16 Seconds East 73.8 feet  
 thence North 34 Degrees 08 Minutes 36 Seconds East 54.5 feet  
 thence North 08 Degrees 35 Minutes 57 Seconds East 95.3 feet  
 thence North 18 Degrees 31 Minutes 43 Seconds East 102.6 feet  
 thence North 17 Degrees 43 Minutes 53 Seconds East 91.1 feet  
 thence North 16 Degrees 55 Minutes 46 Seconds East 19.9 feet  
 thence North 08 Degrees 26 Minutes 03 Seconds East 17.3 feet  
 thence North 32 Degrees 50 Minutes 20 Seconds East 87 feet  
 thence North 25 Degrees 01 Minutes 04 Seconds East 108.9 feet  
 thence North 20 Degrees 56 Minutes 53 Seconds East 103.2 feet  
 thence North 33 Degrees 40 Minutes 52 Seconds East 103.3 feet  
 thence North 31 Degrees 53 Minutes 21 Seconds East 59.2 feet  
 thence North 31 Degrees 53 Minutes 20 Seconds East 52.9 feet  
 thence North 41 Degrees 53 Minutes 02 Seconds East 113.8 feet  
 thence North 32 Degrees 57 Minutes 47 Seconds East 113 feet  
 thence North 32 Degrees 35 Minutes 36 Seconds East 93 feet  
 thence North 34 Degrees 20 Minutes 22 Seconds East 81.4 feet  
 thence North 38 Degrees 31 Minutes 04 Seconds East 69.1 feet  
 thence North 17 Degrees 29 Minutes 24 Seconds East 75.1 feet  
 thence North 38 Degrees 05 Minutes 56 Seconds East 70.8 feet  
 thence North 13 Degrees 48 Minutes 40 Seconds East 52.4 feet  
 thence North 08 Degrees 23 Minutes 01 Seconds East 28.2 feet  
 thence North 13 Degrees 55 Minutes 49 Seconds East 110.7 feet  
 thence North 24 Degrees 25 Minutes 20 Seconds East 96.5 feet  
 thence North 17 Degrees 31 Minutes 34 Seconds East 99.6 feet  
 thence North 22 Degrees 43 Minutes 18 Seconds East 104.8 feet  
 thence North 18 Degrees 37 Minutes 57 Seconds East 128.4 feet  
 thence North 21 Degrees 32 Minutes 37 Seconds East 128.7 feet  
 thence North 32 Degrees 13 Minutes 13 Seconds East 94.6 feet  
 thence North 19 Degrees 22 Minutes 17 Seconds East 85.7 feet  
 thence North 61 Degrees 50 Minutes 38 Seconds East 92 feet  
 thence North 48 Degrees 46 Minutes 25 Seconds East 110.7 feet  
 thence North 51 Degrees 34 Minutes 19 Seconds East 102.6 feet  
 thence North 45 Degrees 06 Minutes 22 Seconds East 95.4 feet  
 thence North 44 Degrees 33 Minutes 53 Seconds East 107.9 feet  
 thence North 29 Degrees 38 Minutes 30 Seconds East 89.4 feet



thence North 24 Degrees 12 Minutes 41 Seconds East 78.3 feet  
 thence North 51 Degrees 26 Minutes 30 Seconds East 35.5 feet  
 thence North 67 Degrees 44 Minutes 47 Seconds East 74.6 feet  
 thence North 74 Degrees 31 Minutes 25 Seconds East 109.1 feet  
 thence North 85 Degrees 26 Minutes 19 Seconds East 106.3 feet  
 thence North 76 Degrees 40 Minutes 39 Seconds East 88.9 feet  
 thence North 59 Degrees 18 Minutes 32 Seconds East 99.3 feet  
 thence North 73 Degrees 08 Minutes 28 Seconds East 94.5 feet  
 thence North 78 Degrees 49 Minutes 34 Seconds East 90.6 feet  
 thence North 70 Degrees 20 Minutes 45 Seconds East 85.2 feet  
 thence North 52 Degrees 46 Minutes 27 Seconds East 85.8 feet  
 thence North 43 Degrees 56 Minutes 10 Seconds East 88.4 feet  
 thence North 14 Degrees 59 Minutes 12 Seconds East 75.9 feet  
 thence North 08 Degrees 38 Minutes 41 Seconds East 61.1 feet  
 thence North 23 Degrees 27 Minutes 06 Seconds East 48 feet  
 thence North 67 Degrees 11 Minutes 58 Seconds East 66.1 feet  
 thence North 74 Degrees 34 Minutes 20 Seconds East 59.1 feet  
 thence North 72 Degrees 28 Minutes 08 Seconds East 83.1 feet  
 thence North 62 Degrees 05 Minutes 26 Seconds East 16.3 feet  
 thence North 64 Degrees 02 Minutes 05 Seconds East 55.3 feet  
 thence North 53 Degrees 35 Minutes 37 Seconds East 82.4 feet  
 thence North 49 Degrees 47 Minutes 07 Seconds East 49.6 feet  
 thence North 38 Degrees 41 Minutes 35 Seconds East 6.7 feet  
 thence North 38 Degrees 41 Minutes 33 Seconds East 44.4 feet  
 thence North 18 Degrees 23 Minutes 35 Seconds East 88 feet  
 thence North 16 Degrees 38 Minutes 00 Seconds East 87.8 feet  
 thence North 10 Degrees 02 Minutes 05 Seconds East 80.4 feet  
 thence North 04 Degrees 09 Minutes 32 Seconds East 80 feet  
 thence North 13 Degrees 28 Minutes 10 Seconds East 71.6 feet  
 thence North 38 Degrees 55 Minutes 05 Seconds East 66.9 feet  
 thence North 39 Degrees 29 Minutes 37 Seconds East 10.3 feet  
 thence North 25 Degrees 07 Minutes 27 Seconds East 29.8 feet  
 thence North 22 Degrees 16 Minutes 41 Seconds East 97.4 feet  
 thence North 14 Degrees 37 Minutes 10 Seconds East 71.3 feet  
 thence North 09 Degrees 00 Minutes 56 Seconds East 68.8 feet  
 thence North 09 Degrees 21 Minutes 51 Seconds East 72.2 feet  
 thence North 49 Degrees 47 Minutes 13 Seconds East 75.7 feet  
 thence North 24 Degrees 30 Minutes 31 Seconds East 86.8 feet  
 thence North 24 Degrees 03 Minutes 52 Seconds East 69.2 feet  
 thence North 27 Degrees 38 Minutes 20 Seconds East 18.2 feet more or less to **the ending**

**point at:** 38 degrees 06 minutes 17.87 seconds North Latitude and -112 degrees 14 minutes 46.27 seconds West Longitude, which can be converted to mapping accuracy State Plane Utah South Zone NAD 83 feet coordinates of X = 1,425,709.3 feet and Y = 10,367,074.1 feet.