

**Acknowledgment and
Notice of Acknowledgment
of Acceptance of R.S. 2477
Right-of-Way Grant**

Ent 251360 Bk 429 Pg 714
Date: 09-MAY-2008 2:12PM
Fee: None
Filed By: CT
LES BARKER, Recorder
GARFIELD COUNTY CORPORATION
For: GOVERNOR/STATE OF UTAH

THE STATE OF UTAH

TO ALL WHOM THESE PRESENTS SHALL COME, Greeting:

Know ye, This is an Acknowledgment and Notice of Acknowledgment made under Utah Code Sections 72-5-309 through 310 inclusive, that the grant of the United States of America of “the right of way for the construction of highways over public lands, not reserved for public uses” under United States Revised Statutes 2477 (43 U.S.C. Section 932 (repealed October 21, 1976, with proviso recognizing the validity of rights-of-way already established)) was accepted for and on behalf of the State of Utah and its political subdivision Garfield County as it pertains to the highway located in Garfield County known as 3 MILE TO GRAVEL PIT; County Road Number: 0197X; State Geographic Information Database (SGID) Road Identification Number: RD090034. Total road length is 1.04 miles more or less.

The reason for this Acknowledgment and Notice of Acknowledgment includes, but is not limited to, the fact that the road was constructed, mechanically, or by continuous use as a public highway for a period of at least ten years, over public lands not reserved for public uses, prior to the earlier of (a) the October 21, 1976 repeal of R.S. 2477 or (b) the date the servient estate was reserved for public uses.

This Acknowledgment and Notice of Acknowledgment applies only to the segments of the road that traverse land owned by the Bureau of Land Management, United States Department of the Interior, and does not apply to segments of the road that traverse land owned by any other person or entity. The State of Utah and its political subdivisions reserve the right to make further acknowledgments and notices of acknowledgment with regard to road segments that traverse land owned by other entities, including the United States of America, through one or more of its agencies.

A printed copy of a map showing the location of the road in said county is appended hereto as “Attachment 1,” a printed copy of representative photos of the road is appended hereto as “Attachment 2,” a printed copy of a description of the beginning and ending points of the entire road together with a list of Townships, Ranges and Sections that may be traversed by the road in said county is appended hereto as “Attachment 3,” and a printed copy of the Road Centerline Description Cover Page(s) is appended hereto as “Attachment 4.” The Appendices listed in “Attachment 4” that contain the actual road centerline descriptions are incorporated herein by reference. Affidavits provided by individuals familiar with the road are appended hereto as “Attachment 5.”

A printed copy of this Acknowledgment and Notice of Acknowledgment, together with its Attachments and Appendices, may be viewed and/or obtained at the office of the Utah State Archives.

An electronic copy of this Acknowledgment and Notice of Acknowledgment, together with its Attachments and Appendices, may be viewed and/or downloaded as read-only PDF (Portable Document Format) files via the

Internet at <http://recorded2477roads.utah.gov>.

The owner of the servient estate in the land underlying the road-segments subject to this Acknowledgment and Notice is believed to be the United States of America through one or more of its agencies. Any of such agencies or any other person with a servient ownership claim or a competing dominant estate right-of-way ownership claim, may file a petition in the State District Court for Salt Lake County for a decision regarding the correctness of this Acknowledgment. A claimant shall file a petition within sixty (60) days after receipt of this Notice.

In Witness Whereof, I, John Harja, the official designee of the Governor of the State of Utah, in conformity to the laws of the State (Utah Code Sections 72-5-308 through 310 inclusive), have caused this Acknowledgment and Notice of Acknowledgment to be made.

Signed by my hand in Salt Lake City, Utah, the 23rd day of April, 2008.

By the Governor's Designee



John Harja

CERTIFICATION

State of Utah)
 : ss
County of Salt Lake)

I hereby certify that the signer of the foregoing document, John Harja, is personally known by me, has made a voluntary signature and taken an oath stating that he is the official designee of the Governor of the State of Utah and is authorized to sign this document on the Governor's behalf pursuant to Utah Code Section 72-5-309. He further vouched that, based upon information and belief, the facts alleged therein are true.

Dated this 23rd day of April, 2008.





Notary Public

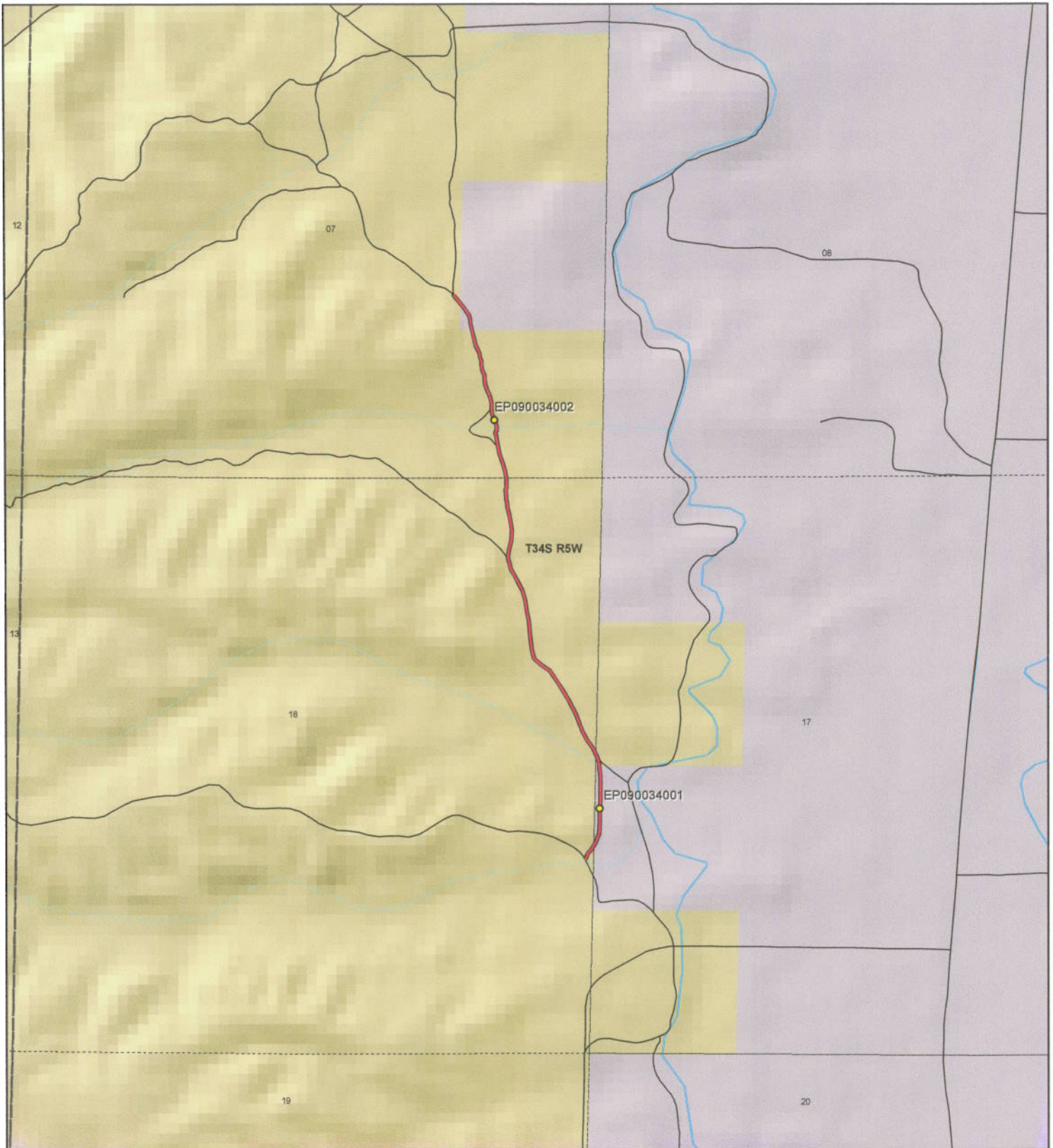

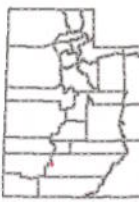
 <p>1:14,118 1 inch equals 0.2 miles</p>		<p align="center">3 MILE TO GRAVEL PIT - Garfield County SGID RD_ID RD090034</p> <table border="0"> <tr> <td colspan="2">Land Ownership Categories</td> <td>Transportation Network</td> </tr> <tr> <td>● BLM</td> <td>◆ Wilderness</td> <td>— 3 MILE TO GRAVEL PIT</td> </tr> <tr> <td>● Private</td> <td>◆ UDWR Wildlife Reserve</td> <td>— Title V: Issued Or Under Consideration By BLM Or County</td> </tr> <tr> <td>● SITLA, State Trust Land</td> <td>◆ DOD, Military</td> <td>— Other Roads</td> </tr> <tr> <td>● USFS, National Forest</td> <td>◆ State Sovereign Land</td> <td>● Photo Event Point</td> </tr> <tr> <td>● State Parks and Recreation</td> <td>◆ National Recreation Area</td> <td>○ Section = 1 Mile</td> </tr> <tr> <td>● Tribal, Indian Reservation</td> <td>◆ USFWS, Natl. Wildlife Refuge</td> <td></td> </tr> <tr> <td>● NPS, National Park</td> <td></td> <td></td> </tr> </table>	Land Ownership Categories		Transportation Network	● BLM	◆ Wilderness	— 3 MILE TO GRAVEL PIT	● Private	◆ UDWR Wildlife Reserve	— Title V: Issued Or Under Consideration By BLM Or County	● SITLA, State Trust Land	◆ DOD, Military	— Other Roads	● USFS, National Forest	◆ State Sovereign Land	● Photo Event Point	● State Parks and Recreation	◆ National Recreation Area	○ Section = 1 Mile	● Tribal, Indian Reservation	◆ USFWS, Natl. Wildlife Refuge		● NPS, National Park			<p>Map prepared by the State of Utah Automated Geographic Reference Center Room 5130 State Office Building Salt Lake City, Utah 84114 Feb 27, 2008</p> 
Land Ownership Categories		Transportation Network																									
● BLM	◆ Wilderness	— 3 MILE TO GRAVEL PIT																									
● Private	◆ UDWR Wildlife Reserve	— Title V: Issued Or Under Consideration By BLM Or County																									
● SITLA, State Trust Land	◆ DOD, Military	— Other Roads																									
● USFS, National Forest	◆ State Sovereign Land	● Photo Event Point																									
● State Parks and Recreation	◆ National Recreation Area	○ Section = 1 Mile																									
● Tribal, Indian Reservation	◆ USFWS, Natl. Wildlife Refuge																										
● NPS, National Park																											

Attachment 2



EP090034001



EP090034002

EP000000000

EP000000000

EP000000000

EP000000000

3 MILE TO GRAVEL PIT - Garfield County
SGID RD_ID RD090034

Map prepared by the State of Utah
Automated Geographic Reference Center
Room 5130 State Office Building
Salt Lake City, Utah 84114
February 29, 2008



Attachment 3

Beginning & Ending Points and Township, Range, and Section References For:

Popular Name: 3 MILE TO GRAVEL PIT

County: Garfield

County Road Number: 0197X

State Geographic Information Database (SGID) Road Identification Number: RD090034.

Total Road Length: 1.04 miles more or less.

Beginning at a point on the road centerline located at 37 degrees 51 minutes 05.98 seconds North Latitude and -112 degrees 27 minutes 02.78 seconds West Longitude, which can be converted to mapping accuracy State Plane Utah South Zone NAD 83 feet coordinates of X = 1,365,905.5 feet and Y = 10,275,374.5 feet based on the US Survey Foot conversion.

Ending at a point on the road centerline located at 37 degrees 51 minutes 56.42 seconds North Latitude and -112 degrees 27 minutes 18.64 seconds West Longitude, which can be converted to mapping accuracy State Plane Utah South Zone NAD 83 feet coordinates of X = 1,364,685.6 feet and Y = 10,280,489.2 feet based on the US Survey Foot conversion.

This road may traverse:

Township 34 South Range 5 West, Section(s) 7,17,18, Salt Lake Base & Meridian
See Attachment 1 above for a cartographic depiction of the course of this road.

**Attachment 4
Road Centerline Description Cover Page(s)**

Popular Name: 3 MILE TO GRAVEL PIT

County: Garfield

County Road Number: 0197X

State Geographic Information Database (SGID) Road Identification Number: RD090034.

Total Road Length: 1.04 miles more or less.

Centerline Descriptions Of Road-Segments That Cross Over Federally Owned Land, Derived From Global Positioning System Data And Cross-checked against USGS Digital Orthophoto Quadrangles Compiled By The Utah Automated Geographic Reference Center And Entered Into The State Geographic Information Database (SGID).

Road-Segments Listed by SGID Road Identification Number (RD_ID)	Road-Segment Numbers	Believed Ownership Of Servient Estate	Approximate Segment Length	See Attached Appendix
RD090034	001	BLM	0.03 Miles	A
RD090034	002	PVT	0.14 Miles	(not shown)
RD090034	003	BLM	0.8 Miles	B
RD090034	004	PVT	0.05 Miles	(not shown)
RD090034	005	BLM	0.02 Miles	C
		Total Road Length	1.04	_____

* Indicates that a Title V permit will be requested, is in process, or has been issued.

† Indicates that road-segments crossing Forest Service land are under consideration by the state and county as of the date of this Acknowledgment and Notice of Acknowledgment.

Attachment 5

AFFIDAVIT OF RUSSELL BULKLEY
3 MILE TO GRAVEL PIT ROAD
GARFIELD COUNTY, UTAH
ROAD NUMBER 0197X

State of Utah)
 : ss.
County of Garfield)

RUSSELL BULKLEY, being first duly sworn, deposes and states as follows:

1. I am an adult competent to testify about the matters set forth below based upon my personal knowledge. I currently reside in Panguitch, Garfield County, Utah. I have lived in Garfield County since 1959. In 1971 and 1972 I worked for the Utah Department of Transportation on roads and from 1973 to 1975 I worked for the Utah Division of Wildlife Resources.

2. I have traveled and am familiar with a road in Garfield County known as 3 Mile to Gravel Pit Road. I am also familiar with the land the road traverses. When I first used and observed the road in the early 1960s it followed the same route as in 2007 when I last observed it. Attached is a Garfield County map showing 3 Mile to Gravel Pit Road. To the best of my knowledge and based upon my use of and familiarity with this road and the land it traverses, the location and route of the road are correctly illustrated on the attached map.

3. The County also identifies this road according to the road number listed above.

4. I have observed that the road has been open to the public for all to use, to come and go as they pleased, since at least as early as the early 1960s and continuing through 2007. Throughout this time period I observed travel on the road by means of cars, trucks, pickup trucks and ATVs. During this time period, the road was used daily for more than ten continuous years prior to 1976 and was so used in 2007.

5. Throughout the time period from the early 1960s to 2007, I used the road myself for hunting, sightseeing and travel in and through the area.

6. Throughout the time period described in the previous paragraph, I have observed other vehicles from the general public using the road at various times for the uses described in the previous paragraph plus livestock operations, rock quarry access and recreation.

7. It is also the reputation in the community that this road has been open to the public for all to use, to come and go as they pleased, since at least as early as the early 1900s and continuing through 1976 to the present, for the uses described in the previous paragraphs.

8. Prior to 1976, I observed the graded surface of the road and other evidence of maintenance and construction activities such as berms along the side of the road.

DATED this 12 day of July, 2007.

RUSSELL BULKLEY

SUBSCRIBED AND SWORN to before me this 12th day of July, 2007.

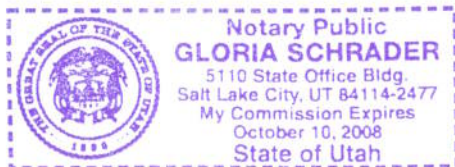

NOTARY PUBLIC

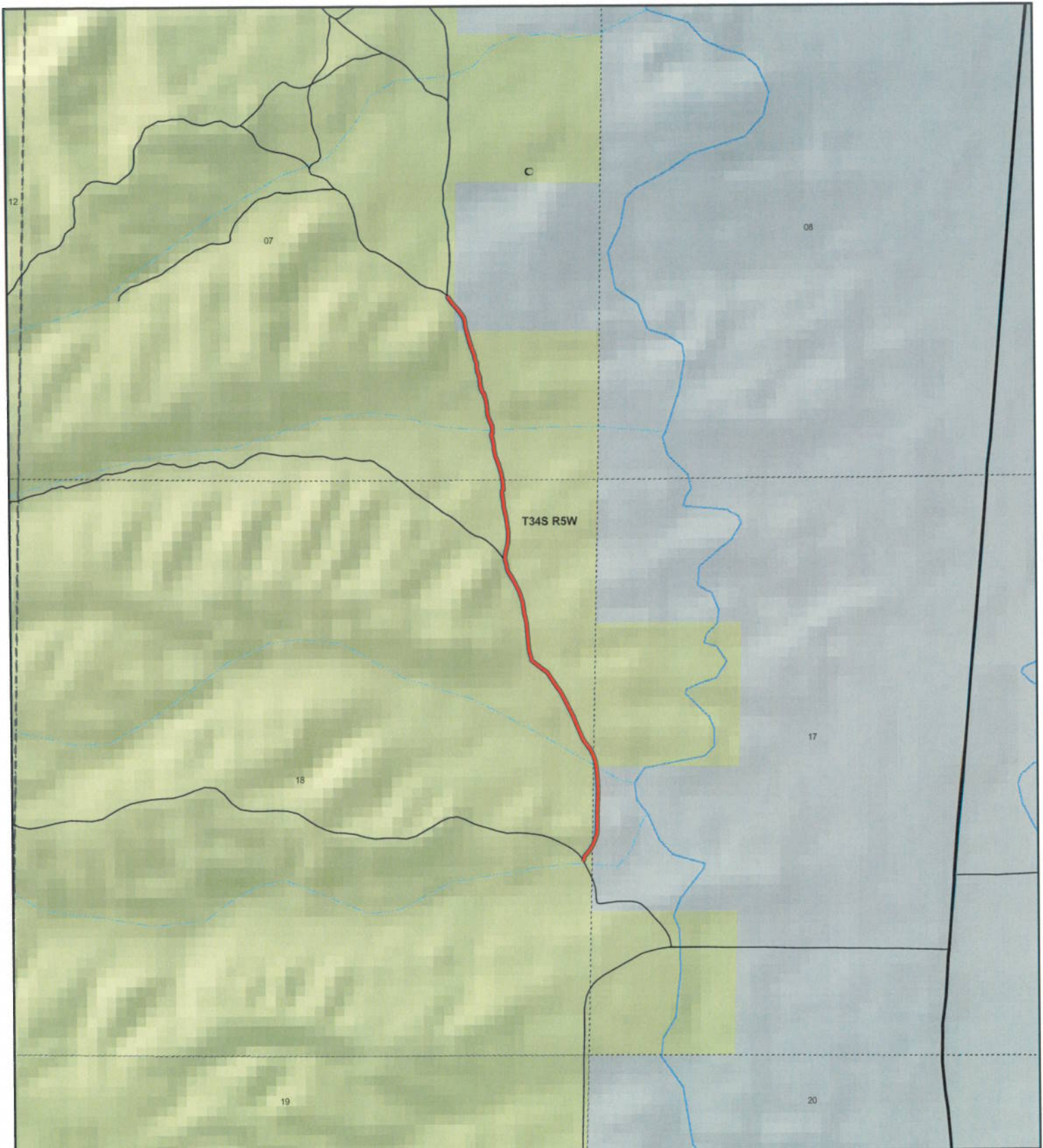

3 MILE TO GRAVEL PIT
County Unique - 0197X

Land Ownership Categories

- BLM
- Private
- SITLA, State Trust Land
- USFS, National Forest
- Wildlife Reserve
- National Park/Monument (NPS)
- National Rec. Area
- Wildemess
- State Park

Transportation Network

- 3 MILE TO GRAVEL PIT
- State / U.S. Highway
- Local Roads

Misc

- City / Town
- Municipalities
- Section = 1 Mile
- Monument Boundary



1:13,931
 1 inch equals 0.2 miles

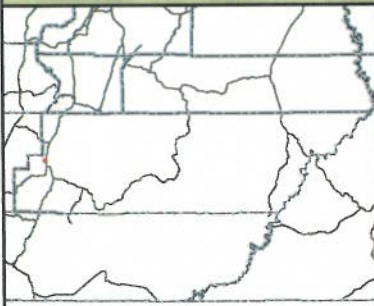

Map prepared by the State of Utah
 AGRC
 Room 5130 State Office Building
 Salt Lake City, Utah 84114
 Jul 05, 2007

AFFIDAVIT OF D. MALOY DODDS

3 MILE TO GRAVEL PIT ROAD

GARFIELD COUNTY, UTAH

ROAD NUMBER 0197X

State of Utah)
 : ss.
County of Garfield)

D. MALOY DODDS, being first duly sworn, deposes and states as follows:

1. I am an adult competent to testify about the matters set forth below based upon my personal knowledge. I currently reside in Panguitch, Garfield County, Utah. I have lived in Garfield County for 76 years. I have been a Garfield County Commissioner for 12 years.

2. I have traveled and am familiar with a road in Garfield County known as 3 Mile to Gravel Pit Road. I am also familiar with the land the road traverses. When I first used and observed the road in the late 1940s it followed the same route as in 2007 when I last observed it. Attached is a Garfield County map showing 3 Mile to Gravel Pit Road. To the best of my knowledge and based upon my use of and familiarity with this road and the land it traverses, the location and route of the road are correctly illustrated on the attached map.

3. I am informed that the County also identifies this road according to the road number listed above.

4. I have observed that the road has been open to the public for all to use, to come and go as they pleased, since at least as early as the late 1940s and continuing through 1976 to 2007. Throughout this time period I have observed travel on the road by means of cars, trucks, ATVs and pickup trucks. Throughout this time period, the road has been used daily for more than ten continuous years prior to 1976, and was so used in 2007.

5. Throughout the time period from the late 1940s to 2007, I have used the road myself for livestock operations, hunting, recreation and travel in and through the area.

6. Throughout the time period described in the previous paragraph, I have observed other vehicles from the general public using the road at various times for the uses described in the previous paragraph, plus gravel pit access.

7. It is also the reputation in the community that this road has been open to the public for all to use, to come and go as they pleased, since at least as early as the early 1900s and continuing through 1976 to the present, for the uses described in the previous paragraphs.

8. Prior to 1976, I observed the graded surface of the road and other evidence of maintenance and construction activities such as berms along the side of the road.

DATED this 9 day of July, 2007.

D. MALOY DODDS

SUBSCRIBED AND SWORN to before me this 9th day of July, 2007.

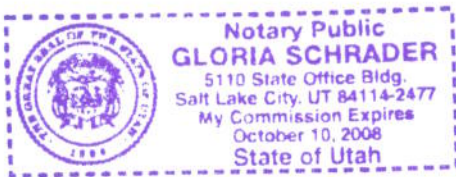

NOTARY PUBLIC

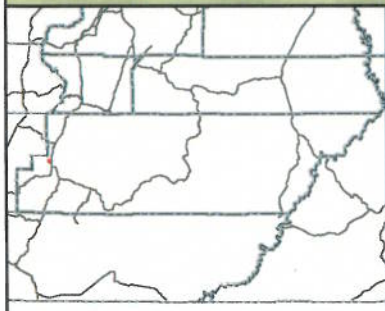

3 MILE TO GRAVEL PIT
County Unique - 0197X

Land Ownership Categories

- BLM
- Private
- SITLA, State Trust Land
- USFS, National Forest
- Wildlife Reserve
- National Park/Monument (NPS)
- National Rec. Area
- Wilderness
- State Park

Transportation Network

- 3 MILE TO GRAVEL PIT
- State / U.S. Highway
- Local Roads

Misc

- City / Town
- Municipalities
- Section = 1 Mile
- Monument Boundary



1:13,931
 1 inch equals 0.2 miles



Map prepared by the State of Utah
 AGRC
 Room 5130 State Office Building
 Salt Lake City, Utah 84114
 Jul 05, 2007



Appendix A to Attachment 4

Popular Name: 3 MILE TO GRAVEL PIT

County: Garfield

County Road Number: 0197X

State Geographic Information Database (SGID) Road Identification Number: RD090034.

Road-Segment Number: 001

Road-Segment Length: 0.03 miles more or less.

Believed owner of the land underlying this road-segment is: Bureau of Land Management.

The following description is based upon the geographic coordinate system using the NAD83 Datum. The source is GPS mapping grade data as indicated in the metadata and/or the transportation data model of the State of Utah Geographic Information Database (SGID).

The road-segment itself is the monument that is identified by its physical presence on the land. The location of said physical presence is closely approximated by mapping grade Global Positioning System (GPS) data. Said data are checked against the corresponding gray-scale 1-meter Digital Orthophoto Quadrangles published by the United States Geological Survey (USGS) to verify a reasonable degree of accuracy. In circumstances where accurate satellite signal acquisition is not possible, such as deep, narrow canyons or under a canopy of dense foliage, or where very sharp curves in the road make accuracy questionable, such portions of the road were digitized from the corresponding gray-scale 1-meter Digital Orthophoto Quadrangles published by the United States Geological Survey (USGS).

This road-segment may traverse:

Township 34 South Range 5 West, Section(s) 18, Salt Lake Base & Meridian

The following description closely approximates the location of the centerline of the physical monument (3 MILE TO GRAVEL PIT)-- Segment 001 based on mapping grade Global Positioning System (GPS) data as defined above:

Beginning at a point on the road center line located at 37 degrees 51 minutes 05.98 seconds North Latitude and -112 degrees 27 minutes 02.78 seconds West Longitude, which can be converted to mapping accuracy State Plane Utah South Zone NAD 83 feet coordinates of X = 1,365,905.5 feet and Y = 10,275,374.5 feet; thence the following courses along the said road center line:

thence North 19 Degrees 29 Minutes 27 Seconds East 17.4 feet

thence North 19 Degrees 47 Minutes 14 Seconds East 28.7 feet

thence North 33 Degrees 44 Minutes 17 Seconds East 29.3 feet

thence North 41 Degrees 46 Minutes 52 Seconds East 41.1 feet

thence North 31 Degrees 45 Minutes 35 Seconds East 39.7 feet more or less to **the ending**

point at: 37 degrees 51 minutes 7.3 seconds North Latitude and -112 degrees 27 minutes 1.8 seconds West Longitude, which can be converted to mapping accuracy State Plane Utah South Zone NAD 83 feet coordinates of X = 1,365,985.6 feet and Y = 10,275,506.7 feet.

Appendix B to Attachment 4

Popular Name: 3 MILE TO GRAVEL PIT

County: Garfield

County Road Number: 0197X

State Geographic Information Database (SGID) Road Identification Number: RD090034.

Road-Segment Number: 003

Road-Segment Length: 0.8 miles more or less.

Believed owner of the land underlying this road-segment is: Bureau of Land Management.

The following description is based upon the geographic coordinate system using the NAD83 Datum. The source is GPS mapping grade data as indicated in the metadata and/or the transportation data model of the State of Utah Geographic Information Database (SGID).

The road-segment itself is the monument that is identified by its physical presence on the land. The location of said physical presence is closely approximated by mapping grade Global Positioning System (GPS) data. Said data are checked against the corresponding gray-scale 1-meter Digital Orthophoto Quadrangles published by the United States Geological Survey (USGS) to verify a reasonable degree of accuracy. In circumstances where accurate satellite signal acquisition is not possible, such as deep, narrow canyons or under a canopy of dense foliage, or where very sharp curves in the road make accuracy questionable, such portions of the road were digitized from the corresponding gray-scale 1-meter Digital Orthophoto Quadrangles published by the United States Geological Survey (USGS).

This road-segment may traverse:

Township 34 South Range 5 West, Section(s) 7,17,18, Salt Lake Base & Meridian

The following description closely approximates the location of the centerline of the physical monument (3 MILE TO GRAVEL PIT)-- Segment 003 based on mapping grade Global Positioning System (GPS) data as defined above:

Beginning at a point on the road center line located at 37 degrees 51 minutes 14.45 seconds North Latitude and -112 degrees 27 minutes 01.36 seconds West Longitude, which can be converted to mapping accuracy State Plane Utah South Zone NAD 83 feet coordinates of X = 1,366,027.8 feet and Y = 10,276,229.7 feet; thence the following courses along the said road center line:

thence North 11 Degrees 45 Minutes 42 Seconds West 44.2 feet
thence North 16 Degrees 12 Minutes 26 Seconds West 56.3 feet
thence North 26 Degrees 52 Minutes 22 Seconds West 6.7 feet
thence North 26 Degrees 52 Minutes 22 Seconds West 60.1 feet
thence North 37 Degrees 02 Minutes 36 Seconds West 83.9 feet
thence North 36 Degrees 03 Minutes 42 Seconds West 20.2 feet
thence North 27 Degrees 59 Minutes 36 Seconds West 60 feet
thence North 21 Degrees 27 Minutes 21 Seconds West 85.5 feet
thence North 22 Degrees 20 Minutes 38 Seconds West 104.1 feet
thence North 27 Degrees 40 Minutes 00 Seconds West 127.1 feet
thence North 28 Degrees 59 Minutes 58 Seconds West 110.7 feet

thence North 36 Degrees 49 Minutes 08 Seconds West 62.9 feet
thence North 34 Degrees 18 Minutes 33 Seconds West 150.8 feet
thence North 54 Degrees 01 Minutes 34 Seconds West 108.7 feet
thence North 52 Degrees 36 Minutes 49 Seconds West 73 feet
thence North 06 Degrees 25 Minutes 24 Seconds West 18.5 feet
thence North 15 Degrees 50 Minutes 58 Seconds West 57.6 feet
thence North 08 Degrees 26 Minutes 16 Seconds West 65 feet
thence North 06 Degrees 02 Minutes 14 Seconds West 98.6 feet
thence North 04 Degrees 57 Minutes 48 Seconds West 101.1 feet
thence North 11 Degrees 12 Minutes 02 Seconds West 97.2 feet
thence North 09 Degrees 29 Minutes 18 Seconds West 98.7 feet
thence North 18 Degrees 03 Minutes 09 Seconds West 94.7 feet
thence North 25 Degrees 32 Minutes 26 Seconds West 94.7 feet
thence North 32 Degrees 27 Minutes 36 Seconds West 67.8 feet
thence North 30 Degrees 25 Minutes 18 Seconds West 56.9 feet
thence North 11 Degrees 30 Minutes 00 Seconds West 62.6 feet
thence North 18 Degrees 08 Minutes 53 Seconds West 30 feet
thence North 03 Degrees 40 Minutes 27 Seconds West 39.1 feet
thence North 09 Degrees 56 Minutes 23 Seconds East 59 feet
thence North 16 Degrees 12 Minutes 22 Seconds East 68.1 feet
thence North 01 Degrees 03 Minutes 21 Seconds East 96.5 feet
thence North 07 Degrees 32 Minutes 06 Seconds West 91.3 feet
thence North 10 Degrees 47 Minutes 15 Seconds West 57.7 feet
thence North 12 Degrees 36 Minutes 57 Seconds West 55.4 feet
thence North 10 Degrees 15 Minutes 57 Seconds West 43.6 feet
thence North 03 Degrees 14 Minutes 37 Seconds West 25.6 feet
thence North 06 Degrees 54 Minutes 17 Seconds West 48.6 feet
thence North 05 Degrees 59 Minutes 00 Seconds West 53.1 feet
thence North 28 Degrees 50 Minutes 24 Seconds East 19.5 feet
thence North 01 Degrees 22 Minutes 43 Seconds West 70.2 feet
thence North 10 Degrees 31 Minutes 16 Seconds West 18.3 feet
thence North 10 Degrees 31 Minutes 20 Seconds West 55.8 feet
thence North 14 Degrees 20 Minutes 39 Seconds West 79.8 feet
thence North 21 Degrees 12 Minutes 07 Seconds West 84.6 feet
thence North 14 Degrees 07 Minutes 05 Seconds West 60.5 feet
thence North 05 Degrees 55 Minutes 12 Seconds West 57 feet
thence North 10 Degrees 29 Minutes 58 Seconds West 59.3 feet
thence North 18 Degrees 30 Minutes 25 Seconds West 25.2 feet
thence North 29 Degrees 00 Minutes 07 Seconds East 21.4 feet
thence North 05 Degrees 24 Minutes 09 Seconds East 29.7 feet
thence North 08 Degrees 15 Minutes 56 Seconds West 30.8 feet
thence North 23 Degrees 53 Minutes 22 Seconds West 45.1 feet
thence North 22 Degrees 21 Minutes 05 Seconds West 57.7 feet
thence North 07 Degrees 03 Minutes 41 Seconds West 50.2 feet
thence North 01 Degrees 30 Minutes 35 Seconds West 46.9 feet
thence North 11 Degrees 18 Minutes 41 Seconds West 48.1 feet
thence North 19 Degrees 06 Minutes 57 Seconds West 47.8 feet
thence North 26 Degrees 01 Minutes 04 Seconds West 39.3 feet
thence North 16 Degrees 28 Minutes 21 Seconds West 47.1 feet

thence North 06 Degrees 20 Minutes 17 Seconds West 46.9 feet
thence North 03 Degrees 14 Minutes 37 Seconds West 25.6 feet
thence North 20 Degrees 42 Minutes 10 Seconds West 27.3 feet
thence North 17 Degrees 00 Minutes 26 Seconds West 37.7 feet
thence North 08 Degrees 37 Minutes 06 Seconds West 29.5 feet
thence North 03 Degrees 16 Minutes 08 Seconds West 38.1 feet
thence North 17 Degrees 05 Minutes 04 Seconds West 46.6 feet
thence North 10 Degrees 45 Minutes 34 Seconds West 34.4 feet
thence North 23 Degrees 39 Minutes 49 Seconds West 78.6 feet
thence North 14 Degrees 39 Minutes 57 Seconds West 99.2 feet
thence North 13 Degrees 36 Minutes 49 Seconds West 48.7 feet more or less to **the ending**

point at: 37 degrees 51 minutes 53.32 seconds North Latitude and -112 degrees 27 minutes 16.53 seconds West Longitude, which can be converted to mapping accuracy State Plane Utah South Zone NAD 83 feet coordinates of X = 1,364,851.9 feet and Y = 10,280,174.0 feet.

Appendix C to Attachment 4

Popular Name: 3 MILE TO GRAVEL PIT

County: Garfield

County Road Number: 0197X

State Geographic Information Database (SGID) Road Identification Number: RD090034.

Road-Segment Number: 005

Road-Segment Length: 0.02 miles more or less.

Believed owner of the land underlying this road-segment is: Bureau of Land Management.

The following description is based upon the geographic coordinate system using the NAD83 Datum. The source is GPS mapping grade data as indicated in the metadata and/or the transportation data model of the State of Utah Geographic Information Database (SGID).

The road-segment itself is the monument that is identified by its physical presence on the land. The location of said physical presence is closely approximated by mapping grade Global Positioning System (GPS) data. Said data are checked against the corresponding gray-scale 1-meter Digital Orthophoto Quadrangles published by the United States Geological Survey (USGS) to verify a reasonable degree of accuracy. In circumstances where accurate satellite signal acquisition is not possible, such as deep, narrow canyons or under a canopy of dense foliage, or where very sharp curves in the road make accuracy questionable, such portions of the road were digitized from the corresponding gray-scale 1-meter Digital Orthophoto Quadrangles published by the United States Geological Survey (USGS).

This road-segment may traverse:

Township 34 South Range 5 West, Section(s) 7, Salt Lake Base & Meridian

The following description closely approximates the location of the centerline of the physical monument (3 MILE TO GRAVEL PIT)-- Segment 005 based on mapping grade Global Positioning System (GPS) data as defined above:

Beginning at a point on the road center line located at 37 degrees 51 minutes 55.62 seconds North Latitude and -112 degrees 27 minutes 17.89 seconds West Longitude, which can be converted to mapping accuracy State Plane Utah South Zone NAD 83 feet coordinates of X = 1,364,744.8 feet and Y = 10,280,407.6 feet; thence the following courses along the said road center line:

thence North 40 Degrees 58 Minutes 58 Seconds West 23.3 feet

thence North 37 Degrees 32 Minutes 34 Seconds West 51.5 feet

thence North 36 Degrees 25 Minutes 38 Seconds West 15 feet

thence North 18 Degrees 14 Minutes 09 Seconds West 11.7 feet more or less to **the ending**

point at: 37 degrees 51 minutes 56.42 seconds North Latitude and -112 degrees 27 minutes 18.64 seconds West Longitude, which can be converted to mapping accuracy State Plane Utah South Zone NAD 83 feet coordinates of X = 1,364,685.6 feet and Y = 10,280,489.2 feet.