

**Acknowledgment and
Notice of Acknowledgment
of Acceptance of R.S. 2477
Right-of-Way Grant**

Ent 251374 Bk 429 Pg 893
Date: 09-MAY-2008 2:43PM
Fee: None
Filed By: CT
LES BARKER, Recorder
GARFIELD COUNTY CORPORATION
For: GOVERNOR/STATE OF UTAH

THE STATE OF UTAH

TO ALL WHOM THESE PRESENTS SHALL COME, Greeting:

Know ye, This is an Acknowledgment and Notice of Acknowledgment made under Utah Code Sections 72-5-309 through 310 inclusive, that the grant of the United States of America of “the right of way for the construction of highways over public lands, not reserved for public uses” under United States Revised Statutes 2477 (43 U.S.C. Section 932 (repealed October 21, 1976, with proviso recognizing the validity of rights-of-way already established)) was accepted for and on behalf of the State of Utah and its political subdivision Garfield County as it pertains to the highway located in Garfield County known as SAGE HEN TO DD HOLLOW ROAD; County Road Number: 0213a; State Geographic Information Database (SGID) Road Identification Number: RD090048. Total road length is 2.02 miles more or less.

The reason for this Acknowledgment and Notice of Acknowledgment includes, but is not limited to, the fact that the road was constructed, mechanically, or by continuous use as a public highway for a period of at least ten years, over public lands not reserved for public uses, prior to the earlier of (a) the October 21, 1976 repeal of R.S. 2477 or (b) the date the servient estate was reserved for public uses.

This Acknowledgment and Notice of Acknowledgment applies only to the segments of the road that traverse land owned by the Bureau of Land Management, United States Department of the Interior, and does not apply to segments of the road that traverse land owned by any other person or entity. The State of Utah and its political subdivisions reserve the right to make further acknowledgments and notices of acknowledgment with regard to road segments that traverse land owned by other entities, including the United States of America, through one or more of its agencies.

A printed copy of a map showing the location of the road in said county is appended hereto as “Attachment 1,” a printed copy of representative photos of the road is appended hereto as “Attachment 2,” a printed copy of a description of the beginning and ending points of the entire road together with a list of Townships, Ranges and Sections that may be traversed by the road in said county is appended hereto as “Attachment 3,” and a printed copy of the Road Centerline Description Cover Page(s) is appended hereto as “Attachment 4.” The Appendices listed in “Attachment 4” that contain the actual road centerline descriptions are incorporated herein by reference. Affidavits provided by individuals familiar with the road are appended hereto as “Attachment 5.”

A printed copy of this Acknowledgment and Notice of Acknowledgment, together with its Attachments and Appendices, may be viewed and/or obtained at the office of the Utah State Archives.

An electronic copy of this Acknowledgment and Notice of Acknowledgment, together with its Attachments and Appendices, may be viewed and/or downloaded as read-only PDF (Portable Document Format) files via the

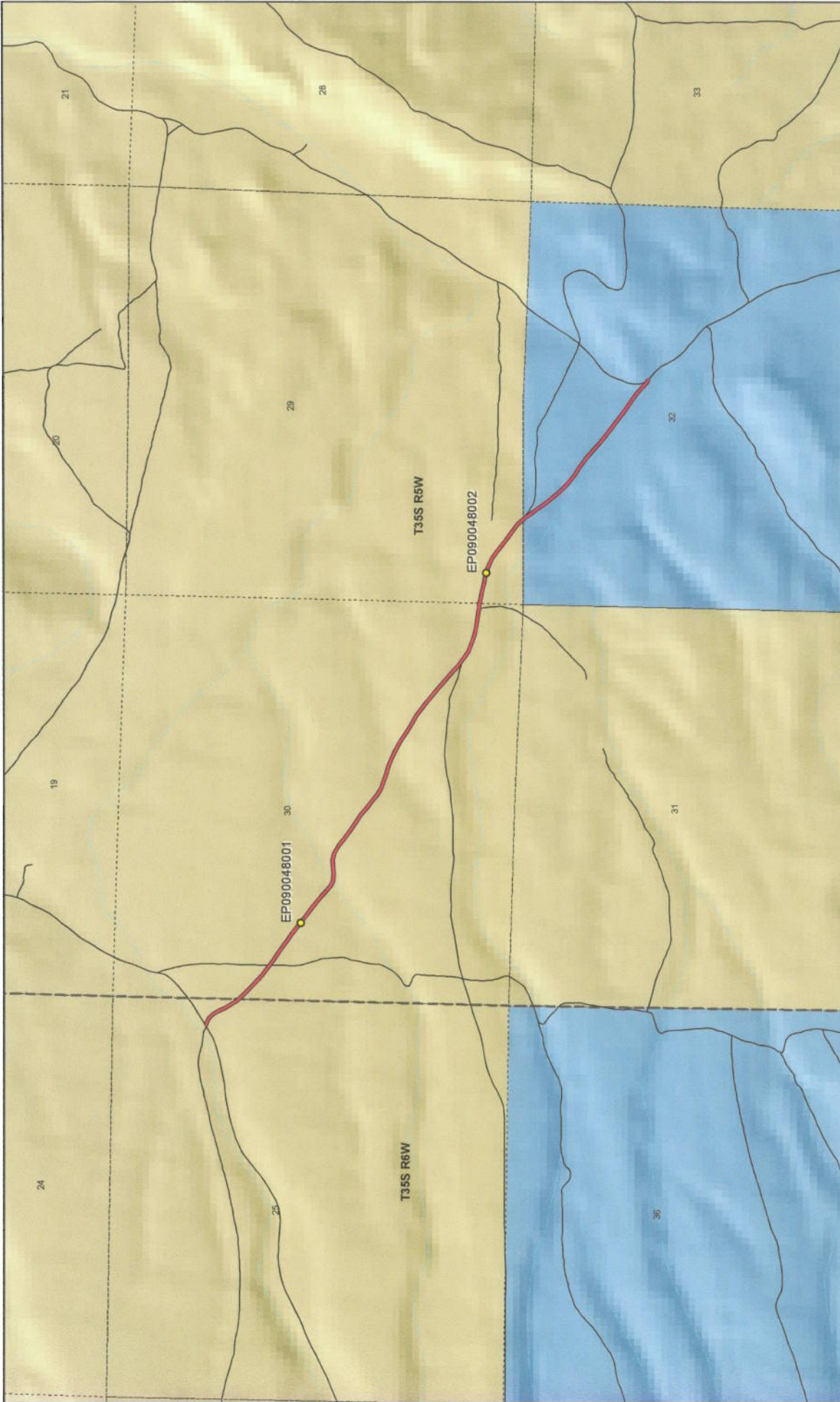



1:21,194
1 inch equals 0.3 miles

SAGE HEN TO DD HOLLOW ROAD - Garfield County
SGID RD_ID RD0900048

Map prepared by the State of Utah
Automated Geographic Reference Center
Room 5130 State Office Building
Salt Lake City, Utah 84114
Feb 27, 2008



Land Ownership Categories

- BLM
- Private
- SITLA, State Trust Land
- USFS, National Forest
- State Parks and Recreation
- Tribal, Indian Reservation
- NPS, National Park
- Wilderness
- UDWR Wildlife Reserve
- DOD, Military
- State Sovereign Land
- National Recreation Area
- USFWS, Natl. Wildlife Refuge
- NPS, National Park

Transportation Network

- SAGE HEN TO DD HOLLOW ROAD
- Other Roads
- Title V, Issued Or Under Consideration By BLM Or County
- Photo Event Point
- Section = 1 Mile



Attachment 2



EP090048001



EP090048002

EP000000000

EP000000000

EP000000000

EP000000000

SAGE HEN TO DD HOLLOW ROAD - Garfield County

SGID RD_ID RD090048

Map prepared by the State of Utah
Automated Geographic Reference Center
Room 5130 State Office Building
Salt Lake City, Utah 84114
February 29, 2008



Attachment 3

Beginning & Ending Points and Township, Range, and Section References For:

Popular Name: SAGE HEN TO DD HOLLOW ROAD

County: Garfield

County Road Number: 0213a

State Geographic Information Database (SGID) Road Identification Number: RD090048.

Total Road Length: 2.02 miles more or less.

Beginning at a point on the road centerline located at 37 degrees 44 minutes 32.12 seconds North Latitude and -112 degrees 28 minutes 18.87 seconds West Longitude, which can be converted to mapping accuracy State Plane Utah South Zone NAD 83 feet coordinates of X = 1,359,389.3 feet and Y = 10,235,601.4 feet based on the US Survey Foot conversion.

Ending at a point on the road centerline located at 37 degrees 43 minutes 35.22 seconds North Latitude and -112 degrees 26 minutes 31.12 seconds West Longitude, which can be converted to mapping accuracy State Plane Utah South Zone NAD 83 feet coordinates of X = 1,367,985.5 feet and Y = 10,229,758.1 feet based on the US Survey Foot conversion.

This road may traverse:

Township 35 South Range 5 West, Section(s) 29,30,32, Salt Lake Base & Meridian

Township 35 South Range 6 West, Section(s) 25, Salt Lake Base & Meridian

See Attachment 1 above for a cartographic depiction of the course of this road.

**Attachment 4
Road Centerline Description Cover Page(s)**

Popular Name: SAGE HEN TO DD HOLLOW ROAD

County: Garfield

County Road Number: 0213a

State Geographic Information Database (SGID) Road Identification Number: RD090048.

Total Road Length: 2.02 miles more or less.

Centerline Descriptions Of Road-Segments That Cross Over Federally Owned Land, Derived From Global Positioning System Data And Cross-checked against USGS Digital Orthophoto Quadrangles Compiled By The Utah Automated Geographic Reference Center And Entered Into The State Geographic Information Database (SGID).

Road-Segments Listed by SGID Road Identification Number (RD_ID)	Road-Segment Numbers	Believed Ownership Of Servient Estate	Approximate Segment Length	See Attached Appendix
RD090048	001	BLM	1.54 Miles	A
RD090048	002	ST	0.48 Miles	(not shown)
		Total Road Length	2.02	_____

* Indicates that a Title V permit will be requested, is in process, or has been issued.

† Indicates that road-segments crossing Forest Service land are under consideration by the state and county as of the date of this Acknowledgment and Notice of Acknowledgment.

Attachment 5

been used weekly, weather permitting, for more than ten continuous years prior to 1976, and was used weekly, weather permitting, in 2007.

4. Throughout the time period from 1955 to 2007, I have used the road myself for hunting, recreation, search and rescue and traveling in and through the area.

5. Throughout the time period described in the previous paragraph, I observed vehicles using the road at various times for the uses described in the previous paragraph, plus residential access, wood gathering, livestock operations and government access.

6. It is also the reputation in the community that this road has been open to the public for all to use, to come and go as they pleased, since at least as early as the early 1940s and continuing through 1976 to the present, for the uses described in the previous paragraphs.

7. Prior to 1976, I observed the graded surface of the road.

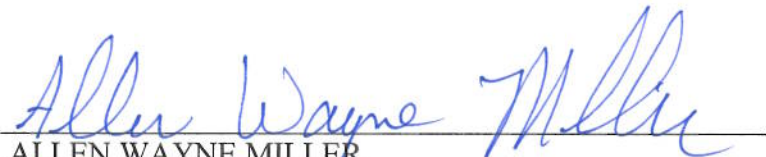

Dated this 9TH day of July, 2007.

ALLEN WAYNE MILLER

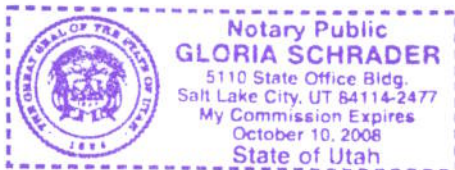
SUBSCRIBED AND SWORN to before me this 9th day of July, 2007.



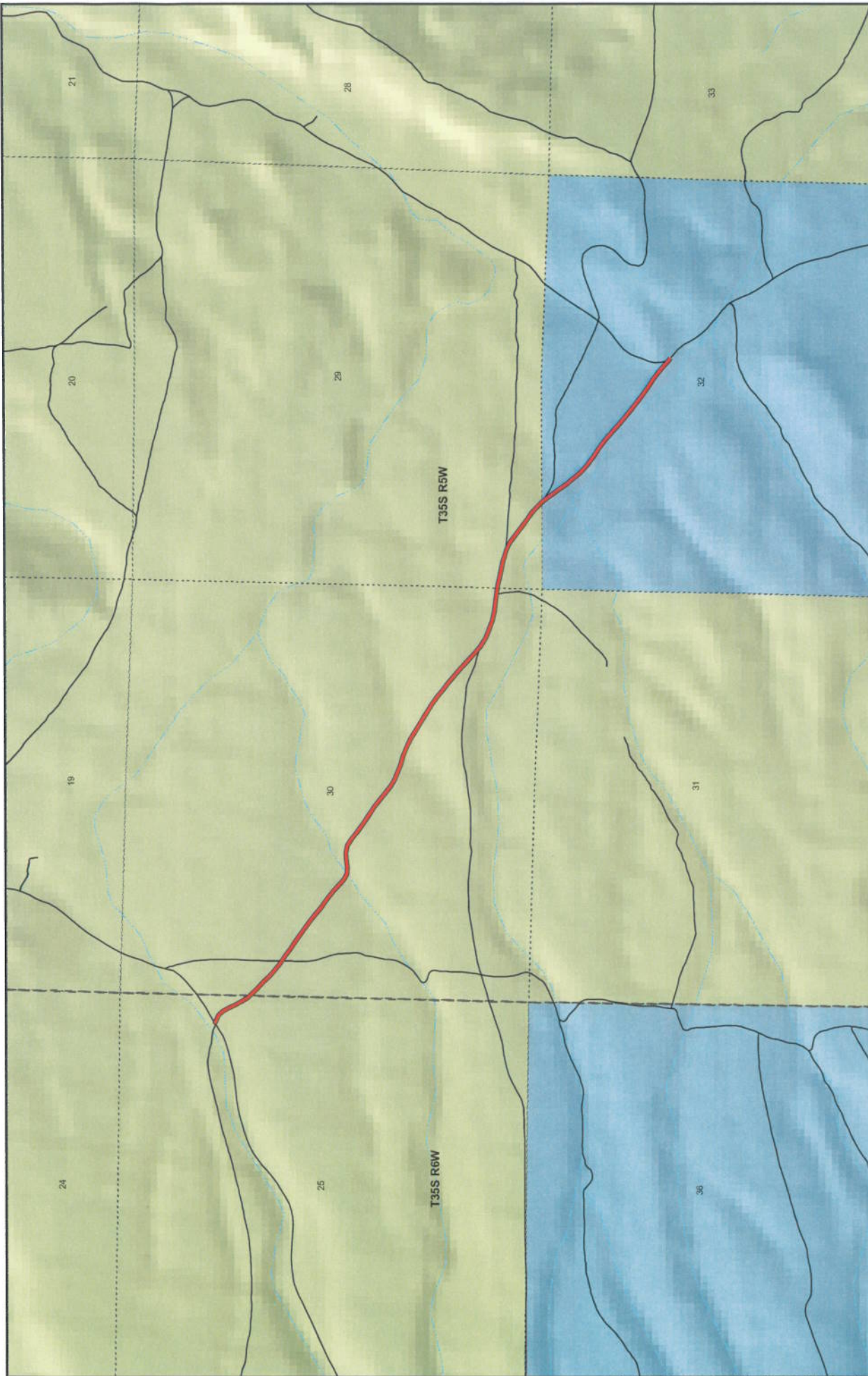

NOTARY PUBLIC

1:20,211
1 inch equals 0.3 miles

Map prepared by the State of Utah
Automated Geospatial Reference Center
Room 5130 State Office Building
Salt Lake City, Utah 84114
July 04, 2007

SAGE HEN TO DD HOLLOW County Unique - 0213a

- | | | |
|---|---|---|
| <p>Land Ownership Categories</p> <ul style="list-style-type: none"> Private SITLA, State Trust Land USFS, National Forest National Park/Monument (NPS) | <p>Misc</p> <ul style="list-style-type: none"> City / Town Municipalities Section = 1 Mile Monument Boundary | <p>Transportation Network</p> <ul style="list-style-type: none"> SAGE HEN TO DD HOLLOW State / U.S. Highway Local Roads |
|---|---|---|

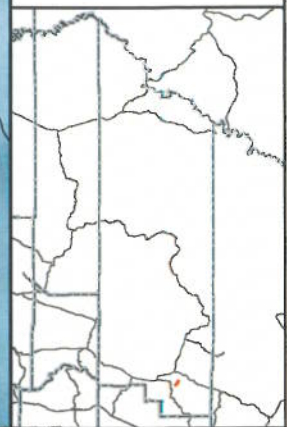

AFFIDAVIT OF LOWELL HUNTINGTON

SAGE HEN TO DD HOLLOW ROAD

COUNTY ROAD NUMBER 0213a

GARFIELD COUNTY, UTAH

State of Utah)
 : ss.
County of Garfield)

LOWELL HUNTINGTON, being first duly sworn, deposes and states as follows:

1. I am an adult competent to testify about the matters set forth below based upon my personal knowledge. I have lived in Garfield County for 62 years.

2. I have traveled and am familiar with a road in Garfield County known as Sage Hen to DD Hollow Creek Road. I am also familiar with the land the road traverses. When I first used and observed the road in 1957, it followed the same route as in 2007 when I last observed it. Attached is a Garfield County map showing Sage Hen to DD Hollow Road. To the best of my knowledge and based upon my use of and familiarity with this road and the land it traverses, the location and route of the road are correctly illustrated on the attached map. The County also identifies this road according to the road number listed above.

3. I have observed that the road has been open to the public for all to use, to come and go as they pleased, since at least as early as 1957 and continuing through 1976 to 2007. Throughout this time period I have observed travel on the road by various means, including cars, trucks, maintenance vehicles, jeeps and ATV's. Throughout this time period, the road has been used daily for more than ten continuous years prior to 1976, and was used daily in 2007.

4. Throughout the time period from 1957 to 2007, I have used the road myself for wood gathering, hunting, trapping, traveling in and through the area and prospecting for minerals.

5. Throughout the time period described in the previous paragraph, I observed vehicles using the road at various times for the uses described in the previous paragraph, plus livestock operations, camping, rock hounding and government access.

6. It is also the reputation in the community that this road has been open to the public for all to use, to come and go as they pleased, since at least as early as the 1940s and continuing through 1976 to the present, for the uses described in the previous paragraphs.

7. Prior to 1976, I observed graders performing maintenance and construction activities on the road.

Dated this 9th day of July, 2007.



LOWELL HUNTINGTON

SUBSCRIBED AND SWORN to before me this 9th day of July, 2007.

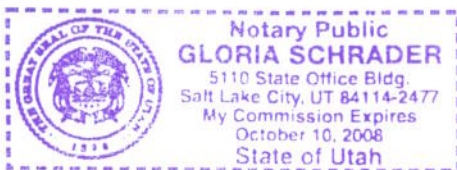



NOTARY PUBLIC

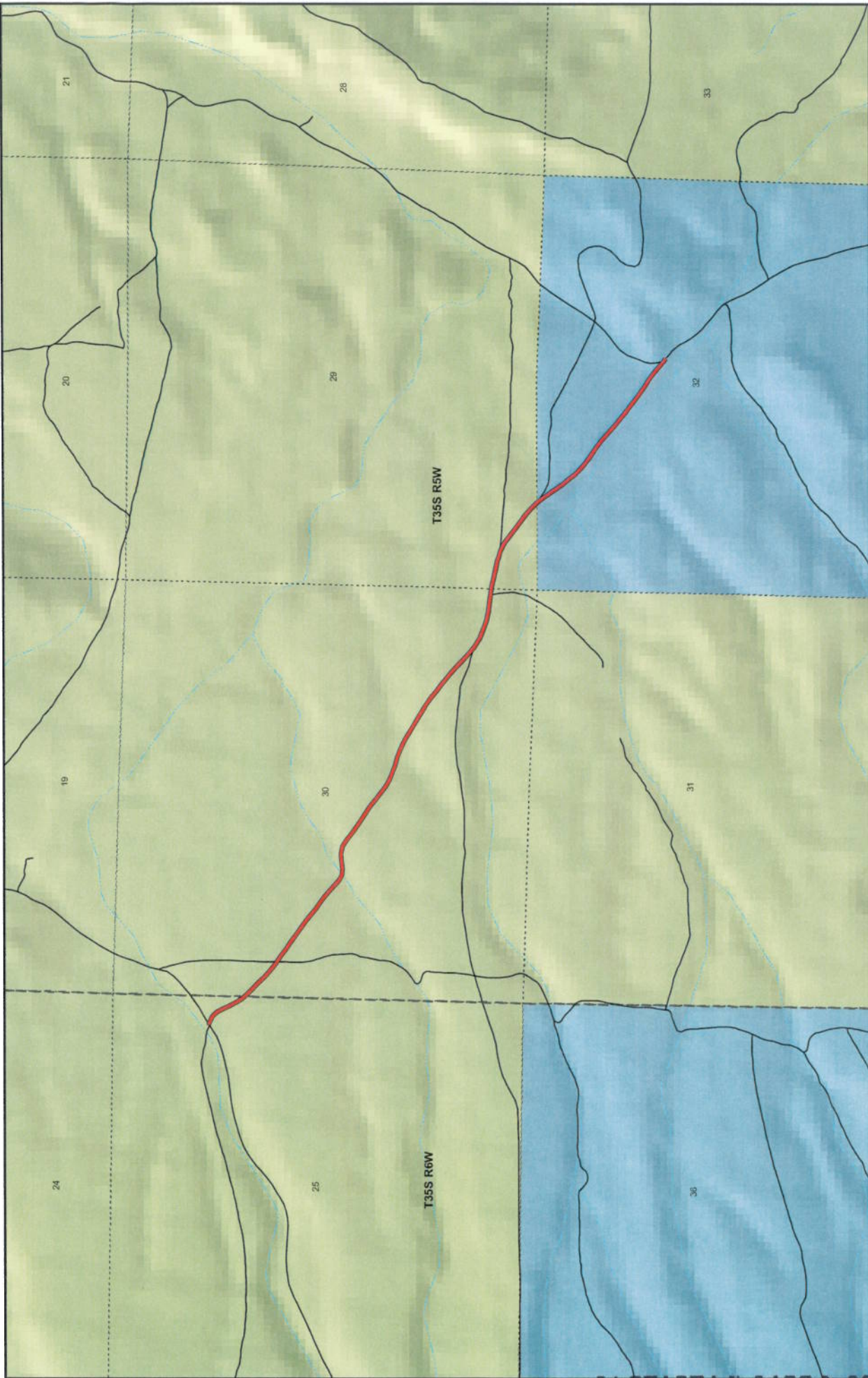

SAGE HEN TO DD HOLLOW
County Unique - 0213a

- Land Ownership Categories**
- BLM
 - Private
 - SITLA, State Trust Land
 - USFS, National Forest
 - National Park/Monument (NPS)

- Misc**
- Wildlife Reserve
 - National Rec. Area
 - Wilderness
 - State Park
 - City / Town
 - Municipalities
 - Section = 1 Mile
 - Monument Boundary

- Transportation Network**
- SAGE HEN TO DD HOLLOW
 - State / U.S. Highway
 - Local Roads



1:20,211
 1 inch equals 0.3 miles



Map prepared by the State of Utah
 Automatic Geoprocessing Reference Center
 AGRC
 Rooms 5100 State Office Building
 Salt Lake City, Utah 84114
 Jan 04, 2007

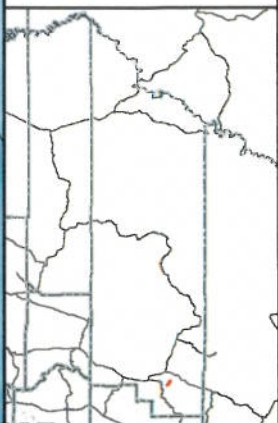

Appendix A to Attachment 4

Popular Name: SAGE HEN TO DD HOLLOW ROAD

County: Garfield

County Road Number: 0213a

State Geographic Information Database (SGID) Road Identification Number: RD090048.

Road-Segment Number: 001

Road-Segment Length: 1.54 miles more or less.

Believed owner of the land underlying this road-segment is: Bureau of Land Management.

The following description is based upon the geographic coordinate system using the NAD83 Datum. The source is GPS mapping grade data as indicated in the metadata and/or the transportation data model of the State of Utah Geographic Information Database (SGID).

The road-segment itself is the monument that is identified by its physical presence on the land. The location of said physical presence is closely approximated by mapping grade Global Positioning System (GPS) data. Said data are checked against the corresponding gray-scale 1-meter Digital Orthophoto Quadrangles published by the United States Geological Survey (USGS) to verify a reasonable degree of accuracy. In circumstances where accurate satellite signal acquisition is not possible, such as deep, narrow canyons or under a canopy of dense foliage, or where very sharp curves in the road make accuracy questionable, such portions of the road were digitized from the corresponding gray-scale 1-meter Digital Orthophoto Quadrangles published by the United States Geological Survey (USGS).

This road-segment may traverse:

Township 35 South Range 5 West, Section(s) 29,30, Salt Lake Base & Meridian

Township 35 South Range 6 West, Section(s) 25, Salt Lake Base & Meridian

The following description closely approximates the location of the centerline of the physical monument (SAGE HEN TO DD HOLLOW ROAD)-- Segment 001 based on mapping grade Global Positioning System (GPS) data as defined above:

Beginning at a point on the road center line located at 37 degrees 44 minutes 32.12 seconds North Latitude and -112 degrees 28 minutes 18.87 seconds West Longitude, which can be converted to mapping accuracy State Plane Utah South Zone NAD 83 feet coordinates of X = 1,359,389.3 feet and Y = 10,235,601.4 feet; thence the following courses along the said road center line:

thence South 62 Degrees 32 Minutes 49 Seconds East 7 feet
thence South 63 Degrees 44 Minutes 26 Seconds East 40.4 feet
thence South 63 Degrees 44 Minutes 26 Seconds East 60.2 feet
thence South 41 Degrees 10 Minutes 29 Seconds East 83.7 feet
thence South 28 Degrees 43 Minutes 59 Seconds East 90.3 feet
thence South 27 Degrees 21 Minutes 22 Seconds East 86.6 feet
thence South 28 Degrees 44 Minutes 22 Seconds East 76.5 feet
thence South 30 Degrees 03 Minutes 01 Seconds East 18.5 feet
thence South 29 Degrees 11 Minutes 31 Seconds East 10.9 feet
thence South 31 Degrees 48 Minutes 35 Seconds East 71.6 feet

thence South 41 Degrees 32 Minutes 55 Seconds East 39.9 feet
 thence South 41 Degrees 32 Minutes 58 Seconds East 52.2 feet
 thence South 45 Degrees 26 Minutes 54 Seconds East 93 feet
 thence South 45 Degrees 26 Minutes 23 Seconds East 99.1 feet
 thence South 45 Degrees 18 Minutes 20 Seconds East 105.3 feet
 thence South 47 Degrees 36 Minutes 25 Seconds East 98.2 feet
 thence South 51 Degrees 00 Minutes 03 Seconds East 86.5 feet
 thence South 53 Degrees 39 Minutes 35 Seconds East 67.1 feet
 thence South 58 Degrees 36 Minutes 14 Seconds East 13.1 feet
 thence South 53 Degrees 26 Minutes 08 Seconds East 23 feet
 thence South 55 Degrees 02 Minutes 17 Seconds East 72.7 feet
 thence South 55 Degrees 38 Minutes 02 Seconds East 100.9 feet
 thence South 55 Degrees 17 Minutes 07 Seconds East 109.8 feet
 thence South 55 Degrees 10 Minutes 16 Seconds East 108.3 feet
 thence South 53 Degrees 57 Minutes 01 Seconds East 109.6 feet
 thence South 53 Degrees 26 Minutes 08 Seconds East 109.9 feet
 thence South 52 Degrees 25 Minutes 50 Seconds East 104.8 feet
 thence South 51 Degrees 52 Minutes 56 Seconds East 99.3 feet
 thence South 54 Degrees 04 Minutes 23 Seconds East 94.4 feet
 thence South 53 Degrees 01 Minutes 55 Seconds East 93.2 feet
 thence South 50 Degrees 18 Minutes 16 Seconds East 98.5 feet
 thence South 49 Degrees 04 Minutes 56 Seconds East 95.1 feet
 thence South 48 Degrees 51 Minutes 19 Seconds East 93.7 feet
 thence South 61 Degrees 03 Minutes 24 Seconds East 84.6 feet
 thence South 86 Degrees 00 Minutes 20 Seconds East 87.5 feet
 thence North 83 Degrees 05 Minutes 22 Seconds East 94.1 feet
 thence North 86 Degrees 30 Minutes 12 Seconds East 94.3 feet
 thence South 78 Degrees 23 Minutes 45 Seconds East 92.2 feet
 thence South 58 Degrees 35 Minutes 25 Seconds East 103 feet
 thence South 51 Degrees 51 Minutes 31 Seconds East 124 feet
 thence South 54 Degrees 07 Minutes 14 Seconds East 131.7 feet
 thence South 57 Degrees 17 Minutes 59 Seconds East 129.5 feet
 thence South 56 Degrees 06 Minutes 18 Seconds East 122.6 feet
 thence South 52 Degrees 58 Minutes 20 Seconds East 121.7 feet
 thence South 51 Degrees 28 Minutes 10 Seconds East 116.7 feet
 thence South 51 Degrees 26 Minutes 01 Seconds East 110.8 feet
 thence South 59 Degrees 55 Minutes 34 Seconds East 99.3 feet
 thence South 67 Degrees 57 Minutes 26 Seconds East 95.8 feet
 thence South 71 Degrees 17 Minutes 09 Seconds East 101.7 feet
 thence South 72 Degrees 27 Minutes 28 Seconds East 111.3 feet
 thence South 71 Degrees 08 Minutes 47 Seconds East 115 feet
 thence South 64 Degrees 07 Minutes 48 Seconds East 129.4 feet
 thence South 58 Degrees 53 Minutes 47 Seconds East 130.3 feet
 thence South 57 Degrees 45 Minutes 19 Seconds East 128.1 feet
 thence South 59 Degrees 36 Minutes 48 Seconds East 130.5 feet
 thence South 58 Degrees 50 Minutes 28 Seconds East 128.9 feet
 thence South 53 Degrees 44 Minutes 10 Seconds East 125 feet
 thence South 51 Degrees 15 Minutes 59 Seconds East 116.2 feet
 thence South 53 Degrees 22 Minutes 07 Seconds East 112.5 feet

thence South 50 Degrees 11 Minutes 26 Seconds East 109 feet
 thence South 47 Degrees 39 Minutes 19 Seconds East 107.5 feet
 thence South 48 Degrees 22 Minutes 27 Seconds East 99.7 feet
 thence South 49 Degrees 08 Minutes 13 Seconds East 100.7 feet
 thence South 49 Degrees 02 Minutes 12 Seconds East 107 feet
 thence South 51 Degrees 13 Minutes 15 Seconds East 96.8 feet
 thence South 44 Degrees 38 Minutes 48 Seconds East 20.2 feet
 thence South 57 Degrees 38 Minutes 52 Seconds East 116.1 feet
 thence South 69 Degrees 15 Minutes 24 Seconds East 120.6 feet
 thence South 71 Degrees 58 Minutes 04 Seconds East 122 feet
 thence South 77 Degrees 44 Minutes 31 Seconds East 117.7 feet
 thence South 82 Degrees 25 Minutes 20 Seconds East 107.7 feet
 thence South 82 Degrees 21 Minutes 25 Seconds East 87.8 feet
 thence South 84 Degrees 27 Minutes 57 Seconds East 29 feet
 thence South 82 Degrees 25 Minutes 20 Seconds East 21.5 feet
 thence South 83 Degrees 23 Minutes 39 Seconds East 32.7 feet
 thence South 79 Degrees 33 Minutes 14 Seconds East 17.7 feet
 thence South 79 Degrees 33 Minutes 16 Seconds East 35.1 feet
 thence South 79 Degrees 19 Minutes 00 Seconds East 103.3 feet
 thence South 77 Degrees 03 Minutes 21 Seconds East 121.7 feet
 thence South 77 Degrees 21 Minutes 32 Seconds East 117.2 feet
 thence South 74 Degrees 18 Minutes 25 Seconds East 48.8 feet
 thence South 83 Degrees 10 Minutes 49 Seconds East 2.6 feet
 thence South 74 Degrees 06 Minutes 29 Seconds East 71.8 feet
 thence South 64 Degrees 37 Minutes 42 Seconds East 113.6 feet
 thence South 54 Degrees 39 Minutes 39 Seconds East 122.7 feet
 thence South 52 Degrees 19 Minutes 51 Seconds East 132.8 feet
 thence South 53 Degrees 26 Minutes 07 Seconds East 116.5 feet
 thence South 54 Degrees 52 Minutes 00 Seconds East 110.4 feet
 thence South 49 Degrees 26 Minutes 30 Seconds East 93.3 feet
 thence South 44 Degrees 59 Minutes 44 Seconds East 85.9 feet
 thence South 39 Degrees 27 Minutes 43 Seconds East 9.7 feet more or less to **the ending point**

at: 37 degrees 43 minutes 51.36 seconds North Latitude and -112 degrees 26 minutes 54.55 seconds West Longitude, which can be converted to mapping accuracy State Plane Utah South Zone NAD 83 feet coordinates of X = 1,366,120.0 feet and Y = 10,231,409.2 feet.