

**Acknowledgment and
Notice of Acknowledgment
of Acceptance of R.S. 2477
Right-of-Way Grant**

Ent 251415 Bk 430 Pg 497
Date: 12-MAY-2008 9:45AM
Fee: None
Filed By: CT
LES BARKER, Recorder
GARFIELD COUNTY CORPORATION
For: GOVERNOR/STATE OF UTAH

THE STATE OF UTAH

TO ALL WHOM THESE PRESENTS SHALL COME, Greeting:

Know ye, This is an Acknowledgment and Notice of Acknowledgment made under Utah Code Sections 72-5-309 through 310 inclusive, that the grant of the United States of America of “the right of way for the construction of highways over public lands, not reserved for public uses” under United States Revised Statutes 2477 (43 U.S.C. Section 932 (repealed October 21, 1976, with proviso recognizing the validity of rights-of-way already established)) was accepted for and on behalf of the State of Utah and its political subdivision Garfield County as it pertains to the highway located in Garfield County known as LAMPSTAND ROAD; County Road Number: 0628; State Geographic Information Database (SGID) Road Identification Number: RD090098. Total road length is 8.17 miles more or less.

The reason for this Acknowledgment and Notice of Acknowledgment includes, but is not limited to, the fact that the road was constructed, mechanically, or by continuous use as a public highway for a period of at least ten years, over public lands not reserved for public uses, prior to the earlier of (a) the October 21, 1976 repeal of R.S. 2477 or (b) the date the servient estate was reserved for public uses.

This Acknowledgment and Notice of Acknowledgment applies only to the segments of the road that traverse land owned by the Bureau of Land Management, United States Department of the Interior, and does not apply to segments of the road that traverse land owned by any other person or entity. The State of Utah and its political subdivisions reserve the right to make further acknowledgments and notices of acknowledgment with regard to road segments that traverse land owned by other entities, including the United States of America, through one or more of its agencies.

A printed copy of a map showing the location of the road in said county is appended hereto as “Attachment 1,” a printed copy of representative photos of the road is appended hereto as “Attachment 2,” a printed copy of a description of the beginning and ending points of the entire road together with a list of Townships, Ranges and Sections that may be traversed by the road in said county is appended hereto as “Attachment 3,” and a printed copy of the Road Centerline Description Cover Page(s) is appended hereto as “Attachment 4.” The Appendices listed in “Attachment 4” that contain the actual road centerline descriptions are incorporated herein by reference. Affidavits provided by individuals familiar with the road are appended hereto as “Attachment 5.”

A printed copy of this Acknowledgment and Notice of Acknowledgment, together with its Attachments and Appendices, may be viewed and/or obtained at the office of the Utah State Archives.

An electronic copy of this Acknowledgment and Notice of Acknowledgment, together with its Attachments and Appendices, may be viewed and/or downloaded as read-only PDF (Portable Document Format) files via the

Internet at <http://recorded2477roads.utah.gov>.

The owner of the servient estate in the land underlying the road-segments subject to this Acknowledgment and Notice is believed to be the United States of America through one or more of its agencies. Any of such agencies or any other person with a servient ownership claim or a competing dominant estate right-of-way ownership claim, may file a petition in the State District Court for Salt Lake County for a decision regarding the correctness of this Acknowledgment. A claimant shall file a petition within sixty (60) days after receipt of this Notice.

In Witness Whereof, I, John Harja, the official designee of the Governor of the State of Utah, in conformity to the laws of the State (Utah Code Sections 72-5-308 through 310 inclusive), have caused this Acknowledgment and Notice of Acknowledgment to be made.

Signed by my hand in Salt Lake City, Utah, the 23rd day of April, 2008.

By the Governor's Designee



John Harja

CERTIFICATION

State of Utah)
 : ss
County of Salt Lake)

I hereby certify that the signer of the foregoing document, John Harja, is personally known by me, has made a voluntary signature and taken an oath stating that he is the official designee of the Governor of the State of Utah and is authorized to sign this document on the Governor's behalf pursuant to Utah Code Section 72-5-309. He further vouched that, based upon information and belief, the facts alleged therein are true.

Dated this 23rd day of April, 2008.

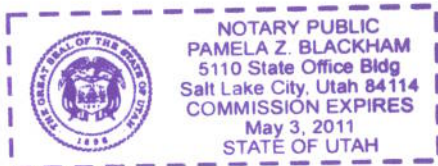

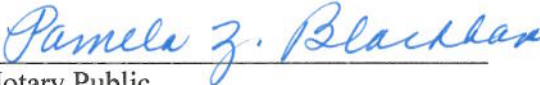

Notary Public



LAMPSTAND ROAD - Garfield County
SGID RD_ID RD090098

Land Ownership Categories

- BLM
- Private
- SITLA, State Trust Land
- USFS, National Forest
- State Parks and Recreation
- Tribal, Indian Reservation
- NPS, National Park
- Wilderness
- UDWR Wildlife Reserve
- DOD, Military
- State Sovereign Land
- National Recreation Area
- USFWS, Natl. Wildlife Refuge

Transportation Network

- LAMPSTAND ROAD
- Other Roads
- Title V, Issued Or Under Consideration By BLM Or County
- Photo Event Point

Section = 1 Mile

1:38,741
1 inch equals 0.6 miles

Map prepared by the State of Utah
Automated Geographic Reference Center
Room 5130 State Office Building
Salt Lake City, Utah 84114
Feb 27, 2008

Attachment 2



EP090098009



EP090098010



EP090098011



EP090098012

EP000000000

EP000000000

LAMPSTAND ROAD - Garfield County
SGID RD_ID RD090098

Map prepared by the State of Utah
Automated Geographic Reference Center
Room 5130 State Office Building
Salt Lake City, Utah 84114
February 29, 2008



Attachment 3

Beginning & Ending Points and Township, Range, and Section References For:

Popular Name: LAMPSTAND ROAD

County: Garfield

County Road Number: 0628

State Geographic Information Database (SGID) Road Identification Number: RD090098.

Total Road Length: 8.17 miles more or less.

Beginning at a point on the road centerline located at 37 degrees 59 minutes 04.24 seconds North Latitude and -111 degrees 14 minutes 30.81 seconds West Longitude, which can be converted to mapping accuracy State Plane Utah South Zone NAD 83 feet coordinates of X = 1,714,806.6 feet and Y = 10,322,457.6 feet based on the US Survey Foot conversion.

Ending at a point on the road centerline located at 37 degrees 56 minutes 04.5 seconds North Latitude and -111 degrees 08 minutes 59.71 seconds West Longitude, which can be converted to mapping accuracy State Plane Utah South Zone NAD 83 feet coordinates of X = 1,741,366.5 feet and Y = 10,308,408.6 feet based on the US Survey Foot conversion.

This road may traverse:

Township 32 South Range 6 East, Section(s) 34,35,36, Salt Lake Base & Meridian

Township 32 South Range 7 East, Section(s) 31,32, Salt Lake Base & Meridian

Township 33 South Range 7 East, Section(s) 4,5,9,16, Salt Lake Base & Meridian

See Attachment 1 above for a cartographic depiction of the course of this road.

**Attachment 4
Road Centerline Description Cover Page(s)**

Popular Name: LAMPSTAND ROAD

County: Garfield

County Road Number: 0628

State Geographic Information Database (SGID) Road Identification Number: RD090098.

Total Road Length: 8.17 miles more or less.

Centerline Descriptions Of Road-Segments That Cross Over Federally Owned Land, Derived From Global Positioning System Data And Cross-checked against USGS Digital Orthophoto Quadrangles Compiled By The Utah Automated Geographic Reference Center And Entered Into The State Geographic Information Database (SGID).

Road-Segments Listed by SGID Road Identification Number (RD_ID)	Road-Segment Numbers	Believed Ownership Of Servient Estate	Approximate Segment Length	See Attached Appendix
RD090098	001	BLM	8.17 Miles	A
		Total Road Length	8.17	_____

* Indicates that a Title V permit will be requested, is in process, or has been issued.

† Indicates that road-segments crossing Forest Service land are under consideration by the state and county as of the date of this Acknowledgment and Notice of Acknowledgment.

Attachment 5

AFFIDAVIT OF SAM SPENCER

LAMPSTAND ROAD

COUNTY ROAD NUMBER 0628

GARFIELD COUNTY, UTAH

State of Utah)
 : ss.
County of Garfield)

SAM SPENCER, being first duly sworn, deposes and states as follows:

1. I am an adult competent to testify about the matters set forth below based upon my personal knowledge. I have lived in Garfield County for 50 years. I have been employed by the Garfield County Road Department for 15 years.

2. I have traveled and am familiar with a road in Garfield County known as Lampstand Road. I am also familiar with the land the road traverses. When I first used and observed the road in the early 1960s, it followed the same route as in 2002 when I last observed it. Attached is a Garfield County map showing Lampstand Road. To the best of my knowledge and based upon my use of and familiarity with this road and the land it traverses, the location and route of the road are correctly illustrated on the attached map. The County also identifies this road according to the road number listed above.

3. I have observed that the road has been open to the public for all to use, to come and go as they pleased, since at least as early as the early 1960s and continuing through 1976 to 2002. Throughout this time period I have observed travel on the road by various means, including cars, trucks, ATVs and jeeps. Throughout this time period, the

road has been used daily, weather permitting, for more than ten continuous years prior to 1976, and was used daily, weather permitting, in 2002.

4. Throughout the time period from the early 1960s to 2002, I have used the road for hunting, wood gathering, rock hounding, picnicking, hiking and sight seeing.

5. Throughout the time period described in the previous paragraph, I observed vehicles using the road at various times for the uses described in the previous paragraph, plus livestock operations, prospecting for minerals, oil and gas exploration and government access.

6. It is also the reputation in the community that this road has been open to the public for all to use, to come and go as they pleased, since at least as early as the 1940s and continuing through 1976 to the present, for the uses described in the previous paragraphs.

7. Prior to 1976, I observed the graded surface of the road.

Dated this 11th day of July, 2007.



SAM SPENCER

SUBSCRIBED AND SWORN to before me this 11th day of July, 2007.

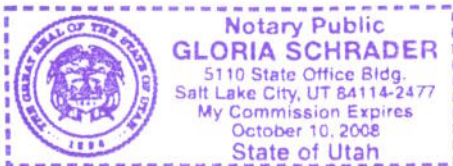



NOTARY PUBLIC

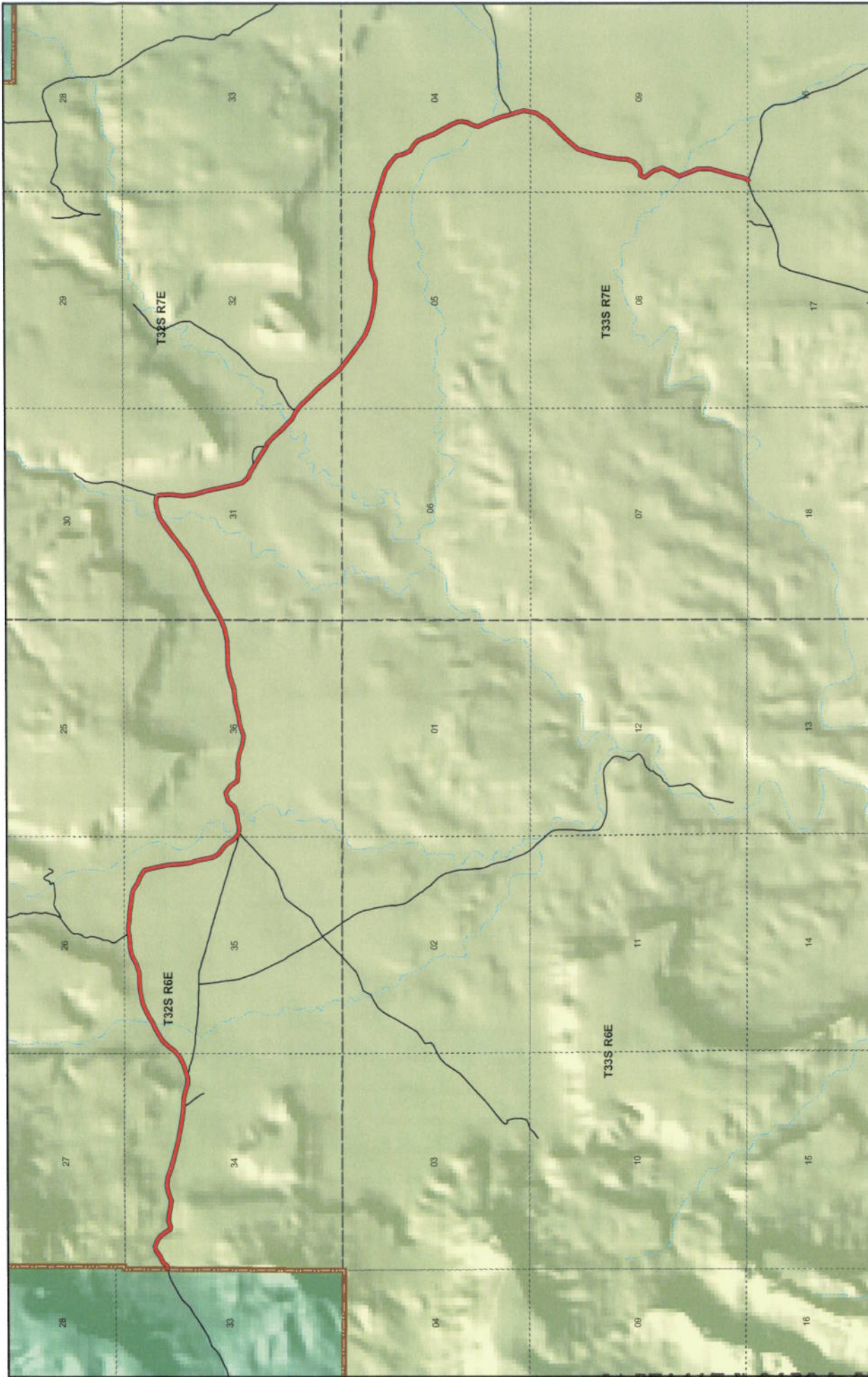

LAMPSTAND RD
County Unique - 0628

Land Ownership Categories

- BLM
- Private
- SITLA, State Trust Land
- USFS, National Forest
- National Park/Monument (NPS)

Misc

- Wildlife Reserve
- National Rec. Area
- Wilderness
- State Park
- City / Town
- Municipalities
- Section = 1 Mile
- Monument Boundary

Transportation Network

- LAMPSTAND RD
- State / U.S. Highway
- Local Roads

1:38,252
 1 inch equals 0.6 miles

Map prepared by the State of Utah
 Automated Geographic Reference Center
 AGRC
 Room 5130, North Building
 Salt Lake City, Utah 84114
 July 05, 2007



AFFIDAVIT OF DELL LEFEVRE

LAMPSTAND ROAD

COUNTY ROAD NUMBER 0628

GARFIELD COUNTY, UTAH

State of Utah)
 : ss.
County of Garfield)

DELL LEFEVRE, being first duly sworn, deposes and states as follows:

1. I am an adult competent to testify about the matters set forth below based upon my personal knowledge. I have lived in Garfield County for 55 years. I have been a Garfield Commissioner for 17 years.

2. I first used and have observed and am familiar with a road in Garfield County known as Lampstand Road. I am also familiar with the land the road traverses. When I first used and observed the road in 1955, it followed the same route as in 2005 when I last observed it. Attached is a Garfield County map showing Lampstand Road. To the best of my knowledge and based upon my use of and familiarity with this road and the land it traverses, the location and route of the road are correctly illustrated on the attached map. The County also identifies this road according to the road number listed above.

3. I have observed that the road has been open to the public for all to use, to come and go as they pleased, since at least as early as 1955 and continuing through 1976 to 2005. Throughout this time period I have observed travel on the road by various means, including cars, trucks, maintenance vehicles and jeeps. Throughout this time

period, the road has been used daily for more than ten continuous years prior to 1976, and was used daily in 2005.

4. Throughout the time period from 1955 to 2005, I have used and observed vehicles using the road for livestock operations, hunting, cedar post cutting, drilling, and travel in and through the area.

5. Throughout the time period described in the previous paragraph, I observed vehicles using the road at various times for the uses described in the previous paragraph, plus recreation, prospecting for minerals, rock hounding and government access.

6. It is also the reputation in the community that this road has been open to the public for all to use, to come and go as they pleased, since at least as early as the early 1900s and continuing through 1976 to the present, for the uses described in the previous paragraphs.

7. Prior to 1976, I observed graders performing maintenance and construction activities on the road.

Dated this 9 day of July, 2007.

DELL LEFEVRE

SUBSCRIBED AND SWORN to before me this 9th day of July, 2007.

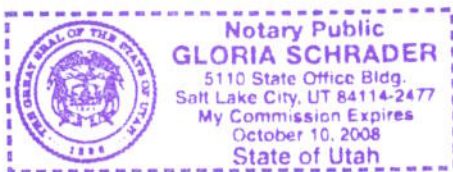

NOTARY PUBLIC

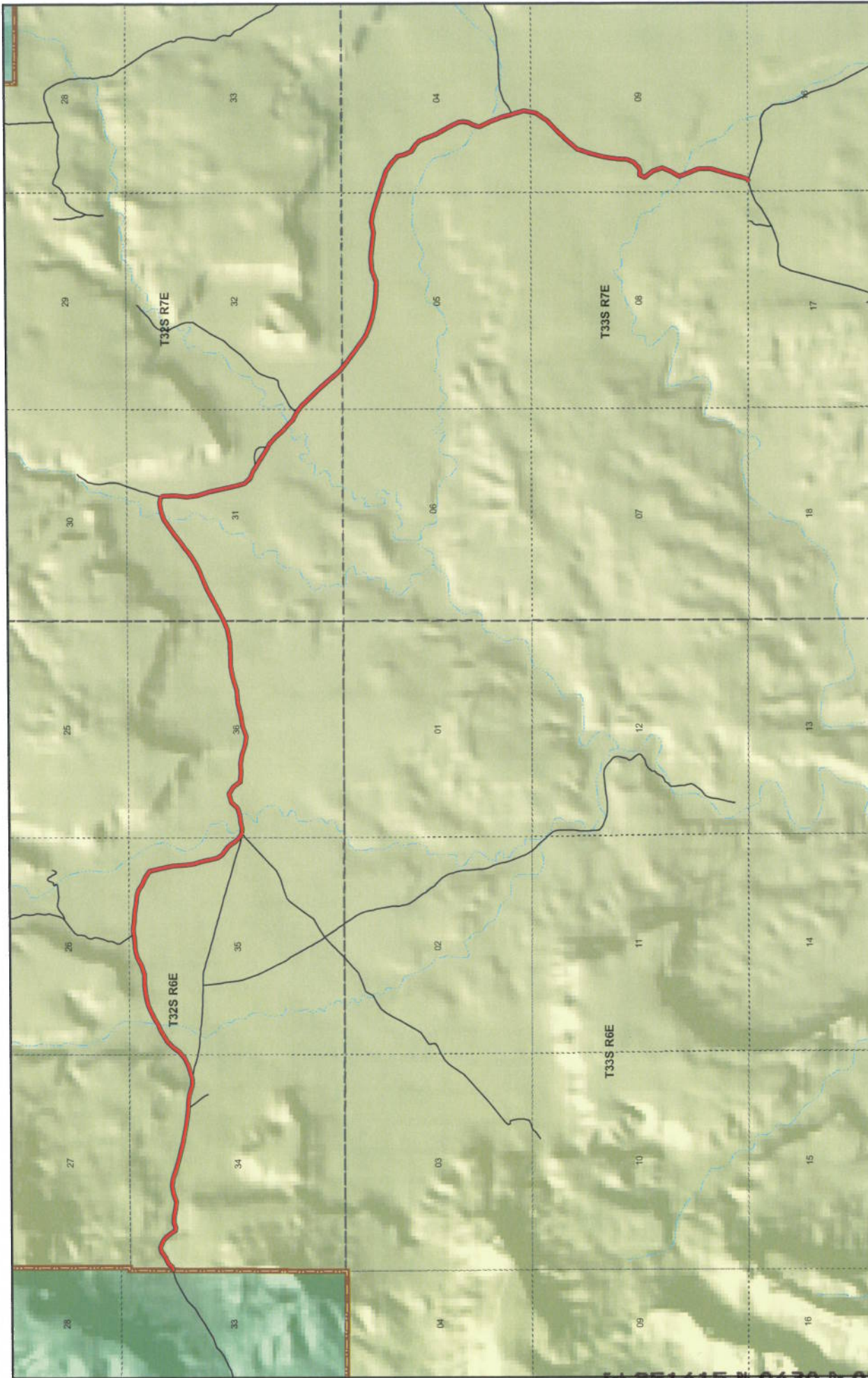

LAMPSTAND RD
County Unique - 0628

- Land Ownership Categories**
- BLM
 - Private
 - SITLA, State Trust Land
 - USFS, National Forest
 - National Park/Monument (NPS)
- Misc**
- Wildlife Reserve
 - National Rec. Area
 - Wilderness
 - State Park
 - City / Town
 - Municipalities
 - Section = 1 Mile
 - Monument Boundary
- Transportation Network**
- LAMPSTAND RD
 - State / U.S. Highway
 - Local Roads



1:38,252
 1 inch equals 0.6 miles



Map prepared by the State of Utah
 Automated Geographic Reference Center
 AGRC
 Room 410, Governor's Building
 Salt Lake City, Utah 84114
 Jul 05, 2007



Appendix A to Attachment 4

Popular Name: LAMPSTAND ROAD

County: Garfield

County Road Number: 0628

State Geographic Information Database (SGID) Road Identification Number: RD090098.

Road-Segment Number: 001

Road-Segment Length: 8.17 miles more or less.

Believed owner of the land underlying this road-segment is: Bureau of Land Management.

The following description is based upon the geographic coordinate system using the NAD83 Datum. The source is GPS mapping grade data as indicated in the metadata and/or the transportation data model of the State of Utah Geographic Information Database (SGID).

The road-segment itself is the monument that is identified by its physical presence on the land. The location of said physical presence is closely approximated by mapping grade Global Positioning System (GPS) data. Said data are checked against the corresponding gray-scale 1-meter Digital Orthophoto Quadrangles published by the United States Geological Survey (USGS) to verify a reasonable degree of accuracy. In circumstances where accurate satellite signal acquisition is not possible, such as deep, narrow canyons or under a canopy of dense foliage, or where very sharp curves in the road make accuracy questionable, such portions of the road were digitized from the corresponding gray-scale 1-meter Digital Orthophoto Quadrangles published by the United States Geological Survey (USGS).

This road-segment may traverse:

Township 32 South Range 6 East, Section(s) 34,35,36, Salt Lake Base & Meridian

Township 32 South Range 7 East, Section(s) 31,32, Salt Lake Base & Meridian

Township 33 South Range 7 East, Section(s) 4,5,9,16, Salt Lake Base & Meridian

The following description closely approximates the location of the centerline of the physical monument (LAMPSTAND ROAD)-- Segment 001 based on mapping grade Global Positioning System (GPS) data as defined above:

Beginning at a point on the road center line located at 37 degrees 59 minutes 04.24 seconds North Latitude and -111 degrees 14 minutes 30.81 seconds West Longitude, which can be converted to mapping accuracy State Plane Utah South Zone NAD 83 feet coordinates of X = 1,714,806.6 feet and Y = 10,322,457.6 feet; thence the following courses along the said road center line:

thence North 79 Degrees 57 Minutes 55 Seconds East	23.3 feet
thence North 74 Degrees 39 Minutes 30 Seconds East	82.2 feet
thence North 35 Degrees 26 Minutes 48 Seconds East	101.1 feet
thence North 58 Degrees 51 Minutes 18 Seconds East	102.4 feet
thence North 74 Degrees 05 Minutes 38 Seconds East	67.1 feet
thence North 56 Degrees 34 Minutes 53 Seconds East	81.1 feet
thence North 53 Degrees 09 Minutes 50 Seconds East	99.2 feet
thence North 75 Degrees 00 Minutes 08 Seconds East	90.6 feet
thence North 89 Degrees 41 Minutes 34 Seconds East	22.3 feet

thence South 70 Degrees 39 Minutes 11 Seconds East 87.8 feet
 thence South 64 Degrees 39 Minutes 57 Seconds East 91 feet
 thence South 50 Degrees 05 Minutes 54 Seconds East 119.5 feet
 thence South 36 Degrees 29 Minutes 11 Seconds East 136.2 feet
 thence South 36 Degrees 51 Minutes 34 Seconds East 118.5 feet
 thence South 79 Degrees 02 Minutes 44 Seconds East 75.6 feet
 thence North 72 Degrees 17 Minutes 53 Seconds East 137.2 feet
 thence South 89 Degrees 03 Minutes 51 Seconds East 151.3 feet
 thence South 77 Degrees 09 Minutes 21 Seconds East 180.3 feet
 thence South 81 Degrees 48 Minutes 34 Seconds East 166.6 feet
 thence North 67 Degrees 37 Minutes 30 Seconds East 65.5 feet
 thence North 70 Degrees 37 Minutes 42 Seconds East 141.7 feet
 thence North 80 Degrees 17 Minutes 23 Seconds East 208.9 feet
 thence South 81 Degrees 28 Minutes 38 Seconds East 171 feet
 thence South 72 Degrees 11 Minutes 00 Seconds East 210 feet
 thence South 74 Degrees 04 Minutes 35 Seconds East 253.6 feet
 thence South 75 Degrees 25 Minutes 18 Seconds East 236.4 feet
 thence South 75 Degrees 17 Minutes 26 Seconds East 228 feet
 thence South 80 Degrees 45 Minutes 02 Seconds East 197.7 feet
 thence South 81 Degrees 26 Minutes 32 Seconds East 181 feet
 thence South 81 Degrees 25 Minutes 34 Seconds East 159.4 feet
 thence South 83 Degrees 35 Minutes 49 Seconds East 168.5 feet
 thence South 84 Degrees 43 Minutes 23 Seconds East 118.1 feet
 thence South 83 Degrees 31 Minutes 04 Seconds East 41.6 feet
 thence South 88 Degrees 15 Minutes 28 Seconds East 183.6 feet
 thence South 74 Degrees 38 Minutes 05 Seconds East 170.1 feet
 thence South 75 Degrees 13 Minutes 23 Seconds East 182.9 feet
 thence South 89 Degrees 41 Minutes 41 Seconds East 153.6 feet
 thence North 74 Degrees 41 Minutes 52 Seconds East 152.2 feet
 thence North 71 Degrees 19 Minutes 30 Seconds East 177.1 feet
 thence North 65 Degrees 16 Minutes 46 Seconds East 203.3 feet
 thence North 49 Degrees 17 Minutes 07 Seconds East 100.6 feet
 thence North 49 Degrees 17 Minutes 07 Seconds East 99.4 feet
 thence North 37 Degrees 09 Minutes 51 Seconds East 200.1 feet
 thence North 43 Degrees 49 Minutes 14 Seconds East 182.9 feet
 thence North 58 Degrees 28 Minutes 28 Seconds East 164.6 feet
 thence North 61 Degrees 06 Minutes 42 Seconds East 154.4 feet
 thence North 65 Degrees 32 Minutes 24 Seconds East 160.4 feet
 thence North 60 Degrees 09 Minutes 49 Seconds East 173.1 feet
 thence North 59 Degrees 43 Minutes 43 Seconds East 180.7 feet
 thence North 70 Degrees 40 Minutes 17 Seconds East 152.1 feet
 thence North 71 Degrees 59 Minutes 54 Seconds East 128.5 feet
 thence North 79 Degrees 37 Minutes 39 Seconds East 189.7 feet
 thence North 84 Degrees 07 Minutes 36 Seconds East 233.5 feet
 thence North 89 Degrees 15 Minutes 55 Seconds East 219.9 feet
 thence North 73 Degrees 05 Minutes 14 Seconds East 230.8 feet
 thence North 60 Degrees 23 Minutes 40 Seconds East 224.7 feet
 thence North 76 Degrees 51 Minutes 13 Seconds East 190.5 feet
 thence North 85 Degrees 12 Minutes 30 Seconds East 184.7 feet

thence North 84 Degrees 41 Minutes 49 Seconds East 154.5 feet
 thence North 80 Degrees 03 Minutes 53 Seconds East 37.3 feet
 thence North 78 Degrees 08 Minutes 18 Seconds East 75.4 feet
 thence North 89 Degrees 41 Minutes 35 Seconds East 90.6 feet
 thence South 77 Degrees 20 Minutes 39 Seconds East 131.7 feet
 thence South 88 Degrees 31 Minutes 21 Seconds East 210.8 feet
 thence South 82 Degrees 30 Minutes 32 Seconds East 232.2 feet
 thence South 81 Degrees 25 Minutes 03 Seconds East 199.6 feet
 thence South 76 Degrees 56 Minutes 48 Seconds East 134.9 feet
 thence South 57 Degrees 32 Minutes 18 Seconds East 169.8 feet
 thence South 66 Degrees 03 Minutes 14 Seconds East 203.7 feet
 thence South 56 Degrees 38 Minutes 44 Seconds East 180.6 feet
 thence South 13 Degrees 43 Minutes 57 Seconds East 209.2 feet
 thence South 12 Degrees 09 Minutes 43 Seconds East 202.9 feet
 thence South 10 Degrees 17 Minutes 48 Seconds East 181.6 feet
 thence South 05 Degrees 08 Minutes 03 Seconds East 171.6 feet
 thence South 06 Degrees 45 Minutes 41 Seconds East 163.5 feet
 thence South 08 Degrees 27 Minutes 12 Seconds East 162.1 feet
 thence South 14 Degrees 53 Minutes 50 Seconds East 156.3 feet
 thence South 17 Degrees 00 Minutes 22 Seconds East 147.3 feet
 thence South 08 Degrees 17 Minutes 21 Seconds East 144.2 feet
 thence South 12 Degrees 38 Minutes 16 Seconds East 144.5 feet
 thence South 32 Degrees 59 Minutes 37 Seconds East 140.4 feet
 thence South 51 Degrees 55 Minutes 29 Seconds East 126.9 feet
 thence South 52 Degrees 38 Minutes 11 Seconds East 112.8 feet
 thence South 42 Degrees 59 Minutes 48 Seconds East 109.4 feet
 thence South 34 Degrees 11 Minutes 07 Seconds East 110.7 feet
 thence South 38 Degrees 48 Minutes 52 Seconds East 96.5 feet
 thence South 49 Degrees 55 Minutes 50 Seconds East 36.3 feet
 thence South 49 Degrees 55 Minutes 53 Seconds East 27 feet
 thence South 57 Degrees 11 Minutes 44 Seconds East 63.1 feet
 thence South 59 Degrees 44 Minutes 34 Seconds East 48.4 feet
 thence South 88 Degrees 03 Minutes 08 Seconds East 83.4 feet
 thence South 87 Degrees 50 Minutes 19 Seconds East 38.1 feet
 thence North 76 Degrees 13 Minutes 40 Seconds East 119.8 feet
 thence North 81 Degrees 16 Minutes 11 Seconds East 190.4 feet
 thence North 74 Degrees 05 Minutes 30 Seconds East 195.3 feet
 thence North 41 Degrees 46 Minutes 41 Seconds East 214.5 feet
 thence North 76 Degrees 20 Minutes 34 Seconds East 206.1 feet
 thence South 58 Degrees 24 Minutes 51 Seconds East 211.8 feet
 thence South 35 Degrees 06 Minutes 05 Seconds East 203 feet
 thence South 84 Degrees 45 Minutes 00 Seconds East 206.8 feet
 thence North 86 Degrees 09 Minutes 04 Seconds East 239.1 feet
 thence South 80 Degrees 56 Minutes 05 Seconds East 205.6 feet
 thence South 70 Degrees 40 Minutes 05 Seconds East 251.9 feet
 thence South 80 Degrees 13 Minutes 41 Seconds East 215.7 feet
 thence North 69 Degrees 30 Minutes 09 Seconds East 271 feet
 thence North 79 Degrees 42 Minutes 13 Seconds East 293.3 feet
 thence North 76 Degrees 56 Minutes 41 Seconds East 297.5 feet

thence North 84 Degrees 24 Minutes 31 Seconds East 302.9 feet
 thence North 71 Degrees 57 Minutes 35 Seconds East 313.6 feet
 thence North 79 Degrees 19 Minutes 02 Seconds East 308 feet
 thence North 89 Degrees 20 Minutes 34 Seconds East 268.5 feet
 thence North 87 Degrees 18 Minutes 16 Seconds East 315 feet
 thence North 78 Degrees 35 Minutes 36 Seconds East 298.3 feet
 thence North 68 Degrees 30 Minutes 25 Seconds East 220.8 feet
 thence North 68 Degrees 30 Minutes 25 Seconds East 51.6 feet
 thence North 60 Degrees 23 Minutes 40 Seconds East 224.7 feet
 thence North 63 Degrees 13 Minutes 14 Seconds East 272.4 feet
 thence North 60 Degrees 38 Minutes 18 Seconds East 300.7 feet
 thence North 67 Degrees 52 Minutes 01 Seconds East 282.5 feet
 thence North 67 Degrees 06 Minutes 21 Seconds East 222.2 feet
 thence North 63 Degrees 07 Minutes 41 Seconds East 161.5 feet
 thence North 60 Degrees 09 Minutes 41 Seconds East 153.1 feet
 thence North 54 Degrees 57 Minutes 16 Seconds East 218.9 feet
 thence North 48 Degrees 35 Minutes 44 Seconds East 139.8 feet
 thence North 54 Degrees 09 Minutes 19 Seconds East 121.4 feet
 thence North 53 Degrees 27 Minutes 15 Seconds East 202.6 feet
 thence North 54 Degrees 39 Minutes 34 Seconds East 260.1 feet
 thence North 55 Degrees 26 Minutes 43 Seconds East 271.2 feet
 thence North 70 Degrees 25 Minutes 25 Seconds East 213.8 feet
 thence North 81 Degrees 11 Minutes 04 Seconds East 210.7 feet
 thence South 79 Degrees 51 Minutes 35 Seconds East 153.9 feet
 thence South 12 Degrees 52 Minutes 13 Seconds East 58.8 feet
 thence South 01 Degrees 47 Minutes 22 Seconds East 279.1 feet
 thence South 06 Degrees 02 Minutes 00 Seconds West 297.2 feet
 thence South 08 Degrees 07 Minutes 53 Seconds East 270 feet
 thence South 17 Degrees 12 Minutes 24 Seconds East 313.9 feet
 thence South 12 Degrees 40 Minutes 31 Seconds East 331 feet
 thence South 12 Degrees 04 Minutes 56 Seconds East 316.8 feet
 thence South 15 Degrees 55 Minutes 37 Seconds East 230.4 feet
 thence South 42 Degrees 50 Minutes 30 Seconds East 188.8 feet
 thence South 69 Degrees 13 Minutes 59 Seconds East 187.1 feet
 thence South 57 Degrees 19 Minutes 15 Seconds East 103.7 feet
 thence South 57 Degrees 25 Minutes 09 Seconds East 155.9 feet
 thence South 56 Degrees 49 Minutes 26 Seconds East 276.6 feet
 thence South 63 Degrees 01 Minutes 07 Seconds East 186.1 feet
 thence South 62 Degrees 32 Minutes 53 Seconds East 42.3 feet
 thence South 46 Degrees 43 Minutes 03 Seconds East 235.6 feet
 thence South 43 Degrees 11 Minutes 24 Seconds East 226.2 feet
 thence South 46 Degrees 50 Minutes 03 Seconds East 174.1 feet
 thence South 45 Degrees 18 Minutes 24 Seconds East 201.9 feet
 thence South 61 Degrees 32 Minutes 26 Seconds East 221.6 feet
 thence South 54 Degrees 22 Minutes 41 Seconds East 55.9 feet
 thence South 55 Degrees 08 Minutes 19 Seconds East 11.8 feet
 thence South 55 Degrees 08 Minutes 16 Seconds East 136.3 feet
 thence South 41 Degrees 11 Minutes 00 Seconds East 251.8 feet
 thence South 47 Degrees 10 Minutes 17 Seconds East 249.6 feet

thence South 42 Degrees 58 Minutes 58 Seconds East 223.2 feet
 thence South 40 Degrees 23 Minutes 18 Seconds East 235.5 feet
 thence South 40 Degrees 07 Minutes 15 Seconds East 282.4 feet
 thence South 51 Degrees 48 Minutes 21 Seconds East 106 feet
 thence South 51 Degrees 48 Minutes 22 Seconds East 170.7 feet
 thence South 53 Degrees 46 Minutes 40 Seconds East 264.7 feet
 thence South 52 Degrees 50 Minutes 17 Seconds East 263.8 feet
 thence South 55 Degrees 37 Minutes 50 Seconds East 248.6 feet
 thence South 65 Degrees 53 Minutes 52 Seconds East 222.4 feet
 thence South 74 Degrees 13 Minutes 46 Seconds East 254.8 feet
 thence South 78 Degrees 01 Minutes 39 Seconds East 277.8 feet
 thence South 82 Degrees 38 Minutes 36 Seconds East 307.6 feet
 thence South 87 Degrees 32 Minutes 32 Seconds East 306.2 feet
 thence North 69 Degrees 47 Minutes 36 Seconds East 308.6 feet
 thence North 85 Degrees 14 Minutes 45 Seconds East 296.3 feet
 thence South 84 Degrees 07 Minutes 48 Seconds East 317.2 feet
 thence South 84 Degrees 30 Minutes 03 Seconds East 295.3 feet
 thence North 79 Degrees 12 Minutes 51 Seconds East 270.7 feet
 thence South 80 Degrees 09 Minutes 20 Seconds East 251.4 feet
 thence South 72 Degrees 09 Minutes 46 Seconds East 326.7 feet
 thence South 72 Degrees 36 Minutes 58 Seconds East 149.8 feet
 thence South 72 Degrees 36 Minutes 58 Seconds East 233.6 feet
 thence South 73 Degrees 19 Minutes 52 Seconds East 326 feet
 thence South 57 Degrees 02 Minutes 43 Seconds East 255.5 feet
 thence South 46 Degrees 49 Minutes 22 Seconds East 201.7 feet
 thence South 12 Degrees 50 Minutes 52 Seconds East 164.7 feet
 thence South 26 Degrees 26 Minutes 15 Seconds East 193.7 feet
 thence South 57 Degrees 20 Minutes 30 Seconds East 187 feet
 thence South 47 Degrees 41 Minutes 18 Seconds East 128.4 feet
 thence South 22 Degrees 00 Minutes 26 Seconds East 173.1 feet
 thence South 22 Degrees 02 Minutes 32 Seconds East 265 feet
 thence South 30 Degrees 26 Minutes 23 Seconds East 252.4 feet
 thence South 30 Degrees 08 Minutes 01 Seconds East 198.6 feet
 thence South 24 Degrees 48 Minutes 56 Seconds East 167.7 feet
 thence South 05 Degrees 05 Minutes 45 Seconds East 121.9 feet
 thence South 11 Degrees 33 Minutes 05 Seconds West 127.8 feet
 thence South 28 Degrees 32 Minutes 45 Seconds West 117.7 feet
 thence South 15 Degrees 45 Minutes 18 Seconds West 155.4 feet
 thence South 25 Degrees 54 Minutes 06 Seconds East 294.8 feet
 thence South 20 Degrees 38 Minutes 38 Seconds East 322 feet
 thence South 15 Degrees 08 Minutes 22 Seconds East 246.1 feet
 thence South 15 Degrees 14 Minutes 17 Seconds East 25.5 feet
 thence South 16 Degrees 00 Minutes 47 Seconds East 281.3 feet
 thence South 10 Degrees 56 Minutes 29 Seconds West 166.3 feet
 thence South 10 Degrees 56 Minutes 30 Seconds West 133.2 feet
 thence South 32 Degrees 31 Minutes 12 Seconds West 320.3 feet
 thence South 44 Degrees 06 Minutes 38 Seconds West 342.3 feet
 thence South 43 Degrees 31 Minutes 53 Seconds West 366.3 feet
 thence South 39 Degrees 52 Minutes 39 Seconds West 317.9 feet

thence South 18 Degrees 37 Minutes 31 Seconds West 334.8 feet
thence South 15 Degrees 06 Minutes 00 Seconds West 369.4 feet
thence South 07 Degrees 00 Minutes 07 Seconds West 304.4 feet
thence South 04 Degrees 05 Minutes 52 Seconds West 243.6 feet
thence South 21 Degrees 41 Minutes 31 Seconds West 177 feet
thence South 49 Degrees 03 Minutes 05 Seconds West 100.8 feet
thence South 48 Degrees 41 Minutes 36 Seconds West 66.5 feet
thence South 60 Degrees 54 Minutes 08 Seconds West 83.1 feet
thence North 86 Degrees 15 Minutes 25 Seconds West 111.5 feet
thence South 27 Degrees 03 Minutes 08 Seconds West 127.1 feet
thence South 36 Degrees 34 Minutes 51 Seconds East 246.3 feet
thence South 21 Degrees 27 Minutes 22 Seconds East 241.1 feet
thence South 23 Degrees 24 Minutes 45 Seconds West 227.6 feet
thence South 30 Degrees 31 Minutes 03 Seconds West 231.2 feet
thence South 21 Degrees 33 Minutes 41 Seconds East 223.6 feet
thence South 22 Degrees 44 Minutes 33 Seconds East 275.2 feet
thence South 00 Degrees 05 Minutes 10 Seconds West 287.2 feet
thence South 15 Degrees 22 Minutes 26 Seconds West 282.9 feet
thence South 17 Degrees 37 Minutes 31 Seconds West 248.4 feet
thence South 11 Degrees 31 Minutes 37 Seconds West 246.5 feet
thence South 19 Degrees 28 Minutes 14 Seconds West 163.9 feet
thence South 62 Degrees 39 Minutes 42 Seconds West 10.5 feet
thence South 62 Degrees 39 Minutes 45 Seconds West 61.7 feet more or less to **the ending**

point at: 37 degrees 56 minutes 044.5 seconds North Latitude and -111 degrees 08 minutes 59.71 seconds West Longitude, which can be converted to mapping accuracy State Plane Utah South Zone NAD 83 feet coordinates of X = 1,741,366.5 feet and Y = 10,308,408.6 feet.