

**Acknowledgment and
Notice of Acknowledgment
of Acceptance of R.S. 2477
Right-of-Way Grant**

ENTRY NO. 00139781
06/18/2008 01:58:23 PM B: 0350 P: 0763
Easements and Right of Ways PAGE 1 / 13
VERJEAN CARUSO, KANE COUNTY RECORDER
FEE \$ 0.00 BY GOVERNOR OF UTAH



THE STATE OF UTAH

TO ALL WHOM THESE PRESENTS SHALL COME, Greeting:

Know ye, This is an Acknowledgment and Notice of Acknowledgment made under Utah Code Sections 72-5-309 through 310 inclusive, that the grant of the United States of America of “the right of way for the construction of highways over public lands, not reserved for public uses” under United States Revised Statutes 2477 (43 U.S.C. Section 932 (repealed October 21, 1976, with proviso recognizing the validity of rights-of-way already established)) was accepted for and on behalf of the State of Utah and its political subdivision Kane County as it pertains to the highway located in Kane County known as Red Knoll Road; County Road Number: K1200; State Geographic Information Database (SGID) Road Identification Number: RD130042. Total road length is 2.54 miles more or less.

The reason for this Acknowledgment and Notice of Acknowledgment includes, but is not limited to, the fact that the road was constructed, mechanically, or by continuous use as a public highway for a period of at least ten years, over public lands not reserved for public uses, prior to the earlier of (a) the October 21, 1976 repeal of R.S. 2477 or (b) the date the servient estate was reserved for public uses.

This Acknowledgment and Notice of Acknowledgment applies only to the segments of the road that traverse land owned by the Bureau of Land Management, United States Department of the Interior, and does not apply to segments of the road that traverse land owned by any other person or entity. The State of Utah and its political subdivisions reserve the right to make further acknowledgments and notices of acknowledgment with regard to road segments that traverse land owned by other entities, including the United States of America, through one or more of its agencies.

A printed copy of a map showing the location of the road in said county is appended hereto as “Attachment 1,” a printed copy of representative photos of the road is appended hereto as “Attachment 2,” a printed copy of a description of the beginning and ending points of the entire road together with a list of Townships, Ranges and Sections that may be traversed by the road in said county is appended hereto as “Attachment 3,” and a printed copy of the Road Centerline Description Cover Page(s) is appended hereto as “Attachment 4.” The Appendices listed in “Attachment 4” that contain the actual road centerline descriptions are incorporated herein by reference. Affidavits provided by individuals familiar with the road are appended hereto as “Attachment 5.”

A printed copy of this Acknowledgment and Notice of Acknowledgment, together with its Attachments and Appendices, may be viewed and/or obtained at the office of the Utah State Archives.

An electronic copy of this Acknowledgment and Notice of Acknowledgment, together with its Attachments and Appendices, may be viewed and/or downloaded as read-only PDF (Portable Document Format) files via the

Internet at <http://recorded2477roads.utah.gov>.

The owner of the servient estate in the land underlying the road-segments subject to this Acknowledgment and Notice is believed to be the United States of America through one or more of its agencies. Any of such agencies or any other person with a servient ownership claim or a competing dominant estate right-of-way ownership claim, may file a petition in the State District Court for Salt Lake County for a decision regarding the correctness of this Acknowledgment. A claimant shall file a petition within sixty (60) days after receipt of this Notice.

In Witness Whereof, I, John Harja, the official designee of the Governor of the State of Utah, in conformity to the laws of the State (Utah Code Sections 72-5-308 through 310 inclusive), have caused this Acknowledgment and Notice of Acknowledgment to be made.

Signed by my hand in Salt Lake City, Utah, the 12th day of June, 2008.

By the Governor's Designee



John Harja

CERTIFICATION

State of Utah)
 : ss
County of Salt Lake)

I hereby certify that the signer of the foregoing document, John Harja, is personally known by me, has made a voluntary signature and taken an oath stating that he is the official designee of the Governor of the State of Utah and is authorized to sign this document on the Governor's behalf pursuant to Utah Code Section 72-5-309. He further vouched that, based upon information and belief, the facts alleged therein are true.

Dated this 12th day of June, 2008.





Notary Public

ENTRY NO. 00139781

06/18/2008 01:58:23 PM B: 0350 P: 0764
Easements and Right of Ways PAGE 2 / 13
VERJEAN CARUSO, KANE COUNTY RECORDER
FEE \$ 0.00 BY GOVERNOR OF UTAH





ENTRY NO. 00139781
 06/18/2008 01:58:23 PM B: 0350 P: 0765
 Easements and Right of Ways PAGE 3 / 13
 VERJEAN CARUSO, KANE COUNTY RECORDER
 FEE \$ 0.00 BY GOVERNOR OF UTAH







Red Knoll Road - Kane County
SGID RD_ID RD130042

Land Ownership Categories

-  BLM
-  Private
-  SITLA, State Trust Land
-  USFS, National Forest
-  State Parks and Recreation
-  Tribal, Indian Reservation
-  NPS, National Park
-  Wilderness
-  UDWR Wildlife Reserve
-  DOD, Military
-  State Sovereign Land
-  National Recreation Area
-  USFWS, Natl. Wildlife Refuge

Transportation Network

-  Red Knoll Road
-  Title V: Issued Or Under Consideration By BLM Or County
-  Other Roads
-  Photo Event Point
-  Section = 1 Mile



1:19,807

1 inch equals 0.3 miles



Map prepared by the State of Utah
 Automated Geographic Reference Center
 Room 5130 State Office Building
 Salt Lake City, Utah 84114
 Jun 10, 2008





EP130042017



EP130042024



EP130042025



EP130042026

ENTRY NO. 00139781

06/18/2008 01:58:23 PM B: 0350 P: 0766

Easements and Right of Ways PAGE 4 / 13

VERJEAN CARUSO, KANE COUNTY RECORDER

FEE \$ 0.00 BY GOVERNOR OF UTAH



EP000000000

EP000000000

Red Knoll Road- Kane County

SGID RD_ID RD130042

Map prepared by the State of Utah
Automated Geographic Reference Center
Room 5130 State Office Building
Salt Lake City, Utah 84114
June 10, 2008



Attachment 3

Beginning & Ending Points and Township, Range, and Section References For:

Popular Name: Red Knoll Road

County: Kane

County Road Number: K1200

State Geographic Information Database (SGID) Road Identification Number: RD130042.

Total Road Length: 2.54 miles more or less.

Beginning at a point on the road centerline located at 37 degrees 09 minutes 20.03 seconds North Latitude and -112 degrees 38 minutes 07.68 seconds West Longitude, which can be converted to mapping accuracy State Plane Utah South Zone NAD 83 feet coordinates of X = 1,309,504.6 feet and Y = 10,022,525.3 feet based on the US Survey Foot conversion.

Ending at a point on the road centerline located at 37 degrees 10 minutes 37.38 seconds North Latitude and -112 degrees 37 minutes 42.74 seconds West Longitude, which can be converted to mapping accuracy State Plane Utah South Zone NAD 83 feet coordinates of X = 1,311,618.3 feet and Y = 10,030,323.7 feet based on the US Survey Foot conversion.

This road may traverse:

Township 42 South Range 7 West, Section(s) 9,10,16, Salt Lake Base & Meridian
See Attachment 1 above for a cartographic depiction of the course of this road.

ENTRY NO. 00139781
06/18/2008 01:58:23 PM B: 0350 P: 0767
Easements and Right of Ways PAGE 5 / 13
VERJEAN CARUSO, KANE COUNTY RECORDER
FEE \$ 0.00 BY GOVERNOR OF UTAH



**Attachment 4
Road Centerline Description Cover Page(s)**

Popular Name: Red Knoll Road

County: Kane

County Road Number: K1200

State Geographic Information Database (SGID) Road Identification Number: RD130042.

Total Road Length: 2.54 miles more or less.

Centerline Descriptions Of Road-Segments That Cross Over Federally Owned Land, Derived From Global Positioning System Data And Cross-checked against USGS Digital Orthophoto Quadrangles Compiled By The Utah Automated Geographic Reference Center And Entered Into The State Geographic Information Database (SGID).

Road-Segments Listed by SGID Road Identification Number (RD ID)	Road-Segment Numbers	Believed Ownership Of Servient Estate	Approximate Segment Length	See Attached Appendix
RD130042	001	ST	1.74 Miles	(not shown)
RD130042	002	BLM	0.81 Miles	A
		Total Road Length	2.54	—————

* Indicates that a Title V permit will be requested, is in process, or has been issued.

† Indicates that road-segments crossing Forest Service land are under consideration by the state and county as of the date of this Acknowledgment and Notice of Acknowledgment.

ENTRY NO. 00139781

06/18/2008 01:58:23 PM B: 0350 P: 0768

Easements and Right of Ways PAGE 6 / 13

VERJEAN CARUSO, KANE COUNTY RECORDER

FEE \$ 0.00 BY GOVERNOR OF UTAH



Attachment 5

ENTRY NO. 00139781

06/18/2008 01:58:23 PM B: 0350 P: 0769

Easements and Right of Ways PAGE 7 / 13

VERJEAN CARUSO, KANE COUNTY RECORDER

FEE \$ 0.00 BY GOVERNOR OF UTAH



AFFIDAVIT OF VAUGHN A. JUDD

RED KNOLL ROAD

COUNTY ROAD NUMBER K1200

KANE COUNTY, UTAH

State of Utah)
 :SS
County of Kane)

VAUGHN A. JUDD, being first duly sworn, deposes and states as follows:

1. I am an adult competent to testify about the matters set forth below based upon my personal knowledge. I currently reside in Alton, Kane County. I was born in Kane County and have lived here my entire life, 83 years.

2. I have traveled and am familiar with a road in Kane County known as Red Knoll Road. I am also familiar with the land the road traverses. When I first used and observed the road in the late 1930s, it followed the same route as in 2006 when I last observed it. Attached is a Kane County map showing Red Knoll Road. To the best of my knowledge and based upon my use of and familiarity with this road and the land it traverses, the location and route of the road are correctly illustrated on the attached map. The County also identifies this road according to the road number listed above.

3. I have observed that the road has been open to the public for all to use, to come and go as they pleased, since at least as early as the late 1930s and continuing through 1976 to 2006. Throughout this time period I have observed travel on the road by various means, including, automobiles, pickup trucks, ATVs and jeeps and cattle trucks. Throughout this time period, the road has been used at least daily, for more than ten continuous years prior to 1976, and was used daily in 2006.

ENTRY NO. 00139781

06/18/2008 01:58:23 PM B: 0350 P: 0770

Easements and Right of Ways PAGE 8 / 13

VERJEAN CARUSO, KANE COUNTY RECORDER

FEE \$ 0.00 BY GOVERNOR OF UTAH



4. Throughout the time period from the late 1930s to the late 2006, I have used the road myself for hunting, sightseeing, and recreation.

5. Throughout the time period described in the previous paragraph, I have observed vehicles using the road at various times for the uses described in the previous paragraph, plus, livestock operations, wood gathering, camping, communications and utility access and travel in and through the area.

6. It is also the reputation in the community that this road has been open to the public for all to use, to come and go as they pleased, since at least the early 1930s and continuing through 1976 to the present, for the uses described in the previous paragraphs.

7. Prior to 1976, I observed the graded and graveled surface of the road and other evidence of maintenance and construction such as berms along the side of the road.

Dated this 15 day of May, 2007.



VAUGHN A. JUDD

SUBSCRIBED AND SWORN to before me this 15th day of May, 2007.

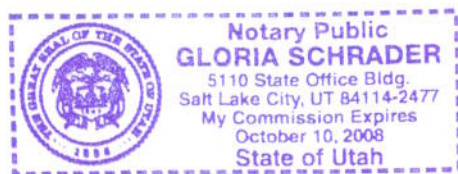



NOTARY PUBLIC

ENTRY NO. 00139781

06/18/2008 01:58:23 PM B: 0350 P: 0771
Easements and Right of Ways PAGE 9 / 13
VERJEAN CARUSO, KANE COUNTY RECORDER
FEE \$ 0.00 BY GOVERNOR OF UTAH



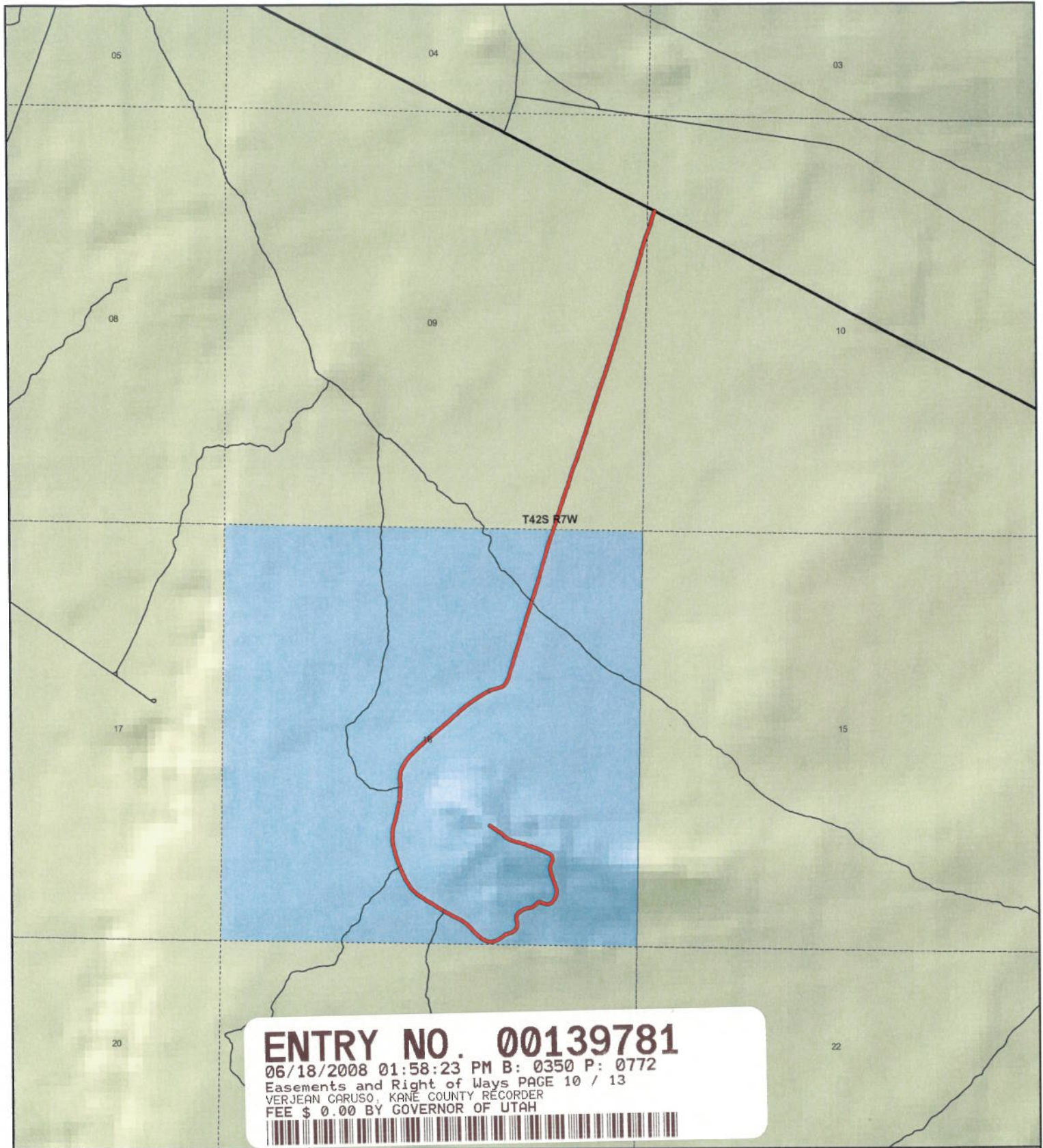

ENTRY NO. 00139781
 06/18/2008 01:58:23 PM B: 0350 P: 0772
 Easements and Right of Ways PAGE 10 / 13
 VERJEAN CARUSO, KANE COUNTY RECORDER
 FEE \$ 0.00 BY GOVERNOR OF UTAH

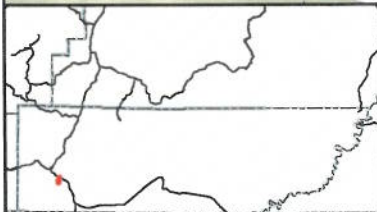

Red Knoll Road
County Unique - K1200

- Land Ownership Categories**
- BLM
 - Private
 - ◆ SITLA, State Trust Land
 - ◆ USFS, National Forest
 - ◆ Wildlife Reserve
 - ◆ National Park/Monument (NPS)
 - ◆ National Rec. Area
 - ◆ Wilderness
 - ◆ State Park

- Transportation Network**
- Red Knoll Road
 - State / U.S. Highway
 - Local Roads
- Misc**
- City / Town
 - ⋯ Municipalities
 - ⋯ Section = 1 Mile
 - ⊞ Monument Boundary



1:19,454
 1 inch equals 0.3 miles



Map prepared by the State of Utah
 AGRC
 Room 5130 State Office Building
 Salt Lake City, Utah 84114
 May 07, 2007



AFFIDAVIT OF VANE CAMPBELL

RED KNOLL ROAD

COUNTY ROAD NUMBER K1200

KANE COUNTY, UTAH

State of Utah)
 : ss.
County of Kane)

Vane Campbell, being first duly sworn, deposes and states as follows:

1. I am an adult competent to testify about the matters set forth below based upon my personal knowledge. I was born January 4, 1930, in Circleville, UT and moved to Alton, Kane County, Utah when I was two years old and have lived in Alton for the past 74 years. I started to work for the Kane County Road Department in 1967. I left the county in 1970 for other employment and returned to the county road department in 1972 and was made Superintendent of the Kane County Road Department in 1974. I worked for the road department until I retired in 1992.

2. I have traveled and am familiar with a road in Kane County known as the Red Knoll Road. I am also familiar with the land the road traverses. When I first used and observed the road in 1967, it followed the same route as in 1992 when I last observed it. Attached is a Kane County map showing the Red Knoll Road. To the best of my knowledge and based upon my use of and familiarity with this road and the land it traverses, the location and route of the road are correctly illustrated on the attached map. The County also identifies this road according to the road number listed above.

3. I have observed that the road has been open to the public for all to use, to come and go as they pleased, since at least as early as 1967 and continuing through 1976 to 1992. Throughout this time period I have observed travel on the road by various

ENTRY NO. 00139781

06/18/2008 01:58:23 PM B: 0350 P: 0773
Easements and Right of Ways PAGE 11 / 13
VERJEAN CARUSO, KANE COUNTY RECORDER
FEE \$ 0.00 BY GOVERNOR OF UTAH



means, including Kane County road maintenance vehicles, cars, four wheel drive vehicles, ATVs and trucks. Throughout this time period, the road has been used weekly for more than ten continuous years prior to 1976.

4. Throughout the time period from 1967 to 1992, I have used the road myself for performing maintenance on the roads and traveling in and through the area.

5. Throughout the time period described in the previous paragraph, I observed vehicles using the road at various times for the uses described in the previous paragraph, plus hunting, cedar post cutting, oil and gas exploration, hiking, rock hounding, livestock operations.

6. It is also the reputation in the community that this road has been open to the public for all to use, to come and go as they pleased, since at least as early as the late 1960s and continuing through 1976 to the present.

7. Prior to 1976, I personally performed maintenance and construction activities on the road. The lower portion of this road was created in the mid 1970s.

Dated this 15 day of May, 2007.

Vane Campbell
VANE CAMPBELL

SUBSCRIBED AND SWORN to before me this 15th day of May, 2007.

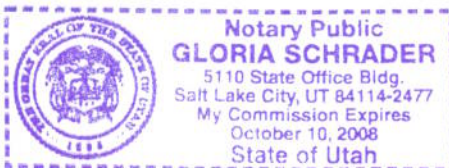

Gloria Schrader
NOTARY PUBLIC

ENTRY NO. 00139781

06/18/2008 01:58:23 PM B: 0350 P: 0774
Easements and Right of Ways PAGE 12 / 13
VERJEAN CARUSO, KANE COUNTY RECORDER
FEE \$ 0.00 BY GOVERNOR OF UTAH



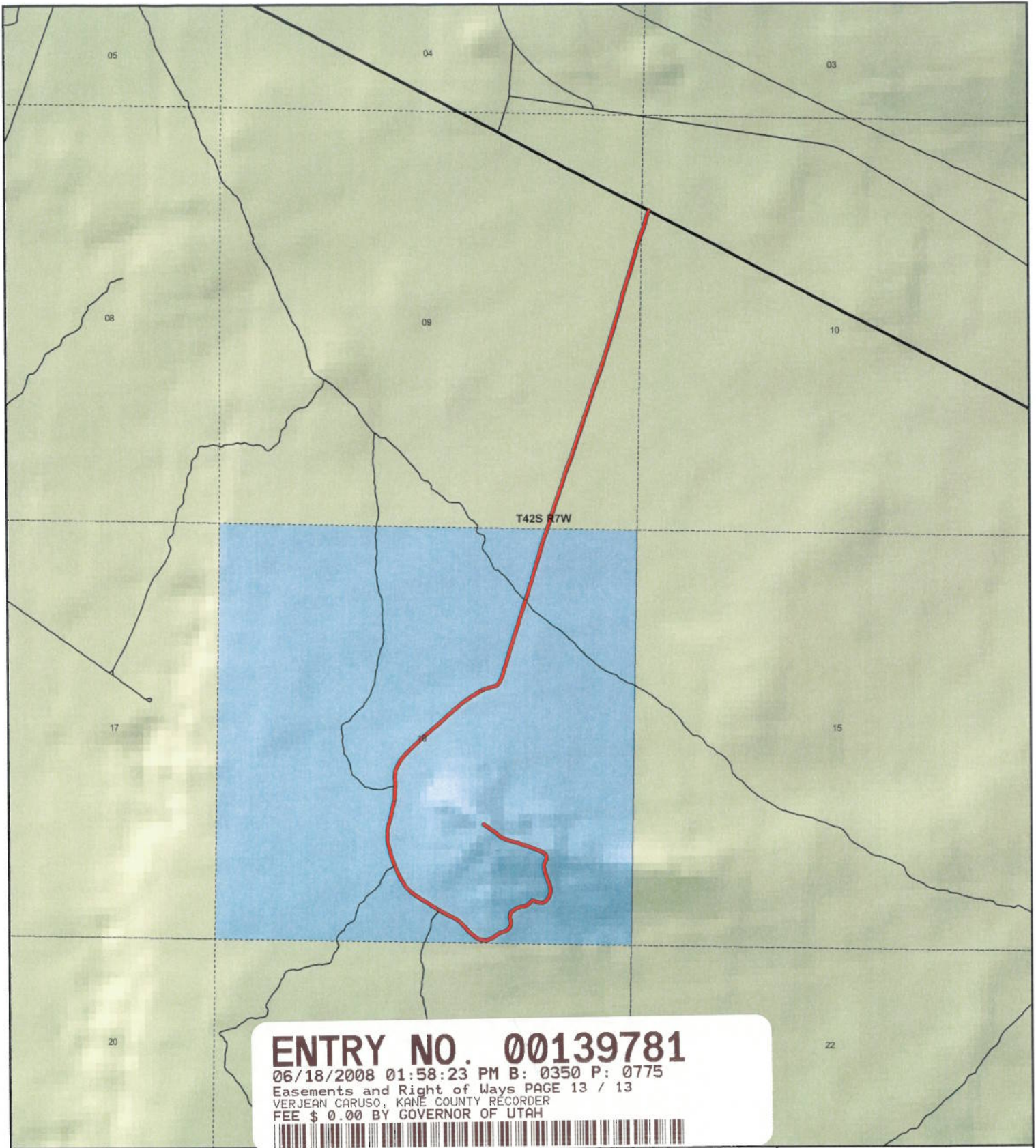

ENTRY NO. 00139781
 06/18/2008 01:58:23 PM B: 0350 P: 0775
 Easements and Right of Ways PAGE 13 / 13
 VERJEAN CARUSO, KANE COUNTY RECORDER
 FEE \$ 0.00 BY GOVERNOR OF UTAH



**Red Knoll Road
 County Unique - K1200**

Land Ownership Categories

- BLM
- Private
- SITLA, State Trust Land
- USFS, National Forest
- Wildlife Reserve
- National Park/Monument (NPS)
- National Rec. Area
- Wilderness
- State Park

Transportation Network

- Red Knoll Road
 - State / U.S. Highway
 - Local Roads
- Misc**
- City / Town
 - Municipalities
 - Section = 1 Mile
 - Monument Boundary

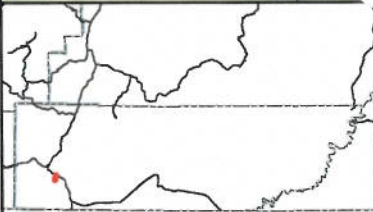

1:19,454
 1 inch equals 0.3 miles



Map prepared by the State of Utah
 AGRC
 Room 5130 State Office Building
 Salt Lake City, Utah 84114
 May 07, 2007



Appendix A to Attachment 4

Popular Name: Red Knoll Road

County: Kane

County Road Number: K1200

State Geographic Information Database (SGID) Road Identification Number: RD130042.

Road-Segment Number: 002

Road-Segment Length: 0.81 miles more or less.

Believed owner of the land underlying this road-segment is: Bureau of Land Management.

The following description is based upon the geographic coordinate system using the NAD83 Datum. The source is GPS mapping grade data as indicated in the metadata and/or the transportation data model of the State of Utah Geographic Information Database (SGID).

The road-segment itself is the monument that is identified by its physical presence on the land. The location of said physical presence is closely approximated by mapping grade Global Positioning System (GPS) data. Said data are checked against the corresponding gray-scale 1-meter Digital Orthophoto Quadrangles published by the United States Geological Survey (USGS) to verify a reasonable degree of accuracy. In circumstances where accurate satellite signal acquisition is not possible, such as deep, narrow canyons or under a canopy of dense foliage, or where very sharp curves in the road make accuracy questionable, such portions of the road were digitized from the corresponding gray-scale 1-meter Digital Orthophoto Quadrangles published by the United States Geological Survey (USGS).

This road-segment may traverse:

Township 42 South Range 7 West, Section(s) 9,10, Salt Lake Base & Meridian

The following description closely approximates the location of the centerline of the physical monument (Red Knoll Road)-- Segment 002 based on mapping grade Global Positioning System (GPS) data as defined above:

Beginning at a point on the road center line located at 37 degrees 09 minutes 57.19 seconds North Latitude and -112 degrees 37 minutes 58.08 seconds West Longitude, which can be converted to mapping accuracy State Plane Utah South Zone NAD 83 feet coordinates of X = 1,310,327.5 feet and Y = 10,026,274.0 feet; thence the following courses along the said road center line:

thence North 26 Degrees 16 Minutes 21 Seconds East	0.1 feet
thence North 17 Degrees 29 Minutes 40 Seconds East	20.2 feet
thence North 17 Degrees 53 Minutes 03 Seconds East	20.7 feet
thence North 17 Degrees 53 Minutes 03 Seconds East	20.7 feet
thence North 16 Degrees 53 Minutes 26 Seconds East	22.3 feet
thence North 16 Degrees 58 Minutes 15 Seconds East	22.3 feet
thence North 18 Degrees 06 Minutes 57 Seconds East	22.4 feet
thence North 17 Degrees 21 Minutes 02 Seconds East	23.3 feet
thence North 17 Degrees 23 Minutes 51 Seconds East	22.4 feet
thence North 18 Degrees 10 Minutes 11 Seconds East	21.7 feet
thence North 17 Degrees 27 Minutes 07 Seconds East	21.5 feet
thence North 17 Degrees 10 Minutes 33 Seconds East	21.5 feet

thence North 17 Degrees 20 Minutes 01 Seconds East 20.6 feet
 thence North 17 Degrees 49 Minutes 39 Seconds East 20.8 feet
 thence North 17 Degrees 53 Minutes 03 Seconds East 20.7 feet
 thence North 18 Degrees 59 Minutes 50 Seconds East 20.9 feet
 thence North 18 Degrees 08 Minutes 32 Seconds East 20.8 feet
 thence North 18 Degrees 08 Minutes 32 Seconds East 20.8 feet
 thence North 19 Degrees 57 Minutes 57 Seconds East 19.2 feet
 thence North 18 Degrees 15 Minutes 42 Seconds East 19.9 feet
 thence North 19 Degrees 14 Minutes 28 Seconds East 20 feet
 thence North 19 Degrees 57 Minutes 57 Seconds East 19.2 feet
 thence North 17 Degrees 59 Minutes 34 Seconds East 19.9 feet
 thence North 18 Degrees 01 Minutes 02 Seconds East 19 feet
 thence North 19 Degrees 18 Minutes 46 Seconds East 18.3 feet
 thence North 20 Degrees 18 Minutes 41 Seconds East 18.4 feet
 thence North 19 Degrees 16 Minutes 01 Seconds East 17.4 feet
 thence North 18 Degrees 08 Minutes 32 Seconds East 18.2 feet
 thence North 18 Degrees 08 Minutes 32 Seconds East 18.2 feet
 thence North 18 Degrees 59 Minutes 50 Seconds East 17.4 feet
 thence North 17 Degrees 53 Minutes 19 Seconds East 16.4 feet
 thence North 16 Degrees 56 Minutes 14 Seconds East 16.3 feet
 thence North 17 Degrees 04 Minutes 07 Seconds East 15.5 feet
 thence North 19 Degrees 08 Minutes 50 Seconds East 14.8 feet
 thence North 18 Degrees 13 Minutes 41 Seconds East 13.8 feet
 thence North 17 Degrees 03 Minutes 41 Seconds East 13.8 feet
 thence North 16 Degrees 28 Minutes 36 Seconds East 12.9 feet
 thence North 17 Degrees 00 Minutes 19 Seconds East 12 feet
 thence North 16 Degrees 06 Minutes 20 Seconds East 12 feet
 thence North 17 Degrees 06 Minutes 17 Seconds East 10.3 feet
 thence North 14 Degrees 57 Minutes 45 Seconds East 9.4 feet
 thence North 17 Degrees 15 Minutes 46 Seconds East 9.5 feet
 thence North 18 Degrees 29 Minutes 07 Seconds East 8.7 feet
 thence North 19 Degrees 08 Minutes 11 Seconds East 9.6 feet
 thence North 19 Degrees 11 Minutes 36 Seconds East 11.3 feet
 thence North 18 Degrees 38 Minutes 50 Seconds East 16.5 feet
 thence North 20 Degrees 30 Minutes 51 Seconds East 21.1 feet
 thence North 20 Degrees 01 Minutes 14 Seconds East 26.3 feet
 thence North 20 Degrees 17 Minutes 13 Seconds East 28 feet
 thence North 20 Degrees 06 Minutes 02 Seconds East 29.8 feet
 thence North 20 Degrees 23 Minutes 46 Seconds East 29.8 feet
 thence North 20 Degrees 16 Minutes 41 Seconds East 29.8 feet
 thence North 19 Degrees 08 Minutes 50 Seconds East 29.6 feet
 thence North 19 Degrees 05 Minutes 14 Seconds East 29.6 feet
 thence North 18 Degrees 43 Minutes 36 Seconds East 29.5 feet
 thence North 18 Degrees 59 Minutes 50 Seconds East 27.8 feet
 thence North 18 Degrees 19 Minutes 46 Seconds East 28.6 feet
 thence North 18 Degrees 52 Minutes 11 Seconds East 27.8 feet
 thence North 19 Degrees 07 Minutes 29 Seconds East 27.8 feet
 thence North 18 Degrees 23 Minutes 09 Seconds East 26.8 feet
 thence North 17 Degrees 14 Minutes 38 Seconds East 25.8 feet

thence North 18 Degrees 15 Minutes 54 Seconds East 24.2 feet
 thence North 19 Degrees 03 Minutes 14 Seconds East 23.5 feet
 thence North 19 Degrees 35 Minutes 03 Seconds East 22.7 feet
 thence North 18 Degrees 14 Minutes 52 Seconds East 22.5 feet
 thence North 17 Degrees 22 Minutes 19 Seconds East 22.4 feet
 thence North 17 Degrees 03 Minutes 04 Seconds East 22.3 feet
 thence North 18 Degrees 02 Minutes 10 Seconds East 22.4 feet
 thence North 17 Degrees 49 Minutes 29 Seconds East 22.5 feet
 thence North 17 Degrees 56 Minutes 58 Seconds East 21.6 feet
 thence North 17 Degrees 21 Minutes 55 Seconds East 20.7 feet
 thence North 17 Degrees 02 Minutes 42 Seconds East 20.6 feet
 thence North 16 Degrees 43 Minutes 46 Seconds East 20.6 feet
 thence North 17 Degrees 06 Minutes 17 Seconds East 20.6 feet
 thence North 16 Degrees 57 Minutes 06 Seconds East 21.5 feet
 thence North 18 Degrees 54 Minutes 44 Seconds East 20.8 feet
 thence North 19 Degrees 15 Minutes 44 Seconds East 21.8 feet
 thence North 18 Degrees 29 Minutes 07 Seconds East 22.5 feet
 thence North 17 Degrees 59 Minutes 21 Seconds East 23.3 feet
 thence North 17 Degrees 54 Minutes 46 Seconds East 23.3 feet
 thence North 18 Degrees 49 Minutes 37 Seconds East 23.4 feet
 thence North 18 Degrees 22 Minutes 16 Seconds East 23.4 feet
 thence North 18 Degrees 48 Minutes 03 Seconds East 22.6 feet
 thence North 19 Degrees 16 Minutes 18 Seconds East 22.6 feet
 thence North 18 Degrees 19 Minutes 37 Seconds East 22.5 feet
 thence North 17 Degrees 54 Minutes 46 Seconds East 23.3 feet
 thence North 18 Degrees 46 Minutes 20 Seconds East 21.7 feet
 thence North 17 Degrees 56 Minutes 58 Seconds East 21.6 feet
 thence North 18 Degrees 04 Minutes 56 Seconds East 19.9 feet
 thence North 17 Degrees 38 Minutes 26 Seconds East 19 feet
 thence North 17 Degrees 39 Minutes 34 Seconds East 17.2 feet
 thence North 18 Degrees 19 Minutes 22 Seconds East 16.4 feet
 thence North 19 Degrees 55 Minutes 55 Seconds East 16.6 feet
 thence North 18 Degrees 32 Minutes 21 Seconds East 16.5 feet
 thence North 17 Degrees 06 Minutes 17 Seconds East 15.5 feet
 thence North 18 Degrees 20 Minutes 18 Seconds East 12.1 feet
 thence North 19 Degrees 42 Minutes 31 Seconds East 8.7 feet
 thence North 20 Degrees 39 Minutes 25 Seconds East 6.1 feet
 thence North 20 Degrees 48 Minutes 28 Seconds East 14.9 feet
 thence North 18 Degrees 43 Minutes 58 Seconds East 25.2 feet
 thence North 19 Degrees 19 Minutes 17 Seconds East 28.7 feet
 thence North 20 Degrees 04 Minutes 29 Seconds East 28 feet
 thence North 18 Degrees 44 Minutes 30 Seconds East 27.8 feet
 thence North 18 Degrees 16 Minutes 01 Seconds East 28.6 feet
 thence North 18 Degrees 50 Minutes 56 Seconds East 26.9 feet
 thence North 18 Degrees 23 Minutes 09 Seconds East 26.8 feet
 thence North 18 Degrees 08 Minutes 32 Seconds East 25.9 feet
 thence North 17 Degrees 52 Minutes 51 Seconds East 25 feet
 thence North 17 Degrees 44 Minutes 54 Seconds East 24.2 feet
 thence North 16 Degrees 54 Minutes 40 Seconds East 23.2 feet

thence North 17 Degrees 15 Minutes 59 Seconds East 22.4 feet
 thence North 17 Degrees 12 Minutes 07 Seconds East 21.5 feet
 thence North 17 Degrees 22 Minutes 19 Seconds East 22.4 feet
 thence North 17 Degrees 08 Minutes 36 Seconds East 23.2 feet
 thence North 17 Degrees 44 Minutes 54 Seconds East 24.2 feet
 thence North 17 Degrees 03 Minutes 40 Seconds East 27.5 feet
 thence North 17 Degrees 11 Minutes 58 Seconds East 28.4 feet
 thence North 16 Degrees 45 Minutes 17 Seconds East 30 feet
 thence North 16 Degrees 04 Minutes 36 Seconds East 31.7 feet
 thence North 17 Degrees 27 Minutes 07 Seconds East 31 feet
 thence North 18 Degrees 13 Minutes 14 Seconds East 30.3 feet
 thence North 18 Degrees 25 Minutes 29 Seconds East 29.4 feet
 thence North 17 Degrees 50 Minutes 27 Seconds East 27.6 feet
 thence North 17 Degrees 06 Minutes 17 Seconds East 25.8 feet
 thence North 16 Degrees 13 Minutes 30 Seconds East 24.8 feet
 thence North 15 Degrees 51 Minutes 40 Seconds East 24.8 feet
 thence North 15 Degrees 20 Minutes 58 Seconds East 24.7 feet
 thence North 16 Degrees 30 Minutes 54 Seconds East 24.9 feet
 thence North 14 Degrees 21 Minutes 10 Seconds East 25.4 feet
 thence North 15 Degrees 46 Minutes 25 Seconds East 25.6 feet
 thence North 17 Degrees 00 Minutes 48 Seconds East 25.8 feet
 thence North 16 Degrees 55 Minutes 02 Seconds East 25.7 feet
 thence North 16 Degrees 48 Minutes 16 Seconds East 25.8 feet
 thence North 16 Degrees 32 Minutes 13 Seconds East 24.8 feet
 thence North 16 Degrees 13 Minutes 30 Seconds East 24.8 feet
 thence North 16 Degrees 04 Minutes 46 Seconds East 24.8 feet
 thence North 15 Degrees 07 Minutes 45 Seconds East 24.7 feet
 thence North 15 Degrees 16 Minutes 43 Seconds East 25.5 feet
 thence North 13 Degrees 45 Minutes 39 Seconds East 26.2 feet
 thence North 14 Degrees 34 Minutes 02 Seconds East 25.5 feet
 thence North 14 Degrees 55 Minutes 24 Seconds East 25.5 feet
 thence North 14 Degrees 25 Minutes 28 Seconds East 25.4 feet
 thence North 15 Degrees 20 Minutes 58 Seconds East 23.9 feet
 thence North 14 Degrees 47 Minutes 49 Seconds East 22.9 feet
 thence North 14 Degrees 14 Minutes 30 Seconds East 22.9 feet
 thence North 14 Degrees 14 Minutes 30 Seconds East 22.9 feet
 thence North 15 Degrees 50 Minutes 19 Seconds East 22.2 feet
 thence North 17 Degrees 59 Minutes 03 Seconds East 116.7 feet
 thence North 16 Degrees 19 Minutes 29 Seconds East 26.5 feet
 thence North 16 Degrees 38 Minutes 36 Seconds East 26.6 feet
 thence North 16 Degrees 32 Minutes 16 Seconds East 27.4 feet
 thence North 17 Degrees 31 Minutes 16 Seconds East 25.8 feet
 thence North 16 Degrees 56 Minutes 55 Seconds East 24.9 feet
 thence North 16 Degrees 37 Minutes 53 Seconds East 24 feet
 thence North 18 Degrees 26 Minutes 38 Seconds East 21.7 feet
 thence North 17 Degrees 21 Minutes 54 Seconds East 20.7 feet
 thence North 17 Degrees 27 Minutes 06 Seconds East 19.8 feet
 thence North 16 Degrees 57 Minutes 19 Seconds East 18 feet
 thence North 15 Degrees 15 Minutes 10 Seconds East 18.7 feet

thence North 15 Degrees 26 Minutes 45 Seconds East 18.8 feet
 thence North 15 Degrees 20 Minutes 58 Seconds East 18.7 feet
 thence North 14 Degrees 57 Minutes 44 Seconds East 18.7 feet
 thence North 14 Degrees 22 Minutes 44 Seconds East 18.7 feet
 thence North 13 Degrees 41 Minutes 39 Seconds East 18.6 feet
 thence North 14 Degrees 26 Minutes 04 Seconds East 17.8 feet
 thence North 14 Degrees 42 Minutes 35 Seconds East 17 feet
 thence North 14 Degrees 23 Minutes 19 Seconds East 17 feet
 thence North 16 Degrees 03 Minutes 19 Seconds East 15.4 feet
 thence North 15 Degrees 56 Minutes 17 Seconds East 15.4 feet
 thence North 17 Degrees 34 Minutes 26 Seconds East 14.7 feet
 thence North 16 Degrees 34 Minutes 20 Seconds East 16.3 feet
 thence North 17 Degrees 47 Minutes 51 Seconds East 15.5 feet
 thence North 16 Degrees 54 Minutes 11 Seconds East 16.3 feet
 thence North 17 Degrees 13 Minutes 57 Seconds East 16.3 feet
 thence North 18 Degrees 22 Minutes 56 Seconds East 17.3 feet
 thence North 17 Degrees 20 Minutes 52 Seconds East 17.2 feet
 thence North 18 Degrees 22 Minutes 56 Seconds East 17.3 feet
 thence North 18 Degrees 59 Minutes 50 Seconds East 17.4 feet
 thence North 19 Degrees 36 Minutes 46 Seconds East 16.6 feet
 thence North 21 Degrees 16 Minutes 32 Seconds East 15 feet
 thence North 19 Degrees 10 Minutes 11 Seconds East 13.9 feet
 thence North 18 Degrees 48 Minutes 02 Seconds East 0.9 feet
 thence North 21 Degrees 38 Minutes 58 Seconds East 12.4 feet
 thence North 19 Degrees 49 Minutes 03 Seconds East 11.4 feet
 thence North 18 Degrees 53 Minutes 42 Seconds East 8.7 feet
 thence North 25 Degrees 20 Minutes 53 Seconds East 5.5 feet
 thence North 20 Degrees 10 Minutes 46 Seconds East 5.3 feet
 thence North 19 Degrees 20 Minutes 12 Seconds East 10.5 feet
 thence North 19 Degrees 11 Minutes 35 Seconds East 11.3 feet
 thence North 19 Degrees 50 Minutes 36 Seconds East 10.5 feet
 thence North 18 Degrees 23 Minutes 30 Seconds East 9.5 feet
 thence North 16 Degrees 24 Minutes 23 Seconds East 6.9 feet
 thence North 16 Degrees 11 Minutes 45 Seconds East 4.3 feet
 thence North 19 Degrees 05 Minutes 57 Seconds East 4.3 feet
 thence North 16 Degrees 24 Minutes 23 Seconds East 8.6 feet
 thence North 16 Degrees 19 Minutes 31 Seconds East 11.1 feet
 thence North 14 Degrees 57 Minutes 00 Seconds East 13.6 feet
 thence North 15 Degrees 20 Minutes 57 Seconds East 13.6 feet
 thence North 14 Degrees 33 Minutes 47 Seconds East 14.5 feet
 thence North 14 Degrees 37 Minutes 48 Seconds East 14.4 feet
 thence North 13 Degrees 42 Minutes 42 Seconds East 14.4 feet
 thence North 15 Degrees 20 Minutes 57 Seconds East 13.6 feet
 thence North 15 Degrees 12 Minutes 59 Seconds East 13.6 feet
 thence North 16 Degrees 11 Minutes 45 Seconds East 12.8 feet
 thence North 19 Degrees 21 Minutes 39 Seconds East 12.2 feet
 thence North 20 Degrees 47 Minutes 58 Seconds East 12.3 feet
 thence North 24 Degrees 58 Minutes 28 Seconds East 9.1 feet
 thence North 22 Degrees 22 Minutes 52 Seconds East 8 feet

thence North 25 Degrees 36 Minutes 49 Seconds East 6.4 feet
thence North 27 Degrees 10 Minutes 53 Seconds East 5.5 feet
thence North 24 Degrees 05 Minutes 36 Seconds East 5.4 feet
thence North 26 Degrees 27 Minutes 19 Seconds East 4.6 feet
thence North 26 Degrees 22 Minutes 26 Seconds East 8.3 feet more or less to **the ending point**
at: 37 degrees 10 minutes 37.38 seconds North Latitude and -112 degrees 37 minutes 42.74 seconds West
Longitude, which can be converted to mapping accuracy State Plane Utah South Zone NAD 83 feet
coordinates of X = 1,311,618.3 feet and Y = 10,030,323.7 feet.