

**Acknowledgment and
Notice of Acknowledgment
of Acceptance of R.S. 2477
Right-of-Way Grant**



THE STATE OF UTAH

TO ALL WHOM THESE PRESENTS SHALL COME, Greeting:

Know ye, This is an Acknowledgment and Notice of Acknowledgment made under Utah Code Sections 72-5-309 through 310 inclusive, that the grant of the United States of America of “the right of way for the construction of highways over public lands, not reserved for public uses” under United States Revised Statutes 2477 (43 U.S.C. Section 932 (repealed October 21, 1976, with proviso recognizing the validity of rights-of-way already established)) was accepted for and on behalf of the State of Utah and its political subdivision Millard County as it pertains to the highway located in Millard County known as Fields Road; County Road Number: MC1152; State Geographic Information Database (SGID) Road Identification Number: RD140187. Total road length is 3.64 miles more or less.

The reason for this Acknowledgment and Notice of Acknowledgment includes, but is not limited to, the fact that the road was constructed, mechanically, or by continuous use as a public highway for a period of at least ten years, over public lands not reserved for public uses, prior to the earlier of (a) the October 21, 1976 repeal of R.S. 2477 or (b) the date the servient estate was reserved for public uses.

This Acknowledgment and Notice of Acknowledgment applies only to the segments of the road that traverse land owned by the Bureau of Land Management, United States Department of the Interior, and does not apply to segments of the road that traverse land owned by any other person or entity. The State of Utah and its political subdivisions reserve the right to make further acknowledgments and notices of acknowledgment with regard to road segments that traverse land owned by other entities, including the United States of America, through one or more of its agencies.

A printed copy of a map showing the location of the road in said county is appended hereto as “Attachment 1,” a printed copy of representative photos of the road is appended hereto as “Attachment 2,” a printed copy of a description of the beginning and ending points of the entire road together with a list of Townships, Ranges and Sections that may be traversed by the road in said county is appended hereto as “Attachment 3,” and a printed copy of the Road Centerline Description Cover Page(s) is appended hereto as “Attachment 4.” The Appendices listed in “Attachment 4” that contain the actual road centerline descriptions are incorporated herein by reference. Affidavits provided by individuals familiar with the road are appended hereto as “Attachment 5.”

A printed copy of this Acknowledgment and Notice of Acknowledgment, together with its Attachments and Appendices, may be viewed and/or obtained at the office of the Utah State Archives.

An electronic copy of this Acknowledgment and Notice of Acknowledgment, together with its Attachments and Appendices, may be viewed and/or downloaded as read-only PDF (Portable Document Format) files via the

Internet at <http://recorded2477roads.utah.gov>.

The owner of the servient estate in the land underlying the road-segments subject to this Acknowledgment and Notice is believed to be the United States of America through one or more of its agencies. Any of such agencies or any other person with a servient ownership claim or a competing dominant estate right-of-way ownership claim, may file a petition in the State District Court for Salt Lake County for a decision regarding the correctness of this Acknowledgment. A claimant shall file a petition within sixty (60) days after receipt of this Notice.

In Witness Whereof, I, John Harja, the official designee of the Governor of the State of Utah, in conformity to the laws of the State (Utah Code Sections 72-5-308 through 310 inclusive), have caused this Acknowledgment and Notice of Acknowledgment to be made.

Signed by my hand in Salt Lake City, Utah, the 23rd day of April, 2008.

By the Governor's Designee



John Harja

CERTIFICATION

State of Utah)
: ss
County of Salt Lake)

I hereby certify that the signer of the foregoing document, John Harja, is personally known by me, has made a voluntary signature and taken an oath stating that he is the official designee of the Governor of the State of Utah and is authorized to sign this document on the Governor's behalf pursuant to Utah Code Section 72-5-309. He further vouched that, based upon information and belief, the facts alleged therein are true.

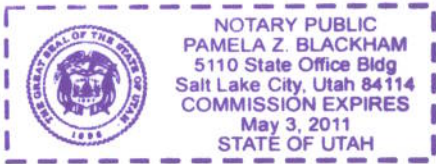
Dated this 23rd day of April, 2008.





Notary Public

00165721

B: 484 P: 744 Fee \$0.00
Connie Hansen, Millard Recorder Page 2 of 13
05/14/2008 09:18:55 AM By UT STATE GOVERNOR

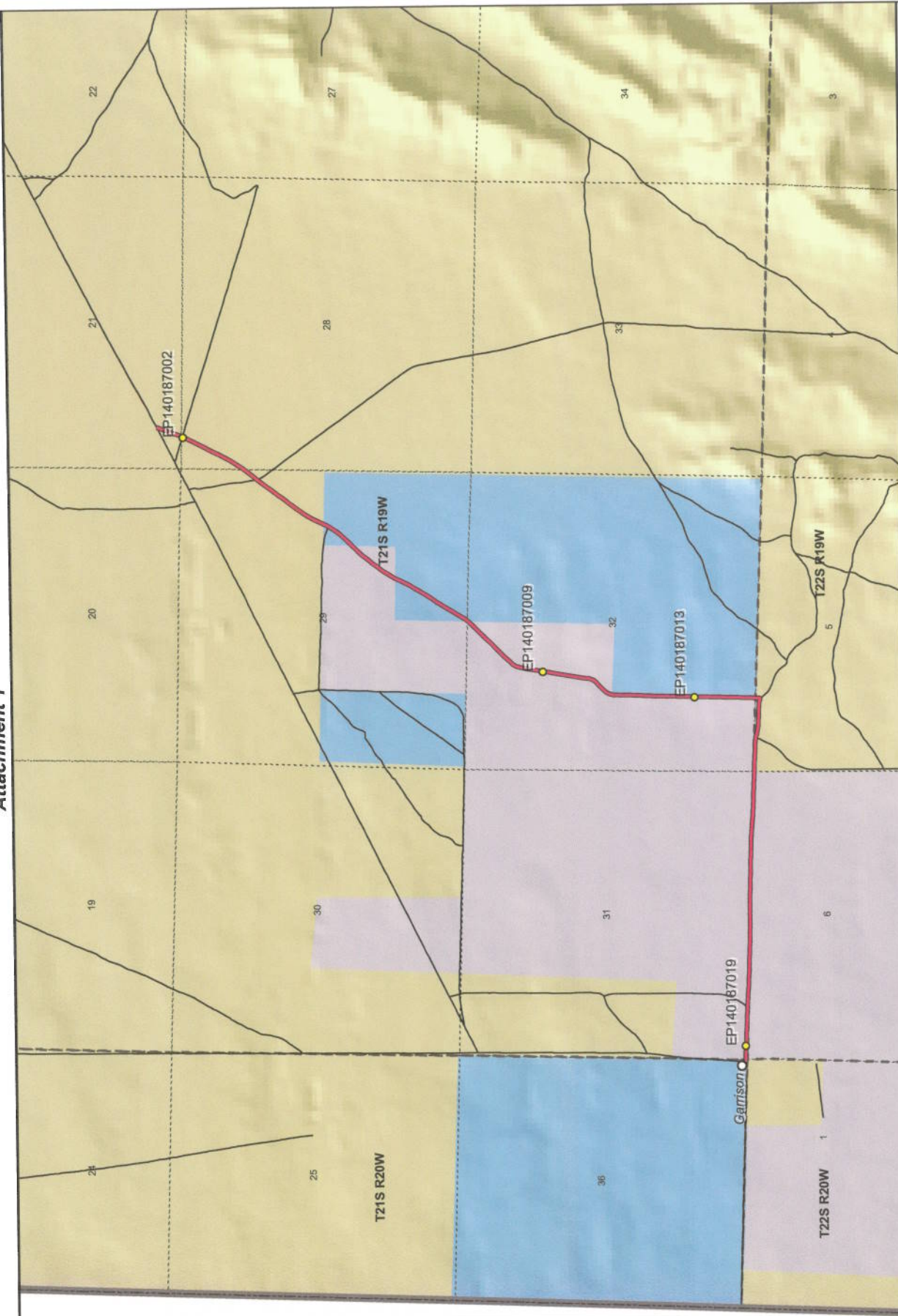



Map prepared by the State of Utah
 Automated Geographic Reference Center
 Room 5130 State Office Building
 Salt Lake City, Utah 84114
 Nov 23, 2008

Fields Road - Millard County SGID RD_ID RD140187

Land Ownership Categories

- BLM
- Private
- SITLA, State Trust Land
- USFS, National Forest
- State Parks and Recreation
- Tribal, Indian Reservation
- NPS, National Park
- Wilderness
- UDWR Wildlife Reserve
- DOD, Military
- State Sovereign Land
- National Recreation Area
- USFWS, Natl. Wildlife Refuge

Transportation Network

- Fields Road
- Other Roads
- Title V, Issued Or Under Consideration By BLM Or County
- Photo Event Point

Section = 1 Mile

1:30,950
 1 inch equals 0.5 miles

00165721

B: 484 P: 745 Fee \$0.00 Page 3 of 13
 Connie Hansen, Millard Recorder
 05/14/2008 09:18:55 AM By UT STATE GOVERNOR



Attachment 2



EP140187009



EP140187013



EP140187002



EP140187019

00165721

B: 484 P: 746 Fee \$0.00 Page 4 of 13
Connie Hansen, Millard Recorder
05/14/2008 09:18:55 AM By UT STATE GOVERNOR



EP000000000

EP000000000

Fields Road - Millard County
SGID RD_ID RD140187

Map prepared by the State of Utah
Automated Geographic Reference Center
Room 5130 State Office Building
Salt Lake City, Utah 84114
November 22, 2006



Attachment 3

Beginning & Ending Points and Township, Range, and Section References For:

Popular Name: Fields Road

County: Millard

County Road Number: MC1152

State Geographic Information Database (SGID) Road Identification Number: RD140187.

Total Road Length: 3.64 miles more or less.

Beginning at a point on the road centerline located at 38 degrees 56 minutes 26.48 seconds North Latitude and -114 degrees 02 minutes 00.43 seconds West Longitude, which can be converted to mapping accuracy State Plane Utah Central Zone NAD 83 feet coordinates of X = 919,873.3 feet and Y = 6,793,097.4 feet based on the US Survey Foot conversion.

Ending at a point on the road centerline located at 38 degrees 58 minutes 15.75 seconds North Latitude and -113 degrees 59 minutes 36.64 seconds West Longitude, which can be converted to mapping accuracy State Plane Utah Central Zone NAD 83 feet coordinates of X = 931,539.0 feet and Y = 6,803,829.6 feet based on the US Survey Foot conversion.

This road may traverse:

Township 21 South Range 19 West, Section(s) 21,28,29,31,32, Salt Lake Base & Meridian

Township 21 South Range 20 West, Section(s) 36, Salt Lake Base & Meridian

Township 22 South Range 19 West, Section(s) 5, Salt Lake Base & Meridian

See Attachment 1 above for a cartographic depiction of the course of this road.

00165721

B: 484 P: 747 Fee \$0.00

Connie Hansen, Millard Recorder

05/14/2008 09:18:55 AM

Page 5 of 13

By UT STATE GOVERNOR



Attachment 4
Road Centerline Description Cover Page(s)

Popular Name: Fields Road

County: Millard

County Road Number: MC1152

State Geographic Information Database (SGID) Road Identification Number: RD140187.

Total Road Length: 3.64 miles more or less.

Centerline Descriptions Of Road-Segments That Cross Over Federally Owned Land, Derived From Global Positioning System Data And Cross-checked against USGS Digital Orthophoto Quadrangles Compiled By The Utah Automated Geographic Reference Center And Entered Into The State Geographic Information Database (SGID).

Road-Segments Listed by SGID Road Identification Number (RD ID)	Road-Segment Numbers	Believed Ownership Of Servient Estate	Approximate Segment Length	See Attached Appendix
RD140187	001	ST	0.01 Miles	(not shown)
RD140187	002	PVT	1 Miles	(not shown)
RD140187	003	BLM	0.27 Miles	A
RD140187	004	ST	0.51 Miles	(not shown)
RD140187	005	PVT	0.58 Miles	(not shown)
RD140187	006	ST	0.3 Miles	(not shown)
RD140187	007	PVT	0.19 Miles	(not shown)
RD140187	008	ST	0.13 Miles	(not shown)
RD140187	009	BLM	0.67 Miles	B
		Total Road Length	3.64	_____

* Indicates that a Title V permit will be requested, is in process, or has been issued.

† Indicates that road-segments crossing Forest Service land are under consideration by the state and county as of the date of this Acknowledgment and Notice of Acknowledgment.

00165721

B: 484 P: 748 Fee \$0.00
Connie Hansen, Millard Recorder
05/14/2008 09:18:55 AM

By UT STATE GOVERNOR Page 6 of 13



Attachment 5

00165721

B: 484 P: 749 Fee \$0.00 Page 7 of 13
Connie Hansen, Millard Recorder
05/14/2008 09:18:55 AM By UT STATE GOVERNOR



AFFIDAVIT OF JAY ATKINSON

FIELDS ROAD

MILLARD COUNTY, UTAH

ROAD NUMBER MC 1152

State of Utah)
 : ss.
County of Millard)

JAY ATKINSON, being first duly sworn, deposes and states as follows:

1. I am an adult competent to testify about the matters set forth below based upon my personal knowledge. I currently reside in Millard County, Utah. I have lived in Millard County for sixty-eight years. I was an employee of the Millard County Road Department from February of 1970 to April of 2000, and participated in maintenance of the road during that time.

2. I have traveled and am familiar with a road in Millard County known as Fields Road. I am also familiar with the land the road traverses. When I first used and observed the road in the early 1940s, it followed the same route as in 2000 when I last observed it. Attached is a Millard County map showing Fields Road. To the best of my knowledge and based upon my use of and familiarity with this road and the land it traverses, the location and route of the road are correctly illustrated on the attached map.

3. I am informed that the County also identifies this road according to the road number listed above.

4. I have observed that the road has been open to the public for all to use, to come and go as they pleased, since at least as early as the early 1940s and continuing through 1976 to 2000. Throughout this time period I have observed travel on the road by various means, including cars, trucks, recreational vehicles, and pickup trucks. Throughout this time period, the road has been used daily for more than ten continuous years prior to 1976, and was so used through 2000.

00165721

B: 484 P: 750 Fee \$0.00

Connie Hansen, Millard Recorder

05/14/2008 09:18:55 AM

By UT STATE GOVERNOR

Page 8 of 13



5. Throughout the time period from the early 1940s to 2000, I have used the road myself for the following uses: hunting, rock hounding, county road work and recreation.

6. Throughout the time period described in the previous paragraph, I observed other vehicles from the general public using the road at various times for the uses described in the previous paragraph, plus the following uses: livestock operations, farming, traveling in and through the area, trapping, government access, picnicking, hiking and sightseeing.

7. It is also the reputation in the community that this road has been open to the public for all to use, to come and go as they pleased, since at least as early as the early 1940s and continuing through 1976 to the present, for the uses described in the previous paragraphs.

8. Prior to 1976, I participated in maintenance and construction activities on the road. Construction and maintenance have been performed since the early 1950s by Millard County Road Department.

DATED this 6 day of December, 2006.

Jay Atkinson
JAY ATKINSON

SUBSCRIBED AND SWORN to before me this 6th day of December, 2006.

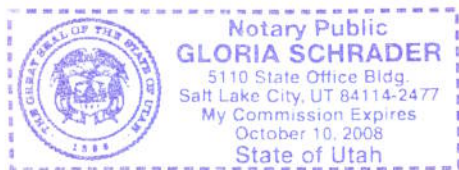

Gloria Schrader
NOTARY PUBLIC

00165721

B: 484 P: 751 Fee \$0.00 Page 9 of 13
Connie Hansen, Millard Recorder
05/14/2008 09:18:55 AM By UT STATE GOVERNOR



ROAD = MC1152
FIELDS ROAD

Garrison

1

00165721
B: 484 P: 752 Fee \$0.00
Connie Hansen, Millard Recorder
05/14/2008 09:18:55 AM By UT STATE GOVERNOR
Page 10 of 13

M I L L A R D C O U N T Y

-  B Class Road of Interest
-  Interstate
-  Highway Major
-  Highway Minor
-  B Class Road
-  Unimproved Road
-  County Border
-  River
-  Cities / Towns
-  Lakes
-  Lakes - Intermittent
-  Township & Range Line
-  Forest Service Lands
-  BLM Lands
-  State Trust Lands
-  Private Lands

0 0.050 0.1
Miles

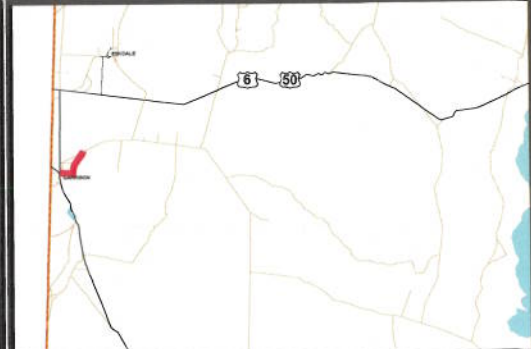

AFFIDAVIT OF WILLIAM THAYNE HENRIE

FIELDS ROAD

MILLARD COUNTY, UTAH

ROAD NUMBER MC1152

State of Utah)
 : ss.
County of Millard)

WILLIAM THAYNE HENRIE, being first duly sworn, deposes and states as follows:

1. I am an adult competent to testify about the matters set forth below based upon my personal knowledge. I currently reside in Millard County, Utah. I have lived in Millard County for fifty-eight years. I have been an employee of the Millard County Road Department since June of 1990, have been the Road Department Supervisor from January 1993 to the present and have participated in maintenance of the road during that time.

2. I have traveled and am familiar with a road in Millard County known as Fields Road. I am also familiar with the land the road traverses. When I first used and observed the road in the 1950s, it followed the same route as in 2006 when I last observed it. Attached is a Millard County map showing Fields Road. To the best of my knowledge and based upon my use of and familiarity with this road and the land it traverses, the location and route of the road are correctly illustrated on the attached map.

3. I am informed that the County also identifies this road according to the road number listed above.

4. I have observed that the road has been open to the public for all to use, to come and go as they pleased, since at least as early as the 1950s and continuing through 1976 to the present. Throughout this time period I have observed travel on the road by means of cars, trucks, recreational vehicles, and pickup trucks. Throughout this time period, the road has been used daily for more than ten continuous years prior to 1976, and is presently used daily.

00165721

B: 484 P: 753 Fee \$0.00
Connie Hansen, Millard Recorder
05/14/2008 09:18:55 AM By UT STATE GOVERNOR Page 11 of 13



5. Throughout the time period from the 1950s to the present, I have used the road myself for camping, hunting, rock hounding, participating in search and rescue efforts and recreation.

6. Throughout the time period described in the previous paragraph, I have observed other vehicles from the general public using the road at various times for the uses described in the previous paragraph, plus mining, prospecting for minerals, livestock operations, farming, trapping, tourism, government access, picnicking, hiking and sightseeing.

7. It is also the reputation in the community that this road has been open to the public for all to use, to come and go as they pleased, since at least as early as the early 1900s and continuing through 1976 to the present, for the uses described in the previous paragraphs.

8. Prior to 1976 I observed graders and other maintenance equipment performing maintenance and construction activities on the road. Maintenance on the road has been performed since 1955 by the Millard County Road Department.

DATED this 5 day of December, 2006.

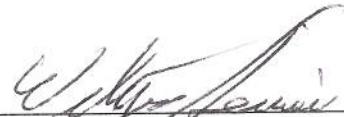

WILLIAM THAYNE HENRIE

SUBSCRIBED AND SWORN to before me this 5th day of December, 2006.

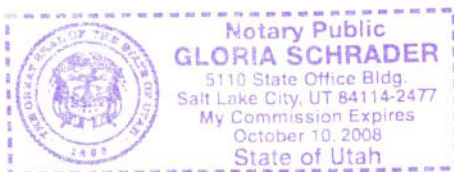



NOTARY PUBLIC

00165721

B: 484 P: 754 Fee \$0.00 Page 12 of 13
Connie Hansen, Millard Recorder
05/14/2008 09:18:55 AM By UT STATE GOVERNOR



ROAD = MC1152
FIELDS ROAD

Garrison

1

00165721

B: 484 P: 755 Fee \$0.00
Connie Hansen, Millard Recorder
05/14/2008 09:18:55 AM By UT STATE GOVERNOR Page 13 of 13



M I L L A R D C O U N T Y

— B Class Road of Interest

- | | | |
|-------------------|------------------------|-------------------------|
| — Interstate | — County Border | — Township & Range Line |
| — Highway Major | — River | — Forest Service Lands |
| — Highway Minor | — Cities / Towns | — BLM Lands |
| — B Class Road | — Lakes | — State Trust Lands |
| — Unimproved Road | — Lakes - Intermittent | — Private Lands |

0 0 0 0 0 0 0 1

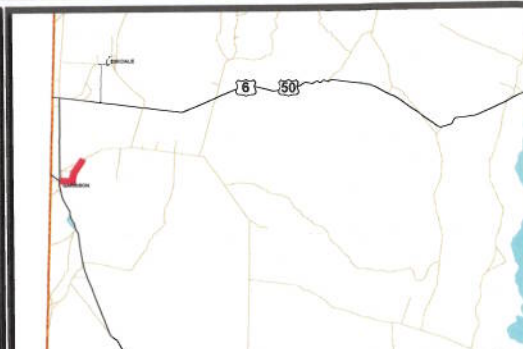

Appendix A to Attachment 4

Popular Name: Fields Road

County: Millard

County Road Number: MC1152

State Geographic Information Database (SGID) Road Identification Number: RD140187.

Road-Segment Number: 003

Road-Segment Length: 0.27 miles more or less.

Believed owner of the land underlying this road-segment is: Bureau of Land Management.

The following description is based upon the geographic coordinate system using the NAD83 Datum. The source is GPS mapping grade data as indicated in the metadata and/or the transportation data model of the State of Utah Geographic Information Database (SGID).

The road-segment itself is the monument that is identified by its physical presence on the land. The location of said physical presence is closely approximated by mapping grade Global Positioning System (GPS) data. Said data are checked against the corresponding gray-scale 1-meter Digital Orthophoto Quadrangles published by the United States Geological Survey (USGS) to verify a reasonable degree of accuracy. In circumstances where accurate satellite signal acquisition is not possible, such as deep, narrow canyons or under a canopy of dense foliage, or where very sharp curves in the road make accuracy questionable, such portions of the road were digitized from the corresponding gray-scale 1-meter Digital Orthophoto Quadrangles published by the United States Geological Survey (USGS).

This road-segment may traverse:

Township 21 South Range 19 West, Section(s) 32, Salt Lake Base & Meridian

Township 22 South Range 19 West, Section(s) 5, Salt Lake Base & Meridian

The following description closely approximates the location of the centerline of the physical monument (Fields Road)-- Segment 003 based on mapping grade Global Positioning System (GPS) data as defined above:

Beginning at a point on the road center line located at 38 degrees 56 minutes 26.23 seconds North Latitude and -114 degrees 00 minutes 53.25 seconds West Longitude, which can be converted to mapping accuracy State Plane Utah Central Zone NAD 83 feet coordinates of X = 925,179.1 feet and Y = 6,792,922.4 feet; thence the following courses along the said road center line:

thence South 88 Degrees 18 Minutes 36 Seconds East 9.5 feet
thence South 87 Degrees 42 Minutes 21 Seconds East 72.9 feet
thence South 88 Degrees 34 Minutes 43 Seconds East 77.1 feet
thence South 88 Degrees 14 Minutes 22 Seconds East 73.5 feet
thence South 88 Degrees 08 Minutes 02 Seconds East 69.9 feet
thence South 87 Degrees 40 Minutes 09 Seconds East 64.7 feet
thence South 87 Degrees 49 Minutes 19 Seconds East 61.1 feet
thence South 85 Degrees 42 Minutes 39 Seconds East 49.3 feet
thence South 89 Degrees 37 Minutes 35 Seconds East 28.5 feet
thence South 89 Degrees 14 Minutes 36 Seconds East 72.2 feet
thence South 83 Degrees 42 Minutes 11 Seconds East 8.6 feet

thence South 77 Degrees 07 Minutes 38 Seconds East 25.9 feet
thence South 75 Degrees 45 Minutes 02 Seconds East 9.1 feet
thence South 77 Degrees 09 Minutes 03 Seconds East 10.1 feet
thence South 72 Degrees 52 Minutes 23 Seconds East 58.1 feet
thence South 76 Degrees 46 Minutes 30 Seconds East 51.9 feet
thence South 78 Degrees 48 Minutes 26 Seconds East 65.9 feet
thence South 85 Degrees 29 Minutes 57 Seconds East 70.8 feet
thence South 86 Degrees 59 Minutes 56 Seconds East 68.7 feet
thence South 88 Degrees 57 Minutes 32 Seconds East 70.9 feet
thence South 87 Degrees 53 Minutes 11 Seconds East 62.7 feet
thence South 87 Degrees 34 Minutes 17 Seconds East 69.3 feet
thence South 88 Degrees 24 Minutes 41 Seconds East 70.2 feet
thence South 85 Degrees 43 Minutes 23 Seconds East 61.8 feet
thence South 66 Degrees 29 Minutes 24 Seconds East 45.5 feet
thence North 79 Degrees 20 Minutes 55 Seconds East 27.3 feet
thence North 07 Degrees 50 Minutes 42 Seconds East 9.3 feet
thence North 00 Degrees 45 Minutes 23 Seconds East 36.1 feet
thence North 01 Degrees 18 Minutes 21 Seconds East 11.8 feet more or less to **the ending**

point at: 38 degrees 56 minutes 026.1 seconds North Latitude and -114 degrees 00 minutes 036.2 seconds West Longitude, which can be converted to mapping accuracy State Plane Utah Central Zone NAD 83 feet coordinates of X = 926,524.9 feet and Y = 6,792,871.7 feet.

Appendix B to Attachment 4

Popular Name: Fields Road

County: Millard

County Road Number: MC1152

State Geographic Information Database (SGID) Road Identification Number: RD140187.

Road-Segment Number: 009

Road-Segment Length: 0.67 miles more or less.

Believed owner of the land underlying this road-segment is: Bureau of Land Management.

The following description is based upon the geographic coordinate system using the NAD83 Datum. The source is GPS mapping grade data as indicated in the metadata and/or the transportation data model of the State of Utah Geographic Information Database (SGID).

The road-segment itself is the monument that is identified by its physical presence on the land. The location of said physical presence is closely approximated by mapping grade Global Positioning System (GPS) data. Said data are checked against the corresponding gray-scale 1-meter Digital Orthophoto Quadrangles published by the United States Geological Survey (USGS) to verify a reasonable degree of accuracy. In circumstances where accurate satellite signal acquisition is not possible, such as deep, narrow canyons or under a canopy of dense foliage, or where very sharp curves in the road make accuracy questionable, such portions of the road were digitized from the corresponding gray-scale 1-meter Digital Orthophoto Quadrangles published by the United States Geological Survey (USGS).

This road-segment may traverse:

Township 21 South Range 19 West, Section(s) 21,28,29, Salt Lake Base & Meridian

The following description closely approximates the location of the centerline of the physical monument (Fields Road)-- Segment 009 based on mapping grade Global Positioning System (GPS) data as defined above:

Beginning at a point on the road center line located at 38 degrees 57 minutes 45.22 seconds North Latitude and -113 degrees 59 minutes 58.18 seconds West Longitude, which can be converted to mapping accuracy State Plane Utah Central Zone NAD 83 feet coordinates of X = 929,752.1 feet and Y = 6,800,789.1 feet; thence the following courses along the said road center line:

thence North 24 Degrees 25 Minutes 52 Seconds East	45.5 feet
thence North 24 Degrees 43 Minutes 50 Seconds East	86.9 feet
thence North 25 Degrees 15 Minutes 54 Seconds East	82.9 feet
thence North 28 Degrees 48 Minutes 51 Seconds East	79.6 feet
thence North 30 Degrees 49 Minutes 10 Seconds East	90.8 feet
thence North 34 Degrees 57 Minutes 33 Seconds East	97.2 feet
thence North 35 Degrees 45 Minutes 23 Seconds East	90.9 feet
thence North 36 Degrees 25 Minutes 10 Seconds East	91.6 feet
thence North 37 Degrees 29 Minutes 01 Seconds East	62.6 feet
thence North 37 Degrees 07 Minutes 09 Seconds East	35.1 feet
thence North 37 Degrees 13 Minutes 40 Seconds East	105 feet
thence North 36 Degrees 35 Minutes 01 Seconds East	106.6 feet

thence North 36 Degrees 30 Minutes 09 Seconds East 92.5 feet
 thence North 36 Degrees 19 Minutes 15 Seconds East 85.8 feet
 thence North 35 Degrees 56 Minutes 05 Seconds East 92.7 feet
 thence North 36 Degrees 08 Minutes 26 Seconds East 93.3 feet
 thence North 38 Degrees 04 Minutes 52 Seconds East 80.3 feet
 thence North 38 Degrees 22 Minutes 24 Seconds East 42 feet
 thence North 38 Degrees 55 Minutes 15 Seconds East 32.2 feet
 thence North 38 Degrees 19 Minutes 23 Seconds East 58.3 feet
 thence North 37 Degrees 58 Minutes 59 Seconds East 75.2 feet
 thence North 35 Degrees 28 Minutes 55 Seconds East 85.3 feet
 thence North 36 Degrees 35 Minutes 01 Seconds East 3.3 feet
 thence North 35 Degrees 48 Minutes 29 Seconds East 82.4 feet
 thence North 34 Degrees 22 Minutes 51 Seconds East 85.3 feet
 thence North 34 Degrees 42 Minutes 20 Seconds East 76.1 feet
 thence North 31 Degrees 48 Minutes 58 Seconds East 82.1 feet
 thence North 29 Degrees 02 Minutes 12 Seconds East 88.4 feet
 thence North 28 Degrees 42 Minutes 26 Seconds East 90 feet
 thence North 27 Degrees 06 Minutes 27 Seconds East 91.2 feet
 thence North 26 Degrees 16 Minutes 43 Seconds East 90.9 feet
 thence North 25 Degrees 58 Minutes 58 Seconds East 85.2 feet
 thence North 26 Degrees 55 Minutes 47 Seconds East 77.4 feet
 thence North 27 Degrees 19 Minutes 36 Seconds East 72.2 feet
 thence North 27 Degrees 03 Minutes 48 Seconds East 64.2 feet
 thence North 28 Degrees 15 Minutes 54 Seconds East 50.8 feet
 thence North 28 Degrees 37 Minutes 44 Seconds East 39.3 feet
 thence North 26 Degrees 29 Minutes 32 Seconds East 39.3 feet
 thence North 27 Degrees 05 Minutes 43 Seconds East 72 feet
 thence North 27 Degrees 35 Minutes 08 Seconds East 77.2 feet
 thence North 25 Degrees 09 Minutes 41 Seconds East 52.7 feet
 thence North 21 Degrees 30 Minutes 54 Seconds East 23 feet
 thence North 22 Degrees 20 Minutes 00 Seconds East 21.3 feet
 thence North 19 Degrees 46 Minutes 10 Seconds East 22 feet
 thence North 19 Degrees 59 Minutes 46 Seconds East 64.3 feet
 thence North 19 Degrees 02 Minutes 12 Seconds East 107 feet
 thence North 21 Degrees 04 Minutes 36 Seconds East 103.5 feet
 thence North 21 Degrees 05 Minutes 03 Seconds East 89.1 feet
 thence North 20 Degrees 00 Minutes 09 Seconds East 57.7 feet
 thence North 22 Degrees 43 Minutes 20 Seconds East 26 feet more or less to **the ending point**

at: 38 degrees 58 minutes 15.75 seconds North Latitude and -113 degrees 59 minutes 36.64 seconds West Longitude, which can be converted to mapping accuracy State Plane Utah Central Zone NAD 83 feet coordinates of X = 931,539.0 feet and Y = 6,803,829.6 feet.