

**Acknowledgment and
Notice of Acknowledgment
of Acceptance of R.S. 2477
Right-of-Way Grant**

00166655

B: 490 P: 386 Fee \$0.00
Connie Hansen, Millard Recorder
07/16/2008 09:31:25 AM By UT STATE GOVERNOR Page 1 of 13



THE STATE OF UTAH

TO ALL WHOM THESE PRESENTS SHALL COME, Greeting:

Know ye, This is an Acknowledgment and Notice of Acknowledgment made under Utah Code Sections 72-5-309 through 310 inclusive, that the grant of the United States of America of “the right of way for the construction of highways over public lands, not reserved for public uses” under United States Revised Statutes 2477 (43 U.S.C. Section 932 (repealed October 21, 1976, with proviso recognizing the validity of rights-of-way already established)) was accepted for and on behalf of the State of Utah and its political subdivision Millard County as it pertains to the highway located in Millard County known as Ibex Well Road; County Road Number: MC12; State Geographic Information Database (SGID) Road Identification Number: RD140239. Total road length is 20.34 miles more or less.

The reason for this Acknowledgment and Notice of Acknowledgment includes, but is not limited to, the fact that the road was constructed, mechanically, or by continuous use as a public highway for a period of at least ten years, over public lands not reserved for public uses, prior to the earlier of (a) the October 21, 1976 repeal of R.S. 2477 or (b) the date the servient estate was reserved for public uses.

This Acknowledgment and Notice of Acknowledgment applies only to the segments of the road that traverse land owned by the Bureau of Land Management, United States Department of the Interior, and does not apply to segments of the road that traverse land owned by any other person or entity. The State of Utah and its political subdivisions reserve the right to make further acknowledgments and notices of acknowledgment with regard to road segments that traverse land owned by other entities, including the United States of America, through one or more of its agencies.

A printed copy of a map showing the location of the road in said county is appended hereto as “Attachment 1,” a printed copy of representative photos of the road is appended hereto as “Attachment 2,” a printed copy of a description of the beginning and ending points of the entire road together with a list of Townships, Ranges and Sections that may be traversed by the road in said county is appended hereto as “Attachment 3,” and a printed copy of the Road Centerline Description Cover Page(s) is appended hereto as “Attachment 4.” The Appendices listed in “Attachment 4” that contain the actual road centerline descriptions are incorporated herein by reference. Affidavits provided by individuals familiar with the road are appended hereto as “Attachment 5.”

A printed copy of this Acknowledgment and Notice of Acknowledgment, together with its Attachments and Appendices, may be viewed and/or obtained at the office of the Utah State Archives.

An electronic copy of this Acknowledgment and Notice of Acknowledgment, together with its Attachments and Appendices, may be viewed and/or downloaded as read-only PDF (Portable Document Format) files via the

Internet at <http://recorded2477roads.utah.gov>.

The owner of the servient estate in the land underlying the road-segments subject to this Acknowledgment and Notice is believed to be the United States of America through one or more of its agencies. Any of such agencies or any other person with a servient ownership claim or a competing dominant estate right-of-way ownership claim, may file a petition in the State District Court for Salt Lake County for a decision regarding the correctness of this Acknowledgment. A claimant shall file a petition within sixty (60) days after receipt of this Notice.

In Witness Whereof, I, John Harja, the official designee of the Governor of the State of Utah, in conformity to the laws of the State (Utah Code Sections 72-5-308 through 310 inclusive), have caused this Acknowledgment and Notice of Acknowledgment to be made.

Signed by my hand in Salt Lake City, Utah, the 10th day of July, 2008.

By the Governor's Designee



John Harja

CERTIFICATION

State of Utah)
 : ss
County of Salt Lake)

I hereby certify that the signer of the foregoing document, John Harja, is personally known by me, has made a voluntary signature and taken an oath stating that he is the official designee of the Governor of the State of Utah and is authorized to sign this document on the Governor's behalf pursuant to Utah Code Section 72-5-309. He further vouched that, based upon information and belief, the facts alleged therein are true.

Dated this 10th day of July, 2008.



Notary Public

00166655

B: 490 P: 387 Fee \$0.00 Page 2 of 13
Connie Hansen, Millard Recorder By UT STATE GOVERNOR
07/16/2008 09:31:25 AM

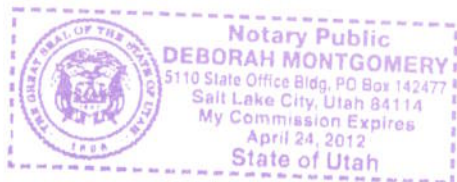

Attachment 1

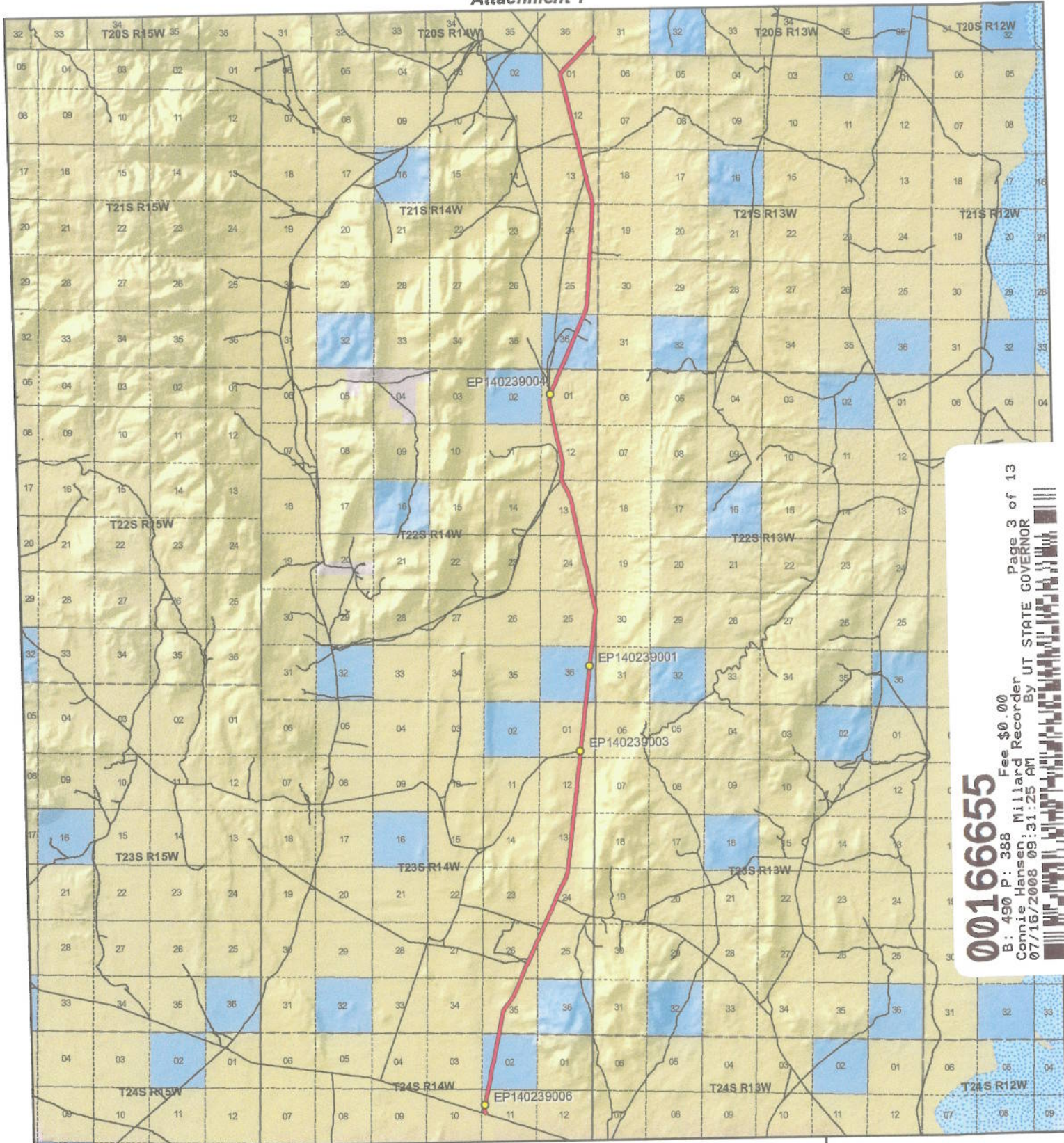

00166655
 Fee \$0.00
 B: 490 P: 388
 Connie Hansen, Millard Recorder
 07/16/2008 09:31:25 AM
 By UT STATE GOVERNOR

Ibx Well Road - Millard County
SGID RD_ID RD140239

- | | | |
|----------------------------------|--------------------------------|---|
| Land Ownership Categories | | Transportation Network |
| ● BLM | ◆ Wilderness | — Ibx Well Road |
| ● Private | ◆ UDWR Wildlife Reserve | — Title V: Issued Or Under Consideration By BLM Or County |
| ◆ SITLA, State Trust Land | ◆ DOD, Military | — Other Roads |
| ◆ USFS, National Forest | ◆ State Sovereign Land | ● Photo Event Point |
| ◆ State Parks and Recreation | ◆ National Recreation Area | ○ Section = 1 Mile |
| ◆ Tribal, Indian Reservation | ◆ USFWS, Natl. Wildlife Refuge | |
| ◆ NPS, National Park | | |

Map prepared by the State of Utah
 Automated Geographic Reference Center
 Room 5130 State Office Building
 Salt Lake City, Utah 84114
 Jun 03, 2006

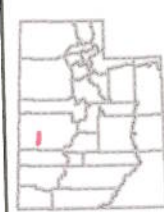

1:146,942
 1 inch equals 2.3 miles



EP140239001



EP140239004



EP140239006



EP140239003

00166655

B: 490 P: 389 Fee \$0.00 Page 4 of 13
Connie Hansen, Millard Recorder
07/16/2008 09:31:25 AM By UT STATE GOVERNOR

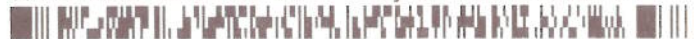

EP000000000

EP000000000

Ibex Well Road - Millard County
SGID RD_ID RD140239



Map prepared by the State of Utah
Automated Geographic Reference Center
Room 5130 State Office Building
Salt Lake City, Utah 84114
June 3, 2008



Attachment 3

Beginning & Ending Points and Township, Range, and Section References For:

Popular Name: Ibex Well Road

County: Millard

County Road Number: MC12

State Geographic Information Database (SGID) Road Identification Number: RD140239.

Total Road Length: 20.34 miles more or less.

Beginning at a point on the road centerline located at 38 degrees 44 minutes 27.71 seconds North Latitude and -113 degrees 23 minutes 46.91 seconds West Longitude, which can be converted to mapping accuracy State Plane Utah Central Zone NAD 83 feet coordinates of X = 1,099,495.4 feet and Y = 6,715,905.3 feet based on the US Survey Foot conversion.

Ending at a point on the road centerline located at 39 degrees 01 minutes 23.46 seconds North Latitude and -113 degrees 21 minutes 45.87 seconds West Longitude, which can be converted to mapping accuracy State Plane Utah Central Zone NAD 83 feet coordinates of X = 1,111,224.7 feet and Y = 6,818,450.0 feet based on the US Survey Foot conversion.

This road may traverse:

Township 20 South Range 13 West, Section(s) 31, Salt Lake Base & Meridian
Township 20 South Range 14 West, Section(s) 36, Salt Lake Base & Meridian
Township 21 South Range 14 West, Section(s) 1,12,13,24,25,36, Salt Lake Base & Meridian
Township 22 South Range 14 West, Section(s) 1,12,13,24,25,36, Salt Lake Base & Meridian
Township 23 South Range 14 West, Section(s) 1,12,13,24,25,26,35, Salt Lake Base & Meridian
Township 24 South Range 14 West, Section(s) 2,11, Salt Lake Base & Meridian
See Attachment 1 above for a cartographic depiction of the course of this road.

00166655

B: 490 P: 390 Fee \$0.00
Connie Hansen, Millard Recorder Page 5 of 13
07/16/2008 09:31:25 AM By UT STATE GOVERNOR



**Attachment 4
Road Centerline Description Cover Page(s)**

Popular Name: Ibex Well Road

County: Millard

County Road Number: MC12

State Geographic Information Database (SGID) Road Identification Number: RD140239.

Total Road Length: 20.34 miles more or less.

Centerline Descriptions Of Road-Segments That Cross Over Federally Owned Land, Derived From Global Positioning System Data And Cross-checked against USGS Digital Orthophoto Quadrangles Compiled By The Utah Automated Geographic Reference Center And Entered Into The State Geographic Information Database (SGID).

Road-Segments Listed by SGID Road Identification Number (RD ID)	Road-Segment Numbers	Believed Ownership Of Servient Estate	Approximate Segment Length	See Attached Appendix
RD140239	001	BLM	0.46 Miles	A
RD140239	002	ST	1.03 Miles	(not shown)
RD140239	003	BLM	6.27 Miles	B
RD140239	004	ST	1.01 Miles	(not shown)
RD140239	005	BLM	5.15 Miles	C
RD140239	006	ST	1.08 Miles	(not shown)
RD140239	007	BLM	5.33 Miles	D
		Total Road Length	20.34	

* Indicates that a Title V permit will be requested, is in process, or has been issued.

† Indicates that road-segments crossing Forest Service land are under consideration by the state and county as of the date of this Acknowledgment and Notice of Acknowledgment.

00166655

B: 490 P: 391 Fee \$0.00
 Connie Hansen, Millard Recorder Page 6 of 13
 07/16/2008 09:31:25 AM By UT STATE GOVERNOR



Attachment 5

00166655

B: 490 P: 392 Fee \$0.00
Connie Hansen, Millard Recorder Page 7 of 13
07/16/2008 09:31:25 AM By UT STATE GOVERNOR



AFFIDAVIT OF JAY ATKINSON

IBEX WELL ROAD

MILLARD COUNTY, UTAH

ROAD NUMBER MC 12

State of Utah)
 : ss.
County of Millard)

JAY ATKINSON, being first duly sworn, deposes and states as follows:

1. I am an adult competent to testify about the matters set forth below based upon my personal knowledge. I currently reside in Millard County, Utah. I have lived in Millard County for sixty-eight years. I was an employee of the Millard County Road Department from February of 1970 to April of 2000, and participated in maintenance of the road during that time.
2. I have traveled and am familiar with a road in Millard County known as Ibox Well Road. I am also familiar with the land the road traverses. When I first used and observed the road in the early 1940s, it followed the same route as in 2006 when I last observed it. Attached is a Millard County map showing Ibox Well Road. To the best of my knowledge and based upon my use of and familiarity with this road and the land it traverses, the location and route of the road are correctly illustrated on the attached map.
3. I am informed that the County also identifies this road according to the road number listed above.
4. I have observed that the road has been open to the public for all to use, to come and go as they pleased, since at least as early as the early 1940s and continuing through 1976 to 2006. Throughout this time period I have observed travel on the road by various means, including cars, trucks, recreational vehicles, and pickup trucks. Throughout this time period, the road has been used daily for more than ten continuous years prior to 1976, and is presently used daily.

00166655

B: 490 P: 393 Fee \$0.00
Connie Hansen, Millard Recorder
07/16/2008 09:31:25 AM By UT STATE GOVERNOR

Page 8 of 13



5. Throughout the time period from the early 1940s to 2006, I have used the road myself for the following uses: hunting, county road work and recreation.

6. Throughout the time period described in the previous paragraph, I observed other vehicles from the general public using the road at various times for the uses described in the previous paragraph, plus the following uses: livestock operations, rock hounding, traveling in and through the area, trapping, government access, picnicking, hiking and sightseeing.

7. It is also the reputation in the community that this road has been open to the public for all to use, to come and go as they pleased, since at least as early as the early 1930s and continuing through 1976 to the present, for the uses described in the previous paragraphs.

8. Prior to 1976, I participated in maintenance and construction activities on the road. Construction and maintenance have been performed since the early 1950s by Millard County Road Department.

DATED this 6 day of December, 2006.



JAY ATKINSON

SUBSCRIBED AND SWORN to before me this 6th day of December, 2006.

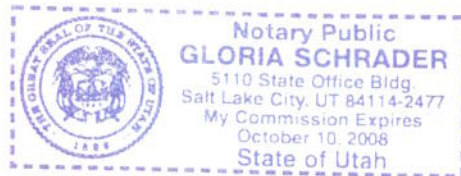



NOTARY PUBLIC

00166655

B: 490 P: 394 Fee \$0.00
Connie Hansen, Millard Recorder
07/16/2008 09:31:25 AM Page 9 of 13
By UT STATE GOVERNOR





**ROAD = MC12
IBEX WELL ROAD**

00166655

B: 490 P: 395 Fee \$0.00
 Connie Hansen, Millard Recorder
 07/16/2008 09:31:25 AM By UT STATE GOVERNOR



MILLARD COUNTY

- Interstate
- Highway Major
- Highway Minor
- B Class Road
- Unimproved Road
- County Border
- River
- / / / Cities / Towns
- Lakes
- Lakes - Intermittent
- Township & Range Line
- Forest Service Lands
- BLM Lands
- State Trust Lands
- Private Lands

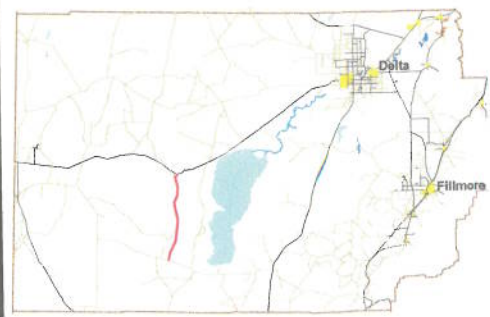

AFFIDAVIT OF WILLIAM THAYNE HENRIE

IBEX WELL ROAD

MILLARD COUNTY, UTAH

ROAD NUMBER MC12

State of Utah)
 : SS.
County of Millard)

00166655

B: 490 P: 396 Fee \$0.00 Page 11 of 13
Connie Hansen, Millard Recorder
07/16/2008 09:31:25 AM By UT STATE GOVERNOR



WILLIAM THAYNE HENRIE, being first duly sworn, deposes and states as follows:

1. I am an adult competent to testify about the matters set forth below based upon my personal knowledge. I currently reside in Millard County, Utah. I have lived in Millard County for fifty-eight years. I have been an employee of the Millard County Road Department since June of 1990, have been the Road Department Supervisor from January 1993 to the present and have participated in maintenance of the road during that time.

2. I have traveled and am familiar with a road in Millard County known as Ibex Well Road. I am also familiar with the land the road traverses. When I first used and observed the road in the 1950s, it followed the same route as in 2006 when I last observed it. Attached is a Millard County map showing Ibex Well Road. To the best of my knowledge and based upon my use of and familiarity with this road and the land it traverses, the location and route of the road are correctly illustrated on the attached map.

3. I am informed that the County also identifies this road according to the road number listed above.

4. I have observed that the road has been open to the public for all to use, to come and go as they pleased, since at least as early as the 1950s and continuing through 1976 to the present. Throughout this time period I have observed travel on the road by means of cars, trucks, recreational vehicles, and pickup trucks. Throughout this time period, the road has been used daily for more than ten continuous years prior to 1976, and is presently used daily.

5. Throughout the time period from the 1950s to the present, I have used the road myself for camping, gathering fire wood, hunting, rock hounding, participating in search and rescue efforts and recreation.

6. Throughout the time period described in the previous paragraph, I have observed other vehicles from the general public using the road at various times for the uses described in the previous paragraph, plus mining, prospecting for minerals, livestock operations, trapping, tourism, government access, picnicking, hiking and sightseeing.

7. It is also the reputation in the community that this road has been open to the public for all to use, to come and go as they pleased, since at least as early as the early 1900s and continuing through 1976 to the present, for the uses described in the previous paragraphs.

8. Prior to 1976 I observed graders and other maintenance equipment performing maintenance and construction activities on the road. Maintenance on the road has been performed since 1955 by the Millard County Road Department.

DATED this 5 day of December, 2006.

WILLIAM THAYNE HENRIE

SUBSCRIBED AND SWORN to before me this 5th day of December, 2006.



NOTARY PUBLIC

00166655

B: 490 P: 397 Fee \$0.00
Connie Hansen, Millard Recorder
07/16/2008 09:31:25 AM By UT STATE GOVERNOR Page 12 of 13





**ROAD = MC12
IBEX WELL ROAD**

00166655

B: 490 P: 398 Fee \$0.00
 Connie Hansen, Millard Recorder
 07/16/2008 09:31:25 AM By UT STATE GOVERNOR



MILLARD COUNTY

- B Class Road of Interest
- Interstate
- Highway Major
- Highway Minor
- B Class Road
- - - Unimproved Road
- County Border
- River
- / / / Cities / Towns
- Lakes
- Lakes - Intermittent
- Township & Range Line
- Forest Service Lands
- BLM Lands
- State Trust Lands
- Private Lands

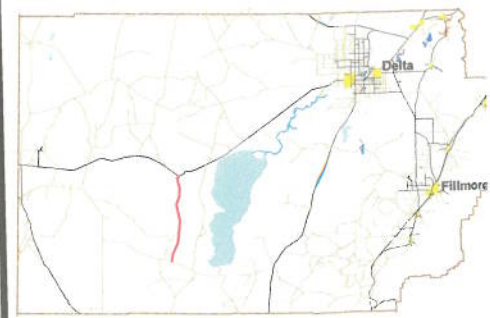

Lake