

**Acknowledgment and
Notice of Acknowledgment
of Acceptance of R.S. 2477
Right-of-Way Grant**

00165751

B: 485 P: 222 Fee \$0.00
Connie Hansen, Millard Recorder
05/14/2008 09:50:25 AM By UT STATE GOVERNOR Page 1 of 13



THE STATE OF UTAH

TO ALL WHOM THESE PRESENTS SHALL COME, Greeting:

Know ye, This is an Acknowledgment and Notice of Acknowledgment made under Utah Code Sections 72-5-309 through 310 inclusive, that the grant of the United States of America of “the right of way for the construction of highways over public lands, not reserved for public uses” under United States Revised Statutes 2477 (43 U.S.C. Section 932 (repealed October 21, 1976, with proviso recognizing the validity of rights-of-way already established)) was accepted for and on behalf of the State of Utah and its political subdivision Millard County as it pertains to the highway located in Millard County known as East Antelope Reservoir Road; County Road Number: MC1792; State Geographic Information Database (SGID) Road Identification Number: RD140853. Total road length is 2.69 miles more or less.

The reason for this Acknowledgment and Notice of Acknowledgment includes, but is not limited to, the fact that the road was constructed, mechanically, or by continuous use as a public highway for a period of at least ten years, over public lands not reserved for public uses, prior to the earlier of (a) the October 21, 1976 repeal of R.S. 2477 or (b) the date the servient estate was reserved for public uses.

This Acknowledgment and Notice of Acknowledgment applies only to the segments of the road that traverse land owned by the Bureau of Land Management, United States Department of the Interior, and does not apply to segments of the road that traverse land owned by any other person or entity. The State of Utah and its political subdivisions reserve the right to make further acknowledgments and notices of acknowledgment with regard to road segments that traverse land owned by other entities, including the United States of America, through one or more of its agencies.

A printed copy of a map showing the location of the road in said county is appended hereto as “Attachment 1,” a printed copy of representative photos of the road is appended hereto as “Attachment 2,” a printed copy of a description of the beginning and ending points of the entire road together with a list of Townships, Ranges and Sections that may be traversed by the road in said county is appended hereto as “Attachment 3,” and a printed copy of the Road Centerline Description Cover Page(s) is appended hereto as “Attachment 4.” The Appendices listed in “Attachment 4” that contain the actual road centerline descriptions are incorporated herein by reference. Affidavits provided by individuals familiar with the road are appended hereto as “Attachment 5.”

A printed copy of this Acknowledgment and Notice of Acknowledgment, together with its Attachments and Appendices, may be viewed and/or obtained at the office of the Utah State Archives.

An electronic copy of this Acknowledgment and Notice of Acknowledgment, together with its Attachments and Appendices, may be viewed and/or downloaded as read-only PDF (Portable Document Format) files via the



00165751

B: 485 P: 224 Fee \$0.00 Page 3 of 13
 Connie Hansen, Millard Recorder
 05/14/2008 09:50:25 AM By UT STATE GOVERNOR



Map prepared by the State of Utah
 Automated Geographic Reference Center
 Room 5130 State Office Building
 Salt Lake City, Utah 84114
 Nov 23, 2006

East Antelope Reservoir Road - Millard County SGID RD_ID RD140853

Wilderness	East Antelope Reservoir Road
UDWR Wildlife Reserve	Other Roads
DOD, Military	Title V, Issued Or Under Consideration By BLM
State Sovereign Land	Photo Event Point
National Recreation Area	Section = 1 Mile
USFWS, Natl. Wildlife Refuge	

BLM	Wilderness
Private	UDWR Wildlife Reserve
SITLA, State Trust Land	DOD, Military
USFS, National Forest	State Sovereign Land
State Parks and Recreation	National Recreation Area
Tribal, Indian Reservation	USFWS, Natl. Wildlife Refuge
NPS, National Park	

Transportation Network

East Antelope Reservoir Road
Other Roads
Title V, Issued Or Under Consideration By BLM
Photo Event Point
Section = 1 Mile



1:21,550
 1 inch equals 0.3 miles

Attachment 2



EP140853001



EP140853003



EP140853006



EP140853012

EP000000000

EP000000000

00165751

B: 485 P: 225 Fee \$0.00 Page 4 of 13
Connie Hansen, Millard Recorder By UT STATE GOVERNOR
05/14/2008 09:50:25 AM



East Antelope Reservoir Road - Millard County
SGID RD_ID RD140853

Map prepared by the State of Utah
Automated Geographic Reference Center
Room 5130 State Office Building
Salt Lake City, Utah 84114
November 22, 2006



Attachment 3

Beginning & Ending Points and Township, Range, and Section References For:

Popular Name: East Antelope Reservoir Road

County: Millard

County Road Number: MC1792

State Geographic Information Database (SGID) Road Identification Number: RD140853.

Total Road Length: 2.69 miles more or less.

Beginning at a point on the road centerline located at 38 degrees 41 minutes 04.83 seconds North Latitude and -113 degrees 53 minutes 43.03 seconds West Longitude, which can be converted to mapping accuracy State Plane Utah Central Zone NAD 83 feet coordinates of X = 956,663.4 feet and Y = 6,698,799.9 feet based on the US Survey Foot conversion.

Ending at a point on the road centerline located at 38 degrees 41 minutes 43.79 seconds North Latitude and -113 degrees 50 minutes 52.95 seconds West Longitude, which can be converted to mapping accuracy State Plane Utah Central Zone NAD 83 feet coordinates of X = 970,249.8 feet and Y = 6,702,382.3 feet based on the US Survey Foot conversion.

This road may traverse:

Township 24 South Range 18 West, Section(s) 27,28,32,33, Salt Lake Base & Meridian
See Attachment 1 above for a cartographic depiction of the course of this road.

00165751

B: 485 P: 226 Fee \$0.00 Page 5 of 13
Connie Hansen, Millard Recorder
05/14/2008 09:50:25 AM By UT STATE GOVERNOR



Attachment 4
Road Centerline Description Cover Page(s)

Popular Name: East Antelope Reservoir Road

County: Millard

County Road Number: MC1792

State Geographic Information Database (SGID) Road Identification Number: RD140853.

Total Road Length: 2.69 miles more or less.

Centerline Descriptions Of Road-Segments That Cross Over Federally Owned Land, Derived From Global Positioning System Data And Cross-checked against USGS Digital Orthophoto Quadrangles Compiled By The Utah Automated Geographic Reference Center And Entered Into The State Geographic Information Database (SGID).

Road-Segments Listed by SGID Road Identification Number (RD_ID)	Road-Segment Numbers	Believed Ownership Of Servient Estate	Approximate Segment Length	See Attached Appendix
RD140853	001	ST	0.97 Miles	(not shown)
RD140853	002	BLM	1.71 Miles	A
		Total Road Length	2.69	_____

* Indicates that a Title V permit will be requested, is in process, or has been issued.

† Indicates that road-segments crossing Forest Service land are under consideration by the state and county as of the date of this Acknowledgment and Notice of Acknowledgment.

00165751

B: 485 P: 227 Fee \$0.00
 Connie Hansen, Millard Recorder Page 6 of 13
 05/14/2008 09:50:25 AM By UT STATE GOVERNOR



Attachment 5

00165751

B: 485 P: 228 Fee \$0.00 Page 7 of 13
Connie Hansen, Millard Recorder
05/14/2008 09:50:25 AM By UT STATE GOVERNOR



AFFIDAVIT OF JAY ATKINSON
EAST ANTELOPE RESERVOIR ROAD
MILLARD COUNTY, UTAH
ROAD NUMBER MC 1792

State of Utah)
 : ss.
County of Millard)

JAY ATKINSON, being first duly sworn, deposes and states as follows:

1. I am an adult competent to testify about the matters set forth below based upon my personal knowledge. I currently reside in Millard County, Utah. I have lived in Millard County for sixty-eight years. I was an employee of the Millard County Road Department from February of 1970 to April of 2000, and participated in maintenance of the road during that time.

2. I have traveled and am familiar with a road in Millard County known as East Antelope Reservoir Road. I am also familiar with the land the road traverses. When I first used and observed the road in the early 1940s, it followed the same route as in 2000 when I last observed it. Attached is a Millard County map showing East Antelope Reservoir Road. To the best of my knowledge and based upon my use of and familiarity with this road and the land it traverses, the location and route of the road are correctly illustrated on the attached map.

3. I am informed that the County also identifies this road according to the road number listed above.

4. I have observed that the road has been open to the public for all to use, to come and go as they pleased, since at least as early as the early 1940s and continuing through 1976 to 2000. Throughout this time period I have observed travel on the road by various means, including cars, trucks, recreational vehicles, and pickup trucks. Throughout this time period, the road has been used weekly for more than ten continuous years prior to 1976, and was so used through 2000.

00165751

B: 485 P: 229 Fee \$0.00
Connie Hansen, Millard Recorder
05/14/2008 09:50:25 AM

Page 8 of 13

By UT STATE GOVERNOR



5. Throughout the time period from the early 1940s to 2000, I have used the road myself for the following uses: hunting, rock hounding, county road work and recreation.

6. Throughout the time period described in the previous paragraph, I observed other vehicles from the general public using the road at various times for the uses described in the previous paragraph, plus the following uses: livestock operations, traveling in and through the area, trapping, government access, picnicking, hiking and sightseeing.

7. It is also the reputation in the community that this road has been open to the public for all to use, to come and go as they pleased, since at least as early as the early 1930s and continuing through 1976 to the present, for the uses described in the previous paragraphs.

8. Prior to 1976, I participated in maintenance and construction activities on the road. Construction and maintenance have been performed since the early 1950s by Millard County Road Department.

DATED this 6 day of December, 2006.



JAY ATKINSON

SUBSCRIBED AND SWORN to before me this 6th day of December, 2006.

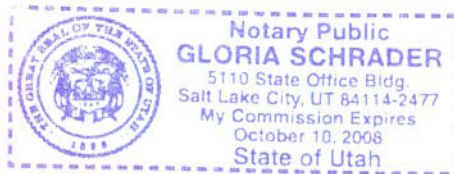



NOTARY PUBLIC

00165751

B: 485 P: 230 Fee \$0.00
Connie Hansen, Millard Recorder Page 9 of 13
05/14/2008 09:50:25 AM By UT STATE GOVERNOR



**ROAD = MC1792
EAST ANTELOPE RESERVOIR ROAD**

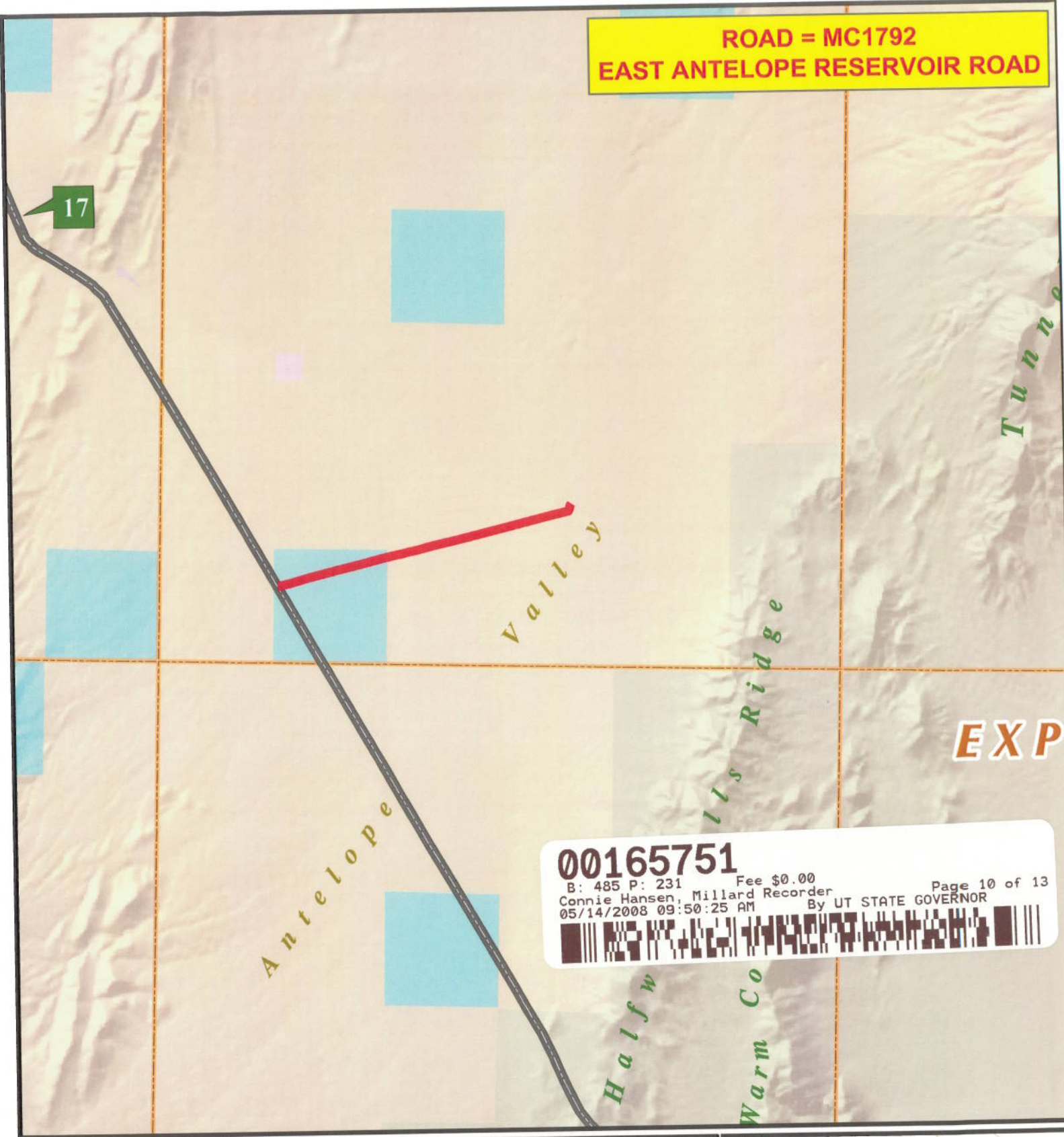

00165751
 B: 485 P: 231 Fee \$0.00 Page 10 of 13
 Connie Hansen, Millard Recorder
 05/14/2008 09:50:25 AM By UT STATE GOVERNOR

M I L L A R D C O U N T Y

- Interstate
- Highway Major
- Highway Minor
- B Class Road
- - - Unimproved Road
- County Border
- River
- / / / Cities / Towns
- Lakes
- Lakes - Intermittent
- Township & Range Line
- Forest Service Lands
- BLM Lands
- State Trust Lands
- Private Lands

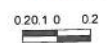

AFFIDAVIT OF WILLIAM THAYNE HENRIE

EAST ANTELOPE RESERVOIR ROAD

MILLARD COUNTY, UTAH

ROAD NUMBER MC1792

State of Utah)
 : ss.
County of Millard)

WILLIAM THAYNE HENRIE, being first duly sworn, deposes and states as follows:

1. I am an adult competent to testify about the matters set forth below based upon my personal knowledge. I currently reside in Millard County, Utah. I have lived in Millard County for fifty-eight years. I have been an employee of the Millard County Road Department since June of 1990, have been the Road Department Supervisor from January 1993 to the present and have participated in maintenance of the road during that time.

2. I have traveled and am familiar with a road in Millard County known as East Antelope Reservoir Road. I am also familiar with the land the road traverses. When I first used and observed the road in the 1950s, it followed the same route as in 2006 when I last observed it. Attached is a Millard County map showing East Antelope Reservoir Road. To the best of my knowledge and based upon my use of and familiarity with this road and the land it traverses, the location and route of the road are correctly illustrated on the attached map.

3. I am informed that the County also identifies this road according to the road number listed above.

4. I have observed that the road has been open to the public for all to use, to come and go as they pleased, since at least as early as the 1950s and continuing through 1976 to the present. Throughout this time period I have observed travel on the road by means of cars, trucks, recreational vehicles, and pickup trucks. Throughout this time period, the road has been used weekly for more than ten continuous years prior to 1976, and is presently used weekly.

00165751

B: 485 P: 232 Fee \$0.00
Connie Hansen, Millard Recorder Page 11 of 13
05/14/2008 09:50:25 AM By UT STATE GOVERNOR



5. Throughout the time period from the 1950s to the present, I have used the road myself for camping, gathering fire wood, hunting, rock hounding, participating in search and rescue efforts and recreation.

6. Throughout the time period described in the previous paragraph, I have observed other vehicles from the general public using the road at various times for the uses described in the previous paragraph, plus mining, prospecting for minerals, livestock operations, trapping, tourism, government access, picnicking, hiking and sightseeing.

7. It is also the reputation in the community that this road has been open to the public for all to use, to come and go as they pleased, since at least as early as the early 1900s and continuing through 1976 to the present, for the uses described in the previous paragraphs.

8. Prior to 1976 I observed graders and other maintenance equipment performing maintenance and construction activities on the road. Maintenance on the road has been performed since 1955 by the Millard County Road Department.

DATED this 5 day of December, 2006.

WILLIAM THAYNE HENRIE

SUBSCRIBED AND SWORN to before me this 5th day of December, 2006.

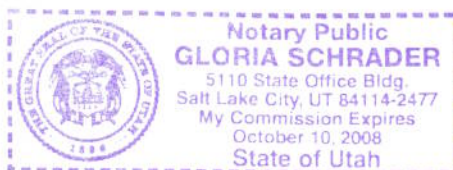



NOTARY PUBLIC

00165751

B: 485 P: 233 Fee \$0.00 Page 12 of 13
Connie Hansen, Millard Recorder
05/14/2008 09:50:25 AM By UT STATE GOVERNOR

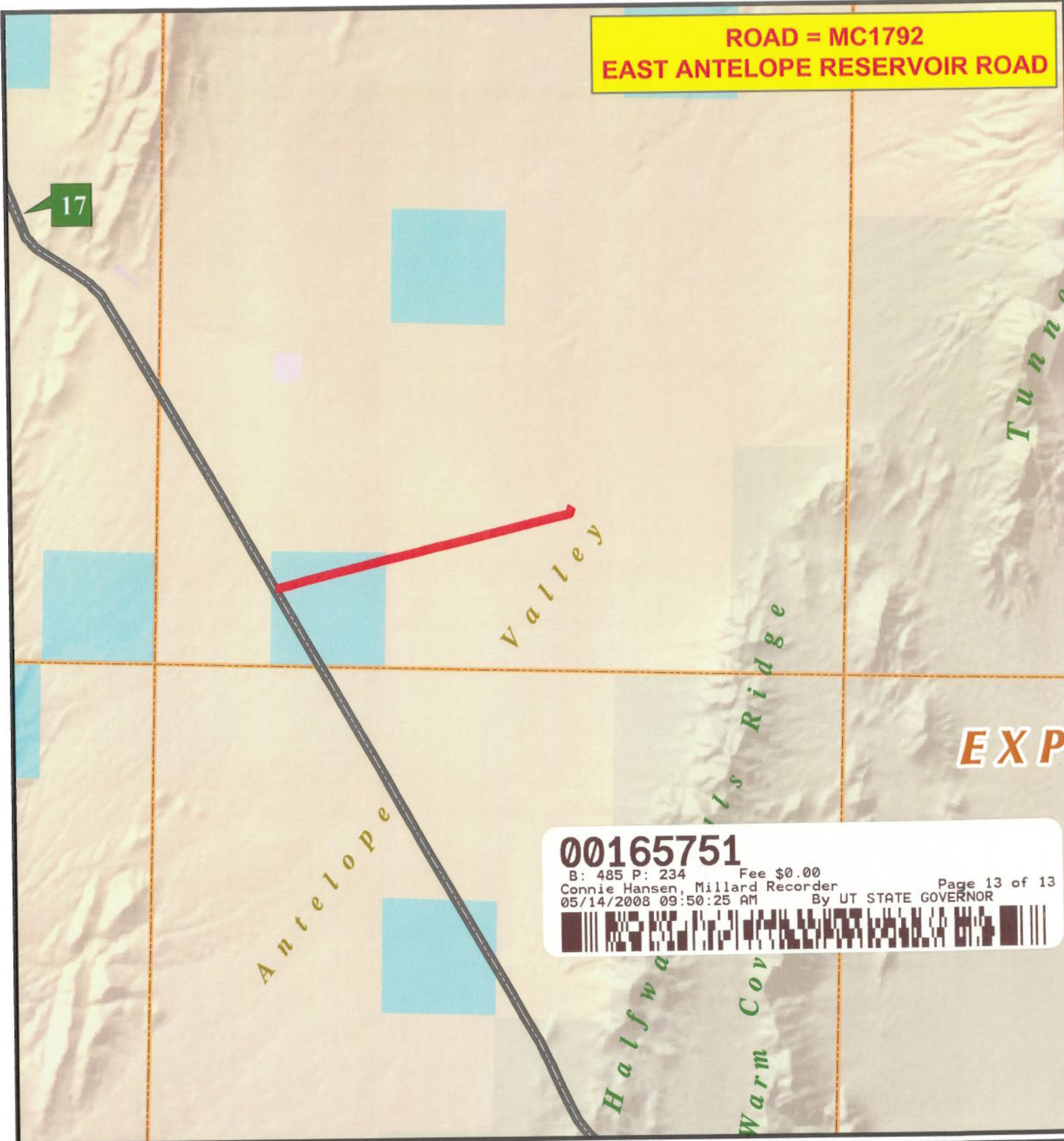

**ROAD = MC1792
EAST ANTELOPE RESERVOIR ROAD**



00165751
 B: 485 P: 234 Fee \$0.00
 Connie Hansen, Millard Recorder
 05/14/2008 09:50:25 AM By UT STATE GOVERNOR

M I L L A R D C O U N T Y

- B Class Road of Interest**
- Interstate
 - Highway Major
 - Highway Minor
 - B Class Road
 - Unimproved Road
 - County Border
 - River
 - Cities / Towns
 - Lakes
 - Lakes - Intermittent
 - Township & Range Line
 - Forest Service Lands
 - BLM Lands
 - State Trust Lands
 - Private Lands

0 20 1 0 0 2



Appendix A to Attachment 4

Popular Name: East Antelope Reservoir Road

County: Millard

County Road Number: MC1792

State Geographic Information Database (SGID) Road Identification Number: RD140853.

Road-Segment Number: 002

Road-Segment Length: 1.71 miles more or less.

Believed owner of the land underlying this road-segment is: Bureau of Land Management.

The following description is based upon the geographic coordinate system using the NAD83 Datum. The source is GPS mapping grade data as indicated in the metadata and/or the transportation data model of the State of Utah Geographic Information Database (SGID).

The road-segment itself is the monument that is identified by its physical presence on the land. The location of said physical presence is closely approximated by mapping grade Global Positioning System (GPS) data. Said data are checked against the corresponding gray-scale 1-meter Digital Orthophoto Quadrangles published by the United States Geological Survey (USGS) to verify a reasonable degree of accuracy. In circumstances where accurate satellite signal acquisition is not possible, such as deep, narrow canyons or under a canopy of dense foliage, or where very sharp curves in the road make accuracy questionable, such portions of the road were digitized from the corresponding gray-scale 1-meter Digital Orthophoto Quadrangles published by the United States Geological Survey (USGS).

This road-segment may traverse:

Township 24 South Range 18 West, Section(s) 27,28,32,33, Salt Lake Base & Meridian

The following description closely approximates the location of the centerline of the physical monument (East Antelope Reservoir Road)-- Segment 002 based on mapping grade Global Positioning System (GPS) data as defined above:

Beginning at a point on the road center line located at 38 degrees 41 minutes 18.51 seconds North Latitude and -113 degrees 52 minutes 40.54 seconds West Longitude, which can be converted to mapping accuracy State Plane Utah Central Zone NAD 83 feet coordinates of X = 961,654.1 feet and Y = 6,700,051.0 feet; thence the following courses along the said road center line:

thence North 77 Degrees 37 Minutes 42 Seconds East	4.7 feet
thence North 76 Degrees 55 Minutes 08 Seconds East	14.8 feet
thence North 76 Degrees 37 Minutes 53 Seconds East	57.9 feet
thence North 77 Degrees 08 Minutes 17 Seconds East	72.3 feet
thence North 77 Degrees 01 Minutes 25 Seconds East	71.6 feet
thence North 77 Degrees 41 Minutes 03 Seconds East	70.8 feet
thence North 78 Degrees 11 Minutes 58 Seconds East	69 feet
thence North 76 Degrees 41 Minutes 14 Seconds East	68.3 feet
thence North 77 Degrees 13 Minutes 27 Seconds East	68.2 feet
thence North 76 Degrees 53 Minutes 40 Seconds East	68 feet
thence North 76 Degrees 58 Minutes 52 Seconds East	66.9 feet

thence North 78 Degrees 14 Minutes 44 Seconds East 65.9 feet
 thence North 76 Degrees 33 Minutes 44 Seconds East 67.7 feet
 thence North 76 Degrees 43 Minutes 43 Seconds East 65.6 feet
 thence North 76 Degrees 17 Minutes 15 Seconds East 60.7 feet
 thence North 76 Degrees 05 Minutes 46 Seconds East 55.7 feet
 thence North 77 Degrees 52 Minutes 30 Seconds East 47.9 feet
 thence North 77 Degrees 04 Minutes 14 Seconds East 32.9 feet
 thence North 76 Degrees 55 Minutes 08 Seconds East 29.6 feet
 thence North 78 Degrees 34 Minutes 27 Seconds East 45.8 feet
 thence North 77 Degrees 46 Minutes 44 Seconds East 52.3 feet
 thence North 76 Degrees 23 Minutes 25 Seconds East 58.3 feet
 thence North 76 Degrees 16 Minutes 28 Seconds East 62.1 feet
 thence North 76 Degrees 07 Minutes 21 Seconds East 62.8 feet
 thence North 76 Degrees 07 Minutes 21 Seconds East 20.9 feet
 thence North 76 Degrees 07 Minutes 21 Seconds East 41.8 feet
 thence North 76 Degrees 58 Minutes 16 Seconds East 63.9 feet
 thence North 76 Degrees 19 Minutes 50 Seconds East 63.7 feet
 thence North 76 Degrees 15 Minutes 43 Seconds East 63.4 feet
 thence North 76 Degrees 10 Minutes 19 Seconds East 65.8 feet
 thence North 74 Degrees 33 Minutes 49 Seconds East 69 feet
 thence North 74 Degrees 57 Minutes 57 Seconds East 69.5 feet
 thence North 74 Degrees 04 Minutes 14 Seconds East 70.5 feet
 thence North 75 Degrees 29 Minutes 37 Seconds East 70.7 feet
 thence North 74 Degrees 58 Minutes 46 Seconds East 70.9 feet
 thence North 75 Degrees 45 Minutes 00 Seconds East 72 feet
 thence North 75 Degrees 52 Minutes 43 Seconds East 71.3 feet
 thence North 76 Degrees 12 Minutes 23 Seconds East 70.2 feet
 thence North 76 Degrees 08 Minutes 37 Seconds East 69.8 feet
 thence North 76 Degrees 44 Minutes 56 Seconds East 68.7 feet
 thence North 76 Degrees 53 Minutes 39 Seconds East 68 feet
 thence North 76 Degrees 37 Minutes 30 Seconds East 68 feet
 thence North 76 Degrees 48 Minutes 36 Seconds East 69 feet
 thence North 78 Degrees 12 Minutes 16 Seconds East 70.6 feet
 thence North 77 Degrees 30 Minutes 56 Seconds East 69.8 feet
 thence North 76 Degrees 43 Minutes 42 Seconds East 70 feet
 thence North 76 Degrees 50 Minutes 53 Seconds East 70.7 feet
 thence North 76 Degrees 49 Minutes 57 Seconds East 67.6 feet
 thence North 77 Degrees 35 Minutes 21 Seconds East 67.1 feet
 thence North 77 Degrees 35 Minutes 21 Seconds East 67.1 feet
 thence North 77 Degrees 09 Minutes 51 Seconds East 67.9 feet
 thence North 77 Degrees 58 Minutes 38 Seconds East 67.7 feet
 thence North 77 Degrees 57 Minutes 17 Seconds East 64.3 feet
 thence North 77 Degrees 44 Minutes 15 Seconds East 60 feet
 thence North 77 Degrees 44 Minutes 49 Seconds East 55.3 feet
 thence North 77 Degrees 13 Minutes 57 Seconds East 53.1 feet
 thence North 77 Degrees 52 Minutes 29 Seconds East 47.9 feet
 thence North 76 Degrees 28 Minutes 57 Seconds East 45.8 feet
 thence North 76 Degrees 34 Minutes 19 Seconds East 36 feet
 thence North 71 Degrees 17 Minutes 17 Seconds East 10.4 feet

thence North 76 Degrees 59 Minutes 55 Seconds East 10.4 feet
thence North 76 Degrees 02 Minutes 20 Seconds East 38.8 feet
thence North 76 Degrees 50 Minutes 23 Seconds East 63.3 feet
thence North 76 Degrees 47 Minutes 33 Seconds East 66 feet
thence North 76 Degrees 26 Minutes 03 Seconds East 67.1 feet
thence North 76 Degrees 28 Minutes 57 Seconds East 68.7 feet
thence North 75 Degrees 41 Minutes 12 Seconds East 70.3 feet
thence North 76 Degrees 12 Minutes 23 Seconds East 70.2 feet
thence North 76 Degrees 12 Minutes 23 Seconds East 70.2 feet
thence North 75 Degrees 21 Minutes 18 Seconds East 68.7 feet
thence North 76 Degrees 32 Minutes 41 Seconds East 69.1 feet
thence North 76 Degrees 17 Minutes 31 Seconds East 67.8 feet
thence North 77 Degrees 07 Minutes 57 Seconds East 66.2 feet
thence North 76 Degrees 40 Minutes 04 Seconds East 69.7 feet
thence North 75 Degrees 13 Minutes 38 Seconds East 69.4 feet
thence North 76 Degrees 42 Minutes 31 Seconds East 71.4 feet
thence North 77 Degrees 01 Minutes 24 Seconds East 71.6 feet
thence North 75 Degrees 09 Minutes 33 Seconds East 69.1 feet
thence North 76 Degrees 36 Minutes 23 Seconds East 69.4 feet
thence North 77 Degrees 06 Minutes 27 Seconds East 70.6 feet
thence North 76 Degrees 27 Minutes 08 Seconds East 71.4 feet
thence North 76 Degrees 41 Minutes 22 Seconds East 72.7 feet
thence North 76 Degrees 42 Minutes 31 Seconds East 71.4 feet
thence North 77 Degrees 35 Minutes 29 Seconds East 71.8 feet
thence North 76 Degrees 41 Minutes 22 Seconds East 72.7 feet
thence North 77 Degrees 02 Minutes 56 Seconds East 70.3 feet
thence North 75 Degrees 57 Minutes 04 Seconds East 68.9 feet
thence North 76 Degrees 17 Minutes 30 Seconds East 67.8 feet
thence North 76 Degrees 43 Minutes 41 Seconds East 61.3 feet
thence North 75 Degrees 41 Minutes 12 Seconds East 6.8 feet
thence North 76 Degrees 05 Minutes 45 Seconds East 66.8 feet
thence North 76 Degrees 00 Minutes 02 Seconds East 58.1 feet
thence North 75 Degrees 46 Minutes 56 Seconds East 47.7 feet
thence North 76 Degrees 55 Minutes 07 Seconds East 44.4 feet
thence North 76 Degrees 21 Minutes 45 Seconds East 53.9 feet
thence North 76 Degrees 29 Minutes 54 Seconds East 67.4 feet
thence North 76 Degrees 05 Minutes 45 Seconds East 66.8 feet
thence North 76 Degrees 31 Minutes 56 Seconds East 64.7 feet
thence North 75 Degrees 03 Minutes 11 Seconds East 64.8 feet
thence North 75 Degrees 20 Minutes 54 Seconds East 67.4 feet
thence North 76 Degrees 38 Minutes 16 Seconds East 62.3 feet
thence North 75 Degrees 46 Minutes 13 Seconds East 54.4 feet
thence North 75 Degrees 54 Minutes 02 Seconds East 42.6 feet
thence North 76 Degrees 19 Minutes 49 Seconds East 28.3 feet
thence North 73 Degrees 46 Minutes 38 Seconds East 4.8 feet
thence North 79 Degrees 06 Minutes 11 Seconds East 5.3 feet
thence North 75 Degrees 46 Minutes 37 Seconds East 50.4 feet
thence North 76 Degrees 05 Minutes 45 Seconds East 66.8 feet
thence North 76 Degrees 17 Minutes 30 Seconds East 67.8 feet

thence North 76 Degrees 52 Minutes 13 Seconds East 69.3 feet
 thence North 75 Degrees 48 Minutes 54 Seconds East 71 feet
 thence North 76 Degrees 00 Minutes 34 Seconds East 70.6 feet
 thence North 77 Degrees 50 Minutes 03 Seconds East 70.1 feet
 thence North 76 Degrees 12 Minutes 22 Seconds East 70.2 feet
 thence North 76 Degrees 21 Minutes 21 Seconds East 68.1 feet
 thence North 75 Degrees 29 Minutes 35 Seconds East 70.7 feet
 thence North 76 Degrees 00 Minutes 34 Seconds East 70.6 feet
 thence North 76 Degrees 40 Minutes 03 Seconds East 69.7 feet
 thence North 75 Degrees 57 Minutes 04 Seconds East 68.9 feet
 thence North 75 Degrees 49 Minutes 32 Seconds East 65.6 feet
 thence North 75 Degrees 45 Minutes 28 Seconds East 63.9 feet
 thence North 76 Degrees 54 Minutes 19 Seconds East 63.6 feet
 thence North 75 Degrees 53 Minutes 54 Seconds East 64.5 feet
 thence North 76 Degrees 25 Minutes 09 Seconds East 68.4 feet
 thence North 75 Degrees 25 Minutes 39 Seconds East 70.4 feet
 thence North 76 Degrees 16 Minutes 06 Seconds East 70.5 feet
 thence North 76 Degrees 35 Minutes 19 Seconds East 70.7 feet
 thence North 76 Degrees 57 Minutes 54 Seconds East 71.3 feet
 thence North 77 Degrees 08 Minutes 15 Seconds East 72.3 feet
 thence North 76 Degrees 46 Minutes 02 Seconds East 71.7 feet
 thence North 76 Degrees 57 Minutes 54 Seconds East 71.3 feet
 thence North 76 Degrees 32 Minutes 40 Seconds East 69.1 feet
 thence North 77 Degrees 07 Minutes 56 Seconds East 66.2 feet
 thence North 77 Degrees 25 Minutes 12 Seconds East 63.1 feet
 thence North 77 Degrees 27 Minutes 28 Seconds East 69.5 feet
 thence North 78 Degrees 15 Minutes 11 Seconds East 69.3 feet
 thence North 77 Degrees 41 Minutes 01 Seconds East 70.8 feet
 thence North 76 Degrees 27 Minutes 07 Seconds East 71.4 feet
 thence North 77 Degrees 24 Minutes 11 Seconds East 58.4 feet
 thence North 76 Degrees 05 Minutes 44 Seconds East 33.4 feet
 thence North 74 Degrees 39 Minutes 15 Seconds East 26.5 feet
 thence North 77 Degrees 33 Minutes 37 Seconds East 38.9 feet
 thence North 76 Degrees 01 Minutes 26 Seconds East 54 feet
 thence North 77 Degrees 50 Minutes 02 Seconds East 12.7 feet
 thence North 73 Degrees 06 Minutes 06 Seconds East 22.9 feet
 thence North 54 Degrees 11 Minutes 06 Seconds East 19.8 feet
 thence North 36 Degrees 11 Minutes 30 Seconds East 9.4 feet
 thence North 26 Degrees 38 Minutes 21 Seconds East 23.9 feet
 thence North 20 Degrees 19 Minutes 44 Seconds East 43.8 feet
 thence North 17 Degrees 10 Minutes 11 Seconds East 48.1 feet
 thence North 13 Degrees 03 Minutes 28 Seconds East 45.5 feet
 thence North 10 Degrees 25 Minutes 09 Seconds East 30 feet
 thence North 06 Degrees 03 Minutes 46 Seconds East 8.9 feet
 thence North 13 Degrees 27 Minutes 32 Seconds East 30.4 feet
 thence North 23 Degrees 14 Minutes 26 Seconds East 38.6 feet
 thence North 32 Degrees 50 Minutes 02 Seconds East 36 feet more or less to **the ending point**

at: 38 degrees 41 minutes 43.79 seconds North Latitude and -113 degrees 50 minutes 52.95 seconds West Longitude, which can be converted to mapping accuracy State Plane Utah Central Zone NAD 83 feet

coordinates of X = 970,249.8 feet and Y = 6,702,382.3 feet.