

00165765

B: 485 P: 404 Fee \$0.00
Connie Hansen, Millard Recorder
05/14/2008 10:03:31 AM By UT STATE GOVERNOR Page 1 of 13

**Acknowledgment and
Notice of Acknowledgment
of Acceptance of R.S. 2477
Right-of-Way Grant**



THE STATE OF UTAH

TO ALL WHOM THESE PRESENTS SHALL COME, Greeting:

Know ye, This is an Acknowledgment and Notice of Acknowledgment made under Utah Code Sections 72-5-309 through 310 inclusive, that the grant of the United States of America of “the right of way for the construction of highways over public lands, not reserved for public uses” under United States Revised Statutes 2477 (43 U.S.C. Section 932 (repealed October 21, 1976, with proviso recognizing the validity of rights-of-way already established)) was accepted for and on behalf of the State of Utah and its political subdivision Millard County as it pertains to the highway located in Millard County known as Antelope Point Cutoff Road; County Road Number: MC208; State Geographic Information Database (SGID) Road Identification Number: RD141159. Total road length is 3.49 miles more or less.

The reason for this Acknowledgment and Notice of Acknowledgment includes, but is not limited to, the fact that the road was constructed, mechanically, or by continuous use as a public highway for a period of at least ten years, over public lands not reserved for public uses, prior to the earlier of (a) the October 21, 1976 repeal of R.S. 2477 or (b) the date the servient estate was reserved for public uses.

This Acknowledgment and Notice of Acknowledgment applies only to the segments of the road that traverse land owned by the Bureau of Land Management, United States Department of the Interior, and does not apply to segments of the road that traverse land owned by any other person or entity. The State of Utah and its political subdivisions reserve the right to make further acknowledgments and notices of acknowledgment with regard to road segments that traverse land owned by other entities, including the United States of America, through one or more of its agencies.

A printed copy of a map showing the location of the road in said county is appended hereto as “Attachment 1,” a printed copy of representative photos of the road is appended hereto as “Attachment 2,” a printed copy of a description of the beginning and ending points of the entire road together with a list of Townships, Ranges and Sections that may be traversed by the road in said county is appended hereto as “Attachment 3,” and a printed copy of the Road Centerline Description Cover Page(s) is appended hereto as “Attachment 4.” The Appendices listed in “Attachment 4” that contain the actual road centerline descriptions are incorporated herein by reference. Affidavits provided by individuals familiar with the road are appended hereto as “Attachment 5.”

A printed copy of this Acknowledgment and Notice of Acknowledgment, together with its Attachments and Appendices, may be viewed and/or obtained at the office of the Utah State Archives.

An electronic copy of this Acknowledgment and Notice of Acknowledgment, together with its Attachments and Appendices, may be viewed and/or downloaded as read-only PDF (Portable Document Format) files via the

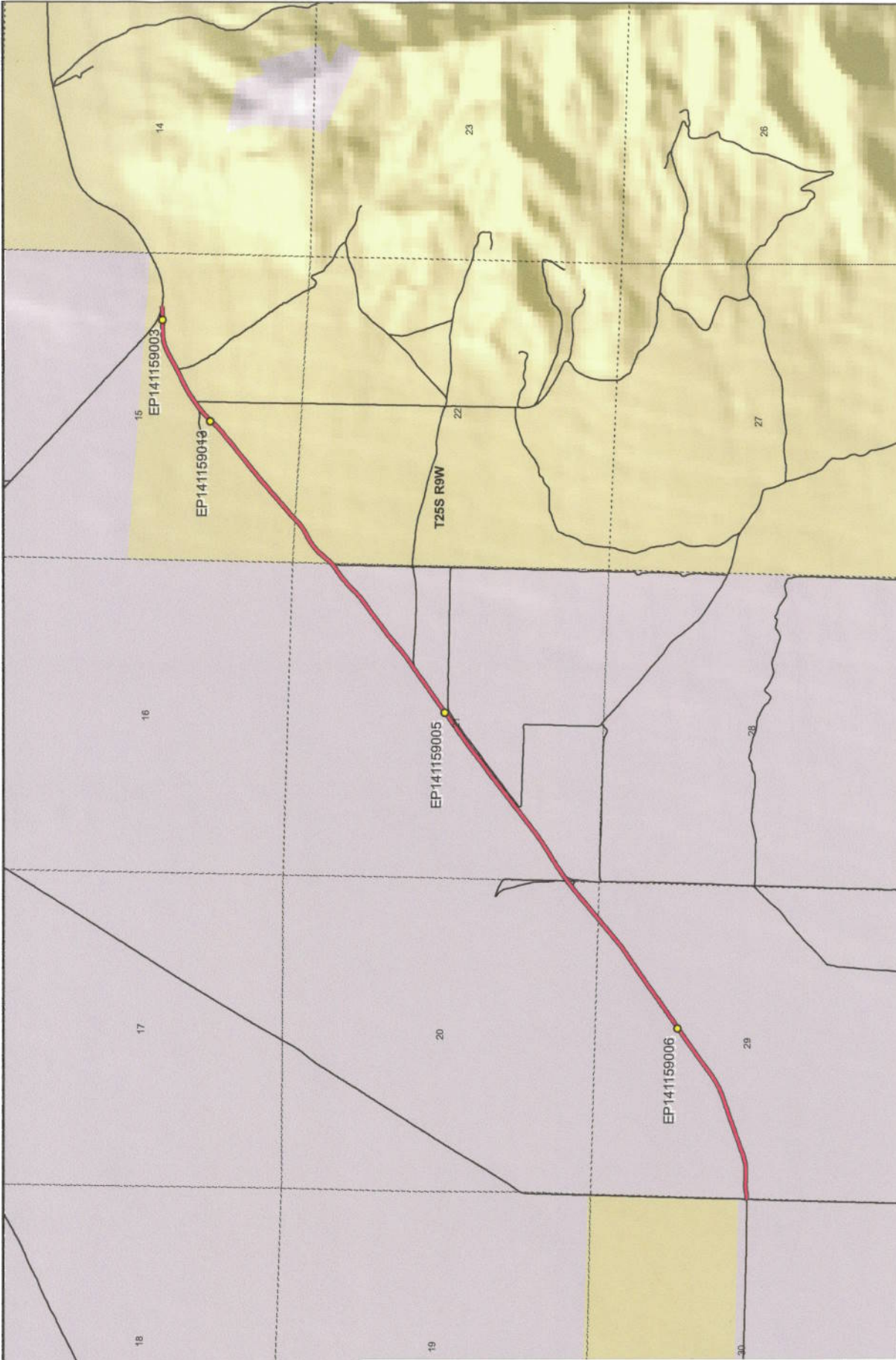

00165765
 B: 485 P: 406 Fee \$0.00
 Connie Hansen, Millard Recorder
 05/14/2008 10:03:31 AM By UT STATE GOVERNOR
 Page 3 of 13



1:29,053
 1 inch equals 0.5 miles

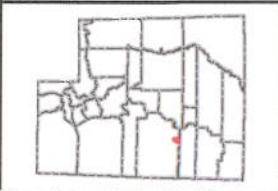

**Antelope Point Cutoff Road - Millard County
 SGID RD_ID RD141159**

- Land Ownership Categories**
- BLM
 - Private
 - SITLA, State Trust Land
 - USFS, National Forest
 - State Parks and Recreation
 - Tribal, Indian Reservation
 - NPS, National Park

- Wilderness
- UDWR Wildlife Reserve
- DOD, Military
- State Sovereign Land
- National Recreation Area
- USFWS, Natl. Wildlife Refuge

- Transportation Network**
- Antelope Point Cutoff Road
 - Other Roads
 - Title V: Issued Or Under Consideration By BLM Or County
 - Photo Event Point
 - Section = 1 Mile

Map prepared by the State of Utah
 Automated Geographic Reference Center
 Room 5130 State Office Building
 Salt Lake City, Utah 84114
 Nov 23, 2006





EP141159003



EP141159005



EP141159006



EP141159013

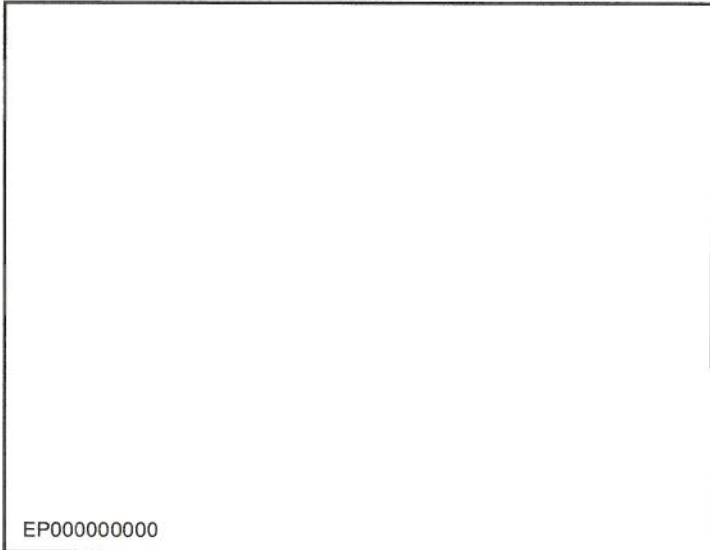

EP000000000

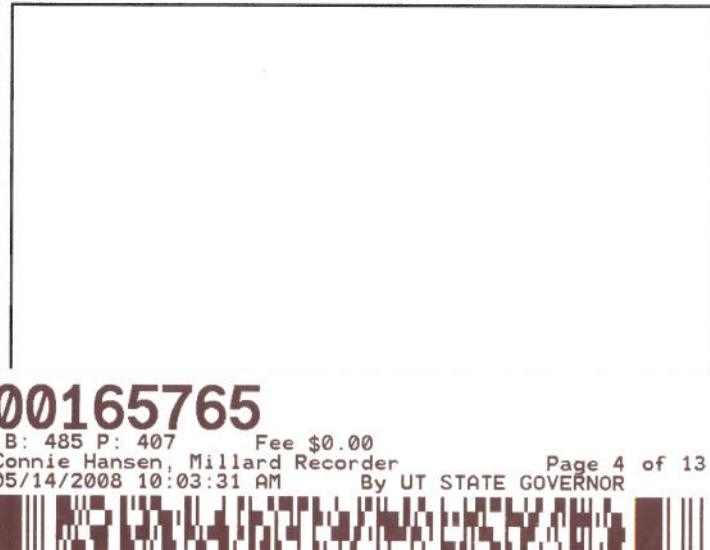

00165765

B: 485 P: 407 Fee \$0.00
Connie Hansen, Millard Recorder
05/14/2008 10:03:31 AM

Page 4 of 13
By UT STATE GOVERNOR



Antelope Point Cutoff Road - Millard County
SGID RD_ID RD141159

Map prepared by the State of Utah
Automated Geographic Reference Center
Room 5130 State Office Building
Salt Lake City, Utah 84114
November 22, 2006



Attachment 3

Beginning & Ending Points and Township, Range, and Section References For:

Popular Name: Antelope Point Cutoff Road

County: Millard

County Road Number: MC208

State Geographic Information Database (SGID) Road Identification Number: RD141159.

Total Road Length: 3.49 miles more or less.

Beginning at a point on the road centerline located at 38 degrees 36 minutes 32.69 seconds North Latitude and -112 degrees 53 minutes 51.62 seconds West Longitude, which can be converted to mapping accuracy State Plane Utah Central Zone NAD 83 feet coordinates of X = 1,240,978.3 feet and Y = 6,665,229.9 feet based on the US Survey Foot conversion.

Ending at a point on the road centerline located at 38 degrees 38 minutes 13.94 seconds North Latitude and -112 degrees 50 minutes 44.07 seconds West Longitude, which can be converted to mapping accuracy State Plane Utah Central Zone NAD 83 feet coordinates of X = 1,256,020.0 feet and Y = 6,675,245.4 feet based on the US Survey Foot conversion.

This road may traverse:

Township 25 South Range 9 West, Section(s) 15,20,21,22,29, Salt Lake Base & Meridian
See Attachment 1 above for a cartographic depiction of the course of this road.

00165765

B: 485 P: 408 Fee \$0.00
Connie Hansen, Millard Recorder
05/14/2008 10:03:31 AM

Page 5 of 13

By UT STATE GOVERNOR



**Attachment 4
Road Centerline Description Cover Page(s)**

Popular Name: Antelope Point Cutoff Road

County: Millard

County Road Number: MC208

State Geographic Information Database (SGID) Road Identification Number: RD141159.

Total Road Length: 3.49 miles more or less.

Centerline Descriptions Of Road-Segments That Cross Over Federally Owned Land, Derived From Global Positioning System Data And Cross-checked against USGS Digital Orthophoto Quadrangles Compiled By The Utah Automated Geographic Reference Center And Entered Into The State Geographic Information Database (SGID).

| Road-Segments Listed by SGID Road Identification Number (RD_ID) | Road-Segment Numbers | Believed Ownership Of Servient Estate | Approximate Segment Length | See Attached Appendix |
|--|---------------------------------|--|---|----------------------------------|
| RD141159 | 001 | PVT | 2.47 Miles | (not shown) |
| RD141159 | 002 | BLM | 0.97 Miles | A |
| RD141159 | 003 | BLM | 0.02 Miles | B |
| RD141159 | 004 | BLM | 0.04 Miles | C |
| | | Total Road Length | 3.49 | _____ |

* Indicates that a Title V permit will be requested, is in process, or has been issued.

† Indicates that road-segments crossing Forest Service land are under consideration by the state and county as of the date of this Acknowledgment and Notice of Acknowledgment.

00165765

B: 485 P: 409 Fee \$0.00
 Connie Hansen, Millard Recorder Page 6 of 13
 05/14/2008 10:03:31 AM By UT STATE GOVERNOR



Attachment 5

00165765

B: 485 P: 410 Fee \$0.00
Connie Hansen, Millard Recorder

05/14/2008 10:03:31 AM By UT STATE GOVERNOR Page 7 of 13



AFFIDAVIT OF JAY ATKINSON
ANTELOPE POINT CUTOFF ROAD
MILLARD COUNTY, UTAH
ROAD NUMBER MC 208

State of Utah)
 : ss.
County of Millard)

JAY ATKINSON, being first duly sworn, deposes and states as follows:

1. I am an adult competent to testify about the matters set forth below based upon my personal knowledge. I currently reside in Millard County, Utah. I have lived in Millard County for sixty-eight years. I was an employee of the Millard County Road Department from February of 1970 to April of 2000, and participated in maintenance of the road during that time.

2. I have traveled and am familiar with a road in Millard County known as Antelope Point Cutoff Road. I am also familiar with the land the road traverses. When I first used and observed the road in the early 1950s, it followed the same route as in 1999 when I last observed it. Attached is a Millard County map showing Antelope Point Cutoff Road. To the best of my knowledge and based upon my use of and familiarity with this road and the land it traverses, the location and route of the road are correctly illustrated on the attached map.

3. I am informed that the County also identifies this road according to the road number listed above.

4. I have observed that the road has been open to the public for all to use, to come and go as they pleased, since at least as early as the early 1950s and continuing through 1976 to 1999. Throughout this time period I have observed travel on the road by various means, including cars, trucks, recreational vehicles, and pickup trucks. Throughout this time period, the road has been used weekly for more than ten continuous years prior to 1976, and was so used through 1999.

00165765
B: 485 P: 411 Fee \$0.00
Connie Hansen, Millard Recorder
05/14/2008 10:03:31 AM By UT STATE GOVERNOR Page 8 of 13



5. Throughout the time period from the early 1950s to the present, I have used the road myself for the following uses: hunting, rock hounding, county road work and recreation.

6. Throughout the time period described in the previous paragraph, I observed other vehicles from the general public using the road at various times for the uses described in the previous paragraph, plus the following uses: livestock operations, trapping, government access, picnicking, traveling in and through the area, hiking and sightseeing.

7. It is also the reputation in the community that this road has been open to the public for all to use, to come and go as they pleased, since at least as early as the early 1940s and continuing through 1976 to the present, for the uses described in the previous paragraphs.

8. Prior to 1976, I participated in maintenance and construction activities on the road. Construction and maintenance have been performed since the early 1950s by Millard County Road Department.

DATED this 6 day of December, 2006.



JAY ATKINSON

SUBSCRIBED AND SWORN to before me this 6th day of December, 2006.

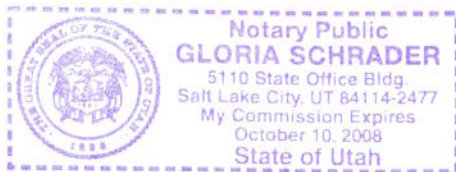



NOTARY PUBLIC

00165765

B: 485 P: 412 Fee \$0.00
Connie Hansen, Millard Recorder
05/14/2008 10:03:31 AM By UT STATE GOVERNOR Page 9 of 13



**ROAD = MC208
ANTELOPE POINT CUTOFF ROAD**

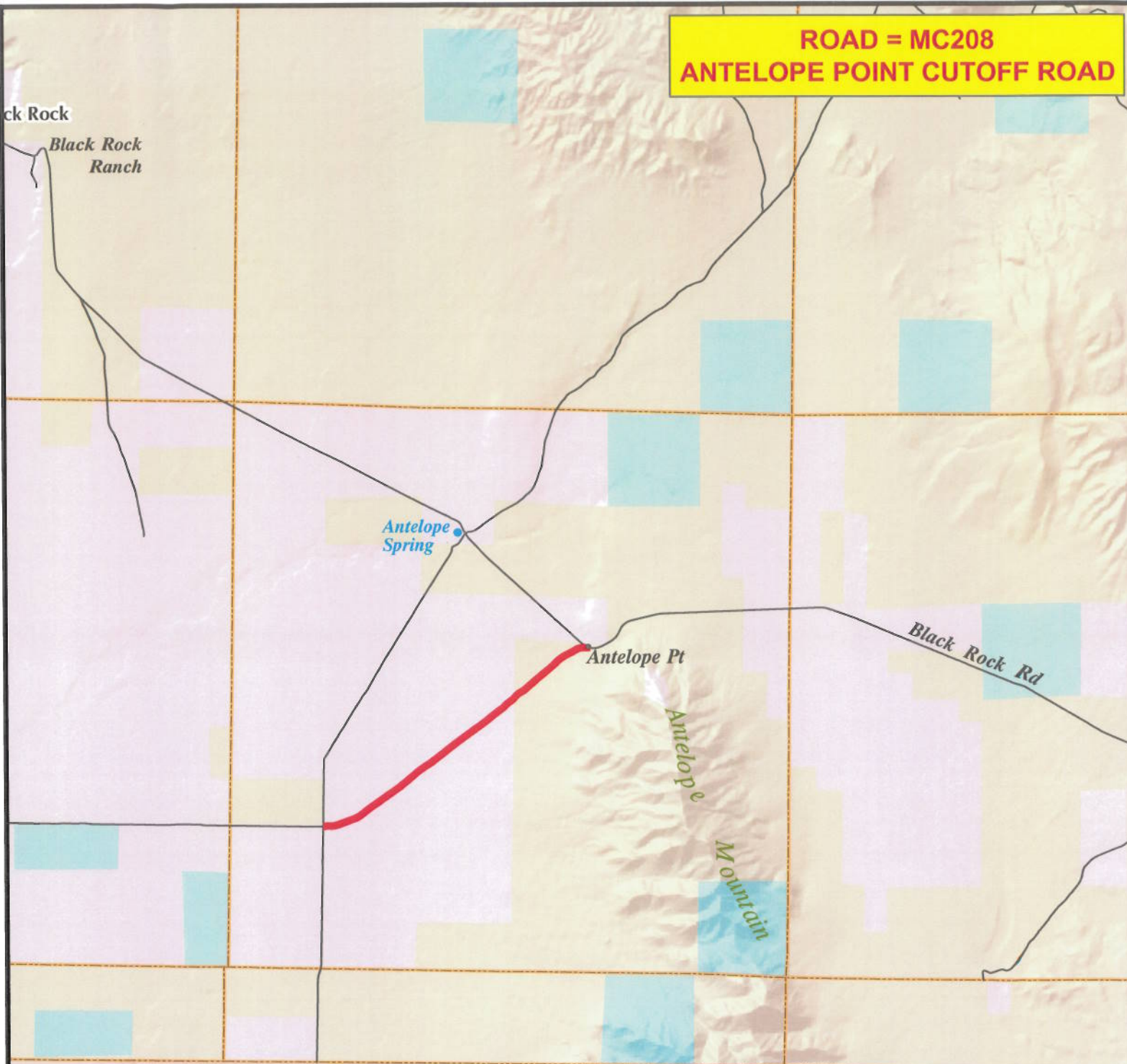

00165765

B: 485 P: 413 Fee \$0.00
 Connie Hansen, Millard Recorder
 05/14/2008 10:03:31 AM By UT STATE GOVERNOR Page 10 of 13



M I L L A R D C O U N T Y

— B Class Road of Interest

- | | | |
|-------------------|------------------------|-------------------------|
| — Interstate | — County Border | — Township & Range Line |
| — Highway Major | — River | — Forest Service Lands |
| — Highway Minor | — Cities / Towns | — BLM Lands |
| — B Class Road | — Lakes | — State Trust Lands |
| — Unimproved Road | — Lakes - Intermittent | — Private Lands |

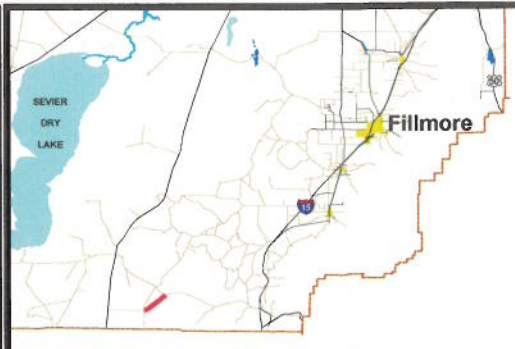

AFFIDAVIT OF WILLIAM THAYNE HENRIE

ANTELOPE POINT CUTOFF ROAD

MILLARD COUNTY, UTAH

ROAD NUMBER MC208

State of Utah)
 : ss.
County of Millard)

WILLIAM THAYNE HENRIE, being first duly sworn, deposes and states as follows:

1. I am an adult competent to testify about the matters set forth below based upon my personal knowledge. I currently reside in Millard County, Utah. I have lived in Millard County for fifty-eight years. I have been an employee of the Millard County Road Department since June of 1990, have been the Road Department Supervisor from January 1993 to the present and have participated in maintenance of the road during that time.

2. I have traveled and am familiar with a road in Millard County known as Antelope Point Cutoff Road. I am also familiar with the land the road traverses. When I first used and observed the road in the 1950s, it followed the same route as in 2006 when I last observed it. Attached is a Millard County map showing Antelope Point Cutoff Road. To the best of my knowledge and based upon my use of and familiarity with this road and the land it traverses, the location and route of the road are correctly illustrated on the attached map.

3. I am informed that the County also identifies this road according to the road number listed above.

4. I have observed that the road has been open to the public for all to use, to come and go as they pleased, since at least as early as the 1950s and continuing through 1976 to the present. Throughout this time period I have observed travel on the road by means of cars, trucks, recreational vehicles, and pickup trucks. Throughout this time period, the road has been used daily for more than ten continuous years prior to 1976, and is presently used daily.

00165765

B: 485 P: 414 Fee \$0.00 Page 11 of 13
Connie Hansen, Millard Recorder
05/14/2008 10:03:31 AM By UT STATE GOVERNOR



5. Throughout the time period from the 1950s to the present, I have used the road myself for camping, gathering fire wood, hunting, rock hounding, participating in search and rescue efforts and recreation.

6. Throughout the time period described in the previous paragraph, I have observed other vehicles from the general public using the road at various times for the uses described in the previous paragraph, plus mining, prospecting for minerals, livestock operations, farming, trapping, tourism, government access, picnicking, hiking and sightseeing.

7. It is also the reputation in the community that this road has been open to the public for all to use, to come and go as they pleased, since at least as early as the 1900s and continuing through 1976 to the present, for the uses described in the previous paragraphs.

8. Prior to 1976 I observed graders and other maintenance equipment performing maintenance and construction activities on the road. Maintenance on the road has been performed since 1955 by the Millard County Road Department.

DATED this 5 day of December, 2006.

WILLIAM THAYNE HENRIE

SUBSCRIBED AND SWORN to before me this 5th day of December, 2006.

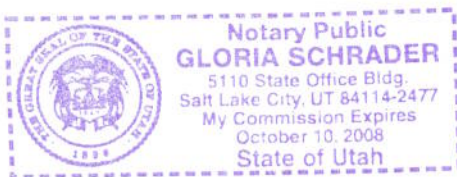



NOTARY PUBLIC

00165765
B: 485 P: 415 Fee \$0.00
Connie Hansen, Millard Recorder
05/14/2008 10:03:31 AM By UT STATE GOVERNOR
Page 12 of 13

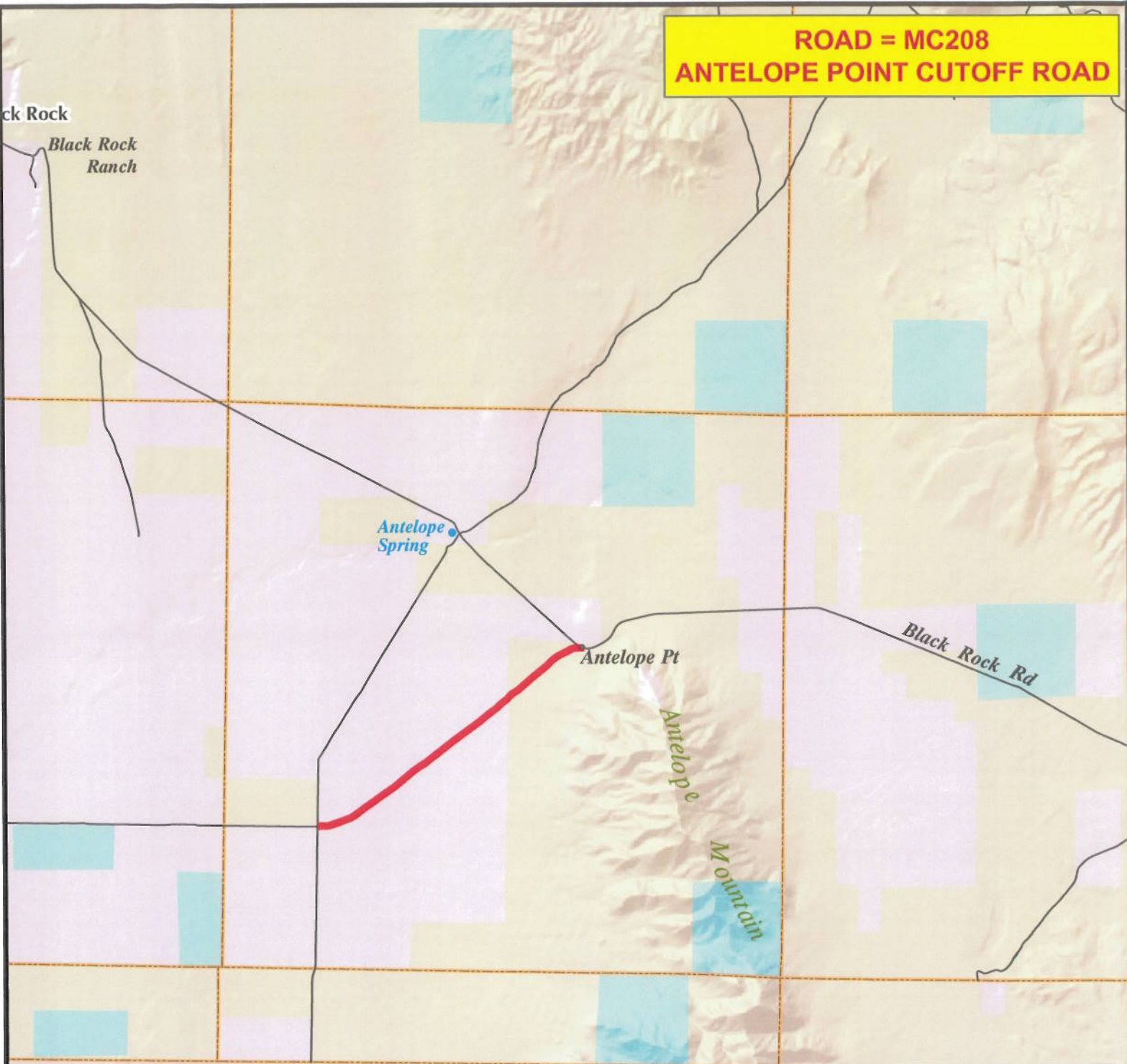

**ROAD = MC208
ANTELOPE POINT CUTOFF ROAD**



00165765

B: 485 P: 416 Fee \$0.00
 Connie Hansen, Millard Recorder
 05/14/2008 10:03:31 AM By UT STATE GOVERNOR



M I L L A R D C O U N T Y

- B Class Road of Interest**
- Interstate
 - Highway Major
 - Highway Minor
 - B Class Road
 - Unimproved Road
 - County Border
 - River
 - Cities / Towns
 - Lakes
 - Lakes - Intermittent
 - Township & Range Line
 - Forest Service Lands
 - BLM Lands
 - State Trust Lands
 - Private Lands

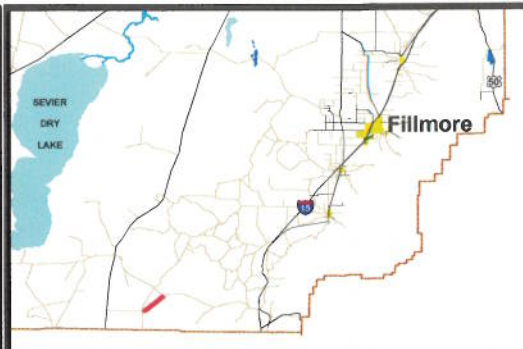

Appendix A to Attachment 4

Popular Name: Antelope Point Cutoff Road

County: Millard

County Road Number: MC208

State Geographic Information Database (SGID) Road Identification Number: RD141159.

Road-Segment Number: 002

Road-Segment Length: 0.97 miles more or less.

Believed owner of the land underlying this road-segment is: Bureau of Land Management.

The following description is based upon the geographic coordinate system using the NAD83 Datum. The source is GPS mapping grade data as indicated in the metadata and/or the transportation data model of the State of Utah Geographic Information Database (SGID).

The road-segment itself is the monument that is identified by its physical presence on the land. The location of said physical presence is closely approximated by mapping grade Global Positioning System (GPS) data. Said data are checked against the corresponding gray-scale 1-meter Digital Orthophoto Quadrangles published by the United States Geological Survey (USGS) to verify a reasonable degree of accuracy. In circumstances where accurate satellite signal acquisition is not possible, such as deep, narrow canyons or under a canopy of dense foliage, or where very sharp curves in the road make accuracy questionable, such portions of the road were digitized from the corresponding gray-scale 1-meter Digital Orthophoto Quadrangles published by the United States Geological Survey (USGS).

This road-segment may traverse:

Township 25 South Range 9 West, Section(s) 15,21,22, Salt Lake Base & Meridian

The following description closely approximates the location of the centerline of the physical monument (Antelope Point Cutoff Road)-- Segment 002 based on mapping grade Global Positioning System (GPS) data as defined above:

Beginning at a point on the road center line located at 38 degrees 37 minutes 44.76 seconds North Latitude and -112 degrees 51 minutes 38.24 seconds West Longitude, which can be converted to mapping accuracy State Plane Utah Central Zone NAD 83 feet coordinates of X = 1,251,677.1 feet and Y = 6,672,357.9 feet; thence the following courses along the said road center line:

thence North 44 Degrees 42 Minutes 35 Seconds East 1.4 feet
thence North 47 Degrees 11 Minutes 57 Seconds East 10.7 feet
thence North 44 Degrees 42 Minutes 35 Seconds East 5.6 feet
thence North 43 Degrees 04 Minutes 23 Seconds East 8.1 feet
thence North 43 Degrees 52 Minutes 46 Seconds East 16 feet
thence North 43 Degrees 49 Minutes 42 Seconds East 15.1 feet
thence North 42 Degrees 13 Minutes 12 Seconds East 16 feet
thence North 42 Degrees 55 Minutes 11 Seconds East 14.9 feet
thence North 41 Degrees 59 Minutes 00 Seconds East 14.6 feet
thence North 41 Degrees 53 Minutes 39 Seconds East 14.2 feet
thence North 39 Degrees 41 Minutes 47 Seconds East 13.3 feet

thence North 40 Degrees 08 Minutes 09 Seconds East 11.6 feet
thence North 40 Degrees 43 Minutes 07 Seconds East 10 feet
thence North 39 Degrees 48 Minutes 38 Seconds East 8.2 feet
thence North 37 Degrees 00 Minutes 49 Seconds East 8.7 feet
thence North 39 Degrees 48 Minutes 38 Seconds East 8.2 feet
thence North 38 Degrees 22 Minutes 10 Seconds East 8.4 feet
thence North 41 Degrees 03 Minutes 27 Seconds East 10.9 feet
thence North 40 Degrees 45 Minutes 52 Seconds East 13.5 feet
thence North 42 Degrees 04 Minutes 02 Seconds East 15.1 feet
thence North 42 Degrees 55 Minutes 11 Seconds East 14.9 feet
thence North 43 Degrees 01 Minutes 30 Seconds East 15.8 feet
thence North 43 Degrees 55 Minutes 29 Seconds East 16.9 feet
thence North 43 Degrees 52 Minutes 46 Seconds East 16 feet
thence North 47 Degrees 48 Minutes 13 Seconds East 17.2 feet
thence North 43 Degrees 56 Minutes 45 Seconds East 17.4 feet
thence North 47 Degrees 00 Minutes 01 Seconds East 17.4 feet
thence North 47 Degrees 00 Minutes 01 Seconds East 17.4 feet
thence North 48 Degrees 19 Minutes 52 Seconds East 18.4 feet
thence North 50 Degrees 43 Minutes 07 Seconds East 17.7 feet
thence North 50 Degrees 43 Minutes 07 Seconds East 17.7 feet
thence North 51 Degrees 22 Minutes 35 Seconds East 18 feet
thence North 53 Degrees 16 Minutes 44 Seconds East 17.1 feet
thence North 55 Degrees 22 Minutes 46 Seconds East 16.3 feet
thence North 54 Degrees 02 Minutes 00 Seconds East 15.8 feet
thence North 57 Degrees 42 Minutes 15 Seconds East 15.5 feet
thence North 56 Degrees 22 Minutes 08 Seconds East 14.9 feet
thence North 56 Degrees 01 Minutes 10 Seconds East 14.2 feet
thence North 59 Degrees 27 Minutes 11 Seconds East 13.7 feet
thence North 58 Degrees 16 Minutes 48 Seconds East 13.8 feet
thence North 59 Degrees 14 Minutes 39 Seconds East 12.9 feet
thence North 60 Degrees 58 Minutes 11 Seconds East 11.6 feet
thence North 57 Degrees 42 Minutes 15 Seconds East 9.3 feet
thence North 63 Degrees 08 Minutes 40 Seconds East 7.3 feet
thence North 64 Degrees 56 Minutes 04 Seconds East 4.7 feet
thence North 60 Degrees 39 Minutes 18 Seconds East 10.1 feet
thence North 61 Degrees 19 Minutes 00 Seconds East 13.8 feet
thence North 60 Degrees 39 Minutes 18 Seconds East 16.9 feet
thence North 60 Degrees 14 Minutes 01 Seconds East 17.3 feet
thence North 60 Degrees 45 Minutes 31 Seconds East 17.6 feet
thence North 61 Degrees 42 Minutes 01 Seconds East 17.5 feet
thence North 60 Degrees 45 Minutes 31 Seconds East 17.6 feet
thence North 59 Degrees 50 Minutes 01 Seconds East 17.8 feet
thence North 59 Degrees 50 Minutes 01 Seconds East 17.8 feet
thence North 57 Degrees 49 Minutes 08 Seconds East 17.4 feet
thence North 58 Degrees 02 Minutes 03 Seconds East 18.1 feet
thence North 57 Degrees 49 Minutes 08 Seconds East 17.4 feet
thence North 55 Degrees 25 Minutes 22 Seconds East 17.5 feet
thence North 52 Degrees 24 Minutes 20 Seconds East 17.3 feet
thence North 51 Degrees 56 Minutes 02 Seconds East 16.6 feet

thence North 50 Degrees 02 Minutes 30 Seconds East 17.5 feet
thence North 49 Degrees 28 Minutes 24 Seconds East 16.8 feet
thence North 50 Degrees 11 Minutes 13 Seconds East 17 feet
thence North 46 Degrees 18 Minutes 03 Seconds East 16.7 feet
thence North 47 Degrees 07 Minutes 45 Seconds East 16.5 feet
thence North 47 Degrees 58 Minutes 48 Seconds East 16.3 feet
thence North 46 Degrees 18 Minutes 03 Seconds East 16.7 feet
thence North 46 Degrees 18 Minutes 03 Seconds East 16.7 feet
thence North 47 Degrees 03 Minutes 46 Seconds East 17 feet
thence North 47 Degrees 53 Minutes 22 Seconds East 8.4 feet
thence North 46 Degrees 06 Minutes 24 Seconds East 9.5 feet
thence North 46 Degrees 15 Minutes 28 Seconds East 17.2 feet
thence North 45 Degrees 30 Minutes 59 Seconds East 16.5 feet
thence North 46 Degrees 26 Minutes 43 Seconds East 15.3 feet
thence North 46 Degrees 33 Minutes 26 Seconds East 14.4 feet
thence North 45 Degrees 42 Minutes 53 Seconds East 13.2 feet
thence North 47 Degrees 00 Minutes 01 Seconds East 11.6 feet
thence North 44 Degrees 42 Minutes 34 Seconds East 9.7 feet
thence North 52 Degrees 24 Minutes 20 Seconds East 8.7 feet
thence North 51 Degrees 25 Minutes 10 Seconds East 7.9 feet
thence North 51 Degrees 50 Minutes 04 Seconds East 7.5 feet
thence North 48 Degrees 17 Minutes 09 Seconds East 7.4 feet
thence North 51 Degrees 25 Minutes 10 Seconds East 7.9 feet
thence North 49 Degrees 20 Minutes 42 Seconds East 8.6 feet
thence North 46 Degrees 15 Minutes 28 Seconds East 8.6 feet
thence North 49 Degrees 20 Minutes 42 Seconds East 8.6 feet
thence North 50 Degrees 25 Minutes 13 Seconds East 9.3 feet
thence North 48 Degrees 56 Minutes 45 Seconds East 12.6 feet
thence North 49 Degrees 06 Minutes 30 Seconds East 15.1 feet
thence North 48 Degrees 44 Minutes 16 Seconds East 16.5 feet
thence North 49 Degrees 13 Minutes 25 Seconds East 17.7 feet
thence North 48 Degrees 37 Minutes 40 Seconds East 17 feet
thence North 49 Degrees 28 Minutes 23 Seconds East 16.8 feet
thence North 51 Degrees 37 Minutes 15 Seconds East 15.4 feet
thence North 48 Degrees 10 Minutes 40 Seconds East 15.3 feet
thence North 48 Degrees 24 Minutes 03 Seconds East 14.4 feet
thence North 50 Degrees 36 Minutes 56 Seconds East 13.5 feet
thence North 48 Degrees 39 Minutes 17 Seconds East 13.5 feet
thence North 48 Degrees 56 Minutes 45 Seconds East 12.6 feet
thence North 48 Degrees 56 Minutes 45 Seconds East 12.6 feet
thence North 48 Degrees 56 Minutes 45 Seconds East 12.6 feet
thence North 51 Degrees 17 Minutes 29 Seconds East 12.1 feet
thence North 47 Degrees 56 Minutes 57 Seconds East 12.3 feet
thence North 51 Degrees 33 Minutes 08 Seconds East 11.7 feet
thence North 46 Degrees 54 Minutes 44 Seconds East 12.1 feet
thence North 49 Degrees 17 Minutes 00 Seconds East 11.6 feet
thence North 50 Degrees 32 Minutes 09 Seconds East 11.4 feet
thence North 49 Degrees 17 Minutes 00 Seconds East 11.6 feet
thence North 49 Degrees 28 Minutes 23 Seconds East 11.2 feet

thence North 49 Degrees 17 Minutes 00 Seconds East 11.6 feet
thence North 48 Degrees 04 Minutes 34 Seconds East 11.9 feet
thence North 49 Degrees 17 Minutes 00 Seconds East 11.6 feet
thence North 49 Degrees 17 Minutes 00 Seconds East 11.6 feet
thence North 46 Degrees 54 Minutes 44 Seconds East 12.1 feet
thence North 46 Degrees 54 Minutes 44 Seconds East 12.1 feet
thence North 46 Degrees 54 Minutes 44 Seconds East 12.1 feet
thence North 47 Degrees 00 Minutes 00 Seconds East 11.6 feet
thence North 48 Degrees 21 Minutes 42 Seconds East 10.9 feet
thence North 48 Degrees 31 Minutes 25 Seconds East 10.5 feet
thence North 50 Degrees 25 Minutes 12 Seconds East 9.3 feet
thence North 46 Degrees 10 Minutes 42 Seconds East 9.1 feet
thence North 48 Degrees 04 Minutes 33 Seconds East 7.9 feet
thence North 49 Degrees 54 Minutes 14 Seconds East 7.7 feet
thence North 54 Degrees 29 Minutes 31 Seconds East 6.8 feet
thence North 51 Degrees 25 Minutes 10 Seconds East 7.9 feet
thence North 54 Degrees 10 Minutes 19 Seconds East 8.5 feet
thence North 51 Degrees 02 Minutes 59 Seconds East 10.5 feet
thence North 51 Degrees 17 Minutes 29 Seconds East 12.1 feet
thence North 50 Degrees 40 Minutes 26 Seconds East 15.6 feet
thence North 48 Degrees 19 Minutes 52 Seconds East 18.4 feet
thence North 50 Degrees 08 Minutes 59 Seconds East 19.6 feet
thence North 47 Degrees 15 Minutes 15 Seconds East 20.9 feet
thence North 50 Degrees 36 Minutes 56 Seconds East 20.3 feet
thence North 48 Degrees 42 Minutes 01 Seconds East 20 feet
thence North 48 Degrees 04 Minutes 33 Seconds East 19.8 feet
thence North 50 Degrees 08 Minutes 59 Seconds East 19.6 feet
thence North 49 Degrees 38 Minutes 55 Seconds East 18.9 feet
thence North 50 Degrees 33 Minutes 56 Seconds East 18.2 feet
thence North 49 Degrees 13 Minutes 25 Seconds East 17.7 feet
thence North 50 Degrees 20 Minutes 25 Seconds East 16.6 feet
thence North 50 Degrees 30 Minutes 08 Seconds East 16.1 feet
thence North 50 Degrees 40 Minutes 26 Seconds East 15.6 feet
thence North 49 Degrees 54 Minutes 14 Seconds East 15.4 feet
thence North 50 Degrees 03 Minutes 55 Seconds East 14.9 feet
thence North 50 Degrees 14 Minutes 13 Seconds East 14.5 feet
thence North 51 Degrees 02 Minutes 59 Seconds East 14.7 feet
thence North 47 Degrees 26 Minutes 09 Seconds East 14.6 feet
thence North 50 Degrees 51 Minutes 22 Seconds East 15.2 feet
thence North 50 Degrees 14 Minutes 13 Seconds East 14.5 feet
thence North 50 Degrees 14 Minutes 13 Seconds East 14.5 feet
thence North 50 Degrees 25 Minutes 12 Seconds East 14 feet
thence North 47 Degrees 37 Minutes 13 Seconds East 13.7 feet
thence North 50 Degrees 36 Minutes 56 Seconds East 13.5 feet
thence North 47 Degrees 37 Minutes 13 Seconds East 13.7 feet
thence North 49 Degrees 54 Minutes 14 Seconds East 12.8 feet
thence North 49 Degrees 17 Minutes 00 Seconds East 11.6 feet
thence North 51 Degrees 02 Minutes 59 Seconds East 10.5 feet
thence North 50 Degrees 25 Minutes 12 Seconds East 9.3 feet

thence North 52 Degrees 50 Minutes 22 Seconds East 6.6 feet
thence North 52 Degrees 08 Minutes 27 Seconds East 5.4 feet
thence North 49 Degrees 28 Minutes 23 Seconds East 5.6 feet
thence North 53 Degrees 52 Minutes 19 Seconds East 7.3 feet
thence North 49 Degrees 17 Minutes 00 Seconds East 11.6 feet
thence North 52 Degrees 35 Minutes 33 Seconds East 15.2 feet
thence North 52 Degrees 50 Minutes 22 Seconds East 16.4 feet
thence North 52 Degrees 37 Minutes 00 Seconds East 16.9 feet
thence North 52 Degrees 00 Minutes 55 Seconds East 18.2 feet
thence North 51 Degrees 45 Minutes 19 Seconds East 20.8 feet
thence North 49 Degrees 54 Minutes 14 Seconds East 23.1 feet
thence North 51 Degrees 45 Minutes 19 Seconds East 20.8 feet
thence North 51 Degrees 02 Minutes 59 Seconds East 21 feet
thence North 49 Degrees 54 Minutes 14 Seconds East 20.5 feet
thence North 50 Degrees 01 Minutes 26 Seconds East 20 feet
thence North 51 Degrees 39 Minutes 45 Seconds East 19.2 feet
thence North 50 Degrees 16 Minutes 54 Seconds East 19.1 feet
thence North 49 Degrees 46 Minutes 23 Seconds East 18.4 feet
thence North 50 Degrees 43 Minutes 06 Seconds East 17.7 feet
thence North 49 Degrees 20 Minutes 42 Seconds East 17.2 feet
thence North 52 Degrees 21 Minutes 36 Seconds East 15.7 feet
thence North 51 Degrees 02 Minutes 59 Seconds East 14.7 feet
thence North 50 Degrees 03 Minutes 55 Seconds East 14.9 feet
thence North 51 Degrees 15 Minutes 21 Seconds East 14.2 feet
thence North 51 Degrees 28 Minutes 32 Seconds East 13.8 feet
thence North 49 Degrees 33 Minutes 12 Seconds East 13.7 feet
thence North 51 Degrees 42 Minutes 39 Seconds East 13.3 feet
thence North 50 Degrees 36 Minutes 56 Seconds East 13.5 feet
thence North 49 Degrees 33 Minutes 12 Seconds East 13.7 feet
thence North 50 Degrees 25 Minutes 12 Seconds East 14 feet
thence North 50 Degrees 14 Minutes 13 Seconds East 14.5 feet
thence North 51 Degrees 15 Minutes 21 Seconds East 14.2 feet
thence North 47 Degrees 37 Minutes 13 Seconds East 13.7 feet
thence North 50 Degrees 49 Minutes 30 Seconds East 13.1 feet
thence North 47 Degrees 56 Minutes 57 Seconds East 12.3 feet
thence North 51 Degrees 02 Minutes 59 Seconds East 10.5 feet
thence North 51 Degrees 20 Minutes 31 Seconds East 10 feet
thence North 53 Degrees 52 Minutes 18 Seconds East 7.3 feet
thence North 46 Degrees 20 Minutes 46 Seconds East 8.1 feet
thence North 51 Degrees 17 Minutes 29 Seconds East 12.1 feet
thence North 48 Degrees 53 Minutes 40 Seconds East 19.1 feet
thence North 49 Degrees 40 Minutes 45 Seconds East 21.4 feet
thence North 49 Degrees 40 Minutes 45 Seconds East 21.4 feet
thence North 50 Degrees 14 Minutes 13 Seconds East 21.7 feet
thence North 49 Degrees 47 Minutes 20 Seconds East 21 feet
thence North 49 Degrees 34 Minutes 26 Seconds East 21.9 feet
thence North 50 Degrees 29 Minutes 01 Seconds East 20.8 feet
thence North 50 Degrees 29 Minutes 01 Seconds East 20.8 feet
thence North 48 Degrees 42 Minutes 01 Seconds East 20 feet

thence North 49 Degrees 25 Minutes 02 Seconds East 19.8 feet
thence North 48 Degrees 14 Minutes 30 Seconds East 18.8 feet
thence North 46 Degrees 06 Minutes 24 Seconds East 19 feet
thence North 46 Degrees 56 Minutes 26 Seconds East 17.9 feet
thence North 46 Degrees 10 Minutes 41 Seconds East 18.1 feet
thence North 46 Degrees 10 Minutes 41 Seconds East 18.1 feet
thence North 43 Degrees 59 Minutes 03 Seconds East 18.3 feet
thence North 43 Degrees 55 Minutes 28 Seconds East 16.9 feet
thence North 45 Degrees 30 Minutes 59 Seconds East 16.5 feet
thence North 41 Degrees 14 Minutes 28 Seconds East 15.3 feet
thence North 42 Degrees 55 Minutes 10 Seconds East 14.9 feet
thence North 42 Degrees 51 Minutes 42 Seconds East 14.4 feet
thence North 41 Degrees 41 Minutes 48 Seconds East 13.2 feet
thence North 42 Degrees 30 Minutes 24 Seconds East 12.1 feet
thence North 46 Degrees 10 Minutes 41 Seconds East 9.1 feet
thence North 43 Degrees 22 Minutes 38 Seconds East 10 feet
thence North 44 Degrees 42 Minutes 34 Seconds East 8.8 feet
thence North 43 Degrees 26 Minutes 11 Seconds East 10.4 feet
thence North 43 Degrees 44 Minutes 18 Seconds East 13.7 feet
thence North 45 Degrees 30 Minutes 59 Seconds East 16.5 feet
thence North 44 Degrees 42 Minutes 34 Seconds East 18.6 feet
thence North 44 Degrees 01 Minutes 09 Seconds East 19.3 feet
thence North 46 Degrees 06 Minutes 24 Seconds East 19 feet
thence North 46 Degrees 10 Minutes 41 Seconds East 18.1 feet
thence North 47 Degrees 48 Minutes 12 Seconds East 17.2 feet
thence North 46 Degrees 23 Minutes 39 Seconds East 15.8 feet
thence North 49 Degrees 43 Minutes 21 Seconds East 13.3 feet
thence North 50 Degrees 46 Minutes 55 Seconds East 11 feet
thence North 52 Degrees 50 Minutes 22 Seconds East 8.2 feet
thence North 51 Degrees 02 Minutes 58 Seconds East 6.3 feet
thence North 52 Degrees 24 Minutes 19 Seconds East 8.7 feet
thence North 47 Degrees 48 Minutes 12 Seconds East 17.2 feet
thence North 50 Degrees 43 Minutes 06 Seconds East 17.7 feet
thence North 50 Degrees 11 Minutes 12 Seconds East 17 feet
thence North 50 Degrees 40 Minutes 26 Seconds East 15.6 feet
thence North 49 Degrees 23 Minutes 43 Seconds East 14.2 feet
thence North 52 Degrees 31 Minutes 29 Seconds East 11.9 feet
thence North 51 Degrees 02 Minutes 58 Seconds East 10.5 feet
thence North 54 Degrees 20 Minutes 49 Seconds East 12.5 feet
thence North 52 Degrees 18 Minutes 14 Seconds East 7 feet
thence North 51 Degrees 25 Minutes 09 Seconds East 7.9 feet
thence North 52 Degrees 28 Minutes 28 Seconds East 10.3 feet
thence North 52 Degrees 13 Minutes 59 Seconds East 12.4 feet
thence North 54 Degrees 00 Minutes 10 Seconds East 12.9 feet
thence North 55 Degrees 12 Minutes 03 Seconds East 12.7 feet
thence North 53 Degrees 08 Minutes 11 Seconds East 12.7 feet
thence North 56 Degrees 58 Minutes 27 Seconds East 10.9 feet
thence North 55 Degrees 25 Minutes 21 Seconds East 8.7 feet
thence North 52 Degrees 18 Minutes 14 Seconds East 7 feet

thence North 50 Degrees 14 Minutes 13 Seconds East 7.2 feet
thence North 51 Degrees 39 Minutes 44 Seconds East 9.6 feet
thence North 56 Degrees 48 Minutes 15 Seconds East 13.3 feet
thence North 54 Degrees 10 Minutes 18 Seconds East 16.9 feet
thence North 55 Degrees 45 Minutes 01 Seconds East 19.4 feet
thence North 56 Degrees 31 Minutes 51 Seconds East 20.4 feet
thence North 58 Degrees 35 Minutes 13 Seconds East 20.3 feet
thence North 55 Degrees 00 Minutes 51 Seconds East 20.8 feet
thence North 55 Degrees 29 Minutes 37 Seconds East 19.8 feet
thence North 60 Degrees 33 Minutes 41 Seconds East 19.5 feet
thence North 58 Degrees 44 Minutes 44 Seconds East 19.1 feet
thence North 59 Degrees 05 Minutes 27 Seconds East 18.7 feet
thence North 59 Degrees 50 Minutes 00 Seconds East 17.8 feet
thence North 59 Degrees 57 Minutes 52 Seconds East 18.5 feet
thence North 60 Degrees 56 Minutes 30 Seconds East 19.1 feet
thence North 62 Degrees 18 Minutes 06 Seconds East 20 feet
thence North 61 Degrees 54 Minutes 28 Seconds East 20.4 feet
thence North 62 Degrees 18 Minutes 06 Seconds East 20 feet
thence North 62 Degrees 43 Minutes 45 Seconds East 20.3 feet
thence North 63 Degrees 08 Minutes 39 Seconds East 19.8 feet
thence North 63 Degrees 08 Minutes 39 Seconds East 19.8 feet
thence North 63 Degrees 34 Minutes 42 Seconds East 19.4 feet
thence North 64 Degrees 30 Minutes 29 Seconds East 18.5 feet
thence North 63 Degrees 35 Minutes 43 Seconds East 18.6 feet
thence North 62 Degrees 40 Minutes 42 Seconds East 18.1 feet
thence North 63 Degrees 35 Minutes 43 Seconds East 18.6 feet
thence North 64 Degrees 33 Minutes 52 Seconds East 17.8 feet
thence North 64 Degrees 37 Minutes 33 Seconds East 17 feet
thence North 62 Degrees 06 Minutes 43 Seconds East 16.3 feet
thence North 64 Degrees 21 Minutes 47 Seconds East 13.8 feet
thence North 64 Degrees 35 Minutes 40 Seconds East 11.6 feet
thence North 67 Degrees 05 Minutes 22 Seconds East 8.5 feet
thence North 63 Degrees 08 Minutes 39 Seconds East 7.3 feet
thence North 63 Degrees 08 Minutes 39 Seconds East 7.3 feet
thence North 64 Degrees 41 Minutes 33 Seconds East 10.9 feet
thence North 62 Degrees 00 Minutes 35 Seconds East 14.8 feet
thence North 65 Degrees 15 Minutes 55 Seconds East 7.9 feet
thence North 63 Degrees 08 Minutes 39 Seconds East 10.3 feet
thence North 62 Degrees 14 Minutes 05 Seconds East 18.5 feet
thence North 61 Degrees 54 Minutes 28 Seconds East 20.4 feet
thence North 61 Degrees 31 Minutes 50 Seconds East 20.8 feet
thence North 61 Degrees 10 Minutes 09 Seconds East 21.3 feet
thence North 62 Degrees 21 Minutes 34 Seconds East 21.4 feet
thence North 60 Degrees 23 Minutes 57 Seconds East 21.5 feet
thence North 61 Degrees 10 Minutes 09 Seconds East 21.3 feet
thence North 60 Degrees 23 Minutes 57 Seconds East 21.5 feet
thence North 61 Degrees 31 Minutes 50 Seconds East 20.8 feet
thence North 61 Degrees 05 Minutes 56 Seconds East 20.6 feet
thence North 60 Degrees 39 Minutes 17 Seconds East 20.3 feet

thence North 60 Degrees 11 Minutes 52 Seconds East 20 feet
 thence North 60 Degrees 05 Minutes 08 Seconds East 19.3 feet
 thence North 60 Degrees 56 Minutes 30 Seconds East 19.1 feet
 thence North 60 Degrees 56 Minutes 30 Seconds East 19.1 feet
 thence North 61 Degrees 48 Minutes 43 Seconds East 18.9 feet
 thence North 63 Degrees 35 Minutes 43 Seconds East 18.6 feet
 thence North 64 Degrees 01 Minutes 57 Seconds East 18.9 feet
 thence North 64 Degrees 01 Minutes 57 Seconds East 18.9 feet
 thence North 65 Degrees 50 Minutes 57 Seconds East 18.7 feet
 thence North 69 Degrees 02 Minutes 05 Seconds East 18.6 feet
 thence North 68 Degrees 40 Minutes 18 Seconds East 18.3 feet
 thence North 72 Degrees 54 Minutes 39 Seconds East 18.2 feet
 thence North 69 Degrees 59 Minutes 13 Seconds East 18.5 feet
 thence North 72 Degrees 54 Minutes 39 Seconds East 18.2 feet
 thence North 76 Degrees 38 Minutes 24 Seconds East 18.9 feet
 thence North 76 Degrees 51 Minutes 42 Seconds East 19.2 feet
 thence North 76 Degrees 51 Minutes 42 Seconds East 19.2 feet
 thence North 80 Degrees 34 Minutes 45 Seconds East 18.6 feet
 thence North 81 Degrees 16 Minutes 56 Seconds East 17.9 feet
 thence North 82 Degrees 02 Minutes 33 Seconds East 17.2 feet
 thence North 85 Degrees 02 Minutes 33 Seconds East 16.1 feet
 thence North 84 Degrees 50 Minutes 41 Seconds East 15.5 feet
 thence North 85 Degrees 48 Minutes 31 Seconds East 14.5 feet
 thence North 87 Degrees 02 Minutes 46 Seconds East 14.1 feet
 thence North 85 Degrees 25 Minutes 12 Seconds East 13.2 feet
 thence North 89 Degrees 42 Minutes 33 Seconds East 11.5 feet
 thence North 86 Degrees 07 Minutes 58 Seconds East 10.5 feet
 thence North 89 Degrees 42 Minutes 33 Seconds East 8.5 feet
 thence North 83 Degrees 59 Minutes 55 Seconds East 6.6 feet
 thence North 89 Degrees 42 Minutes 33 Seconds East 7.2 feet
 thence North 89 Degrees 42 Minutes 33 Seconds East 7.5 feet
 thence North 89 Degrees 42 Minutes 33 Seconds East 8.5 feet
 thence North 89 Degrees 42 Minutes 33 Seconds East 10.5 feet
 thence North 89 Degrees 42 Minutes 33 Seconds East 13.8 feet
 thence North 89 Degrees 42 Minutes 33 Seconds East 17.1 feet
 thence South 88 Degrees 14 Minutes 42 Seconds East 18.4 feet
 thence North 89 Degrees 42 Minutes 33 Seconds East 18.4 feet
 thence South 88 Degrees 05 Minutes 16 Seconds East 17.1 feet
 thence North 89 Degrees 42 Minutes 33 Seconds East 16.1 feet
 thence South 86 Degrees 17 Minutes 59 Seconds East 14.1 feet
 thence North 89 Degrees 42 Minutes 33 Seconds East 8.2 feet

thence North 88 Degrees 08 Minutes 49 Seconds East 36.1 feet more or less to **the ending point at:** 38 degrees 38 minutes 13.79 seconds North Latitude and -112 degrees 50 minutes 46.83 seconds West Longitude, which can be converted to mapping accuracy State Plane Utah Central Zone NAD 83 feet coordinates of X = 1,255,800.8 feet and Y = 6,675,233.1 feet.

Appendix B to Attachment 4

Popular Name: Antelope Point Cutoff Road

County: Millard

County Road Number: MC208

State Geographic Information Database (SGID) Road Identification Number: RD141159.

Road-Segment Number: 003

Road-Segment Length: 0.02 miles more or less.

Believed owner of the land underlying this road-segment is: Bureau of Land Management.

The following description is based upon the geographic coordinate system using the NAD83 Datum. The source is GPS mapping grade data as indicated in the metadata and/or the transportation data model of the State of Utah Geographic Information Database (SGID).

The road-segment itself is the monument that is identified by its physical presence on the land. The location of said physical presence is closely approximated by mapping grade Global Positioning System (GPS) data. Said data are checked against the corresponding gray-scale 1-meter Digital Orthophoto Quadrangles published by the United States Geological Survey (USGS) to verify a reasonable degree of accuracy. In circumstances where accurate satellite signal acquisition is not possible, such as deep, narrow canyons or under a canopy of dense foliage, or where very sharp curves in the road make accuracy questionable, such portions of the road were digitized from the corresponding gray-scale 1-meter Digital Orthophoto Quadrangles published by the United States Geological Survey (USGS).

This road-segment may traverse:

Township 25 South Range 9 West, Section(s) 15, Salt Lake Base & Meridian

The following description closely approximates the location of the centerline of the physical monument (Antelope Point Cutoff Road)-- Segment 003 based on mapping grade Global Positioning System (GPS) data as defined above:

Beginning at a point on the road center line located at 38 degrees 38 minutes 13.79 seconds North Latitude and -112 degrees 50 minutes 46.83 seconds West Longitude, which can be converted to mapping accuracy State Plane Utah Central Zone NAD 83 feet coordinates of X = 1,255,800.8 feet and Y = 6,675,233.1 feet; thence the following courses along the said road center line:

thence North 13 Degrees 34 Minutes 24 Seconds East 79.4 feet more or less to **the ending point at:** 38 degrees 38 minutes 14.56 seconds North Latitude and -112 degrees 50 minutes 46.61 seconds West Longitude, which can be converted to mapping accuracy State Plane Utah Central Zone NAD 83 feet coordinates of X = 1,255,819.5 feet and Y = 6,675,310.3 feet.

Appendix C to Attachment 4

Popular Name: Antelope Point Cutoff Road

County: Millard

County Road Number: MC208

State Geographic Information Database (SGID) Road Identification Number: RD141159.

Road-Segment Number: 004

Road-Segment Length: 0.04 miles more or less.

Believed owner of the land underlying this road-segment is: Bureau of Land Management.

The following description is based upon the geographic coordinate system using the NAD83 Datum. The source is GPS mapping grade data as indicated in the metadata and/or the transportation data model of the State of Utah Geographic Information Database (SGID).

The road-segment itself is the monument that is identified by its physical presence on the land. The location of said physical presence is closely approximated by mapping grade Global Positioning System (GPS) data. Said data are checked against the corresponding gray-scale 1-meter Digital Orthophoto Quadrangles published by the United States Geological Survey (USGS) to verify a reasonable degree of accuracy. In circumstances where accurate satellite signal acquisition is not possible, such as deep, narrow canyons or under a canopy of dense foliage, or where very sharp curves in the road make accuracy questionable, such portions of the road were digitized from the corresponding gray-scale 1-meter Digital Orthophoto Quadrangles published by the United States Geological Survey (USGS).

This road-segment may traverse:

Township 25 South Range 9 West, Section(s) 15, Salt Lake Base & Meridian

The following description closely approximates the location of the centerline of the physical monument (Antelope Point Cutoff Road)-- Segment 004 based on mapping grade Global Positioning System (GPS) data as defined above:

Beginning at a point on the road center line located at 38 degrees 38 minutes 13.79 seconds North Latitude and -112 degrees 50 minutes 46.83 seconds West Longitude, which can be converted to mapping accuracy State Plane Utah Central Zone NAD 83 feet coordinates of X = 1,255,800.8 feet and Y = 6,675,233.1 feet; thence the following courses along the said road center line:

thence North 87 Degrees 39 Minutes 50 Seconds East 46 feet

thence North 86 Degrees 31 Minutes 46 Seconds East 11.8 feet

thence North 86 Degrees 34 Minutes 05 Seconds East 161.7 feet more or less to **the ending**

point at: 38 degrees 38 minutes 13.94 seconds North Latitude and -112 degrees 50 minutes 44.07 seconds West Longitude, which can be converted to mapping accuracy State Plane Utah Central Zone NAD 83 feet coordinates of X = 1,256,020.0 feet and Y = 6,675,245.4 feet.