

**Acknowledgment and  
Notice of Acknowledgment  
of Acceptance of R.S. 2477  
Right-of-Way Grant**



**THE STATE OF UTAH**

**TO ALL WHOM THESE PRESENTS SHALL COME, Greeting:**

**Know ye,** This is an Acknowledgment and Notice of Acknowledgment made under Utah Code Sections 72-5-309 through 310 inclusive, that the grant of the United States of America of “the right of way for the construction of highways over public lands, not reserved for public uses” under United States Revised Statutes 2477 (43 U.S.C. Section 932 (repealed October 21, 1976, with proviso recognizing the validity of rights-of-way already established)) was accepted for and on behalf of the State of Utah and its political subdivision Millard County as it pertains to the highway located in Millard County known as Coyote Springs Road; County Road Number: MC241; State Geographic Information Database (SGID) Road Identification Number: RD141216. Total road length is 9.04 miles more or less.

The reason for this Acknowledgment and Notice of Acknowledgment includes, but is not limited to, the fact that the road was constructed, mechanically, or by continuous use as a public highway for a period of at least ten years, over public lands not reserved for public uses, prior to the earlier of (a) the October 21, 1976 repeal of R.S. 2477 or (b) the date the servient estate was reserved for public uses.

This Acknowledgment and Notice of Acknowledgment applies only to the segments of the road that traverse land owned by the Bureau of Land Management, United States Department of the Interior, and does not apply to segments of the road that traverse land owned by any other person or entity. The State of Utah and its political subdivisions reserve the right to make further acknowledgments and notices of acknowledgment with regard to road segments that traverse land owned by other entities, including the United States of America, through one or more of its agencies.

A printed copy of a map showing the location of the road in said county is appended hereto as “Attachment 1,” a printed copy of representative photos of the road is appended hereto as “Attachment 2,” a printed copy of a description of the beginning and ending points of the entire road together with a list of Townships, Ranges and Sections that may be traversed by the road in said county is appended hereto as “Attachment 3,” and a printed copy of the Road Centerline Description Cover Page(s) is appended hereto as “Attachment 4.” The Appendices listed in “Attachment 4” that contain the actual road centerline descriptions are incorporated herein by reference. Affidavits provided by individuals familiar with the road are appended hereto as “Attachment 5.”

A printed copy of this Acknowledgment and Notice of Acknowledgment, together with its Attachments and Appendices, may be viewed and/or obtained at the office of the Utah State Archives.

An electronic copy of this Acknowledgment and Notice of Acknowledgment, together with its Attachments and Appendices, may be viewed and/or downloaded as read-only PDF (Portable Document Format) files via the

Internet at <http://recorded2477roads.utah.gov>.

The owner of the servient estate in the land underlying the road-segments subject to this Acknowledgment and Notice is believed to be the United States of America through one or more of its agencies. Any of such agencies or any other person with a servient ownership claim or a competing dominant estate right-of-way ownership claim, may file a petition in the State District Court for Salt Lake County for a decision regarding the correctness of this Acknowledgment. A claimant shall file a petition within sixty (60) days after receipt of this Notice.

**In Witness Whereof**, I, John Harja, the official designee of the Governor of the State of Utah, in conformity to the laws of the State (Utah Code Sections 72-5-308 through 310 inclusive), have caused this Acknowledgment and Notice of Acknowledgment to be made.

Signed by my hand in Salt Lake City, Utah, the 23<sup>rd</sup> day of April, 2008.

By the Governor's Designee

  
\_\_\_\_\_  
John Harja

**CERTIFICATION**

State of Utah                    )  
  : ss  
County of Salt Lake         )

I hereby certify that the signer of the foregoing document, John Harja, is personally known by me, has made a voluntary signature and taken an oath stating that he is the official designee of the Governor of the State of Utah and is authorized to sign this document on the Governor's behalf pursuant to Utah Code Section 72-5-309. He further vouched that, based upon information and belief, the facts alleged therein are true.

Dated this 23<sup>rd</sup> day of April, 2008.

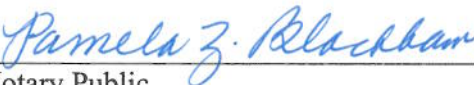

  
\_\_\_\_\_  
Notary Public



00165774

B: 485 P: 523 Fee \$0.00  
Connie Hansen, Millard Recorder  
05/14/2008 10:08:44 AM By UT STATE GOVERNOR

Page 3 of 13



Map prepared by the State of Utah  
Automated Geographic Reference Center  
Room 5130 State Office Building  
Salt Lake City, Utah 84114  
Mar 20, 2008

### Coyote Springs Road - Millard County SGID RD\_ID RD141216

#### Land Ownership Categories

- BLM
- Private
- SITLA, State Trust Land
- USFS, National Forest
- State Parks and Recreation
- Tribal, Indian Reservation
- NPS, National Park

#### Transportation Network

- Coyote Springs Road
- Other Roads
- Title V, Issued Or Under Consideration By BLM Or County
- Photo Event Point
- Section = 1 Mile

#### Wilderness

- UDWR Wildlife Reserve
- DOD, Military
- State Sovereign Land
- National Recreation Area
- USFWS, Natl. Wildlife Refuge



1:57,469  
1 inch equals 0.9 miles

Attachment 2



EP141216004



EP141216007



EP141216011



EP141216012

EP000000000

EP000000000

00165774

B: 485 P: 524 Fee \$0.00 Page 4 of 13  
Connie Hansen, Millard Recorder  
05/14/2008 10:08:44 AM By UT STATE GOVERNOR



Coyote Springs Road - Millard County  
SGID RD\_ID RD141216

Map prepared by the State of Utah  
Automated Geographic Reference Center  
Room 5130 State Office Building  
Salt Lake City, Utah 84114  
November 22, 2006



### Attachment 3

#### Beginning & Ending Points and Township, Range, and Section References For:

**Popular Name: Coyote Springs Road**

**County: Millard**

**County Road Number: MC241**

**State Geographic Information Database (SGID) Road Identification Number: RD141216.**

**Total Road Length: 9.04 miles more or less.**

**Beginning at a point** on the road centerline located at 39 degrees 24 minutes 31 seconds North Latitude and -113 degrees 38 minutes 44.38 seconds West Longitude, which can be converted to mapping accuracy State Plane Utah Central Zone NAD 83 feet coordinates of X = 1,034,231.3 feet and Y = 6,960,591.1 feet based on the US Survey Foot conversion.

**Ending at a point** on the road centerline located at 39 degrees 25 minutes 25.94 seconds North Latitude and -113 degrees 29 minutes 16.55 seconds West Longitude, which can be converted to mapping accuracy State Plane Utah Central Zone NAD 83 feet coordinates of X = 1,078,908.6 feet and Y = 6,965,119.0 feet based on the US Survey Foot conversion.

This road may traverse:

Township 16 South Range 15 West, Section(s) 7,8,9,10,11,12,13,14, Salt Lake Base & Meridian  
Township 16 South Range 16 West, Section(s) 12,13,14,15,21,22, Salt Lake Base & Meridian  
See Attachment 1 above for a cartographic depiction of the course of this road.

**00165774**

B: 485 P: 525 Fee \$0.00  
Connie Hansen, Millard Recorder  
05/14/2008 10:08:44 AM By UT STATE GOVERNOR Page 5 of 13



**Attachment 4  
Road Centerline Description Cover Page(s)**

**Popular Name: Coyote Springs Road**

**County: Millard**

**County Road Number: MC241**

**State Geographic Information Database (SGID) Road Identification Number: RD141216.**

**Total Road Length: 9.04 miles more or less.**

**Centerline Descriptions Of Road-Segments That Cross Over Federally Owned Land, Derived From Global Positioning System Data And Cross-checked against USGS Digital Orthophoto Quadrangles Compiled By The Utah Automated Geographic Reference Center And Entered Into The State Geographic Information Database (SGID).**

<b>Road-Segments Listed by SGID Road Identification Number (RD_ID)</b>	<b>Road-Segment Numbers</b>	<b>Believed Ownership Of Servient Estate</b>	<b>Approximate Segment Length</b>	<b>See Attached Appendix</b>
<b>RD141216</b>	<b>001</b>	<b>BLM</b>	<b>8.88 Miles</b>	<b>A</b>
<b>RD141216</b>	<b>002</b>	<b>BLM</b>	<b>0.16 Miles</b>	<b>B</b>
		<b>Total Road Length</b>	<b>9.04</b>	<b>_____</b>

\* Indicates that a Title V permit will be requested, is in process, or has been issued.

† Indicates that road-segments crossing Forest Service land are under consideration by the state and county as of the date of this Acknowledgment and Notice of Acknowledgment.

**00165774**

B: 485 P: 526 Fee \$0.00  
 Connie Hansen, Millard Recorder  
 05/14/2008 10:08:44 AM By UT STATE GOVERNOR Page 6 of 13



**Attachment 5**

**00165774**

B: 485 P: 527 Fee \$0.00

Connie Hansen, Millard Recorder

05/14/2008 10:08:44 AM

By UT STATE GOVERNOR

Page 7 of 13



**AFFIDAVIT OF JAY ATKINSON**

**COYOTE SPRINGS ROAD**

**MILLARD COUNTY, UTAH**

**ROAD NUMBER MC 241**

State of Utah                    )  
  : ss.  
County of Millard                )

JAY ATKINSON, being first duly sworn, deposes and states as follows:

1. I am an adult competent to testify about the matters set forth below based upon my personal knowledge. I currently reside in Millard County, Utah. I have lived in Millard County for sixty-eight years. I was an employee of the Millard County Road Department from February of 1970 to April of 2000, and participated in maintenance of the road during that time.

2. I have traveled and am familiar with a road in Millard County known as Coyote Springs Road. I am also familiar with the land the road traverses. When I first used and observed the road in the early 1940s, it followed the same route as in 2006 when I last observed it. Attached is a Millard County map showing Coyote Springs Road. To the best of my knowledge and based upon my use of and familiarity with this road and the land it traverses, the location and route of the road are correctly illustrated on the attached map.

3. I am informed that the County also identifies this road according to the road number listed above.

4. I have observed that the road has been open to the public for all to use, to come and go as they pleased, since at least as early as the early 1940s and continuing through 1976 to 2006. Throughout this time period I have observed travel on the road by various means, including cars, trucks, recreational vehicles, and pickup trucks. Throughout this time period, the road has been used weekly for more than ten continuous years prior to 1976, and is presently used weekly.

**00165774**

B: 485 P: 528 Fee \$0.00 Page 8 of 13  
Connie Hansen, Millard Recorder By UT STATE GOVERNOR  
05/14/2008 10:08:44 AM





5. Throughout the time period from the early 1940s to 2006, I have used the road myself for the following uses: hunting, rock hounding, county road work and recreation.

6. Throughout the time period described in the previous paragraph, I observed other vehicles from the general public using the road at various times for the uses described in the previous paragraph, plus the following uses: livestock operations, trapping, government access, picnicking, traveling in and through the area, hiking and sightseeing.

7. It is also the reputation in the community that this road has been open to the public for all to use, to come and go as they pleased, since at least as early as the early 1930s and continuing through 1976 to the present, for the uses described in the previous paragraphs.

8. Prior to 1976, I participated in maintenance and construction activities on the road. Construction and maintenance have been performed since the early 1950s by Millard County Road Department.

DATED this 6 day of December, 2006.

  
\_\_\_\_\_  
JAY ATKINSON

SUBSCRIBED AND SWORN to before me this 6<sup>th</sup> day of December, 2006.

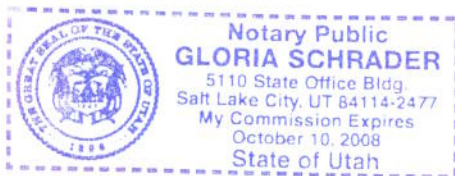

  
\_\_\_\_\_  
NOTARY PUBLIC

**00165774**

B: 485 P: 529 Fee \$0.00  
Connie Hansen, Millard Recorder  
05/14/2008 10:08:44 AM By UT STATE GOVERNOR Page 9 of 13



**ROAD = MC241  
COYOTE SPRINGS ROAD**



**00165774**  
 B: 485 P: 530 Fee \$0.00  
 Connie Hansen, Millard Recorder Page 10 of 13  
 05/14/2008 10:08:44 AM By UT STATE GOVERNOR

**M I L L A R D C O U N T Y**

**— B Class Road of Interest**

— Interstate	— County Border	— Township & Range Line
— Highway Major	— River	— Forest Service Lands
— Highway Minor	— Cities / Towns	— BLM Lands
— B Class Road	— Lakes	— State Trust Lands
— Unimproved Road	— Lakes - Intermittent	— Private Lands

0.6 0.3 0 0.6  
Miles

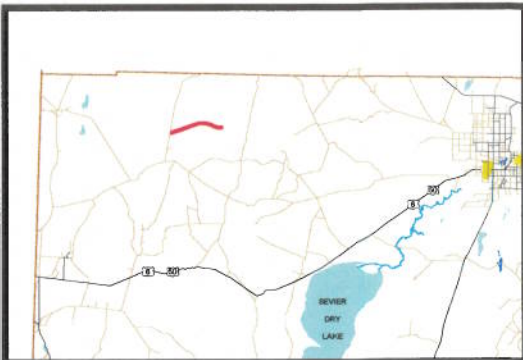

**AFFIDAVIT OF WILLIAM THAYNE HENRIE**

**COYOTE SPRINGS ROAD**

**MILLARD COUNTY, UTAH**

**ROAD NUMBER MC241**

State of Utah                    )  
  : ss.  
County of Millard                )

WILLIAM THAYNE HENRIE, being first duly sworn, deposes and states as follows:

1. I am an adult competent to testify about the matters set forth below based upon my personal knowledge. I currently reside in Millard County, Utah. I have lived in Millard County for fifty-eight years. I have been an employee of the Millard County Road Department since June of 1990, have been the Road Department Supervisor from January 1993 to the present and have participated in maintenance of the road during that time.

2. I have traveled and am familiar with a road in Millard County known as Coyote Springs Road. I am also familiar with the land the road traverses. When I first used and observed the road in the 1950s, it followed the same route as in 2006 when I last observed it. Attached is a Millard County map showing Coyote Springs Road. To the best of my knowledge and based upon my use of and familiarity with this road and the land it traverses, the location and route of the road are correctly illustrated on the attached map.

3. I am informed that the County also identifies this road according to the road number listed above.

4. I have observed that the road has been open to the public for all to use, to come and go as they pleased, since at least as early as the 1950s and continuing through 1976 to the present. Throughout this time period I have observed travel on the road by means of cars, trucks, recreational vehicles, and pickup trucks. Throughout this time period, the road has been used weekly for more than ten continuous years prior to 1976, and is presently used weekly.

**00165774**

B: 485 P: 531 Fee \$0.00

Connie Hansen, Millard Recorder

05/14/2008 10:08:44 AM

By UT STATE GOVERNOR

Page 11 of 13



5. Throughout the time period from the 1950s to the present, I have used the road myself for camping, gathering fire wood, hunting, rock hounding, participating in search and rescue efforts and recreation.

6. Throughout the time period described in the previous paragraph, I have observed other vehicles from the general public using the road at various times for the uses described in the previous paragraph, plus mining, prospecting for minerals, livestock operations, trapping, tourism, government access, picnicking, hiking and sightseeing.

7. It is also the reputation in the community that this road has been open to the public for all to use, to come and go as they pleased, since at least as early as the early 1900s and continuing through 1976 to the present, for the uses described in the previous paragraphs.

8. Prior to 1976 I observed graders and other maintenance equipment performing maintenance and construction activities on the road. Maintenance on the road has been performed since 1955 by the Millard County Road Department.

DATED this 5 day of December, 2006.

  
WILLIAM THAYNE HENRIE

SUBSCRIBED AND SWORN to before me this 5th day of December, 2006.

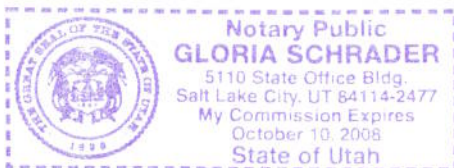

  
NOTARY PUBLIC



**ROAD = MC241  
COYOTE SPRINGS ROAD**



**00165774**

B: 485 P: 533 Fee \$0.00  
 Connie Hansen, Millard Recorder Page 13 of 13  
 05/14/2008 10:08:44 AM By UT STATE GOVERNOR



**M I L L A R D C O U N T Y**

— B Class Road of Interest

- |                   |                        |                         |
|-------------------|------------------------|-------------------------|
| — Interstate      | — County Border        | — Township & Range Line |
| — Highway Major   | — River                | — Forest Service Lands  |
| — Highway Minor   | — Cities / Towns       | — BLM Lands             |
| — B Class Road    | — Lakes                | — State Trust Lands     |
| — Unimproved Road | — Lakes - Intermittent | — Private Lands         |

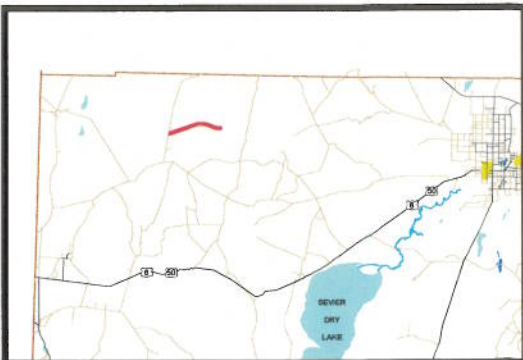

## Appendix A to Attachment 4

**Popular Name: Coyote Springs Road**

**County: Millard**

**County Road Number: MC241**

**State Geographic Information Database (SGID) Road Identification Number: RD141216.**

**Road-Segment Number: 001**

**Road-Segment Length: 8.88 miles more or less.**

**Believed owner of the land underlying this road-segment is: Bureau of Land Management.**

*The following description is based upon the geographic coordinate system using the NAD83 Datum. The source is GPS mapping grade data as indicated in the metadata and/or the transportation data model of the State of Utah Geographic Information Database (SGID).*

The road-segment itself is the monument that is identified by its physical presence on the land. The location of said physical presence is closely approximated by mapping grade Global Positioning System (GPS) data. Said data are checked against the corresponding gray-scale 1-meter Digital Orthophoto Quadrangles published by the United States Geological Survey (USGS) to verify a reasonable degree of accuracy. In circumstances where accurate satellite signal acquisition is not possible, such as deep, narrow canyons or under a canopy of dense foliage, or where very sharp curves in the road make accuracy questionable, such portions of the road were digitized from the corresponding gray-scale 1-meter Digital Orthophoto Quadrangles published by the United States Geological Survey (USGS).

This road-segment may traverse:

Township 16 South Range 15 West, Section(s) 7,8,9,10,11,13,14, Salt Lake Base & Meridian

Township 16 South Range 16 West, Section(s) 12,13,14,15,21,22, Salt Lake Base & Meridian

The following description closely approximates the location of the centerline of the physical monument (Coyote Springs Road)-- Segment 001 based on mapping grade Global Positioning System (GPS) data as defined above:

**Beginning at a point** on the road center line located at 39 degrees 24 minutes 31 seconds North Latitude and -113 degrees 38 minutes 44.38 seconds West Longitude, which can be converted to mapping accuracy State Plane Utah Central Zone NAD 83 feet coordinates of X = 1,034,231.3 feet and Y = 6,960,591.1 feet; thence the following courses along the said road center line:

thence South 81 Degrees 19 Minutes 59 Seconds East	6.3 feet
thence North 85 Degrees 36 Minutes 30 Seconds East	32.2 feet
thence North 87 Degrees 44 Minutes 29 Seconds East	57.8 feet
thence North 86 Degrees 11 Minutes 49 Seconds East	118.3 feet
thence North 85 Degrees 07 Minutes 39 Seconds East	103 feet
thence North 82 Degrees 34 Minutes 08 Seconds East	5.3 feet
thence North 81 Degrees 14 Minutes 47 Seconds East	33.5 feet
thence North 76 Degrees 55 Minutes 07 Seconds East	115.7 feet
thence North 72 Degrees 51 Minutes 01 Seconds East	37.4 feet
thence North 75 Degrees 39 Minutes 28 Seconds East	40.6 feet
thence North 74 Degrees 23 Minutes 09 Seconds East	93.2 feet

thence North 72 Degrees 39 Minutes 22 Seconds East 63.8 feet  
 thence North 72 Degrees 00 Minutes 51 Seconds East 165.2 feet  
 thence North 71 Degrees 30 Minutes 04 Seconds East 196.4 feet  
 thence North 71 Degrees 36 Minutes 38 Seconds East 101.4 feet  
 thence North 71 Degrees 26 Minutes 11 Seconds East 100.5 feet  
 thence North 71 Degrees 24 Minutes 45 Seconds East 193.4 feet  
 thence North 71 Degrees 03 Minutes 58 Seconds East 184.8 feet  
 thence North 71 Degrees 15 Minutes 32 Seconds East 11.4 feet  
 thence North 71 Degrees 00 Minutes 29 Seconds East 165.8 feet  
 thence North 71 Degrees 24 Minutes 11 Seconds East 165.1 feet  
 thence North 71 Degrees 45 Minutes 43 Seconds East 130 feet  
 thence North 70 Degrees 12 Minutes 28 Seconds East 90.5 feet  
 thence North 73 Degrees 41 Minutes 34 Seconds East 46.4 feet  
 thence North 73 Degrees 21 Minutes 28 Seconds East 19.8 feet  
 thence North 71 Degrees 35 Minutes 48 Seconds East 105.6 feet  
 thence North 70 Degrees 59 Minutes 19 Seconds East 131.9 feet  
 thence North 70 Degrees 23 Minutes 38 Seconds East 89.3 feet  
 thence North 73 Degrees 38 Minutes 53 Seconds East 77.1 feet  
 thence North 71 Degrees 15 Minutes 32 Seconds East 196 feet  
 thence North 70 Degrees 53 Minutes 17 Seconds East 192.3 feet  
 thence North 71 Degrees 23 Minutes 13 Seconds East 185.9 feet  
 thence North 71 Degrees 28 Minutes 24 Seconds East 194.1 feet  
 thence North 71 Degrees 20 Minutes 48 Seconds East 203.2 feet  
 thence North 71 Degrees 05 Minutes 11 Seconds East 206.6 feet  
 thence North 70 Degrees 26 Minutes 39 Seconds East 197 feet  
 thence North 72 Degrees 01 Minutes 16 Seconds East 179.3 feet  
 thence North 70 Degrees 33 Minutes 02 Seconds East 151 feet  
 thence North 71 Degrees 59 Minutes 12 Seconds East 114.3 feet  
 thence North 71 Degrees 19 Minutes 13 Seconds East 96.8 feet  
 thence North 70 Degrees 32 Minutes 29 Seconds East 116 feet  
 thence North 70 Degrees 53 Minutes 38 Seconds East 65.1 feet  
 thence North 72 Degrees 49 Minutes 45 Seconds East 87.1 feet  
 thence North 71 Degrees 34 Minutes 19 Seconds East 113.9 feet  
 thence North 71 Degrees 27 Minutes 23 Seconds East 210.7 feet  
 thence North 71 Degrees 15 Minutes 32 Seconds East 201.2 feet  
 thence North 71 Degrees 13 Minutes 43 Seconds East 196.8 feet  
 thence North 70 Degrees 56 Minutes 30 Seconds East 206.1 feet  
 thence North 71 Degrees 15 Minutes 32 Seconds East 204.3 feet  
 thence North 71 Degrees 15 Minutes 32 Seconds East 187.7 feet  
 thence North 71 Degrees 40 Minutes 41 Seconds East 155.9 feet  
 thence North 71 Degrees 18 Minutes 42 Seconds East 112.3 feet  
 thence North 70 Degrees 27 Minutes 18 Seconds East 103.5 feet  
 thence North 70 Degrees 46 Minutes 09 Seconds East 121.4 feet  
 thence North 70 Degrees 25 Minutes 42 Seconds East 35.8 feet  
 thence North 73 Degrees 13 Minutes 11 Seconds East 87.9 feet  
 thence North 72 Degrees 59 Minutes 40 Seconds East 6.8 feet  
 thence North 69 Degrees 19 Minutes 02 Seconds East 12.2 feet  
 thence North 70 Degrees 51 Minutes 32 Seconds East 118.9 feet  
 thence North 71 Degrees 34 Minutes 07 Seconds East 210.9 feet

thence North 71 Degrees 58 Minutes 56 Seconds East 172.5 feet  
 thence North 70 Degrees 55 Minutes 37 Seconds East 125.4 feet  
 thence North 70 Degrees 13 Minutes 52 Seconds East 46.3 feet  
 thence North 72 Degrees 47 Minutes 04 Seconds East 128.6 feet  
 thence North 70 Degrees 26 Minutes 21 Seconds East 224.8 feet  
 thence North 71 Degrees 18 Minutes 47 Seconds East 218.4 feet  
 thence North 71 Degrees 26 Minutes 46 Seconds East 222.1 feet  
 thence North 71 Degrees 24 Minutes 08 Seconds East 206.9 feet  
 thence North 71 Degrees 02 Minutes 55 Seconds East 198 feet  
 thence North 71 Degrees 15 Minutes 31 Seconds East 223 feet  
 thence North 71 Degrees 00 Minutes 53 Seconds East 219.2 feet  
 thence North 71 Degrees 17 Minutes 11 Seconds East 214 feet  
 thence North 71 Degrees 07 Minutes 09 Seconds East 213.1 feet  
 thence North 71 Degrees 27 Minutes 15 Seconds East 212.7 feet  
 thence North 71 Degrees 41 Minutes 22 Seconds East 193.1 feet  
 thence North 71 Degrees 22 Minutes 35 Seconds East 151.3 feet  
 thence North 70 Degrees 48 Minutes 08 Seconds East 91.2 feet  
 thence North 72 Degrees 43 Minutes 05 Seconds East 65.2 feet  
 thence North 74 Degrees 58 Minutes 26 Seconds East 80 feet  
 thence North 70 Degrees 32 Minutes 43 Seconds East 25 feet  
 thence North 73 Degrees 18 Minutes 14 Seconds East 11.6 feet  
 thence North 69 Degrees 37 Minutes 19 Seconds East 54.5 feet  
 thence North 70 Degrees 56 Minutes 37 Seconds East 113.3 feet  
 thence North 70 Degrees 11 Minutes 56 Seconds East 95.3 feet  
 thence North 72 Degrees 25 Minutes 40 Seconds East 25.4 feet  
 thence North 70 Degrees 21 Minutes 31 Seconds East 19.8 feet  
 thence North 72 Degrees 07 Minutes 06 Seconds East 76 feet  
 thence North 73 Degrees 01 Minutes 53 Seconds East 97.2 feet  
 thence North 69 Degrees 38 Minutes 15 Seconds East 88 feet  
 thence North 71 Degrees 31 Minutes 06 Seconds East 91.5 feet  
 thence North 71 Degrees 04 Minutes 33 Seconds East 97.6 feet  
 thence North 71 Degrees 15 Minutes 31 Seconds East 129.6 feet  
 thence North 71 Degrees 23 Minutes 38 Seconds East 131.6 feet  
 thence North 71 Degrees 04 Minutes 19 Seconds East 127.4 feet  
 thence North 71 Degrees 21 Minutes 18 Seconds East 123 feet  
 thence North 71 Degrees 46 Minutes 41 Seconds East 125.8 feet  
 thence North 72 Degrees 20 Minutes 22 Seconds East 132 feet  
 thence North 70 Degrees 28 Minutes 35 Seconds East 121.6 feet  
 thence North 72 Degrees 11 Minutes 52 Seconds East 63.3 feet  
 thence North 71 Degrees 22 Minutes 27 Seconds East 205.6 feet  
 thence North 71 Degrees 42 Minutes 29 Seconds East 119 feet  
 thence North 71 Degrees 42 Minutes 13 Seconds East 93.5 feet  
 thence North 71 Degrees 27 Minutes 32 Seconds East 207.5 feet  
 thence North 71 Degrees 15 Minutes 30 Seconds East 206.4 feet  
 thence North 71 Degrees 45 Minutes 16 Seconds East 191.7 feet  
 thence North 70 Degrees 58 Minutes 36 Seconds East 168.6 feet  
 thence North 71 Degrees 30 Minutes 16 Seconds East 145 feet  
 thence North 70 Degrees 47 Minutes 54 Seconds East 103.3 feet  
 thence North 72 Degrees 02 Minutes 36 Seconds East 106 feet



thence North 71 Degrees 51 Minutes 34 Seconds East 128.5 feet  
 thence North 71 Degrees 36 Minutes 58 Seconds East 116.3 feet  
 thence North 71 Degrees 48 Minutes 53 Seconds East 32.1 feet  
 thence North 71 Degrees 09 Minutes 20 Seconds East 115.5 feet  
 thence North 71 Degrees 03 Minutes 56 Seconds East 184.8 feet  
 thence North 71 Degrees 21 Minutes 12 Seconds East 187.6 feet  
 thence North 71 Degrees 55 Minutes 42 Seconds East 177.4 feet  
 thence North 71 Degrees 41 Minutes 30 Seconds East 178.3 feet  
 thence North 71 Degrees 17 Minutes 47 Seconds East 155.9 feet  
 thence North 71 Degrees 02 Minutes 28 Seconds East 82 feet  
 thence North 73 Degrees 04 Minutes 21 Seconds East 22.9 feet  
 thence North 72 Degrees 41 Minutes 35 Seconds East 53.8 feet  
 thence North 68 Degrees 19 Minutes 22 Seconds East 8.1 feet  
 thence North 71 Degrees 15 Minutes 30 Seconds East 179.4 feet  
 thence North 71 Degrees 13 Minutes 55 Seconds East 225.8 feet  
 thence North 71 Degrees 22 Minutes 01 Seconds East 219.1 feet  
 thence North 71 Degrees 46 Minutes 22 Seconds East 207.9 feet  
 thence North 71 Degrees 45 Minutes 16 Seconds East 191.7 feet  
 thence North 71 Degrees 48 Minutes 41 Seconds East 182.7 feet  
 thence North 71 Degrees 48 Minutes 05 Seconds East 175.1 feet  
 thence North 71 Degrees 02 Minutes 37 Seconds East 166.2 feet  
 thence North 71 Degrees 17 Minutes 50 Seconds East 152.8 feet  
 thence North 71 Degrees 02 Minutes 13 Seconds East 134.3 feet  
 thence North 70 Degrees 22 Minutes 43 Seconds East 108.1 feet  
 thence North 70 Degrees 40 Minutes 03 Seconds East 40.2 feet  
 thence North 73 Degrees 50 Minutes 02 Seconds East 60 feet  
 thence North 71 Degrees 47 Minutes 10 Seconds East 101.3 feet  
 thence North 72 Degrees 02 Minutes 35 Seconds East 22.7 feet  
 thence North 72 Degrees 00 Minutes 49 Seconds East 110.2 feet  
 thence North 71 Degrees 23 Minutes 49 Seconds East 128.5 feet  
 thence North 71 Degrees 34 Minutes 48 Seconds East 147.7 feet  
 thence North 71 Degrees 04 Minutes 07 Seconds East 125.3 feet  
 thence North 70 Degrees 32 Minutes 15 Seconds East 66 feet  
 thence North 71 Degrees 51 Minutes 11 Seconds East 149.9 feet  
 thence North 71 Degrees 41 Minutes 44 Seconds East 67.9 feet  
 thence North 71 Degrees 39 Minutes 32 Seconds East 74.2 feet  
 thence North 71 Degrees 33 Minutes 37 Seconds East 118 feet  
 thence North 70 Degrees 40 Minutes 03 Seconds East 110.7 feet  
 thence North 70 Degrees 46 Minutes 07 Seconds East 48.5 feet  
 thence North 72 Degrees 34 Minutes 46 Seconds East 125.9 feet  
 thence North 72 Degrees 04 Minutes 50 Seconds East 130.1 feet  
 thence North 71 Degrees 21 Minutes 39 Seconds East 115.8 feet  
 thence North 71 Degrees 56 Minutes 54 Seconds East 25.8 feet  
 thence North 72 Degrees 59 Minutes 38 Seconds East 13.7 feet  
 thence North 69 Degrees 14 Minutes 37 Seconds East 82.6 feet  
 thence North 69 Degrees 03 Minutes 20 Seconds East 27 feet  
 thence North 71 Degrees 41 Minutes 54 Seconds East 189 feet  
 thence North 71 Degrees 37 Minutes 04 Seconds East 132.1 feet  
 thence North 71 Degrees 12 Minutes 34 Seconds East 122.1 feet

thence North 70 Degrees 54 Minutes 10 Seconds East 117.1 feet  
thence North 71 Degrees 21 Minutes 42 Seconds East 114.7 feet  
thence North 71 Degrees 52 Minutes 27 Seconds East 106.1 feet  
thence North 72 Degrees 47 Minutes 02 Seconds East 42.9 feet  
thence North 72 Degrees 09 Minutes 15 Seconds East 212.2 feet  
thence North 71 Degrees 36 Minutes 26 Seconds East 153.2 feet  
thence North 71 Degrees 44 Minutes 37 Seconds East 122.4 feet  
thence North 71 Degrees 25 Minutes 22 Seconds East 144.4 feet  
thence North 71 Degrees 37 Minutes 01 Seconds East 198.7 feet  
thence North 71 Degrees 11 Minutes 53 Seconds East 198.5 feet  
thence North 71 Degrees 54 Minutes 57 Seconds East 198.7 feet  
thence North 71 Degrees 18 Minutes 48 Seconds East 215.3 feet  
thence North 71 Degrees 31 Minutes 51 Seconds East 217.8 feet  
thence North 71 Degrees 08 Minutes 50 Seconds East 214.5 feet  
thence North 71 Degrees 09 Minutes 16 Seconds East 172.3 feet  
thence North 72 Degrees 58 Minutes 55 Seconds East 151.7 feet  
thence North 71 Degrees 43 Minutes 01 Seconds East 207.2 feet  
thence North 71 Degrees 12 Minutes 00 Seconds East 204.7 feet  
thence North 71 Degrees 19 Minutes 03 Seconds East 199.8 feet  
thence North 71 Degrees 31 Minutes 47 Seconds East 196.8 feet  
thence North 71 Degrees 35 Minutes 15 Seconds East 198.4 feet  
thence North 71 Degrees 48 Minutes 51 Seconds East 192.3 feet  
thence North 72 Degrees 02 Minutes 02 Seconds East 183.8 feet  
thence North 71 Degrees 20 Minutes 54 Seconds East 131.3 feet  
thence North 71 Degrees 33 Minutes 46 Seconds East 39 feet  
thence North 72 Degrees 01 Minutes 00 Seconds East 156.6 feet  
thence North 71 Degrees 28 Minutes 04 Seconds East 141.6 feet  
thence North 71 Degrees 39 Minutes 20 Seconds East 134.5 feet  
thence North 72 Degrees 18 Minutes 50 Seconds East 135.1 feet  
thence North 71 Degrees 34 Minutes 33 Seconds East 130.8 feet  
thence North 72 Degrees 09 Minutes 05 Seconds East 119.7 feet  
thence North 71 Degrees 11 Minutes 41 Seconds East 94.1 feet  
thence North 69 Degrees 48 Minutes 28 Seconds East 16.4 feet  
thence North 71 Degrees 15 Minutes 28 Seconds East 10.4 feet  
thence North 70 Degrees 10 Minutes 04 Seconds East 49.1 feet  
thence North 71 Degrees 26 Minutes 49 Seconds East 188.6 feet  
thence North 71 Degrees 48 Minutes 51 Seconds East 192.3 feet  
thence North 71 Degrees 46 Minutes 42 Seconds East 194.1 feet  
thence North 71 Degrees 46 Minutes 23 Seconds East 196.1 feet  
thence North 71 Degrees 52 Minutes 26 Seconds East 192.9 feet  
thence North 71 Degrees 17 Minutes 27 Seconds East 179.7 feet  
thence North 71 Degrees 44 Minutes 24 Seconds East 147.9 feet  
thence North 71 Degrees 43 Minutes 50 Seconds East 138.3 feet  
thence North 71 Degrees 51 Minutes 52 Seconds East 137.1 feet  
thence North 71 Degrees 26 Minutes 02 Seconds East 135 feet  
thence North 71 Degrees 32 Minutes 00 Seconds East 129.4 feet  
thence North 71 Degrees 10 Minutes 04 Seconds East 132.1 feet  
thence North 71 Degrees 35 Minutes 40 Seconds East 123.5 feet  
thence North 70 Degrees 18 Minutes 30 Seconds East 112.7 feet

thence North 71 Degrees 46 Minutes 35 Seconds East 91.7 feet  
 thence North 71 Degrees 28 Minutes 04 Seconds East 84.9 feet  
 thence North 74 Degrees 06 Minutes 42 Seconds East 70.8 feet  
 thence North 74 Degrees 19 Minutes 27 Seconds East 58.2 feet  
 thence North 73 Degrees 12 Minutes 04 Seconds East 52 feet  
 thence North 75 Degrees 46 Minutes 05 Seconds East 40.9 feet  
 thence North 77 Degrees 51 Minutes 33 Seconds East 35.2 feet  
 thence North 80 Degrees 28 Minutes 54 Seconds East 36.9 feet  
 thence North 80 Degrees 44 Minutes 50 Seconds East 35.9 feet  
 thence North 81 Degrees 37 Minutes 10 Seconds East 46.7 feet  
 thence North 85 Degrees 34 Minutes 13 Seconds East 36.5 feet  
 thence North 87 Degrees 26 Minutes 17 Seconds East 41.7 feet  
 thence North 88 Degrees 14 Minutes 46 Seconds East 65 feet  
 thence North 88 Degrees 59 Minutes 54 Seconds East 54.1 feet  
 thence North 89 Degrees 41 Minutes 34 Seconds East 49.9 feet  
 thence North 87 Degrees 15 Minutes 59 Seconds East 38.7 feet  
 thence South 87 Degrees 49 Minutes 03 Seconds East 15.1 feet  
 thence South 87 Degrees 25 Minutes 36 Seconds East 52.2 feet  
 thence North 89 Degrees 41 Minutes 34 Seconds East 125.9 feet  
 thence North 89 Degrees 28 Minutes 10 Seconds East 168.3 feet  
 thence North 89 Degrees 54 Minutes 20 Seconds East 176.5 feet  
 thence North 89 Degrees 41 Minutes 34 Seconds East 180.7 feet  
 thence North 89 Degrees 11 Minutes 37 Seconds East 188.3 feet  
 thence North 89 Degrees 23 Minutes 49 Seconds East 190.6 feet  
 thence North 89 Degrees 47 Minutes 35 Seconds East 187.3 feet  
 thence North 89 Degrees 24 Minutes 07 Seconds East 129.2 feet  
 thence North 89 Degrees 22 Minutes 40 Seconds East 59.7 feet  
 thence North 89 Degrees 41 Minutes 34 Seconds East 183.7 feet  
 thence South 89 Degrees 43 Minutes 59 Seconds East 163.7 feet  
 thence North 89 Degrees 24 Minutes 57 Seconds East 135.8 feet  
 thence North 89 Degrees 12 Minutes 55 Seconds East 118.1 feet  
 thence South 89 Degrees 57 Minutes 16 Seconds East 106.6 feet  
 thence South 89 Degrees 47 Minutes 33 Seconds East 109.6 feet  
 thence North 89 Degrees 41 Minutes 34 Seconds East 127.3 feet  
 thence South 89 Degrees 34 Minutes 28 Seconds East 128.3 feet  
 thence South 89 Degrees 35 Minutes 14 Seconds East 130.6 feet  
 thence North 88 Degrees 59 Minutes 01 Seconds East 132.5 feet  
 thence South 89 Degrees 34 Minutes 01 Seconds East 126.9 feet  
 thence South 89 Degrees 57 Minutes 43 Seconds East 108.9 feet  
 thence North 89 Degrees 41 Minutes 34 Seconds East 18.4 feet  
 thence North 89 Degrees 21 Minutes 34 Seconds East 112.8 feet  
 thence South 88 Degrees 07 Minutes 37 Seconds East 129.3 feet  
 thence South 84 Degrees 45 Minutes 42 Seconds East 33.9 feet  
 thence South 85 Degrees 36 Minutes 59 Seconds East 64.2 feet  
 thence South 80 Degrees 23 Minutes 16 Seconds East 135.2 feet  
 thence South 78 Degrees 54 Minutes 50 Seconds East 132.8 feet  
 thence South 77 Degrees 48 Minutes 32 Seconds East 133.4 feet  
 thence South 77 Degrees 41 Minutes 07 Seconds East 109.6 feet  
 thence South 77 Degrees 46 Minutes 42 Seconds East 12.1 feet

thence South 76 Degrees 16 Minutes 15 Seconds East 52.7 feet  
 thence South 76 Degrees 30 Minutes 48 Seconds East 112.8 feet  
 thence South 77 Degrees 21 Minutes 16 Seconds East 33.7 feet  
 thence South 76 Degrees 54 Minutes 53 Seconds East 14.2 feet  
 thence South 78 Degrees 48 Minutes 38 Seconds East 98.7 feet  
 thence South 76 Degrees 48 Minutes 19 Seconds East 119.4 feet  
 thence South 77 Degrees 02 Minutes 11 Seconds East 71.4 feet  
 thence South 76 Degrees 33 Minutes 14 Seconds East 48.3 feet  
 thence South 77 Degrees 21 Minutes 38 Seconds East 146.4 feet  
 thence South 77 Degrees 49 Minutes 55 Seconds East 113.9 feet  
 thence South 75 Degrees 22 Minutes 32 Seconds East 15.3 feet  
 thence South 76 Degrees 57 Minutes 10 Seconds East 113.6 feet  
 thence South 76 Degrees 45 Minutes 58 Seconds East 128.9 feet  
 thence South 77 Degrees 41 Minutes 04 Seconds East 238.6 feet  
 thence South 76 Degrees 31 Minutes 01 Seconds East 203.7 feet  
 thence South 77 Degrees 30 Minutes 55 Seconds East 201.5 feet  
 thence South 77 Degrees 29 Minutes 55 Seconds East 204.2 feet  
 thence South 76 Degrees 49 Minutes 45 Seconds East 204.1 feet  
 thence South 77 Degrees 31 Minutes 09 Seconds East 204.5 feet  
 thence South 76 Degrees 27 Minutes 16 Seconds East 198.6 feet  
 thence South 77 Degrees 04 Minutes 00 Seconds East 194.8 feet  
 thence South 77 Degrees 23 Minutes 01 Seconds East 118.8 feet  
 thence South 77 Degrees 10 Minutes 57 Seconds East 65 feet  
 thence South 77 Degrees 33 Minutes 28 Seconds East 166.5 feet  
 thence South 76 Degrees 39 Minutes 19 Seconds East 177.9 feet  
 thence South 77 Degrees 34 Minutes 14 Seconds East 196.4 feet  
 thence South 77 Degrees 13 Minutes 51 Seconds East 189.9 feet  
 thence South 76 Degrees 50 Minutes 19 Seconds East 160.5 feet  
 thence South 76 Degrees 19 Minutes 18 Seconds East 89.6 feet  
 thence South 74 Degrees 08 Minutes 49 Seconds East 120.2 feet  
 thence South 71 Degrees 44 Minutes 25 Seconds East 180.3 feet  
 thence South 66 Degrees 51 Minutes 57 Seconds East 183 feet  
 thence South 59 Degrees 50 Minutes 29 Seconds East 168.2 feet  
 thence South 50 Degrees 59 Minutes 38 Seconds East 166.2 feet  
 thence South 52 Degrees 13 Minutes 06 Seconds East 169.6 feet  
 thence South 61 Degrees 32 Minutes 15 Seconds East 160.2 feet  
 thence South 75 Degrees 49 Minutes 02 Seconds East 150.8 feet  
 thence South 83 Degrees 33 Minutes 31 Seconds East 142.4 feet  
 thence South 83 Degrees 58 Minutes 01 Seconds East 121.8 feet  
 thence South 83 Degrees 59 Minutes 10 Seconds East 107.3 feet  
 thence South 83 Degrees 12 Minutes 41 Seconds East 79.7 feet  
 thence South 81 Degrees 47 Minutes 02 Seconds East 121.7 feet  
 thence South 82 Degrees 26 Minutes 20 Seconds East 172.5 feet  
 thence South 81 Degrees 25 Minutes 00 Seconds East 178.3 feet  
 thence South 77 Degrees 37 Minutes 54 Seconds East 180.9 feet  
 thence South 68 Degrees 20 Minutes 47 Seconds East 175.4 feet  
 thence South 66 Degrees 04 Minutes 45 Seconds East 172.6 feet  
 thence South 65 Degrees 34 Minutes 06 Seconds East 179.5 feet  
 thence South 64 Degrees 18 Minutes 55 Seconds East 175.9 feet

thence South 64 Degrees 36 Minutes 02 Seconds East 176.2 feet  
 thence South 65 Degrees 14 Minutes 34 Seconds East 168 feet  
 thence South 64 Degrees 03 Minutes 30 Seconds East 159.5 feet  
 thence South 59 Degrees 20 Minutes 36 Seconds East 143.4 feet  
 thence South 49 Degrees 53 Minutes 35 Seconds East 130.5 feet  
 thence South 39 Degrees 26 Minutes 44 Seconds East 122.6 feet  
 thence South 36 Degrees 37 Minutes 09 Seconds East 121.3 feet  
 thence South 36 Degrees 10 Minutes 00 Seconds East 115.3 feet  
 thence South 51 Degrees 04 Minutes 43 Seconds East 108.4 feet  
 thence South 71 Degrees 29 Minutes 36 Seconds East 109.8 feet  
 thence South 74 Degrees 46 Minutes 58 Seconds East 30.6 feet  
 thence South 76 Degrees 16 Minutes 15 Seconds East 67.6 feet  
 thence South 75 Degrees 56 Minutes 58 Seconds East 156.1 feet  
 thence South 75 Degrees 54 Minutes 25 Seconds East 25.1 feet  
 thence South 76 Degrees 03 Minutes 18 Seconds East 147.9 feet  
 thence South 75 Degrees 17 Minutes 43 Seconds East 135.5 feet  
 thence South 75 Degrees 44 Minutes 08 Seconds East 127.8 feet  
 thence South 73 Degrees 59 Minutes 35 Seconds East 126.1 feet  
 thence South 75 Degrees 23 Minutes 45 Seconds East 119.8 feet  
 thence South 74 Degrees 14 Minutes 14 Seconds East 82.9 feet  
 thence South 74 Degrees 21 Minutes 42 Seconds East 21.5 feet  
 thence South 75 Degrees 12 Minutes 21 Seconds East 21.4 feet  
 thence South 75 Degrees 41 Minutes 31 Seconds East 133.9 feet  
 thence South 74 Degrees 35 Minutes 54 Seconds East 119.9 feet  
 thence South 75 Degrees 14 Minutes 52 Seconds East 75.7 feet  
 thence South 75 Degrees 50 Minutes 12 Seconds East 10.5 feet  
 thence South 76 Degrees 32 Minutes 46 Seconds East 16.5 feet  
 thence South 75 Degrees 08 Minutes 22 Seconds East 56.4 feet  
 thence South 76 Degrees 25 Minutes 33 Seconds East 117.6 feet  
 thence South 75 Degrees 51 Minutes 29 Seconds East 110.4 feet  
 thence South 77 Degrees 13 Minutes 07 Seconds East 120.2 feet  
 thence South 77 Degrees 13 Minutes 46 Seconds East 118.9 feet  
 thence South 77 Degrees 33 Minutes 48 Seconds East 123.4 feet  
 thence South 77 Degrees 39 Minutes 58 Seconds East 127.4 feet  
 thence South 78 Degrees 06 Minutes 23 Seconds East 124.2 feet  
 thence South 78 Degrees 29 Minutes 08 Seconds East 115.3 feet  
 thence South 78 Degrees 28 Minutes 24 Seconds East 105.6 feet  
 thence South 78 Degrees 25 Minutes 06 Seconds East 101.9 feet  
 thence South 78 Degrees 27 Minutes 14 Seconds East 81.4 feet  
 thence South 80 Degrees 00 Minutes 08 Seconds East 7.3 feet  
 thence South 80 Degrees 14 Minutes 47 Seconds East 41.3 feet  
 thence South 77 Degrees 41 Minutes 07 Seconds East 109.6 feet  
 thence South 78 Degrees 39 Minutes 24 Seconds East 97.5 feet  
 thence South 76 Degrees 43 Minutes 16 Seconds East 81 feet  
 thence South 77 Degrees 43 Minutes 26 Seconds East 75.3 feet  
 thence South 78 Degrees 30 Minutes 29 Seconds East 75.4 feet  
 thence South 80 Degrees 15 Minutes 54 Seconds East 64 feet  
 thence South 75 Degrees 18 Minutes 26 Seconds East 71 feet  
 thence South 76 Degrees 32 Minutes 07 Seconds East 68.9 feet

thence South 81 Degrees 08 Minutes 00 Seconds East 53.5 feet  
 thence South 78 Degrees 00 Minutes 42 Seconds East 52.4 feet  
 thence South 74 Degrees 21 Minutes 42 Seconds East 26.3 feet  
 thence South 75 Degrees 03 Minutes 07 Seconds East 3.7 feet  
 thence South 75 Degrees 26 Minutes 54 Seconds East 16.6 feet  
 thence South 72 Degrees 36 Minutes 24 Seconds East 16.2 feet  
 thence South 76 Degrees 16 Minutes 15 Seconds East 8.1 feet  
 thence South 67 Degrees 49 Minutes 39 Seconds East 10.3 feet  
 thence South 67 Degrees 24 Minutes 59 Seconds East 16 feet  
 thence South 62 Degrees 57 Minutes 26 Seconds East 64.3 feet  
 thence South 52 Degrees 16 Minutes 08 Seconds East 70.8 feet  
 thence South 45 Degrees 29 Minutes 28 Seconds East 72.1 feet  
 thence South 42 Degrees 51 Minutes 01 Seconds East 70.3 feet  
 thence South 41 Degrees 29 Minutes 34 Seconds East 3.5 feet  
 thence South 42 Degrees 06 Minutes 06 Seconds East 58.1 feet  
 thence South 46 Degrees 37 Minutes 26 Seconds East 40.4 feet  
 thence South 58 Degrees 12 Minutes 03 Seconds East 39.5 feet  
 thence South 71 Degrees 45 Minutes 48 Seconds East 54.7 feet  
 thence South 82 Degrees 18 Minutes 08 Seconds East 63.6 feet  
 thence South 87 Degrees 07 Minutes 38 Seconds East 71 feet  
 thence South 88 Degrees 16 Minutes 14 Seconds East 73.8 feet  
 thence South 87 Degrees 15 Minutes 26 Seconds East 80.1 feet  
 thence South 89 Degrees 12 Minutes 04 Seconds East 85 feet  
 thence South 88 Degrees 00 Minutes 59 Seconds East 82.1 feet  
 thence South 86 Degrees 30 Minutes 28 Seconds East 84.2 feet  
 thence South 88 Degrees 32 Minutes 40 Seconds East 85.3 feet  
 thence South 87 Degrees 22 Minutes 17 Seconds East 76.9 feet  
 thence South 85 Degrees 32 Minutes 36 Seconds East 23.7 feet  
 thence South 87 Degrees 23 Minutes 02 Seconds East 77.2 feet  
 thence South 88 Degrees 13 Minutes 15 Seconds East 99.1 feet  
 thence South 87 Degrees 17 Minutes 39 Seconds East 99.9 feet  
 thence South 87 Degrees 33 Minutes 38 Seconds East 89 feet  
 thence South 89 Degrees 13 Minutes 58 Seconds East 52.5 feet  
 thence South 87 Degrees 52 Minutes 13 Seconds East 30.9 feet  
 thence South 86 Degrees 50 Minutes 19 Seconds East 108.4 feet  
 thence South 88 Degrees 08 Minutes 11 Seconds East 112.6 feet  
 thence South 87 Degrees 13 Minutes 20 Seconds East 109.7 feet  
 thence South 87 Degrees 40 Minutes 50 Seconds East 107.4 feet  
 thence South 87 Degrees 12 Minutes 47 Seconds East 12.2 feet  
 thence South 86 Degrees 57 Minutes 49 Seconds East 95.6 feet  
 thence South 87 Degrees 07 Minutes 38 Seconds East 106.4 feet  
 thence South 86 Degrees 09 Minutes 15 Seconds East 99.6 feet  
 thence South 86 Degrees 06 Minutes 18 Seconds East 80.6 feet  
 thence South 87 Degrees 04 Minutes 57 Seconds East 70 feet  
 thence South 86 Degrees 47 Minutes 53 Seconds East 69.7 feet  
 thence South 86 Degrees 24 Minutes 23 Seconds East 72.3 feet  
 thence South 87 Degrees 04 Minutes 57 Seconds East 70 feet  
 thence South 86 Degrees 10 Minutes 56 Seconds East 68.4 feet  
 thence South 87 Degrees 37 Minutes 08 Seconds East 69.9 feet

thence South 86 Degrees 39 Minutes 39 Seconds East 67 feet  
thence South 87 Degrees 00 Minutes 18 Seconds East 68.3 feet  
thence South 86 Degrees 09 Minutes 45 Seconds East 68.1 feet  
thence South 85 Degrees 57 Minutes 00 Seconds East 69.1 feet  
thence South 87 Degrees 57 Minutes 13 Seconds East 71.9 feet  
thence South 86 Degrees 18 Minutes 58 Seconds East 70.7 feet  
thence South 84 Degrees 44 Minutes 05 Seconds East 67.6 feet  
thence South 85 Degrees 38 Minutes 47 Seconds East 60.6 feet more or less to **the ending**

**point at:** 39 degrees 25 minutes 25.94 seconds North Latitude and -113 degrees 29 minutes 16.55 seconds West Longitude, which can be converted to mapping accuracy State Plane Utah Central Zone NAD 83 feet coordinates of X = 1,078,908.6 feet and Y = 6,965,119.0 feet.

## Appendix B to Attachment 4

**Popular Name: Coyote Springs Road**

**County: Millard**

**County Road Number: MC241**

**State Geographic Information Database (SGID) Road Identification Number: RD141216.**

**Road-Segment Number: 002**

**Road-Segment Length: 0.16 miles more or less.**

**Believed owner of the land underlying this road-segment is: Bureau of Land Management.**

*The following description is based upon the geographic coordinate system using the NAD83 Datum. The source is GPS mapping grade data as indicated in the metadata and/or the transportation data model of the State of Utah Geographic Information Database (SGID).*

The road-segment itself is the monument that is identified by its physical presence on the land. The location of said physical presence is closely approximated by mapping grade Global Positioning System (GPS) data. Said data are checked against the corresponding gray-scale 1-meter Digital Orthophoto Quadrangles published by the United States Geological Survey (USGS) to verify a reasonable degree of accuracy. In circumstances where accurate satellite signal acquisition is not possible, such as deep, narrow canyons or under a canopy of dense foliage, or where very sharp curves in the road make accuracy questionable, such portions of the road were digitized from the corresponding gray-scale 1-meter Digital Orthophoto Quadrangles published by the United States Geological Survey (USGS).

This road-segment may traverse:

Township 16 South Range 15 West, Section(s) 12,13, Salt Lake Base & Meridian

The following description closely approximates the location of the centerline of the physical monument (Coyote Springs Road)-- Segment 002 based on mapping grade Global Positioning System (GPS) data as defined above:

**Beginning at a point** on the road center line located at 39 degrees 25 minutes 25.94 seconds North Latitude and -113 degrees 29 minutes 16.55 seconds West Longitude, which can be converted to mapping accuracy State Plane Utah Central Zone NAD 83 feet coordinates of X = 1,078,908.6 feet and Y = 6,965,119.0 feet; thence the following courses along the said road center line:

thence North 79 Degrees 59 Minutes 43 Seconds East	52.6 feet
thence North 60 Degrees 42 Minutes 14 Seconds East	55.5 feet
thence North 44 Degrees 26 Minutes 56 Seconds East	54.5 feet
thence North 41 Degrees 19 Minutes 34 Seconds East	11.8 feet
thence North 42 Degrees 24 Minutes 08 Seconds East	11.6 feet
thence North 47 Degrees 25 Minutes 08 Seconds East	4.9 feet
thence North 43 Degrees 03 Minutes 22 Seconds East	32.5 feet
thence North 38 Degrees 21 Minutes 09 Seconds East	37.8 feet
thence North 43 Degrees 20 Minutes 41 Seconds East	39.4 feet
thence North 65 Degrees 59 Minutes 24 Seconds East	29.4 feet
thence North 66 Degrees 42 Minutes 14 Seconds East	11.8 feet
thence South 69 Degrees 27 Minutes 09 Seconds East	14.7 feet



thence South 69 Degrees 30 Minutes 01 Seconds East 17.5 feet  
thence South 31 Degrees 33 Minutes 29 Seconds East 44.9 feet  
thence South 01 Degrees 50 Minutes 04 Seconds East 24.6 feet  
thence South 15 Degrees 38 Minutes 17 Seconds West 23.9 feet  
thence South 24 Degrees 12 Minutes 00 Seconds West 24.5 feet  
thence South 31 Degrees 47 Minutes 56 Seconds West 39.5 feet  
thence South 42 Degrees 15 Minutes 48 Seconds West 38.3 feet  
thence South 56 Degrees 31 Minutes 46 Seconds West 39.6 feet  
thence South 76 Degrees 11 Minutes 49 Seconds West 42.2 feet  
thence South 89 Degrees 41 Minutes 34 Seconds West 57.4 feet  
thence North 81 Degrees 33 Minutes 39 Seconds West 129.4 feet more or less to **the ending**

**point at:** 39 degrees 25 minutes 25.94 seconds North Latitude and -113 degrees 29 minutes 16.55 seconds West Longitude, which can be converted to mapping accuracy State Plane Utah Central Zone NAD 83 feet coordinates of X = 1,078,908.6 feet and Y = 6,965,119.0 feet.