

**Acknowledgment and
Notice of Acknowledgment
of Acceptance of R.S. 2477
Right-of-Way Grant**

00165792

B: 485 P: 755 Fee \$0.00
Connie Hansen, Millard Recorder
05/14/2008 10:27:43 AM By UT STATE GOVERNOR Page 1 of 13



THE STATE OF UTAH

TO ALL WHOM THESE PRESENTS SHALL COME, Greeting:

Know ye, This is an Acknowledgment and Notice of Acknowledgment made under Utah Code Sections 72-5-309 through 310 inclusive, that the grant of the United States of America of “the right of way for the construction of highways over public lands, not reserved for public uses” under United States Revised Statutes 2477 (43 U.S.C. Section 932 (repealed October 21, 1976, with proviso recognizing the validity of rights-of-way already established)) was accepted for and on behalf of the State of Utah and its political subdivision Millard County as it pertains to the highway located in Millard County known as Nowhere Road; County Road Number: MC3391; State Geographic Information Database (SGID) Road Identification Number: RD141710. Total road length is 1.5 miles more or less.

The reason for this Acknowledgment and Notice of Acknowledgment includes, but is not limited to, the fact that the road was constructed, mechanically, or by continuous use as a public highway for a period of at least ten years, over public lands not reserved for public uses, prior to the earlier of (a) the October 21, 1976 repeal of R.S. 2477 or (b) the date the servient estate was reserved for public uses.

This Acknowledgment and Notice of Acknowledgment applies only to the segments of the road that traverse land owned by the Bureau of Land Management, United States Department of the Interior, and does not apply to segments of the road that traverse land owned by any other person or entity. The State of Utah and its political subdivisions reserve the right to make further acknowledgments and notices of acknowledgment with regard to road segments that traverse land owned by other entities, including the United States of America, through one or more of its agencies.

A printed copy of a map showing the location of the road in said county is appended hereto as “Attachment 1,” a printed copy of representative photos of the road is appended hereto as “Attachment 2,” a printed copy of a description of the beginning and ending points of the entire road together with a list of Townships, Ranges and Sections that may be traversed by the road in said county is appended hereto as “Attachment 3,” and a printed copy of the Road Centerline Description Cover Page(s) is appended hereto as “Attachment 4.” The Appendices listed in “Attachment 4” that contain the actual road centerline descriptions are incorporated herein by reference. Affidavits provided by individuals familiar with the road are appended hereto as “Attachment 5.”

A printed copy of this Acknowledgment and Notice of Acknowledgment, together with its Attachments and Appendices, may be viewed and/or obtained at the office of the Utah State Archives.

An electronic copy of this Acknowledgment and Notice of Acknowledgment, together with its Attachments and Appendices, may be viewed and/or downloaded as read-only PDF (Portable Document Format) files via the

Internet at <http://recorded2477roads.utah.gov>.

The owner of the servient estate in the land underlying the road-segments subject to this Acknowledgment and Notice is believed to be the United States of America through one or more of its agencies. Any of such agencies or any other person with a servient ownership claim or a competing dominant estate right-of-way ownership claim, may file a petition in the State District Court for Salt Lake County for a decision regarding the correctness of this Acknowledgment. A claimant shall file a petition within sixty (60) days after receipt of this Notice.

In Witness Whereof, I, John Harja, the official designee of the Governor of the State of Utah, in conformity to the laws of the State (Utah Code Sections 72-5-308 through 310 inclusive), have caused this Acknowledgment and Notice of Acknowledgment to be made.

Signed by my hand in Salt Lake City, Utah, the 23rd day of APRIL, 2008.

By the Governor's Designee



John Harja

CERTIFICATION

State of Utah)
 : ss
County of Salt Lake)

I hereby certify that the signer of the foregoing document, John Harja, is personally known by me, has made a voluntary signature and taken an oath stating that he is the official designee of the Governor of the State of Utah and is authorized to sign this document on the Governor's behalf pursuant to Utah Code Section 72-5-309. He further vouched that, based upon information and belief, the facts alleged therein are true.

Dated this 23rd day of April, 2008.

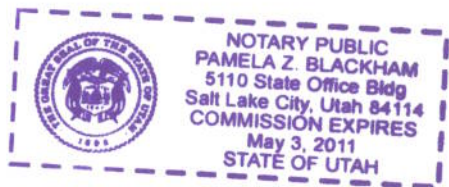

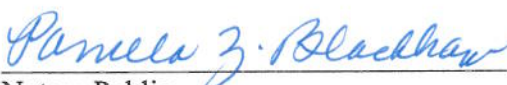

Notary Public

00165792
B: 485 P: 756 Fee \$0.00 Page 2 of 13
Connie Hansen, Millard Recorder By UT STATE GOVERNOR
05/14/2008 10:27:43 AM



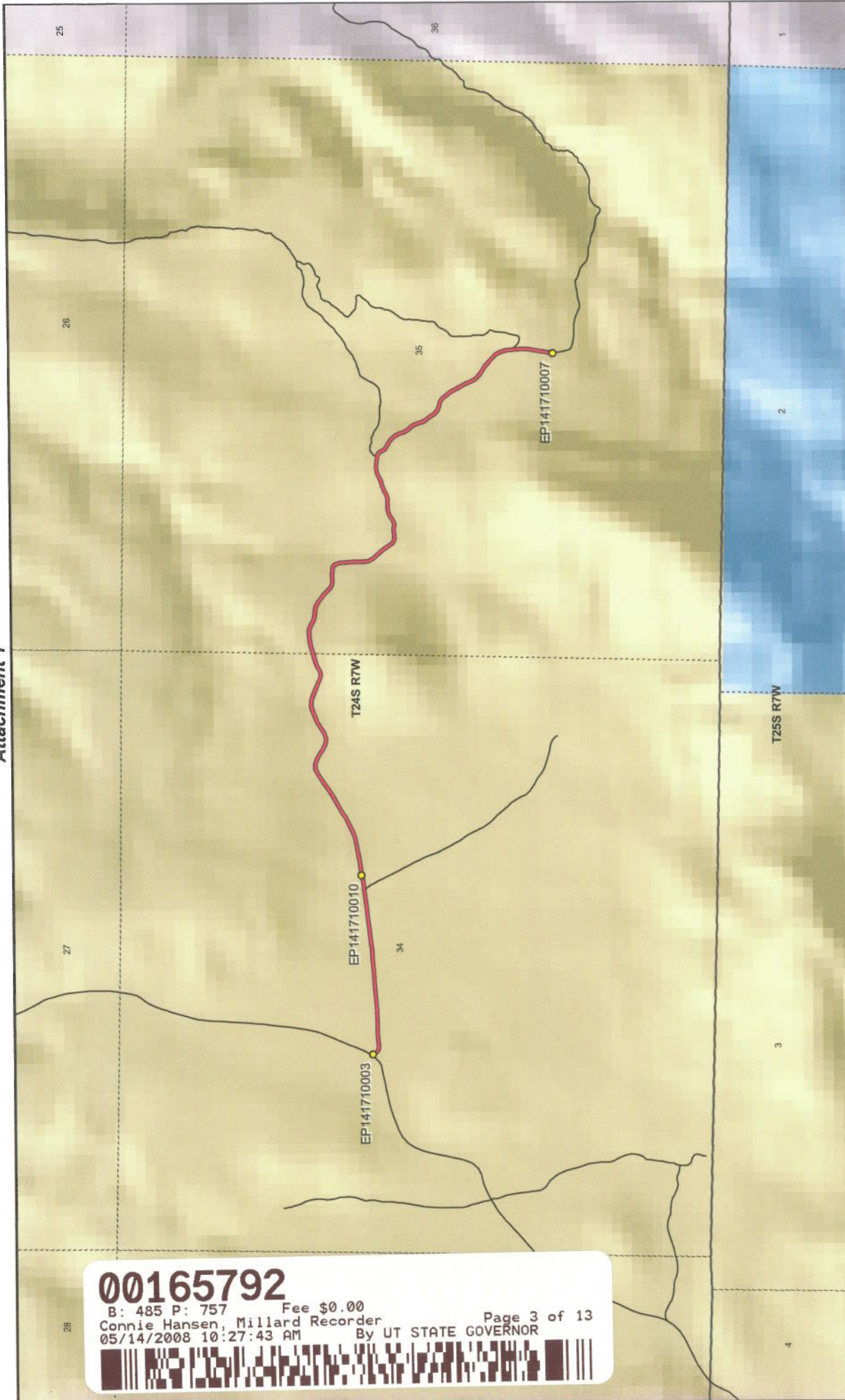

00165792

B: 485 P: 757 Fee \$0.00 Page 3 of 13
Connie Hansen, Millard Recorder
05/14/2008 10:27:43 AM By UT STATE GOVERNOR



1:14,124
1 inch equals 0.2 miles



Nowhere Road - Millard County
SGID RD_ID RD141710

- Land Ownership Categories**
- BLM
 - Private
 - SITLA, State Trust Land
 - USFS, National Forest
 - State Parks and Recreation
 - Tribal, Indian Reservation
 - NPS, National Park

- Wilderness
- UDWR Wildlife Reserve
- DOD, Military
- State Sovereign Land
- National Recreation Area
- USFWS, Natl. Wildlife Refuge

- Transportation Network**
- Nowhere Road
 - Other Roads
 - Title V: Issued Or Under Consideration By BLM County
 - Photo Event Point
 - Section = 1 Mile

Map prepared by the State of Utah
Automated Geographic Reference Center
Room 5130 State Office Building
Salt Lake City, Utah 84114
Nov 23, 2006





EP141710003



EP141710007



EP141710010

EP000000000

EP000000000

EP000000000

00165792

B: 485 P: 758 Fee \$0.00 Page 4 of 13
Connie Hansen, Millard Recorder
05/14/2008 10:27:43 AM By UT STATE GOVERNOR



Nowhere Road - Millard County
SGID RD_ID RD141710

Map prepared by the State of Utah
Automated Geographic Reference Center
Room 5130 State Office Building
Salt Lake City, Utah 84114
November 22, 2006



Attachment 3

Beginning & Ending Points and Township, Range, and Section References For:

Popular Name: Nowhere Road

County: Millard

County Road Number: MC3391

State Geographic Information Database (SGID) Road Identification Number: RD141710.

Total Road Length: 1.5 miles more or less.

Beginning at a point on the road centerline located at 38 degrees 40 minutes 048.2 seconds North Latitude and -112 degrees 37 minutes 47.15 seconds West Longitude, which can be converted to mapping accuracy State Plane Utah Central Zone NAD 83 feet coordinates of X = 1,317,865.0 feet and Y = 6,689,998.0 feet based on the US Survey Foot conversion.

Ending at a point on the road centerline located at 38 degrees 40 minutes 033.1 seconds North Latitude and -112 degrees 36 minutes 028.7 seconds West Longitude, which can be converted to mapping accuracy State Plane Utah Central Zone NAD 83 feet coordinates of X = 1,324,067.9 feet and Y = 6,688,392.7 feet based on the US Survey Foot conversion.

This road may traverse:

Township 24 South Range 7 West, Section(s) 34,35, Salt Lake Base & Meridian
See Attachment 1 above for a cartographic depiction of the course of this road.



**Attachment 4
Road Centerline Description Cover Page(s)**

Popular Name: Nowhere Road

County: Millard

County Road Number: MC3391

State Geographic Information Database (SGID) Road Identification Number: RD141710.

Total Road Length: 1.5 miles more or less.

Centerline Descriptions Of Road-Segments That Cross Over Federally Owned Land, Derived From Global Positioning System Data And Cross-checked against USGS Digital Orthophoto Quadrangles Compiled By The Utah Automated Geographic Reference Center And Entered Into The State Geographic Information Database (SGID).

Road-Segments Listed by SGID Road Identification Number (RD ID)	Road-Segment Numbers	Believed Ownership Of Servient Estate	Approximate Segment Length	See Attached Appendix
RD141710	001	BLM	1.5 Miles	A
		Total Road Length	1.5	_____

* Indicates that a Title V permit will be requested, is in process, or has been issued.

† Indicates that road-segments crossing Forest Service land are under consideration by the state and county as of the date of this Acknowledgment and Notice of Acknowledgment.

00165792

B: 485 P: 760 Fee \$0.00
 Connie Hansen, Millard Recorder
 05/14/2008 10:27:43 AM By UT STATE GOVERNOR Page 6 of 13



Attachment 5

00165792

B: 485 P: 761 Fee \$0.00
Connie Hansen, Millard Recorder
05/14/2008 10:27:43 AM By UT STATE GOVERNOR Page 7 of 13



AFFIDAVIT OF WILLIAM THAYNE HENRIE

NOWHERE ROAD

MILLARD COUNTY, UTAH

ROAD NUMBER MC3391

State of Utah)
 : ss.
County of Millard)

WILLIAM THAYNE HENRIE, being first duly sworn, deposes and states as follows:

1. I am an adult competent to testify about the matters set forth below based upon my personal knowledge. I currently reside in Millard County, Utah. I have lived in Millard County for fifty-eight years. I have been an employee of the Millard County Road Department since June of 1990, have been the Road Department Supervisor from January 1993 to the present and have participated in maintenance of the road during that time.

2. I have traveled and am familiar with a road in Millard County known as Nowhere Road. I am also familiar with the land the road traverses. When I first used and observed the road in the 1950s, it followed the same route as in 2006 when I last observed it. Attached is a Millard County map showing Nowhere Road. To the best of my knowledge and based upon my use of and familiarity with this road and the land it traverses, the location and route of the road are correctly illustrated on the attached map.

3. I am informed that the County also identifies this road according to the road number listed above.

4. I have observed that the road has been open to the public for all to use, to come and go as they pleased, since at least as early as the 1950s and continuing through 1976 to the present. Throughout this time period I have observed travel on the road by means of cars, trucks, recreational vehicles, and pickup trucks. Throughout this time period, the road has been used weekly for more than ten continuous years prior to 1976, and is presently used weekly

00165792

B: 485 P: 762 Fee \$0.00 Page 8 of 13
Connie Hansen, Millard Recorder
05/14/2008 10:27:43 AM By UT STATE GOVERNOR



5. Throughout the time period from the 1950s to the present, I have used the road myself for camping, gathering fire wood, hunting, rock hounding, participating in search and rescue efforts and recreation.

6. Throughout the time period described in the previous paragraph, I have observed other vehicles from the general public using the road at various times for the uses described in the previous paragraph, plus mining, prospecting for minerals, livestock operations, trapping, tourism, government access, picnicking, hiking and sightseeing.

7. It is also the reputation in the community that this road has been open to the public for all to use, to come and go as they pleased, since at least as early as the early 1900s and continuing through 1976 to the present, for the uses described in the previous paragraphs.

8. Prior to 1976 I observed graders and other maintenance equipment performing maintenance and construction activities on the road. Maintenance on the road has been performed since 1955 by the Millard County Road Department.

DATED this 5 day of December, 2006.



WILLIAM THAYNE HENRIE

SUBSCRIBED AND SWORN to before me this 5th day of December, 2006.

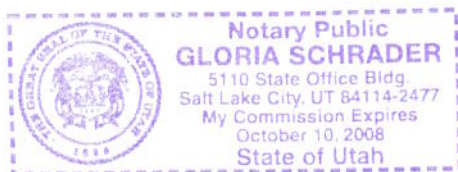



NOTARY PUBLIC



ROAD = MC3391
NOWHERE ROAD

Dog Valley

138



00165792

B: 485 P: 764 Fee \$0.00
Connie Hansen, Millard Recorder Page 10 of 13
05/14/2008 10:27:43 AM By UT STATE GOVERNOR



MILLARD COUNTY

— B Class Road of Interest

- Interstate
- County Border
- Township & Range Line
- Highway Major
- River
- Forest Service Lands
- Highway Minor
- Cities / Towns
- BLM Lands
- B Class Road
- Lakes
- State Trust Lands
- Unimproved Road
- Lakes - Intermittent
- Private Lands



AFFIDAVIT OF JOHN LARSEN

NOWHERE ROAD

MILLARD COUNTY, UTAH

ROAD NUMBER MC3391

State of Utah)
 : ss
County of Millard)

JOHN LARSEN, being first duly sworn, deposes and states as follows:

1. I am an adult competent to testify about the matters set forth below based upon my personal knowledge. I currently reside in Millard County, Utah. I have lived in Millard County for forty-six years. I have been an employee of the Millard County Road Department since June 1980 to present and have participated in maintenance of the road during that time.

2. I have traveled and am familiar with a road in Millard County known as the Nowhere Road. I am also familiar with the land the road traverses. When I first used and observed the road in the early 1960s, it followed the same route as in 2006 when I last observed it. Attached is a Millard County map showing Nowhere Road. To the best of my knowledge and based upon my use of and familiarity with this road and the land it traverses, the location and route of the road are correctly illustrated on the attached map.

3. I am informed that the County also identifies this road according to the road number listed above.

4. I have observed that the road has been open to the public for all to use, to come and go as they pleased, since at least as early as 1962 and continuing through 1976 to the present. Throughout this time period I have observed travel on the road by various means, including car, truck, recreational vehicle, and pickup truck. Throughout this time period, the road has been used weekly for more than ten continuous years prior to 1976, and is presently used weekly.

00165792

B: 485 P: 765 Fee \$0.00
Connie Hansen, Millard Recorder
05/14/2008 10:27:43 AM

Page 11 of 13

By UT STATE GOVERNOR



5. Throughout the time period from the early 1960s to the present, I have used the road myself for the following uses: hunting, camping, gathering fire wood, and recreation.

6. Throughout the time period described in the previous paragraph, I observed other vehicles from the general public using the road at various times for the uses described in the previous paragraph, plus the following uses: Mining, prospecting for minerals, livestock operations, farming, trapping, tourism, government access, picnicking, hiking and sightseeing.

7. It is also the reputation in the community that this road has been open to the public for all to use, to come and go as they pleased, since at least as early as 1900 and continuing through 1976 to the present, for the uses described in the previous paragraphs.

8. Prior to 1976, I observed the graded surface of the road and have personally graded the road since 1980.

DATED this 4 day of December, 2006.

John Larsen
JOHN LARSEN

SUBSCRIBED AND SWORN to before me this 4th day of December, 2006.

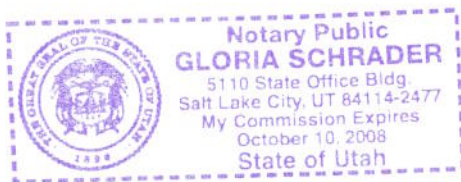

Gloria Schrader
NOTARY PUBLIC



ROAD = MC3391
NOWHERE ROAD

Dog Valley

138



00165792

B: 485 P: 767 Fee \$0.00 Page 13 of 13
Connie Hansen, Millard Recorder By UT STATE GOVERNOR
05/14/2008 10:27:43 AM



MILLARD COUNTY

- Interstate
- Highway Major
- Highway Minor
- B Class Road
- - - Unimproved Road
- County Border
- River
- ▨ Cities / Towns
- Lakes
- Lakes - Intermittent
- Township & Range Line
- ▨ Forest Service Lands
- ▨ BLM Lands
- ▨ State Trust Lands
- ▨ Private Lands

— B Class Road of Interest

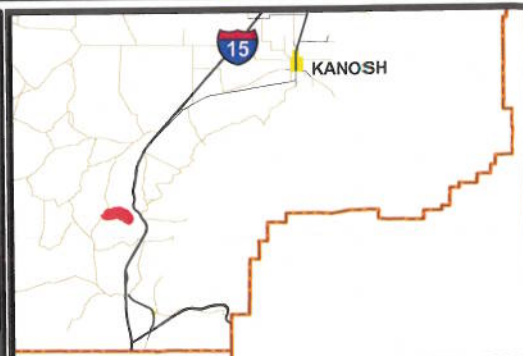

Appendix A to Attachment 4

Popular Name: Nowhere Road

County: Millard

County Road Number: MC3391

State Geographic Information Database (SGID) Road Identification Number: RD141710.

Road-Segment Number: 001

Road-Segment Length: 1.5 miles more or less.

Believed owner of the land underlying this road-segment is: Bureau of Land Management.

The following description is based upon the geographic coordinate system using the NAD83 Datum. The source is GPS mapping grade data as indicated in the metadata and/or the transportation data model of the State of Utah Geographic Information Database (SGID).

The road-segment itself is the monument that is identified by its physical presence on the land. The location of said physical presence is closely approximated by mapping grade Global Positioning System (GPS) data. Said data are checked against the corresponding gray-scale 1-meter Digital Orthophoto Quadrangles published by the United States Geological Survey (USGS) to verify a reasonable degree of accuracy. In circumstances where accurate satellite signal acquisition is not possible, such as deep, narrow canyons or under a canopy of dense foliage, or where very sharp curves in the road make accuracy questionable, such portions of the road were digitized from the corresponding gray-scale 1-meter Digital Orthophoto Quadrangles published by the United States Geological Survey (USGS).

This road-segment may traverse:

Township 24 South Range 7 West, Section(s) 34,35, Salt Lake Base & Meridian

The following description closely approximates the location of the centerline of the physical monument (Nowhere Road)-- Segment 001 based on mapping grade Global Positioning System (GPS) data as defined above:

Beginning at a point on the road center line located at 38 degrees 40 minutes 048.2 seconds North Latitude and -112 degrees 37 minutes 47.15 seconds West Longitude, which can be converted to mapping accuracy State Plane Utah Central Zone NAD 83 feet coordinates of X = 1,317,865.0 feet and Y = 6,689,998.0 feet; thence the following courses along the said road center line:

thence South 22 Degrees 48 Minutes 56 Seconds East	29.1 feet
thence South 32 Degrees 27 Minutes 58 Seconds East	24 feet
thence South 59 Degrees 59 Minutes 32 Seconds East	29.3 feet
thence South 84 Degrees 15 Minutes 26 Seconds East	34.3 feet
thence North 83 Degrees 08 Minutes 19 Seconds East	45.9 feet
thence North 85 Degrees 54 Minutes 42 Seconds East	59.5 feet
thence North 89 Degrees 11 Minutes 11 Seconds East	72.5 feet
thence North 88 Degrees 15 Minutes 17 Seconds East	77.8 feet
thence North 87 Degrees 16 Minutes 43 Seconds East	77.5 feet
thence North 84 Degrees 41 Minutes 30 Seconds East	75.1 feet
thence North 84 Degrees 07 Minutes 13 Seconds East	74.2 feet

thence North 84 Degrees 36 Minutes 10 Seconds East 73.8 feet
 thence North 85 Degrees 14 Minutes 45 Seconds East 71.8 feet
 thence North 85 Degrees 31 Minutes 34 Seconds East 72.1 feet
 thence North 84 Degrees 30 Minutes 37 Seconds East 72.5 feet
 thence North 85 Degrees 43 Minutes 56 Seconds East 71.1 feet
 thence North 83 Degrees 07 Minutes 22 Seconds East 68.7 feet
 thence North 82 Degrees 50 Minutes 18 Seconds East 63.1 feet
 thence North 82 Degrees 58 Minutes 40 Seconds East 64.4 feet
 thence North 82 Degrees 43 Minutes 05 Seconds East 67.4 feet
 thence North 84 Degrees 01 Minutes 21 Seconds East 66.3 feet
 thence North 83 Degrees 46 Minutes 38 Seconds East 60.4 feet
 thence North 81 Degrees 20 Minutes 06 Seconds East 144.3 feet
 thence North 82 Degrees 10 Minutes 51 Seconds East 17.5 feet
 thence North 81 Degrees 11 Minutes 15 Seconds East 68.7 feet
 thence North 79 Degrees 43 Minutes 37 Seconds East 36 feet
 thence North 85 Degrees 37 Minutes 09 Seconds East 18.4 feet
 thence North 79 Degrees 48 Minutes 02 Seconds East 21 feet
 thence North 80 Degrees 05 Minutes 06 Seconds East 39.3 feet
 thence North 80 Degrees 25 Minutes 56 Seconds East 48.9 feet
 thence North 80 Degrees 17 Minutes 51 Seconds East 56.2 feet
 thence North 79 Degrees 24 Minutes 00 Seconds East 55 feet
 thence North 77 Degrees 26 Minutes 24 Seconds East 54.1 feet
 thence North 77 Degrees 54 Minutes 27 Seconds East 53 feet
 thence North 69 Degrees 28 Minutes 48 Seconds East 39.9 feet
 thence North 65 Degrees 08 Minutes 15 Seconds East 37.9 feet
 thence North 65 Degrees 27 Minutes 20 Seconds East 40 feet
 thence North 64 Degrees 04 Minutes 58 Seconds East 35.7 feet
 thence North 62 Degrees 35 Minutes 00 Seconds East 30.2 feet
 thence North 60 Degrees 56 Minutes 13 Seconds East 19.1 feet
 thence North 53 Degrees 48 Minutes 43 Seconds East 30.8 feet
 thence North 56 Degrees 31 Minutes 34 Seconds East 51 feet
 thence North 60 Degrees 32 Minutes 40 Seconds East 51.9 feet
 thence North 59 Degrees 52 Minutes 09 Seconds East 51.5 feet
 thence North 60 Degrees 27 Minutes 21 Seconds East 47 feet
 thence North 57 Degrees 36 Minutes 21 Seconds East 42.6 feet
 thence North 54 Degrees 34 Minutes 14 Seconds East 43.3 feet
 thence North 54 Degrees 10 Minutes 01 Seconds East 45.2 feet
 thence North 54 Degrees 34 Minutes 57 Seconds East 47.3 feet
 thence North 58 Degrees 18 Minutes 52 Seconds East 45.4 feet
 thence North 65 Degrees 21 Minutes 49 Seconds East 45.4 feet
 thence North 87 Degrees 04 Minutes 56 Seconds East 43 feet
 thence South 70 Degrees 48 Minutes 32 Seconds East 45.3 feet
 thence South 61 Degrees 12 Minutes 14 Seconds East 49.9 feet
 thence South 57 Degrees 36 Minutes 11 Seconds East 52.3 feet
 thence South 62 Degrees 26 Minutes 07 Seconds East 52 feet
 thence South 81 Degrees 27 Minutes 42 Seconds East 49.2 feet
 thence North 71 Degrees 16 Minutes 11 Seconds East 51.9 feet
 thence North 56 Degrees 17 Minutes 49 Seconds East 55.4 feet
 thence North 56 Degrees 28 Minutes 58 Seconds East 55.7 feet

thence North 65 Degrees 38 Minutes 09 Seconds East 53.9 feet
 thence North 70 Degrees 03 Minutes 03 Seconds East 53.7 feet
 thence North 72 Degrees 53 Minutes 59 Seconds East 51.1 feet
 thence South 87 Degrees 48 Minutes 20 Seconds East 45.3 feet
 thence South 69 Degrees 55 Minutes 46 Seconds East 46.2 feet
 thence South 70 Degrees 25 Minutes 51 Seconds East 54.1 feet
 thence South 69 Degrees 41 Minutes 57 Seconds East 55 feet
 thence South 62 Degrees 30 Minutes 00 Seconds East 47.9 feet
 thence South 76 Degrees 44 Minutes 29 Seconds East 37.8 feet
 thence North 77 Degrees 41 Minutes 35 Seconds East 31.5 feet
 thence North 62 Degrees 32 Minutes 23 Seconds East 28 feet
 thence North 60 Degrees 15 Minutes 03 Seconds East 32 feet
 thence North 68 Degrees 53 Minutes 52 Seconds East 35.1 feet
 thence North 75 Degrees 17 Minutes 02 Seconds East 35.6 feet
 thence North 76 Degrees 01 Minutes 14 Seconds East 38.8 feet
 thence North 71 Degrees 16 Minutes 11 Seconds East 2.1 feet
 thence North 73 Degrees 20 Minutes 37 Seconds East 37.3 feet
 thence North 75 Degrees 54 Minutes 18 Seconds East 38.5 feet
 thence North 81 Degrees 03 Minutes 43 Seconds East 41.5 feet
 thence North 84 Degrees 38 Minutes 07 Seconds East 40.9 feet
 thence North 83 Degrees 56 Minutes 47 Seconds East 39.2 feet
 thence South 79 Degrees 36 Minutes 37 Seconds East 35.4 feet
 thence South 66 Degrees 23 Minutes 35 Seconds East 31.6 feet
 thence South 62 Degrees 03 Minutes 59 Seconds East 35.4 feet
 thence South 72 Degrees 52 Minutes 38 Seconds East 35.1 feet
 thence South 86 Degrees 26 Minutes 40 Seconds East 34.2 feet
 thence South 82 Degrees 18 Minutes 54 Seconds East 35.5 feet
 thence South 74 Degrees 16 Minutes 47 Seconds East 36.9 feet
 thence South 59 Degrees 24 Minutes 51 Seconds East 39 feet
 thence South 52 Degrees 20 Minutes 27 Seconds East 41.6 feet
 thence South 51 Degrees 12 Minutes 05 Seconds East 40.6 feet
 thence South 43 Degrees 51 Minutes 47 Seconds East 37.1 feet
 thence South 47 Degrees 48 Minutes 57 Seconds East 36.9 feet
 thence South 60 Degrees 56 Minutes 15 Seconds East 36.1 feet
 thence South 86 Degrees 12 Minutes 34 Seconds East 36.8 feet
 thence North 86 Degrees 24 Minutes 38 Seconds East 45.7 feet
 thence South 86 Degrees 08 Minutes 08 Seconds East 36.2 feet
 thence South 86 Degrees 26 Minutes 40 Seconds East 34.2 feet
 thence South 48 Degrees 50 Minutes 49 Seconds East 33.7 feet
 thence South 19 Degrees 44 Minutes 07 Seconds East 35.5 feet
 thence South 07 Degrees 07 Minutes 07 Seconds East 38.7 feet
 thence South 04 Degrees 04 Minutes 52 Seconds East 44.7 feet
 thence South 02 Degrees 16 Minutes 12 Seconds East 47.6 feet
 thence South 01 Degrees 51 Minutes 14 Seconds East 48.3 feet
 thence South 02 Degrees 19 Minutes 34 Seconds East 46.3 feet
 thence South 08 Degrees 14 Minutes 19 Seconds East 42.7 feet
 thence South 28 Degrees 54 Minutes 20 Seconds East 41.1 feet
 thence South 41 Degrees 28 Minutes 52 Seconds East 41.9 feet
 thence South 42 Degrees 20 Minutes 40 Seconds East 45.1 feet

thence South 37 Degrees 56 Minutes 03 Seconds East 48.9 feet
 thence South 32 Degrees 27 Minutes 59 Seconds East 48.1 feet
 thence South 37 Degrees 42 Minutes 02 Seconds East 35.1 feet
 thence South 55 Degrees 10 Minutes 59 Seconds East 25.7 feet
 thence South 74 Degrees 48 Minutes 59 Seconds East 22.1 feet
 thence North 89 Degrees 42 Minutes 17 Seconds East 26.9 feet
 thence North 81 Degrees 59 Minutes 34 Seconds East 31.8 feet
 thence North 89 Degrees 42 Minutes 17 Seconds East 33.5 feet
 thence South 81 Degrees 35 Minutes 59 Seconds East 28.2 feet
 thence North 77 Degrees 19 Minutes 26 Seconds East 27.6 feet
 thence North 58 Degrees 44 Minutes 27 Seconds East 28.7 feet
 thence North 57 Degrees 02 Minutes 37 Seconds East 30.4 feet
 thence North 60 Degrees 27 Minutes 21 Seconds East 28.2 feet
 thence North 74 Degrees 54 Minutes 28 Seconds East 36 feet
 thence South 88 Degrees 46 Minutes 28 Seconds East 37.1 feet
 thence South 89 Degrees 08 Minutes 58 Seconds East 32.8 feet
 thence North 84 Degrees 56 Minutes 27 Seconds East 27.7 feet
 thence North 76 Degrees 22 Minutes 48 Seconds East 25.6 feet
 thence North 65 Degrees 44 Minutes 32 Seconds East 25.9 feet
 thence North 60 Degrees 39 Minutes 00 Seconds East 23.7 feet
 thence North 58 Degrees 05 Minutes 49 Seconds East 5 feet
 thence North 64 Degrees 14 Minutes 28 Seconds East 7.6 feet
 thence North 69 Degrees 24 Minutes 00 Seconds East 35 feet
 thence North 74 Degrees 24 Minutes 42 Seconds East 43.5 feet
 thence North 66 Degrees 22 Minutes 45 Seconds East 39 feet
 thence North 63 Degrees 23 Minutes 11 Seconds East 34 feet
 thence North 71 Degrees 38 Minutes 39 Seconds East 31.8 feet
 thence North 86 Degrees 35 Minutes 37 Seconds East 30.2 feet
 thence South 81 Degrees 35 Minutes 59 Seconds East 28.2 feet
 thence South 84 Degrees 12 Minutes 24 Seconds East 24.8 feet
 thence South 82 Degrees 23 Minutes 17 Seconds East 23.9 feet
 thence South 78 Degrees 39 Minutes 42 Seconds East 22.8 feet
 thence South 62 Degrees 07 Minutes 00 Seconds East 20.8 feet
 thence South 45 Degrees 17 Minutes 43 Seconds East 17.6 feet
 thence South 33 Degrees 12 Minutes 01 Seconds East 6.6 feet
 thence South 28 Degrees 08 Minutes 34 Seconds East 19.7 feet
 thence South 33 Degrees 31 Minutes 37 Seconds East 22.8 feet
 thence South 53 Degrees 58 Minutes 06 Seconds East 27.7 feet
 thence South 59 Degrees 27 Minutes 26 Seconds East 25.6 feet
 thence South 59 Degrees 42 Minutes 57 Seconds East 25.2 feet
 thence South 50 Degrees 49 Minutes 22 Seconds East 21.7 feet
 thence South 46 Degrees 15 Minutes 58 Seconds East 27.4 feet
 thence South 38 Degrees 29 Minutes 38 Seconds East 25.5 feet
 thence South 29 Degrees 56 Minutes 42 Seconds East 24.5 feet
 thence South 20 Degrees 41 Minutes 24 Seconds East 27.3 feet
 thence South 18 Degrees 58 Minutes 19 Seconds East 24.6 feet
 thence South 24 Degrees 40 Minutes 54 Seconds East 27 feet
 thence South 36 Degrees 04 Minutes 16 Seconds East 27.5 feet
 thence South 41 Degrees 45 Minutes 01 Seconds East 26.3 feet

thence South 36 Degrees 42 Minutes 42 Seconds East 24.9 feet
 thence South 29 Degrees 20 Minutes 59 Seconds East 23.7 feet
 thence South 19 Degrees 51 Minutes 12 Seconds East 26.5 feet
 thence South 12 Degrees 20 Minutes 16 Seconds East 25.2 feet
 thence South 22 Degrees 22 Minutes 56 Seconds East 24.4 feet
 thence South 32 Degrees 30 Minutes 42 Seconds East 28.3 feet
 thence South 37 Degrees 15 Minutes 49 Seconds East 38.2 feet
 thence South 36 Degrees 49 Minutes 26 Seconds East 44.1 feet
 thence South 46 Degrees 48 Minutes 38 Seconds East 43.9 feet
 thence South 67 Degrees 40 Minutes 31 Seconds East 42.7 feet
 thence South 76 Degrees 29 Minutes 16 Seconds East 39.9 feet
 thence South 56 Degrees 10 Minutes 50 Seconds East 36.9 feet
 thence South 37 Degrees 42 Minutes 02 Seconds East 42.1 feet
 thence South 38 Degrees 42 Minutes 48 Seconds East 48.6 feet
 thence South 30 Degrees 18 Minutes 49 Seconds East 51.2 feet
 thence South 28 Degrees 43 Minutes 27 Seconds East 49.6 feet
 thence South 27 Degrees 52 Minutes 38 Seconds East 49.6 feet
 thence South 22 Degrees 46 Minutes 29 Seconds East 51.5 feet
 thence South 30 Degrees 02 Minutes 24 Seconds East 50.3 feet
 thence South 47 Degrees 06 Minutes 34 Seconds East 51.3 feet
 thence South 59 Degrees 03 Minutes 21 Seconds East 46.8 feet
 thence South 55 Degrees 37 Minutes 54 Seconds East 37.5 feet
 thence South 48 Degrees 56 Minutes 51 Seconds East 32.8 feet
 thence South 48 Degrees 45 Minutes 06 Seconds East 34.6 feet
 thence South 50 Degrees 15 Minutes 54 Seconds East 32.1 feet
 thence South 43 Degrees 38 Minutes 06 Seconds East 32 feet
 thence South 34 Degrees 23 Minutes 47 Seconds East 38 feet
 thence South 23 Degrees 01 Minutes 52 Seconds East 37.4 feet
 thence South 13 Degrees 25 Minutes 45 Seconds East 40.4 feet
 thence South 07 Degrees 15 Minutes 31 Seconds East 43.3 feet
 thence South 04 Degrees 22 Minutes 51 Seconds East 18.4 feet
 thence South 03 Degrees 36 Minutes 47 Seconds East 22.7 feet
 thence South 05 Degrees 34 Minutes 35 Seconds East 39.2 feet
 thence South 00 Degrees 12 Minutes 42 Seconds West 37.1 feet
 thence South 05 Degrees 49 Minutes 12 Seconds West 37 feet
 thence South 11 Degrees 13 Minutes 42 Seconds West 34.5 feet
 thence South 07 Degrees 08 Minutes 10 Seconds West 30.4 feet
 thence South 08 Degrees 05 Minutes 16 Seconds West 31.5 feet
 thence South 07 Degrees 17 Minutes 57 Seconds West 34.8 feet
 thence South 12 Degrees 34 Minutes 47 Seconds West 35.3 feet
 thence South 06 Degrees 41 Minutes 08 Seconds West 32.4 feet
 thence South 01 Degrees 39 Minutes 33 Seconds East 13.8 feet more or less to **the ending**

point at: 38 degrees 40 minutes 033.1 seconds North Latitude and -112 degrees 36 minutes 028.7 seconds West Longitude, which can be converted to mapping accuracy State Plane Utah Central Zone NAD 83 feet coordinates of X = 1,324,067.9 feet and Y = 6,688,392.7 feet.