

00165788
 B: 485 P: 703 Fee \$0.00
 Connie Hansen, Millard Recorder
 05/14/2008 10:27:43 AM By UT STATE GOVERNOR Page 1 of 13



**Acknowledgment and
 Notice of Acknowledgment
 of Acceptance of R.S. 2477
 Right-of-Way Grant**

THE STATE OF UTAH

TO ALL WHOM THESE PRESENTS SHALL COME, Greeting:

Know ye, This is an Acknowledgment and Notice of Acknowledgment made under Utah Code Sections 72-5-309 through 310 inclusive, that the grant of the United States of America of “the right of way for the construction of highways over public lands, not reserved for public uses” under United States Revised Statutes 2477 (43 U.S.C. Section 932 (repealed October 21, 1976, with proviso recognizing the validity of rights-of-way already established)) was accepted for and on behalf of the State of Utah and its political subdivision Millard County as it pertains to the highway located in Millard County known as 12-A Well Road; County Road Number: MC3445; State Geographic Information Database (SGID) Road Identification Number: RD141769. Total road length is 5.95 miles more or less.

The reason for this Acknowledgment and Notice of Acknowledgment includes, but is not limited to, the fact that the road was constructed, mechanically, or by continuous use as a public highway for a period of at least ten years, over public lands not reserved for public uses, prior to the earlier of (a) the October 21, 1976 repeal of R.S. 2477 or (b) the date the servient estate was reserved for public uses.

This Acknowledgment and Notice of Acknowledgment applies only to the segments of the road that traverse land owned by the Bureau of Land Management, United States Department of the Interior, and does not apply to segments of the road that traverse land owned by any other person or entity. The State of Utah and its political subdivisions reserve the right to make further acknowledgments and notices of acknowledgment with regard to road segments that traverse land owned by other entities, including the United States of America, through one or more of its agencies.

A printed copy of a map showing the location of the road in said county is appended hereto as “Attachment 1,” a printed copy of representative photos of the road is appended hereto as “Attachment 2,” a printed copy of a description of the beginning and ending points of the entire road together with a list of Townships, Ranges and Sections that may be traversed by the road in said county is appended hereto as “Attachment 3,” and a printed copy of the Road Centerline Description Cover Page(s) is appended hereto as “Attachment 4.” The Appendices listed in “Attachment 4” that contain the actual road centerline descriptions are incorporated herein by reference. Affidavits provided by individuals familiar with the road are appended hereto as “Attachment 5.”

A printed copy of this Acknowledgment and Notice of Acknowledgment, together with its Attachments and Appendices, may be viewed and/or obtained at the office of the Utah State Archives.

An electronic copy of this Acknowledgment and Notice of Acknowledgment, together with its Attachments and Appendices, may be viewed and/or downloaded as read-only PDF (Portable Document Format) files via the

Internet at <http://recorded2477roads.utah.gov>.

The owner of the servient estate in the land underlying the road-segments subject to this Acknowledgment and Notice is believed to be the United States of America through one or more of its agencies. Any of such agencies or any other person with a servient ownership claim or a competing dominant estate right-of-way ownership claim, may file a petition in the State District Court for Salt Lake County for a decision regarding the correctness of this Acknowledgment. A claimant shall file a petition within sixty (60) days after receipt of this Notice.

In Witness Whereof, I, John Harja, the official designee of the Governor of the State of Utah, in conformity to the laws of the State (Utah Code Sections 72-5-308 through 310 inclusive), have caused this Acknowledgment and Notice of Acknowledgment to be made.

Signed by my hand in Salt Lake City, Utah, the 23rd day of April, 2008.

By the Governor's Designee



John Harja

CERTIFICATION

State of Utah)
 : ss
County of Salt Lake)

I hereby certify that the signer of the foregoing document, John Harja, is personally known by me, has made a voluntary signature and taken an oath stating that he is the official designee of the Governor of the State of Utah and is authorized to sign this document on the Governor's behalf pursuant to Utah Code Section 72-5-309. He further vouched that, based upon information and belief, the facts alleged therein are true.

Dated this 23rd day of April, 2008.





Notary Public

00165788
B: 485 P: 704 Fee \$0.00
Connie Hansen, Millard Recorder
05/14/2008 10:27:43 AM By UT STATE GOVERNOR Page 2 of 13



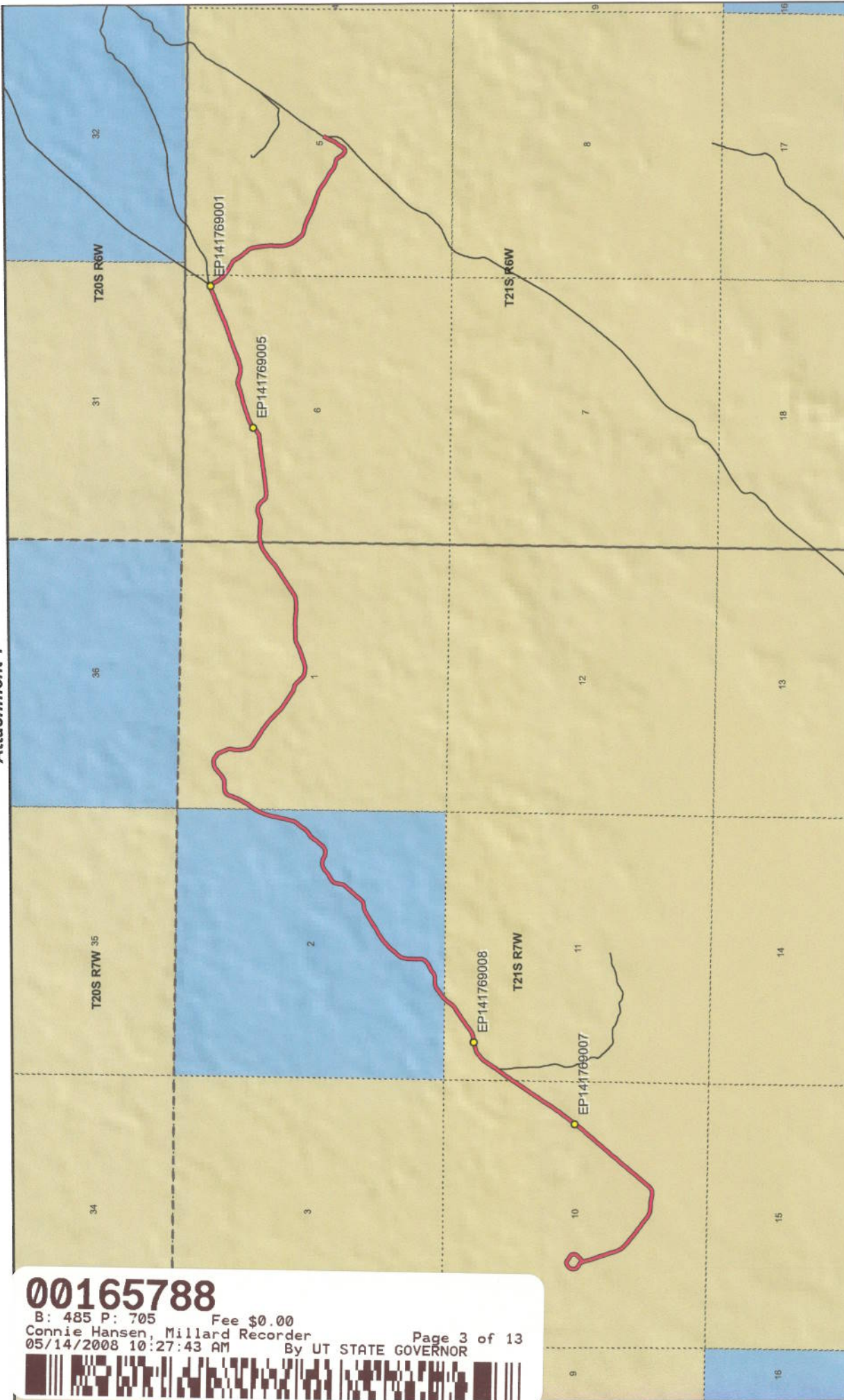

00165788

B: 485 P: 705 Fee \$0.00
Connie Hansen, Millard Recorder
05/14/2008 10:27:43 AM By UT STATE GOVERNOR



1:31,575
1 inch equals 0.5 miles

Land Ownership Categories

- BLM
- Private
- SITLA, State Trust Land
- USFS, National Forest
- State Parks and Recreation
- Tribal, Indian Reservation
- NPS, National Park

**12-A Well Road - Millard County
SGID RD_ID RD141769**

Transportation Network

- 12-A Well Road
- Other Roads
- Title V, Issued Or Under Consideration By BLM
- County
- Photo Event Point
- Section = 1 Mile

- Wilderness
- UDWR Wildlife Reserve
- DOD, Military
- State Sovereign Land
- National Recreation Area
- USFWS, Natl. Wildlife Refuge

Map prepared by the State of Utah
Automated Geographic Reference Center
Room 5130 State Office Building
Salt Lake City, Utah 84114
Nov 23, 2006

Attachment 2



EP141769001



EP141769005



EP141769007



EP141769008

00165788

B: 485 P: 706 Fee \$0.00 Page 4 of 13
Connie Hansen, Millard Recorder
05/14/2008 10:27:43 AM By UT STATE GOVERNOR



EP000000000

EP000000000

**12-A Well Road - Millard County
SGID RD_ID RD141769**

Map prepared by the State of Utah
Automated Geographic Reference Center
Room 5130 State Office Building
Salt Lake City, Utah 84114
November 22, 2006



Attachment 3

Beginning & Ending Points and Township, Range, and Section References For:

Popular Name: 12-A Well Road

County: Millard

County Road Number: MC3445

State Geographic Information Database (SGID) Road Identification Number: RD141769.

Total Road Length: 5.95 miles more or less.

Beginning at a point on the road centerline located at 39 degrees 00 minutes 58.21 seconds North Latitude and -112 degrees 33 minutes 03.52 seconds West Longitude, which can be converted to mapping accuracy State Plane Utah Central Zone NAD 83 feet coordinates of X = 1,341,796.6 feet and Y = 6,812,138.8 feet based on the US Survey Foot conversion.

Ending at a point on the road centerline located at 39 degrees 00 minutes 05.03 seconds North Latitude and -112 degrees 37 minutes 44.12 seconds West Longitude, which can be converted to mapping accuracy State Plane Utah Central Zone NAD 83 feet coordinates of X = 1,319,583.1 feet and Y = 6,807,028.8 feet based on the US Survey Foot conversion.

This road may traverse:

Township 21 South Range 6 West, Section(s) 5,6, Salt Lake Base & Meridian

Township 21 South Range 7 West, Section(s) 1,2,10,11, Salt Lake Base & Meridian

See Attachment 1 above for a cartographic depiction of the course of this road.



**Attachment 4
Road Centerline Description Cover Page(s)**

Popular Name: 12-A Well Road

County: Millard

County Road Number: MC3445

State Geographic Information Database (SGID) Road Identification Number: RD141769.

Total Road Length: 5.95 miles more or less.

Centerline Descriptions Of Road-Segments That Cross Over Federally Owned Land, Derived From Global Positioning System Data And Cross-checked against USGS Digital Orthophoto Quadrangles Compiled By The Utah Automated Geographic Reference Center And Entered Into The State Geographic Information Database (SGID).

Road-Segments Listed by SGID Road Identification Number (RD ID)	Road-Segment Numbers	Believed Ownership Of Servient Estate	Approximate Segment Length	See Attached Appendix
RD141769	001	BLM	3.19 Miles	A
RD141769	002	ST	1.1 Miles	(not shown)
RD141769	003	BLM	1.49 Miles	B
RD141769	004	BLM	0.18 Miles	C
		Total Road Length	5.95	—————

* Indicates that a Title V permit will be requested, is in process, or has been issued.

† Indicates that road-segments crossing Forest Service land are under consideration by the state and county as of the date of this Acknowledgment and Notice of Acknowledgment.

00165788

B: 485 P: 708 Fee \$0.00
 Connie Hansen, Millard Recorder
 05/14/2008 10:27:43 AM By UT STATE GOVERNOR Page 6 of 13



Attachment 5

00165788
B: 485 P: 709 Fee \$0.00
Connie Hansen, Millard Recorder
05/14/2008 10:27:43 AM By UT STATE GOVERNOR Page 7 of 13



AFFIDAVIT OF JAY ATKINSON

12-A WELL ROAD

MILLARD COUNTY, UTAH

ROAD NUMBER MC3445

State of Utah)
 : ss.
County of Millard)

JAY ATKINSON, being first duly sworn, deposes and states as follows:

1. I am an adult competent to testify about the matters set forth below based upon my personal knowledge. I currently reside in Millard County, Utah. I have lived in Millard County for sixty-eight years. I was an employee of the Millard County Road Department from February of 1970 to April of 2000, and participated in maintenance of the road during that time.

2. I have traveled and am familiar with a road in Millard County known as 12-A Well Road. I am also familiar with the land the road traverses. When I first used and observed the road in the early 1970s, it followed the same route as in 1999 when I last observed it. Attached is a Millard County map showing 12-A Well Road. To the best of my knowledge and based upon my use of and familiarity with this road and the land it traverses, the location and route of the road are correctly illustrated on the attached map.

3. I am informed that the County also identifies this road according to the road number listed above.

4. I have observed that the road has been open to the public for all to use, to come and go as they pleased, since at least as early as the early 1970s and continuing through 1976 to 1999. Throughout this time period I have observed travel on the road by various means, including cars, trucks, recreational vehicles, and pickup trucks. Throughout this time period, the road has been used weekly for more than ten continuous years prior to 1976, and was so used through 1999.

00165788

B: 485 P: 710 Fee \$0.00
Connie Hansen, Millard Recorder Page 8 of 13
05/14/2008 10:27:43 AM By UT STATE GOVERNOR



5. Throughout the time period from the early 1940s to the present, I have used the road myself for the following uses: hunting, camping, county road work and recreation.

6. Throughout the time period described in the previous paragraph, I observed other vehicles from the general public using the road at various times for the uses described in the previous paragraph, plus the following uses: livestock operations, trapping, government access, picnicking, hiking and sightseeing.

7. It is also the reputation in the community that this road has been open to the public for all to use, to come and go as they pleased, since at least as early as the early 1940s and continuing through 1976 to the present, for the uses described in the previous paragraphs.

8. Prior to 1976, I participated in maintenance and construction activities on the road. Construction and maintenance have been performed since the early 1950s by Millard County Road Department.

DATED this 6 day of December, 2006.



JAY ATKINSON

SUBSCRIBED AND SWORN to before me this 6th day of December, 2006.

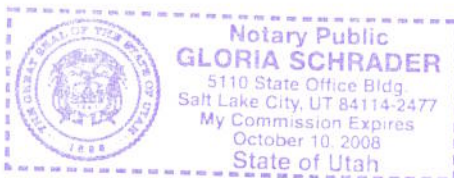



NOTARY PUBLIC

00165788

B: 485 P: 711 Fee \$0.00
Connie Hansen, Millard Recorder Page 9 of 13
05/14/2008 10:27:43 AM By UT STATE GOVERNOR



**ROAD = MC3445
12-A WELL ROAD**



MILLARD COUNTY

- B Class Road of Interest
- Interstate
- Highway Major
- Highway Minor
- B Class Road
- Unimproved Road
- County Border
- River
- Cities / Towns
- Lakes
- Lakes - Intermittent
- Township & Range Line
- Forest Service Lands
- BLM Lands
- State Trust Lands
- Private Lands

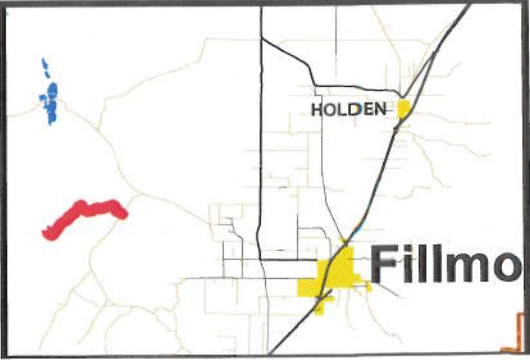

AFFIDAVIT OF WILLIAM THAYNE HENRIE

12-A WELL ROAD

MILLARD COUNTY, UTAH

ROAD NUMBER MC3445

State of Utah)
 : ss.
County of Millard)

WILLIAM THAYNE HENRIE, being first duly sworn, deposes and states as follows:

1. I am an adult competent to testify about the matters set forth below based upon my personal knowledge. I currently reside in Millard County, Utah. I have lived in Millard County for fifty-eight years. I have been an employee of the Millard County Road Department since June of 1990, have been the Road Department Supervisor from January 1993 to the present and have participated in maintenance of the road during that time.

2. I have traveled and am familiar with a road in Millard County known as 12-A Well Road. I am also familiar with the land the road traverses. When I first used and observed the road in the 1950s, it followed the same route as in 2006 when I last observed it. Attached is a Millard County map showing 12-A Well Road. To the best of my knowledge and based upon my use of and familiarity with this road and the land it traverses, the location and route of the road are correctly illustrated on the attached map.

3. I am informed that the County also identifies this road according to the road number listed above.

4. I have observed that the road has been open to the public for all to use, to come and go as they pleased, since at least as early as the 1950s and continuing through 1976 to the present. Throughout this time period I have observed travel on the road by means of cars, trucks, recreational vehicles, and pickup trucks. Throughout this time period, the road has been used weekly for more than ten continuous years prior to 1976, and is presently used weekly.

5. Throughout the time period from the 1950s to the present, I have used the road myself for camping, gathering fire wood, hunting, rock hounding, participating in search and rescue efforts and recreation.

6. Throughout the time period described in the previous paragraph, I have observed other vehicles from the general public using the road at various times for the uses described in the previous paragraph, plus mining, prospecting for minerals, livestock operations, farming, trapping, tourism, government access, picnicking, hiking and sightseeing.

7. It is also the reputation in the community that this road has been open to the public for all to use, to come and go as they pleased, since at least as early as the early 1900s and continuing through 1976 to the present, for the uses described in the previous paragraphs.

8. Prior to 1976 I observed graders and other maintenance equipment performing maintenance and construction activities on the road. Maintenance on the road has been performed since the 1950s by the Millard County Road Department.

DATED this 5 day of December, 2006.



WILLIAM THAYNE HENRIE

SUBSCRIBED AND SWORN to before me this 5th day of December, 2006.

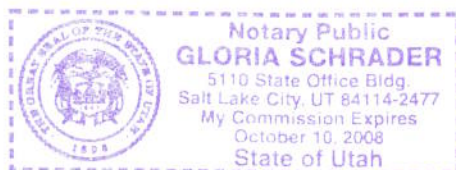



NOTARY PUBLIC



**ROAD = MC3445
12-A WELL ROAD**



MILLARD COUNTY

— B Class Road of Interest

- Interstate
- Highway Major
- Highway Minor
- B Class Road
- Unimproved Road

- County Border
- River
- Cities / Towns
- Lakes
- Lakes - Intermittent

- Township & Range Line
- Forest Service Lands
- BLM Lands
- State Trust Lands
- Private Lands

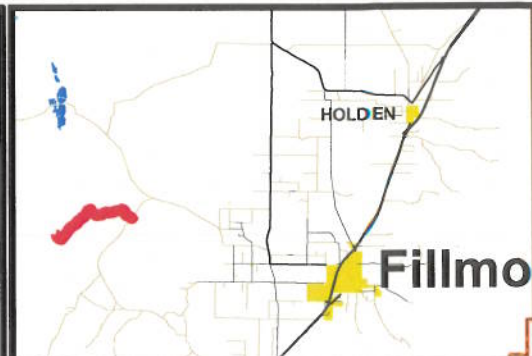

Appendix A to Attachment 4

Popular Name: 12-A Well Road

County: Millard

County Road Number: MC3445

State Geographic Information Database (SGID) Road Identification Number: RD141769.

Road-Segment Number: 001

Road-Segment Length: 3.19 miles more or less.

Believed owner of the land underlying this road-segment is: Bureau of Land Management.

The following description is based upon the geographic coordinate system using the NAD83 Datum. The source is GPS mapping grade data as indicated in the metadata and/or the transportation data model of the State of Utah Geographic Information Database (SGID).

The road-segment itself is the monument that is identified by its physical presence on the land. The location of said physical presence is closely approximated by mapping grade Global Positioning System (GPS) data. Said data are checked against the corresponding gray-scale 1-meter Digital Orthophoto Quadrangles published by the United States Geological Survey (USGS) to verify a reasonable degree of accuracy. In circumstances where accurate satellite signal acquisition is not possible, such as deep, narrow canyons or under a canopy of dense foliage, or where very sharp curves in the road make accuracy questionable, such portions of the road were digitized from the corresponding gray-scale 1-meter Digital Orthophoto Quadrangles published by the United States Geological Survey (USGS).

This road-segment may traverse:

Township 21 South Range 6 West, Section(s) 5,6, Salt Lake Base & Meridian

Township 21 South Range 7 West, Section(s) 1, Salt Lake Base & Meridian

The following description closely approximates the location of the centerline of the physical monument (12-A Well Road)-- Segment 001 based on mapping grade Global Positioning System (GPS) data as defined above:

Beginning at a point on the road center line located at 39 degrees 00 minutes 58.21 seconds North Latitude and -112 degrees 33 minutes 03.52 seconds West Longitude, which can be converted to mapping accuracy State Plane Utah Central Zone NAD 83 feet coordinates of X = 1,341,796.6 feet and Y = 6,812,138.8 feet; thence the following courses along the said road center line:

thence South 28 Degrees 32 Minutes 07 Seconds West 59.2 feet
thence South 24 Degrees 23 Minutes 56 Seconds West 36.1 feet
thence South 22 Degrees 57 Minutes 08 Seconds West 43.2 feet
thence South 23 Degrees 10 Minutes 41 Seconds West 43.6 feet
thence South 25 Degrees 39 Minutes 38 Seconds West 42 feet
thence South 30 Degrees 39 Minutes 37 Seconds West 45.9 feet
thence South 34 Degrees 53 Minutes 39 Seconds West 45 feet
thence South 36 Degrees 44 Minutes 45 Seconds West 41.9 feet
thence South 34 Degrees 16 Minutes 33 Seconds West 41.1 feet
thence South 34 Degrees 29 Minutes 09 Seconds West 38 feet
thence South 40 Degrees 58 Minutes 53 Seconds West 35.8 feet

thence South 54 Degrees 05 Minutes 31 Seconds West 32.7 feet
thence North 86 Degrees 06 Minutes 20 Seconds West 35.9 feet
thence North 58 Degrees 09 Minutes 40 Seconds West 43.8 feet
thence North 48 Degrees 03 Minutes 31 Seconds West 43.4 feet
thence North 36 Degrees 46 Minutes 21 Seconds West 37.5 feet
thence North 34 Degrees 31 Minutes 08 Seconds West 19.8 feet
thence North 30 Degrees 57 Minutes 14 Seconds West 10.3 feet
thence North 32 Degrees 14 Minutes 30 Seconds West 29.8 feet
thence North 43 Degrees 30 Minutes 48 Seconds West 29.7 feet
thence North 57 Degrees 36 Minutes 40 Seconds West 26.1 feet
thence North 70 Degrees 38 Minutes 58 Seconds West 24.4 feet
thence North 77 Degrees 08 Minutes 44 Seconds West 25.9 feet
thence North 77 Degrees 15 Minutes 27 Seconds West 27.6 feet
thence North 75 Degrees 15 Minutes 24 Seconds West 31.6 feet
thence North 73 Degrees 14 Minutes 46 Seconds West 30.2 feet
thence North 58 Degrees 14 Minutes 09 Seconds West 32.1 feet
thence North 51 Degrees 34 Minutes 00 Seconds West 38.3 feet
thence North 50 Degrees 55 Minutes 32 Seconds West 45 feet
thence North 56 Degrees 03 Minutes 40 Seconds West 47.2 feet
thence North 61 Degrees 03 Minutes 16 Seconds West 47 feet
thence North 61 Degrees 37 Minutes 48 Seconds West 47.9 feet
thence North 61 Degrees 10 Minutes 28 Seconds West 49.2 feet
thence North 56 Degrees 54 Minutes 53 Seconds West 17.3 feet
thence North 55 Degrees 41 Minutes 31 Seconds West 28.3 feet
thence North 55 Degrees 18 Minutes 40 Seconds West 84.1 feet
thence North 54 Degrees 12 Minutes 17 Seconds West 39 feet
thence North 56 Degrees 30 Minutes 50 Seconds West 52.5 feet
thence North 62 Degrees 01 Minutes 42 Seconds West 49.2 feet
thence North 65 Degrees 47 Minutes 25 Seconds West 45.1 feet
thence North 68 Degrees 25 Minutes 02 Seconds West 41.4 feet
thence North 71 Degrees 41 Minutes 53 Seconds West 35 feet
thence North 73 Degrees 39 Minutes 52 Seconds West 29.8 feet
thence North 69 Degrees 44 Minutes 50 Seconds West 25.2 feet
thence North 72 Degrees 17 Minutes 56 Seconds West 13.8 feet
thence North 71 Degrees 05 Minutes 57 Seconds West 30.9 feet
thence North 71 Degrees 13 Minutes 41 Seconds West 37.2 feet
thence North 72 Degrees 40 Minutes 30 Seconds West 36.8 feet
thence North 68 Degrees 35 Minutes 21 Seconds West 39.9 feet
thence North 70 Degrees 10 Minutes 01 Seconds West 41.9 feet
thence North 66 Degrees 26 Minutes 05 Seconds West 40.5 feet
thence North 65 Degrees 47 Minutes 01 Seconds West 41.1 feet
thence North 65 Degrees 14 Minutes 08 Seconds West 44.9 feet
thence North 64 Degrees 06 Minutes 54 Seconds West 44.6 feet
thence North 63 Degrees 20 Minutes 39 Seconds West 42.7 feet
thence North 68 Degrees 12 Minutes 57 Seconds West 24.4 feet
thence North 74 Degrees 52 Minutes 51 Seconds West 9.9 feet
thence North 65 Degrees 39 Minutes 23 Seconds West 30.7 feet
thence North 67 Degrees 56 Minutes 46 Seconds West 44 feet
thence North 74 Degrees 34 Minutes 16 Seconds West 48.4 feet

thence North 79 Degrees 36 Minutes 39 Seconds West 47.8 feet
thence North 76 Degrees 49 Minutes 20 Seconds West 49.3 feet
thence North 69 Degrees 39 Minutes 22 Seconds West 48.4 feet
thence North 54 Degrees 06 Minutes 36 Seconds West 50 feet
thence North 41 Degrees 29 Minutes 21 Seconds West 52.3 feet
thence North 39 Degrees 39 Minutes 56 Seconds West 54.3 feet
thence North 38 Degrees 06 Minutes 53 Seconds West 51.9 feet
thence North 34 Degrees 48 Minutes 42 Seconds West 51 feet
thence North 30 Degrees 53 Minutes 57 Seconds West 43.8 feet
thence North 22 Degrees 43 Minutes 44 Seconds West 44.7 feet
thence North 15 Degrees 12 Minutes 32 Seconds West 47.2 feet
thence North 10 Degrees 20 Minutes 00 Seconds West 49 feet
thence North 07 Degrees 28 Minutes 39 Seconds West 47.3 feet
thence North 03 Degrees 34 Minutes 25 Seconds West 46 feet
thence North 00 Degrees 18 Minutes 11 Seconds West 47.6 feet
thence North 02 Degrees 48 Minutes 42 Seconds East 48.3 feet
thence North 02 Degrees 20 Minutes 00 Seconds East 49.9 feet
thence North 00 Degrees 47 Minutes 54 Seconds East 51.2 feet
thence North 03 Degrees 13 Minutes 13 Seconds West 51.6 feet
thence North 04 Degrees 56 Minutes 54 Seconds West 52.7 feet
thence North 06 Degrees 45 Minutes 20 Seconds West 55.5 feet
thence North 07 Degrees 12 Minutes 52 Seconds West 54.5 feet
thence North 09 Degrees 22 Minutes 49 Seconds West 56.2 feet
thence North 09 Degrees 56 Minutes 51 Seconds West 50.9 feet
thence North 16 Degrees 33 Minutes 48 Seconds West 49.2 feet
thence North 27 Degrees 20 Minutes 03 Seconds West 54.2 feet
thence North 36 Degrees 57 Minutes 33 Seconds West 52.8 feet
thence North 41 Degrees 57 Minutes 53 Seconds West 55.8 feet
thence North 42 Degrees 41 Minutes 23 Seconds West 56 feet
thence North 36 Degrees 50 Minutes 31 Seconds West 56.8 feet
thence North 28 Degrees 33 Minutes 40 Seconds West 59.6 feet
thence North 31 Degrees 54 Minutes 38 Seconds West 60.1 feet
thence North 45 Degrees 18 Minutes 11 Seconds West 55.7 feet
thence North 56 Degrees 42 Minutes 43 Seconds West 52.8 feet
thence North 61 Degrees 04 Minutes 44 Seconds West 53.8 feet
thence North 60 Degrees 25 Minutes 38 Seconds West 53.4 feet
thence North 57 Degrees 09 Minutes 47 Seconds West 47.4 feet
thence North 54 Degrees 04 Minutes 15 Seconds West 47.2 feet
thence North 52 Degrees 31 Minutes 39 Seconds West 49.8 feet
thence North 49 Degrees 42 Minutes 07 Seconds West 6.1 feet
thence North 48 Degrees 42 Minutes 21 Seconds West 43 feet
thence North 43 Degrees 25 Minutes 15 Seconds West 49.4 feet
thence North 37 Degrees 41 Minutes 28 Seconds West 50.8 feet
thence North 31 Degrees 46 Minutes 48 Seconds West 37.7 feet
thence North 30 Degrees 02 Minutes 53 Seconds West 13.2 feet
thence North 29 Degrees 04 Minutes 15 Seconds West 19.1 feet
thence North 29 Degrees 34 Minutes 42 Seconds West 49.7 feet
thence North 39 Degrees 30 Minutes 37 Seconds West 48.3 feet
thence North 47 Degrees 47 Minutes 34 Seconds West 16 feet

thence North 51 Degrees 18 Minutes 44 Seconds West 8.9 feet
thence North 64 Degrees 35 Minutes 36 Seconds West 9.8 feet
thence North 79 Degrees 28 Minutes 49 Seconds West 22.7 feet
thence South 79 Degrees 02 Minutes 10 Seconds West 28.4 feet
thence South 69 Degrees 39 Minutes 56 Seconds West 33.5 feet
thence South 67 Degrees 29 Minutes 35 Seconds West 34.7 feet
thence South 66 Degrees 29 Minutes 53 Seconds West 37.5 feet
thence South 67 Degrees 42 Minutes 19 Seconds West 36.8 feet
thence South 68 Degrees 09 Minutes 20 Seconds West 40.2 feet
thence South 67 Degrees 53 Minutes 42 Seconds West 37.1 feet
thence South 68 Degrees 39 Minutes 33 Seconds West 36.6 feet
thence South 67 Degrees 36 Minutes 58 Seconds West 37.5 feet
thence South 69 Degrees 22 Minutes 24 Seconds West 37.8 feet
thence South 68 Degrees 04 Minutes 54 Seconds West 37.4 feet
thence South 69 Degrees 04 Minutes 59 Seconds West 38.2 feet
thence South 68 Degrees 57 Minutes 28 Seconds West 36.1 feet
thence South 69 Degrees 39 Minutes 56 Seconds West 33.5 feet
thence South 68 Degrees 07 Minutes 31 Seconds West 30.3 feet
thence South 69 Degrees 00 Minutes 04 Seconds West 31.6 feet
thence South 66 Degrees 10 Minutes 24 Seconds West 30.4 feet
thence South 65 Degrees 15 Minutes 09 Seconds West 31.7 feet
thence South 66 Degrees 58 Minutes 56 Seconds West 30.6 feet
thence South 65 Degrees 55 Minutes 27 Seconds West 30.1 feet
thence South 68 Degrees 14 Minutes 56 Seconds West 29.6 feet
thence South 67 Degrees 59 Minutes 46 Seconds West 34.6 feet
thence South 69 Degrees 37 Minutes 30 Seconds West 36.3 feet
thence South 70 Degrees 45 Minutes 27 Seconds West 35.4 feet
thence South 72 Degrees 16 Minutes 43 Seconds West 35.1 feet
thence South 71 Degrees 26 Minutes 01 Seconds West 34.6 feet
thence South 73 Degrees 18 Minutes 25 Seconds West 34.9 feet
thence South 71 Degrees 15 Minutes 42 Seconds West 33.2 feet
thence South 71 Degrees 15 Minutes 42 Seconds West 25.9 feet
thence South 70 Degrees 53 Minutes 48 Seconds West 16.3 feet
thence South 70 Degrees 31 Minutes 03 Seconds West 24 feet
thence South 71 Degrees 41 Minutes 33 Seconds West 27.6 feet
thence South 71 Degrees 55 Minutes 31 Seconds West 26.9 feet
thence South 69 Degrees 18 Minutes 06 Seconds West 27.3 feet
thence South 68 Degrees 10 Minutes 26 Seconds West 25 feet
thence South 69 Degrees 35 Minutes 02 Seconds West 24.8 feet
thence South 69 Degrees 50 Minutes 29 Seconds West 25.1 feet
thence South 70 Degrees 32 Minutes 54 Seconds West 25 feet
thence South 69 Degrees 08 Minutes 26 Seconds West 28 feet
thence South 69 Degrees 36 Minutes 05 Seconds West 28.7 feet
thence South 69 Degrees 16 Minutes 27 Seconds West 32.9 feet
thence South 68 Degrees 42 Minutes 14 Seconds West 30.2 feet
thence South 68 Degrees 13 Minutes 44 Seconds West 31.4 feet
thence South 68 Degrees 50 Minutes 32 Seconds West 29.5 feet
thence South 68 Degrees 59 Minutes 15 Seconds West 28.8 feet
thence South 70 Degrees 02 Minutes 34 Seconds West 29.3 feet

thence South 69 Degrees 17 Minutes 12 Seconds West 30.1 feet
thence South 69 Degrees 30 Minutes 08 Seconds West 30.4 feet
thence South 70 Degrees 40 Minutes 16 Seconds West 30.2 feet
thence South 72 Degrees 29 Minutes 53 Seconds West 28.9 feet
thence South 72 Degrees 04 Minutes 28 Seconds West 29.3 feet
thence South 76 Degrees 31 Minutes 27 Seconds West 31.7 feet
thence South 77 Degrees 41 Minutes 07 Seconds West 31.5 feet
thence South 79 Degrees 52 Minutes 38 Seconds West 34.6 feet
thence South 87 Degrees 05 Minutes 39 Seconds West 36.1 feet
thence North 88 Degrees 10 Minutes 55 Seconds West 35.5 feet
thence North 80 Degrees 08 Minutes 28 Seconds West 35.3 feet
thence North 76 Degrees 24 Minutes 01 Seconds West 34.1 feet
thence North 70 Degrees 59 Minutes 12 Seconds West 33.7 feet
thence North 71 Degrees 02 Minutes 16 Seconds West 35.8 feet
thence North 74 Degrees 54 Minutes 53 Seconds West 37.1 feet
thence North 82 Degrees 22 Minutes 13 Seconds West 40.4 feet
thence South 86 Degrees 41 Minutes 02 Seconds West 43.7 feet
thence South 76 Degrees 14 Minutes 53 Seconds West 46.6 feet
thence South 73 Degrees 04 Minutes 33 Seconds West 45.9 feet
thence South 70 Degrees 02 Minutes 34 Seconds West 43.9 feet
thence South 70 Degrees 51 Minutes 46 Seconds West 44.7 feet
thence South 73 Degrees 41 Minutes 33 Seconds West 44 feet
thence South 80 Degrees 05 Minutes 04 Seconds West 41.3 feet
thence South 81 Degrees 09 Minutes 57 Seconds West 39.8 feet
thence South 79 Degrees 18 Minutes 28 Seconds West 40 feet
thence South 72 Degrees 37 Minutes 45 Seconds West 39.1 feet
thence South 70 Degrees 57 Minutes 19 Seconds West 38.8 feet
thence South 70 Degrees 48 Minutes 38 Seconds West 39.5 feet
thence South 70 Degrees 16 Minutes 52 Seconds West 42.4 feet
thence South 71 Degrees 07 Minutes 39 Seconds West 44.3 feet
thence South 72 Degrees 10 Minutes 16 Seconds West 45.8 feet
thence South 71 Degrees 23 Minutes 18 Seconds West 47 feet
thence South 71 Degrees 59 Minutes 46 Seconds West 48.6 feet
thence South 71 Degrees 01 Minutes 12 Seconds West 49.2 feet
thence South 66 Degrees 11 Minutes 53 Seconds West 49.4 feet
thence South 57 Degrees 38 Minutes 48 Seconds West 44.5 feet
thence South 50 Degrees 48 Minutes 44 Seconds West 39.2 feet
thence South 51 Degrees 15 Minutes 34 Seconds West 26.4 feet
thence South 48 Degrees 30 Minutes 39 Seconds West 10.5 feet
thence South 47 Degrees 54 Minutes 44 Seconds West 20.7 feet
thence South 50 Degrees 18 Minutes 51 Seconds West 28.4 feet
thence South 52 Degrees 55 Minutes 56 Seconds West 35.6 feet
thence South 56 Degrees 47 Minutes 29 Seconds West 39.9 feet
thence South 60 Degrees 32 Minutes 55 Seconds West 39.1 feet
thence South 69 Degrees 54 Minutes 56 Seconds West 39.8 feet
thence South 81 Degrees 04 Minutes 52 Seconds West 43.8 feet
thence South 88 Degrees 23 Minutes 05 Seconds West 43 feet
thence South 87 Degrees 50 Minutes 57 Seconds West 40.7 feet
thence South 87 Degrees 09 Minutes 47 Seconds West 37.1 feet

thence South 82 Degrees 26 Minutes 00 Seconds West 33.7 feet
thence South 85 Degrees 10 Minutes 04 Seconds West 33.2 feet
thence South 82 Degrees 09 Minutes 51 Seconds West 40.1 feet
thence South 79 Degrees 44 Minutes 19 Seconds West 43.6 feet
thence South 81 Degrees 41 Minutes 31 Seconds West 42.4 feet
thence South 81 Degrees 27 Minutes 01 Seconds West 45.8 feet
thence South 83 Degrees 00 Minutes 35 Seconds West 47.9 feet
thence South 82 Degrees 28 Minutes 21 Seconds West 47 feet
thence South 82 Degrees 55 Minutes 02 Seconds West 47.3 feet
thence South 82 Degrees 12 Minutes 42 Seconds West 45.3 feet
thence South 81 Degrees 23 Minutes 28 Seconds West 45.4 feet
thence South 82 Degrees 57 Minutes 39 Seconds West 42 feet
thence South 82 Degrees 34 Minutes 18 Seconds West 39.7 feet
thence South 83 Degrees 03 Minutes 51 Seconds West 42.6 feet
thence South 82 Degrees 25 Minutes 18 Seconds West 46.6 feet
thence South 83 Degrees 34 Minutes 52 Seconds West 46.2 feet
thence South 83 Degrees 51 Minutes 43 Seconds West 45.2 feet
thence South 83 Degrees 24 Minutes 10 Seconds West 44.9 feet
thence South 83 Degrees 02 Minutes 08 Seconds West 45.3 feet
thence South 81 Degrees 44 Minutes 37 Seconds West 45.1 feet
thence South 83 Degrees 18 Minutes 35 Seconds West 44.2 feet
thence South 83 Degrees 45 Minutes 00 Seconds West 47.5 feet
thence South 86 Degrees 19 Minutes 49 Seconds West 44.7 feet
thence North 82 Degrees 44 Minutes 30 Seconds West 37.4 feet
thence North 70 Degrees 54 Minutes 19 Seconds West 24.7 feet
thence North 58 Degrees 17 Minutes 51 Seconds West 6.2 feet
thence North 55 Degrees 31 Minutes 30 Seconds West 14.4 feet
thence North 45 Degrees 52 Minutes 13 Seconds West 23.4 feet
thence North 35 Degrees 21 Minutes 08 Seconds West 26.9 feet
thence North 38 Degrees 07 Minutes 53 Seconds West 35.3 feet
thence North 45 Degrees 40 Minutes 57 Seconds West 35 feet
thence North 53 Degrees 07 Minutes 06 Seconds West 35.8 feet
thence North 61 Degrees 20 Minutes 34 Seconds West 38.6 feet
thence North 71 Degrees 33 Minutes 12 Seconds West 37.8 feet
thence North 82 Degrees 26 Minutes 59 Seconds West 38.4 feet
thence South 87 Degrees 04 Minutes 13 Seconds West 35.8 feet
thence South 78 Degrees 09 Minutes 44 Seconds West 32.8 feet
thence South 73 Degrees 05 Minutes 55 Seconds West 35.6 feet
thence South 70 Degrees 20 Minutes 16 Seconds West 38.6 feet
thence South 71 Degrees 59 Minutes 13 Seconds West 41 feet
thence South 79 Degrees 21 Minutes 18 Seconds West 45.7 feet
thence North 89 Degrees 32 Minutes 57 Seconds West 49.9 feet
thence North 85 Degrees 02 Minutes 43 Seconds West 53.7 feet
thence North 85 Degrees 30 Minutes 31 Seconds West 51 feet
thence North 84 Degrees 35 Minutes 32 Seconds West 49.5 feet
thence North 86 Degrees 35 Minutes 16 Seconds West 50.6 feet
thence North 88 Degrees 22 Minutes 05 Seconds West 48.6 feet
thence South 87 Degrees 50 Minutes 57 Seconds West 50.9 feet
thence South 80 Degrees 25 Minutes 00 Seconds West 50.9 feet

thence South 76 Degrees 23 Minutes 54 Seconds West 18.5 feet
thence South 76 Degrees 14 Minutes 53 Seconds West 31 feet
thence South 71 Degrees 07 Minutes 40 Seconds West 44.3 feet
thence South 68 Degrees 54 Minutes 43 Seconds West 48.1 feet
thence South 62 Degrees 49 Minutes 22 Seconds West 54.4 feet
thence South 56 Degrees 16 Minutes 39 Seconds West 57.8 feet
thence South 53 Degrees 30 Minutes 13 Seconds West 50 feet
thence South 53 Degrees 05 Minutes 23 Seconds West 14.3 feet
thence South 54 Degrees 42 Minutes 17 Seconds West 8 feet
thence South 53 Degrees 58 Minutes 10 Seconds West 23 feet
thence South 52 Degrees 31 Minutes 56 Seconds West 25.5 feet
thence South 52 Degrees 49 Minutes 37 Seconds West 26.3 feet
thence South 51 Degrees 42 Minutes 48 Seconds West 30.4 feet
thence South 48 Degrees 17 Minutes 37 Seconds West 40.7 feet
thence South 49 Degrees 23 Minutes 30 Seconds West 48.2 feet
thence South 53 Degrees 35 Minutes 09 Seconds West 49.6 feet
thence South 56 Degrees 06 Minutes 55 Seconds West 48.1 feet
thence South 56 Degrees 31 Minutes 50 Seconds West 49.8 feet
thence South 57 Degrees 41 Minutes 29 Seconds West 49.5 feet
thence South 57 Degrees 20 Minutes 20 Seconds West 50.9 feet
thence South 57 Degrees 04 Minutes 39 Seconds West 48.7 feet
thence South 56 Degrees 47 Minutes 30 Seconds West 46.5 feet
thence South 56 Degrees 39 Minutes 24 Seconds West 48.1 feet
thence South 56 Degrees 18 Minutes 30 Seconds West 51.9 feet
thence South 56 Degrees 43 Minutes 09 Seconds West 51.2 feet
thence South 56 Degrees 56 Minutes 21 Seconds West 50.3 feet
thence South 55 Degrees 54 Minutes 19 Seconds West 51.3 feet
thence South 56 Degrees 00 Minutes 24 Seconds West 49.7 feet
thence South 57 Degrees 11 Minutes 45 Seconds West 48.2 feet
thence South 57 Degrees 54 Minutes 17 Seconds West 46.7 feet
thence South 63 Degrees 54 Minutes 03 Seconds West 43.7 feet
thence South 78 Degrees 27 Minutes 45 Seconds West 48.8 feet
thence South 84 Degrees 46 Minutes 35 Seconds West 49.7 feet
thence South 88 Degrees 59 Minutes 22 Seconds West 53.2 feet
thence South 87 Degrees 48 Minutes 46 Seconds West 49.9 feet
thence South 88 Degrees 27 Minutes 38 Seconds West 45.6 feet
thence North 86 Degrees 57 Minutes 39 Seconds West 45 feet
thence North 86 Degrees 31 Minutes 00 Seconds West 44.7 feet
thence North 85 Degrees 21 Minutes 09 Seconds West 41.8 feet
thence North 83 Degrees 40 Minutes 13 Seconds West 42.6 feet
thence North 83 Degrees 25 Minutes 41 Seconds West 46.6 feet
thence North 85 Degrees 41 Minutes 54 Seconds West 49.1 feet
thence South 88 Degrees 53 Minutes 24 Seconds West 46.6 feet
thence South 85 Degrees 27 Minutes 38 Seconds West 44.4 feet
thence South 86 Degrees 57 Minutes 07 Seconds West 48 feet
thence South 88 Degrees 32 Minutes 36 Seconds West 48.9 feet
thence South 89 Degrees 41 Minutes 49 Seconds West 46.6 feet
thence North 88 Degrees 22 Minutes 04 Seconds West 48.6 feet
thence South 87 Degrees 01 Minutes 30 Seconds West 49.3 feet

thence South 77 Degrees 17 Minutes 50 Seconds West 47.4 feet
thence South 63 Degrees 49 Minutes 50 Seconds West 48.1 feet
thence South 62 Degrees 47 Minutes 27 Seconds West 49.3 feet
thence South 66 Degrees 24 Minutes 08 Seconds West 51.4 feet
thence South 70 Degrees 33 Minutes 48 Seconds West 51.1 feet
thence South 70 Degrees 57 Minutes 20 Seconds West 58.2 feet
thence South 71 Degrees 04 Minutes 31 Seconds West 63.7 feet
thence South 72 Degrees 24 Minutes 56 Seconds West 61.9 feet
thence South 74 Degrees 47 Minutes 12 Seconds West 57.4 feet
thence South 73 Degrees 59 Minutes 18 Seconds West 54.5 feet
thence South 80 Degrees 52 Minutes 14 Seconds West 53.5 feet
thence North 87 Degrees 24 Minutes 15 Seconds West 51.9 feet
thence North 78 Degrees 20 Minutes 16 Seconds West 50.6 feet
thence North 68 Degrees 52 Minutes 05 Seconds West 47.6 feet
thence North 54 Degrees 48 Minutes 34 Seconds West 49.2 feet
thence North 46 Degrees 23 Minutes 38 Seconds West 48.7 feet
thence North 42 Degrees 40 Minutes 13 Seconds West 40.4 feet
thence North 37 Degrees 36 Minutes 24 Seconds West 8.7 feet
thence North 42 Degrees 48 Minutes 48 Seconds West 21.4 feet
thence North 43 Degrees 04 Minutes 18 Seconds West 35.8 feet
thence North 51 Degrees 47 Minutes 09 Seconds West 41.1 feet
thence North 66 Degrees 20 Minutes 25 Seconds West 42 feet
thence North 75 Degrees 00 Minutes 35 Seconds West 43.5 feet
thence North 70 Degrees 31 Minutes 07 Seconds West 48.5 feet
thence North 59 Degrees 27 Minutes 54 Seconds West 51.2 feet
thence North 53 Degrees 30 Minutes 11 Seconds West 53.7 feet
thence North 55 Degrees 35 Minutes 11 Seconds West 55.9 feet
thence North 57 Degrees 26 Minutes 49 Seconds West 56.2 feet
thence North 57 Degrees 54 Minutes 53 Seconds West 52.1 feet
thence North 55 Degrees 05 Minutes 07 Seconds West 47.8 feet
thence North 53 Degrees 10 Minutes 36 Seconds West 44 feet
thence North 51 Degrees 49 Minutes 50 Seconds West 46.9 feet
thence North 49 Degrees 42 Minutes 05 Seconds West 48.4 feet
thence North 47 Degrees 09 Minutes 01 Seconds West 50.4 feet
thence North 45 Degrees 48 Minutes 35 Seconds West 52.4 feet
thence North 45 Degrees 18 Minutes 10 Seconds West 50.1 feet
thence North 45 Degrees 18 Minutes 10 Seconds West 47.3 feet
thence North 45 Degrees 18 Minutes 10 Seconds West 47.8 feet
thence North 48 Degrees 22 Minutes 27 Seconds West 47.6 feet
thence North 50 Degrees 20 Minutes 12 Seconds West 45 feet
thence North 49 Degrees 59 Minutes 19 Seconds West 42.6 feet
thence North 51 Degrees 21 Minutes 42 Seconds West 41.8 feet
thence North 53 Degrees 31 Minutes 07 Seconds West 43.8 feet
thence North 55 Degrees 01 Minutes 18 Seconds West 42.6 feet
thence North 55 Degrees 49 Minutes 08 Seconds West 39.4 feet
thence North 56 Degrees 28 Minutes 36 Seconds West 38.3 feet
thence North 58 Degrees 53 Minutes 51 Seconds West 36.5 feet
thence North 58 Degrees 14 Minutes 27 Seconds West 35.2 feet
thence North 57 Degrees 12 Minutes 40 Seconds West 34.9 feet

thence North 55 Degrees 38 Minutes 40 Seconds West 32.3 feet
thence North 56 Degrees 18 Minutes 23 Seconds West 34 feet
thence North 54 Degrees 45 Minutes 54 Seconds West 39.5 feet
thence North 55 Degrees 38 Minutes 08 Seconds West 42.7 feet
thence North 55 Degrees 05 Minutes 07 Seconds West 41 feet
thence North 52 Degrees 25 Minutes 40 Seconds West 37.4 feet
thence North 39 Degrees 13 Minutes 49 Seconds West 32.9 feet
thence North 22 Degrees 47 Minutes 57 Seconds West 35.2 feet
thence North 13 Degrees 57 Minutes 38 Seconds West 36.1 feet
thence North 09 Degrees 51 Minutes 26 Seconds West 33.6 feet
thence North 12 Degrees 30 Minutes 12 Seconds West 12.4 feet
thence North 09 Degrees 16 Minutes 32 Seconds West 31.6 feet
thence North 07 Degrees 08 Minutes 44 Seconds West 41.3 feet
thence North 05 Degrees 12 Minutes 53 Seconds West 42.2 feet
thence North 01 Degrees 20 Minutes 40 Seconds West 36.1 feet
thence North 05 Degrees 24 Minutes 27 Seconds East 26.4 feet
thence North 11 Degrees 23 Minutes 11 Seconds East 29.2 feet
thence North 15 Degrees 51 Minutes 15 Seconds East 36.6 feet
thence North 06 Degrees 11 Minutes 26 Seconds East 40.6 feet
thence North 11 Degrees 31 Minutes 31 Seconds West 42.2 feet
thence North 24 Degrees 24 Minutes 18 Seconds West 41 feet
thence North 23 Degrees 22 Minutes 24 Seconds West 38.5 feet
thence North 18 Degrees 25 Minutes 59 Seconds West 39 feet
thence North 19 Degrees 39 Minutes 43 Seconds West 38.6 feet
thence North 27 Degrees 05 Minutes 24 Seconds West 37.9 feet
thence North 37 Degrees 16 Minutes 16 Seconds West 38.2 feet
thence North 54 Degrees 49 Minutes 39 Seconds West 35.1 feet
thence North 52 Degrees 10 Minutes 22 Seconds West 38.8 feet
thence North 60 Degrees 41 Minutes 17 Seconds West 35.9 feet
thence North 73 Degrees 47 Minutes 54 Seconds West 9.2 feet
thence North 76 Degrees 48 Minutes 26 Seconds West 25.3 feet
thence North 85 Degrees 35 Minutes 42 Seconds West 28 feet
thence South 86 Degrees 42 Minutes 56 Seconds West 31.5 feet
thence South 80 Degrees 41 Minutes 43 Seconds West 33.6 feet
thence South 71 Degrees 26 Minutes 22 Seconds West 33.5 feet
thence South 60 Degrees 05 Minutes 33 Seconds West 33.2 feet
thence South 52 Degrees 15 Minutes 55 Seconds West 33.5 feet
thence South 48 Degrees 24 Minutes 44 Seconds West 35.8 feet
thence South 48 Degrees 42 Minutes 17 Seconds West 36.5 feet
thence South 49 Degrees 17 Minutes 49 Seconds West 40.5 feet
thence South 51 Degrees 37 Minutes 05 Seconds West 40.4 feet
thence South 57 Degrees 24 Minutes 03 Seconds West 41.1 feet
thence South 62 Degrees 56 Minutes 11 Seconds West 43 feet
thence South 74 Degrees 00 Minutes 07 Seconds West 41.2 feet
thence South 87 Degrees 43 Minutes 19 Seconds West 38.1 feet
thence North 85 Degrees 06 Minutes 30 Seconds West 43.5 feet
thence North 88 Degrees 26 Minutes 06 Seconds West 30.2 feet
thence South 89 Degrees 41 Minutes 49 Seconds West 6.2 feet
thence South 89 Degrees 41 Minutes 49 Seconds West 5.9 feet

thence South 85 Degrees 33 Minutes 08 Seconds West 22.7 feet
thence South 78 Degrees 30 Minutes 07 Seconds West 32.1 feet
thence South 69 Degrees 04 Minutes 43 Seconds West 35.4 feet
thence South 59 Degrees 21 Minutes 53 Seconds West 35.7 feet
thence South 43 Degrees 05 Minutes 00 Seconds West 33 feet
thence South 28 Degrees 52 Minutes 40 Seconds West 28.9 feet
thence South 18 Degrees 20 Minutes 19 Seconds West 28.7 feet
thence South 14 Degrees 44 Minutes 05 Seconds West 22.8 feet
thence South 16 Degrees 05 Minutes 11 Seconds West 29.1 feet
thence South 19 Degrees 27 Minutes 23 Seconds West 35.9 feet
thence South 25 Degrees 48 Minutes 39 Seconds West 37.3 feet
thence South 26 Degrees 52 Minutes 02 Seconds West 41.7 feet
thence South 27 Degrees 23 Minutes 47 Seconds West 44.5 feet
thence South 26 Degrees 37 Minutes 29 Seconds West 46.4 feet
thence South 27 Degrees 12 Minutes 04 Seconds West 44.8 feet
thence South 29 Degrees 49 Minutes 34 Seconds West 42.5 feet
thence South 33 Degrees 31 Minutes 09 Seconds West 39.5 feet
thence South 37 Degrees 15 Minutes 56 Seconds West 37.7 feet
thence South 37 Degrees 42 Minutes 31 Seconds West 36.2 feet
thence South 37 Degrees 37 Minutes 05 Seconds West 35.8 feet
thence South 35 Degrees 41 Minutes 02 Seconds West 34.1 feet
thence South 29 Degrees 44 Minutes 18 Seconds West 31.5 feet more or less to **the ending**

point at: 39 degrees 01 minutes 10.31 seconds North Latitude and -112 degrees 35 minutes 52.06 seconds West Longitude, which can be converted to mapping accuracy State Plane Utah Central Zone NAD 83 feet coordinates of X = 1,328,509.7 feet and Y = 6,813,522.9 feet.

Appendix B to Attachment 4

Popular Name: 12-A Well Road

County: Millard

County Road Number: MC3445

State Geographic Information Database (SGID) Road Identification Number: RD141769.

Road-Segment Number: 003

Road-Segment Length: 1.49 miles more or less.

Believed owner of the land underlying this road-segment is: Bureau of Land Management.

The following description is based upon the geographic coordinate system using the NAD83 Datum. The source is GPS mapping grade data as indicated in the metadata and/or the transportation data model of the State of Utah Geographic Information Database (SGID).

The road-segment itself is the monument that is identified by its physical presence on the land. The location of said physical presence is closely approximated by mapping grade Global Positioning System (GPS) data. Said data are checked against the corresponding gray-scale 1-meter Digital Orthophoto Quadrangles published by the United States Geological Survey (USGS) to verify a reasonable degree of accuracy. In circumstances where accurate satellite signal acquisition is not possible, such as deep, narrow canyons or under a canopy of dense foliage, or where very sharp curves in the road make accuracy questionable, such portions of the road were digitized from the corresponding gray-scale 1-meter Digital Orthophoto Quadrangles published by the United States Geological Survey (USGS).

This road-segment may traverse:

Township 21 South Range 7 West, Section(s) 10,11, Salt Lake Base & Meridian

The following description closely approximates the location of the centerline of the physical monument (12-A Well Road)-- Segment 003 based on mapping grade Global Positioning System (GPS) data as defined above:

Beginning at a point on the road center line located at 39 degrees 00 minutes 32.89 seconds North Latitude and -112 degrees 36 minutes 38.75 seconds West Longitude, which can be converted to mapping accuracy State Plane Utah Central Zone NAD 83 feet coordinates of X = 1,324,778.1 feet and Y = 6,809,783.0 feet; thence the following courses along the said road center line:

thence South 48 Degrees 14 Minutes 32 Seconds West 26.3 feet
thence South 47 Degrees 47 Minutes 29 Seconds West 17.2 feet
thence South 39 Degrees 24 Minutes 58 Seconds West 55.5 feet
thence South 35 Degrees 14 Minutes 06 Seconds West 56.5 feet
thence South 37 Degrees 06 Minutes 10 Seconds West 56.2 feet
thence South 47 Degrees 19 Minutes 57 Seconds West 55.5 feet
thence South 55 Degrees 00 Minutes 08 Seconds West 62.3 feet
thence South 57 Degrees 37 Minutes 48 Seconds West 64.3 feet
thence South 57 Degrees 08 Minutes 13 Seconds West 64.6 feet
thence South 56 Degrees 14 Minutes 54 Seconds West 64.9 feet
thence South 56 Degrees 29 Minutes 27 Seconds West 64.7 feet
thence South 56 Degrees 15 Minutes 44 Seconds West 61.3 feet

thence South 53 Degrees 50 Minutes 40 Seconds West 55.5 feet
thence South 51 Degrees 12 Minutes 11 Seconds West 53.2 feet
thence South 51 Degrees 08 Minutes 08 Seconds West 60 feet
thence South 60 Degrees 21 Minutes 21 Seconds West 63.6 feet
thence South 70 Degrees 47 Minutes 20 Seconds West 62.8 feet
thence South 78 Degrees 51 Minutes 52 Seconds West 54.1 feet
thence South 81 Degrees 27 Minutes 42 Seconds West 25.2 feet
thence South 80 Degrees 14 Minutes 06 Seconds West 22 feet
thence South 77 Degrees 36 Minutes 10 Seconds West 18.8 feet
thence South 76 Degrees 04 Minutes 14 Seconds West 11.1 feet
thence South 80 Degrees 26 Minutes 14 Seconds West 30.6 feet
thence South 82 Degrees 18 Minutes 41 Seconds West 35.7 feet
thence South 80 Degrees 45 Minutes 07 Seconds West 35.9 feet
thence South 74 Degrees 23 Minutes 48 Seconds West 36.1 feet
thence South 70 Degrees 04 Minutes 46 Seconds West 35.2 feet
thence South 62 Degrees 39 Minutes 25 Seconds West 35.4 feet
thence South 57 Degrees 57 Minutes 30 Seconds West 37.4 feet
thence South 50 Degrees 54 Minutes 47 Seconds West 70.7 feet
thence South 50 Degrees 13 Minutes 30 Seconds West 36.1 feet
thence South 43 Degrees 34 Minutes 27 Seconds West 35.5 feet
thence South 42 Degrees 27 Minutes 59 Seconds West 35.8 feet
thence South 36 Degrees 20 Minutes 35 Seconds West 33.5 feet
thence South 30 Degrees 52 Minutes 57 Seconds West 14.6 feet
thence South 32 Degrees 33 Minutes 58 Seconds West 25.4 feet
thence South 33 Degrees 55 Minutes 45 Seconds West 38.5 feet
thence South 33 Degrees 44 Minutes 36 Seconds West 44 feet
thence South 33 Degrees 43 Minutes 00 Seconds West 47.5 feet
thence South 34 Degrees 45 Minutes 25 Seconds West 45.7 feet
thence South 34 Degrees 39 Minutes 08 Seconds West 41.2 feet
thence South 34 Degrees 31 Minutes 19 Seconds West 9.2 feet
thence South 34 Degrees 47 Minutes 36 Seconds West 14.8 feet
thence South 36 Degrees 34 Minutes 02 Seconds West 4.9 feet
thence South 36 Degrees 13 Minutes 35 Seconds West 11 feet
thence South 36 Degrees 04 Minutes 55 Seconds West 15.5 feet
thence South 35 Degrees 06 Minutes 52 Seconds West 18.1 feet
thence South 35 Degrees 39 Minutes 29 Seconds West 20.7 feet
thence South 34 Degrees 49 Minutes 54 Seconds West 21.7 feet
thence South 35 Degrees 14 Minutes 07 Seconds West 22.6 feet
thence South 36 Degrees 43 Minutes 40 Seconds West 23.4 feet
thence South 34 Degrees 02 Minutes 37 Seconds West 23.8 feet
thence South 35 Degrees 57 Minutes 05 Seconds West 24.4 feet
thence South 34 Degrees 59 Minutes 03 Seconds West 26.1 feet
thence South 36 Degrees 50 Minutes 39 Seconds West 27.2 feet
thence South 34 Degrees 54 Minutes 54 Seconds West 27.3 feet
thence South 35 Degrees 49 Minutes 58 Seconds West 25.6 feet
thence South 34 Degrees 06 Minutes 21 Seconds West 29 feet
thence South 35 Degrees 10 Minutes 02 Seconds West 32.2 feet
thence South 33 Degrees 46 Minutes 29 Seconds West 13.5 feet
thence South 33 Degrees 50 Minutes 00 Seconds West 23.4 feet

thence South 34 Degrees 04 Minutes 40 Seconds West 37.8 feet
thence South 33 Degrees 56 Minutes 47 Seconds West 37.3 feet
thence South 33 Degrees 07 Minutes 48 Seconds West 40.5 feet
thence South 33 Degrees 15 Minutes 50 Seconds West 42.1 feet
thence South 34 Degrees 18 Minutes 11 Seconds West 39.9 feet
thence South 35 Degrees 01 Minutes 27 Seconds West 41.4 feet
thence South 34 Degrees 18 Minutes 11 Seconds West 39.9 feet
thence South 34 Degrees 27 Minutes 12 Seconds West 39.1 feet
thence South 32 Degrees 45 Minutes 34 Seconds West 41.5 feet
thence South 32 Degrees 01 Minutes 02 Seconds West 38.1 feet
thence South 32 Degrees 12 Minutes 34 Seconds West 35.4 feet
thence South 34 Degrees 44 Minutes 22 Seconds West 30.9 feet
thence South 33 Degrees 12 Minutes 56 Seconds West 30.3 feet
thence South 34 Degrees 00 Minutes 19 Seconds West 33.8 feet
thence South 33 Degrees 41 Minutes 38 Seconds West 34 feet
thence South 32 Degrees 43 Minutes 17 Seconds West 31.3 feet
thence South 33 Degrees 03 Minutes 06 Seconds West 31 feet
thence South 34 Degrees 04 Minutes 40 Seconds West 30.2 feet
thence South 32 Degrees 58 Minutes 21 Seconds West 25.1 feet
thence South 33 Degrees 51 Minutes 26 Seconds West 11.1 feet
thence South 31 Degrees 05 Minutes 49 Seconds West 29.6 feet
thence South 31 Degrees 18 Minutes 18 Seconds West 30.1 feet
thence South 32 Degrees 44 Minutes 44 Seconds West 32.5 feet
thence South 31 Degrees 00 Minutes 06 Seconds West 28.4 feet
thence South 32 Degrees 31 Minutes 34 Seconds West 24.2 feet
thence South 31 Degrees 42 Minutes 11 Seconds West 21.7 feet
thence South 30 Degrees 39 Minutes 41 Seconds West 21 feet
thence South 32 Degrees 05 Minutes 51 Seconds West 20.2 feet
thence South 37 Degrees 26 Minutes 40 Seconds West 25.7 feet
thence South 36 Degrees 03 Minutes 38 Seconds West 37.1 feet
thence South 35 Degrees 41 Minutes 21 Seconds West 38.5 feet
thence South 33 Degrees 23 Minutes 15 Seconds West 46.1 feet
thence South 33 Degrees 29 Minutes 30 Seconds West 50.1 feet
thence South 35 Degrees 14 Minutes 07 Seconds West 50.8 feet
thence South 35 Degrees 29 Minutes 33 Seconds West 59.5 feet
thence South 36 Degrees 15 Minutes 46 Seconds West 61.7 feet
thence South 36 Degrees 19 Minutes 32 Seconds West 62.1 feet
thence South 36 Degrees 49 Minutes 17 Seconds West 59.3 feet
thence South 36 Degrees 34 Minutes 03 Seconds West 55.8 feet
thence South 37 Degrees 02 Minutes 14 Seconds West 40 feet
thence South 38 Degrees 21 Minutes 27 Seconds West 8.4 feet
thence South 39 Degrees 33 Minutes 08 Seconds West 49.2 feet
thence South 36 Degrees 55 Minutes 57 Seconds West 20.6 feet
thence South 38 Degrees 21 Minutes 27 Seconds West 42 feet
thence South 38 Degrees 14 Minutes 01 Seconds West 47.4 feet
thence South 39 Degrees 21 Minutes 30 Seconds West 49.9 feet
thence South 39 Degrees 11 Minutes 10 Seconds West 53.1 feet
thence South 40 Degrees 00 Minutes 42 Seconds West 56.8 feet
thence South 40 Degrees 33 Minutes 36 Seconds West 54.7 feet

thence South 39 Degrees 58 Minutes 39 Seconds West 50.8 feet
thence South 39 Degrees 42 Minutes 14 Seconds West 48 feet
thence South 39 Degrees 27 Minutes 02 Seconds West 45.7 feet
thence South 41 Degrees 17 Minutes 42 Seconds West 43 feet
thence South 41 Degrees 07 Minutes 17 Seconds West 44.6 feet
thence South 40 Degrees 12 Minutes 47 Seconds West 47.5 feet
thence South 40 Degrees 03 Minutes 44 Seconds West 51.7 feet
thence South 40 Degrees 22 Minutes 21 Seconds West 55.4 feet
thence South 40 Degrees 17 Minutes 56 Seconds West 57.5 feet
thence South 39 Degrees 53 Minutes 39 Seconds West 55.4 feet
thence South 40 Degrees 49 Minutes 09 Seconds West 54.9 feet
thence South 40 Degrees 34 Minutes 46 Seconds West 58.2 feet
thence South 39 Degrees 27 Minutes 37 Seconds West 55.9 feet
thence South 39 Degrees 57 Minutes 10 Seconds West 58.9 feet
thence South 39 Degrees 32 Minutes 32 Seconds West 62 feet
thence South 40 Degrees 17 Minutes 56 Seconds West 60.5 feet
thence South 39 Degrees 20 Minutes 31 Seconds West 59.7 feet
thence South 38 Degrees 42 Minutes 01 Seconds West 60 feet
thence South 40 Degrees 31 Minutes 29 Seconds West 54.2 feet
thence South 39 Degrees 15 Minutes 27 Seconds West 48.9 feet
thence South 38 Degrees 59 Minutes 14 Seconds West 46.6 feet
thence South 39 Degrees 27 Minutes 12 Seconds West 48.2 feet
thence South 40 Degrees 00 Minutes 10 Seconds West 48.2 feet
thence South 38 Degrees 54 Minutes 44 Seconds West 52.9 feet
thence South 39 Degrees 49 Minutes 40 Seconds West 51.9 feet
thence South 39 Degrees 22 Minutes 19 Seconds West 55 feet
thence South 40 Degrees 07 Minutes 26 Seconds West 58.2 feet
thence South 41 Degrees 13 Minutes 46 Seconds West 61.4 feet
thence South 43 Degrees 06 Minutes 46 Seconds West 58.7 feet
thence South 48 Degrees 55 Minutes 01 Seconds West 56.8 feet
thence South 64 Degrees 30 Minutes 54 Seconds West 54.8 feet
thence South 86 Degrees 07 Minutes 17 Seconds West 57.9 feet
thence North 80 Degrees 22 Minutes 04 Seconds West 59 feet
thence North 79 Degrees 49 Minutes 58 Seconds West 61.4 feet
thence North 83 Degrees 03 Minutes 54 Seconds West 62.5 feet
thence North 86 Degrees 00 Minutes 17 Seconds West 56.9 feet
thence North 84 Degrees 11 Minutes 11 Seconds West 55.4 feet
thence North 79 Degrees 34 Minutes 48 Seconds West 56.4 feet
thence North 69 Degrees 10 Minutes 13 Seconds West 57.3 feet
thence North 58 Degrees 35 Minutes 34 Seconds West 60.6 feet
thence North 53 Degrees 11 Minutes 06 Seconds West 60.9 feet
thence North 52 Degrees 32 Minutes 20 Seconds West 58.9 feet
thence North 52 Degrees 30 Minutes 04 Seconds West 44.4 feet
thence North 56 Degrees 59 Minutes 29 Seconds West 13.7 feet
thence North 53 Degrees 40 Minutes 04 Seconds West 15.9 feet
thence North 51 Degrees 38 Minutes 32 Seconds West 25.2 feet
thence North 50 Degrees 13 Minutes 45 Seconds West 27 feet
thence North 52 Degrees 08 Minutes 41 Seconds West 29.2 feet
thence North 51 Degrees 38 Minutes 32 Seconds West 27.3 feet

thence North 53 Degrees 25 Minutes 55 Seconds West 26.3 feet
thence North 53 Degrees 52 Minutes 16 Seconds West 17.1 feet
thence North 52 Degrees 49 Minutes 33 Seconds West 24.8 feet
thence North 52 Degrees 30 Minutes 04 Seconds West 44.4 feet
thence North 52 Degrees 06 Minutes 12 Seconds West 50.9 feet
thence North 51 Degrees 12 Minutes 29 Seconds West 54.1 feet
thence North 50 Degrees 37 Minutes 19 Seconds West 57.6 feet
thence North 50 Degrees 55 Minutes 10 Seconds West 56.9 feet
thence North 48 Degrees 46 Minutes 47 Seconds West 42.1 feet
thence North 47 Degrees 02 Minutes 16 Seconds West 23 feet
thence North 42 Degrees 48 Minutes 45 Seconds West 42.7 feet
thence North 38 Degrees 01 Minutes 18 Seconds West 53.1 feet
thence North 31 Degrees 05 Minutes 53 Seconds West 57.7 feet
thence North 23 Degrees 25 Minutes 11 Seconds West 61 feet
thence North 19 Degrees 16 Minutes 51 Seconds West 65.6 feet
thence North 18 Degrees 33 Minutes 24 Seconds West 66 feet
thence North 18 Degrees 27 Minutes 33 Seconds West 64.2 feet
thence North 18 Degrees 16 Minutes 43 Seconds West 64.9 feet
thence North 18 Degrees 27 Minutes 49 Seconds West 65.3 feet
thence North 18 Degrees 33 Minutes 24 Seconds West 66 feet
thence North 18 Degrees 07 Minutes 49 Seconds West 68.6 feet
thence North 17 Degrees 40 Minutes 22 Seconds West 67 feet
thence North 17 Degrees 10 Minutes 08 Seconds West 64.5 feet
thence North 15 Degrees 57 Minutes 21 Seconds West 62 feet
thence North 13 Degrees 11 Minutes 45 Seconds West 55.9 feet more or less to **the ending**

point at: 39 degrees 00 minutes 05.03 seconds North Latitude and -112 degrees 37 minutes 44.12 seconds West Longitude, which can be converted to mapping accuracy State Plane Utah Central Zone NAD 83 feet coordinates of X = 1,319,583.1 feet and Y = 6,807,028.8 feet.

Appendix C to Attachment 4

Popular Name: 12-A Well Road

County: Millard

County Road Number: MC3445

State Geographic Information Database (SGID) Road Identification Number: RD141769.

Road-Segment Number: 004

Road-Segment Length: 0.18 miles more or less.

Believed owner of the land underlying this road-segment is: Bureau of Land Management.

The following description is based upon the geographic coordinate system using the NAD83 Datum. The source is GPS mapping grade data as indicated in the metadata and/or the transportation data model of the State of Utah Geographic Information Database (SGID).

The road-segment itself is the monument that is identified by its physical presence on the land. The location of said physical presence is closely approximated by mapping grade Global Positioning System (GPS) data. Said data are checked against the corresponding gray-scale 1-meter Digital Orthophoto Quadrangles published by the United States Geological Survey (USGS) to verify a reasonable degree of accuracy. In circumstances where accurate satellite signal acquisition is not possible, such as deep, narrow canyons or under a canopy of dense foliage, or where very sharp curves in the road make accuracy questionable, such portions of the road were digitized from the corresponding gray-scale 1-meter Digital Orthophoto Quadrangles published by the United States Geological Survey (USGS).

This road-segment may traverse:

Township 21 South Range 7 West, Section(s) 10, Salt Lake Base & Meridian

The following description closely approximates the location of the centerline of the physical monument (12-A Well Road)-- Segment 004 based on mapping grade Global Positioning System (GPS) data as defined above:

Beginning at a point on the road center line located at 39 degrees 00 minutes 05.03 seconds North Latitude and -112 degrees 37 minutes 44.12 seconds West Longitude, which can be converted to mapping accuracy State Plane Utah Central Zone NAD 83 feet coordinates of X = 1,319,583.1 feet and Y = 6,807,028.8 feet; thence the following courses along the said road center line:

thence North 19 Degrees 40 Minutes 18 Seconds West 44.5 feet
thence North 58 Degrees 53 Minutes 35 Seconds West 43.4 feet
thence North 56 Degrees 09 Minutes 58 Seconds West 46.8 feet
thence North 44 Degrees 41 Minutes 33 Seconds West 43.6 feet
thence North 26 Degrees 37 Minutes 12 Seconds West 34 feet
thence North 16 Degrees 14 Minutes 51 Seconds West 19.1 feet
thence North 03 Degrees 59 Minutes 36 Seconds West 10.2 feet
thence North 03 Degrees 52 Minutes 42 Seconds West 10.5 feet
thence North 08 Degrees 16 Minutes 53 Seconds East 35.2 feet
thence North 26 Degrees 02 Minutes 39 Seconds East 38.4 feet
thence North 44 Degrees 41 Minutes 52 Seconds East 39.4 feet
thence North 51 Degrees 57 Minutes 53 Seconds East 34.9 feet

thence North 61 Degrees 59 Minutes 54 Seconds East 29.6 feet
thence North 83 Degrees 26 Minutes 37 Seconds East 24.1 feet
thence South 72 Degrees 08 Minutes 58 Seconds East 21.1 feet
thence South 59 Degrees 36 Minutes 08 Seconds East 24.4 feet
thence South 56 Degrees 48 Minutes 57 Seconds East 25.6 feet
thence South 50 Degrees 44 Minutes 33 Seconds East 19.6 feet
thence South 54 Degrees 02 Minutes 53 Seconds East 6.1 feet
thence South 53 Degrees 37 Minutes 40 Seconds East 19.2 feet
thence South 55 Degrees 49 Minutes 47 Seconds East 26.7 feet
thence South 49 Degrees 10 Minutes 03 Seconds East 34.4 feet
thence South 32 Degrees 48 Minutes 50 Seconds East 35.4 feet
thence South 01 Degrees 50 Minutes 11 Seconds East 36.8 feet
thence South 19 Degrees 25 Minutes 49 Seconds West 32.1 feet
thence South 36 Degrees 04 Minutes 55 Seconds West 31 feet
thence South 45 Degrees 04 Minutes 38 Seconds West 35 feet
thence South 45 Degrees 52 Minutes 01 Seconds West 34.1 feet
thence South 39 Degrees 58 Minutes 11 Seconds West 31 feet
thence South 56 Degrees 15 Minutes 28 Seconds West 62.5 feet more or less to **the ending**

point at: 39 degrees 00 minutes 05.03 seconds North Latitude and -112 degrees 37 minutes 44.12 seconds West Longitude, which can be converted to mapping accuracy State Plane Utah Central Zone NAD 83 feet coordinates of X = 1,319,583.1 feet and Y = 6,807,028.8 feet.