

**Acknowledgment and  
Notice of Acknowledgment  
of Acceptance of R.S. 2477  
Right-of-Way Grant**



**THE STATE OF UTAH**

**TO ALL WHOM THESE PRESENTS SHALL COME, Greeting:**

**Know ye,** This is an Acknowledgment and Notice of Acknowledgment made under Utah Code Sections 72-5-309 through 310 inclusive, that the grant of the United States of America of “the right of way for the construction of highways over public lands, not reserved for public uses” under United States Revised Statutes 2477 (43 U.S.C. Section 932 (repealed October 21, 1976, with proviso recognizing the validity of rights-of-way already established)) was accepted for and on behalf of the State of Utah and its political subdivision Millard County as it pertains to the highway located in Millard County known as Pilgrim Road; County Road Number: MC6044; State Geographic Information Database (SGID) Road Identification Number: RD143734. Total road length is 2.21 miles more or less.

The reason for this Acknowledgment and Notice of Acknowledgment includes, but is not limited to, the fact that the road was constructed, mechanically, or by continuous use as a public highway for a period of at least ten years, over public lands not reserved for public uses, prior to the earlier of (a) the October 21, 1976 repeal of R.S. 2477 or (b) the date the servient estate was reserved for public uses.

This Acknowledgment and Notice of Acknowledgment applies only to the segments of the road that traverse land owned by the Bureau of Land Management, United States Department of the Interior, and does not apply to segments of the road that traverse land owned by any other person or entity. The State of Utah and its political subdivisions reserve the right to make further acknowledgments and notices of acknowledgment with regard to road segments that traverse land owned by other entities, including the United States of America, through one or more of its agencies.

A printed copy of a map showing the location of the road in said county is appended hereto as “Attachment 1,” a printed copy of representative photos of the road is appended hereto as “Attachment 2,” a printed copy of a description of the beginning and ending points of the entire road together with a list of Townships, Ranges and Sections that may be traversed by the road in said county is appended hereto as “Attachment 3,” and a printed copy of the Road Centerline Description Cover Page(s) is appended hereto as “Attachment 4.” The Appendices listed in “Attachment 4” that contain the actual road centerline descriptions are incorporated herein by reference. Affidavits provided by individuals familiar with the road are appended hereto as “Attachment 5.”

A printed copy of this Acknowledgment and Notice of Acknowledgment, together with its Attachments and Appendices, may be viewed and/or obtained at the office of the Utah State Archives.

An electronic copy of this Acknowledgment and Notice of Acknowledgment, together with its Attachments and Appendices, may be viewed and/or downloaded as read-only PDF (Portable Document Format) files via the

Internet at <http://recorded2477roads.utah.gov>.

The owner of the servient estate in the land underlying the road-segments subject to this Acknowledgment and Notice is believed to be the United States of America through one or more of its agencies. Any of such agencies or any other person with a servient ownership claim or a competing dominant estate right-of-way ownership claim, may file a petition in the State District Court for Salt Lake County for a decision regarding the correctness of this Acknowledgment. A claimant shall file a petition within sixty (60) days after receipt of this Notice.

**In Witness Whereof**, I, John Harja, the official designee of the Governor of the State of Utah, in conformity to the laws of the State (Utah Code Sections 72-5-308 through 310 inclusive), have caused this Acknowledgment and Notice of Acknowledgment to be made.

Signed by my hand in Salt Lake City, Utah, the 23<sup>rd</sup> day of April, 2008.

By the Governor's Designee

  
\_\_\_\_\_  
John Harja

**CERTIFICATION**

State of Utah                    )  
  : ss  
County of Salt Lake         )

I hereby certify that the signer of the foregoing document, John Harja, is personally known by me, has made a voluntary signature and taken an oath stating that he is the official designee of the Governor of the State of Utah and is authorized to sign this document on the Governor's behalf pursuant to Utah Code Section 72-5-309. He further vouched that, based upon information and belief, the facts alleged therein are true.

Dated this 23<sup>rd</sup> day of April, 2008.



  
\_\_\_\_\_  
Notary Public

**00165872**  
B: 486 P: 885 Fee \$0.00  
Connie Hansen, Millard Recorder  
05/14/2008 11:54:01 AM By UT STATE GOVERNOR Page 2 of 13



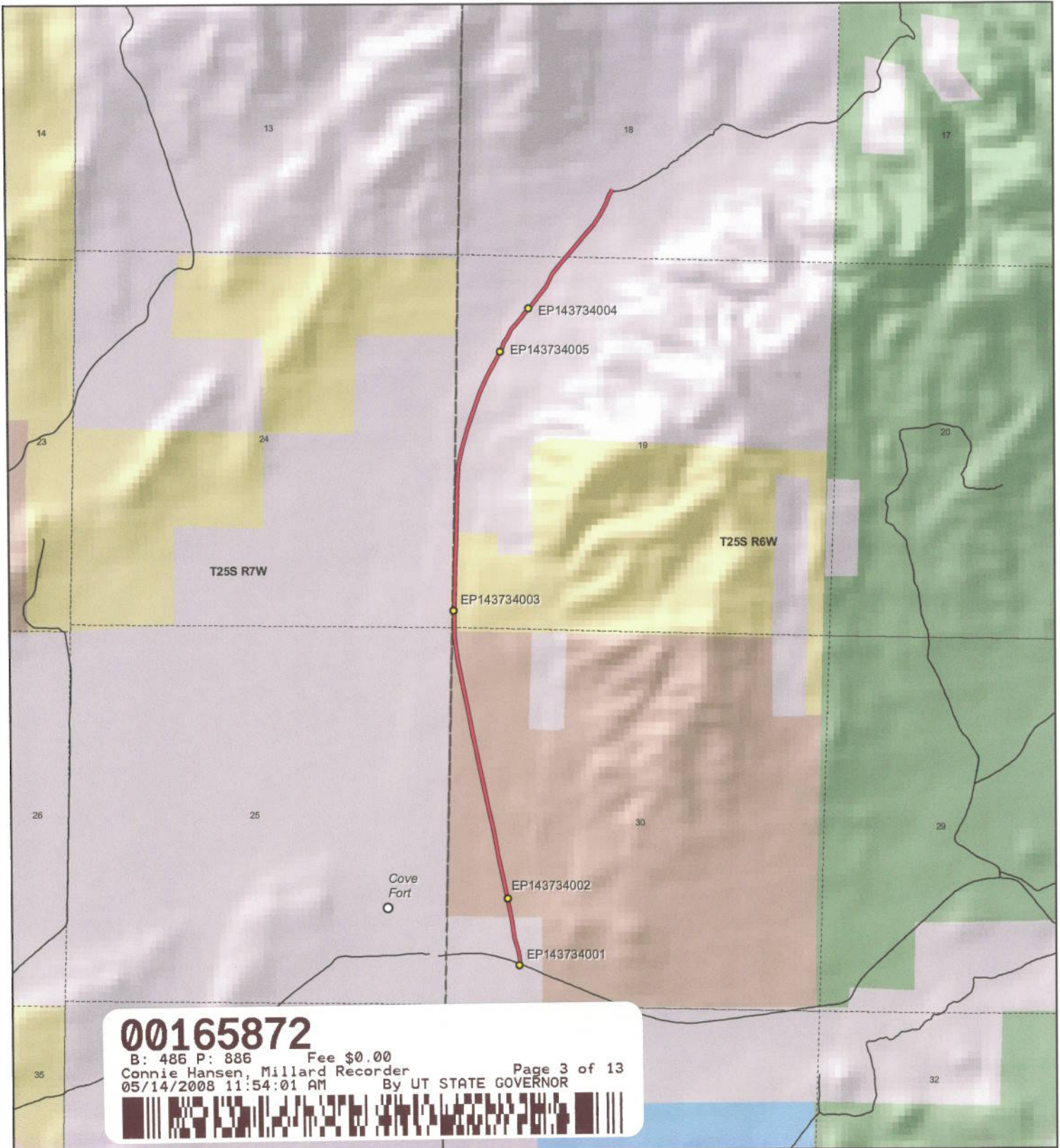

**00165872**  
 B: 486 P: 886 Fee \$0.00  
 Connie Hansen, Millard Recorder  
 05/14/2008 11:54:01 AM By UT STATE GOVERNOR  
 Page 3 of 13

1:22,084  
 1 inch equals 0.3 miles

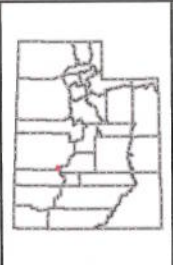

**Pilgrim Road - Millard County**  
**SGID RD\_ID RD143734**

<b>Land Ownership Categories</b>		<b>Transportation Network</b>	
BLM	Wilderness	Pilgrim Road	Title V: Issued Or Under Consideration By BLM Or County
Private	UDWR Wildlife Reserve	Other Roads	Photo Event Point
SITLA, State Trust Land	DOD, Military	Section = 1 Mile	
USFS, National Forest	State Sovereign Land		
State Parks and Recreation	National Recreation Area		
Tribal, Indian Reservation	USFWS, Natl. Wildlife Refuge		
NPS, National Park			

Map prepared by the State of Utah  
 Automated Geographic Reference Center  
 Room 5130 State Office Building  
 Salt Lake City, Utah 84114  
 Mar 03, 2008

Attachment 2



EP143734002



EP143734004



EP143734001



EP143734003



EP143734005

**00165872**  
 B: 486 P: 887 Fee \$0.00  
 Connie Hansen, Millard Recorder  
 05/14/2008 11:54:01 AM By UT STATE GOVERNOR

Page 4 of 13



EP000000000

**Pilgrim Road - Millard County  
SGID RD\_ID RD143734**

Map prepared by the State of Utah  
Automated Geographic Reference Center  
Room 5130 State Office Building  
Salt Lake City, Utah 84114  
March 3, 2008



### Attachment 3

#### Beginning & Ending Points and Township, Range, and Section References For:

**Popular Name: Pilgrim Road**

**County: Millard**

**County Road Number: MC6044**

**State Geographic Information Database (SGID) Road Identification Number: RD143734.**

**Total Road Length: 2.21 miles more or less.**

**Beginning at a point** on the road centerline located at 38 degrees 36 minutes 04.49 seconds North Latitude and -112 degrees 34 minutes 39.06 seconds West Longitude, which can be converted to mapping accuracy State Plane Utah Central Zone NAD 83 feet coordinates of X = 1,332,436.0 feet and Y = 6,661,111.5 feet based on the US Survey Foot conversion.

**Ending at a point** on the road centerline located at 38 degrees 37 minutes 52.69 seconds North Latitude and -112 degrees 34 minutes 24.18 seconds West Longitude, which can be converted to mapping accuracy State Plane Utah Central Zone NAD 83 feet coordinates of X = 1,333,748.3 feet and Y = 6,672,044.1 feet based on the US Survey Foot conversion.

This road may traverse:

Township 25 South Range 6 West, Section(s) 18,19,30, Salt Lake Base & Meridian  
See Attachment 1 above for a cartographic depiction of the course of this road.

**00165872**

B: 486 P: 888 Fee \$0.00  
Connie Hansen, Millard Recorder Page 5 of 13  
05/14/2008 11:54:01 AM By UT STATE GOVERNOR



**Attachment 4  
Road Centerline Description Cover Page(s)**

**Popular Name: Pilgrim Road**

**County: Millard**

**County Road Number: MC6044**

**State Geographic Information Database (SGID) Road Identification Number: RD143734.**

**Total Road Length: 2.21 miles more or less.**

**Centerline Descriptions Of Road-Segments That Cross Over Federally Owned Land, Derived From Global Positioning System Data And Cross-checked against USGS Digital Orthophoto Quadrangles Compiled By The Utah Automated Geographic Reference Center And Entered Into The State Geographic Information Database (SGID).**

<b>Road-Segments Listed by SGID Road Identification Number (RD ID)</b>	<b>Road-Segment Numbers</b>	<b>Believed Ownership Of Servient Estate</b>	<b>Approximate Segment Length</b>	<b>See Attached Appendix</b>
<b>RD143734</b>	<b>001</b>	<b>PVT</b>	<b>0.13 Miles</b>	<b>(not shown)</b>
<b>RD143734</b>	<b>002</b>	<b>Tribal</b>	<b>0.78 Miles</b>	<b>(not shown)</b>
<b>RD143734</b>	<b>003</b>	<b>BLM</b>	<b>0.26 Miles</b>	<b>A</b>
<b>RD143734</b>	<b>004</b>	<b>PVT</b>	<b>1.04 Miles</b>	<b>(not shown)</b>
		<b>Total Road Length</b>	<b>2.21</b>	<b>_____</b>

\* Indicates that a Title V permit will be requested, is in process, or has been issued.

† Indicates that road-segments crossing Forest Service land are under consideration by the state and county as of the date of this Acknowledgment and Notice of Acknowledgment.



**Attachment 5**

**00165872**

B: 486 P: 890 Fee \$0.00 Page 7 of 13  
Connie Hansen, Millard Recorder By UT STATE GOVERNOR  
05/14/2008 11:54:01 AM



**AFFIDAVIT OF JOHN LARSEN  
PILGRIM ROAD  
MILLARD COUNTY, UTAH  
ROAD NUMBER MC6044**

State of Utah                    )  
  : ss  
County of Millard                )

JOHN LARSEN, being first duly sworn, deposes and states as follows:

1. I am an adult competent to testify about the matters set forth below based upon my personal knowledge. I currently reside in Millard County, Utah. I have lived in Millard County for forty-six years. I have been an employee of the Millard County Road Department since June 1980 to present and have participated in maintenance of the road during that time.

2. I have traveled and am familiar with a road in Millard County known as the Pilgrim Road. I am also familiar with the land the road traverses. When I first used and observed the road in the early 1960s, it followed the same route as in 2006 when I last observed it. Attached is a Millard County map showing Pilgrim Road. To the best of my knowledge and based upon my use of and familiarity with this road and the land it traverses, the location and route of the road are correctly illustrated on the attached map.

3. I am informed that the County also identifies this road according to the road number listed above.

4. I have observed that the road has been open to the public for all to use, to come and go as they pleased, since at least as early as the early 1960s and continuing through 1976 to the present. Throughout this time period I have observed travel on the road by various means, including cars, trucks, recreational vehicles, and pickup trucks. Throughout this time period, the road has been used daily for more than ten continuous years prior to 1976, and is presently used daily.

5. Throughout the time period from the early 1960s to the present, I have used the

**00165872**

B: 486 P: 891 Fee \$0.00  
Connie Hansen, Millard Recorder Page 8 of 13  
05/14/2008 11:54:01 AM By UT STATE GOVERNOR





road myself for the following uses: hunting, camping, gathering fire wood, and recreation.

6. Throughout the time period described in the previous paragraph, I observed other vehicles from the general public using the road at various times for the uses described in the previous paragraph, plus the following uses: Mining, prospecting for minerals, livestock operations, farming, trapping, tourism, government access, picnicking, hiking and sightseeing.

7. It is also the reputation in the community that this road has been open to the public for all to use, to come and go as they pleased, since at least as early as 1900 and continuing through 1976 to the present, for the uses described in the previous paragraphs.

8. Prior to 1976, I observed the graded surface of the road and have personally graded the road since 1980.

DATED this 4 day of December, 2006.

John Larsen  
JOHN LARSEN

SUBSCRIBED AND SWORN to before me this 4th day of December, 2006.

Gloria Schrader  
NOTARY PUBLIC

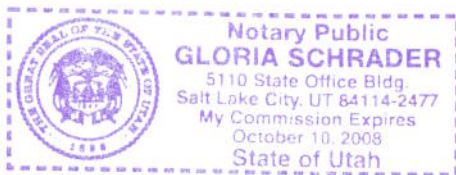

00165872

B: 486 P: 892 Fee \$0.00  
Connie Hansen, Millard Recorder Page 9 of 13  
05/14/2008 11:54:01 AM By UT STATE GOVERNOR



ROAD = MC6044  
PILGRIM ROAD



135

Cove  
Fort



00165872

B: 486 P: 893 Fee \$0.00  
Connie Hansen, Millard Recorder  
05/14/2008 11:54:01 AM By UT STATE GOVERNOR Page 10 of 13



132

# M I L L A R D C O U N T Y

— B Class Road of Interest

- Interstate
- Highway Major
- Highway Minor
- B Class Road
- Unimproved Road
- County Border
- River
- Cities / Towns
- Lakes
- Lakes - Intermittent
- Township & Range Line
- Forest Service Lands
- BLM Lands
- State Trust Lands
- Private Lands

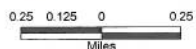

**AFFIDAVIT OF DEAN LARSEN  
PILGRIM ROAD  
MILLARD COUNTY, UTAH  
ROAD NUMBER MC6044**

State of Utah                                 )  
  : ss.  
County of Millard                         )

DEAN LARSEN, being first duly sworn, deposes and states as follows:

1. I am an adult competent to testify about the matters set forth below based upon my personal knowledge. I currently reside in Holden, Millard County, Utah. I have lived in Millard County for forty-six years.

2. I have traveled and am familiar with a road in Millard County known as the Pilgrim Road. I am also familiar with the land the road traverses. When I first used and observed the road in the early 1960s, it followed the same route as in 2006 when I last observed it. Attached is a Millard County map showing Pilgrim Road. To the best of my knowledge and based upon my use of and familiarity with this road and the land it traverses, the location and route of the road are correctly illustrated on the attached map.

3. I am informed that the County also identifies this road according to the road number listed above.

4. I have observed that the road has been open to the public for all to use, to come and go as they pleased, since at least as early as the early 1960s and continuing through 1976 to the present. Throughout this time period I have observed travel on the road by various means, including cars, trucks, recreational vehicles, and pickup trucks. Throughout this time period, the road has been used daily for more than ten continuous years prior to 1976, and is presently used daily.

5. Throughout the time period from the early 1960s to the present, I have used the road myself for the following uses: hunting, camping, gathering fire wood, and recreation.

**00165872**

B: 486 P: 894 Fee \$0.00 Page 11 of 13  
Connie Hansen, Millard Recorder By UT STATE GOVERNOR  
05/14/2008 11:54:01 AM



6. Throughout the time period described in the previous paragraph, I observed other vehicles from the general public using the road at various times for the uses described in the previous paragraph, plus the following uses: Mining, prospecting for minerals, livestock operations, farming, trapping, tourism, government access, picnicking, hiking and sightseeing.

7. It is also the reputation in the community that this road has been open to the public for all to use, to come and go as they pleased, since at least as early as 1900 and continuing through 1976 to the present, for the uses described in the previous paragraphs.

8. I observed the following evidence of maintenance/construction activities on the road prior to 1976: I have personally observed the graded surface of the road.

DATED this 4 day of December, 2006.

  
DEAN LARSEN

SUBSCRIBED AND SWORN to before me this 4th day of December, 2006.

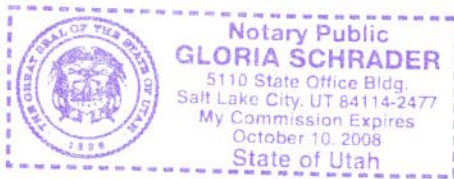

  
NOTARY PUBLIC

**00165872**

B: 486 P: 895 Fee \$0.00 Page 12 of 13  
Connie Hansen, Millard Recorder  
05/14/2008 11:54:01 AM By UT STATE GOVERNOR



ROAD = MC6044  
PILGRIM ROAD



135

# Cove Fort



132

## 00165872

B: 486 P: 896 Fee \$0.00  
Connie Hansen, Millard Recorder  
05/14/2008 11:54:01 AM By UT STATE GOVERNOR Page 13 of 13



# M I L L A R D C O U N T Y

— B Class Road of Interest

- Interstate
- County Border
- Township & Range Line
- Highway Major
- River
- Forest Service Lands
- Highway Minor
- Cities / Towns
- BLM Lands
- B Class Road
- Lakes
- State Trust Lands
- Unimproved Road
- Lakes - Intermittent
- Private Lands



## Appendix A to Attachment 4

**Popular Name: Pilgrim Road**

**County: Millard**

**County Road Number: MC6044**

**State Geographic Information Database (SGID) Road Identification Number: RD143734.**

**Road-Segment Number: 003**

**Road-Segment Length: 0.26 miles more or less.**

**Believed owner of the land underlying this road-segment is: Bureau of Land Management.**

*The following description is based upon the geographic coordinate system using the NAD83 Datum. The source is GPS mapping grade data as indicated in the metadata and/or the transportation data model of the State of Utah Geographic Information Database (SGID).*

The road-segment itself is the monument that is identified by its physical presence on the land. The location of said physical presence is closely approximated by mapping grade Global Positioning System (GPS) data. Said data are checked against the corresponding gray-scale 1-meter Digital Orthophoto Quadrangles published by the United States Geological Survey (USGS) to verify a reasonable degree of accuracy. In circumstances where accurate satellite signal acquisition is not possible, such as deep, narrow canyons or under a canopy of dense foliage, or where very sharp curves in the road make accuracy questionable, such portions of the road were digitized from the corresponding gray-scale 1-meter Digital Orthophoto Quadrangles published by the United States Geological Survey (USGS).

This road-segment may traverse:

Township 25 South Range 6 West, Section(s) 19, Salt Lake Base & Meridian

The following description closely approximates the location of the centerline of the physical monument (Pilgrim Road)-- Segment 003 based on mapping grade Global Positioning System (GPS) data as defined above:

**Beginning at a point** on the road center line located at 38 degrees 36 minutes 50.79 seconds North Latitude and -112 degrees 34 minutes 51.51 seconds West Longitude, which can be converted to mapping accuracy State Plane Utah Central Zone NAD 83 feet coordinates of X = 1,331,504.1 feet and Y = 6,665,807.6 feet; thence the following courses along the said road center line:

thence North 00 Degrees 17 Minutes 39 Seconds West 49.6 feet

thence North 00 Degrees 22 Minutes 48 Seconds West 218.9 feet

thence North 01 Degrees 06 Minutes 05 Seconds East 336.8 feet

thence North 00 Degrees 44 Minutes 34 Seconds East 326.3 feet

thence North 01 Degrees 42 Minutes 58 Seconds East 308.7 feet

thence North 01 Degrees 52 Minutes 32 Seconds East 156 feet more or less to **the ending**

**point at:** 38 degrees 37 minutes 04.59 seconds North Latitude and -112 degrees 34 minutes 51.42 seconds West Longitude, which can be converted to mapping accuracy State Plane Utah Central Zone NAD 83 feet coordinates of X = 1,331,527.5 feet and Y = 6,667,203.5 feet.