

**Acknowledgment and  
Notice of Acknowledgment  
of Acceptance of R.S. 2477  
Right-of-Way Grant**

**00165898**

B: 487 P: 313 Fee \$0.00  
Connie Hansen, Millard Recorder Page 1 of 13  
05/14/2008 01:31:03 PM By UT STATE GOVERNOR



**THE STATE OF UTAH**

**TO ALL WHOM THESE PRESENTS SHALL COME, Greeting:**

**Know ye,** This is an Acknowledgment and Notice of Acknowledgment made under Utah Code Sections 72-5-309 through 310 inclusive, that the grant of the United States of America of “the right of way for the construction of highways over public lands, not reserved for public uses” under United States Revised Statutes 2477 (43 U.S.C. Section 932 (repealed October 21, 1976, with proviso recognizing the validity of rights-of-way already established)) was accepted for and on behalf of the State of Utah and its political subdivision Millard County as it pertains to the highway located in Millard County known as Eskdale South Loop Road; County Road Number: MC927; State Geographic Information Database (SGID) Road Identification Number: RD144083. Total road length is 2.14 miles more or less.

The reason for this Acknowledgment and Notice of Acknowledgment includes, but is not limited to, the fact that the road was constructed, mechanically, or by continuous use as a public highway for a period of at least ten years, over public lands not reserved for public uses, prior to the earlier of (a) the October 21, 1976 repeal of R.S. 2477 or (b) the date the servient estate was reserved for public uses.

This Acknowledgment and Notice of Acknowledgment applies only to the segments of the road that traverse land owned by the Bureau of Land Management, United States Department of the Interior, and does not apply to segments of the road that traverse land owned by any other person or entity. The State of Utah and its political subdivisions reserve the right to make further acknowledgments and notices of acknowledgment with regard to road segments that traverse land owned by other entities, including the United States of America, through one or more of its agencies.

A printed copy of a map showing the location of the road in said county is appended hereto as “Attachment 1,” a printed copy of representative photos of the road is appended hereto as “Attachment 2,” a printed copy of a description of the beginning and ending points of the entire road together with a list of Townships, Ranges and Sections that may be traversed by the road in said county is appended hereto as “Attachment 3,” and a printed copy of the Road Centerline Description Cover Page(s) is appended hereto as “Attachment 4.” The Appendices listed in “Attachment 4” that contain the actual road centerline descriptions are incorporated herein by reference. Affidavits provided by individuals familiar with the road are appended hereto as “Attachment 5.”

A printed copy of this Acknowledgment and Notice of Acknowledgment, together with its Attachments and Appendices, may be viewed and/or obtained at the office of the Utah State Archives.

An electronic copy of this Acknowledgment and Notice of Acknowledgment, together with its Attachments and Appendices, may be viewed and/or downloaded as read-only PDF (Portable Document Format) files via the

Internet at <http://recorded2477roads.utah.gov>.

The owner of the servient estate in the land underlying the road-segments subject to this Acknowledgment and Notice is believed to be the United States of America through one or more of its agencies. Any of such agencies or any other person with a servient ownership claim or a competing dominant estate right-of-way ownership claim, may file a petition in the State District Court for Salt Lake County for a decision regarding the correctness of this Acknowledgment. A claimant shall file a petition within sixty (60) days after receipt of this Notice.

**In Witness Whereof**, I, John Harja, the official designee of the Governor of the State of Utah, in conformity to the laws of the State (Utah Code Sections 72-5-308 through 310 inclusive), have caused this Acknowledgment and Notice of Acknowledgment to be made.

Signed by my hand in Salt Lake City, Utah, the 23<sup>rd</sup> day of April, 2008.

By the Governor's Designee

  
\_\_\_\_\_  
John Harja

**CERTIFICATION**

State of Utah                    )  
  : ss  
County of Salt Lake         )

I hereby certify that the signer of the foregoing document, John Harja, is personally known by me, has made a voluntary signature and taken an oath stating that he is the official designee of the Governor of the State of Utah and is authorized to sign this document on the Governor's behalf pursuant to Utah Code Section 72-5-309. He further vouched that, based upon information and belief, the facts alleged therein are true.

Dated this 23<sup>rd</sup> day of April, 2008.

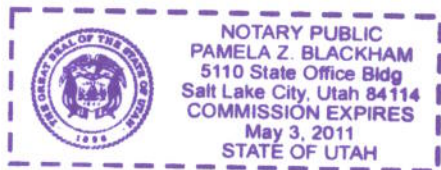

  
\_\_\_\_\_  
Notary Public

**00165898**

B: 487 P: 314                    Fee \$0.00  
Connie Hansen, Millard Recorder                    Page 2 of 13  
05/14/2008 01:31:03 PM                    By UT STATE GOVERNOR







**00165898**

B: 487 P: 315 Fee \$0.00 Page 3 of 13  
 Connie Hansen, Millard Recorder  
 05/14/2008 01:31:03 PM By UT STATE GOVERNOR



1:19,193  
 1 inch equals 0.3 miles

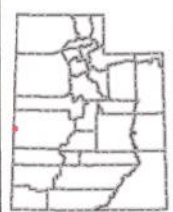

**Eskdale South Loop Road - Millard County**  
**SGID RD\_ID RD144083**

**Land Ownership Categories**

- BLM
- Private
- SITLA, State Trust Land
- USFS, National Forest
- State Parks and Recreation
- Tribal, Indian Reservation
- NPS, National Park
- Wilderness
- UDWR Wildlife Reserve
- DOD, Military
- State Sovereign Land
- National Recreation Area
- USFWS, Natl. Wildlife Refuge

**Transportation Network**

- Eskdale South Loop Road
- Title V: Issued Or Under Consideration By BLM Or County
- Other Roads
- Photo Event Point
- Section = 1 Mile

Map prepared by the State of Utah  
 Automated Geographic Reference Center  
 Room 5130 State Office Building  
 Salt Lake City, Utah 84114  
 Nov 26, 2006



Attachment 2



EP144083001



EP144083005



EP144083009



EP144083007

00165898

B: 487 P: 316 Fee \$0.00 Page 4 of 13  
Connie Hansen, Millard Recorder 05/14/2008 01:31:03 PM By UT STATE GOVERNOR



EP000000000

EP000000000

Eskdale South Loop Road - Millard County  
SGID RD\_ID RD144083

Map prepared by the State of Utah  
Automated Geographic Reference Center  
Room 5130 State Office Building  
Salt Lake City, Utah 84114  
November 24, 2006





### Attachment 3

#### Beginning & Ending Points and Township, Range, and Section References For:

**Popular Name: Eskdale South Loop Road**

**County: Millard**

**County Road Number: MC927**

**State Geographic Information Database (SGID) Road Identification Number: RD144083.**

**Total Road Length: 2.14 miles more or less.**

**Beginning at a point** on the road centerline located at 39 degrees 03 minutes 10.83 seconds North Latitude and -113 degrees 59 minutes 36.66 seconds West Longitude, which can be converted to mapping accuracy State Plane Utah Central Zone NAD 83 feet coordinates of X = 932,369.5 feet and Y = 6,833,672.4 feet based on the US Survey Foot conversion.

**Ending at a point** on the road centerline located at 39 degrees 04 minutes 38.52 seconds North Latitude and -113 degrees 59 minutes 23.01 seconds West Longitude, which can be converted to mapping accuracy State Plane Utah Central Zone NAD 83 feet coordinates of X = 933,692.9 feet and Y = 6,842,510.6 feet based on the US Survey Foot conversion.

This road may traverse:

Township 20 South Range 19 West, Section(s) 9,16,21, Salt Lake Base & Meridian  
See Attachment 1 above for a cartographic depiction of the course of this road.

**00165898**

B: 487 P: 317 Fee \$0.00  
Connie Hansen, Millard Recorder  
05/14/2008 01:31:03 PM

Page 5 of 13  
By UT STATE GOVERNOR



**Attachment 4  
Road Centerline Description Cover Page(s)**

**Popular Name:** Eskdale South Loop Road

**County:** Millard

**County Road Number:** MC927

**State Geographic Information Database (SGID) Road Identification Number:** RD144083.

**Total Road Length:** 2.14 miles more or less.

**Centerline Descriptions Of Road-Segments That Cross Over Federally Owned Land, Derived From Global Positioning System Data And Cross-checked against USGS Digital Orthophoto Quadrangles Compiled By The Utah Automated Geographic Reference Center And Entered Into The State Geographic Information Database (SGID).**

<b>Road-Segments Listed by SGID Road Identification Number (RD_ID)</b>	<b>Road-Segment Numbers</b>	<b>Believed Ownership Of Servient Estate</b>	<b>Approximate Segment Length</b>	<b>See Attached Appendix</b>
<b>RD144083</b>	<b>001</b>	<b>BLM</b>	<b>0.71 Miles</b>	<b>A</b>
<b>RD144083</b>	<b>002</b>	<b>PVT</b>	<b>0.01 Miles</b>	<b>(not shown)</b>
<b>RD144083</b>	<b>003</b>	<b>ST</b>	<b>1.15 Miles</b>	<b>(not shown)</b>
<b>RD144083</b>	<b>004</b>	<b>BLM</b>	<b>0.27 Miles</b>	<b>B</b>
		<b>Total Road Length</b>	<b>2.14</b>	<b>_____</b>

\* Indicates that a Title V permit will be requested, is in process, or has been issued.

† Indicates that road-segments crossing Forest Service land are under consideration by the state and county as of the date of this Acknowledgment and Notice of Acknowledgment.

**00165898**

B: 487 P: 318 Fee \$0.00

Connie Hansen, Millard Recorder

05/14/2008 01:31:03 PM

By UT STATE GOVERNOR

Page 6 of 13



**Attachment 5**

**00165898**

B: 487 P: 319 Fee \$0.00  
Connie Hansen, Millard Recorder Page 7 of 13  
05/14/2008 01:31:03 PM By UT STATE GOVERNOR



**AFFIDAVIT OF JAY ATKINSON**  
**ESKDALE SOUTH LOOP ROAD**  
**MILLARD COUNTY, UTAH**  
**ROAD NUMBER MC 927**

State of Utah                    )  
  : ss.  
County of Millard                )

JAY ATKINSON, being first duly sworn, deposes and states as follows:

1. I am an adult competent to testify about the matters set forth below based upon my personal knowledge. I currently reside in Millard County, Utah. I have lived in Millard County for sixty-eight years. I was an employee of the Millard County Road Department from February of 1970 to April of 2000, and participated in maintenance of the road during that time.

2. I have traveled and am familiar with a road in Millard County known as Eskdale South Loop Road. I am also familiar with the land the road traverses. When I first used and observed the road in the early 1950s, it followed the same route as in 2000 when I last observed it. Attached is a Millard County map showing Eskdale South Loop Road. To the best of my knowledge and based upon my use of and familiarity with this road and the land it traverses, the location and route of the road are correctly illustrated on the attached map.

3. I am informed that the County also identifies this road according to the road number listed above.

4. I have observed that the road has been open to the public for all to use, to come and go as they pleased, since at least as early as the early 1950s and continuing through 1976 to 2000. Throughout this time period I have observed travel on the road by various means, including cars, trucks, recreational vehicles, and pickup trucks. Throughout this time period, the road has been used daily for more than ten continuous years prior to 1976, and was so used through 2000.

**00165898**

B: 487 P: 320 Fee \$0.00  
Connie Hansen, Millard Recorder  
05/14/2008 01:31:03 PM By UT STATE GOVERNOR Page 8 of 13





5. Throughout the time period from the early 1950s to 2000, I have used the road myself for the following uses: hunting, rock hounding, county road work and recreation.

6. Throughout the time period described in the previous paragraph, I observed other vehicles from the general public using the road at various times for the uses described in the previous paragraph, plus the following uses: livestock operations, farming, traveling in and through the area, trapping, government access, picnicking, hiking and sightseeing.

7. It is also the reputation in the community that this road has been open to the public for all to use, to come and go as they pleased, since at least as early as the early 1940s and continuing through 1976 to the present, for the uses described in the previous paragraphs.

8. Prior to 1976, I participated in maintenance and construction activities on the road. Construction and maintenance have been performed since the early 1950s by Millard County Road Department.

DATED this 6 day of December, 2006.

Jay Atkinson  
JAY ATKINSON

SUBSCRIBED AND SWORN to before me this 6<sup>th</sup> day of December, 2006.

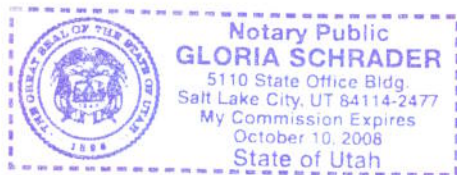

Gloria Schrader  
NOTARY PUBLIC

00165898

B: 487 P: 321 Fee \$0.00  
Connie Hansen, Millard Recorder  
05/14/2008 01:31:03 PM By UT STATE GOVERNOR Page 9 of 13



ROAD = MC927  
ESKDALE SOUTH LOOP ROAD

Eskdale

Valley

Garrison

50 6

00165898

B: 487 P: 322 Fee \$0.00  
Connie Hansen, Millard Recorder Page 10 of 13  
05/14/2008 01:31:03 PM By UT STATE GOVERNOR



# MILLARD COUNTY

B Class Road of Interest

- Interstate
- Highway Major
- Highway Minor
- B Class Road
- Unimproved Road
- County Border
- River
- Cities / Towns
- Lakes
- Lakes - Intermittent
- Township & Range Line
- Forest Service Lands
- BLM Lands
- State Trust Lands
- Private Lands

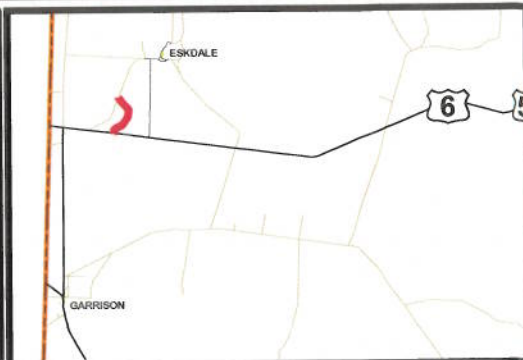



**AFFIDAVIT OF WILLIAM THAYNE HENRIE**

**ESKDALE SOUTH LOOP ROAD**

**MILLARD COUNTY, UTAH**

**ROAD NUMBER MC927**

State of Utah                    )  
  : ss.  
County of Millard                )

WILLIAM THAYNE HENRIE, being first duly sworn, deposes and states as follows:

1. I am an adult competent to testify about the matters set forth below based upon my personal knowledge. I currently reside in Millard County, Utah. I have lived in Millard County for fifty-eight years. I have been an employee of the Millard County Road Department since June of 1990, have been the Road Department Supervisor from January 1993 to the present and have participated in maintenance of the road during that time.

2. I have traveled and am familiar with a road in Millard County known as Eskdale South Loop Road. I am also familiar with the land the road traverses. When I first used and observed the road in the 1950s, it followed the same route as in 2006 when I last observed it. Attached is a Millard County map showing Eskdale South Loop Road. To the best of my knowledge and based upon my use of and familiarity with this road and the land it traverses, the location and route of the road are correctly illustrated on the attached map.

3. I am informed that the County also identifies this road according to the road number listed above.

4. I have observed that the road has been open to the public for all to use, to come and go as they pleased, since at least as early as the 1950s and continuing through 1976 to the present. Throughout this time period I have observed travel on the road by means of cars, trucks, recreational vehicles, and pickup trucks. Throughout this time period, the road has been used daily for more than ten continuous years prior to 1976, and is presently used daily.



5. Throughout the time period from the 1950s to the present, I have used the road myself for camping, hunting, rock hounding, participating in search and rescue efforts and recreation.

6. Throughout the time period described in the previous paragraph, I have observed other vehicles from the general public using the road at various times for the uses described in the previous paragraph, plus mining, prospecting for minerals, livestock operations, farming, trapping, tourism, government access, picnicking, hiking and sightseeing.

7. It is also the reputation in the community that this road has been open to the public for all to use, to come and go as they pleased, since at least as early as the early 1900s and continuing through 1976 to the present, for the uses described in the previous paragraphs.

8. Prior to 1976 I observed graders and other maintenance equipment performing maintenance and construction activities on the road. Maintenance on the road has been performed since 1955 by the Millard County Road Department.

DATED this 5 day of December, 2006.

  
\_\_\_\_\_  
WILLIAM THAYNE HENRIE

SUBSCRIBED AND SWORN to before me this 5th day of December, 2006.



  
\_\_\_\_\_  
NOTARY PUBLIC

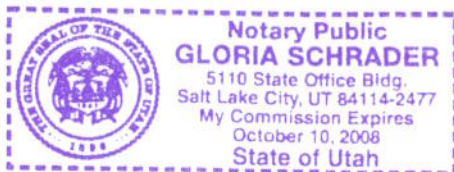

**00165898**  
B: 487 P: 324 Fee \$0.00  
Connie Hansen, Millard Recorder  
05/14/2008 01:31:03 PM Page 12 of 13  
By UT STATE GOVERNOR



ROAD = MC927  
ESKDALE SOUTH LOOP ROAD

Eskdale

50 6

Ferguson

00165898

B: 487 P: 325 Fee \$0.00 Page 13 of 13  
Connie Hansen, Millard Recorder  
05/14/2008 01:31:03 PM By UT STATE GOVERNOR



# MILLARD COUNTY

B Class Road of Interest

- Interstate
- Highway Major
- Highway Minor
- B Class Road
- Unimproved Road

- County Border
- River
- Cities / Towns
- Lakes
- Lakes - Intermittent

- Township & Range Line
- Forest Service Lands
- BLM Lands
- State Trust Lands
- Private Lands

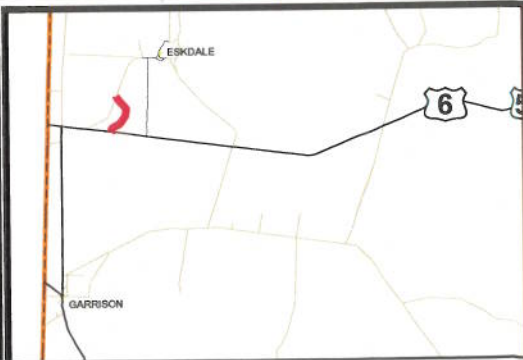



## Appendix A to Attachment 4

**Popular Name: Eskdale South Loop Road**

**County: Millard**

**County Road Number: MC927**

**State Geographic Information Database (SGID) Road Identification Number: RD144083.**

**Road-Segment Number: 001**

**Road-Segment Length: 0.71 miles more or less.**

**Believed owner of the land underlying this road-segment is: Bureau of Land Management.**

*The following description is based upon the geographic coordinate system using the NAD83 Datum. The source is GPS mapping grade data as indicated in the metadata and/or the transportation data model of the State of Utah Geographic Information Database (SGID).*

The road-segment itself is the monument that is identified by its physical presence on the land. The location of said physical presence is closely approximated by mapping grade Global Positioning System (GPS) data. Said data are checked against the corresponding gray-scale 1-meter Digital Orthophoto Quadrangles published by the United States Geological Survey (USGS) to verify a reasonable degree of accuracy. In circumstances where accurate satellite signal acquisition is not possible, such as deep, narrow canyons or under a canopy of dense foliage, or where very sharp curves in the road make accuracy questionable, such portions of the road were digitized from the corresponding gray-scale 1-meter Digital Orthophoto Quadrangles published by the United States Geological Survey (USGS).

This road-segment may traverse:

Township 20 South Range 19 West, Section(s) 16,21, Salt Lake Base & Meridian

The following description closely approximates the location of the centerline of the physical monument (Eskdale South Loop Road)-- Segment 001 based on mapping grade Global Positioning System (GPS) data as defined above:

**Beginning at a point** on the road center line located at 39 degrees 03 minutes 10.83 seconds North Latitude and -113 degrees 59 minutes 36.66 seconds West Longitude, which can be converted to mapping accuracy State Plane Utah Central Zone NAD 83 feet coordinates of X = 932,369.5 feet and Y = 6,833,672.4 feet; thence the following courses along the said road center line:

thence North 12 Degrees 11 Minutes 21 Seconds East	41 feet
thence North 08 Degrees 21 Minutes 10 Seconds East	41.5 feet
thence North 09 Degrees 44 Minutes 35 Seconds East	43.3 feet
thence North 12 Degrees 42 Minutes 17 Seconds East	8.8 feet
thence North 08 Degrees 31 Minutes 01 Seconds East	47.1 feet
thence North 08 Degrees 49 Minutes 27 Seconds East	62.1 feet
thence North 09 Degrees 12 Minutes 44 Seconds East	77.5 feet
thence North 10 Degrees 19 Minutes 47 Seconds East	90.8 feet
thence North 11 Degrees 41 Minutes 10 Seconds East	99.6 feet
thence North 14 Degrees 33 Minutes 42 Seconds East	106.2 feet
thence North 21 Degrees 51 Minutes 26 Seconds East	100.9 feet



thence North 28 Degrees 33 Minutes 56 Seconds East 91.7 feet  
 thence North 34 Degrees 18 Minutes 28 Seconds East 97.6 feet  
 thence North 39 Degrees 12 Minutes 55 Seconds East 104.1 feet  
 thence North 42 Degrees 07 Minutes 33 Seconds East 97.7 feet  
 thence North 46 Degrees 00 Minutes 08 Seconds East 92.5 feet  
 thence North 51 Degrees 13 Minutes 01 Seconds East 88 feet  
 thence North 56 Degrees 08 Minutes 19 Seconds East 87.8 feet  
 thence North 61 Degrees 24 Minutes 33 Seconds East 92 feet  
 thence North 62 Degrees 58 Minutes 03 Seconds East 94.7 feet  
 thence North 63 Degrees 58 Minutes 45 Seconds East 90.6 feet  
 thence North 65 Degrees 21 Minutes 17 Seconds East 87.5 feet  
 thence North 64 Degrees 26 Minutes 48 Seconds East 32.3 feet  
 thence North 62 Degrees 11 Minutes 52 Seconds East 17.7 feet  
 thence North 62 Degrees 18 Minutes 08 Seconds East 49.9 feet  
 thence North 63 Degrees 08 Minutes 41 Seconds East 64.5 feet  
 thence North 62 Degrees 44 Minutes 39 Seconds East 62.9 feet  
 thence North 64 Degrees 30 Minutes 31 Seconds East 67.8 feet  
 thence North 63 Degrees 53 Minutes 45 Seconds East 78.3 feet  
 thence North 64 Degrees 23 Minutes 02 Seconds East 88.2 feet  
 thence North 64 Degrees 49 Minutes 07 Seconds East 90.4 feet  
 thence North 64 Degrees 26 Minutes 16 Seconds East 84.5 feet  
 thence North 65 Degrees 10 Minutes 49 Seconds East 90.8 feet  
 thence North 65 Degrees 30 Minutes 32 Seconds East 96 feet  
 thence North 63 Degrees 55 Minutes 21 Seconds East 97.2 feet  
 thence North 63 Degrees 25 Minutes 34 Seconds East 89.6 feet  
 thence North 65 Degrees 19 Minutes 24 Seconds East 81 feet  
 thence North 65 Degrees 00 Minutes 11 Seconds East 76.9 feet  
 thence North 62 Degrees 22 Minutes 30 Seconds East 76.4 feet  
 thence North 57 Degrees 42 Minutes 16 Seconds East 40.2 feet  
 thence North 57 Degrees 50 Minutes 38 Seconds East 14.3 feet  
 thence North 53 Degrees 35 Minutes 26 Seconds East 15 feet  
 thence North 47 Degrees 21 Minutes 08 Seconds East 45.3 feet  
 thence North 42 Degrees 26 Minutes 08 Seconds East 64.3 feet  
 thence North 39 Degrees 46 Minutes 46 Seconds East 72.9 feet  
 thence North 36 Degrees 18 Minutes 03 Seconds East 80.9 feet  
 thence North 35 Degrees 52 Minutes 05 Seconds East 84.5 feet  
 thence North 36 Degrees 13 Minutes 56 Seconds East 86.5 feet  
 thence North 35 Degrees 23 Minutes 10 Seconds East 47.2 feet  
 thence North 35 Degrees 34 Minutes 21 Seconds East 33.6 feet  
 thence North 35 Degrees 30 Minutes 26 Seconds East 84.1 feet  
 thence North 35 Degrees 16 Minutes 32 Seconds East 77.8 feet more or less to **the ending**

**point at:** 39 degrees 03 minutes 35.85 seconds North Latitude and -113 degrees 59 minutes 05.74 seconds West Longitude, which can be converted to mapping accuracy State Plane Utah Central Zone NAD 83 feet coordinates of X = 934,878.0 feet and Y = 6,836,134.2 feet.

## Appendix B to Attachment 4

**Popular Name: Eskdale South Loop Road**

**County: Millard**

**County Road Number: MC927**

**State Geographic Information Database (SGID) Road Identification Number: RD144083.**

**Road-Segment Number: 004**

**Road-Segment Length: 0.27 miles more or less.**

**Believed owner of the land underlying this road-segment is: Bureau of Land Management.**

*The following description is based upon the geographic coordinate system using the NAD83 Datum. The source is GPS mapping grade data as indicated in the metadata and/or the transportation data model of the State of Utah Geographic Information Database (SGID).*

The road-segment itself is the monument that is identified by its physical presence on the land. The location of said physical presence is closely approximated by mapping grade Global Positioning System (GPS) data. Said data are checked against the corresponding gray-scale 1-meter Digital Orthophoto Quadrangles published by the United States Geological Survey (USGS) to verify a reasonable degree of accuracy. In circumstances where accurate satellite signal acquisition is not possible, such as deep, narrow canyons or under a canopy of dense foliage, or where very sharp curves in the road make accuracy questionable, such portions of the road were digitized from the corresponding gray-scale 1-meter Digital Orthophoto Quadrangles published by the United States Geological Survey (USGS).

This road-segment may traverse:

Township 20 South Range 19 West, Section(s) 9, Salt Lake Base & Meridian

The following description closely approximates the location of the centerline of the physical monument (Eskdale South Loop Road)-- Segment 004 based on mapping grade Global Positioning System (GPS) data as defined above:

**Beginning at a point** on the road center line located at 39 degrees 04 minutes 26.79 seconds North Latitude and -113 degrees 59 minutes 12.62 seconds West Longitude, which can be converted to mapping accuracy State Plane Utah Central Zone NAD 83 feet coordinates of X = 934,478.6 feet and Y = 6,841,301.6 feet; thence the following courses along the said road center line:

thence North 40 Degrees 05 Minutes 46 Seconds West 2.6 feet  
thence North 40 Degrees 53 Minutes 31 Seconds West 3 feet  
thence North 38 Degrees 51 Minutes 21 Seconds West 93.1 feet  
thence North 38 Degrees 19 Minutes 04 Seconds West 97.4 feet  
thence North 37 Degrees 49 Minutes 25 Seconds West 96.4 feet  
thence North 36 Degrees 53 Minutes 20 Seconds West 96.8 feet  
thence North 35 Degrees 21 Minutes 40 Seconds West 98.2 feet  
thence North 35 Degrees 22 Minutes 14 Seconds West 105 feet  
thence North 35 Degrees 28 Minutes 59 Seconds West 107.5 feet  
thence North 33 Degrees 53 Minutes 06 Seconds West 109.1 feet  
thence North 33 Degrees 11 Minutes 45 Seconds West 106.2 feet



thence North 32 Degrees 40 Minutes 17 Seconds West 95.5 feet  
thence North 32 Degrees 48 Minutes 29 Seconds West 93.3 feet  
thence North 30 Degrees 43 Minutes 37 Seconds West 97.8 feet  
thence North 26 Degrees 29 Minutes 16 Seconds West 91.4 feet  
thence North 22 Degrees 16 Minutes 09 Seconds West 78.9 feet  
thence North 18 Degrees 38 Minutes 51 Seconds West 76 feet more or less to **the ending point**  
**at:** 39 degrees 04 minutes 38.52 seconds North Latitude and -113 degrees 59 minutes 23.01 seconds West  
Longitude, which can be converted to mapping accuracy State Plane Utah Central Zone NAD 83 feet  
coordinates of X = 933,692.9 feet and Y = 6,842,510.6 feet.