

**Acknowledgment and
Notice of Acknowledgment
of Acceptance of R.S. 2477
Right-of-Way Grant**

Ent 103178 Bk 894 Pg 521-533
Date: 29-MAY-2008 4:25PM
Fee: None
Filed By: LCJ
LOUISE JONES, Recorder
SAN JUAN COUNTY CORPORATION
For: GOVERNOR STATE OF UTAH

THE STATE OF UTAH

TO ALL WHOM THESE PRESENTS SHALL COME, Greeting:

Know ye, This is an Acknowledgment and Notice of Acknowledgment made under Utah Code Sections 72-5-309 through 310 inclusive, that the grant of the United States of America of “the right of way for the construction of highways over public lands, not reserved for public uses” under United States Revised Statutes 2477 (43 U.S.C. Section 932 (repealed October 21, 1976, with proviso recognizing the validity of rights-of-way already established)) was accepted for and on behalf of the State of Utah and its political subdivision San Juan County as it pertains to the highway located in San Juan County known as OWL CREEK ROAD; County Road Number: B253; State Geographic Information Database (SGID) Road Identification Number: RD190258. Total road length is 5.28 miles more or less.

The reason for this Acknowledgment and Notice of Acknowledgment includes, but is not limited to, the fact that the road was constructed, mechanically, or by continuous use as a public highway for a period of at least ten years, over public lands not reserved for public uses, prior to the earlier of (a) the October 21, 1976 repeal of R.S. 2477 or (b) the date the servient estate was reserved for public uses.

This Acknowledgment and Notice of Acknowledgment applies only to the segments of the road that traverse land owned by the Bureau of Land Management, United States Department of the Interior, and does not apply to segments of the road that traverse land owned by any other person or entity. The State of Utah and its political subdivisions reserve the right to make further acknowledgments and notices of acknowledgment with regard to road segments that traverse land owned by other entities, including the United States of America, through one or more of its agencies.

A printed copy of a map showing the location of the road in said county is appended hereto as “Attachment 1,” a printed copy of representative photos of the road is appended hereto as “Attachment 2,” a printed copy of a description of the beginning and ending points of the entire road together with a list of Townships, Ranges and Sections that may be traversed by the road in said county is appended hereto as “Attachment 3,” and a printed copy of the Road Centerline Description Cover Page(s) is appended hereto as “Attachment 4.” The Appendices listed in “Attachment 4” that contain the actual road centerline descriptions are incorporated herein by reference. Affidavits provided by individuals familiar with the road are appended hereto as “Attachment 5.”

A printed copy of this Acknowledgment and Notice of Acknowledgment, together with its Attachments and Appendices, may be viewed and/or obtained at the office of the Utah State Archives.

An electronic copy of this Acknowledgment and Notice of Acknowledgment, together with its Attachments and Appendices, may be viewed and/or downloaded as read-only PDF (Portable Document Format) files via the

Internet at <http://recorded2477roads.utah.gov>.

The owner of the servient estate in the land underlying the road-segments subject to this Acknowledgment and Notice is believed to be the United States of America through one or more of its agencies. Any of such agencies or any other person with a servient ownership claim or a competing dominant estate right-of-way ownership claim, may file a petition in the State District Court for Salt Lake County for a decision regarding the correctness of this Acknowledgment. A claimant shall file a petition within sixty (60) days after receipt of this Notice.

In Witness Whereof, I, John Harja, the official designee of the Governor of the State of Utah, in conformity to the laws of the State (Utah Code Sections 72-5-308 through 310 inclusive), have caused this Acknowledgment and Notice of Acknowledgment to be made.

Signed by my hand in Salt Lake City, Utah, the 22nd day of May, 2008.

By the Governor's Designee



John Harja

CERTIFICATION

State of Utah)
 : ss
County of Salt Lake)

I hereby certify that the signer of the foregoing document, John Harja, is personally known by me, has made a voluntary signature and taken an oath stating that he is the official designee of the Governor of the State of Utah and is authorized to sign this document on the Governor's behalf pursuant to Utah Code Section 72-5-309. He further vouched that, based upon information and belief, the facts alleged therein are true.

Dated this 22nd day of May, 2008.



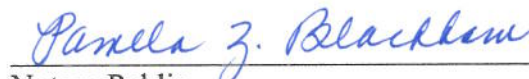

Notary Public

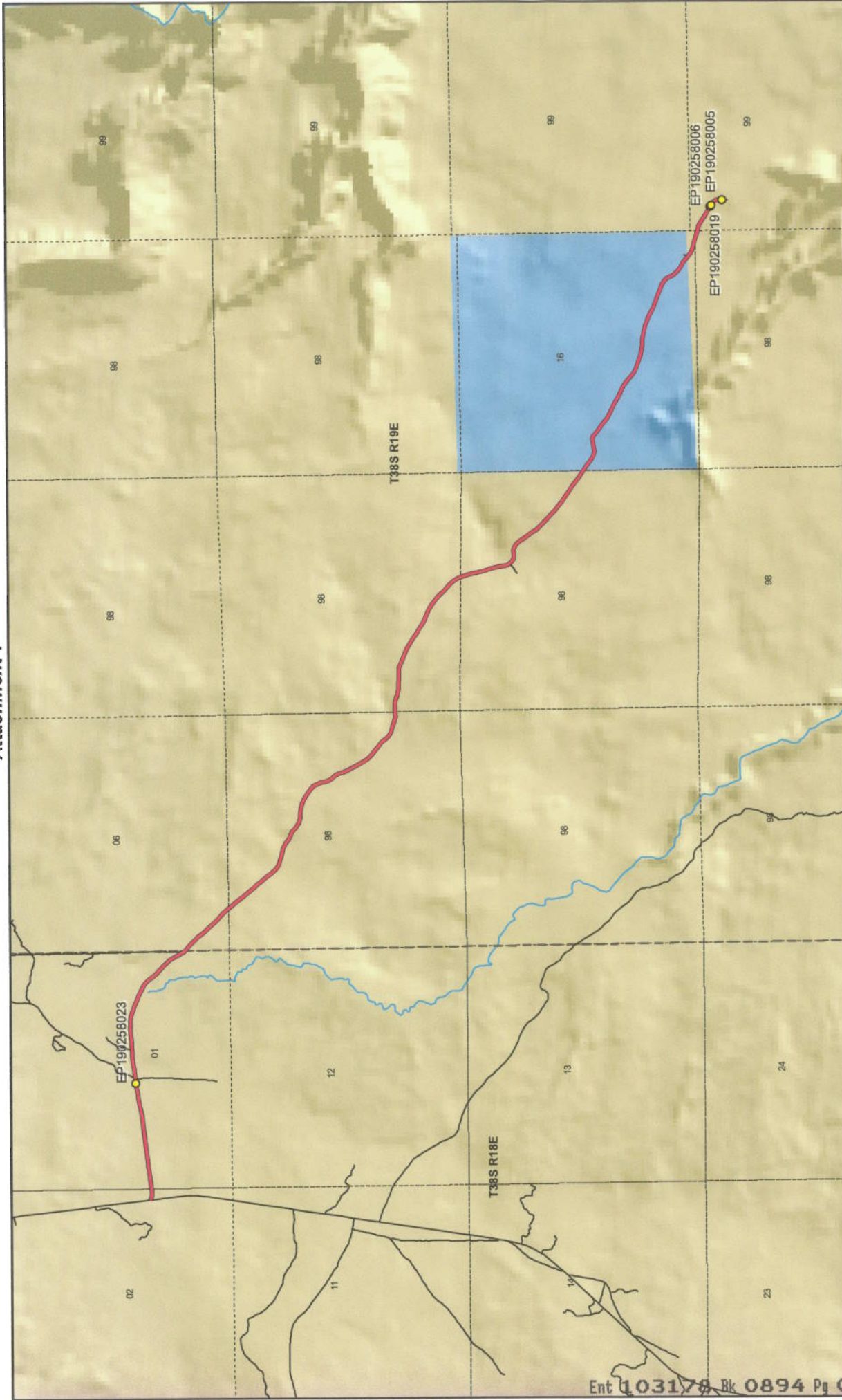

Ent 103178 Bk 0894 Pg 0523

OWL CREEK ROAD - San Juan County
SGID RD_ID RD190258

Land Ownership Categories

- BLM
- Private
- SITLA, State Trust Land
- USFS, National Forest
- State Parks and Recreation
- Tribal, Indian Reservation
- NPS, National Park

Transportation Network

- OWL CREEK ROAD
- Other Roads
- Title V, Leased Or Under Consideration By BLM Or County
- Photo Event Point

Section = 1 Mile

Map prepared by the State of Utah
Automated Geographic Reference Center
Room 5130 State Office Building
Salt Lake City, Utah 84114
Apr 07, 2008





1:35,317
1 inch equals 0.6 miles



Page 1 of 1

Attachment 1

SGID Road Identification Number RD_ID: RD190258

Attachment 2



EP190258005



EP190258006



EP190258019



EP190258023

EP000000000

EP000000000

OWL CREEK ROAD - San Juan County
SGID RD_ID RD190258

Map prepared by the State of Utah
Automated Geographic Reference Center
Room 5130 State Office Building
Salt Lake City, Utah 84114
April 11, 2008



Attachment 3

Beginning & Ending Points and Township, Range, and Section References For:

Popular Name: OWL CREEK ROAD

County: San Juan

County Road Number: B253

State Geographic Information Database (SGID) Road Identification Number: RD190258.

Total Road Length: 5.28 miles more or less.

Beginning at a point on the road centerline located at 37 degrees 30 minutes 035.1 seconds North Latitude and -109 degrees 53 minutes 37.72 seconds West Longitude, which can be converted to mapping accuracy State Plane Utah South Zone NAD 83 feet coordinates of X = 2,106,285.6 feet and Y = 10,153,481.9 feet based on the US Survey Foot conversion.

Ending at a point on the road centerline located at 37 degrees 28 minutes 25.24 seconds North Latitude and -109 degrees 49 minutes 05.91 seconds West Longitude, which can be converted to mapping accuracy State Plane Utah South Zone NAD 83 feet coordinates of X = 2,128,419.3 feet and Y = 10,140,734.6 feet based on the US Survey Foot conversion.

This road may traverse:

Township 38 South Range 18 East, Section(s) 1,2, Salt Lake Base & Meridian

Township 38 South Range 19 East, Section(s) 0n/a, Salt Lake Base & Meridian

Township 38 South Range 19 East, Section(s) 6,16, Salt Lake Base & Meridian

See Attachment 1 above for a cartographic depiction of the course of this road.

**Attachment 4
Road Centerline Description Cover Page(s)**

Popular Name: OWL CREEK ROAD

County: San Juan

County Road Number: B253

State Geographic Information Database (SGID) Road Identification Number: RD190258.

Total Road Length: 5.28 miles more or less.

Centerline Descriptions Of Road-Segments That Cross Over Federally Owned Land, Derived From Global Positioning System Data And Cross-checked against USGS Digital Orthophoto Quadrangles Compiled By The Utah Automated Geographic Reference Center And Entered Into The State Geographic Information Database (SGID).

Road-Segments Listed by SGID Road Identification Number (RD_ID)	Road-Segment Numbers	Believed Ownership Of Servient Estate	Approximate Segment Length	See Attached Appendix
RD190258	001	BLM	3.92 Miles	A
RD190258	002	ST	1.03 Miles	(not shown)
RD190258	003	BLM	0.32 Miles	B
		Total Road Length	5.28	—————

* Indicates that a Title V permit will be requested, is in process, or has been issued.

† Indicates that road-segments crossing Forest Service land are under consideration by the state and county as of the date of this Acknowledgment and Notice of Acknowledgment.

Attachment 5

AFFIDAVIT OF ALBERT E. STEELE

OWL CREEK ROAD

SAN JUAN COUNTY, UTAH

COUNTY ROAD NUMBER B253

State of Utah)
 : ss
County of San Juan)

Albert E. Steele, being first duly sworn, deposes and states as follows:

1. I am an adult competent to testify about the matters set forth below based upon my personal knowledge. I currently reside in San Juan County, Utah. I have lived in San Juan County for 60 years.

2. I have traveled and am familiar with a road in San Juan County known as Owl Creek Road. I am also familiar with the land the road traverses. When I first used and observed the road in 1960, it followed the same route as in 2002, when I last observed it. Attached is a San Juan County map showing Owl Creek Road. To the best of my knowledge and based upon my use of and familiarity with this road and the land it traverses, the location and route of the road are correctly illustrated on the attached map.

3. I am informed that the County identifies this road according to the road number described above.

4. I have observed that the road has been open to the public for all to use, to come and go as they pleased, since at least as early as 1960 and continuing through 1976 to 2002. Throughout this time period I have observed travel on the road by various means, including: pickup, automobile, other truck, and jeep. Throughout this time period, the road was used daily for more than 10 continuous years prior to 1976 and was used daily in 2002.

5. Throughout the time period from 1960 to 2002, I have used the road myself for the following uses: predator control and recreation.

6. Throughout the time period described in the previous paragraph, I observed vehicles using the road at various times for the uses described in the previous paragraph, plus the following uses: livestock operations, wood gathering, hunting, tourism, archeology, mineral prospecting, oil and gas exploration, and traveling in and through the area.

7. It is also the reputation in the community that this road has been open to the public for all to use, to come and go as they pleased, since at least as early as the early 1950s and continuing through 1976 to the present, for the uses described in the previous paragraphs.

8. I observed the graded surface prior to 1976.

Dated this 18th day of September, 2007.

Albert E. Steele
Albert E. Steele

SUBSCRIBED AND SWORN TO before me this 18th day of September, 2007.

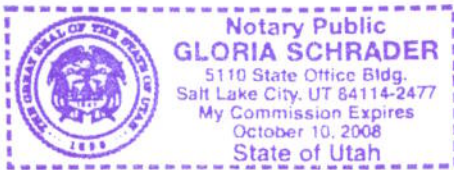

Gloria Schrader
Notary Public

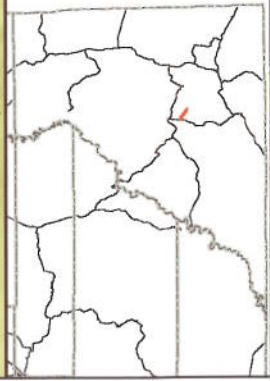
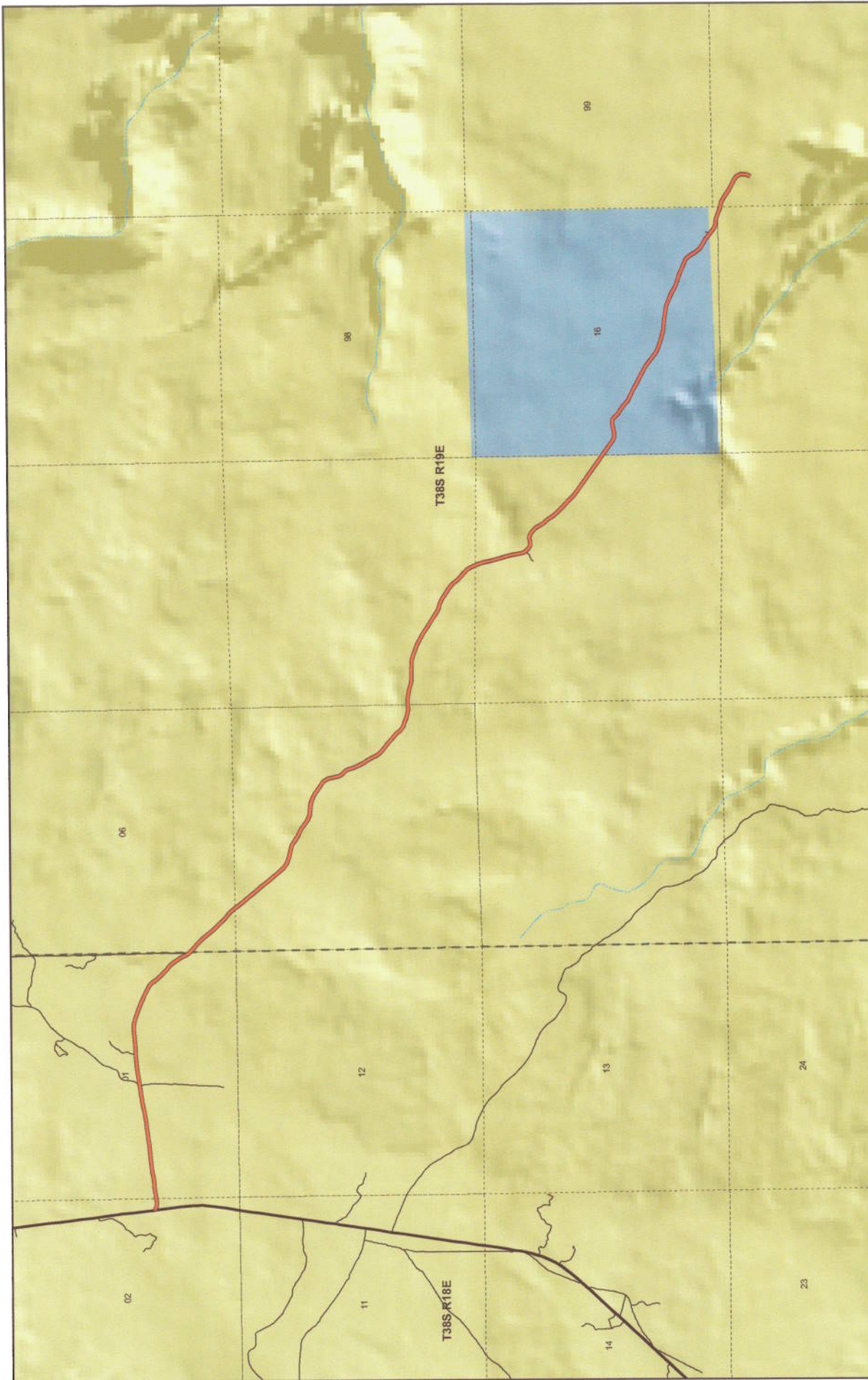

OWL CREEK
County Unique - B253

- Land Ownership Categories**
- BLM
 - National Recreation Area
 - SITLA, State Trust Land
 - USFS, National Forest
 - National Parks & Monuments (NPS)
- Misc**
- City / Town
 - Municipalities
 - Section = 1 Mile
- Transportation Network**
- OWL CREEK
 - State / U.S. Highway
 - Local Roads



1:33,694
 1 inch equals 0.5 miles
 Jul 26, 2007

AFFIDAVIT OF KENNETH ROBERT CHRISTENSEN

OWL CREEK ROAD

SAN JUAN COUNTY, UTAH

COUNTY ROAD NUMBER B253

State of Utah)
 : ss
County of San Juan)

Kenneth Robert Christensen, being first duly sworn, deposes and states as follows:

1. I am an adult competent to testify about the matters set forth below based upon my personal knowledge. I currently reside in San Juan County, Utah. I have lived in San Juan County since 1929.

2. I have traveled and am familiar with a road in San Juan County known as Owl Creek Road. I am also familiar with the land the road traverses. When I first used and observed the road in 1965, it followed the same route as in 1994, when I last observed it. Attached is a San Juan County map showing Owl Creek Road. To the best of my knowledge and based upon my use of and familiarity with this road and the land it traverses, the location and route of the road are correctly illustrated on the attached map.

3. I am informed that the County identifies this road according to the road number described above.

4. I have observed that the road has been open to the public for all to use, to come and go as they pleased, since at least as early as 1965 and continuing through 1976 to 1994. Throughout this time period I have observed travel on the road by various means, including: pickup, trailer, other truck, bulldozer and jeep. Throughout this time period, the road has been used weekly for more than 10 continuous years prior to 1976, and was used weekly in 1994.

5. Throughout the time period from 1965 to 1994, I have used the road myself for the following uses: range studies and range improvement with the BLM.

6. Throughout the time period described in the previous paragraph, I observed vehicles using the road at various times for the uses described in the previous paragraph, plus the following uses: hunting, wood gathering, recreation and livestock operations.

7. It is also the reputation in the community that this road has been open to the public for all to use, to come and go as they pleased, since at least as early as 1965 and continuing through 1976 to the present, for the uses described in the previous paragraphs.

8. I observed the following evidence of construction and maintenance performed on the road prior to 1976: I observed the graded surface of the road.

Dated this 18 day of September, 2007.



Kenneth Robert Christensen

SUBSCRIBED AND SWORN TO before me this 18th day of September, 2007.

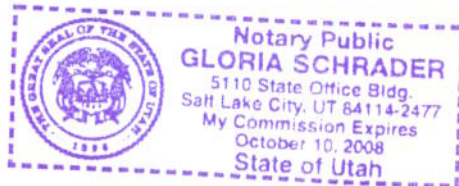



Notary Public

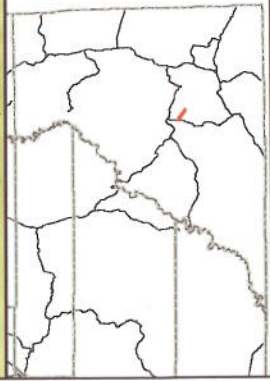
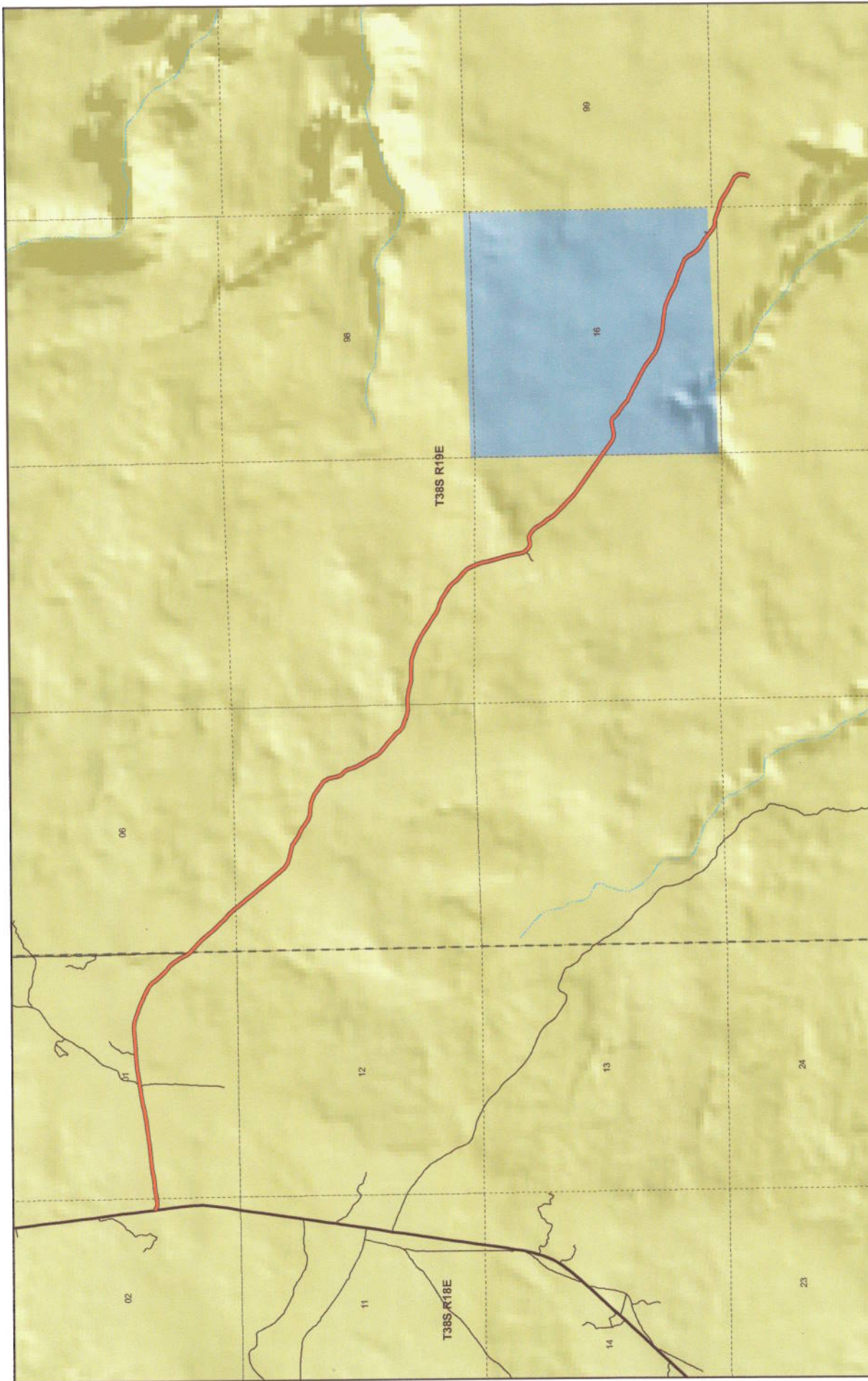

OWL CREEK
County Unique - B253

- Land Ownership Categories**
- BLM
 - National Recreation Area
 - SITLA, State Trust Land
 - USFS, National Forest
 - National Parks & Monuments (NPS)
- Misc**
- City / Town
 - Municipalities
 - Section = 1 Mile
 - Private
 - Wilderness
 - State Park
 - Tribal Lands
- Transportation Network**
- OWL CREEK
 - State / U.S. Highway
 - Local Roads



1:33,694
1 inch equals 0.5 miles
Jul 26, 2007

Appendix A to Attachment 4

Popular Name: OWL CREEK ROAD

County: San Juan

County Road Number: B253

State Geographic Information Database (SGID) Road Identification Number: RD190258.

Road-Segment Number: 001

Road-Segment Length: 3.92 miles more or less.

Believed owner of the land underlying this road-segment is: Bureau of Land Management.

The following description is based upon the geographic coordinate system using the NAD83 Datum. The source is GPS mapping grade data as indicated in the metadata and/or the transportation data model of the State of Utah Geographic Information Database (SGID).

The road-segment itself is the monument that is identified by its physical presence on the land. The location of said physical presence is closely approximated by mapping grade Global Positioning System (GPS) data. Said data are checked against the corresponding gray-scale 1-meter Digital Orthophoto Quadrangles published by the United States Geological Survey (USGS) to verify a reasonable degree of accuracy. In circumstances where accurate satellite signal acquisition is not possible, such as deep, narrow canyons or under a canopy of dense foliage, or where very sharp curves in the road make accuracy questionable, such portions of the road were digitized from the corresponding gray-scale 1-meter Digital Orthophoto Quadrangles published by the United States Geological Survey (USGS).

This road-segment may traverse:

Township 38 South Range 18 East, Section(s) 1,2, Salt Lake Base & Meridian

Township 38 South Range 19 East, Section(s) 0n/a, Salt Lake Base & Meridian

Township 38 South Range 19 East, Section(s) 6, Salt Lake Base & Meridian

The following description closely approximates the location of the centerline of the physical monument (OWL CREEK ROAD)-- Segment 001 based on mapping grade Global Positioning System (GPS) data as defined above:

Beginning at a point on the road center line located at 37 degrees 30 minutes 035.1 seconds North Latitude and -109 degrees 53 minutes 37.72 seconds West Longitude, which can be converted to mapping accuracy State Plane Utah South Zone NAD 83 feet coordinates of X = 2,106,285.6 feet and Y = 10,153,481.9 feet; thence the following courses along the said road center line:

thence South 67 Degrees 16 Minutes 15 Seconds East 31 feet
thence South 63 Degrees 44 Minutes 43 Seconds East 32.3 feet
thence South 72 Degrees 21 Minutes 15 Seconds East 37.3 feet
thence South 85 Degrees 01 Minutes 13 Seconds East 35.6 feet
thence North 86 Degrees 40 Minutes 36 Seconds East 31.2 feet
thence North 83 Degrees 37 Minutes 01 Seconds East 31 feet
thence North 82 Degrees 56 Minutes 58 Seconds East 36.3 feet
thence North 82 Degrees 07 Minutes 35 Seconds East 19.7 feet
thence North 82 Degrees 07 Minutes 20 Seconds East 22.7 feet

thence North 80 Degrees 18 Minutes 44 Seconds East 36.3 feet
 thence North 80 Degrees 53 Minutes 56 Seconds East 32.2 feet
 thence North 80 Degrees 25 Minutes 29 Seconds East 46.9 feet
 thence North 81 Degrees 19 Minutes 58 Seconds East 58.7 feet
 thence North 83 Degrees 20 Minutes 57 Seconds East 68.3 feet
 thence North 82 Degrees 55 Minutes 08 Seconds East 72.4 feet
 thence North 82 Degrees 21 Minutes 09 Seconds East 77.1 feet
 thence North 82 Degrees 05 Minutes 41 Seconds East 79.5 feet
 thence North 81 Degrees 17 Minutes 47 Seconds East 80.9 feet
 thence North 82 Degrees 37 Minutes 15 Seconds East 82.7 feet
 thence North 83 Degrees 19 Minutes 30 Seconds East 85.9 feet
 thence North 83 Degrees 17 Minutes 06 Seconds East 97.1 feet
 thence North 82 Degrees 36 Minutes 29 Seconds East 106.5 feet
 thence North 82 Degrees 50 Minutes 48 Seconds East 115.7 feet
 thence North 83 Degrees 18 Minutes 47 Seconds East 115.2 feet
 thence North 82 Degrees 43 Minutes 56 Seconds East 111.1 feet
 thence North 82 Degrees 27 Minutes 54 Seconds East 117.4 feet
 thence North 82 Degrees 04 Minutes 22 Seconds East 113.9 feet
 thence North 81 Degrees 58 Minutes 03 Seconds East 117.2 feet
 thence North 80 Degrees 58 Minutes 00 Seconds East 121.2 feet
 thence North 78 Degrees 47 Minutes 13 Seconds East 126.7 feet
 thence North 78 Degrees 10 Minutes 51 Seconds East 129.9 feet
 thence North 79 Degrees 46 Minutes 41 Seconds East 123.9 feet
 thence North 80 Degrees 05 Minutes 21 Seconds East 112.2 feet
 thence North 81 Degrees 48 Minutes 42 Seconds East 105.4 feet
 thence North 81 Degrees 49 Minutes 46 Seconds East 98.4 feet
 thence North 79 Degrees 49 Minutes 25 Seconds East 15.3 feet
 thence North 80 Degrees 38 Minutes 44 Seconds East 96 feet
 thence North 81 Degrees 00 Minutes 49 Seconds East 121.8 feet
 thence North 82 Degrees 17 Minutes 52 Seconds East 122.4 feet
 thence North 83 Degrees 26 Minutes 07 Seconds East 120.5 feet
 thence North 85 Degrees 01 Minutes 56 Seconds East 117.2 feet
 thence North 85 Degrees 47 Minutes 20 Seconds East 115.8 feet
 thence North 86 Degrees 39 Minutes 35 Seconds East 118 feet
 thence North 85 Degrees 46 Minutes 00 Seconds East 115.1 feet
 thence North 85 Degrees 36 Minutes 13 Seconds East 115.1 feet
 thence North 85 Degrees 58 Minutes 57 Seconds East 116.7 feet
 thence North 88 Degrees 32 Minutes 13 Seconds East 114.2 feet
 thence South 79 Degrees 44 Minutes 28 Seconds East 114.5 feet
 thence South 72 Degrees 04 Minutes 54 Seconds East 115.4 feet
 thence South 70 Degrees 53 Minutes 16 Seconds East 120.4 feet
 thence South 67 Degrees 10 Minutes 20 Seconds East 122.8 feet
 thence South 68 Degrees 13 Minutes 48 Seconds East 112.6 feet
 thence South 67 Degrees 01 Minutes 37 Seconds East 87.2 feet
 thence South 63 Degrees 27 Minutes 13 Seconds East 86.4 feet
 thence South 62 Degrees 41 Minutes 30 Seconds East 87.8 feet
 thence South 57 Degrees 38 Minutes 58 Seconds East 76 feet
 thence South 44 Degrees 55 Minutes 33 Seconds East 69.2 feet
 thence South 35 Degrees 01 Minutes 16 Seconds East 76.6 feet

thence South 37 Degrees 08 Minutes 06 Seconds East 83.2 feet
 thence South 42 Degrees 49 Minutes 15 Seconds East 90.8 feet
 thence South 46 Degrees 03 Minutes 02 Seconds East 89.8 feet
 thence South 49 Degrees 02 Minutes 31 Seconds East 85.6 feet
 thence South 48 Degrees 18 Minutes 08 Seconds East 66.7 feet
 thence South 45 Degrees 18 Minutes 38 Seconds East 50.1 feet
 thence South 39 Degrees 29 Minutes 41 Seconds East 50.4 feet
 thence South 38 Degrees 27 Minutes 02 Seconds East 62.2 feet
 thence South 35 Degrees 54 Minutes 44 Seconds East 68.2 feet
 thence South 31 Degrees 59 Minutes 40 Seconds East 80.6 feet
 thence South 28 Degrees 53 Minutes 12 Seconds East 87.8 feet
 thence South 28 Degrees 17 Minutes 00 Seconds East 77.7 feet
 thence South 32 Degrees 42 Minutes 18 Seconds East 56.4 feet
 thence South 40 Degrees 21 Minutes 35 Seconds East 36.6 feet
 thence South 40 Degrees 20 Minutes 15 Seconds East 35.9 feet
 thence South 48 Degrees 48 Minutes 27 Seconds East 83.7 feet
 thence South 50 Degrees 18 Minutes 34 Seconds East 98.5 feet
 thence South 43 Degrees 42 Minutes 57 Seconds East 108.4 feet
 thence South 41 Degrees 54 Minutes 04 Seconds East 109.3 feet
 thence South 40 Degrees 54 Minutes 42 Seconds East 93.8 feet
 thence South 40 Degrees 26 Minutes 26 Seconds East 103.9 feet
 thence South 41 Degrees 57 Minutes 23 Seconds East 126.9 feet
 thence South 42 Degrees 57 Minutes 35 Seconds East 141.4 feet
 thence South 43 Degrees 58 Minutes 58 Seconds East 140.2 feet
 thence South 50 Degrees 43 Minutes 28 Seconds East 142.6 feet
 thence South 39 Degrees 49 Minutes 12 Seconds East 138.2 feet
 thence South 37 Degrees 57 Minutes 49 Seconds East 37.9 feet
 thence South 37 Degrees 56 Minutes 52 Seconds East 103.4 feet
 thence South 41 Degrees 31 Minutes 28 Seconds East 126.5 feet
 thence South 39 Degrees 04 Minutes 20 Seconds East 115.3 feet
 thence South 39 Degrees 39 Minutes 44 Seconds East 106.1 feet
 thence South 39 Degrees 17 Minutes 35 Seconds East 81.9 feet
 thence South 37 Degrees 21 Minutes 35 Seconds East 83.9 feet
 thence South 40 Degrees 39 Minutes 15 Seconds East 102.9 feet
 thence South 39 Degrees 38 Minutes 49 Seconds East 112.9 feet
 thence South 39 Degrees 58 Minutes 32 Seconds East 119.8 feet
 thence South 40 Degrees 15 Minutes 54 Seconds East 129.3 feet
 thence South 39 Degrees 08 Minutes 25 Seconds East 138.2 feet
 thence South 41 Degrees 44 Minutes 50 Seconds East 126.9 feet
 thence South 56 Degrees 03 Minutes 12 Seconds East 119.5 feet
 thence South 71 Degrees 09 Minutes 18 Seconds East 132 feet
 thence South 75 Degrees 46 Minutes 52 Seconds East 138.7 feet
 thence South 77 Degrees 52 Minutes 47 Seconds East 125 feet
 thence South 59 Degrees 03 Minutes 26 Seconds East 111.3 feet
 thence South 53 Degrees 41 Minutes 28 Seconds East 105.1 feet
 thence South 67 Degrees 09 Minutes 39 Seconds East 101 feet
 thence South 63 Degrees 03 Minutes 19 Seconds East 97.5 feet
 thence South 52 Degrees 08 Minutes 03 Seconds East 109.4 feet
 thence South 55 Degrees 57 Minutes 04 Seconds East 116.9 feet

thence South 68 Degrees 17 Minutes 34 Seconds East	112.9 feet
thence South 86 Degrees 51 Minutes 26 Seconds East	114.4 feet
thence South 87 Degrees 12 Minutes 12 Seconds East	115 feet
thence South 74 Degrees 28 Minutes 59 Seconds East	109.5 feet
thence South 63 Degrees 40 Minutes 46 Seconds East	127.4 feet
thence South 55 Degrees 55 Minutes 05 Seconds East	133.6 feet
thence South 57 Degrees 20 Minutes 55 Seconds East	114.6 feet
thence South 52 Degrees 31 Minutes 00 Seconds East	81.4 feet
thence South 27 Degrees 54 Minutes 29 Seconds East	130.3 feet
thence South 16 Degrees 02 Minutes 18 Seconds East	59.3 feet
thence South 13 Degrees 01 Minutes 18 Seconds East	89.5 feet
thence South 16 Degrees 46 Minutes 32 Seconds East	84.5 feet
thence South 30 Degrees 23 Minutes 25 Seconds East	76.6 feet
thence South 43 Degrees 58 Minutes 42 Seconds East	79.8 feet
thence South 35 Degrees 59 Minutes 13 Seconds East	63 feet
thence South 20 Degrees 36 Minutes 17 Seconds East	67.2 feet
thence South 19 Degrees 08 Minutes 40 Seconds East	89.5 feet
thence South 23 Degrees 16 Minutes 07 Seconds East	102.6 feet
thence South 27 Degrees 19 Minutes 24 Seconds East	112.7 feet
thence South 28 Degrees 34 Minutes 40 Seconds East	113.6 feet
thence South 29 Degrees 55 Minutes 20 Seconds East	104.9 feet
thence South 29 Degrees 53 Minutes 35 Seconds East	100.4 feet
thence South 36 Degrees 57 Minutes 36 Seconds East	102.3 feet
thence South 46 Degrees 47 Minutes 09 Seconds East	108.2 feet
thence South 51 Degrees 34 Minutes 27 Seconds East	114.9 feet
thence South 50 Degrees 19 Minutes 26 Seconds East	119.5 feet
thence South 49 Degrees 47 Minutes 01 Seconds East	110.1 feet
thence South 47 Degrees 16 Minutes 28 Seconds East	81.3 feet
thence South 39 Degrees 58 Minutes 12 Seconds East	82.3 feet
thence South 42 Degrees 29 Minutes 43 Seconds East	56.7 feet
thence South 55 Degrees 05 Minutes 35 Seconds East	41 feet
thence South 60 Degrees 14 Minutes 32 Seconds East	36 feet
thence South 64 Degrees 40 Minutes 11 Seconds East	27.3 feet
thence South 67 Degrees 58 Minutes 55 Seconds East	39.7 feet
thence South 73 Degrees 12 Minutes 29 Seconds East	62.5 feet
thence South 71 Degrees 33 Minutes 39 Seconds East	75.5 feet
thence South 70 Degrees 18 Minutes 30 Seconds East	83.5 feet
thence South 79 Degrees 37 Minutes 18 Seconds East	83.2 feet
thence North 87 Degrees 10 Minutes 27 Seconds East	97.2 feet
thence North 86 Degrees 38 Minutes 10 Seconds East	14.8 feet
thence North 86 Degrees 33 Minutes 25 Seconds East	69.7 feet
thence South 87 Degrees 56 Minutes 40 Seconds East	79.5 feet
thence South 87 Degrees 52 Minutes 27 Seconds East	61.8 feet
thence South 80 Degrees 09 Minutes 55 Seconds East	63.3 feet
thence South 75 Degrees 46 Minutes 35 Seconds East	45.8 feet
thence South 66 Degrees 09 Minutes 55 Seconds East	10.4 feet
thence South 64 Degrees 24 Minutes 15 Seconds East	12.8 feet
thence South 66 Degrees 52 Minutes 55 Seconds East	10.7 feet
thence South 72 Degrees 32 Minutes 59 Seconds East	44.1 feet

thence South 76 Degrees 03 Minutes 05 Seconds East 61.3 feet
 thence South 84 Degrees 09 Minutes 51 Seconds East 64.4 feet
 thence South 88 Degrees 25 Minutes 10 Seconds East 69.6 feet
 thence South 87 Degrees 14 Minutes 09 Seconds East 79.5 feet
 thence South 89 Degrees 00 Minutes 14 Seconds East 86.3 feet
 thence South 89 Degrees 40 Minutes 44 Seconds East 89.3 feet
 thence South 89 Degrees 43 Minutes 45 Seconds East 64.7 feet
 thence South 83 Degrees 58 Minutes 14 Seconds East 47.5 feet
 thence South 82 Degrees 57 Minutes 30 Seconds East 41 feet
 thence South 73 Degrees 17 Minutes 54 Seconds East 46 feet
 thence South 66 Degrees 33 Minutes 40 Seconds East 80.7 feet
 thence South 70 Degrees 10 Minutes 50 Seconds East 98.2 feet
 thence South 69 Degrees 50 Minutes 03 Seconds East 110.7 feet
 thence South 63 Degrees 53 Minutes 02 Seconds East 121.7 feet
 thence South 58 Degrees 23 Minutes 01 Seconds East 127.2 feet
 thence South 57 Degrees 41 Minutes 29 Seconds East 126.6 feet
 thence South 56 Degrees 25 Minutes 06 Seconds East 128.9 feet
 thence South 59 Degrees 33 Minutes 56 Seconds East 132.9 feet
 thence South 54 Degrees 14 Minutes 18 Seconds East 122.6 feet
 thence South 60 Degrees 43 Minutes 00 Seconds East 108.3 feet
 thence South 71 Degrees 58 Minutes 36 Seconds East 117.9 feet
 thence South 66 Degrees 14 Minutes 18 Seconds East 121.5 feet
 thence South 58 Degrees 55 Minutes 21 Seconds East 129.2 feet
 thence South 55 Degrees 31 Minutes 59 Seconds East 129.4 feet
 thence South 52 Degrees 36 Minutes 36 Seconds East 104.1 feet
 thence South 40 Degrees 54 Minutes 44 Seconds East 75.6 feet
 thence South 37 Degrees 26 Minutes 30 Seconds East 86.4 feet
 thence South 50 Degrees 42 Minutes 19 Seconds East 96.3 feet
 thence South 50 Degrees 58 Minutes 21 Seconds East 108.2 feet
 thence South 41 Degrees 10 Minutes 34 Seconds East 115.9 feet
 thence South 29 Degrees 32 Minutes 55 Seconds East 119.6 feet
 thence South 22 Degrees 20 Minutes 09 Seconds East 59.3 feet
 thence South 22 Degrees 19 Minutes 35 Seconds East 68.5 feet
 thence South 17 Degrees 27 Minutes 29 Seconds East 124.7 feet
 thence South 13 Degrees 46 Minutes 10 Seconds East 118.4 feet
 thence South 13 Degrees 11 Minutes 42 Seconds East 114.8 feet
 thence South 15 Degrees 23 Minutes 30 Seconds East 113.5 feet
 thence South 16 Degrees 53 Minutes 06 Seconds East 115 feet
 thence South 15 Degrees 45 Minutes 02 Seconds East 107.2 feet
 thence South 13 Degrees 00 Minutes 46 Seconds East 106 feet
 thence South 09 Degrees 36 Minutes 36 Seconds East 113.7 feet
 thence South 14 Degrees 57 Minutes 44 Seconds East 103.8 feet
 thence South 39 Degrees 36 Minutes 01 Seconds East 97.9 feet
 thence South 56 Degrees 12 Minutes 48 Seconds East 89.6 feet
 thence North 89 Degrees 28 Minutes 21 Seconds East 87 feet
 thence North 77 Degrees 44 Minutes 57 Seconds East 76.1 feet
 thence North 88 Degrees 49 Minutes 38 Seconds East 43.7 feet
 thence South 61 Degrees 55 Minutes 54 Seconds East 32.4 feet
 thence South 58 Degrees 32 Minutes 12 Seconds East 51.7 feet

thence South 54 Degrees 29 Minutes 08 Seconds East 68.4 feet
 thence South 42 Degrees 16 Minutes 53 Seconds East 83.4 feet
 thence South 30 Degrees 15 Minutes 42 Seconds East 101.9 feet
 thence South 36 Degrees 24 Minutes 54 Seconds East 108 feet
 thence South 40 Degrees 52 Minutes 58 Seconds East 69.1 feet
 thence South 34 Degrees 22 Minutes 53 Seconds East 68.5 feet
 thence South 30 Degrees 13 Minutes 37 Seconds East 95.4 feet
 thence South 42 Degrees 18 Minutes 41 Seconds East 106.4 feet
 thence South 45 Degrees 45 Minutes 37 Seconds East 118.3 feet
 thence South 47 Degrees 07 Minutes 51 Seconds East 124.2 feet
 thence South 45 Degrees 49 Minutes 38 Seconds East 128.8 feet
 thence South 46 Degrees 34 Minutes 45 Seconds East 125.8 feet
 thence South 52 Degrees 05 Minutes 15 Seconds East 127.8 feet
 thence South 55 Degrees 10 Minutes 20 Seconds East 126 feet
 thence South 54 Degrees 09 Minutes 44 Seconds East 125.2 feet
 thence South 56 Degrees 00 Minutes 27 Seconds East 127.5 feet
 thence South 54 Degrees 24 Minutes 20 Seconds East 124.8 feet
 thence South 54 Degrees 43 Minutes 29 Seconds East 134.8 feet
 thence South 55 Degrees 02 Minutes 09 Seconds East 141.5 feet
 thence South 55 Degrees 18 Minutes 29 Seconds East 143 feet more or less to **the ending**

point at: 37 degrees 28 minutes 57.75 seconds North Latitude and -109 degrees 50 minutes 19.56 seconds West Longitude, which can be converted to mapping accuracy State Plane Utah South Zone NAD 83 feet coordinates of X = 2,122,424.5 feet and Y = 10,143,915.4 feet.

Appendix B to Attachment 4

Popular Name: OWL CREEK ROAD

County: San Juan

County Road Number: B253

State Geographic Information Database (SGID) Road Identification Number: RD190258.

Road-Segment Number: 003

Road-Segment Length: 0.32 miles more or less.

Believed owner of the land underlying this road-segment is: Bureau of Land Management.

The following description is based upon the geographic coordinate system using the NAD83 Datum. The source is GPS mapping grade data as indicated in the metadata and/or the transportation data model of the State of Utah Geographic Information Database (SGID).

The road-segment itself is the monument that is identified by its physical presence on the land. The location of said physical presence is closely approximated by mapping grade Global Positioning System (GPS) data. Said data are checked against the corresponding gray-scale 1-meter Digital Orthophoto Quadrangles published by the United States Geological Survey (USGS) to verify a reasonable degree of accuracy. In circumstances where accurate satellite signal acquisition is not possible, such as deep, narrow canyons or under a canopy of dense foliage, or where very sharp curves in the road make accuracy questionable, such portions of the road were digitized from the corresponding gray-scale 1-meter Digital Orthophoto Quadrangles published by the United States Geological Survey (USGS).

This road-segment may traverse:

Township 38 South Range 19 East, Section(s) 0n/a, Salt Lake Base & Meridian

Township 38 South Range 19 East, Section(s) 16, Salt Lake Base & Meridian

The following description closely approximates the location of the centerline of the physical monument (OWL CREEK ROAD)-- Segment 003 based on mapping grade Global Positioning System (GPS) data as defined above:

Beginning at a point on the road center line located at 37 degrees 28 minutes 34.03 seconds North Latitude and -109 degrees 49 minutes 21.14 seconds West Longitude, which can be converted to mapping accuracy State Plane Utah South Zone NAD 83 feet coordinates of X = 2,127,175.8 feet and Y = 10,141,601.1 feet; thence the following courses along the said road center line:

thence South 52 Degrees 36 Minutes 05 Seconds East	129.8 feet
thence South 62 Degrees 51 Minutes 22 Seconds East	103.9 feet
thence South 82 Degrees 47 Minutes 56 Seconds East	120.5 feet
thence South 72 Degrees 18 Minutes 31 Seconds East	116.9 feet
thence South 72 Degrees 20 Minutes 40 Seconds East	19 feet
thence South 70 Degrees 58 Minutes 26 Seconds East	131.8 feet
thence South 77 Degrees 28 Minutes 49 Seconds East	25 feet
thence South 77 Degrees 28 Minutes 20 Seconds East	100.6 feet
thence South 60 Degrees 24 Minutes 33 Seconds East	133.6 feet
thence South 57 Degrees 45 Minutes 07 Seconds East	147.6 feet

thence South 61 Degrees 35 Minutes 02 Seconds East 128.4 feet
thence South 60 Degrees 19 Minutes 27 Seconds East 115.6 feet
thence South 57 Degrees 52 Minutes 12 Seconds East 96 feet
thence South 42 Degrees 16 Minutes 43 Seconds East 70.2 feet
thence South 13 Degrees 36 Minutes 59 Seconds East 49.9 feet
thence South 00 Degrees 33 Minutes 43 Seconds West 107.6 feet
thence South 15 Degrees 19 Minutes 51 Seconds West 8.5 feet
thence South 24 Degrees 46 Minutes 20 Seconds West 34.1 feet
thence South 24 Degrees 44 Minutes 22 Seconds West 33.3 feet
thence South 27 Degrees 16 Minutes 14 Seconds West 24.8 feet more or less to **the ending**

point at: 37 degrees 28 minutes 25.24 seconds North Latitude and -109 degrees 49 minutes 05.91 seconds West Longitude, which can be converted to mapping accuracy State Plane Utah South Zone NAD 83 feet coordinates of X = 2,128,419.3 feet and Y = 10,140,734.6 feet.