

**Acknowledgment and  
Notice of Acknowledgment  
of Acceptance of R.S. 2477  
Right-of-Way Grant**

**THE STATE OF UTAH**

**TO ALL WHOM THESE PRESENTS SHALL COME, Greeting:**

**Know ye,** This is an Acknowledgment and Notice of Acknowledgment made under Utah Code Sections 72-5-309 through 310 inclusive, that the grant of the United States of America of “the right of way for the construction of highways over public lands, not reserved for public uses” under United States Revised Statutes 2477 (43 U.S.C. Section 932 (repealed October 21, 1976, with proviso recognizing the validity of rights-of-way already established)) was accepted for and on behalf of the State of Utah and its political subdivision San Juan County as it pertains to the highway located in San Juan County known as HAT FLAT ROAD; County Road Number: B2531; State Geographic Information Database (SGID) Road Identification Number: RD190259. Total road length is 2.52 miles more or less.

The reason for this Acknowledgment and Notice of Acknowledgment includes, but is not limited to, the fact that the road was constructed, mechanically, or by continuous use as a public highway for a period of at least ten years, over public lands not reserved for public uses, prior to the earlier of (a) the October 21, 1976 repeal of R.S. 2477 or (b) the date the servient estate was reserved for public uses.

This Acknowledgment and Notice of Acknowledgment applies only to the segments of the road that traverse land owned by the Bureau of Land Management, United States Department of the Interior, and does not apply to segments of the road that traverse land owned by any other person or entity. The State of Utah and its political subdivisions reserve the right to make further acknowledgments and notices of acknowledgment with regard to road segments that traverse land owned by other entities, including the United States of America, through one or more of its agencies.

A printed copy of a map showing the location of the road in said county is appended hereto as “Attachment 1,” a printed copy of representative photos of the road is appended hereto as “Attachment 2,” a printed copy of a description of the beginning and ending points of the entire road together with a list of Townships, Ranges and Sections that may be traversed by the road in said county is appended hereto as “Attachment 3,” and a printed copy of the Road Centerline Description Cover Page(s) is appended hereto as “Attachment 4.” The Appendices listed in “Attachment 4” that contain the actual road centerline descriptions are incorporated herein by reference. Affidavits provided by individuals familiar with the road are appended hereto as “Attachment 5.”

A printed copy of this Acknowledgment and Notice of Acknowledgment, together with its Attachments and Appendices, may be viewed and/or obtained at the office of the Utah State Archives.

An electronic copy of this Acknowledgment and Notice of Acknowledgment, together with its Attachments and Appendices, may be viewed and/or downloaded as read-only PDF (Portable Document Format) files via the

Internet at <http://recorded2477roads.utah.gov>.

The owner of the servient estate in the land underlying the road-segments subject to this Acknowledgment and Notice is believed to be the United States of America through one or more of its agencies. Any of such agencies or any other person with a servient ownership claim or a competing dominant estate right-of-way ownership claim, may file a petition in the State District Court for Salt Lake County for a decision regarding the correctness of this Acknowledgment. A claimant shall file a petition within sixty (60) days after receipt of this Notice.

**In Witness Whereof**, I, John Harja, the official designee of the Governor of the State of Utah, in conformity to the laws of the State (Utah Code Sections 72-5-308 through 310 inclusive), have caused this Acknowledgment and Notice of Acknowledgment to be made.

Signed by my hand in Salt Lake City, Utah, the 22<sup>nd</sup> day of MAY, 2008.

By the Governor's Designee

  
\_\_\_\_\_  
John Harja

**CERTIFICATION**

State of Utah                    )  
  : ss  
County of Salt Lake         )

I hereby certify that the signer of the foregoing document, John Harja, is personally known by me, has made a voluntary signature and taken an oath stating that he is the official designee of the Governor of the State of Utah and is authorized to sign this document on the Governor's behalf pursuant to Utah Code Section 72-5-309. He further vouched that, based upon information and belief, the facts alleged therein are true.

Dated this 22<sup>nd</sup> day of May, 2008.



  
\_\_\_\_\_  
Notary Public

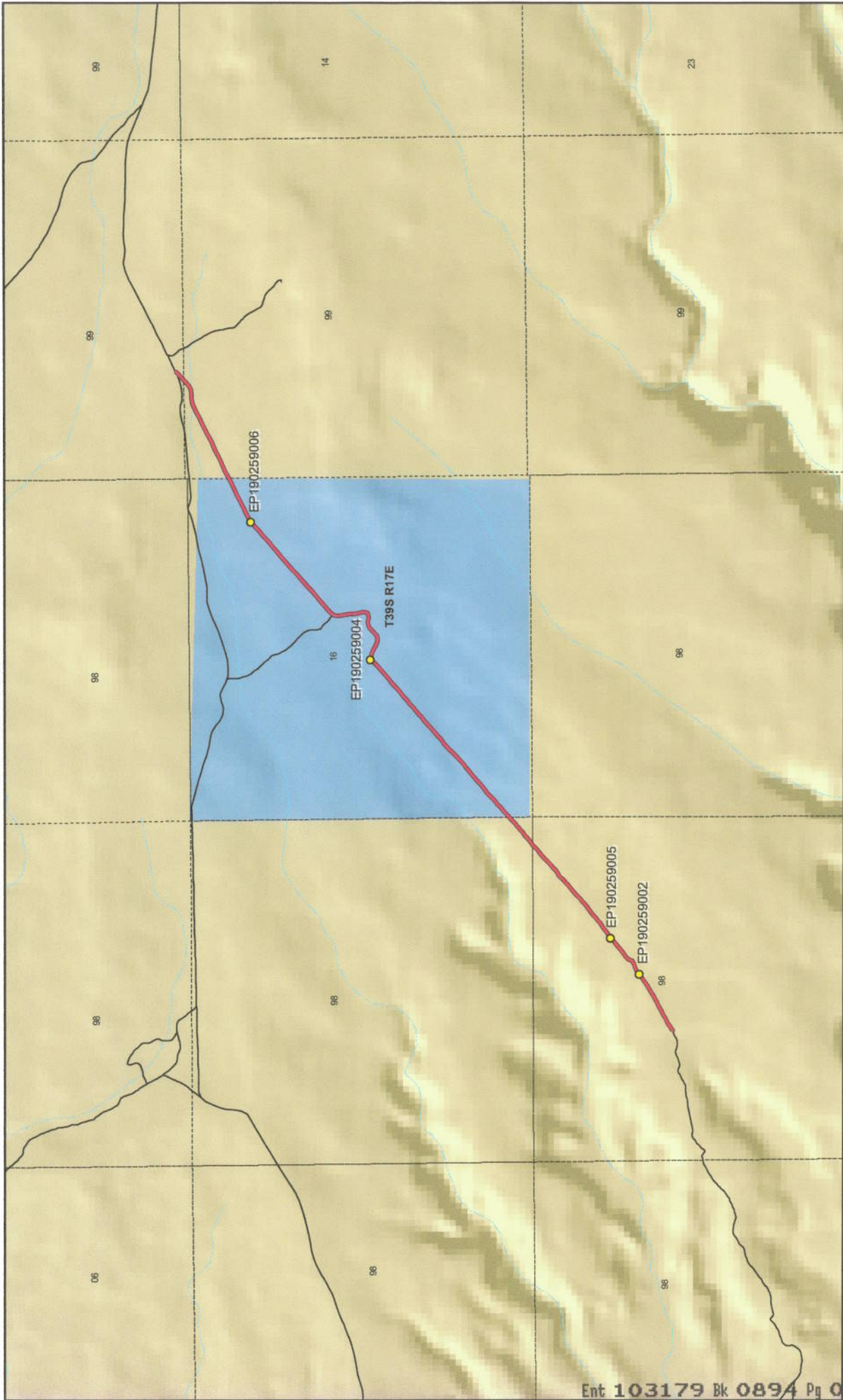

Ent 103179 Bk 0894 Pg 0536



1:24,626  
1 inch equals 0.4 miles

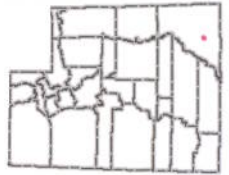

**HAT FLAT ROAD - San Juan County  
SGID RD\_ID RD190259**

- Land Ownership Categories**
- BLM
  - Private
  - SITLA, State Trust Land
  - USFS, National Forest
  - State Parks and Recreation
  - Tribal, Indian Reservation
  - NPS, National Park

- Wilderness**
- UDWR Wildlife Reserve
  - DOD, Military
  - State Sovereign Land
  - National Recreation Area
  - USFWS, Natl. Wildlife Refuge

- Transportation Network**
- HAT FLAT ROAD
  - Other Roads
  - Title V - Issued Or Under Consideration By BLM
  - Photo Event Point
  - Section = 1 Mile

Map prepared by the State of Utah  
Automated Geographic Reference Center  
Room 5130 State Office Building  
Salt Lake City, Utah 84114  
Apr 07, 2008

Attachment 2



EP190259002



EP190259004



EP190259005



EP190259006

EP000000000

EP000000000

**HAT FLAT ROAD - San Juan County**  
**SGID RD\_ID RD190259**

Map prepared by the State of Utah  
Automated Geographic Reference Center  
Room 5130 State Office Building  
Salt Lake City, Utah 84114  
April 11, 2008



## Attachment 3

### Beginning & Ending Points and Township, Range, and Section References For:

**Popular Name: HAT FLAT ROAD**

**County: San Juan**

**County Road Number: B2531**

**State Geographic Information Database (SGID) Road Identification Number: RD190259.**

**Total Road Length: 2.52 miles more or less.**

**Beginning at a point** on the road centerline located at 37 degrees 22 minutes 59.98 seconds North Latitude and -110 degrees 04 minutes 03.08 seconds West Longitude, which can be converted to mapping accuracy State Plane Utah South Zone NAD 83 feet coordinates of X = 2,056,610.5 feet and Y = 10,106,636.2 feet based on the US Survey Foot conversion.

**Ending at a point** on the road centerline located at 37 degrees 24 minutes 14.91 seconds North Latitude and -110 degrees 01 minutes 55.88 seconds West Longitude, which can be converted to mapping accuracy State Plane Utah South Zone NAD 83 feet coordinates of X = 2,066,756.9 feet and Y = 10,114,372.8 feet based on the US Survey Foot conversion.

This road may traverse:

Township 39 South Range 17 East, Section(s) 0n/a, Salt Lake Base & Meridian

Township 39 South Range 17 East, Section(s) 16, Salt Lake Base & Meridian

See Attachment 1 above for a cartographic depiction of the course of this road.

**Attachment 4  
Road Centerline Description Cover Page(s)**

**Popular Name: HAT FLAT ROAD**

**County: San Juan**

**County Road Number: B2531**

**State Geographic Information Database (SGID) Road Identification Number: RD190259.**

**Total Road Length: 2.52 miles more or less.**

**Centerline Descriptions Of Road-Segments That Cross Over Federally Owned Land, Derived From Global Positioning System Data And Cross-checked against USGS Digital Orthophoto Quadrangles Compiled By The Utah Automated Geographic Reference Center And Entered Into The State Geographic Information Database (SGID).**

<b>Road-Segments Listed by SGID Road Identification Number (RD_ID)</b>	<b>Road-Segment Numbers</b>	<b>Believed Ownership Of Servient Estate</b>	<b>Approximate Segment Length</b>	<b>See Attached Appendix</b>
<b>RD190259</b>	<b>001</b>	<b>BLM</b>	<b>0.79 Miles</b>	<b>A</b>
<b>RD190259</b>	<b>002</b>	<b>ST</b>	<b>1.38 Miles</b>	<b>(not shown)</b>
<b>RD190259</b>	<b>003</b>	<b>BLM</b>	<b>0.35 Miles</b>	<b>B</b>
		<b>Total Road Length</b>	<b>2.52</b>	<b>_____</b>

\* Indicates that a Title V permit will be requested, is in process, or has been issued.

† Indicates that road-segments crossing Forest Service land are under consideration by the state and county as of the date of this Acknowledgment and Notice of Acknowledgment.

## **Attachment 5**

**AFFIDAVIT OF KENNETH ROBERT CHRISTENSEN**

**HAT FLAT ROAD**

**SAN JUAN COUNTY, UTAH**

**COUNTY ROAD NUMBER B2531**

State of Utah                    )  
  : ss  
County of San Juan            )

Kenneth Robert Christensen, being first duly sworn, deposes and states as follows:

1. I am an adult competent to testify about the matters set forth below based upon my personal knowledge. I currently reside in San Juan County, Utah. I have lived in San Juan County since 1929.

2. I have traveled and am familiar with a road in San Juan County known as Hat Flat Road. I am also familiar with the land the road traverses. When I first used and observed the road in 1965, it followed the same route as in 1994, when I last observed it. Attached is a San Juan County map showing Hat Flat Road. To the best of my knowledge and based upon my use of and familiarity with this road and the land it traverses, the location and route of the road are correctly illustrated on the attached map.

3. I am informed that the County identifies this road according to the road number described above.

4. I have observed that the road has been open to the public for all to use, to come and go as they pleased, since at least as early as 1965 and continuing through 1976 to 1994. Throughout this time period I have observed travel on the road by various means, including: pickup, trailer, other truck, bulldozer and jeep. Throughout this time period, the road has been used weekly for more than 10 continuous years prior to 1976, and was used weekly in 1994.



5. Throughout the time period from 1965 to 1994, I have used the road myself for the following uses: range studies and range improvement with the BLM.

6. Throughout the time period described in the previous paragraph, I observed vehicles using the road at various times for the uses described in the previous paragraph, plus the following uses: hunting, wood gathering, recreation and livestock operations.

7. It is also the reputation in the community that this road has been open to the public for all to use, to come and go as they pleased, since at least as early as 1965 and continuing through 1976 to the present, for the uses described in the previous paragraphs.

8. I observed the following evidence of construction and maintenance performed on the road prior to 1976: I observed the graded surface of the road.

Dated this 18 day of September, 2007.

  
Kenneth Robert Christensen

SUBSCRIBED AND SWORN TO before me this 18th day of September, 2007.

  
Notary Public

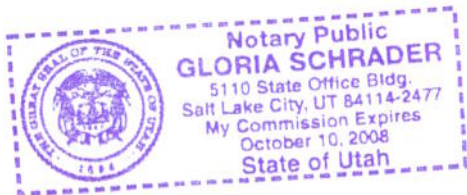

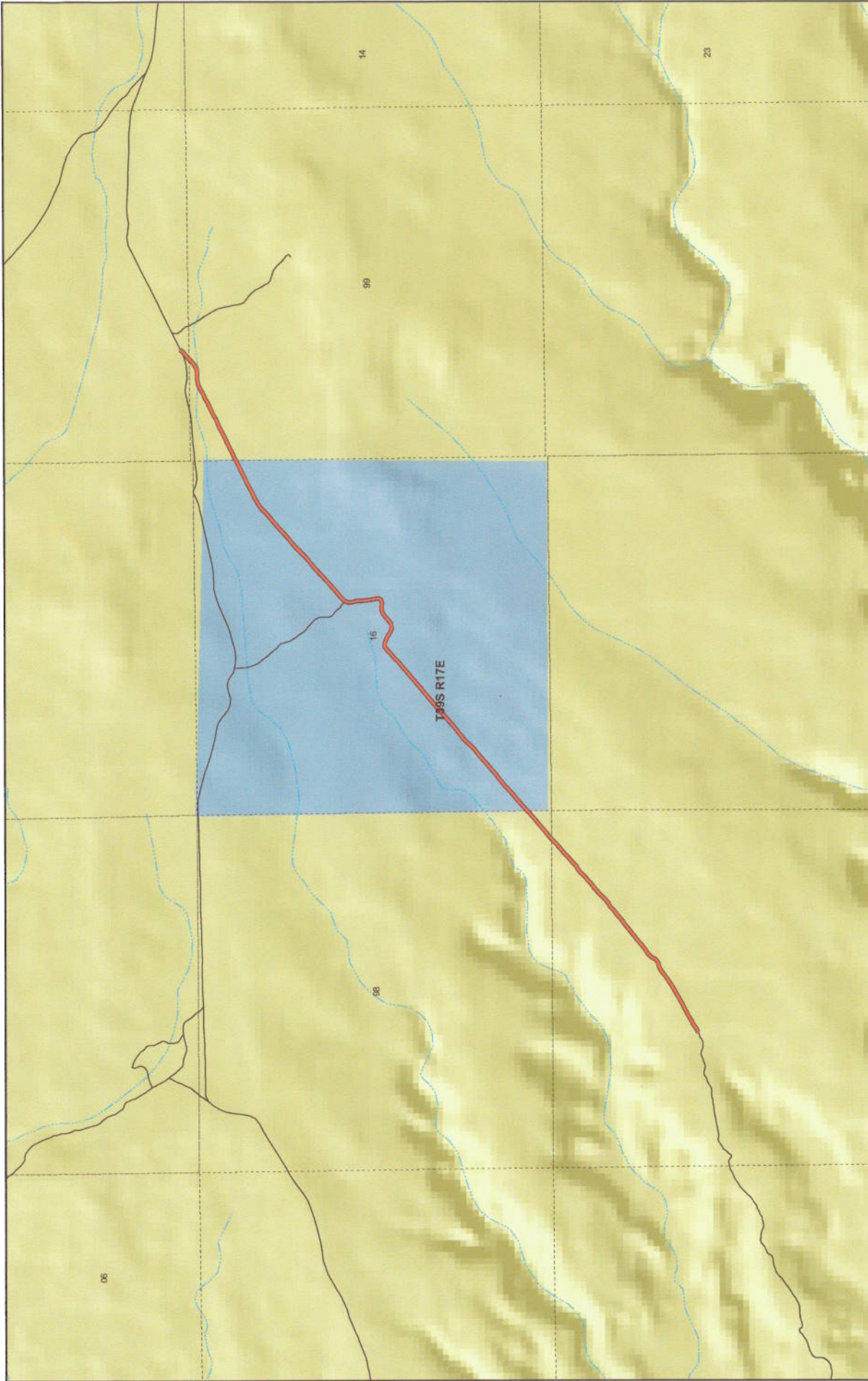

**HAT FLAT**  
**County Unique - B2531**

**Land Ownership Categories**

- BLM
- National Recreation Area
- SITLA, State Trust Land
- USFS, National Forest
- National Parks & Monuments (NPS)

**Misc**

- City / Town
- Municipalities
- Section = 1 Mile

**Transportation Network**

- HAT FLAT
- State / U.S. Highway
- Local Roads

1:23,494  
 1 inch equals 0.4 miles  
 JUN 26, 2007



**AFFIDAVIT OF ALBERT E. STEELE**

**HAT FLAT ROAD**

**SAN JUAN COUNTY, UTAH**

**COUNTY ROAD NUMBER B2531**

State of Utah                    )  
  : ss  
County of San Juan            )

Albert E. Steele, being first duly sworn, deposes and states as follows:

1. I am an adult competent to testify about the matters set forth below based upon my personal knowledge. I currently reside in San Juan County, Utah. I have lived in San Juan County for 60 years.

2. I have traveled and am familiar with a road in San Juan County known as Hat Flat Road. I am also familiar with the land the road traverses. When I first used and observed the road in 1960, it followed the same route as in 2007, when I last observed it. Attached is a San Juan County map showing Hat Flat Road. To the best of my knowledge and based upon my use of and familiarity with this road and the land it traverses, the location and route of the road are correctly illustrated on the attached map.

3. I am informed that the County identifies this road according to the road number described above.

4. I have observed that the road has been open to the public for all to use, to come and go as they pleased, since at least as early as 1960 and continuing through 1976 to 2007. Throughout this time period I have observed travel on the road by various means, including: pickup, automobile, other truck, and jeep. Throughout this time period, the road was used weekly for more than 10 continuous years prior to 1976 and was used weekly in 2007.

5. Throughout the time period from 1960 to 2007, I have used the road myself for the following uses: predator control and recreation.

6. Throughout the time period described in the previous paragraph, I observed vehicles using the road at various times for the uses described in the previous paragraph, plus the following uses: livestock operations, hunting, tourism, archeology, mineral prospecting, oil and gas exploration, and traveling in and through the area.

7. It is also the reputation in the community that this road has been open to the public for all to use, to come and go as they pleased, since at least as early as the early 1950s and continuing through 1976 to the present, for the uses described in the previous paragraphs.

8. I observed the graded surface prior to 1976.

Dated this 15<sup>th</sup> day of September, 2007.

Albert E. Steele  
Albert E. Steele

SUBSCRIBED AND SWORN TO before me this 18<sup>th</sup> day of September, 2007.

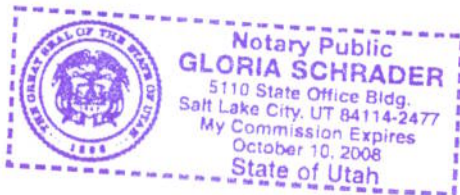

Gloria Schrader  
Notary Public

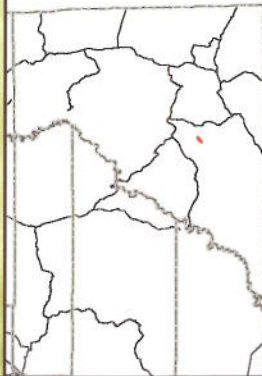
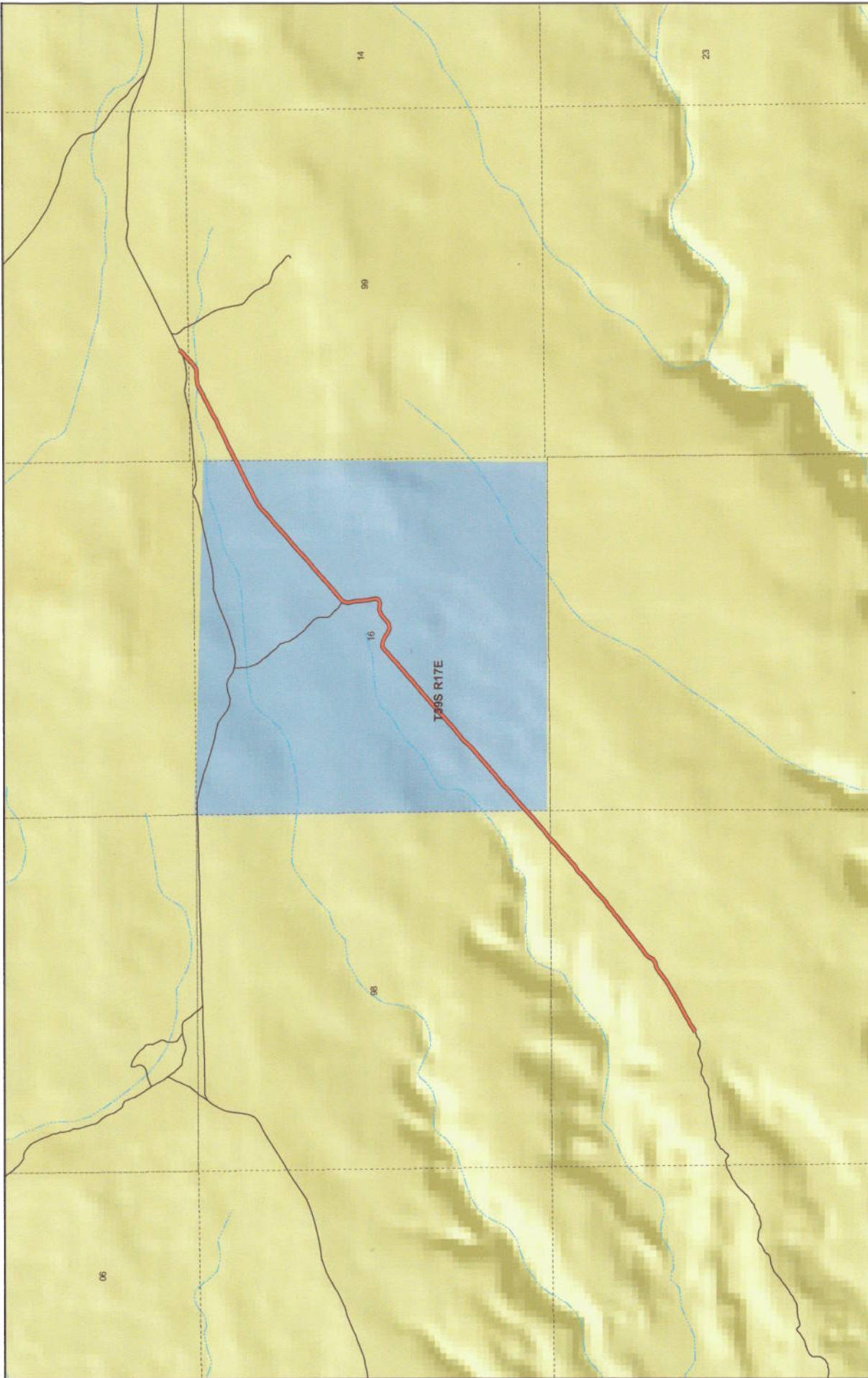

**HAT FLAT**  
**County Unique - B2531**

- Land Ownership Categories**
- BLM
  - National Recreation Area
  - SITLA, State Trust Land
  - USFS, National Forest
  - National Parks & Monuments (NPS)

- Misc**
- Private
  - Wilderness
  - State Park
  - Tribal Lands
  - City / Town
  - Municipalities
  - Section = 1 Mile

- Transportation Network**
- HAT FLAT
  - State / U.S. Highway
  - Local Roads



1:23,494  
 1 inch equals 0.4 miles  
 Jul 26, 2007

Appendix A to Attachment 4

**Popular Name: HAT FLAT ROAD**

**County: San Juan**

**County Road Number: B2531**

**State Geographic Information Database (SGID) Road Identification Number: RD190259.**

**Road-Segment Number: 001**

**Road-Segment Length: 0.79 miles more or less.**

**Believed owner of the land underlying this road-segment is: Bureau of Land Management.**

*The following description is based upon the geographic coordinate system using the NAD83 Datum. The source is GPS mapping grade data as indicated in the metadata and/or the transportation data model of the State of Utah Geographic Information Database (SGID).*

The road-segment itself is the monument that is identified by its physical presence on the land. The location of said physical presence is closely approximated by mapping grade Global Positioning System (GPS) data. Said data are checked against the corresponding gray-scale 1-meter Digital Orthophoto Quadrangles published by the United States Geological Survey (USGS) to verify a reasonable degree of accuracy. In circumstances where accurate satellite signal acquisition is not possible, such as deep, narrow canyons or under a canopy of dense foliage, or where very sharp curves in the road make accuracy questionable, such portions of the road were digitized from the corresponding gray-scale 1-meter Digital Orthophoto Quadrangles published by the United States Geological Survey (USGS).

This road-segment may traverse:

Township 39 South Range 17 East, Section(s) 0n/a, Salt Lake Base & Meridian

The following description closely approximates the location of the centerline of the physical monument (HAT FLAT ROAD)-- Segment 001 based on mapping grade Global Positioning System (GPS) data as defined above:

**Beginning at a point** on the road center line located at 37 degrees 22 minutes 59.98 seconds North Latitude and -110 degrees 04 minutes 03.08 seconds West Longitude, which can be converted to mapping accuracy State Plane Utah South Zone NAD 83 feet coordinates of X = 2,056,610.5 feet and Y = 10,106,636.2 feet; thence the following courses along the said road center line:

thence North 63 Degrees 07 Minutes 24 Seconds East 4.4 feet  
thence North 62 Degrees 12 Minutes 50 Seconds East 9.2 feet  
thence North 62 Degrees 40 Minutes 33 Seconds East 18.8 feet  
thence North 59 Degrees 56 Minutes 37 Seconds East 23.8 feet  
thence North 56 Degrees 10 Minutes 39 Seconds East 29.1 feet  
thence North 56 Degrees 08 Minutes 32 Seconds East 36.2 feet  
thence North 58 Degrees 14 Minutes 11 Seconds East 39.6 feet  
thence North 59 Degrees 23 Minutes 48 Seconds East 38.4 feet  
thence North 57 Degrees 04 Minutes 09 Seconds East 39 feet  
thence North 57 Degrees 00 Minutes 58 Seconds East 35.9 feet  
thence North 61 Degrees 42 Minutes 32 Seconds East 35.7 feet  
thence North 65 Degrees 55 Minutes 28 Seconds East 48 feet

thence North 60 Degrees 04 Minutes 37 Seconds East 52.5 feet  
 thence North 62 Degrees 16 Minutes 51 Seconds East 49.9 feet  
 thence North 61 Degrees 48 Minutes 37 Seconds East 51.2 feet  
 thence North 61 Degrees 14 Minutes 44 Seconds East 53.7 feet  
 thence North 62 Degrees 05 Minutes 52 Seconds East 57.4 feet  
 thence North 57 Degrees 53 Minutes 40 Seconds East 66 feet  
 thence North 60 Degrees 48 Minutes 06 Seconds East 76.1 feet  
 thence North 55 Degrees 52 Minutes 26 Seconds East 83.7 feet  
 thence North 54 Degrees 20 Minutes 11 Seconds East 94.2 feet  
 thence North 52 Degrees 39 Minutes 42 Seconds East 71.9 feet  
 thence North 56 Degrees 22 Minutes 40 Seconds East 13.7 feet  
 thence North 51 Degrees 31 Minutes 52 Seconds East 5.8 feet  
 thence North 51 Degrees 41 Minutes 23 Seconds East 40 feet  
 thence North 61 Degrees 19 Minutes 29 Seconds East 60.8 feet  
 thence North 74 Degrees 39 Minutes 47 Seconds East 64.6 feet  
 thence North 53 Degrees 46 Minutes 43 Seconds East 58.8 feet  
 thence North 27 Degrees 10 Minutes 24 Seconds East 64 feet  
 thence North 42 Degrees 44 Minutes 36 Seconds East 61.5 feet  
 thence North 53 Degrees 36 Minutes 45 Seconds East 56.8 feet  
 thence North 52 Degrees 27 Minutes 13 Seconds East 61.8 feet  
 thence North 52 Degrees 52 Minutes 20 Seconds East 70.1 feet  
 thence North 51 Degrees 08 Minutes 50 Seconds East 74.3 feet  
 thence North 50 Degrees 08 Minutes 45 Seconds East 73.2 feet  
 thence North 52 Degrees 02 Minutes 04 Seconds East 67.2 feet  
 thence North 51 Degrees 45 Minutes 43 Seconds East 64.1 feet  
 thence North 51 Degrees 47 Minutes 06 Seconds East 58.2 feet  
 thence North 51 Degrees 35 Minutes 59 Seconds East 46.3 feet  
 thence North 54 Degrees 23 Minutes 20 Seconds East 55.1 feet  
 thence North 52 Degrees 07 Minutes 11 Seconds East 43.1 feet  
 thence North 45 Degrees 48 Minutes 42 Seconds East 35.5 feet  
 thence North 51 Degrees 20 Minutes 01 Seconds East 48.1 feet  
 thence North 53 Degrees 15 Minutes 27 Seconds East 51.4 feet  
 thence North 46 Degrees 20 Minutes 18 Seconds East 56.4 feet  
 thence North 50 Degrees 48 Minutes 14 Seconds East 52.3 feet  
 thence North 58 Degrees 20 Minutes 08 Seconds East 58 feet  
 thence North 51 Degrees 57 Minutes 48 Seconds East 66 feet  
 thence North 47 Degrees 50 Minutes 00 Seconds East 63.4 feet  
 thence North 46 Degrees 51 Minutes 47 Seconds East 18.3 feet  
 thence North 43 Degrees 55 Minutes 52 Seconds East 52.7 feet  
 thence North 43 Degrees 52 Minutes 33 Seconds East 65.4 feet  
 thence North 50 Degrees 32 Minutes 21 Seconds East 66 feet  
 thence North 53 Degrees 22 Minutes 08 Seconds East 61.5 feet  
 thence North 51 Degrees 04 Minutes 44 Seconds East 58.4 feet  
 thence North 44 Degrees 13 Minutes 08 Seconds East 56.6 feet  
 thence North 52 Degrees 07 Minutes 11 Seconds East 48.4 feet  
 thence North 36 Degrees 11 Minutes 23 Seconds East 40.8 feet  
 thence North 44 Degrees 59 Minutes 07 Seconds East 44.8 feet  
 thence North 59 Degrees 12 Minutes 10 Seconds East 47.2 feet  
 thence North 60 Degrees 52 Minutes 39 Seconds East 52.4 feet

thence North 43 Degrees 47 Minutes 10 Seconds East 58.9 feet  
 thence North 46 Degrees 48 Minutes 34 Seconds East 62.7 feet  
 thence North 48 Degrees 39 Minutes 39 Seconds East 67 feet  
 thence North 47 Degrees 58 Minutes 09 Seconds East 73 feet  
 thence North 47 Degrees 42 Minutes 04 Seconds East 83.9 feet  
 thence North 50 Degrees 51 Minutes 45 Seconds East 88.5 feet  
 thence North 44 Degrees 59 Minutes 30 Seconds East 87.7 feet  
 thence North 47 Degrees 24 Minutes 03 Seconds East 18.1 feet  
 thence North 47 Degrees 22 Minutes 38 Seconds East 60.8 feet  
 thence North 50 Degrees 54 Minutes 15 Seconds East 70.7 feet  
 thence North 51 Degrees 18 Minutes 07 Seconds East 64.5 feet  
 thence North 50 Degrees 10 Minutes 28 Seconds East 41.3 feet  
 thence North 45 Degrees 11 Minutes 44 Seconds East 26.2 feet  
 thence North 48 Degrees 32 Minutes 57 Seconds East 37.9 feet  
 thence North 50 Degrees 11 Minutes 50 Seconds East 45.9 feet  
 thence North 49 Degrees 23 Minutes 00 Seconds East 48.2 feet  
 thence North 49 Degrees 35 Minutes 15 Seconds East 8.2 feet  
 thence North 45 Degrees 42 Minutes 41 Seconds East 26 feet  
 thence North 48 Degrees 34 Minutes 35 Seconds East 24 feet  
 thence North 47 Degrees 34 Minutes 47 Seconds East 69 feet

thence North 47 Degrees 49 Minutes 34 Seconds East 12.3 feet more or less to **the ending point at:** 37 degrees 23 minutes 024.6 seconds North Latitude and -110 degrees 03 minutes 22.06 seconds West Longitude, which can be converted to mapping accuracy State Plane Utah South Zone NAD 83 feet coordinates of X = 2,059,882.4 feet and Y = 10,109,176.7 feet.



**Appendix B to Attachment 4**

**Popular Name: HAT FLAT ROAD**

**County: San Juan**

**County Road Number: B2531**

**State Geographic Information Database (SGID) Road Identification Number: RD190259.**

**Road-Segment Number: 003**

**Road-Segment Length: 0.35 miles more or less.**

**Believed owner of the land underlying this road-segment is: Bureau of Land Management.**

*The following description is based upon the geographic coordinate system using the NAD83 Datum. The source is GPS mapping grade data as indicated in the metadata and/or the transportation data model of the State of Utah Geographic Information Database (SGID).*

The road-segment itself is the monument that is identified by its physical presence on the land. The location of said physical presence is closely approximated by mapping grade Global Positioning System (GPS) data. Said data are checked against the corresponding gray-scale 1-meter Digital Orthophoto Quadrangles published by the United States Geological Survey (USGS) to verify a reasonable degree of accuracy. In circumstances where accurate satellite signal acquisition is not possible, such as deep, narrow canyons or under a canopy of dense foliage, or where very sharp curves in the road make accuracy questionable, such portions of the road were digitized from the corresponding gray-scale 1-meter Digital Orthophoto Quadrangles published by the United States Geological Survey (USGS).

This road-segment may traverse:

Township 39 South Range 17 East, Section(s) 0n/a, Salt Lake Base & Meridian

The following description closely approximates the location of the centerline of the physical monument (HAT FLAT ROAD)-- Segment 003 based on mapping grade Global Positioning System (GPS) data as defined above:

**Beginning at a point** on the road center line located at 37 degrees 24 minutes 06.89 seconds North Latitude and -110 degrees 02 minutes 16.35 seconds West Longitude, which can be converted to mapping accuracy State Plane Utah South Zone NAD 83 feet coordinates of X = 2,065,118.0 feet and Y = 10,113,536.1 feet; thence the following courses along the said road center line:

thence North 63 Degrees 23 Minutes 25 Seconds East 28.4 feet  
thence North 63 Degrees 12 Minutes 53 Seconds East 92 feet  
thence North 62 Degrees 21 Minutes 06 Seconds East 43.6 feet  
thence North 63 Degrees 43 Minutes 28 Seconds East 42 feet  
thence North 63 Degrees 28 Minutes 25 Seconds East 72.1 feet  
thence North 64 Degrees 12 Minutes 22 Seconds East 85.4 feet  
thence North 62 Degrees 13 Minutes 42 Seconds East 93.9 feet  
thence North 65 Degrees 07 Minutes 17 Seconds East 88.4 feet  
thence North 66 Degrees 46 Minutes 58 Seconds East 75.9 feet  
thence North 62 Degrees 58 Minutes 19 Seconds East 55.5 feet  
thence North 58 Degrees 32 Minutes 24 Seconds East 34.9 feet  
thence North 59 Degrees 46 Minutes 57 Seconds East 57.9 feet

thence North 61 Degrees 56 Minutes 37 Seconds East 64.1 feet  
thence North 62 Degrees 59 Minutes 11 Seconds East 61.3 feet  
thence North 64 Degrees 33 Minutes 20 Seconds East 58.7 feet  
thence North 63 Degrees 07 Minutes 24 Seconds East 64.6 feet  
thence North 62 Degrees 53 Minutes 41 Seconds East 73.5 feet  
thence North 62 Degrees 12 Minutes 51 Seconds East 83.2 feet  
thence North 64 Degrees 33 Minutes 20 Seconds East 88.1 feet  
thence North 80 Degrees 05 Minutes 00 Seconds East 86.5 feet  
thence North 89 Degrees 26 Minutes 29 Seconds East 76.1 feet  
thence North 84 Degrees 50 Minutes 07 Seconds East 69.8 feet  
thence North 58 Degrees 17 Minutes 54 Seconds East 68 feet  
thence North 47 Degrees 19 Minutes 15 Seconds East 80.8 feet  
thence North 46 Degrees 58 Minutes 22 Seconds East 34.3 feet  
thence North 47 Degrees 01 Minutes 27 Seconds East 51.8 feet  
thence North 48 Degrees 09 Minutes 44 Seconds East 72.8 feet  
thence North 43 Degrees 05 Minutes 10 Seconds East 66.4 feet more or less to **the ending**

**point at:** 37 degrees 24 minutes 14.91 seconds North Latitude and -110 degrees 01 minutes 55.88 seconds West Longitude, which can be converted to mapping accuracy State Plane Utah South Zone NAD 83 feet coordinates of X = 2,066,756.9 feet and Y = 10,114,372.8 feet.