

**Acknowledgment and  
Notice of Acknowledgment  
of Acceptance of R.S. 2477  
Right-of-Way Grant**

Ent 103181 Bk 894 Pg 560 -572  
Date: 29-MAY-2008 4:32PM  
Fee: None  
Filed By: LCJ  
LOUISE JONES, Recorder  
SAN JUAN COUNTY CORPORATION  
For: GOVERNOR STATE OF UTAH

**THE STATE OF UTAH**

**TO ALL WHOM THESE PRESENTS SHALL COME, Greeting:**

**Know ye,** This is an Acknowledgment and Notice of Acknowledgment made under Utah Code Sections 72-5-309 through 310 inclusive, that the grant of the United States of America of “the right of way for the construction of highways over public lands, not reserved for public uses” under United States Revised Statutes 2477 (43 U.S.C. Section 932 (repealed October 21, 1976, with proviso recognizing the validity of rights-of-way already established)) was accepted for and on behalf of the State of Utah and its political subdivision San Juan County as it pertains to the highway located in San Juan County known as HOLE IN THE ROCK ROAD; County Road Number: B2541; State Geographic Information Database (SGID) Road Identification Number: RD190261. Total road length is 2.2 miles more or less.

The reason for this Acknowledgment and Notice of Acknowledgment includes, but is not limited to, the fact that the road was constructed, mechanically, or by continuous use as a public highway for a period of at least ten years, over public lands not reserved for public uses, prior to the earlier of (a) the October 21, 1976 repeal of R.S. 2477 or (b) the date the servient estate was reserved for public uses.

This Acknowledgment and Notice of Acknowledgment applies only to the segments of the road that traverse land owned by the Bureau of Land Management, United States Department of the Interior, and does not apply to segments of the road that traverse land owned by any other person or entity. The State of Utah and its political subdivisions reserve the right to make further acknowledgments and notices of acknowledgment with regard to road segments that traverse land owned by other entities, including the United States of America, through one or more of its agencies.

A printed copy of a map showing the location of the road in said county is appended hereto as “Attachment 1,” a printed copy of representative photos of the road is appended hereto as “Attachment 2,” a printed copy of a description of the beginning and ending points of the entire road together with a list of Townships, Ranges and Sections that may be traversed by the road in said county is appended hereto as “Attachment 3,” and a printed copy of the Road Centerline Description Cover Page(s) is appended hereto as “Attachment 4.” The Appendices listed in “Attachment 4” that contain the actual road centerline descriptions are incorporated herein by reference. Affidavits provided by individuals familiar with the road are appended hereto as “Attachment 5.”

A printed copy of this Acknowledgment and Notice of Acknowledgment, together with its Attachments and Appendices, may be viewed and/or obtained at the office of the Utah State Archives.

An electronic copy of this Acknowledgment and Notice of Acknowledgment, together with its Attachments and Appendices, may be viewed and/or downloaded as read-only PDF (Portable Document Format) files via the

Internet at <http://recorded2477roads.utah.gov>.

The owner of the servient estate in the land underlying the road-segments subject to this Acknowledgment and Notice is believed to be the United States of America through one or more of its agencies. Any of such agencies or any other person with a servient ownership claim or a competing dominant estate right-of-way ownership claim, may file a petition in the State District Court for Salt Lake County for a decision regarding the correctness of this Acknowledgment. A claimant shall file a petition within sixty (60) days after receipt of this Notice.

**In Witness Whereof**, I, John Harja, the official designee of the Governor of the State of Utah, in conformity to the laws of the State (Utah Code Sections 72-5-308 through 310 inclusive), have caused this Acknowledgment and Notice of Acknowledgment to be made.

Signed by my hand in Salt Lake City, Utah, the 22<sup>nd</sup> day of May, 2008.

By the Governor's Designee

  
\_\_\_\_\_  
John Harja

**CERTIFICATION**

State of Utah                    )  
  : ss  
County of Salt Lake         )

I hereby certify that the signer of the foregoing document, John Harja, is personally known by me, has made a voluntary signature and taken an oath stating that he is the official designee of the Governor of the State of Utah and is authorized to sign this document on the Governor's behalf pursuant to Utah Code Section 72-5-309. He further vouched that, based upon information and belief, the facts alleged therein are true.

Dated this 22<sup>nd</sup> day of May, 2008.

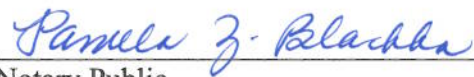

  
\_\_\_\_\_  
Notary Public

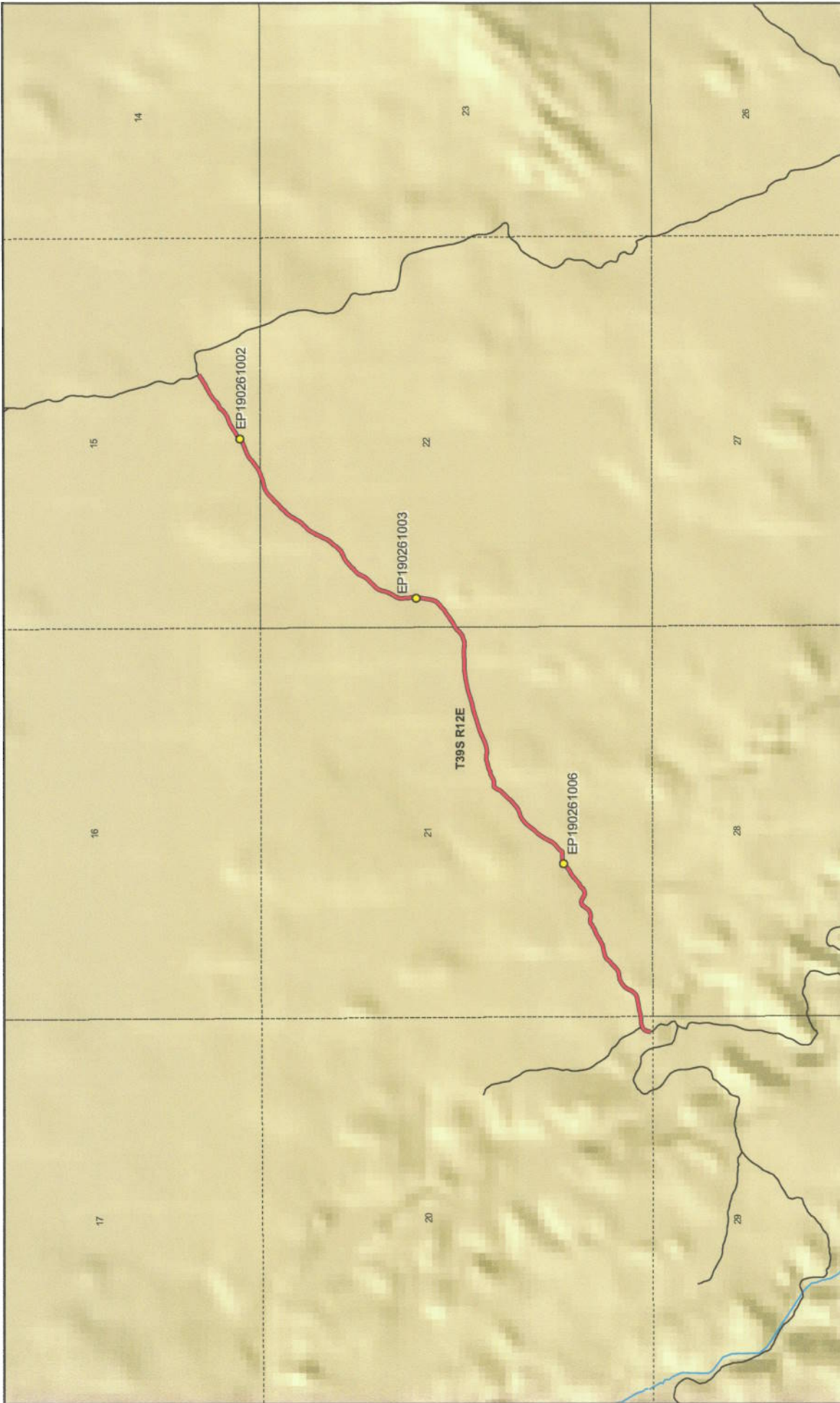

Map prepared by the State of Utah  
Automated Geographic Reference Center  
Room 5130 State Office Building  
Salt Lake City, Utah 84114  
Apr 07, 2008

### HOLE IN THE ROCK ROAD - San Juan County

#### SGID RD\_ID RD190261

**Land Ownership Categories**

- BLM
- Private
- SITLA, State Trust Land
- USFS, National Forest
- State Parks and Recreation
- Tribal, Indian Reservation
- NPS, National Park

**Transportation Network**

- HOLE IN THE ROCK ROAD
- Other Roads
- Title V: Issued Or Under Consideration By BLM Or County
- Photo Event Point
- Section = 1 Mile

**Wilderness**

- UDWR Wildlife Reserve
- DOD, Military
- State Sovereign Land
- National Recreation Area
- USFWS, Natl. Wildlife Refuge

1:21,628  
1 inch equals 0.3 miles

Attachment 2



EP190261002



EP190261003



EP190261006

EP000000000

EP000000000

EP000000000

**HOLE IN THE ROCK ROAD - San Juan County**  
**SGID RD\_ID RD190261**

Map prepared by the State of Utah  
Automated Geographic Reference Center  
Room 5130 State Office Building  
Salt Lake City, Utah 84114  
April 11, 2008



## Attachment 3

### Beginning & Ending Points and Township, Range, and Section References For:

**Popular Name: HOLE IN THE ROCK ROAD**

**County: San Juan**

**County Road Number: B2541**

**State Geographic Information Database (SGID) Road Identification Number: RD190261.**

**Total Road Length: 2.2 miles more or less.**

**Beginning at a point** on the road centerline located at 37 degrees 22 minutes 29.54 seconds North Latitude and -110 degrees 36 minutes 7.6 seconds West Longitude, which can be converted to mapping accuracy State Plane Utah South Zone NAD 83 feet coordinates of X = 1,901,326.4 feet and Y = 10,101,621.8 feet based on the US Survey Foot conversion.

**Ending at a point** on the road centerline located at 37 degrees 23 minutes 29.54 seconds North Latitude and -110 degrees 34 minutes 17.17 seconds West Longitude, which can be converted to mapping accuracy State Plane Utah South Zone NAD 83 feet coordinates of X = 1,910,179.1 feet and Y = 10,107,777.1 feet based on the US Survey Foot conversion.

This road may traverse:

Township 39 South Range 12 East, Section(s) 15,20,21,22, Salt Lake Base & Meridian  
See Attachment 1 above for a cartographic depiction of the course of this road.

**Attachment 4  
Road Centerline Description Cover Page(s)**

**Popular Name: HOLE IN THE ROCK ROAD**

**County: San Juan**

**County Road Number: B2541**

**State Geographic Information Database (SGID) Road Identification Number: RD190261.**

**Total Road Length: 2.2 miles more or less.**

**Centerline Descriptions Of Road-Segments That Cross Over Federally Owned Land, Derived From Global Positioning System Data And Cross-checked against USGS Digital Orthophoto Quadrangles Compiled By The Utah Automated Geographic Reference Center And Entered Into The State Geographic Information Database (SGID).**

<b>Road-Segments Listed by SGID Road Identification Number (RD_ID)</b>	<b>Road-Segment Numbers</b>	<b>Believed Ownership Of Servient Estate</b>	<b>Approximate Segment Length</b>	<b>See Attached Appendix</b>
<b>RD190261</b>	<b>001</b>	<b>BLM</b>	<b>2.2 Miles</b>	<b>A</b>
		<b>Total Road Length</b>	<b>2.2</b>	<b>_____</b>

\* Indicates that a Title V permit will be requested, is in process, or has been issued.

† Indicates that road-segments crossing Forest Service land are under consideration by the state and county as of the date of this Acknowledgment and Notice of Acknowledgment.

## Attachment 5

**AFFIDAVIT OF ALBERT E. STEELE**

**HOLE IN THE ROCK ROAD**

**SAN JUAN COUNTY, UTAH**

**COUNTY ROAD NUMBER B2541**

State of Utah                    )  
  : ss  
County of San Juan            )

Albert E. Steele, being first duly sworn, deposes and states as follows:

1. I am an adult competent to testify about the matters set forth below based upon my personal knowledge. I currently reside in San Juan County, Utah. I have lived in San Juan County for 60 years.

2. I have traveled and am familiar with a road in San Juan County known as Hole in the Rock Road. I am also familiar with the land the road traverses. When I first used and observed the road in 1960, it followed the same route as in 2002, when I last observed it. Attached is a San Juan County map showing Hole in the Rock Road. To the best of my knowledge and based upon my use of and familiarity with this road and the land it traverses, the location and route of the road are correctly illustrated on the attached map.

3. I am informed that the County identifies this road according to the road number described above.

4. I have observed that the road has been open to the public for all to use, to come and go as they pleased, since at least as early as 1960 and continuing through 1976 to 2002. Throughout this time period I have observed travel on the road by various means, including: pickup, automobile, other truck, and jeep. Throughout this time period, the road was used daily for more than 10 continuous years prior to 1976 and was used daily in 2002.



5. Throughout the time period from 1960 to 2002, I have used the road myself for the following uses: predator control and recreation.

6. Throughout the time period described in the previous paragraph, I observed vehicles using the road at various times for the uses described in the previous paragraph, plus the following uses: livestock operations, hunting, tourism, archeology, mineral prospecting, oil and gas exploration, and traveling in and through the area.

7. It is also the reputation in the community that this road has been open to the public for all to use, to come and go as they pleased, since at least as early as the early 1950s and continuing through 1976 to the present, for the uses described in the previous paragraphs.

8. I observed the graded surface prior to 1976.

Dated this 18<sup>th</sup> day of September, 2007.

*Albert E. Steele*

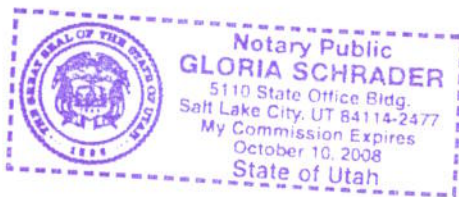

Albert E. Steele

SUBSCRIBED AND SWORN TO before me this 18<sup>th</sup> day of September, 2007.

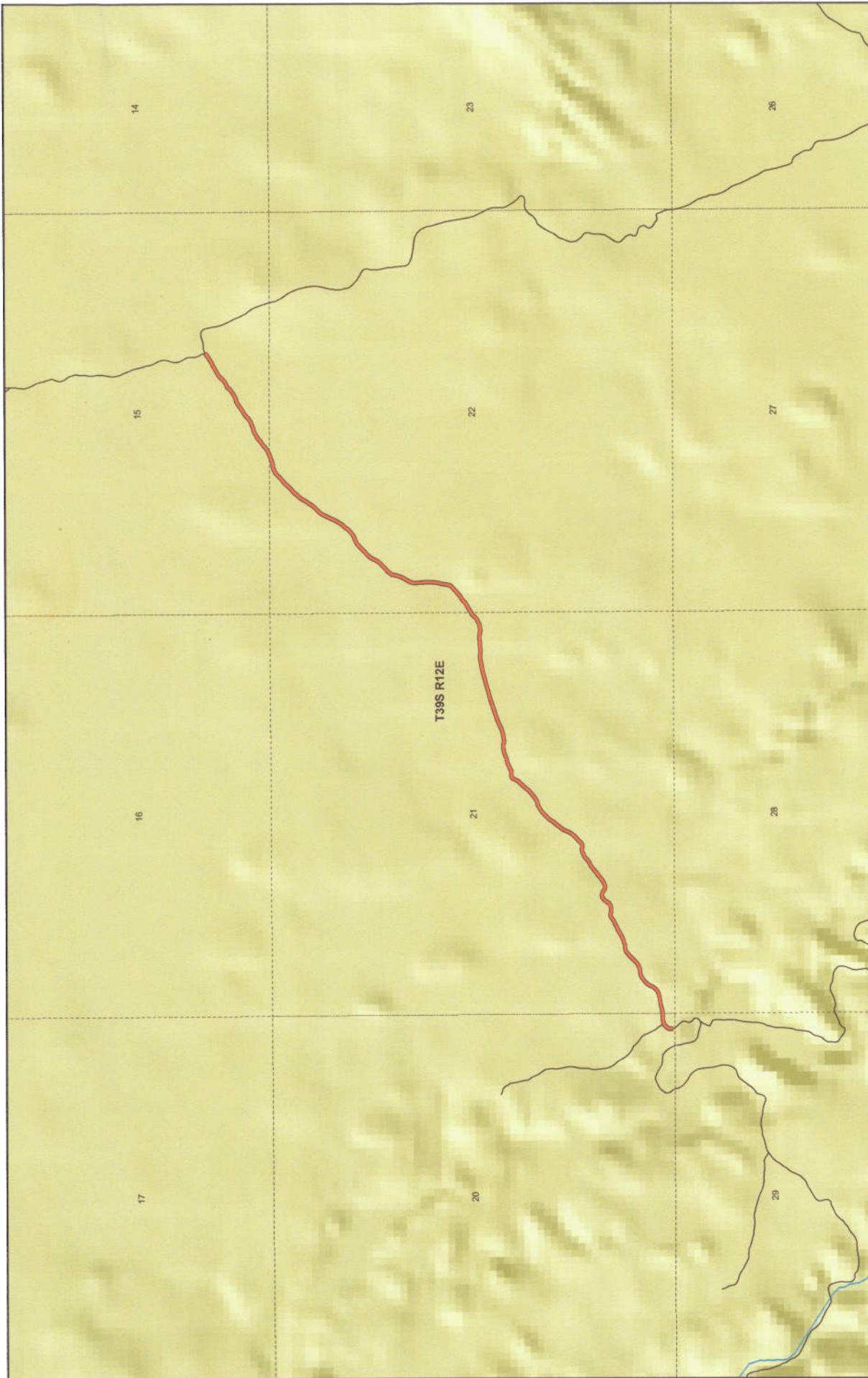

*Gloria Schrader*

Notary Public

1:20,630  
1 inch equals 0.3 miles  
JUL 26, 2007

### HOLE IN THE ROCK County Unique - B2541

**Land Ownership Categories**

- BLM
- National Recreation Area
- SITLA, State Trust Land
- USFS, National Forest
- National Parks & Monuments (NPS)

**Misc**

- City / Town
- Municipalities
- Section = 1 Mile

**Transportation Network**

- HOLE IN THE ROCK
- State / U.S. Highway
- Local Roads



**AFFIDAVIT OF KENNETH ROBERT CHRISTENSEN**

**HOLE IN THE ROCK ROAD**

**SAN JUAN COUNTY, UTAH**

**COUNTY ROAD NUMBER B2541**

State of Utah                    )  
  : ss  
County of San Juan            )

Kenneth Robert Christensen, being first duly sworn, deposes and states as follows:

1. I am an adult competent to testify about the matters set forth below based upon my personal knowledge. I currently reside in San Juan County, Utah. I have lived in San Juan County since 1929.

2. I have traveled and am familiar with a road in San Juan County known as Hole in the Rock Road. I am also familiar with the land the road traverses. When I first used and observed the road in the early 1960s, it followed the same route as in 1994, when I last observed it. Attached is a San Juan County map showing Hole in the Rock Road. To the best of my knowledge and based upon my use of and familiarity with this road and the land it traverses, the location and route of the road are correctly illustrated on the attached map.

3. I am informed that the County identifies this road according to the road number described above.

4. I have observed that the road has been open to the public for all to use, to come and go as they pleased, since at least as early as the early 1960s and continuing through 1976 to 1994. Throughout this time period I have observed travel on the road by various means, including: pickup, horse and jeep. Throughout this time period, the road has been used seasonally for more than 10 continuous years prior to 1976, and was used daily in 1994.

5. Throughout the time period from the early 1960s to 1994, I have used the road myself for the following uses: range studies with the BLM, sight-seeing and recreation.

6. Throughout the time period described in the previous paragraph, I observed vehicles using the road at various times for the uses described in the previous paragraph, plus the following uses: livestock operations.

7. It is also the reputation in the community that this road has been open to the public for all to use, to come and go as they pleased, since at least as early as the early 1960s and continuing through 1976 to the present, for the uses described in the previous paragraphs.

8. I observed the following evidence of construction and maintenance performed on the road prior to 1976: I observed the graded surface of the road.

Dated this 18 day of September, 2007

  
Kenneth Robert Christensen

SUBSCRIBED AND SWORN TO before me this 18th day of September, 2007.

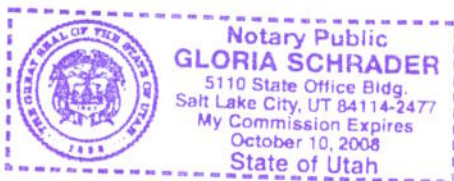

  
Notary Public

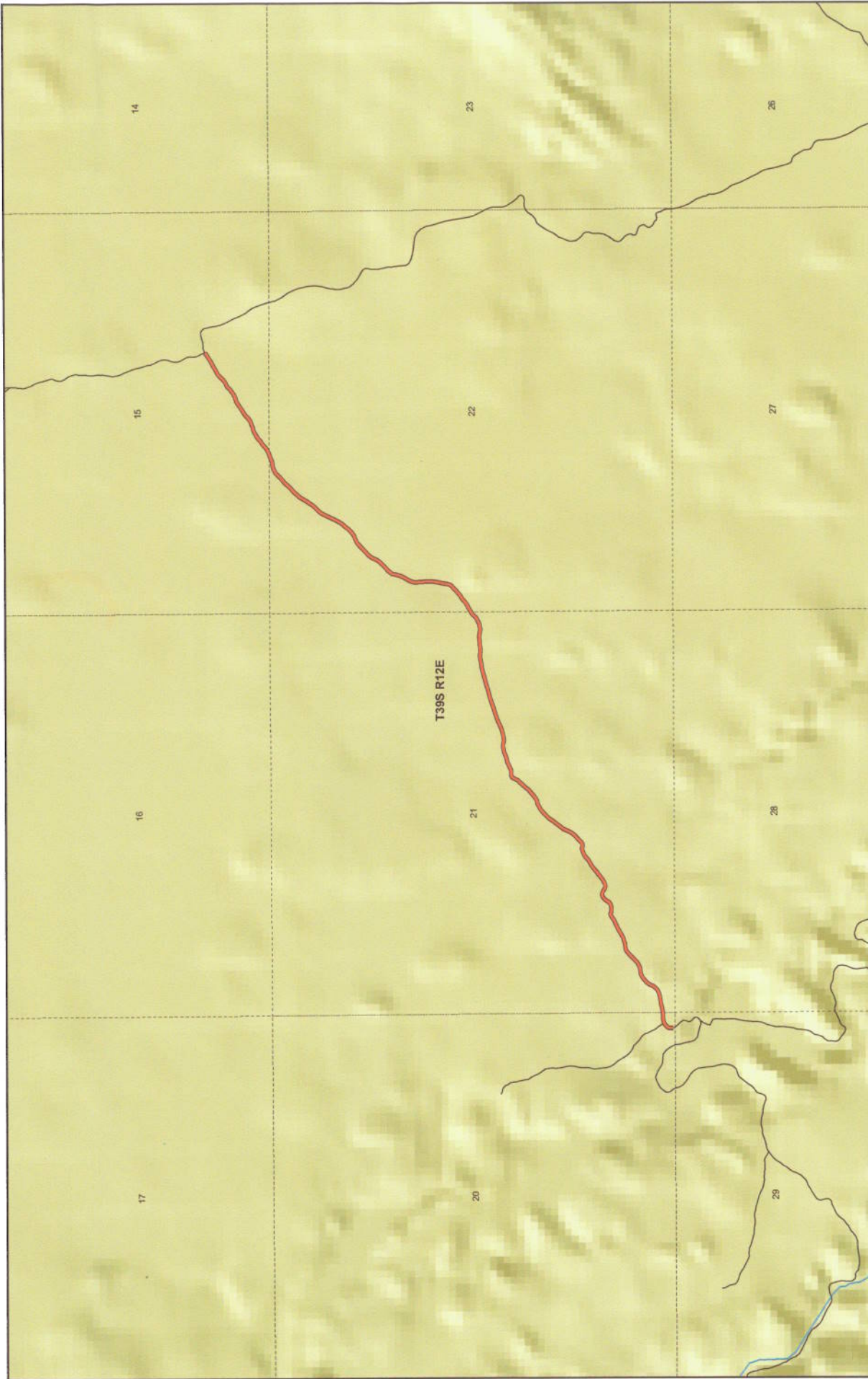

1:20,630  
1 inch equals 0.3 miles  
-JUL 26, 2007

**HOLE IN THE ROCK  
County Unique - B2541**

- Transportation Network**
- HOLE IN THE ROCK
  - State / U.S. Highway
  - Local Roads

- Misc**
- City / Town
  - Municipalities
  - Section = 1 Mile

- Private**
- Wilderness
  - State Park
  - Tribal Lands

- Land Ownership Categories**
- BLM
  - National Recreation Area
  - SITLA, State Trust Land
  - USFS, National Forest
  - National Parks & Monuments (NPS)

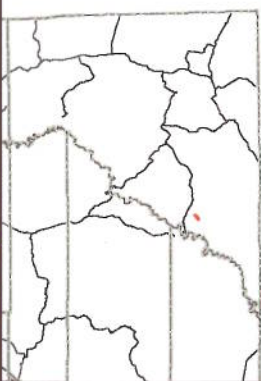

## Appendix A to Attachment 4

**Popular Name: HOLE IN THE ROCK ROAD**

**County: San Juan**

**County Road Number: B2541**

**State Geographic Information Database (SGID) Road Identification Number: RD190261.**

**Road-Segment Number: 001**

**Road-Segment Length: 2.2 miles more or less.**

**Believed owner of the land underlying this road-segment is: Bureau of Land Management.**

*The following description is based upon the geographic coordinate system using the NAD83 Datum. The source is GPS mapping grade data as indicated in the metadata and/or the transportation data model of the State of Utah Geographic Information Database (SGID).*

The road-segment itself is the monument that is identified by its physical presence on the land. The location of said physical presence is closely approximated by mapping grade Global Positioning System (GPS) data. Said data are checked against the corresponding gray-scale 1-meter Digital Orthophoto Quadrangles published by the United States Geological Survey (USGS) to verify a reasonable degree of accuracy. In circumstances where accurate satellite signal acquisition is not possible, such as deep, narrow canyons or under a canopy of dense foliage, or where very sharp curves in the road make accuracy questionable, such portions of the road were digitized from the corresponding gray-scale 1-meter Digital Orthophoto Quadrangles published by the United States Geological Survey (USGS).

This road-segment may traverse:

Township 39 South Range 12 East, Section(s) 15,20,21,22, Salt Lake Base & Meridian

The following description closely approximates the location of the centerline of the physical monument (HOLE IN THE ROCK ROAD)-- Segment 001 based on mapping grade Global Positioning System (GPS) data as defined above:

**Beginning at a point** on the road center line located at 37 degrees 22 minutes 29.54 seconds North Latitude and -110 degrees 36 minutes 7.6 seconds West Longitude, which can be converted to mapping accuracy State Plane Utah South Zone NAD 83 feet coordinates of X = 1,901,326.4 feet and Y = 10,101,621.8 feet; thence the following courses along the said road center line:

thence North 09 Degrees 29 Minutes 50 Seconds West 22.6 feet  
thence North 07 Degrees 44 Minutes 25 Seconds East 32.8 feet  
thence North 27 Degrees 31 Minutes 46 Seconds East 33 feet  
thence North 50 Degrees 04 Minutes 50 Seconds East 37.1 feet  
thence North 64 Degrees 10 Minutes 04 Seconds East 40.4 feet  
thence North 77 Degrees 32 Minutes 11 Seconds East 43.6 feet  
thence South 89 Degrees 55 Minutes 17 Seconds East 48.6 feet  
thence North 84 Degrees 32 Minutes 15 Seconds East 29.2 feet  
thence North 84 Degrees 34 Minutes 57 Seconds East 25.8 feet  
thence North 76 Degrees 48 Minutes 59 Seconds East 58.9 feet  
thence North 76 Degrees 50 Minutes 14 Seconds East 50.2 feet

thence North 80 Degrees 47 Minutes 04 Seconds East 44.5 feet  
 thence North 79 Degrees 30 Minutes 17 Seconds East 42.7 feet  
 thence North 77 Degrees 26 Minutes 42 Seconds East 43.3 feet  
 thence North 63 Degrees 54 Minutes 30 Seconds East 43 feet  
 thence North 45 Degrees 47 Minutes 09 Seconds East 36.4 feet  
 thence North 32 Degrees 31 Minutes 11 Seconds East 36.3 feet  
 thence North 26 Degrees 28 Minutes 58 Seconds East 37.1 feet  
 thence North 27 Degrees 11 Minutes 03 Seconds East 36.3 feet  
 thence North 39 Degrees 48 Minutes 43 Seconds East 38.2 feet  
 thence North 50 Degrees 39 Minutes 56 Seconds East 40.1 feet  
 thence North 51 Degrees 46 Minutes 28 Seconds East 39.5 feet  
 thence North 64 Degrees 08 Minutes 57 Seconds East 41.1 feet  
 thence North 80 Degrees 09 Minutes 40 Seconds East 45.6 feet  
 thence North 78 Degrees 13 Minutes 38 Seconds East 47.9 feet  
 thence North 67 Degrees 17 Minutes 09 Seconds East 40.5 feet  
 thence North 54 Degrees 31 Minutes 29 Seconds East 35.3 feet  
 thence North 42 Degrees 27 Minutes 36 Seconds East 35.8 feet  
 thence North 45 Degrees 25 Minutes 33 Seconds East 36.2 feet  
 thence North 45 Degrees 25 Minutes 33 Seconds East 36.2 feet  
 thence North 49 Degrees 12 Minutes 58 Seconds East 32.4 feet  
 thence North 44 Degrees 41 Minutes 29 Seconds East 30.2 feet  
 thence North 50 Degrees 37 Minutes 43 Seconds East 29.2 feet  
 thence North 67 Degrees 14 Minutes 04 Seconds East 26.6 feet  
 thence North 79 Degrees 55 Minutes 46 Seconds East 31 feet  
 thence North 81 Degrees 15 Minutes 51 Seconds East 35.8 feet  
 thence North 77 Degrees 33 Minutes 36 Seconds East 35.9 feet  
 thence North 72 Degrees 04 Minutes 43 Seconds East 43.4 feet  
 thence North 62 Degrees 00 Minutes 37 Seconds East 45.2 feet  
 thence North 57 Degrees 22 Minutes 18 Seconds East 38.1 feet  
 thence North 61 Degrees 11 Minutes 44 Seconds East 26.1 feet  
 thence North 64 Degrees 40 Minutes 28 Seconds East 21.7 feet  
 thence North 61 Degrees 04 Minutes 51 Seconds East 24.7 feet  
 thence North 63 Degrees 24 Minutes 35 Seconds East 29.6 feet  
 thence North 66 Degrees 49 Minutes 36 Seconds East 29.6 feet  
 thence North 64 Degrees 52 Minutes 15 Seconds East 28.9 feet  
 thence North 61 Degrees 07 Minutes 54 Seconds East 29.5 feet  
 thence North 57 Degrees 29 Minutes 44 Seconds East 31.4 feet  
 thence North 51 Degrees 22 Minutes 16 Seconds East 25.9 feet  
 thence North 64 Degrees 34 Minutes 35 Seconds East 23.2 feet  
 thence South 89 Degrees 28 Minutes 41 Seconds East 22.6 feet  
 thence South 73 Degrees 15 Minutes 34 Seconds East 25.7 feet  
 thence South 81 Degrees 11 Minutes 26 Seconds East 26.9 feet  
 thence North 85 Degrees 46 Minutes 23 Seconds East 24 feet  
 thence North 75 Degrees 13 Minutes 15 Seconds East 21 feet  
 thence North 69 Degrees 13 Minutes 44 Seconds East 23.5 feet  
 thence North 50 Degrees 11 Minutes 30 Seconds East 31.5 feet  
 thence North 36 Degrees 39 Minutes 50 Seconds East 36.6 feet  
 thence North 38 Degrees 08 Minutes 03 Seconds East 40.6 feet  
 thence North 46 Degrees 35 Minutes 16 Seconds East 35.1 feet

thence North 69 Degrees 45 Minutes 56 Seconds East 27.9 feet  
 thence South 78 Degrees 30 Minutes 54 Seconds East 30.5 feet  
 thence South 59 Degrees 20 Minutes 41 Seconds East 32.5 feet  
 thence South 59 Degrees 20 Minutes 41 Seconds East 30.6 feet  
 thence South 73 Degrees 48 Minutes 15 Seconds East 27.7 feet  
 thence North 86 Degrees 13 Minutes 23 Seconds East 21.7 feet  
 thence North 70 Degrees 05 Minutes 14 Seconds East 25.4 feet  
 thence North 59 Degrees 26 Minutes 05 Seconds East 31.9 feet  
 thence North 51 Degrees 42 Minutes 28 Seconds East 30.4 feet  
 thence North 54 Degrees 28 Minutes 25 Seconds East 27.3 feet  
 thence North 53 Degrees 07 Minutes 06 Seconds East 25.3 feet  
 thence North 51 Degrees 44 Minutes 57 Seconds East 24.6 feet  
 thence North 50 Degrees 37 Minutes 43 Seconds East 29.2 feet  
 thence North 48 Degrees 43 Minutes 10 Seconds East 33 feet  
 thence North 49 Degrees 30 Minutes 17 Seconds East 44.3 feet  
 thence North 53 Degrees 05 Minutes 03 Seconds East 28.6 feet  
 thence North 60 Degrees 02 Minutes 29 Seconds East 24.5 feet  
 thence North 59 Degrees 13 Minutes 33 Seconds East 25.9 feet  
 thence North 57 Degrees 50 Minutes 56 Seconds East 36.7 feet  
 thence North 53 Degrees 39 Minutes 50 Seconds East 40.2 feet  
 thence North 50 Degrees 18 Minutes 32 Seconds East 28.4 feet  
 thence North 54 Degrees 59 Minutes 46 Seconds East 20.8 feet  
 thence North 65 Degrees 14 Minutes 50 Seconds East 23.8 feet  
 thence North 66 Degrees 01 Minutes 15 Seconds East 26.2 feet  
 thence North 73 Degrees 21 Minutes 19 Seconds East 19.8 feet  
 thence North 82 Degrees 02 Minutes 26 Seconds East 22.2 feet  
 thence South 88 Degrees 06 Minutes 21 Seconds East 25.6 feet  
 thence South 89 Degrees 39 Minutes 27 Seconds East 28.9 feet  
 thence North 76 Degrees 59 Minutes 30 Seconds East 23.9 feet  
 thence North 42 Degrees 48 Minutes 48 Seconds East 28.3 feet  
 thence North 42 Degrees 20 Minutes 50 Seconds East 39.7 feet  
 thence North 47 Degrees 39 Minutes 22 Seconds East 58.3 feet  
 thence North 43 Degrees 46 Minutes 29 Seconds East 58 feet  
 thence North 23 Degrees 12 Minutes 12 Seconds East 55.1 feet  
 thence North 26 Degrees 39 Minutes 42 Seconds East 62.2 feet  
 thence North 34 Degrees 12 Minutes 55 Seconds East 62.5 feet  
 thence North 38 Degrees 02 Minutes 53 Seconds East 58.2 feet  
 thence North 37 Degrees 06 Minutes 46 Seconds East 54.5 feet  
 thence North 38 Degrees 15 Minutes 35 Seconds East 64.2 feet  
 thence North 40 Degrees 37 Minutes 15 Seconds East 62.1 feet  
 thence North 46 Degrees 57 Minutes 42 Seconds East 52.7 feet  
 thence North 50 Degrees 02 Minutes 18 Seconds East 47.3 feet  
 thence North 56 Degrees 14 Minutes 17 Seconds East 44.1 feet  
 thence North 69 Degrees 04 Minutes 39 Seconds East 38.2 feet  
 thence North 72 Degrees 02 Minutes 28 Seconds East 37.9 feet  
 thence North 61 Degrees 40 Minutes 24 Seconds East 40.5 feet  
 thence North 52 Degrees 14 Minutes 26 Seconds East 38.9 feet  
 thence North 52 Degrees 20 Minutes 31 Seconds East 31.4 feet  
 thence North 49 Degrees 48 Minutes 06 Seconds East 28.7 feet



thence North 48 Degrees 06 Minutes 54 Seconds East 27.2 feet  
 thence North 49 Degrees 29 Minutes 28 Seconds East 30.5 feet  
 thence North 32 Degrees 52 Minutes 11 Seconds East 30.6 feet  
 thence North 37 Degrees 15 Minutes 35 Seconds East 32.3 feet  
 thence North 46 Degrees 05 Minutes 18 Seconds East 38.1 feet  
 thence North 44 Degrees 41 Minutes 28 Seconds East 34.3 feet  
 thence North 41 Degrees 43 Minutes 23 Seconds East 31.4 feet  
 thence North 32 Degrees 15 Minutes 55 Seconds East 28 feet  
 thence North 22 Degrees 53 Minutes 23 Seconds East 27.5 feet  
 thence North 30 Degrees 19 Minutes 16 Seconds East 29 feet  
 thence North 54 Degrees 38 Minutes 58 Seconds East 30.9 feet  
 thence South 89 Degrees 46 Minutes 58 Seconds East 35.8 feet  
 thence North 87 Degrees 28 Minutes 02 Seconds East 33.8 feet  
 thence North 65 Degrees 43 Minutes 43 Seconds East 25.9 feet  
 thence North 61 Degrees 13 Minutes 01 Seconds East 22 feet  
 thence North 66 Degrees 17 Minutes 12 Seconds East 24 feet  
 thence North 64 Degrees 29 Minutes 24 Seconds East 18.5 feet  
 thence North 69 Degrees 30 Minutes 20 Seconds East 23.8 feet  
 thence North 75 Degrees 10 Minutes 49 Seconds East 28.8 feet  
 thence North 71 Degrees 02 Minutes 00 Seconds East 26.7 feet  
 thence North 69 Degrees 30 Minutes 20 Seconds East 23.8 feet  
 thence North 67 Degrees 01 Minutes 36 Seconds East 32.4 feet  
 thence North 72 Degrees 28 Minutes 04 Seconds East 34.4 feet  
 thence North 80 Degrees 13 Minutes 44 Seconds East 31.9 feet  
 thence North 78 Degrees 32 Minutes 12 Seconds East 23.8 feet  
 thence North 88 Degrees 57 Minutes 24 Seconds East 25.6 feet  
 thence South 89 Degrees 27 Minutes 57 Seconds East 22.3 feet  
 thence South 83 Degrees 16 Minutes 48 Seconds East 24.1 feet  
 thence South 81 Degrees 52 Minutes 53 Seconds East 26.9 feet  
 thence North 89 Degrees 09 Minutes 39 Seconds East 35.4 feet  
 thence North 74 Degrees 39 Minutes 39 Seconds East 36.7 feet  
 thence North 78 Degrees 22 Minutes 53 Seconds East 33.5 feet  
 thence North 70 Degrees 15 Minutes 04 Seconds East 41.4 feet  
 thence North 64 Degrees 53 Minutes 41 Seconds East 61.8 feet  
 thence North 66 Degrees 42 Minutes 58 Seconds East 77.4 feet  
 thence North 70 Degrees 57 Minutes 42 Seconds East 80.7 feet  
 thence North 71 Degrees 58 Minutes 53 Seconds East 82 feet  
 thence North 71 Degrees 28 Minutes 47 Seconds East 79.8 feet  
 thence North 73 Degrees 16 Minutes 26 Seconds East 76.6 feet  
 thence North 74 Degrees 56 Minutes 52 Seconds East 83.8 feet  
 thence North 73 Degrees 48 Minutes 33 Seconds East 81.6 feet  
 thence North 73 Degrees 53 Minutes 03 Seconds East 74.7 feet  
 thence North 75 Degrees 02 Minutes 18 Seconds East 74 feet  
 thence North 76 Degrees 08 Minutes 02 Seconds East 47.6 feet  
 thence North 78 Degrees 57 Minutes 44 Seconds East 31.7 feet  
 thence North 79 Degrees 15 Minutes 13 Seconds East 50.7 feet  
 thence North 80 Degrees 10 Minutes 31 Seconds East 57.6 feet  
 thence North 84 Degrees 43 Minutes 17 Seconds East 53 feet  
 thence South 89 Degrees 10 Minutes 13 Seconds East 49.6 feet

thence South 89 Degrees 29 Minutes 45 Seconds East 46.3 feet  
 thence North 85 Degrees 47 Minutes 27 Seconds East 43.4 feet  
 thence North 85 Degrees 31 Minutes 54 Seconds East 36.2 feet  
 thence North 83 Degrees 53 Minutes 31 Seconds East 42.2 feet  
 thence South 88 Degrees 31 Minutes 07 Seconds East 52.5 feet  
 thence South 81 Degrees 47 Minutes 59 Seconds East 42.1 feet  
 thence South 84 Degrees 26 Minutes 20 Seconds East 35.3 feet  
 thence North 82 Degrees 41 Minutes 57 Seconds East 35 feet  
 thence North 72 Degrees 42 Minutes 01 Seconds East 37.1 feet  
 thence North 68 Degrees 20 Minutes 25 Seconds East 38.8 feet  
 thence North 63 Degrees 55 Minutes 19 Seconds East 42.3 feet  
 thence North 46 Degrees 55 Minutes 21 Seconds East 35.8 feet  
 thence North 37 Degrees 43 Minutes 06 Seconds East 32.5 feet  
 thence North 51 Degrees 06 Minutes 36 Seconds East 37.4 feet  
 thence North 63 Degrees 57 Minutes 02 Seconds East 10.2 feet  
 thence North 64 Degrees 00 Minutes 52 Seconds East 28.4 feet  
 thence North 61 Degrees 19 Minutes 20 Seconds East 37.3 feet  
 thence North 54 Degrees 39 Minutes 34 Seconds East 38.9 feet  
 thence North 56 Degrees 34 Minutes 47 Seconds East 45.1 feet  
 thence North 54 Degrees 15 Minutes 05 Seconds East 44.7 feet  
 thence North 53 Degrees 51 Minutes 13 Seconds East 36.4 feet  
 thence North 55 Degrees 34 Minutes 36 Seconds East 36.9 feet  
 thence North 48 Degrees 39 Minutes 49 Seconds East 33.5 feet  
 thence North 46 Degrees 24 Minutes 04 Seconds East 31.1 feet  
 thence North 47 Degrees 50 Minutes 46 Seconds East 29.5 feet  
 thence North 48 Degrees 21 Minutes 57 Seconds East 25.3 feet  
 thence North 47 Degrees 27 Minutes 41 Seconds East 28.8 feet  
 thence North 40 Degrees 03 Minutes 21 Seconds East 25.8 feet  
 thence North 29 Degrees 26 Minutes 10 Seconds East 5.3 feet  
 thence North 20 Degrees 43 Minutes 43 Seconds East 9.1 feet  
 thence North 13 Degrees 43 Minutes 39 Seconds East 18.9 feet  
 thence North 11 Degrees 47 Minutes 09 Seconds East 32.9 feet  
 thence North 09 Degrees 45 Minutes 07 Seconds East 41.3 feet  
 thence North 10 Degrees 12 Minutes 43 Seconds East 46.7 feet  
 thence North 07 Degrees 58 Minutes 50 Seconds East 50.1 feet  
 thence North 07 Degrees 29 Minutes 29 Seconds East 48.4 feet  
 thence North 03 Degrees 09 Minutes 34 Seconds East 32.6 feet  
 thence North 00 Degrees 18 Minutes 31 Seconds West 34.8 feet  
 thence North 05 Degrees 25 Minutes 33 Seconds West 44.2 feet  
 thence North 05 Degrees 42 Minutes 44 Seconds West 48.8 feet  
 thence North 02 Degrees 50 Minutes 05 Seconds West 44.7 feet  
 thence North 08 Degrees 34 Minutes 19 Seconds East 42.5 feet  
 thence North 20 Degrees 39 Minutes 53 Seconds East 42.2 feet  
 thence North 29 Degrees 07 Minutes 47 Seconds East 38.1 feet  
 thence North 26 Degrees 15 Minutes 23 Seconds East 38.2 feet  
 thence North 28 Degrees 50 Minutes 21 Seconds East 39.1 feet  
 thence North 23 Degrees 03 Minutes 55 Seconds East 42.2 feet  
 thence North 10 Degrees 38 Minutes 43 Seconds East 41.5 feet  
 thence North 15 Degrees 12 Minutes 55 Seconds East 42.9 feet

thence North 31 Degrees 48 Minutes 22 Seconds East 36.4 feet  
 thence North 42 Degrees 20 Minutes 16 Seconds East 33.9 feet  
 thence North 48 Degrees 45 Minutes 02 Seconds East 36.1 feet  
 thence North 47 Degrees 03 Minutes 47 Seconds East 39.3 feet  
 thence North 45 Degrees 23 Minutes 55 Seconds East 37.6 feet  
 thence North 43 Degrees 59 Minutes 33 Seconds East 38.1 feet  
 thence North 35 Degrees 47 Minutes 55 Seconds East 34.5 feet  
 thence North 26 Degrees 42 Minutes 46 Seconds East 36.8 feet  
 thence North 25 Degrees 46 Minutes 00 Seconds East 34.3 feet  
 thence North 29 Degrees 38 Minutes 13 Seconds East 34.8 feet  
 thence North 37 Degrees 33 Minutes 58 Seconds East 33.7 feet  
 thence North 46 Degrees 19 Minutes 40 Seconds East 32.5 feet  
 thence North 47 Degrees 36 Minutes 58 Seconds East 31.8 feet  
 thence North 46 Degrees 09 Minutes 36 Seconds East 27.2 feet  
 thence North 43 Degrees 37 Minutes 49 Seconds East 25.1 feet  
 thence North 44 Degrees 11 Minutes 35 Seconds East 26.7 feet  
 thence North 50 Degrees 04 Minutes 50 Seconds East 24.7 feet  
 thence North 49 Degrees 35 Minutes 25 Seconds East 24.5 feet  
 thence North 52 Degrees 49 Minutes 17 Seconds East 27.9 feet  
 thence North 56 Degrees 24 Minutes 59 Seconds East 25.1 feet  
 thence North 68 Degrees 30 Minutes 35 Seconds East 28.2 feet  
 thence North 73 Degrees 11 Minutes 13 Seconds East 37 feet  
 thence North 59 Degrees 53 Minutes 25 Seconds East 41.6 feet  
 thence North 48 Degrees 51 Minutes 42 Seconds East 44.7 feet  
 thence North 40 Degrees 38 Minutes 48 Seconds East 46.1 feet  
 thence North 38 Degrees 17 Minutes 13 Seconds East 45.8 feet  
 thence North 40 Degrees 58 Minutes 33 Seconds East 53.7 feet  
 thence North 33 Degrees 48 Minutes 20 Seconds East 61.4 feet  
 thence North 26 Degrees 32 Minutes 31 Seconds East 58.9 feet  
 thence North 23 Degrees 28 Minutes 03 Seconds East 51.3 feet  
 thence North 26 Degrees 39 Minutes 25 Seconds East 42 feet  
 thence North 31 Degrees 02 Minutes 11 Seconds East 42.3 feet  
 thence North 27 Degrees 19 Minutes 02 Seconds East 39.6 feet  
 thence North 29 Degrees 19 Minutes 47 Seconds East 43.8 feet  
 thence North 43 Degrees 47 Minutes 29 Seconds East 44.3 feet  
 thence North 43 Degrees 46 Minutes 55 Seconds East 43.9 feet  
 thence North 39 Degrees 57 Minutes 03 Seconds East 47.7 feet  
 thence North 37 Degrees 36 Minutes 29 Seconds East 39.5 feet  
 thence North 33 Degrees 06 Minutes 28 Seconds East 38.1 feet  
 thence North 32 Degrees 16 Minutes 37 Seconds East 37.8 feet  
 thence North 30 Degrees 05 Minutes 04 Seconds East 39.6 feet  
 thence North 33 Degrees 31 Minutes 35 Seconds East 36 feet  
 thence North 39 Degrees 18 Minutes 52 Seconds East 39.6 feet  
 thence North 43 Degrees 03 Minutes 17 Seconds East 40.6 feet  
 thence North 46 Degrees 26 Minutes 54 Seconds East 37.8 feet  
 thence North 47 Degrees 53 Minutes 27 Seconds East 37.4 feet  
 thence North 43 Degrees 35 Minutes 47 Seconds East 36.4 feet  
 thence North 42 Degrees 10 Minutes 13 Seconds East 36.9 feet  
 thence North 44 Degrees 21 Minutes 22 Seconds East 39.7 feet

thence North 47 Degrees 44 Minutes 23 Seconds East 39.3 feet  
 thence North 49 Degrees 40 Minutes 25 Seconds East 45.4 feet  
 thence North 46 Degrees 44 Minutes 50 Seconds East 45.3 feet  
 thence North 47 Degrees 40 Minutes 22 Seconds East 44.6 feet  
 thence North 57 Degrees 35 Minutes 06 Seconds East 39.5 feet  
 thence North 70 Degrees 27 Minutes 38 Seconds East 29.9 feet  
 thence North 77 Degrees 38 Minutes 04 Seconds East 34.6 feet  
 thence North 77 Degrees 09 Minutes 45 Seconds East 39.3 feet  
 thence North 74 Degrees 29 Minutes 20 Seconds East 31.3 feet  
 thence North 68 Degrees 51 Minutes 46 Seconds East 32.3 feet  
 thence North 72 Degrees 08 Minutes 16 Seconds East 33.7 feet  
 thence North 69 Degrees 26 Minutes 23 Seconds East 17.4 feet  
 thence North 69 Degrees 29 Minutes 13 Seconds East 22.5 feet  
 thence North 65 Degrees 46 Minutes 30 Seconds East 41.3 feet  
 thence North 52 Degrees 19 Minutes 54 Seconds East 38.4 feet  
 thence North 49 Degrees 42 Minutes 16 Seconds East 39.8 feet  
 thence North 52 Degrees 28 Minutes 29 Seconds East 32.6 feet  
 thence North 52 Degrees 31 Minutes 13 Seconds East 37.5 feet  
 thence North 51 Degrees 22 Minutes 41 Seconds East 33.9 feet  
 thence North 52 Degrees 04 Minutes 19 Seconds East 45.2 feet  
 thence North 59 Degrees 15 Minutes 56 Seconds East 48 feet  
 thence North 67 Degrees 39 Minutes 18 Seconds East 44.6 feet  
 thence North 73 Degrees 02 Minutes 13 Seconds East 40.1 feet  
 thence North 69 Degrees 57 Minutes 15 Seconds East 45.7 feet  
 thence North 67 Degrees 53 Minutes 23 Seconds East 38.9 feet  
 thence North 55 Degrees 15 Minutes 08 Seconds East 27.9 feet  
 thence North 51 Degrees 32 Minutes 02 Seconds East 11.7 feet  
 thence North 40 Degrees 52 Minutes 38 Seconds East 3.5 feet  
 thence North 49 Degrees 11 Minutes 18 Seconds East 20.7 feet  
 thence North 48 Degrees 12 Minutes 46 Seconds East 30.2 feet  
 thence North 51 Degrees 12 Minutes 01 Seconds East 34.8 feet  
 thence North 56 Degrees 53 Minutes 30 Seconds East 35.1 feet  
 thence North 56 Degrees 00 Minutes 04 Seconds East 45 feet  
 thence North 56 Degrees 19 Minutes 29 Seconds East 48.3 feet  
 thence North 62 Degrees 49 Minutes 45 Seconds East 56.7 feet  
 thence North 68 Degrees 51 Minutes 01 Seconds East 61.8 feet  
 thence North 64 Degrees 08 Minutes 33 Seconds East 66.2 feet  
 thence North 47 Degrees 54 Minutes 24 Seconds East 62.1 feet  
 thence North 43 Degrees 40 Minutes 05 Seconds East 52 feet  
 thence North 64 Degrees 24 Minutes 12 Seconds East 46.1 feet  
 thence North 60 Degrees 55 Minutes 25 Seconds East 38.2 feet  
 thence North 45 Degrees 04 Minutes 33 Seconds East 34.6 feet  
 thence North 44 Degrees 20 Minutes 38 Seconds East 38.3 feet  
 thence North 48 Degrees 49 Minutes 33 Seconds East 38.6 feet  
 thence North 55 Degrees 45 Minutes 17 Seconds East 42.3 feet  
 thence North 62 Degrees 46 Minutes 09 Seconds East 47.1 feet  
 thence North 62 Degrees 07 Minutes 26 Seconds East 50.4 feet  
 thence North 58 Degrees 48 Minutes 10 Seconds East 42.8 feet  
 thence North 60 Degrees 51 Minutes 37 Seconds East 40.8 feet

thence North 57 Degrees 41 Minutes 09 Seconds East 40.3 feet  
thence North 55 Degrees 51 Minutes 22 Seconds East 36 feet  
thence North 56 Degrees 25 Minutes 47 Seconds East 36.5 feet more or less to **the ending**  
**point at:** 37 degrees 23 minutes 29.54 seconds North Latitude and -110 degrees 34 minutes 17.17 seconds  
West Longitude, which can be converted to mapping accuracy State Plane Utah South Zone NAD 83 feet  
coordinates of X = 1,910,179.1 feet and Y = 10,107,777.1 feet.