

**Acknowledgment and
Notice of Acknowledgment
of Acceptance of R.S. 2477
Right-of-Way Grant**

THE STATE OF UTAH

TO ALL WHOM THESE PRESENTS SHALL COME, Greeting:

Know ye, This is an Acknowledgment and Notice of Acknowledgment made under Utah Code Sections 72-5-309 through 310 inclusive, that the grant of the United States of America of "the right of way for the construction of highways over public lands, not reserved for public uses" under United States Revised Statutes 2477 (43 U.S.C. Section 932 (repealed October 21, 1976, with proviso recognizing the validity of rights-of-way already established)) was accepted for and on behalf of the State of Utah and its political subdivision Tooele County as it pertains to the highway located in Tooele County known as Fremont Lane; County Road Number: tc02240; State Geographic Information Database (SGID) Road Identification Number: RD230045. Total road length is 7.06 miles more or less.

The reason for this Acknowledgment and Notice of Acknowledgment includes, but is not limited to, the fact that the road was constructed, mechanically, or by continuous use as a public highway for a period of at least ten years, over public lands not reserved for public uses, prior to the earlier of (a) the October 21, 1976 repeal of R.S. 2477 or (b) the date the servient estate was reserved for public uses.

This Acknowledgment and Notice of Acknowledgment applies only to the segments of the road that traverse land owned by the Bureau of Land Management, United States Department of the Interior, and does not apply to segments of the road that traverse land owned by any other person or entity. The State of Utah and its political subdivisions reserve the right to make further acknowledgments and notices of acknowledgment with regard to road segments that traverse land owned by other entities, including the United States of America, through one or more of its agencies.

A printed copy of a map showing the location of the road in said county is appended hereto as "Attachment 1," a printed copy of representative photos of the road is appended hereto as "Attachment 2," a printed copy of a description of the beginning and ending points of the entire road together with a list of Townships, Ranges and Sections that may be traversed by the road in said county is appended hereto as "Attachment 3," and a printed copy of the Road Centerline Description Cover Page(s) is appended hereto as "Attachment 4." The Appendices listed in "Attachment 4" that contain the actual road centerline descriptions are incorporated herein by reference. Affidavits provided by individuals familiar with the road are appended hereto as "Attachment 5."

A printed copy of this Acknowledgment and Notice of Acknowledgment, together with its Attachments and Appendices, may be viewed and/or obtained at the office of the Utah State Archives.

An electronic copy of this Acknowledgment and Notice of Acknowledgment, together with its Attachments and Appendices, may be viewed and/or downloaded as read-only PDF (Portable Document Format) files via the

Internet at <http://recorded2477roads.utah.gov>.

The owner of the servient estate in the land underlying the road-segments subject to this Acknowledgment and Notice is believed to be the United States of America through one or more of its agencies. Any of such agencies or any other person with a servient ownership claim or a competing dominant estate right-of-way ownership claim, may file a petition in the State District Court for Salt Lake County for a decision regarding the correctness of this Acknowledgment. A claimant shall file a petition within sixty (60) days after receipt of this Notice.

In Witness Whereof, I, John Harja, the official designee of the Governor of the State of Utah, in conformity to the laws of the State (Utah Code Sections 72-5-308 through 310 inclusive), have caused this Acknowledgment and Notice of Acknowledgment to be made.

Signed by my hand in Salt Lake City, Utah, the 20th day of June, 2008.

By the Governor's Designee



John Harja

CERTIFICATION

State of Utah)
 : ss
County of Salt Lake)

I hereby certify that the signer of the foregoing document, John Harja, is personally known by me, has made a voluntary signature and taken an oath stating that he is the official designee of the Governor of the State of Utah and is authorized to sign this document on the Governor's behalf pursuant to Utah Code Section 72-5-309. He further vouched that, based upon information and belief, the facts alleged therein are true.

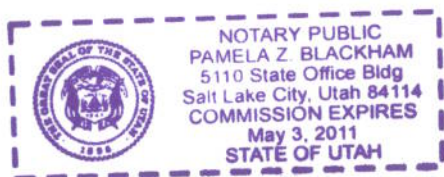
Dated this 20th day of June, 2008.

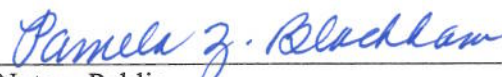

Notary Public

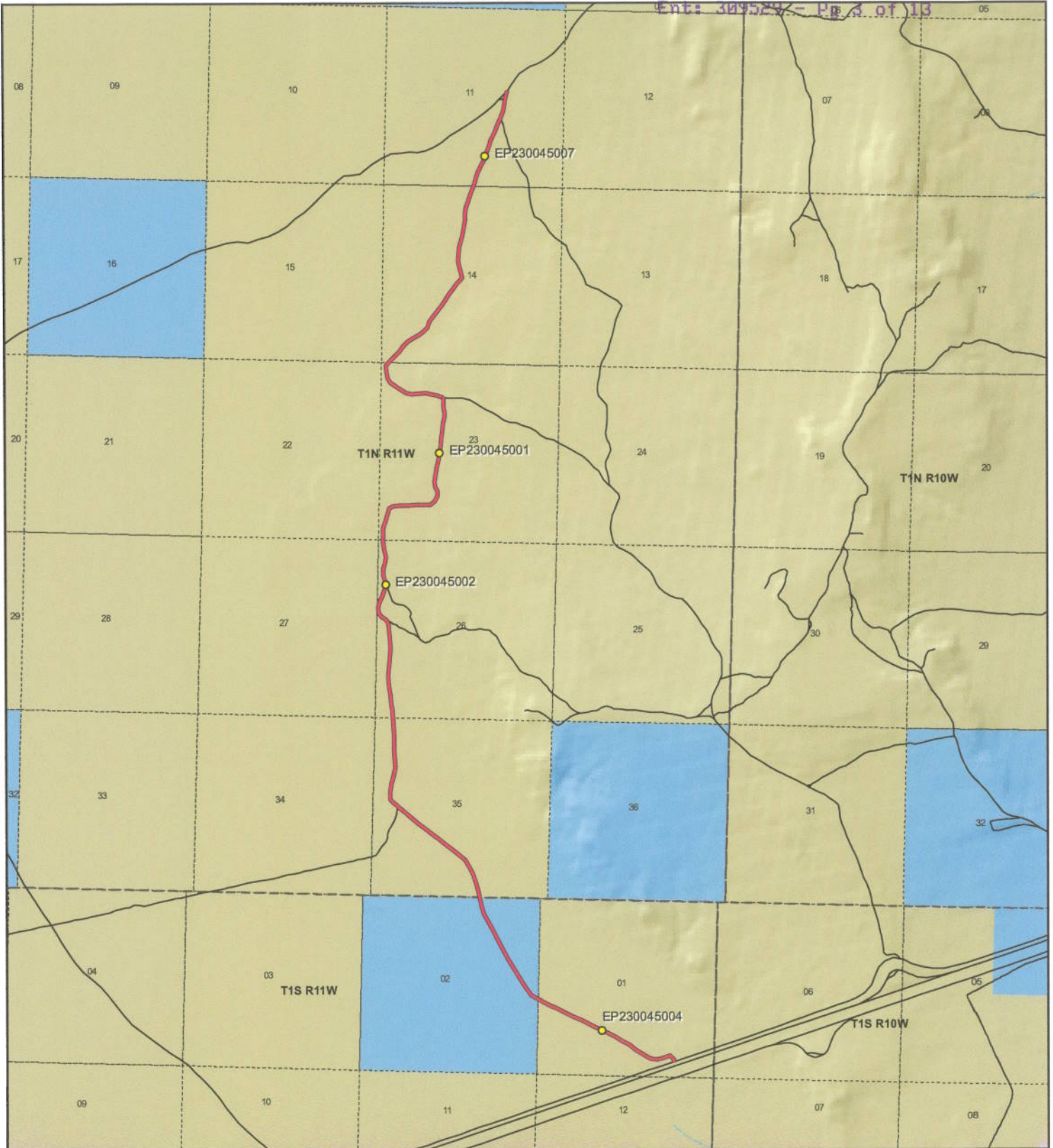

<p>1:46,504 1 inch equals 0.7 miles</p>		<p align="center">Fremont Lane - Tooele County SGID RD_ID RD230045</p> <table border="0"> <tr> <td data-bbox="467 1816 706 2001"> Land Ownership Categories <ul style="list-style-type: none"> BLM Private SITLA, State Trust Land USFS, National Forest State Parks and Recreation Tribal, Indian Reservation NPS, National Park </td> <td data-bbox="706 1816 950 2001"> <ul style="list-style-type: none"> Wilderness UDWR Wildlife Reserve DOD, Military State Sovereign Land National Recreation Area USFWS, Natl. Wildlife Refuge </td> <td data-bbox="950 1816 1161 2001"> Transportation Network <ul style="list-style-type: none"> Fremont Lane Title V: Issued Or Under Consideration By BLM Or County Other Roads Photo Event Point Section = 1 Mile </td> </tr> </table>	Land Ownership Categories <ul style="list-style-type: none"> BLM Private SITLA, State Trust Land USFS, National Forest State Parks and Recreation Tribal, Indian Reservation NPS, National Park 	<ul style="list-style-type: none"> Wilderness UDWR Wildlife Reserve DOD, Military State Sovereign Land National Recreation Area USFWS, Natl. Wildlife Refuge 	Transportation Network <ul style="list-style-type: none"> Fremont Lane Title V: Issued Or Under Consideration By BLM Or County Other Roads Photo Event Point Section = 1 Mile 	<p>Map prepared by the State of Utah Automated Geographic Reference Center Room 5130 State Office Building Salt Lake City, Utah 84114 Jun 17, 2008</p>
Land Ownership Categories <ul style="list-style-type: none"> BLM Private SITLA, State Trust Land USFS, National Forest State Parks and Recreation Tribal, Indian Reservation NPS, National Park 	<ul style="list-style-type: none"> Wilderness UDWR Wildlife Reserve DOD, Military State Sovereign Land National Recreation Area USFWS, Natl. Wildlife Refuge 	Transportation Network <ul style="list-style-type: none"> Fremont Lane Title V: Issued Or Under Consideration By BLM Or County Other Roads Photo Event Point Section = 1 Mile 				



EP230045001



EP230045002



EP230045004



EP230045007

EP000000000

EP000000000



Fremont Lane - Tooele County
SGID RD_ID RD230045

Map prepared by the State of Utah
Automated Geographic Reference Center
Room 5130 State Office Building
Salt Lake City, Utah 84114
June 18, 2008



Attachment 3

Beginning & Ending Points and Township, Range, and Section References For:

Popular Name: Fremont Lane

County: Tooele

County Road Number: tc02240

State Geographic Information Database (SGID) Road Identification Number: RD230045.

Total Road Length: 7.06 miles more or less.

Beginning at a point on the road centerline located at 40 degrees 45 minutes 017.5 seconds North Latitude and -113 degrees 02 minutes 00.96 seconds West Longitude, which can be converted to mapping accuracy State Plane Utah Central Zone NAD 83 feet coordinates of X = 1,215,536.3 feet and Y = 7,447,356.6 feet based on the US Survey Foot conversion.

Ending at a point on the road centerline located at 40 degrees 50 minutes 01.46 seconds North Latitude and -113 degrees 03 minutes 13.39 seconds West Longitude, which can be converted to mapping accuracy State Plane Utah Central Zone NAD 83 feet coordinates of X = 1,210,462.2 feet and Y = 7,476,186.7 feet based on the US Survey Foot conversion.

This road may traverse:

Township 1 North Range 11 West, Section(s) 11,14,23,26,35, Salt Lake Base & Meridian

Township 1 South Range 11 West, Section(s) 1,2, Salt Lake Base & Meridian

See Attachment 1 above for a cartographic depiction of the course of this road.

Attachment 4
Road Centerline Description Cover Page(s)

Popular Name: Fremont Lane

County: Tooele

County Road Number: tc02240

State Geographic Information Database (SGID) Road Identification Number: RD230045.

Total Road Length: 7.06 miles more or less.

Centerline Descriptions Of Road-Segments That Cross Over Federally Owned Land, Derived From Global Positioning System Data And Cross-checked against USGS Digital Orthophoto Quadrangles Compiled By The Utah Automated Geographic Reference Center And Entered Into The State Geographic Information Database (SGID).

Road-Segments Listed by SGID Road Identification Number (RD_ID)	Road-Segment Numbers	Believed Ownership Of Servient Estate	Approximate Segment Length	See Attached Appendix
RD230045	001	BLM	0.88 Miles	A
RD230045	002	ST	0.67 Miles	(not shown)
RD230045	003	BLM	5.51 Miles	B
		Total Road Length	7.06	_____

* Indicates that a Title V permit will be requested, is in process, or has been issued.

† Indicates that road-segments crossing Forest Service land are under consideration by the state and county as of the date of this Acknowledgment and Notice of Acknowledgment.

Attachment 5

AFFIDAVIT OF JAMES S. MCKENDRICK

FREMONT LANE

TOOELE COUNTY, UTAH

ROAD NUMBER tc02240

State of Utah)
 : ss.
County of Tooele)

JAMES S. MCKENDRICK, being first duly sworn, deposes and states as follows:

1. I am an adult competent to testify about the matters set forth below based upon my personal knowledge. I currently reside in Tooele, Tooele County, Utah. I have lived in Tooele County for most of the past 76 years. I was employed by the Tooele County Road Department from 1963 to 1993.

2. I have traveled and am familiar with a road in Tooele County known as Fremont Lane. I am also familiar with the land the road traverses. When I first used and observed the road in the early 1960s it followed the same route as in the early 1990s when I last observed it. Attached is a Tooele County map showing Fremont Lane. To the best of my knowledge and based upon my use of and familiarity with this road and the land it traverses, the location and route of the road are correctly illustrated on the attached map.

3. The County also identifies this road according to the road number listed above.

4. I have observed that the road has been open to the public for all to use, to come and go as they pleased, since at least as early as the early 1960s and continuing through the early 1990s. Throughout this time period I observed travel on the road by means of livestock trucks and pickup trucks. During this time period, the road was used weekly, for more than ten continuous years prior to 1976 and was so used in the early 1990s.

5. Throughout the time period from the early 1960s to the early 1990s, I have used the road myself for county road maintenance and travel through the area.

6. Throughout the time period described in the previous paragraph, I have observed other vehicles from the general public using the road at various times for the uses described in the previous paragraph, plus livestock operations, government access and hunting.

7. It is also the reputation in the community that this road has been open to the public for all to use, to come and go as they pleased, since at least as early as the early 1960s and continuing through 1976 to the present, for the uses described in the previous paragraphs.

8. Prior to 1976, I graded and performed maintenance and construction activities on the road.

DATED this 6 day of June, 2008.

JAMES S. MCKENDRICK

SUBSCRIBED AND SWORN to before me this 6 day of June, 2008.

NOTARY PUBLIC

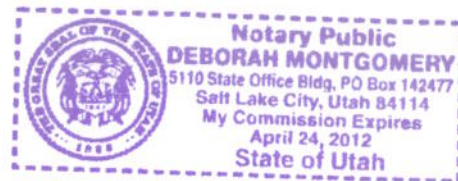

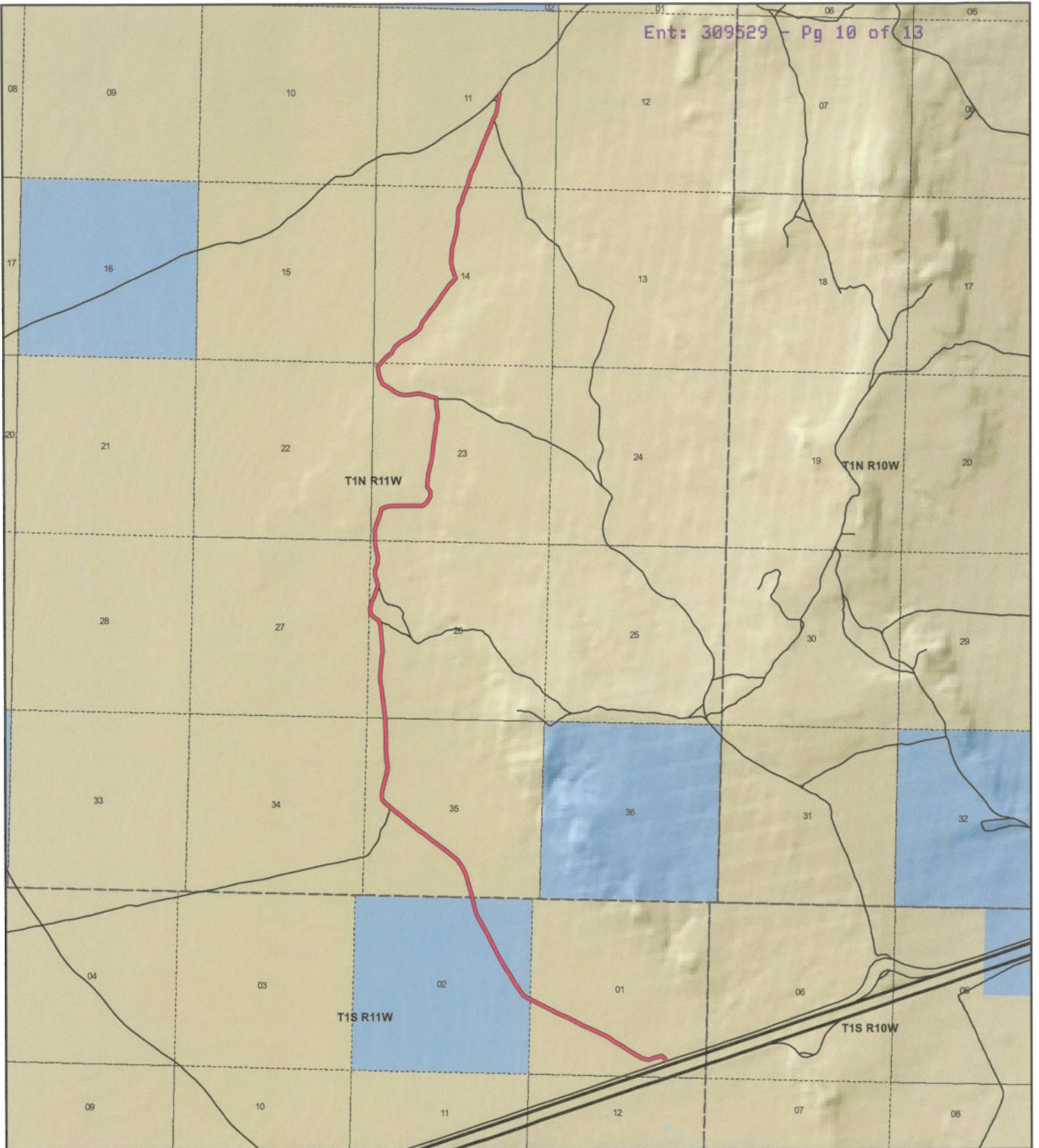

**Tooele County
Fremont Lane
County Unique - tc02240**

Land Ownership Categories

- BLM
- Private
- SITLA, State Trust Land
- USFS, National Forest
- Wildlife Reserve
- Military
- Tribal
- Wilderness
- State Park

Transportation Network

- Fremont Lane
- State / U.S. Highway
- Local Roads

Misc

- City / Town
- Municipalities
- Section = 1 Mile



1:45,784

1 inch equals 0.7 miles



Map prepared by the State of Utah
AGRC
Room 5130 State Office Building
Salt Lake City, Utah 84114
Apr 21, 2008



AFFIDAVIT OF GERALD E. BERTAGNOLE

FREMONT LANE

COUNTY ROAD NUMBER tc02240

TOOELE COUNTY, UTAH

State of Utah)
 : ss.
County of Tooele)

GERALD E. BERTAGNOLE, being first duly sworn, deposes and states as follows:

1. I am an adult competent to testify about the matters set forth below based upon my personal knowledge. My family has owned property in Tooele County since 1933. I have had grazing allotments in various parts of Tooele County since 1936 and continuing to the present.

2. I have traveled and am familiar with a road in Tooele County known as Fremont Lane. I am also familiar with the land the road traverses. When I first used and observed the road in the mid 1950s it followed the same route as in 1998 when I last observed it. Attached is a Tooele County map showing Fremont Lane. To the best of my knowledge and based upon my use of and familiarity with this road and the land it traverses, the location and route of the road are correctly illustrated on the attached map. The County also identifies this road according to the road number listed above.

3. I have observed that the road has been open to the public for all to use, to come and go as they pleased, since at least as early as the mid 1950s and continuing through 1976 to 1998. Throughout this time period I have observed travel on the road by various means, including cars, pickups, livestock trucks, ATVs and jeeps. Throughout

this time period, the road has been used weekly for more than ten continuous years prior to 1976, and was so used in 1998.

4. Throughout the time period from the mid 1950s to 1998, I have used the road myself for livestock operations and travel in and through the area.

5. Throughout the time period described in the previous paragraph, I observed vehicles using the road at various times for the uses described in the previous paragraph, plus hunting, well access, recreation and government access.

6. It is also the reputation in the community that this road has been open to the public for all to use, to come and go as they pleased, since at least as early as the early 1950s.

7. Prior to 1976, I observed the graded surface of the road.

Dated this 3 day of June, 2008.

GERALD E. BERTAGNOLE

SUBSCRIBED AND SWORN to before me this 3rd day of June, 2008.

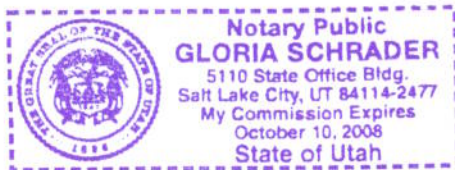

NOTARY PUBLIC

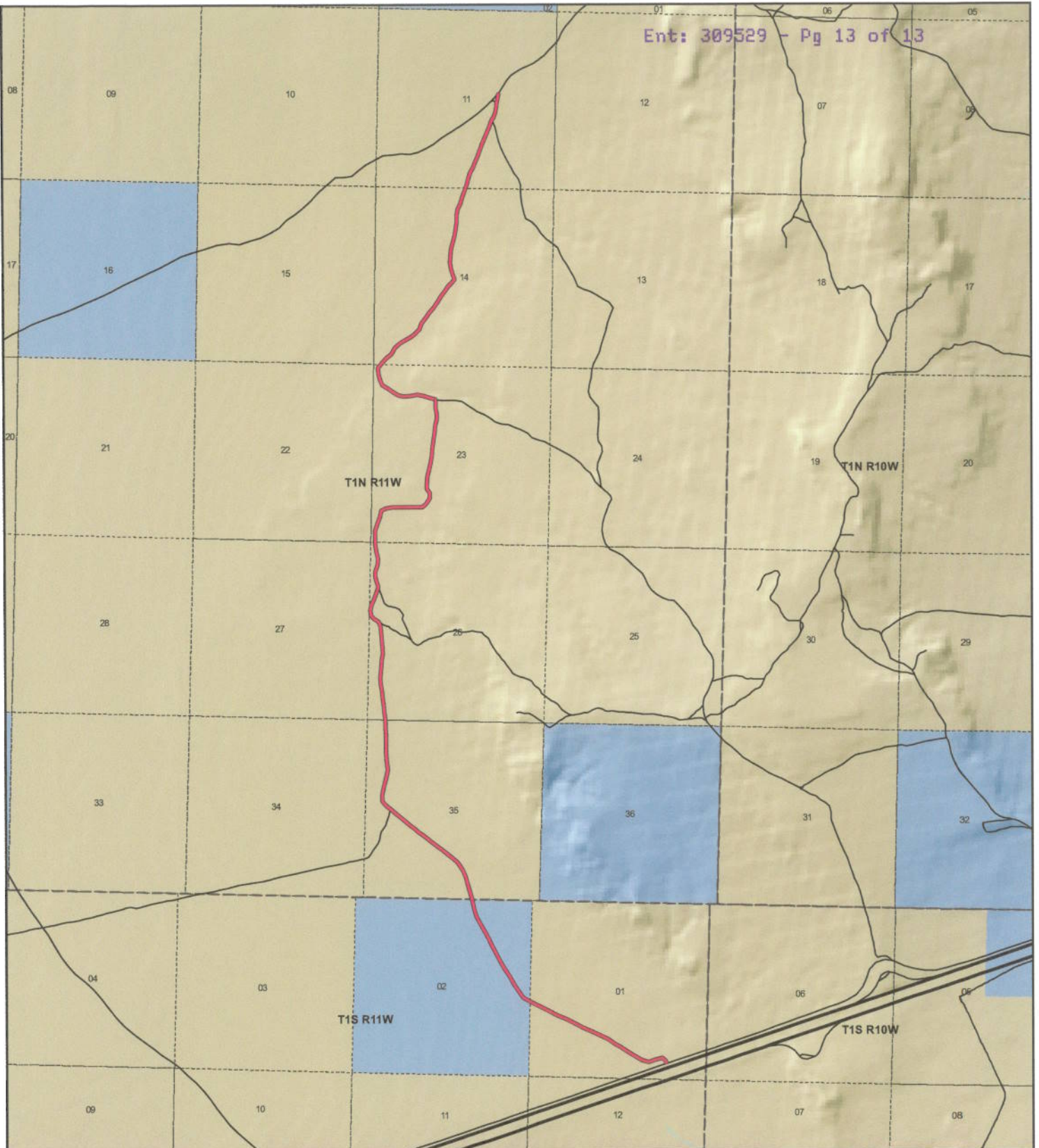

**Tooele County
Fremont Lane
County Unique - tc02240**

Land Ownership Categories

- BLM
- Private
- SITLA, State Trust Land
- USFS, National Forest
- Wildlife Reserve
- Military
- Tribal
- Wilderness
- State Park

Transportation Network

- Fremont Lane
- State / U.S. Highway
- Local Roads

Misc

- City / Town
- Municipalities
- Section = 1 Mile



1:45,784

1 inch equals 0.7 miles



Map prepared by the State of Utah
AGRC
Room 5130 State Office Building
Salt Lake City, Utah 84114
Apr 21, 2008



Appendix A to Attachment 4

Popular Name: Fremont Lane

County: Tooele

County Road Number: tc02240

State Geographic Information Database (SGID) Road Identification Number: RD230045.

Road-Segment Number: 001

Road-Segment Length: 0.88 miles more or less.

Believed owner of the land underlying this road-segment is: Bureau of Land Management.

The following description is based upon the geographic coordinate system using the NAD83 Datum. The source is GPS mapping grade data as indicated in the metadata and/or the transportation data model of the State of Utah Geographic Information Database (SGID).

The road-segment itself is the monument that is identified by its physical presence on the land. The location of said physical presence is closely approximated by mapping grade Global Positioning System (GPS) data. Said data are checked against the corresponding gray-scale 1-meter Digital Orthophoto Quadrangles published by the United States Geological Survey (USGS) to verify a reasonable degree of accuracy. In circumstances where accurate satellite signal acquisition is not possible, such as deep, narrow canyons or under a canopy of dense foliage, or where very sharp curves in the road make accuracy questionable, such portions of the road were digitized from the corresponding gray-scale 1-meter Digital Orthophoto Quadrangles published by the United States Geological Survey (USGS).

This road-segment may traverse:

Township 1 South Range 11 West, Section(s) 1, Salt Lake Base & Meridian

The following description closely approximates the location of the centerline of the physical monument (Fremont Lane)-- Segment 001 based on mapping grade Global Positioning System (GPS) data as defined above:

Beginning at a point on the road center line located at 40 degrees 45 minutes 017.5 seconds North Latitude and -113 degrees 02 minutes 00.96 seconds West Longitude, which can be converted to mapping accuracy State Plane Utah Central Zone NAD 83 feet coordinates of X = 1,215,536.3 feet and Y = 7,447,356.6 feet; thence the following courses along the said road center line:

thence North 18 Degrees 14 Minutes 59 Seconds West 89.6 feet
thence North 48 Degrees 15 Minutes 22 Seconds West 137.1 feet
thence South 73 Degrees 25 Minutes 27 Seconds West 199.6 feet
thence South 71 Degrees 49 Minutes 56 Seconds West 203.7 feet
thence North 76 Degrees 58 Minutes 29 Seconds West 198.6 feet
thence North 61 Degrees 47 Minutes 06 Seconds West 240.2 feet
thence North 58 Degrees 38 Minutes 38 Seconds West 262.2 feet
thence North 53 Degrees 16 Minutes 26 Seconds West 242.2 feet
thence North 63 Degrees 12 Minutes 54 Seconds West 223 feet
thence North 55 Degrees 57 Minutes 03 Seconds West 229.4 feet
thence North 63 Degrees 30 Minutes 23 Seconds West 276.2 feet

thence North 66 Degrees 03 Minutes 51 Seconds West 287.2 feet
thence North 66 Degrees 02 Minutes 14 Seconds West 286.9 feet
thence North 63 Degrees 23 Minutes 54 Seconds West 286 feet
thence North 65 Degrees 31 Minutes 36 Seconds West 269.7 feet
thence North 65 Degrees 19 Minutes 13 Seconds West 267.6 feet
thence North 62 Degrees 28 Minutes 59 Seconds West 252.7 feet
thence North 64 Degrees 38 Minutes 28 Seconds West 234.5 feet
thence North 65 Degrees 29 Minutes 47 Seconds West 230.3 feet
thence North 61 Degrees 56 Minutes 02 Seconds West 206.3 feet more or less to **the ending**
point at: 40 degrees 45 minutes 35.01 seconds North Latitude and -113 degrees 02 minutes 54.27 seconds
West Longitude, which can be converted to mapping accuracy State Plane Utah Central Zone NAD 83 feet
coordinates of X = 1,211,464.9 feet and Y = 7,449,198.7 feet.

Appendix B to Attachment 4

Popular Name: Fremont Lane

County: Tooele

County Road Number: tc02240

State Geographic Information Database (SGID) Road Identification Number: RD230045.

Road-Segment Number: 003

Road-Segment Length: 5.51 miles more or less.

Believed owner of the land underlying this road-segment is: Bureau of Land Management.

The following description is based upon the geographic coordinate system using the NAD83 Datum. The source is GPS mapping grade data as indicated in the metadata and/or the transportation data model of the State of Utah Geographic Information Database (SGID).

The road-segment itself is the monument that is identified by its physical presence on the land. The location of said physical presence is closely approximated by mapping grade Global Positioning System (GPS) data. Said data are checked against the corresponding gray-scale 1-meter Digital Orthophoto Quadrangles published by the United States Geological Survey (USGS) to verify a reasonable degree of accuracy. In circumstances where accurate satellite signal acquisition is not possible, such as deep, narrow canyons or under a canopy of dense foliage, or where very sharp curves in the road make accuracy questionable, such portions of the road were digitized from the corresponding gray-scale 1-meter Digital Orthophoto Quadrangles published by the United States Geological Survey (USGS).

This road-segment may traverse:

Township 1 North Range 11 West, Section(s) 11,14,23,26,35, Salt Lake Base & Meridian

The following description closely approximates the location of the centerline of the physical monument (Fremont Lane)-- Segment 003 based on mapping grade Global Positioning System (GPS) data as defined above:

Beginning at a point on the road center line located at 40 degrees 46 minutes 04.56 seconds North Latitude and -113 degrees 03 minutes 17.75 seconds West Longitude, which can be converted to mapping accuracy State Plane Utah Central Zone NAD 83 feet coordinates of X = 1,209,710.3 feet and Y = 7,452,219.7 feet; thence the following courses along the said road center line:

thence North 13 Degrees 17 Minutes 11 Seconds West 225.9 feet
thence North 16 Degrees 51 Minutes 50 Seconds West 248.1 feet
thence North 17 Degrees 04 Minutes 52 Seconds West 251.8 feet
thence North 28 Degrees 01 Minutes 08 Seconds West 235.3 feet
thence North 33 Degrees 28 Minutes 08 Seconds West 239 feet
thence North 51 Degrees 05 Minutes 44 Seconds West 238.5 feet
thence North 51 Degrees 04 Minutes 42 Seconds West 246.2 feet
thence North 52 Degrees 00 Minutes 36 Seconds West 253.9 feet
thence North 52 Degrees 39 Minutes 46 Seconds West 249.6 feet
thence North 52 Degrees 58 Minutes 29 Seconds West 232.4 feet
thence North 52 Degrees 41 Minutes 55 Seconds West 217.6 feet

thence North 52 Degrees 25 Minutes 31 Seconds West 178.8 feet
 thence North 51 Degrees 27 Minutes 42 Seconds West 143.7 feet
 thence North 52 Degrees 32 Minutes 54 Seconds West 149.9 feet
 thence North 49 Degrees 49 Minutes 46 Seconds West 169.2 feet
 thence North 51 Degrees 11 Minutes 03 Seconds West 187 feet
 thence North 50 Degrees 19 Minutes 07 Seconds West 216.8 feet
 thence North 51 Degrees 10 Minutes 01 Seconds West 96.1 feet
 thence North 50 Degrees 07 Minutes 11 Seconds West 114.3 feet
 thence North 44 Degrees 06 Minutes 52 Seconds West 172.7 feet
 thence North 01 Degrees 35 Minutes 36 Seconds East 203.5 feet
 thence North 08 Degrees 14 Minutes 23 Seconds East 250.5 feet
 thence North 14 Degrees 56 Minutes 27 Seconds East 255.1 feet
 thence North 12 Degrees 18 Minutes 21 Seconds East 247.2 feet
 thence North 06 Degrees 58 Minutes 31 Seconds West 244.4 feet
 thence North 02 Degrees 39 Minutes 58 Seconds West 259.4 feet
 thence North 00 Degrees 25 Minutes 12 Seconds West 255.9 feet
 thence North 02 Degrees 02 Minutes 17 Seconds West 244.5 feet
 thence North 03 Degrees 05 Minutes 17 Seconds West 233.2 feet
 thence North 03 Degrees 33 Minutes 40 Seconds West 239.9 feet
 thence North 05 Degrees 39 Minutes 22 Seconds West 8.9 feet
 thence North 05 Degrees 37 Minutes 31 Seconds West 230 feet
 thence North 07 Degrees 21 Minutes 02 Seconds West 231.4 feet
 thence North 07 Degrees 28 Minutes 56 Seconds West 216.6 feet
 thence North 07 Degrees 37 Minutes 32 Seconds West 196.8 feet
 thence North 07 Degrees 35 Minutes 59 Seconds West 181.9 feet
 thence North 04 Degrees 17 Minutes 43 Seconds West 185.8 feet
 thence North 03 Degrees 04 Minutes 34 Seconds East 175.8 feet
 thence North 04 Degrees 18 Minutes 27 Seconds East 186 feet
 thence North 07 Degrees 14 Minutes 52 Seconds East 193.6 feet
 thence North 05 Degrees 56 Minutes 24 Seconds East 194.8 feet
 thence North 03 Degrees 16 Minutes 48 Seconds West 198.8 feet
 thence North 05 Degrees 30 Minutes 28 Seconds West 204.3 feet
 thence North 05 Degrees 23 Minutes 12 Seconds West 209.2 feet
 thence North 05 Degrees 27 Minutes 34 Seconds West 187.8 feet
 thence North 22 Degrees 22 Minutes 59 Seconds West 148.7 feet
 thence North 56 Degrees 52 Minutes 19 Seconds West 169.5 feet
 thence North 40 Degrees 03 Minutes 56 Seconds West 138.6 feet
 thence North 09 Degrees 18 Minutes 20 Seconds West 141.2 feet
 thence North 10 Degrees 57 Minutes 46 Seconds East 170.6 feet
 thence North 22 Degrees 57 Minutes 28 Seconds East 209 feet
 thence North 23 Degrees 39 Minutes 49 Seconds East 197.6 feet
 thence North 17 Degrees 20 Minutes 42 Seconds East 136 feet
 thence North 04 Degrees 50 Minutes 50 Seconds East 50.7 feet
 thence North 16 Degrees 36 Minutes 54 Seconds West 96 feet
 thence North 15 Degrees 53 Minutes 48 Seconds West 195.8 feet
 thence North 04 Degrees 05 Minutes 08 Seconds West 166 feet
 thence North 20 Degrees 58 Minutes 06 Seconds East 179.6 feet
 thence North 06 Degrees 29 Minutes 44 Seconds East 198.3 feet
 thence North 11 Degrees 44 Minutes 25 Seconds West 220.9 feet

thence North 09 Degrees 14 Minutes 48 Seconds West 214.2 feet
 thence North 03 Degrees 04 Minutes 46 Seconds West 72.3 feet
 thence North 03 Degrees 04 Minutes 12 Seconds West 134.7 feet
 thence North 02 Degrees 13 Minutes 46 Seconds East 197.1 feet
 thence North 16 Degrees 52 Minutes 20 Seconds East 225 feet
 thence North 17 Degrees 26 Minutes 38 Seconds East 230.9 feet
 thence North 16 Degrees 27 Minutes 18 Seconds East 174.8 feet
 thence North 60 Degrees 43 Minutes 46 Seconds East 139.1 feet
 thence North 81 Degrees 44 Minutes 01 Seconds East 214.3 feet
 thence North 89 Degrees 15 Minutes 33 Seconds East 238.9 feet
 thence North 88 Degrees 51 Minutes 53 Seconds East 238.6 feet
 thence North 89 Degrees 14 Minutes 15 Seconds East 226.4 feet
 thence North 88 Degrees 06 Minutes 07 Seconds East 181.8 feet
 thence North 50 Degrees 23 Minutes 53 Seconds East 153 feet
 thence North 29 Degrees 02 Minutes 38 Seconds East 184.5 feet
 thence North 00 Degrees 09 Minutes 03 Seconds East 150.9 feet
 thence North 32 Degrees 33 Minutes 49 Seconds West 141.6 feet
 thence North 03 Degrees 24 Minutes 27 Seconds West 165.9 feet
 thence North 06 Degrees 05 Minutes 55 Seconds East 216.3 feet
 thence North 11 Degrees 44 Minutes 07 Seconds East 214.7 feet
 thence North 12 Degrees 38 Minutes 04 Seconds East 220.5 feet
 thence North 08 Degrees 58 Minutes 11 Seconds East 212.8 feet
 thence North 06 Degrees 33 Minutes 50 Seconds East 218.1 feet
 thence North 06 Degrees 44 Minutes 14 Seconds East 231.4 feet
 thence North 06 Degrees 43 Minutes 23 Seconds East 213.3 feet
 thence North 07 Degrees 27 Minutes 32 Seconds East 205.3 feet
 thence North 11 Degrees 31 Minutes 35 Seconds East 196.1 feet
 thence North 01 Degrees 08 Minutes 01 Seconds West 167.4 feet
 thence North 09 Degrees 07 Minutes 39 Seconds West 167.7 feet
 thence North 02 Degrees 33 Minutes 18 Seconds West 136.3 feet
 thence North 03 Degrees 54 Minutes 50 Seconds East 83.9 feet
 thence North 19 Degrees 16 Minutes 29 Seconds East 40.1 feet
 thence North 79 Degrees 19 Minutes 25 Seconds West 25.7 feet
 thence North 74 Degrees 24 Minutes 06 Seconds West 203 feet
 thence North 74 Degrees 22 Minutes 23 Seconds West 178.8 feet
 thence North 78 Degrees 10 Minutes 49 Seconds West 163.5 feet
 thence South 82 Degrees 27 Minutes 23 Seconds West 196.4 feet
 thence South 82 Degrees 55 Minutes 53 Seconds West 196.2 feet
 thence North 76 Degrees 48 Minutes 20 Seconds West 175.2 feet
 thence North 59 Degrees 47 Minutes 41 Seconds West 164.6 feet
 thence North 56 Degrees 30 Minutes 04 Seconds West 200.3 feet
 thence North 57 Degrees 41 Minutes 11 Seconds West 197.6 feet
 thence North 28 Degrees 15 Minutes 22 Seconds West 168.9 feet
 thence North 13 Degrees 20 Minutes 04 Seconds West 186.9 feet
 thence North 05 Degrees 27 Minutes 05 Seconds West 169.6 feet
 thence North 39 Degrees 29 Minutes 51 Seconds East 140.5 feet
 thence North 39 Degrees 30 Minutes 35 Seconds East 32.6 feet
 thence North 43 Degrees 53 Minutes 43 Seconds East 210.7 feet
 thence North 46 Degrees 18 Minutes 03 Seconds East 193.6 feet

thence North 31 Degrees 37 Minutes 44 Seconds East	206.9 feet
thence North 44 Degrees 59 Minutes 01 Seconds East	200.7 feet
thence North 60 Degrees 52 Minutes 30 Seconds East	197.7 feet
thence North 58 Degrees 12 Minutes 46 Seconds East	176.1 feet
thence North 55 Degrees 04 Minutes 37 Seconds East	159 feet
thence North 42 Degrees 00 Minutes 51 Seconds East	186.5 feet
thence North 20 Degrees 42 Minutes 41 Seconds East	188.1 feet
thence North 36 Degrees 36 Minutes 07 Seconds East	188.9 feet
thence North 37 Degrees 50 Minutes 55 Seconds East	190 feet
thence North 38 Degrees 09 Minutes 53 Seconds East	199.2 feet
thence North 34 Degrees 52 Minutes 12 Seconds East	204.8 feet
thence North 31 Degrees 53 Minutes 41 Seconds East	201.7 feet
thence North 35 Degrees 09 Minutes 23 Seconds East	195.5 feet
thence North 35 Degrees 27 Minutes 16 Seconds East	190.1 feet
thence North 45 Degrees 21 Minutes 35 Seconds East	169.1 feet
thence North 33 Degrees 55 Minutes 55 Seconds East	97.3 feet
thence North 19 Degrees 23 Minutes 39 Seconds West	145.8 feet
thence North 16 Degrees 07 Minutes 34 Seconds West	185.8 feet
thence North 10 Degrees 51 Minutes 40 Seconds West	185.2 feet
thence North 05 Degrees 02 Minutes 42 Seconds East	206 feet
thence North 05 Degrees 52 Minutes 11 Seconds East	203 feet
thence North 14 Degrees 50 Minutes 42 Seconds East	185.3 feet
thence North 14 Degrees 27 Minutes 22 Seconds East	190 feet
thence North 11 Degrees 03 Minutes 06 Seconds East	205.8 feet
thence North 06 Degrees 44 Minutes 38 Seconds East	210 feet
thence North 01 Degrees 02 Minutes 27 Seconds East	216.6 feet
thence North 09 Degrees 38 Minutes 16 Seconds East	194.9 feet
thence North 21 Degrees 27 Minutes 13 Seconds East	194.4 feet
thence North 16 Degrees 41 Minutes 18 Seconds East	187 feet
thence North 20 Degrees 40 Minutes 56 Seconds East	181 feet
thence North 21 Degrees 38 Minutes 21 Seconds East	101.5 feet
thence North 21 Degrees 37 Minutes 11 Seconds East	96.7 feet
thence North 15 Degrees 25 Minutes 29 Seconds East	194.3 feet
thence North 16 Degrees 27 Minutes 16 Seconds East	174.8 feet
thence North 24 Degrees 34 Minutes 26 Seconds East	179.1 feet
thence North 25 Degrees 51 Minutes 23 Seconds East	186.5 feet
thence North 22 Degrees 53 Minutes 40 Seconds East	169.6 feet
thence North 18 Degrees 41 Minutes 55 Seconds East	145.8 feet
thence North 18 Degrees 10 Minutes 11 Seconds East	143.6 feet
thence North 18 Degrees 18 Minutes 44 Seconds East	105.6 feet
thence North 19 Degrees 52 Minutes 37 Seconds East	33.2 feet
thence North 24 Degrees 06 Minutes 02 Seconds East	349.6 feet
thence North 21 Degrees 20 Minutes 50 Seconds East	164.2 feet
thence North 20 Degrees 53 Minutes 24 Seconds East	154.9 feet
thence North 23 Degrees 06 Minutes 54 Seconds East	84.1 feet
thence North 18 Degrees 56 Minutes 31 Seconds East	13.9 feet
thence North 26 Degrees 13 Minutes 01 Seconds East	14.7 feet
thence North 31 Degrees 59 Minutes 58 Seconds East	69.9 feet
thence North 17 Degrees 41 Minutes 59 Seconds East	153.6 feet

thence North 09 Degrees 59 Minutes 32 Seconds East 190.1 feet
thence North 00 Degrees 35 Minutes 11 Seconds West 78.7 feet
thence North 20 Degrees 25 Minutes 27 Seconds East 50.9 feet
thence North 11 Degrees 18 Minutes 41 Seconds East 105.5 feet
thence North 14 Degrees 55 Minutes 41 Seconds East 158.2 feet more or less to **the ending**
point at: 40 degrees 50 minutes 01.46 seconds North Latitude and -113 degrees 03 minutes 13.39 seconds
West Longitude, which can be converted to mapping accuracy State Plane Utah Central Zone NAD 83 feet
coordinates of X = 1,210,462.2 feet and Y = 7,476,186.7 feet.