

**Acknowledgment and  
Notice of Acknowledgment  
of Acceptance of R.S. 2477  
Right-of-Way Grant**

Ent: 309556 - Pg 1 of 13  
Date: 6/23/2008 12:52 PM  
Fee: \$0.00 NO CHARGE  
Filed By: RGL  
CALLEEN B PESHELL, Recorder  
Tooele County Corporation  
For: STATE OF UT GOVERNORS OFF

**THE STATE OF UTAH**

**TO ALL WHOM THESE PRESENTS SHALL COME, Greeting:**

**Know ye,** This is an Acknowledgment and Notice of Acknowledgment made under Utah Code Sections 72-5-309 through 310 inclusive, that the grant of the United States of America of "the right of way for the construction of highways over public lands, not reserved for public uses" under United States Revised Statutes 2477 (43 U.S.C. Section 932 (repealed October 21, 1976, with proviso recognizing the validity of rights-of-way already established)) was accepted for and on behalf of the State of Utah and its political subdivision Tooele County as it pertains to the highway located in Tooele County known as Eight Mile Spring Road; County Road Number: tc02450; State Geographic Information Database (SGID) Road Identification Number: RD230074. Total road length is 9.01 miles more or less.

The reason for this Acknowledgment and Notice of Acknowledgment includes, but is not limited to, the fact that the road was constructed, mechanically, or by continuous use as a public highway for a period of at least ten years, over public lands not reserved for public uses, prior to the earlier of (a) the October 21, 1976 repeal of R.S. 2477 or (b) the date the servient estate was reserved for public uses.

This Acknowledgment and Notice of Acknowledgment applies only to the segments of the road that traverse land owned by the Bureau of Land Management, United States Department of the Interior, and does not apply to segments of the road that traverse land owned by any other person or entity. The State of Utah and its political subdivisions reserve the right to make further acknowledgments and notices of acknowledgment with regard to road segments that traverse land owned by other entities, including the United States of America, through one or more of its agencies.

A printed copy of a map showing the location of the road in said county is appended hereto as "Attachment 1," a printed copy of representative photos of the road is appended hereto as "Attachment 2," a printed copy of a description of the beginning and ending points of the entire road together with a list of Townships, Ranges and Sections that may be traversed by the road in said county is appended hereto as "Attachment 3," and a printed copy of the Road Centerline Description Cover Page(s) is appended hereto as "Attachment 4." The Appendices listed in "Attachment 4" that contain the actual road centerline descriptions are incorporated herein by reference. Affidavits provided by individuals familiar with the road are appended hereto as "Attachment 5."

A printed copy of this Acknowledgment and Notice of Acknowledgment, together with its Attachments and Appendices, may be viewed and/or obtained at the office of the Utah State Archives.

An electronic copy of this Acknowledgment and Notice of Acknowledgment, together with its Attachments and Appendices, may be viewed and/or downloaded as read-only PDF (Portable Document Format) files via the

Internet at <http://recorded2477roads.utah.gov>.

The owner of the servient estate in the land underlying the road-segments subject to this Acknowledgment and Notice is believed to be the United States of America through one or more of its agencies. Any of such agencies or any other person with a servient ownership claim or a competing dominant estate right-of-way ownership claim, may file a petition in the State District Court for Salt Lake County for a decision regarding the correctness of this Acknowledgment. A claimant shall file a petition within sixty (60) days after receipt of this Notice.

**In Witness Whereof**, I, John Harja, the official designee of the Governor of the State of Utah, in conformity to the laws of the State (Utah Code Sections 72-5-308 through 310 inclusive), have caused this Acknowledgment and Notice of Acknowledgment to be made.

Signed by my hand in Salt Lake City, Utah, the 20<sup>th</sup> day of JUNE, 2008.

By the Governor's Designee

  
John Harja

### CERTIFICATION

State of Utah )  
: ss  
County of Salt Lake )

I hereby certify that the signer of the foregoing document, John Harja, is personally known by me, has made a voluntary signature and taken an oath stating that he is the official designee of the Governor of the State of Utah and is authorized to sign this document on the Governor's behalf pursuant to Utah Code Section 72-5-309. He further vouched that, based upon information and belief, the facts alleged therein are true.



Dated this 20<sup>th</sup> day of June, 2008.

  
Notary Public





**Land Ownership Categories**

- BLM
- Private
- SITLA, State Trust Land
- USFS, National Forest
- State Parks and Recreation
- Tribal, Indian Reservation
- NPS, National Park
- Wilderness
- UDWR, Wildlife Reserve
- DOD, Military
- State Sovereign Land
- National Recreation Area
- USFWS, Natl. Wildlife Refuge

**Transportation Network**

- Eight Mile Spring Road
- Other Roads
- Title V: Issued Or Under Consideration By BLM
- Photo Event Point
- Section = 1 Mile

**Eight Mile Spring Road - Tooele County**  
**SGID RD\_ID RD230074**

Map prepared by the State of Utah  
Automated Geographic Reference Center  
Room 5130 State Office Building  
Salt Lake City, Utah 84114  
Jun 16, 2008

Ent: 309556 - Pg 3 of 13

1:51,350  
1 inch equals 0.8 miles

UTAH  
AGRC



Ent: 309556 - Pg 4 of 13



EP230074003



EP230074004



EP230074006



EP230074009

EP000000000

EP000000000

**Eight Mile Spring Road - Tooele County**  
**SGID RD\_ID RD230074**

Map prepared by the State of Utah  
Automated Geographic Reference Center  
Room 5130 State Office Building  
Salt Lake City, Utah 84114  
June 18, 2008



### Attachment 3

#### **Beginning & Ending Points and Township, Range, and Section References For:**

**Popular Name: Eight Mile Spring Road**

**County: Tooele**

**County Road Number: tc02450**

**State Geographic Information Database (SGID) Road Identification Number: RD230074.**

**Total Road Length: 9.01 miles more or less.**

**Beginning at a point** on the road centerline located at 40 degrees 33 minutes 047.6 seconds North Latitude and -112 degrees 53 minutes 30.62 seconds West Longitude, which can be converted to mapping accuracy State Plane Utah Central Zone NAD 83 feet coordinates of X = 1,253,721.2 feet and Y = 7,376,902.8 feet based on the US Survey Foot conversion.

**Ending at a point** on the road centerline located at 40 degrees 30 minutes 48.79 seconds North Latitude and -112 degrees 44 minutes 51.65 seconds West Longitude, which can be converted to mapping accuracy State Plane Utah Central Zone NAD 83 feet coordinates of X = 1,293,517.6 feet and Y = 7,358,218.1 feet based on the US Survey Foot conversion.

This road may traverse:

Township 3 South Range 8 West, Section(s) 19,30,31,32,33, Salt Lake Base & Meridian

Township 3 South Range 9 West, Section(s) 14,15,16,17,23,24, Salt Lake Base & Meridian

See Attachment 1 above for a cartographic depiction of the course of this road.

## Attachment 4

### Road Centerline Description Cover Page(s)

**Popular Name:** Eight Mile Spring Road

**County:** Tooele

**County Road Number:** tc02450

**State Geographic Information Database (SGID) Road Identification Number:** RD230074.

**Total Road Length:** 9.01 miles more or less.

**Centerline Descriptions Of Road-Segments That Cross Over Federally Owned Land, Derived From Global Positioning System Data And Cross-checked against USGS Digital Orthophoto Quadrangles Compiled By The Utah Automated Geographic Reference Center And Entered Into The State Geographic Information Database (SGID).**

<b>Road-Segments Listed by SGID Road Identification Number (RD_ID)</b>	<b>Road-Segment Numbers</b>	<b>Believed Ownership Of Servient Estate</b>	<b>Approximate Segment Length</b>	<b>See Attached Appendix</b>
<b>RD230074</b>	<b>001</b>	<b>PVT</b>	<b>0.31 Miles</b>	<b>(not shown)</b>
<b>RD230074</b>	<b>002</b>	<b>BLM</b>	<b>0.6 Miles</b>	<b>A</b>
<b>RD230074</b>	<b>003</b>	<b>PVT</b>	<b>1.04 Miles</b>	<b>(not shown)</b>
<b>RD230074</b>	<b>004</b>	<b>BLM</b>	<b>4.3 Miles</b>	<b>B</b>
<b>RD230074</b>	<b>005</b>	<b>PVT</b>	<b>0.81 Miles</b>	<b>(not shown)</b>
<b>RD230074</b>	<b>006</b>	<b>ST</b>	<b>1.16 Miles</b>	<b>(not shown)</b>
<b>RD230074</b>	<b>007</b>	<b>PVT</b>	<b>0.79 Miles</b>	<b>(not shown)</b>
		<b>Total Road Length</b>	<b>9.01</b>	<b>_____</b>

\* Indicates that a Title V permit will be requested, is in process, or has been issued.

† Indicates that road-segments crossing Forest Service land are under consideration by the state and county as of the date of this Acknowledgment and Notice of Acknowledgment.

## **Attachment 5**



**AFFIDAVIT OF LEE F. NIX**  
**EIGHTMILE SPRING ROAD**  
**TOOELE COUNTY, UTAH**  
**ROAD NUMBER tc02450**

State of Utah                                 )  
  : ss.  
County of Tooele                         )

LEE F. NIX, being first duly sworn, deposes and states as follows:

1.       I am an adult competent to testify about the matters set forth below based upon my personal knowledge. I currently reside in Tooele, Tooele County, Utah. I was born and raised in Tooele County and have lived here all of my life for 80 years.

2.       I have traveled and am familiar with a road in Tooele County known as Eightmile Spring Road. I am also familiar with the land the road traverses. When I first used and observed the road in the Late 1930s it followed the same route as in 2007 when I last observed it.

Attached is a Tooele County map showing Eightmile Spring Road. To the best of my knowledge and based upon my use of and familiarity with this road and the land it traverses, the location and route of the road are correctly illustrated on the attached map.

3.       I am informed that the County also identifies this road according to the road number listed above.

4.       I have observed that the road has been open to the public for all to use, to come and go as they pleased, since at least as early as the late 1930s and continuing through 2007. During this time period I have observed travel on the road by means of cars, pickup trucks and ATVs. During this time period, the road was used daily, weather permitting, for more than ten continuous years prior to 1976 and was so used in 2007.



5. During the time period from the late 1930s to 2007, I have used the road myself for sightseeing and recreation, hunting, trapping and travel in and through the area.

6. During the time period described in the previous paragraph, I have observed other vehicles from the general public using the road at various times for the uses described in the previous paragraph plus livestock operations.

7. It is also the reputation in the community that this road has been open to the public for all to use, to come and go as they pleased, since at least as early as the early 1900s and continuing through 1976 to the present, for the uses described in the previous paragraphs.

8. Prior to 1976, I observed the graded surface of the road and other evidence of maintenance and construction such as berms along the side of the road.

DATED this 1 day of May, 2008.

  
LEE F. NIX

SUBSCRIBED AND SWORN to before me this 1st day of May, 2008.

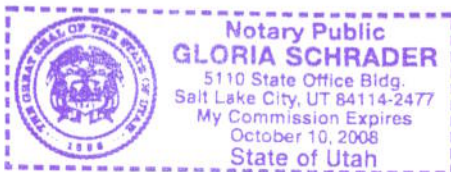

  
NOTARY PUBLIC



Ent: 309556 - Page 10 of 13



1:51,350  
1 inch equals 0.8 miles



Map prepared by the State of Utah  
Automated Geographic Reference Center  
Room 5130 State Office Building  
Salt Lake City, Utah 84114  
Apr 18, 2008



# **Tooele County** **Eightmile Spring Road** **County Unique - tc02450**

**Transportation Network**  
 Eightmile Spring Road  
 State / U.S. Highway  
 Local Roads

**Land Ownership Categories**  
 BLM  
 Private  
 SITLA, State Trust Land  
 USFS, National Forest  
 State Park

**Misc**  
 City / Town  
 Municipalities  
 Section = 1 Mile

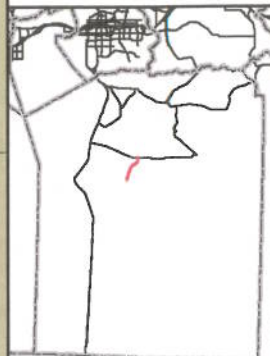



**AFFIDAVIT OF JOHN W. ARBON**

**EIGHTMILE SPRING ROAD**

**TOOELE COUNTY, UTAH**

**ROAD NUMBER tc02450**

State of Utah                     )  
  : ss.  
County of Tooele                )

JOHN W. ARBON, being first duly sworn, deposes and states as follows:

1.       I am an adult competent to testify about the matters set forth below based upon my personal knowledge. I currently reside in Salt Lake City, Utah. I was born and raised in Tooele County and have owned property in the Grantsville area of Tooele County for over 50 years. I have been familiar with Tooele County for all of my life of 74 years.

2.       I have traveled and am familiar with a road in Tooele County known as Eightmile Spring Road. I am also familiar with the land the road traverses. When I first used and observed the road in the early 1960s it followed the same route as in 2004 when I last observed it. Attached is a Tooele County map showing Eightmile Spring Road. To the best of my knowledge and based upon my use of and familiarity with this road and the land it traverses, the location and route of the road are correctly illustrated on the attached map.

3.       I am informed that the County also identifies this road according to the road number listed above.

4.       I have observed that the road has been open to the public for all to use, to come and go as they pleased, since at least as early as the early 1960s and continuing through 2004. During this time period I have observed travel on the road by means of cars, pickup trucks and ATVs. During this time period, the road was used daily, weather permitting, for more than ten continuous years prior to 1976 and was so used in 2004.



5. During the time period from the early 1960s to 2004, I have used the road myself for sightseeing and recreation, hunting and travel in and through the area.

6. During the time period described in the previous paragraph, I have observed other vehicles from the general public using the road at various times for the uses described in the previous paragraph plus livestock operations and trapping.

7. It is also the reputation in the community that this road has been open to the public for all to use, to come and go as they pleased, since at least as early as the early 1900s and continuing through 1976 to the present, for the uses described in the previous paragraphs.

8. Prior to 1976, I observed the graded surface of the road and other evidence of maintenance and construction such as berms along the side of the road.

DATED this 1 day of May, 2008.



JOHN W. ARBON

SUBSCRIBED AND SWORN to before me this 1st day of May, 2008.

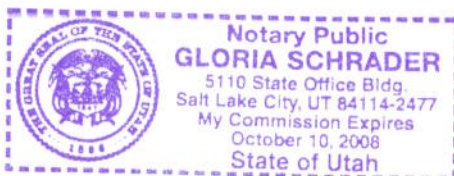
  
NOTARY PUBLIC



1:51,350  
1 inch equals 0.8 miles



Map prepared by the State of Utah  
Automated Geographic Reference Center  
Room 5130 State Office Building  
Salt Lake City, Utah 84114  
Apr 18, 2008



### Tooele County Eightmile Spring Road County Unique - tc02450

**Transportation Network**

- Eightmile Spring Road
- State / U.S. Highway
- Local Roads

**Misc**

- City / Town
- Municipalities
- Section = 1 Mile
- Wildlife Reserve
- Military
- Wilderness
- Tribal

**Land Ownership Categories**

- BLM
- Private
- SITLA, State Trust Land
- USFS, National Forest
- State Park





## Appendix A to Attachment 4

**Popular Name: Eight Mile Spring Road**

**County: Tooele**

**County Road Number: tc02450**

**State Geographic Information Database (SGID) Road Identification Number: RD230074.**

**Road-Segment Number: 002**

**Road-Segment Length: 0.6 miles more or less.**

**Believed owner of the land underlying this road-segment is: Bureau of Land Management.**

*The following description is based upon the geographic coordinate system using the NAD83 Datum. The source is GPS mapping grade data as indicated in the metadata and/or the transportation data model of the State of Utah Geographic Information Database (SGID).*

The road-segment itself is the monument that is identified by its physical presence on the land. The location of said physical presence is closely approximated by mapping grade Global Positioning System (GPS) data. Said data are checked against the corresponding gray-scale 1-meter Digital Orthophoto Quadrangles published by the United States Geological Survey (USGS) to verify a reasonable degree of accuracy. In circumstances where accurate satellite signal acquisition is not possible, such as deep, narrow canyons or under a canopy of dense foliage, or where very sharp curves in the road make accuracy questionable, such portions of the road were digitized from the corresponding gray-scale 1-meter Digital Orthophoto Quadrangles published by the United States Geological Survey (USGS).

This road-segment may traverse:

Township 3 South Range 9 West, Section(s) 17, Salt Lake Base & Meridian

The following description closely approximates the location of the centerline of the physical monument (Eight Mile Spring Road)-- Segment 002 based on mapping grade Global Positioning System (GPS) data as defined above:

**Beginning at a point** on the road center line located at 40 degrees 33 minutes 51.61 seconds North Latitude and -112 degrees 53 minutes 11.59 seconds West Longitude, which can be converted to mapping accuracy State Plane Utah Central Zone NAD 83 feet coordinates of X = 1,255,195.9 feet and Y = 7,377,285.6 feet; thence the following courses along the said road center line:

thence North 89 Degrees 39 Minutes 39 Seconds East	15.4 feet
thence South 79 Degrees 18 Minutes 55 Seconds East	25.7 feet
thence South 65 Degrees 13 Minutes 26 Seconds East	23.2 feet
thence South 52 Degrees 13 Minutes 52 Seconds East	21.3 feet
thence South 29 Degrees 44 Minutes 45 Seconds East	20.7 feet
thence South 17 Degrees 02 Minutes 17 Seconds East	20.6 feet
thence South 00 Degrees 28 Minutes 46 Seconds West	23 feet
thence South 01 Degrees 11 Minutes 19 Seconds West	24.6 feet
thence South 03 Degrees 54 Minutes 54 Seconds East	26.3 feet
thence South 17 Degrees 02 Minutes 17 Seconds East	27.4 feet
thence South 21 Degrees 31 Minutes 12 Seconds East	28.2 feet



thence South 35 Degrees 52 Minutes 35 Seconds East	28.2 feet
thence South 32 Degrees 20 Minutes 39 Seconds East	31 feet
thence South 34 Degrees 01 Minutes 44 Seconds East	29.6 feet
thence South 36 Degrees 53 Minutes 01 Seconds East	34.7 feet
thence South 33 Degrees 43 Minutes 00 Seconds East	33.4 feet
thence South 40 Degrees 22 Minutes 08 Seconds East	32.1 feet
thence South 43 Degrees 52 Minutes 12 Seconds East	36.2 feet
thence South 47 Degrees 53 Minutes 30 Seconds East	36.5 feet
thence South 50 Degrees 13 Minutes 05 Seconds East	38.2 feet
thence South 54 Degrees 00 Minutes 43 Seconds East	41.5 feet
thence South 55 Degrees 52 Minutes 40 Seconds East	40.6 feet
thence South 59 Degrees 17 Minutes 49 Seconds East	41.4 feet
thence South 62 Degrees 47 Minutes 09 Seconds East	42.6 feet
thence South 69 Degrees 08 Minutes 09 Seconds East	40.8 feet
thence South 76 Degrees 31 Minutes 25 Seconds East	41.2 feet
thence South 83 Degrees 19 Minutes 46 Seconds East	40.3 feet
thence South 85 Degrees 48 Minutes 03 Seconds East	82.9 feet
thence South 86 Degrees 06 Minutes 08 Seconds East	44.4 feet
thence South 84 Degrees 02 Minutes 41 Seconds East	44.9 feet
thence South 81 Degrees 54 Minutes 42 Seconds East	44.8 feet
thence South 81 Degrees 54 Minutes 42 Seconds East	44.8 feet
thence South 79 Degrees 50 Minutes 50 Seconds East	45 feet
thence South 73 Degrees 50 Minutes 04 Seconds East	46.2 feet
thence South 71 Degrees 06 Minutes 29 Seconds East	44.8 feet
thence South 71 Degrees 46 Minutes 32 Seconds East	46.4 feet
thence South 71 Degrees 54 Minutes 13 Seconds East	46.7 feet
thence South 72 Degrees 38 Minutes 18 Seconds East	48.6 feet
thence South 72 Degrees 38 Minutes 18 Seconds East	48.6 feet
thence South 70 Degrees 00 Minutes 56 Seconds East	47.2 feet
thence South 73 Degrees 25 Minutes 36 Seconds East	50.8 feet
thence South 72 Degrees 38 Minutes 18 Seconds East	48.6 feet
thence South 73 Degrees 25 Minutes 36 Seconds East	50.8 feet
thence South 72 Degrees 38 Minutes 18 Seconds East	48.6 feet
thence South 73 Degrees 25 Minutes 36 Seconds East	50.8 feet
thence South 72 Degrees 38 Minutes 18 Seconds East	48.6 feet
thence South 72 Degrees 38 Minutes 18 Seconds East	48.6 feet
thence South 72 Degrees 38 Minutes 18 Seconds East	48.6 feet
thence South 72 Degrees 38 Minutes 18 Seconds East	48.6 feet
thence South 70 Degrees 00 Minutes 56 Seconds East	47.2 feet
thence South 71 Degrees 54 Minutes 13 Seconds East	46.7 feet
thence South 71 Degrees 46 Minutes 32 Seconds East	46.4 feet
thence South 73 Degrees 50 Minutes 03 Seconds East	46.2 feet
thence South 73 Degrees 50 Minutes 03 Seconds East	46.2 feet
thence South 71 Degrees 54 Minutes 13 Seconds East	46.7 feet
thence South 72 Degrees 59 Minutes 05 Seconds East	44 feet
thence South 73 Degrees 06 Minutes 40 Seconds East	44.3 feet
thence South 70 Degrees 58 Minutes 08 Seconds East	44.5 feet
thence South 73 Degrees 06 Minutes 40 Seconds East	44.3 feet
thence South 72 Degrees 59 Minutes 05 Seconds East	44 feet

thence South 72 Degrees 59 Minutes 05 Seconds East 44 feet  
 thence South 74 Degrees 19 Minutes 52 Seconds East 41.6 feet  
 thence South 73 Degrees 06 Minutes 40 Seconds East 44.3 feet  
 thence South 72 Degrees 59 Minutes 04 Seconds East 44 feet  
 thence South 72 Degrees 59 Minutes 04 Seconds East 44 feet  
 thence South 72 Degrees 11 Minutes 09 Seconds East 42.1 feet  
 thence South 73 Degrees 06 Minutes 40 Seconds East 44.3 feet  
 thence South 72 Degrees 11 Minutes 09 Seconds East 42.1 feet  
 thence South 75 Degrees 02 Minutes 44 Seconds East 43.5 feet  
 thence South 75 Degrees 09 Minutes 31 Seconds East 43.9 feet  
 thence South 72 Degrees 11 Minutes 09 Seconds East 42.1 feet  
 thence South 72 Degrees 02 Minutes 45 Seconds East 41.8 feet  
 thence South 72 Degrees 11 Minutes 09 Seconds East 42.1 feet  
 thence South 72 Degrees 11 Minutes 09 Seconds East 42.1 feet  
 thence South 74 Degrees 19 Minutes 52 Seconds East 41.6 feet  
 thence South 69 Degrees 08 Minutes 09 Seconds East 40.8 feet  
 thence South 71 Degrees 09 Minutes 34 Seconds East 39.9 feet  
 thence South 73 Degrees 33 Minutes 50 Seconds East 7.2 feet more or less to **the ending point**

**at:** 40 degrees 33 minutes 40.47 seconds North Latitude and -112 degrees 52 minutes 35.32 seconds West Longitude, which can be converted to mapping accuracy State Plane Utah Central Zone NAD 83 feet coordinates of X = 1,257,977.2 feet and Y = 7,376,115.5 feet.



## Appendix B to Attachment 4

**Popular Name: Eight Mile Spring Road**

**County: Tooele**

**County Road Number: tc02450**

**State Geographic Information Database (SGID) Road Identification Number: RD230074.**

**Road-Segment Number: 004**

**Road-Segment Length: 4.3 miles more or less.**

**Believed owner of the land underlying this road-segment is: Bureau of Land Management.**

*The following description is based upon the geographic coordinate system using the NAD83 Datum. The source is GPS mapping grade data as indicated in the metadata and/or the transportation data model of the State of Utah Geographic Information Database (SGID).*

The road-segment itself is the monument that is identified by its physical presence on the land. The location of said physical presence is closely approximated by mapping grade Global Positioning System (GPS) data. Said data are checked against the corresponding gray-scale 1-meter Digital Orthophoto Quadrangles published by the United States Geological Survey (USGS) to verify a reasonable degree of accuracy. In circumstances where accurate satellite signal acquisition is not possible, such as deep, narrow canyons or under a canopy of dense foliage, or where very sharp curves in the road make accuracy questionable, such portions of the road were digitized from the corresponding gray-scale 1-meter Digital Orthophoto Quadrangles published by the United States Geological Survey (USGS).

This road-segment may traverse:

Township 3 South Range 8 West, Section(s) 19,30, Salt Lake Base & Meridian

Township 3 South Range 9 West, Section(s) 14,15,23,24, Salt Lake Base & Meridian

The following description closely approximates the location of the centerline of the physical monument (Eight Mile Spring Road)-- Segment 004 based on mapping grade Global Positioning System (GPS) data as defined above:

**Beginning at a point** on the road center line located at 40 degrees 33 minutes 25.23 seconds North Latitude and -112 degrees 51 minutes 26.83 seconds West Longitude, which can be converted to mapping accuracy State Plane Utah Central Zone NAD 83 feet coordinates of X = 1,263,239.6 feet and Y = 7,374,492.0 feet; thence the following courses along the said road center line:

thence South 75 Degrees 03 Minutes 51 Seconds East	26.2 feet
thence South 72 Degrees 59 Minutes 03 Seconds East	44 feet
thence South 73 Degrees 06 Minutes 39 Seconds East	44.3 feet
thence South 73 Degrees 50 Minutes 02 Seconds East	46.2 feet
thence South 72 Degrees 59 Minutes 03 Seconds East	44 feet
thence South 70 Degrees 58 Minutes 07 Seconds East	44.5 feet
thence South 73 Degrees 50 Minutes 02 Seconds East	46.2 feet
thence South 71 Degrees 54 Minutes 12 Seconds East	46.7 feet
thence South 73 Degrees 50 Minutes 02 Seconds East	46.2 feet
thence South 72 Degrees 38 Minutes 16 Seconds East	48.6 feet



thence South 73 Degrees 50 Minutes 02 Seconds East	46.2 feet
thence South 71 Degrees 54 Minutes 12 Seconds East	46.7 feet
thence South 73 Degrees 43 Minutes 03 Seconds East	45.9 feet
thence South 71 Degrees 54 Minutes 12 Seconds East	46.7 feet
thence South 72 Degrees 45 Minutes 17 Seconds East	48.9 feet
thence South 72 Degrees 38 Minutes 16 Seconds East	48.6 feet
thence South 71 Degrees 54 Minutes 12 Seconds East	46.7 feet
thence South 72 Degrees 38 Minutes 16 Seconds East	48.6 feet
thence South 72 Degrees 38 Minutes 16 Seconds East	48.6 feet
thence South 72 Degrees 38 Minutes 16 Seconds East	48.6 feet
thence South 74 Degrees 36 Minutes 22 Seconds East	48.4 feet
thence South 72 Degrees 38 Minutes 16 Seconds East	48.6 feet
thence South 73 Degrees 19 Minutes 04 Seconds East	50.4 feet
thence South 72 Degrees 45 Minutes 17 Seconds East	48.9 feet
thence South 72 Degrees 38 Minutes 16 Seconds East	48.6 feet
thence South 72 Degrees 38 Minutes 16 Seconds East	48.6 feet
thence South 73 Degrees 25 Minutes 34 Seconds East	50.8 feet
thence South 72 Degrees 38 Minutes 16 Seconds East	48.6 feet
thence South 72 Degrees 45 Minutes 17 Seconds East	48.9 feet
thence South 70 Degrees 41 Minutes 04 Seconds East	48.8 feet
thence South 72 Degrees 45 Minutes 17 Seconds East	48.9 feet
thence South 74 Degrees 30 Minutes 01 Seconds East	48.1 feet
thence South 72 Degrees 38 Minutes 16 Seconds East	48.6 feet
thence South 73 Degrees 50 Minutes 02 Seconds East	46.2 feet
thence South 73 Degrees 50 Minutes 02 Seconds East	46.2 feet
thence South 74 Degrees 30 Minutes 01 Seconds East	48.1 feet
thence South 71 Degrees 54 Minutes 12 Seconds East	46.7 feet
thence South 72 Degrees 38 Minutes 16 Seconds East	48.6 feet
thence South 72 Degrees 45 Minutes 17 Seconds East	48.9 feet
thence South 72 Degrees 38 Minutes 16 Seconds East	48.6 feet
thence South 73 Degrees 25 Minutes 34 Seconds East	50.8 feet
thence South 71 Degrees 33 Minutes 11 Seconds East	50.9 feet
thence South 73 Degrees 25 Minutes 34 Seconds East	50.8 feet
thence South 73 Degrees 25 Minutes 34 Seconds East	50.8 feet
thence South 72 Degrees 21 Minutes 03 Seconds East	53.1 feet
thence South 73 Degrees 19 Minutes 03 Seconds East	50.4 feet
thence South 72 Degrees 21 Minutes 03 Seconds East	53.1 feet
thence South 71 Degrees 40 Minutes 16 Seconds East	51.3 feet
thence South 74 Degrees 02 Minutes 58 Seconds East	52.6 feet
thence South 70 Degrees 48 Minutes 47 Seconds East	49.1 feet
thence South 73 Degrees 25 Minutes 34 Seconds East	50.8 feet
thence South 73 Degrees 25 Minutes 34 Seconds East	50.8 feet
thence South 72 Degrees 38 Minutes 16 Seconds East	48.6 feet
thence South 72 Degrees 38 Minutes 16 Seconds East	48.6 feet
thence South 74 Degrees 30 Minutes 00 Seconds East	48.1 feet
thence South 75 Degrees 48 Minutes 13 Seconds East	45.8 feet
thence South 71 Degrees 54 Minutes 11 Seconds East	46.7 feet
thence South 75 Degrees 09 Minutes 30 Seconds East	43.9 feet
thence South 74 Degrees 19 Minutes 51 Seconds East	41.6 feet



thence South 67 Degrees 54 Minutes 18 Seconds East	38.7 feet
thence South 56 Degrees 21 Minutes 07 Seconds East	35.2 feet
thence South 52 Degrees 02 Minutes 53 Seconds East	31.8 feet
thence South 54 Degrees 48 Minutes 02 Seconds East	28.2 feet
thence South 60 Degrees 56 Minutes 31 Seconds East	26.7 feet
thence South 70 Degrees 27 Minutes 57 Seconds East	29 feet
thence South 83 Degrees 59 Minutes 53 Seconds East	29.7 feet
thence North 86 Degrees 42 Minutes 39 Seconds East	31.9 feet
thence North 89 Degrees 39 Minutes 42 Seconds East	34.1 feet
thence South 87 Degrees 42 Minutes 42 Seconds East	35.8 feet
thence South 82 Degrees 34 Minutes 23 Seconds East	36.4 feet
thence South 77 Degrees 32 Minutes 02 Seconds East	37 feet
thence South 79 Degrees 56 Minutes 27 Seconds East	36.4 feet
thence South 79 Degrees 56 Minutes 27 Seconds East	36.4 feet
thence South 75 Degrees 04 Minutes 59 Seconds East	37.4 feet
thence South 70 Degrees 18 Minutes 26 Seconds East	33.5 feet
thence South 62 Degrees 49 Minutes 34 Seconds East	35.5 feet
thence South 63 Degrees 30 Minutes 58 Seconds East	32.7 feet
thence South 65 Degrees 13 Minutes 24 Seconds East	34.8 feet
thence South 67 Degrees 43 Minutes 06 Seconds East	34.1 feet
thence South 70 Degrees 11 Minutes 11 Seconds East	38.1 feet
thence South 75 Degrees 04 Minutes 59 Seconds East	37.4 feet
thence South 74 Degrees 12 Minutes 19 Seconds East	41.3 feet
thence South 71 Degrees 18 Minutes 45 Seconds East	40.3 feet
thence South 72 Degrees 11 Minutes 07 Seconds East	42.1 feet
thence South 72 Degrees 59 Minutes 03 Seconds East	44 feet
thence South 72 Degrees 19 Minutes 24 Seconds East	42.4 feet
thence South 75 Degrees 02 Minutes 42 Seconds East	43.5 feet
thence South 72 Degrees 59 Minutes 03 Seconds East	44 feet
thence South 71 Degrees 54 Minutes 11 Seconds East	46.7 feet
thence South 71 Degrees 54 Minutes 11 Seconds East	46.7 feet
thence South 73 Degrees 50 Minutes 01 Seconds East	46.2 feet
thence South 72 Degrees 38 Minutes 15 Seconds East	48.6 feet
thence South 72 Degrees 38 Minutes 15 Seconds East	48.6 feet
thence South 72 Degrees 45 Minutes 16 Seconds East	48.9 feet
thence South 74 Degrees 30 Minutes 00 Seconds East	48.1 feet
thence South 73 Degrees 25 Minutes 33 Seconds East	50.8 feet
thence South 72 Degrees 38 Minutes 15 Seconds East	48.6 feet
thence South 70 Degrees 48 Minutes 47 Seconds East	49.1 feet
thence South 73 Degrees 25 Minutes 33 Seconds East	50.8 feet
thence South 73 Degrees 19 Minutes 03 Seconds East	50.4 feet
thence South 73 Degrees 25 Minutes 33 Seconds East	50.8 feet
thence South 72 Degrees 38 Minutes 15 Seconds East	48.6 feet
thence South 73 Degrees 25 Minutes 33 Seconds East	50.8 feet
thence South 72 Degrees 38 Minutes 15 Seconds East	48.6 feet
thence South 73 Degrees 25 Minutes 33 Seconds East	50.8 feet
thence South 71 Degrees 40 Minutes 16 Seconds East	51.3 feet
thence South 73 Degrees 19 Minutes 03 Seconds East	50.4 feet
thence South 73 Degrees 25 Minutes 33 Seconds East	50.8 feet



thence South 71 Degrees 40 Minutes 16 Seconds East	51.3 feet
thence South 74 Degrees 02 Minutes 57 Seconds East	52.6 feet
thence South 72 Degrees 21 Minutes 02 Seconds East	53.1 feet
thence South 74 Degrees 02 Minutes 57 Seconds East	52.6 feet
thence South 71 Degrees 40 Minutes 16 Seconds East	51.3 feet
thence South 73 Degrees 19 Minutes 03 Seconds East	50.4 feet
thence South 72 Degrees 21 Minutes 02 Seconds East	53.1 feet
thence South 73 Degrees 25 Minutes 33 Seconds East	50.8 feet
thence South 71 Degrees 40 Minutes 16 Seconds East	51.3 feet
thence South 73 Degrees 19 Minutes 03 Seconds East	50.4 feet
thence South 71 Degrees 40 Minutes 16 Seconds East	51.3 feet
thence South 73 Degrees 25 Minutes 33 Seconds East	50.8 feet
thence South 73 Degrees 25 Minutes 33 Seconds East	50.8 feet
thence South 73 Degrees 18 Minutes 50 Seconds East	10.5 feet
thence South 73 Degrees 19 Minutes 06 Seconds East	39.9 feet
thence South 71 Degrees 40 Minutes 16 Seconds East	51.3 feet
thence South 74 Degrees 02 Minutes 57 Seconds East	52.6 feet
thence South 72 Degrees 21 Minutes 02 Seconds East	53.1 feet
thence South 72 Degrees 21 Minutes 02 Seconds East	53.1 feet
thence South 74 Degrees 02 Minutes 57 Seconds East	52.6 feet
thence South 72 Degrees 21 Minutes 02 Seconds East	53.1 feet
thence South 73 Degrees 05 Minutes 07 Seconds East	55.3 feet
thence South 72 Degrees 21 Minutes 02 Seconds East	53.1 feet
thence South 74 Degrees 02 Minutes 57 Seconds East	52.6 feet
thence South 72 Degrees 21 Minutes 02 Seconds East	53.1 feet
thence South 73 Degrees 25 Minutes 33 Seconds East	50.8 feet
thence South 72 Degrees 21 Minutes 02 Seconds East	53.1 feet
thence South 71 Degrees 33 Minutes 11 Seconds East	50.9 feet
thence South 72 Degrees 21 Minutes 02 Seconds East	53.1 feet
thence South 73 Degrees 25 Minutes 33 Seconds East	50.8 feet
thence South 71 Degrees 40 Minutes 16 Seconds East	51.3 feet
thence South 74 Degrees 02 Minutes 57 Seconds East	52.6 feet
thence South 72 Degrees 38 Minutes 15 Seconds East	48.6 feet
thence South 71 Degrees 40 Minutes 16 Seconds East	51.3 feet
thence South 73 Degrees 25 Minutes 33 Seconds East	50.8 feet
thence South 72 Degrees 38 Minutes 15 Seconds East	48.6 feet
thence South 72 Degrees 38 Minutes 15 Seconds East	48.6 feet
thence South 74 Degrees 30 Minutes 00 Seconds East	48.1 feet
thence South 72 Degrees 45 Minutes 16 Seconds East	48.9 feet
thence South 71 Degrees 46 Minutes 29 Seconds East	46.4 feet
thence South 71 Degrees 54 Minutes 11 Seconds East	46.7 feet
thence South 73 Degrees 06 Minutes 38 Seconds East	44.3 feet
thence South 71 Degrees 54 Minutes 11 Seconds East	46.7 feet
thence South 72 Degrees 59 Minutes 02 Seconds East	44 feet
thence South 72 Degrees 59 Minutes 02 Seconds East	44 feet
thence South 73 Degrees 06 Minutes 37 Seconds East	44.3 feet
thence South 72 Degrees 11 Minutes 07 Seconds East	42.1 feet
thence South 72 Degrees 59 Minutes 02 Seconds East	44 feet
thence South 74 Degrees 19 Minutes 50 Seconds East	41.6 feet



thence South 72 Degrees 11 Minutes 07 Seconds East	42.1 feet
thence South 73 Degrees 06 Minutes 37 Seconds East	44.3 feet
thence South 72 Degrees 59 Minutes 02 Seconds East	44 feet
thence South 75 Degrees 48 Minutes 12 Seconds East	45.8 feet
thence South 73 Degrees 50 Minutes 01 Seconds East	46.2 feet
thence South 71 Degrees 54 Minutes 11 Seconds East	46.7 feet
thence South 73 Degrees 43 Minutes 02 Seconds East	45.9 feet
thence South 71 Degrees 54 Minutes 11 Seconds East	46.7 feet
thence South 72 Degrees 45 Minutes 16 Seconds East	48.9 feet
thence South 71 Degrees 46 Minutes 29 Seconds East	46.4 feet
thence South 74 Degrees 36 Minutes 21 Seconds East	48.4 feet
thence South 70 Degrees 48 Minutes 46 Seconds East	49.1 feet
thence South 73 Degrees 25 Minutes 33 Seconds East	50.8 feet
thence South 72 Degrees 38 Minutes 15 Seconds East	48.6 feet
thence South 73 Degrees 25 Minutes 33 Seconds East	50.8 feet
thence South 71 Degrees 33 Minutes 10 Seconds East	50.9 feet
thence South 73 Degrees 25 Minutes 33 Seconds East	50.8 feet
thence South 73 Degrees 25 Minutes 33 Seconds East	50.8 feet
thence South 73 Degrees 19 Minutes 02 Seconds East	50.4 feet
thence South 71 Degrees 40 Minutes 15 Seconds East	51.3 feet
thence South 73 Degrees 25 Minutes 33 Seconds East	50.8 feet
thence South 71 Degrees 33 Minutes 10 Seconds East	50.9 feet
thence South 71 Degrees 54 Minutes 10 Seconds East	46.7 feet
thence South 71 Degrees 54 Minutes 10 Seconds East	46.7 feet
thence South 72 Degrees 11 Minutes 06 Seconds East	42.1 feet
thence South 72 Degrees 32 Minutes 09 Seconds East	37.6 feet
thence South 71 Degrees 54 Minutes 10 Seconds East	31.1 feet
thence South 74 Degrees 48 Minutes 49 Seconds East	30.6 feet
thence South 72 Degrees 21 Minutes 02 Seconds East	26.6 feet
thence South 73 Degrees 04 Minutes 38 Seconds East	245 feet
thence South 73 Degrees 04 Minutes 49 Seconds East	169.7 feet
thence South 74 Degrees 56 Minutes 58 Seconds East	37.1 feet
thence South 72 Degrees 41 Minutes 16 Seconds East	37.9 feet
thence South 72 Degrees 32 Minutes 09 Seconds East	37.6 feet
thence South 71 Degrees 09 Minutes 32 Seconds East	40 feet
thence South 71 Degrees 18 Minutes 44 Seconds East	40.3 feet
thence South 74 Degrees 19 Minutes 49 Seconds East	41.6 feet
thence South 75 Degrees 02 Minutes 41 Seconds East	43.5 feet
thence South 71 Degrees 06 Minutes 26 Seconds East	44.8 feet
thence South 72 Degrees 59 Minutes 02 Seconds East	44 feet
thence South 73 Degrees 50 Minutes 00 Seconds East	46.2 feet
thence South 72 Degrees 38 Minutes 14 Seconds East	48.6 feet
thence South 74 Degrees 36 Minutes 21 Seconds East	48.4 feet
thence South 71 Degrees 46 Minutes 29 Seconds East	46.4 feet
thence South 75 Degrees 12 Minutes 50 Seconds East	50.3 feet
thence South 70 Degrees 48 Minutes 46 Seconds East	49.1 feet
thence South 72 Degrees 45 Minutes 15 Seconds East	48.9 feet
thence South 73 Degrees 25 Minutes 32 Seconds East	50.8 feet
thence South 73 Degrees 19 Minutes 02 Seconds East	50.4 feet



thence South 70 Degrees 48 Minutes 46 Seconds East	49.1 feet
thence South 73 Degrees 25 Minutes 32 Seconds East	50.8 feet
thence South 74 Degrees 02 Minutes 56 Seconds East	52.6 feet
thence South 71 Degrees 40 Minutes 15 Seconds East	51.3 feet
thence South 74 Degrees 02 Minutes 56 Seconds East	52.6 feet
thence South 72 Degrees 21 Minutes 01 Seconds East	53.1 feet
thence South 72 Degrees 21 Minutes 01 Seconds East	53.1 feet
thence South 74 Degrees 43 Minutes 19 Seconds East	54.9 feet
thence South 72 Degrees 21 Minutes 01 Seconds East	53.1 feet
thence South 73 Degrees 05 Minutes 06 Seconds East	55.3 feet
thence South 72 Degrees 59 Minutes 01 Seconds East	55 feet
thence South 74 Degrees 43 Minutes 19 Seconds East	54.9 feet
thence South 72 Degrees 06 Minutes 32 Seconds East	57.7 feet
thence South 72 Degrees 59 Minutes 01 Seconds East	55 feet
thence South 72 Degrees 06 Minutes 32 Seconds East	57.7 feet
thence South 71 Degrees 22 Minutes 02 Seconds East	55.5 feet
thence South 73 Degrees 05 Minutes 06 Seconds East	55.3 feet
thence South 72 Degrees 21 Minutes 01 Seconds East	53.1 feet
thence South 74 Degrees 02 Minutes 56 Seconds East	52.6 feet
thence South 69 Degrees 57 Minutes 06 Seconds East	51.8 feet
thence South 73 Degrees 25 Minutes 32 Seconds East	50.8 feet
thence South 70 Degrees 48 Minutes 46 Seconds East	49.1 feet
thence South 72 Degrees 38 Minutes 14 Seconds East	48.6 feet
thence South 72 Degrees 36 Minutes 45 Seconds East	29.3 feet
thence South 72 Degrees 40 Minutes 30 Seconds East	19.2 feet
thence South 73 Degrees 25 Minutes 32 Seconds East	50.8 feet
thence South 72 Degrees 38 Minutes 14 Seconds East	48.6 feet
thence South 71 Degrees 40 Minutes 15 Seconds East	51.3 feet
thence South 72 Degrees 38 Minutes 14 Seconds East	48.6 feet
thence South 72 Degrees 38 Minutes 14 Seconds East	48.6 feet
thence South 73 Degrees 50 Minutes 00 Seconds East	46.2 feet
thence South 72 Degrees 45 Minutes 15 Seconds East	48.9 feet
thence South 71 Degrees 46 Minutes 28 Seconds East	46.4 feet
thence South 74 Degrees 36 Minutes 20 Seconds East	48.4 feet
thence South 75 Degrees 02 Minutes 41 Seconds East	43.5 feet
thence South 71 Degrees 54 Minutes 10 Seconds East	46.7 feet
thence South 73 Degrees 50 Minutes 00 Seconds East	46.2 feet
thence South 70 Degrees 58 Minutes 04 Seconds East	44.5 feet
thence South 74 Degrees 36 Minutes 20 Seconds East	48.4 feet
thence South 73 Degrees 50 Minutes 00 Seconds East	46.2 feet
thence South 72 Degrees 38 Minutes 14 Seconds East	48.6 feet
thence South 74 Degrees 29 Minutes 59 Seconds East	48.1 feet
thence South 70 Degrees 48 Minutes 45 Seconds East	49.1 feet
thence South 73 Degrees 25 Minutes 32 Seconds East	50.8 feet
thence South 72 Degrees 45 Minutes 15 Seconds East	48.9 feet
thence South 71 Degrees 33 Minutes 09 Seconds East	50.9 feet
thence South 73 Degrees 25 Minutes 32 Seconds East	50.8 feet
thence South 73 Degrees 25 Minutes 32 Seconds East	50.8 feet
thence South 70 Degrees 48 Minutes 45 Seconds East	49.1 feet



thence South 72 Degrees 38 Minutes 14 Seconds East	48.6 feet
thence South 74 Degrees 29 Minutes 59 Seconds East	48.1 feet
thence South 71 Degrees 06 Minutes 25 Seconds East	44.8 feet
thence South 73 Degrees 50 Minutes 00 Seconds East	46.2 feet
thence South 72 Degrees 59 Minutes 01 Seconds East	44 feet
thence South 72 Degrees 59 Minutes 01 Seconds East	44 feet
thence South 71 Degrees 54 Minutes 10 Seconds East	46.7 feet
thence South 71 Degrees 54 Minutes 10 Seconds East	46.7 feet
thence South 71 Degrees 54 Minutes 10 Seconds East	46.7 feet
thence South 72 Degrees 38 Minutes 14 Seconds East	48.6 feet
thence South 73 Degrees 25 Minutes 32 Seconds East	50.8 feet
thence South 73 Degrees 25 Minutes 32 Seconds East	50.8 feet
thence South 73 Degrees 19 Minutes 01 Seconds East	50.4 feet
thence South 72 Degrees 27 Minutes 32 Seconds East	53.4 feet
thence South 71 Degrees 33 Minutes 09 Seconds East	50.9 feet
thence South 71 Degrees 40 Minutes 14 Seconds East	51.3 feet
thence South 74 Degrees 02 Minutes 56 Seconds East	52.6 feet
thence South 71 Degrees 33 Minutes 09 Seconds East	50.9 feet
thence South 73 Degrees 25 Minutes 32 Seconds East	50.8 feet
thence South 73 Degrees 25 Minutes 32 Seconds East	50.8 feet
thence South 70 Degrees 48 Minutes 45 Seconds East	49.1 feet
thence South 73 Degrees 25 Minutes 32 Seconds East	50.8 feet
thence South 72 Degrees 38 Minutes 14 Seconds East	48.6 feet
thence South 71 Degrees 40 Minutes 14 Seconds East	51.3 feet
thence South 73 Degrees 19 Minutes 01 Seconds East	50.4 feet
thence South 73 Degrees 25 Minutes 32 Seconds East	50.8 feet
thence South 71 Degrees 40 Minutes 14 Seconds East	51.3 feet
thence South 73 Degrees 25 Minutes 32 Seconds East	50.8 feet
thence South 74 Degrees 02 Minutes 56 Seconds East	52.6 feet
thence South 73 Degrees 19 Minutes 01 Seconds East	50.4 feet
thence South 74 Degrees 08 Minutes 54 Seconds East	53 feet
thence South 74 Degrees 02 Minutes 56 Seconds East	52.6 feet
thence South 72 Degrees 21 Minutes 01 Seconds East	53.1 feet
thence South 72 Degrees 21 Minutes 01 Seconds East	53.1 feet
thence South 74 Degrees 02 Minutes 56 Seconds East	52.6 feet
thence South 71 Degrees 40 Minutes 14 Seconds East	51.3 feet
thence South 71 Degrees 40 Minutes 14 Seconds East	51.3 feet
thence South 70 Degrees 05 Minutes 27 Seconds East	42.7 feet
thence South 57 Degrees 49 Minutes 48 Seconds East	39.7 feet
thence South 49 Degrees 51 Minutes 05 Seconds East	35.4 feet
thence South 40 Degrees 31 Minutes 00 Seconds East	38.7 feet
thence South 37 Degrees 48 Minutes 49 Seconds East	37.2 feet
thence South 36 Degrees 19 Minutes 44 Seconds East	38.5 feet
thence South 38 Degrees 59 Minutes 50 Seconds East	39.9 feet
thence South 40 Degrees 31 Minutes 00 Seconds East	38.7 feet
thence South 48 Degrees 03 Minutes 50 Seconds East	39 feet
thence South 44 Degrees 39 Minutes 20 Seconds East	39 feet
thence South 41 Degrees 45 Minutes 40 Seconds East	37.2 feet
thence South 34 Degrees 56 Minutes 35 Seconds East	39.9 feet



thence South 35 Degrees 19 Minutes 46 Seconds East	40.1 feet
thence South 30 Degrees 56 Minutes 01 Seconds East	43.8 feet
thence South 31 Degrees 18 Minutes 04 Seconds East	44 feet
thence South 29 Degrees 14 Minutes 10 Seconds East	46.8 feet
thence South 30 Degrees 57 Minutes 47 Seconds East	47.7 feet
thence South 29 Degrees 23 Minutes 32 Seconds East	50.7 feet
thence South 30 Degrees 19 Minutes 09 Seconds East	49.2 feet
thence South 30 Degrees 23 Minutes 24 Seconds East	53.1 feet
thence South 30 Degrees 41 Minutes 44 Seconds East	53.2 feet
thence South 32 Degrees 11 Minutes 44 Seconds East	54.1 feet
thence South 28 Degrees 42 Minutes 23 Seconds East	55.9 feet
thence South 30 Degrees 44 Minutes 10 Seconds East	57.1 feet
thence South 31 Degrees 18 Minutes 04 Seconds East	55.5 feet
thence South 28 Degrees 42 Minutes 23 Seconds East	55.9 feet
thence South 32 Degrees 29 Minutes 23 Seconds East	54.3 feet
thence South 29 Degrees 31 Minutes 34 Seconds East	54.5 feet
thence South 32 Degrees 11 Minutes 44 Seconds East	54.1 feet
thence South 29 Degrees 49 Minutes 35 Seconds East	54.7 feet
thence South 30 Degrees 04 Minutes 56 Seconds East	52.9 feet
thence South 29 Degrees 49 Minutes 35 Seconds East	54.7 feet
thence South 31 Degrees 18 Minutes 04 Seconds East	55.5 feet
thence South 30 Degrees 27 Minutes 04 Seconds East	56.9 feet
thence South 30 Degrees 44 Minutes 10 Seconds East	57.1 feet
thence South 30 Degrees 27 Minutes 04 Seconds East	56.9 feet
thence South 29 Degrees 55 Minutes 22 Seconds East	58.5 feet
thence South 31 Degrees 34 Minutes 20 Seconds East	59.5 feet
thence South 28 Degrees 52 Minutes 21 Seconds East	59.8 feet
thence South 30 Degrees 46 Minutes 18 Seconds East	60.9 feet
thence South 30 Degrees 30 Minutes 17 Seconds East	60.7 feet
thence South 30 Degrees 00 Minutes 27 Seconds East	62.3 feet
thence South 32 Degrees 20 Minutes 34 Seconds East	61.9 feet
thence South 29 Degrees 01 Minutes 07 Seconds East	63.6 feet
thence South 31 Degrees 33 Minutes 21 Seconds East	63.3 feet
thence South 30 Degrees 48 Minutes 10 Seconds East	64.7 feet
thence South 30 Degrees 48 Minutes 10 Seconds East	64.7 feet
thence South 30 Degrees 48 Minutes 10 Seconds East	64.7 feet
thence South 31 Degrees 33 Minutes 21 Seconds East	63.3 feet
thence South 31 Degrees 33 Minutes 21 Seconds East	63.3 feet
thence South 30 Degrees 48 Minutes 10 Seconds East	64.7 feet
thence South 30 Degrees 46 Minutes 18 Seconds East	60.9 feet
thence South 31 Degrees 34 Minutes 20 Seconds East	59.5 feet
thence South 29 Degrees 38 Minutes 33 Seconds East	58.3 feet
thence South 30 Degrees 27 Minutes 04 Seconds East	56.9 feet
thence South 28 Degrees 30 Minutes 57 Seconds East	52.1 feet
thence South 30 Degrees 19 Minutes 08 Seconds East	49.2 feet
thence South 33 Degrees 26 Minutes 55 Seconds East	45 feet
thence South 38 Degrees 59 Minutes 50 Seconds East	39.9 feet
thence South 44 Degrees 41 Minutes 37 Seconds East	41.3 feet
thence South 56 Degrees 08 Minutes 13 Seconds East	40.9 feet



thence South 63 Degrees 20 Minutes 58 Seconds East 39.8 feet  
 thence South 64 Degrees 46 Minutes 38 Seconds East 41.8 feet  
 thence South 68 Degrees 03 Minutes 06 Seconds East 43.3 feet  
 thence South 69 Degrees 00 Minutes 02 Seconds East 45.1 feet  
 thence South 70 Degrees 00 Minutes 51 Seconds East 47.2 feet  
 thence South 66 Degrees 22 Minutes 29 Seconds East 48.5 feet  
 thence South 67 Degrees 17 Minutes 10 Seconds East 50.3 feet  
 thence South 67 Degrees 17 Minutes 10 Seconds East 50.3 feet  
 thence South 69 Degrees 57 Minutes 04 Seconds East 51.8 feet  
 thence South 66 Degrees 17 Minutes 13 Seconds East 43.5 feet  
 thence South 67 Degrees 24 Minutes 19 Seconds East 9.3 feet  
 thence South 68 Degrees 08 Minutes 02 Seconds East 52.1 feet  
 thence South 68 Degrees 16 Minutes 10 Seconds East 52.4 feet  
 thence South 69 Degrees 50 Minutes 53 Seconds East 42.8 feet  
 thence South 69 Degrees 42 Minutes 18 Seconds East 8.7 feet  
 thence South 69 Degrees 57 Minutes 04 Seconds East 51.8 feet  
 thence South 69 Degrees 03 Minutes 03 Seconds East 54.2 feet  
 thence South 69 Degrees 49 Minutes 26 Seconds East 51.5 feet  
 thence South 73 Degrees 25 Minutes 31 Seconds East 50.8 feet  
 thence South 70 Degrees 41 Minutes 00 Seconds East 53.7 feet  
 thence South 74 Degrees 02 Minutes 55 Seconds East 52.6 feet  
 thence South 73 Degrees 05 Minutes 05 Seconds East 55.3 feet  
 thence South 72 Degrees 21 Minutes 00 Seconds East 53.1 feet  
 thence South 74 Degrees 43 Minutes 17 Seconds East 54.9 feet  
 thence South 72 Degrees 21 Minutes 00 Seconds East 53.1 feet  
 thence South 71 Degrees 33 Minutes 08 Seconds East 50.9 feet  
 thence South 77 Degrees 01 Minutes 55 Seconds East 49.9 feet  
 thence South 75 Degrees 48 Minutes 10 Seconds East 45.8 feet  
 thence South 71 Degrees 18 Minutes 42 Seconds East 40.3 feet  
 thence South 65 Degrees 13 Minutes 21 Seconds East 34.8 feet  
 thence South 54 Degrees 28 Minutes 28 Seconds East 33.6 feet  
 thence South 49 Degrees 44 Minutes 09 Seconds East 30.3 feet  
 thence South 35 Degrees 52 Minutes 30 Seconds East 28.2 feet  
 thence South 31 Degrees 18 Minutes 04 Seconds East 3.8 feet  
 thence South 32 Degrees 41 Minutes 05 Seconds East 23.3 feet  
 thence South 36 Degrees 35 Minutes 28 Seconds East 24.4 feet  
 thence South 49 Degrees 12 Minutes 57 Seconds East 27.4 feet  
 thence South 64 Degrees 05 Minutes 45 Seconds East 26 feet  
 thence South 75 Degrees 46 Minutes 37 Seconds East 26.1 feet  
 thence North 89 Degrees 39 Minutes 45 Seconds East 29.5 feet  
 thence North 79 Degrees 39 Minutes 16 Seconds East 28.3 feet  
 thence North 77 Degrees 16 Minutes 02 Seconds East 30.6 feet  
 thence North 79 Degrees 32 Minutes 16 Seconds East 28 feet  
 thence North 83 Degrees 23 Minutes 29 Seconds East 30 feet  
 thence South 86 Degrees 55 Minutes 51 Seconds East 27.6 feet  
 thence South 77 Degrees 48 Minutes 30 Seconds East 30.3 feet  
 thence South 72 Degrees 21 Minutes 00 Seconds East 26.6 feet  
 thence South 67 Degrees 28 Minutes 22 Seconds East 29.6 feet  
 thence South 69 Degrees 05 Minutes 12 Seconds East 31.7 feet

thence South 67 Degrees 28 Minutes 22 Seconds East	29.6 feet
thence South 63 Degrees 46 Minutes 20 Seconds East	33 feet
thence South 58 Degrees 37 Minutes 19 Seconds East	34.3 feet
thence South 56 Degrees 48 Minutes 24 Seconds East	32.7 feet
thence South 49 Degrees 47 Minutes 53 Seconds East	32.8 feet
thence South 45 Degrees 20 Minutes 14 Seconds East	32.5 feet
thence South 35 Degrees 19 Minutes 45 Seconds East	32 feet
thence South 32 Degrees 41 Minutes 05 Seconds East	35 feet
thence South 30 Degrees 51 Minutes 19 Seconds East	36.2 feet
thence South 22 Degrees 36 Minutes 27 Seconds East	37.2 feet
thence South 19 Degrees 44 Minutes 55 Seconds East	36.5 feet
thence South 20 Degrees 50 Minutes 19 Seconds East	40.3 feet
thence South 19 Degrees 19 Minutes 13 Seconds East	43.4 feet
thence South 21 Degrees 44 Minutes 32 Seconds East	44.1 feet
thence South 17 Degrees 02 Minutes 11 Seconds East	48 feet
thence South 16 Degrees 29 Minutes 28 Seconds East	49.5 feet
thence South 19 Degrees 00 Minutes 32 Seconds East	50.2 feet
thence South 19 Degrees 00 Minutes 32 Seconds East	50.2 feet
thence South 17 Degrees 32 Minutes 37 Seconds East	53.2 feet
thence South 19 Degrees 51 Minutes 30 Seconds East	33.4 feet
thence South 19 Degrees 53 Minutes 56 Seconds East	20.6 feet
thence South 17 Degrees 52 Minutes 49 Seconds East	53.3 feet
thence South 18 Degrees 46 Minutes 19 Seconds East	57.1 feet
thence South 18 Degrees 46 Minutes 19 Seconds East	57.1 feet
thence South 18 Degrees 27 Minutes 32 Seconds East	57 feet
thence South 18 Degrees 15 Minutes 54 Seconds East	58.6 feet
thence South 20 Degrees 04 Minutes 35 Seconds East	59.3 feet
thence South 18 Degrees 15 Minutes 54 Seconds East	58.6 feet
thence South 19 Degrees 33 Minutes 15 Seconds East	60.8 feet
thence South 19 Degrees 33 Minutes 15 Seconds East	60.8 feet
thence South 20 Degrees 22 Minutes 28 Seconds East	59.4 feet
thence South 17 Degrees 02 Minutes 11 Seconds East	61.7 feet
thence South 17 Degrees 47 Minutes 03 Seconds East	60.2 feet
thence South 19 Degrees 33 Minutes 15 Seconds East	60.8 feet
thence South 17 Degrees 29 Minutes 09 Seconds East	60.1 feet
thence South 20 Degrees 37 Minutes 35 Seconds East	57.7 feet
thence South 18 Degrees 15 Minutes 54 Seconds East	58.6 feet
thence South 20 Degrees 55 Minutes 52 Seconds East	57.8 feet
thence South 18 Degrees 27 Minutes 32 Seconds East	57 feet
thence South 16 Degrees 52 Minutes 37 Seconds East	56.5 feet
thence South 19 Degrees 18 Minutes 27 Seconds East	55.5 feet
thence South 22 Degrees 28 Minutes 01 Seconds East	53.1 feet
thence South 18 Degrees 25 Minutes 39 Seconds East	51.8 feet
thence South 17 Degrees 02 Minutes 11 Seconds East	48 feet
thence South 18 Degrees 00 Minutes 17 Seconds East	46.5 feet
thence South 19 Degrees 19 Minutes 13 Seconds East	43.4 feet
thence South 18 Degrees 54 Minutes 34 Seconds East	43.3 feet
thence South 20 Degrees 50 Minutes 18 Seconds East	40.3 feet
thence South 21 Degrees 41 Minutes 17 Seconds East	38.8 feet



thence South 15 Degrees 35 Minutes 32 Seconds East 37.4 feet  
 thence South 17 Degrees 33 Minutes 38 Seconds East 34.4 feet  
 thence South 20 Degrees 08 Minutes 09 Seconds East 34.9 feet  
 thence South 17 Degrees 33 Minutes 38 Seconds East 34.4 feet  
 thence South 18 Degrees 27 Minutes 32 Seconds East 38 feet  
 thence South 18 Degrees 55 Minutes 41 Seconds East 38.1 feet  
 thence South 17 Degrees 43 Minutes 10 Seconds East 39.5 feet  
 thence South 18 Degrees 10 Minutes 19 Seconds East 39.6 feet  
 thence South 21 Degrees 41 Minutes 17 Seconds East 38.8 feet  
 thence South 17 Degrees 43 Minutes 10 Seconds East 39.5 feet  
 thence South 16 Degrees 16 Minutes 57 Seconds East 35.8 feet  
 thence South 18 Degrees 55 Minutes 41 Seconds East 38.1 feet  
 thence South 17 Degrees 02 Minutes 10 Seconds East 34.3 feet  
 thence South 17 Degrees 02 Minutes 10 Seconds East 34.3 feet  
 thence South 21 Degrees 37 Minutes 00 Seconds East 33.5 feet  
 thence South 18 Degrees 24 Minutes 34 Seconds East 32.8 feet  
 thence South 18 Degrees 46 Minutes 19 Seconds East 31.1 feet  
 thence South 19 Degrees 20 Minutes 35 Seconds East 31.2 feet  
 thence South 17 Degrees 51 Minutes 45 Seconds East 32.7 feet  
 thence South 17 Degrees 51 Minutes 45 Seconds East 32.7 feet  
 thence South 21 Degrees 37 Minutes 00 Seconds East 33.5 feet  
 thence South 17 Degrees 33 Minutes 37 Seconds East 34.4 feet  
 thence South 17 Degrees 51 Minutes 45 Seconds East 32.7 feet  
 thence South 20 Degrees 22 Minutes 27 Seconds East 29.7 feet  
 thence South 18 Degrees 46 Minutes 19 Seconds East 31.1 feet  
 thence South 20 Degrees 22 Minutes 27 Seconds East 29.7 feet  
 thence South 16 Degrees 06 Minutes 15 Seconds East 29 feet  
 thence South 22 Degrees 47 Minutes 38 Seconds East 26.6 feet  
 thence South 18 Degrees 04 Minutes 54 Seconds East 25.8 feet  
 thence South 17 Degrees 02 Minutes 10 Seconds East 20.6 feet  
 thence South 18 Degrees 27 Minutes 32 Seconds East 19 feet  
 thence South 13 Degrees 49 Minutes 58 Seconds East 16.9 feet  
 thence South 15 Degrees 16 Minutes 06 Seconds East 15.3 feet  
 thence South 21 Degrees 08 Minutes 37 Seconds East 17.6 feet  
 thence South 15 Degrees 16 Minutes 06 Seconds East 15.3 feet  
 thence South 24 Degrees 33 Minutes 53 Seconds East 14.4 feet  
 thence South 15 Degrees 16 Minutes 06 Seconds East 15.3 feet  
 thence South 23 Degrees 13 Minutes 39 Seconds East 16 feet  
 thence South 17 Degrees 02 Minutes 10 Seconds East 13.7 feet  
 thence South 22 Degrees 08 Minutes 18 Seconds East 10.6 feet  
 thence South 17 Degrees 02 Minutes 10 Seconds East 6.9 feet  
 thence South 15 Degrees 35 Minutes 31 Seconds East 7.5 feet  
 thence South 18 Degrees 46 Minutes 19 Seconds East 63.3 feet  
 thence South 18 Degrees 52 Minutes 29 Seconds East 5.8 feet

more or less to **the ending point**  
**at:** 40 degrees 31 minutes 42.26 seconds North Latitude and -112 degrees 47 minutes 29.23 seconds West  
 Longitude, which can be converted to mapping accuracy State Plane Utah Central Zone NAD 83 feet  
 coordinates of X = 1,281,426.6 feet and Y = 7,363,801.7 feet.