

**Acknowledgment and
Notice of Acknowledgment
of Acceptance of R.S. 2477
Right-of-Way Grant**

Ent: 309591 - Pg 1 of 13
Date: 6/23/2008 12:52 PM
Fee: \$0.00 NO CHARGE
Filed By: RGL
CALLEEN B PESHELL, Recorder
Tooele County Corporation
For: STATE OF UT GOVERNORS OFF

THE STATE OF UTAH

TO ALL WHOM THESE PRESENTS SHALL COME, Greeting:

Know ye, This is an Acknowledgment and Notice of Acknowledgment made under Utah Code Sections 72-5-309 through 310 inclusive, that the grant of the United States of America of "the right of way for the construction of highways over public lands, not reserved for public uses" under United States Revised Statutes 2477 (43 U.S.C. Section 932 (repealed October 21, 1976, with proviso recognizing the validity of rights-of-way already established)) was accepted for and on behalf of the State of Utah and its political subdivision Tooele County as it pertains to the highway located in Tooele County known as Durand Road; County Road Number: tc03035; State Geographic Information Database (SGID) Road Identification Number: RD230107. Total road length is 2.11 miles more or less.

The reason for this Acknowledgment and Notice of Acknowledgment includes, but is not limited to, the fact that the road was constructed, mechanically, or by continuous use as a public highway for a period of at least ten years, over public lands not reserved for public uses, prior to the earlier of (a) the October 21, 1976 repeal of R.S. 2477 or (b) the date the servient estate was reserved for public uses.

This Acknowledgment and Notice of Acknowledgment applies only to the segments of the road that traverse land owned by the Bureau of Land Management, United States Department of the Interior, and does not apply to segments of the road that traverse land owned by any other person or entity. The State of Utah and its political subdivisions reserve the right to make further acknowledgments and notices of acknowledgment with regard to road segments that traverse land owned by other entities, including the United States of America, through one or more of its agencies.

A printed copy of a map showing the location of the road in said county is appended hereto as "Attachment 1," a printed copy of representative photos of the road is appended hereto as "Attachment 2," a printed copy of a description of the beginning and ending points of the entire road together with a list of Townships, Ranges and Sections that may be traversed by the road in said county is appended hereto as "Attachment 3," and a printed copy of the Road Centerline Description Cover Page(s) is appended hereto as "Attachment 4." The Appendices listed in "Attachment 4" that contain the actual road centerline descriptions are incorporated herein by reference. Affidavits provided by individuals familiar with the road are appended hereto as "Attachment 5."

A printed copy of this Acknowledgment and Notice of Acknowledgment, together with its Attachments and Appendices, may be viewed and/or obtained at the office of the Utah State Archives.

An electronic copy of this Acknowledgment and Notice of Acknowledgment, together with its Attachments and Appendices, may be viewed and/or downloaded as read-only PDF (Portable Document Format) files via the

Internet at <http://recorded2477roads.utah.gov>.

The owner of the servient estate in the land underlying the road-segments subject to this Acknowledgment and Notice is believed to be the United States of America through one or more of its agencies. Any of such agencies or any other person with a servient ownership claim or a competing dominant estate right-of-way ownership claim, may file a petition in the State District Court for Salt Lake County for a decision regarding the correctness of this Acknowledgment. A claimant shall file a petition within sixty (60) days after receipt of this Notice.

In Witness Whereof, I, John Harja, the official designee of the Governor of the State of Utah, in conformity to the laws of the State (Utah Code Sections 72-5-308 through 310 inclusive), have caused this Acknowledgment and Notice of Acknowledgment to be made.

Signed by my hand in Salt Lake City, Utah, the 20th day of June, 2008.

By the Governor's Designee



John Harja

CERTIFICATION

State of Utah)
 : ss
County of Salt Lake)

I hereby certify that the signer of the foregoing document, John Harja, is personally known by me, has made a voluntary signature and taken an oath stating that he is the official designee of the Governor of the State of Utah and is authorized to sign this document on the Governor's behalf pursuant to Utah Code Section 72-5-309. He further vouched that, based upon information and belief, the facts alleged therein are true.

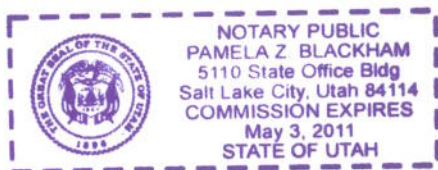
Dated this 20th day of June, 2008.



Notary Public

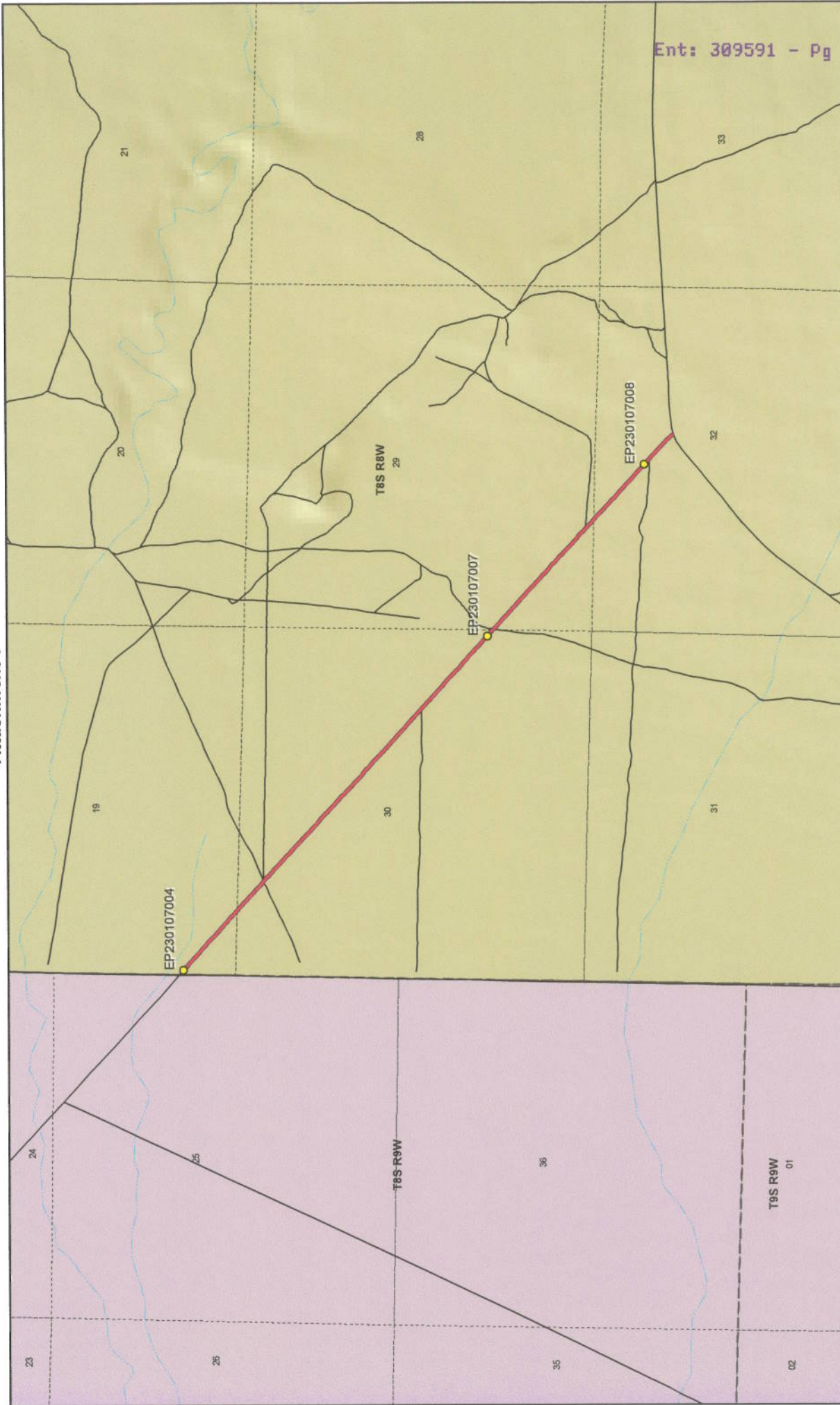

Ent: 309591 - Pg 3 of 13

Map prepared by the State of Utah
Automated Geographic Reference Center
Room 5130 State Office Building
Salt Lake City, Utah 84114
Jun 16, 2008



Durand Road - Tooele County SGID RD_ID RD230107

Transportation Network

- Durand Road
- Other Roads
- Title V: Issued Or Under Consideration By BLM
- Photo Event Point
- Section = 1 Mile

Land Ownership Categories

- BLM
- Private
- SITLA, State Trust Land
- USFS, National Forest
- State Parks and Recreation
- Tribal, Indian Reservation
- NPS, National Park
- Wilderness
- UDWR Wildlife Reserve
- DOD, Military
- State Sovereign Land
- National Recreation Area
- USFWS, Natl. Wildlife Refuge

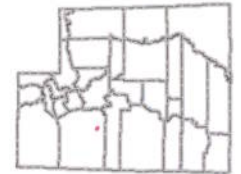

1:24,316
1 inch equals 0.4 miles

Ent: 309591 - Pg 4 of 13



EP230107007



EP230107008



EP230107004

EP000000000

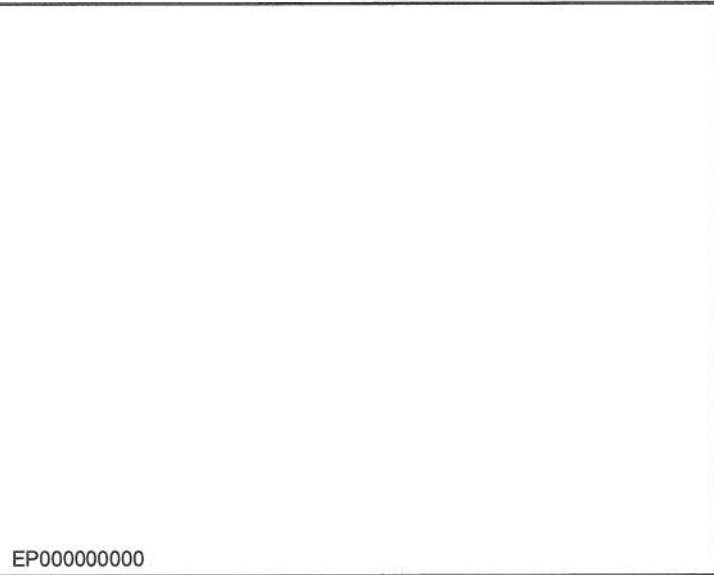

EP000000000

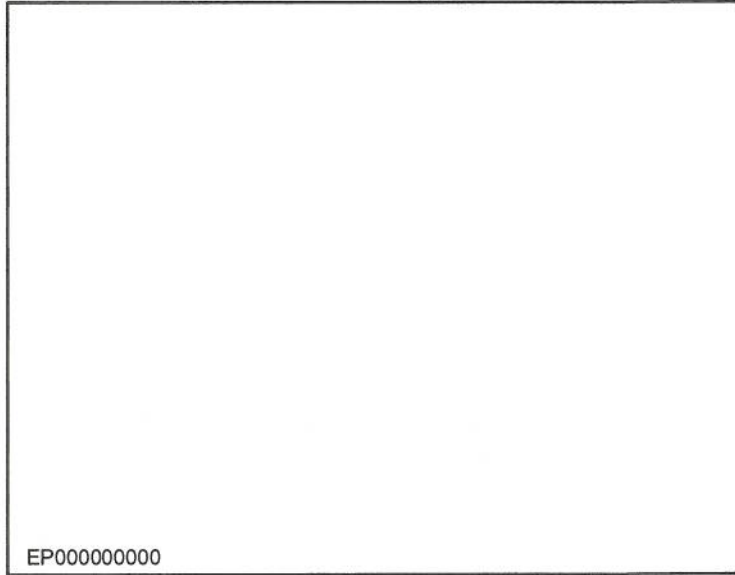

EP000000000

Durand Road - Tooele County
SGID RD_ID RD230107

Map prepared by the State of Utah
Automated Geographic Reference Center
Room 5130 State Office Building
Salt Lake City, Utah 84114
June 18, 2008



Attachment 3

Beginning & Ending Points and Township, Range, and Section References For:

Popular Name: Durand Road

County: Tooele

County Road Number: tc03035

State Geographic Information Database (SGID) Road Identification Number: RD230107.

Total Road Length: 2.11 miles more or less.

Beginning at a point on the road centerline located at 40 degrees 06 minutes 08.28 seconds North Latitude and -112 degrees 47 minutes 56.96 seconds West Longitude, which can be converted to mapping accuracy State Plane Utah Central Zone NAD 83 feet coordinates of X = 1,277,030.7 feet and Y = 7,208,625.7 feet based on the US Survey Foot conversion.

Ending at a point on the road centerline located at 40 degrees 04 minutes 55.59 seconds North Latitude and -112 degrees 46 minutes 10.01 seconds West Longitude, which can be converted to mapping accuracy State Plane Utah Central Zone NAD 83 feet coordinates of X = 1,285,235.3 feet and Y = 7,201,152.5 feet based on the US Survey Foot conversion.

This road may traverse:

Township 8 South Range 8 West, Section(s) 19,29,30,32, Salt Lake Base & Meridian
See Attachment 1 above for a cartographic depiction of the course of this road.

Attachment 4

Road Centerline Description Cover Page(s)

Popular Name: Durand Road

County: Tooele

County Road Number: tc03035

State Geographic Information Database (SGID) Road Identification Number: RD230107.

Total Road Length: 2.11 miles more or less.

Centerline Descriptions Of Road-Segments That Cross Over Federally Owned Land, Derived From Global Positioning System Data And Cross-checked against USGS Digital Orthophoto Quadrangles Compiled By The Utah Automated Geographic Reference Center And Entered Into The State Geographic Information Database (SGID).

Road-Segments Listed by SGID Road Identification Number (RD_ID)	Road-Segment Numbers	Believed Ownership Of Servient Estate	Approximate Segment Length	See Attached Appendix
RD230107	001	BLM	2.11 Miles	A
		Total Road Length	2.11	_____

* Indicates that a Title V permit will be requested, is in process, or has been issued.

† Indicates that road-segments crossing Forest Service land are under consideration by the state and county as of the date of this Acknowledgment and Notice of Acknowledgment.

Attachment 5

AFFIDAVIT OF JAMES S. MCKENDRICK

DURAND ROAD

TOOELE COUNTY, UTAH

ROAD NUMBER tc03035

State of Utah)
 : ss.
County of Tooele)

JAMES S. MCKENDRICK, being first duly sworn, deposes and states as follows:

1. I am an adult competent to testify about the matters set forth below based upon my personal knowledge. I currently reside in Tooele, Tooele County, Utah. I have lived in Tooele County for most of the past 76 years. I was employed by the Tooele County Road Department from 1963 to 1993.

2. I have traveled and am familiar with a road in Tooele County known as Durand Road. I am also familiar with the land the road traverses. When I first used and observed the road in the early 1960s it followed the same route as in the early 1990s when I last observed it. Attached is a Tooele County map showing Durand Road. To the best of my knowledge and based upon my use of and familiarity with this road and the land it traverses, the location and route of the road are correctly illustrated on the attached map.

3. The County also identifies this road according to the road number listed above.

4. I have observed that the road has been open to the public for all to use, to come and go as they pleased, since at least as early as the early 1960s and continuing through the early 1990s. Throughout this time period I observed travel on the road by means of cars, pickup trucks and ATVs. During this time period, the road was used daily, for more than ten continuous years prior to 1976 and was so used in the early 1990s.

5. Throughout the time period from the early 1960s to the early 1990s, I have used the road myself for county road maintenance and travel through the area.

6. Throughout the time period described in the previous paragraph, I have observed other vehicles from the general public using the road at various times for the uses described in the previous paragraph, plus livestock operations, hunting and recreation.

7. It is also the reputation in the community that this road has been open to the public for all to use, to come and go as they pleased, since at least as early as the early 1960s and continuing through 1976 to the present, for the uses described in the previous paragraphs.

8. Prior to 1976, I graded and performed maintenance and construction activities on the road.

DATED this 22 day of May, 2008.

JAMES S. MCKENDRICK

SUBSCRIBED AND SWORN to before me this 22 day of May, 2008.

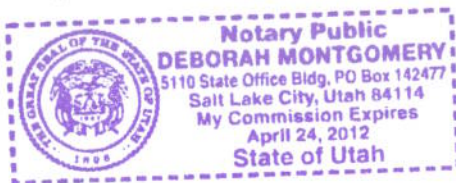

NOTARY PUBLIC



1:23,184
1 inch equals 0.4 miles

Map prepared by the State of Utah
Automated Geospatial Information Center
AGRIC
Room 5130 State Office Building
Salt Lake City, Utah 84114
April 18, 2008



Tooele County Durand Road County Unique - tc03035

Transportation Network
Durand Road
State / U.S. Highway
Local Roads

Misc
City / Town
Municipalities
Section = 1 Mile
Wildlife Reserve
Military
Wilderness
Tribal

Land Ownership Categories
BLM
Private
SITLA, State Trust Land
USFS, National Forest
State Park

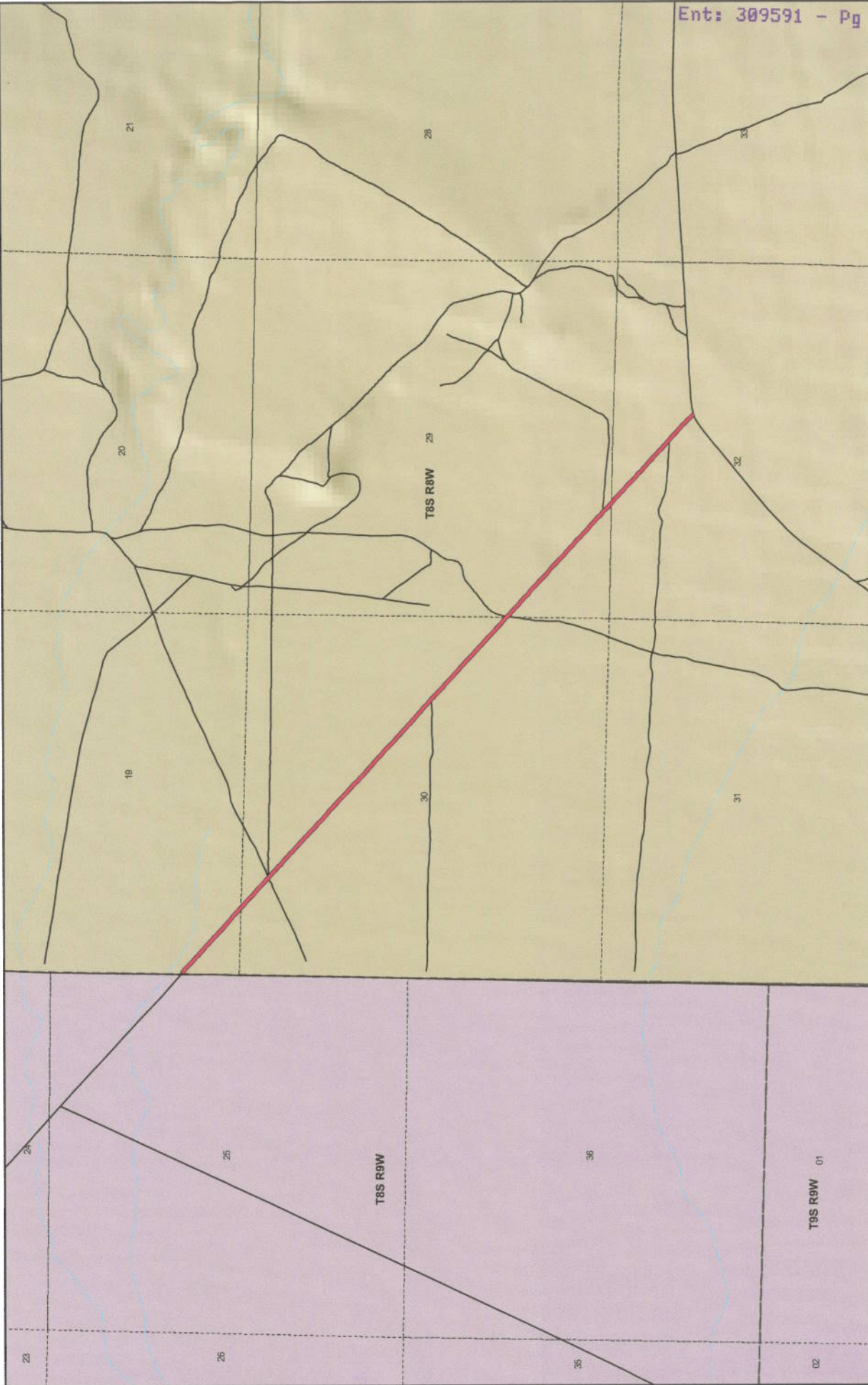

AFFIDAVIT OF LEE F. NIX

DURAND ROAD

TOOELE COUNTY, UTAH

ROAD NUMBER tc03035

State of Utah)
 : ss.
County of Tooele)

LEE F. NIX, being first duly sworn, deposes and states as follows:

1. I am an adult competent to testify about the matters set forth below based upon my personal knowledge. I currently reside in Tooele, Tooele County, Utah. I was born and raised in Tooele County and have lived here all of my life for 80 years.

2. I have traveled and am familiar with a road in Tooele County known as Durand Road. I am also familiar with the land the road traverses. When I first used and observed the road in the late 1930s it followed the same route as in 2006 when I last observed it. Attached is a Tooele County map showing Durand Road. To the best of my knowledge and based upon my use of and familiarity with this road and the land it traverses, the location and route of the road are correctly illustrated on the attached map.

3. I am informed that the County also identifies this road according to the road number listed above.

4. I have observed that the road has been open to the public for all to use, to come and go as they pleased, since at least as early as the late 1930s and continuing through 2006. During this time period I have observed travel on the road by means of cars, pickup trucks and ATVs. During this time period, the road was used daily, weather permitting, for more than ten continuous years prior to 1976 and was so used in 2006.

5. During the time period from the late 1930s to 2006, I have used the road myself for sightseeing and recreation, livestock operations, hunting, trapping and travel in and through the area.

6. During the time period described in the previous paragraph, I have observed other vehicles from the general public using the road at various times for the uses described in the previous paragraph.

7. It is also the reputation in the community that this road has been open to the public for all to use, to come and go as they pleased, since at least as early as the early 1900s and continuing through 1976 to the present, for the uses described in the previous paragraphs.

8. Prior to 1976, I observed the graded surface of the road and other evidence of maintenance and construction such as berms along the side of the road.

DATED this 1 day of May, 2008.

LEE F. NIX

SUBSCRIBED AND SWORN to before me this 1st day of May, 2008.

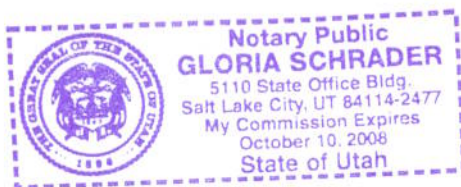

NOTARY PUBLIC

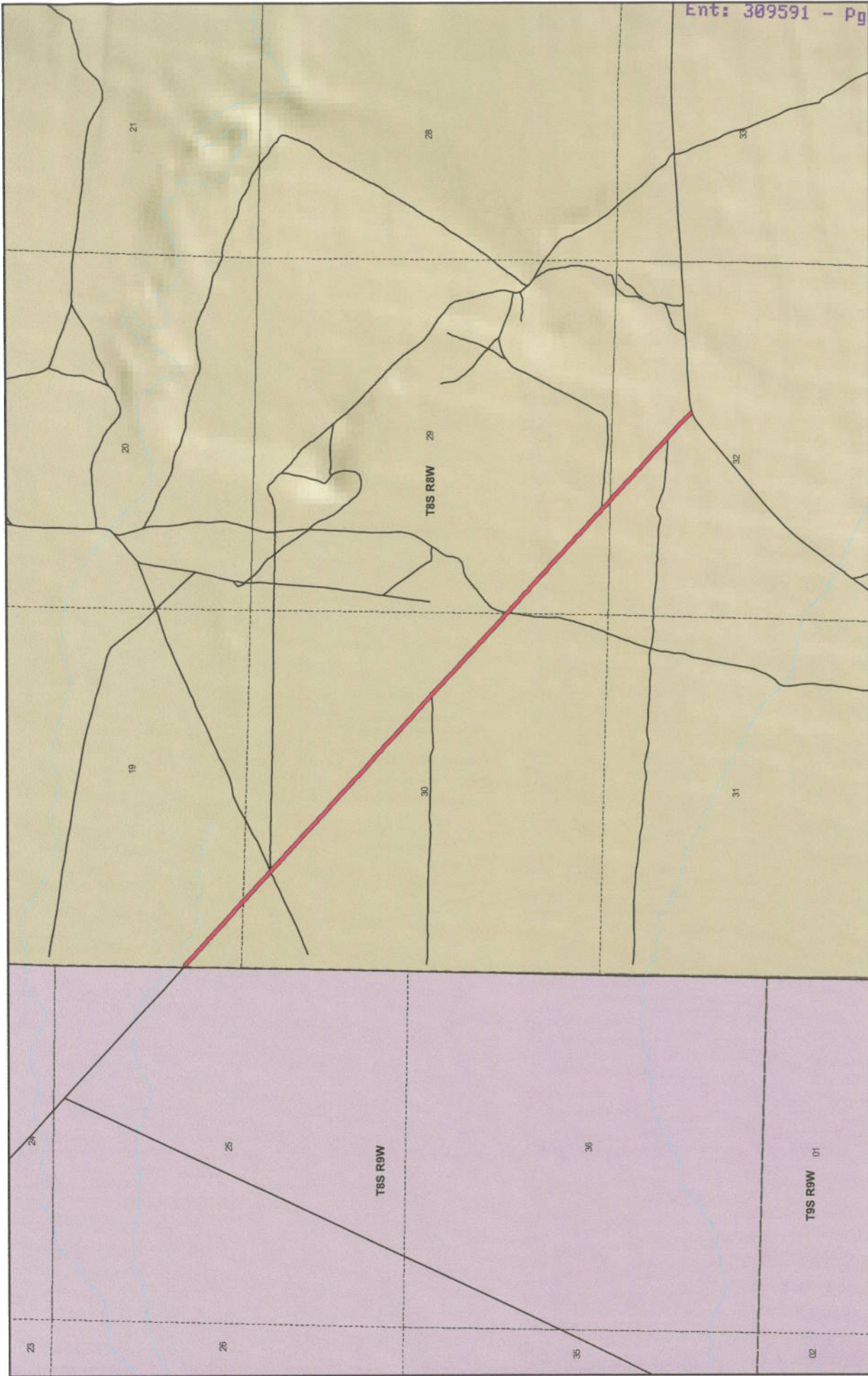

1:23,184
1 inch equals 0.4 miles



Map prepared by the State of Utah
Automated Geographic Reference Center
Room 5130 State Office Building
Salt Lake City, Utah 84114
Apr 18, 2009



Tooele County
Durand Road
County Unique - tc03035

- | | | | |
|----------------------------------|-------------------|------------------|----------------|
| Land Ownership Categories | | Misc | |
| BLM | Yellow circle | Wildlife Reserve | Green diamond |
| Private | Pink circle | Military | Green diamond |
| SITLA, State Trust Land | Light blue circle | Wilderness | Orange diamond |
| USFS, National Forest | Dark blue circle | Tribal | Orange diamond |
| State Park | Dark blue circle | | |
| | | City / Town | Black circle |
| | | Municipalities | Black circle |
| | | Section = 1 Mile | Dashed line |

- Transportation Network**
- Durand Road (Red line)
 - State / U.S. Highway (Thick black line)
 - Local Roads (Thin black line)

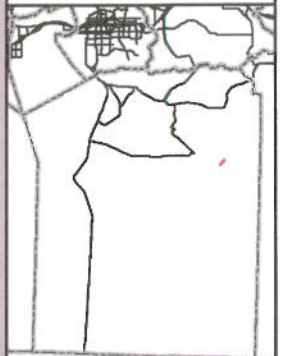

Appendix A to Attachment 4

Popular Name: Durand Road

County: Tooele

County Road Number: tc03035

State Geographic Information Database (SGID) Road Identification Number: RD230107.

Road-Segment Number: 001

Road-Segment Length: 2.11 miles more or less.

Believed owner of the land underlying this road-segment is: Bureau of Land Management.

The following description is based upon the geographic coordinate system using the NAD83 Datum. The source is GPS mapping grade data as indicated in the metadata and/or the transportation data model of the State of Utah Geographic Information Database (SGID).

The road-segment itself is the monument that is identified by its physical presence on the land. The location of said physical presence is closely approximated by mapping grade Global Positioning System (GPS) data. Said data are checked against the corresponding gray-scale 1-meter Digital Orthophoto Quadrangles published by the United States Geological Survey (USGS) to verify a reasonable degree of accuracy. In circumstances where accurate satellite signal acquisition is not possible, such as deep, narrow canyons or under a canopy of dense foliage, or where very sharp curves in the road make accuracy questionable, such portions of the road were digitized from the corresponding gray-scale 1-meter Digital Orthophoto Quadrangles published by the United States Geological Survey (USGS).

This road-segment may traverse:

Township 8 South Range 8 West, Section(s) 19,29,30,32, Salt Lake Base & Meridian

The following description closely approximates the location of the centerline of the physical monument (Durand Road)-- Segment 001 based on mapping grade Global Positioning System (GPS) data as defined above:

Beginning at a point on the road center line located at 40 degrees 06 minutes 08.28 seconds North Latitude and -112 degrees 47 minutes 56.96 seconds West Longitude, which can be converted to mapping accuracy State Plane Utah Central Zone NAD 83 feet coordinates of X = 1,277,030.7 feet and Y = 7,208,625.7 feet; thence the following courses along the said road center line:

thence North 89 Degrees 40 Minutes 22 Seconds East	6.2 feet
thence South 46 Degrees 27 Minutes 00 Seconds East	11.8 feet
thence South 52 Degrees 02 Minutes 12 Seconds East	15.9 feet
thence South 43 Degrees 51 Minutes 29 Seconds East	18.1 feet
thence South 39 Degrees 36 Minutes 58 Seconds East	23.3 feet
thence South 46 Degrees 20 Minutes 59 Seconds East	26 feet
thence South 48 Degrees 54 Minutes 11 Seconds East	22.3 feet
thence South 40 Degrees 41 Minutes 29 Seconds East	25.8 feet
thence South 52 Degrees 31 Minutes 13 Seconds East	24.1 feet
thence South 46 Degrees 20 Minutes 59 Seconds East	26 feet
thence South 55 Degrees 44 Minutes 04 Seconds East	23.1 feet

thence South 46 Degrees 20 Minutes 59 Seconds East	26 feet
thence South 44 Degrees 21 Minutes 21 Seconds East	27.4 feet
thence South 55 Degrees 12 Minutes 53 Seconds East	25.7 feet
thence South 43 Degrees 51 Minutes 29 Seconds East	27.2 feet
thence South 43 Degrees 51 Minutes 29 Seconds East	27.2 feet
thence South 55 Degrees 10 Minutes 21 Seconds East	28.5 feet
thence South 38 Degrees 59 Minutes 12 Seconds East	23.1 feet
thence South 50 Degrees 07 Minutes 36 Seconds East	30.5 feet
thence South 43 Degrees 51 Minutes 29 Seconds East	27.2 feet
thence South 55 Degrees 10 Minutes 21 Seconds East	28.5 feet
thence South 46 Degrees 20 Minutes 59 Seconds East	26 feet
thence South 44 Degrees 21 Minutes 21 Seconds East	27.4 feet
thence South 44 Degrees 25 Minutes 54 Seconds East	29.7 feet
thence South 49 Degrees 39 Minutes 07 Seconds East	27.7 feet
thence South 46 Degrees 50 Minutes 51 Seconds East	26.2 feet
thence South 46 Degrees 20 Minutes 59 Seconds East	26 feet
thence South 49 Degrees 39 Minutes 07 Seconds East	27.7 feet
thence South 52 Degrees 19 Minutes 41 Seconds East	26.6 feet
thence South 41 Degrees 34 Minutes 30 Seconds East	28.4 feet
thence South 47 Degrees 10 Minutes 28 Seconds East	28.8 feet
thence South 49 Degrees 43 Minutes 32 Seconds East	30.2 feet
thence South 44 Degrees 52 Minutes 57 Seconds East	29.9 feet
thence South 47 Degrees 26 Minutes 52 Seconds East	31.3 feet
thence South 47 Degrees 51 Minutes 10 Seconds East	31.6 feet
thence South 52 Degrees 24 Minutes 01 Seconds East	32 feet
thence South 47 Degrees 26 Minutes 52 Seconds East	31.3 feet
thence South 50 Degrees 09 Minutes 26 Seconds East	33.1 feet
thence South 45 Degrees 19 Minutes 36 Seconds East	32.5 feet
thence South 49 Degrees 47 Minutes 15 Seconds East	32.8 feet
thence South 50 Degrees 09 Minutes 26 Seconds East	33.1 feet
thence South 48 Degrees 03 Minutes 11 Seconds East	34.1 feet
thence South 48 Degrees 03 Minutes 11 Seconds East	34.1 feet
thence South 41 Degrees 30 Minutes 46 Seconds East	34.9 feet
thence South 47 Degrees 40 Minutes 48 Seconds East	33.9 feet
thence South 52 Degrees 15 Minutes 40 Seconds East	34.6 feet
thence South 50 Degrees 09 Minutes 26 Seconds East	33.1 feet
thence South 48 Degrees 08 Minutes 32 Seconds East	1.4 feet
thence South 48 Degrees 13 Minutes 43 Seconds East	35.3 feet
thence South 44 Degrees 13 Minutes 55 Seconds East	36.4 feet
thence South 50 Degrees 11 Minutes 00 Seconds East	35.6 feet
thence South 48 Degrees 03 Minutes 11 Seconds East	34.1 feet
thence South 47 Degrees 40 Minutes 48 Seconds East	33.9 feet
thence South 46 Degrees 22 Minutes 52 Seconds East	37.8 feet
thence South 46 Degrees 04 Minutes 50 Seconds East	35.3 feet
thence South 50 Degrees 11 Minutes 00 Seconds East	35.6 feet
thence South 44 Degrees 38 Minutes 41 Seconds East	39 feet
thence South 50 Degrees 11 Minutes 00 Seconds East	35.6 feet
thence South 48 Degrees 13 Minutes 31 Seconds East	36.7 feet
thence South 46 Degrees 38 Minutes 37 Seconds East	40.4 feet

thence South 47 Degrees 10 Minutes 28 Seconds East	43.2 feet
thence South 48 Degrees 13 Minutes 31 Seconds East	36.7 feet
thence South 50 Degrees 31 Minutes 16 Seconds East	38.4 feet
thence South 43 Degrees 21 Minutes 06 Seconds East	33.7 feet
thence South 52 Degrees 45 Minutes 29 Seconds East	5.4 feet
thence South 54 Degrees 11 Minutes 05 Seconds East	36.2 feet
thence South 50 Degrees 31 Minutes 16 Seconds East	35.9 feet
thence South 37 Degrees 48 Minutes 10 Seconds East	37.2 feet
thence South 50 Degrees 31 Minutes 16 Seconds East	38.4 feet
thence South 45 Degrees 00 Minutes 24 Seconds East	41.5 feet
thence South 50 Degrees 31 Minutes 16 Seconds East	38.4 feet
thence South 44 Degrees 38 Minutes 41 Seconds East	39 feet
thence South 48 Degrees 54 Minutes 11 Seconds East	44.6 feet
thence South 48 Degrees 48 Minutes 16 Seconds East	42.1 feet
thence South 48 Degrees 48 Minutes 16 Seconds East	42.1 feet
thence South 41 Degrees 07 Minutes 34 Seconds East	41.2 feet
thence South 52 Degrees 29 Minutes 25 Seconds East	42.8 feet
thence South 48 Degrees 48 Minutes 16 Seconds East	42.1 feet
thence South 45 Degrees 19 Minutes 36 Seconds East	44.1 feet
thence South 44 Degrees 38 Minutes 41 Seconds East	39 feet
thence South 52 Degrees 29 Minutes 25 Seconds East	42.8 feet
thence South 47 Degrees 10 Minutes 27 Seconds East	43.2 feet
thence South 47 Degrees 52 Minutes 46 Seconds East	36.5 feet
thence South 45 Degrees 19 Minutes 36 Seconds East	41.8 feet
thence South 52 Degrees 19 Minutes 41 Seconds East	40 feet
thence South 43 Degrees 00 Minutes 35 Seconds East	40.2 feet
thence South 50 Degrees 12 Minutes 21 Seconds East	38.2 feet
thence South 44 Degrees 38 Minutes 41 Seconds East	39 feet
thence South 48 Degrees 48 Minutes 16 Seconds East	42.1 feet
thence South 48 Degrees 13 Minutes 31 Seconds East	36.7 feet
thence South 45 Degrees 19 Minutes 36 Seconds East	41.8 feet
thence South 52 Degrees 02 Minutes 11 Seconds East	39.7 feet
thence South 43 Degrees 46 Minutes 43 Seconds East	42.9 feet
thence South 46 Degrees 38 Minutes 37 Seconds East	40.4 feet
thence South 52 Degrees 13 Minutes 09 Seconds East	42.5 feet
thence South 45 Degrees 37 Minutes 36 Seconds East	44.3 feet
thence South 49 Degrees 15 Minutes 09 Seconds East	47.4 feet
thence South 48 Degrees 22 Minutes 30 Seconds East	39.3 feet
thence South 49 Degrees 10 Minutes 48 Seconds East	44.9 feet
thence South 47 Degrees 10 Minutes 27 Seconds East	43.2 feet
thence South 45 Degrees 19 Minutes 36 Seconds East	44.1 feet
thence South 47 Degrees 21 Minutes 42 Seconds East	45.7 feet
thence South 49 Degrees 15 Minutes 09 Seconds East	47.4 feet
thence South 46 Degrees 57 Minutes 48 Seconds East	40.6 feet
thence South 47 Degrees 21 Minutes 42 Seconds East	45.7 feet
thence South 45 Degrees 19 Minutes 36 Seconds East	44.1 feet
thence South 51 Degrees 00 Minutes 37 Seconds East	49.2 feet
thence South 46 Degrees 52 Minutes 29 Seconds East	42.9 feet
thence South 47 Degrees 21 Minutes 42 Seconds East	45.7 feet

thence South 46 Degrees 10 Minutes 24 Seconds East	47.1 feet
thence South 45 Degrees 19 Minutes 36 Seconds East	44.1 feet
thence South 49 Degrees 15 Minutes 09 Seconds East	47.4 feet
thence South 45 Degrees 53 Minutes 38 Seconds East	46.9 feet
thence South 48 Degrees 54 Minutes 11 Seconds East	44.6 feet
thence South 47 Degrees 38 Minutes 25 Seconds East	46 feet
thence South 45 Degrees 19 Minutes 36 Seconds East	44.1 feet
thence South 52 Degrees 22 Minutes 44 Seconds East	45.4 feet
thence South 49 Degrees 15 Minutes 09 Seconds East	47.4 feet
thence South 48 Degrees 54 Minutes 11 Seconds East	44.6 feet
thence South 45 Degrees 37 Minutes 36 Seconds East	44.3 feet
thence South 49 Degrees 15 Minutes 09 Seconds East	47.4 feet
thence South 48 Degrees 22 Minutes 30 Seconds East	39.3 feet
thence South 48 Degrees 54 Minutes 10 Seconds East	44.6 feet
thence South 49 Degrees 10 Minutes 48 Seconds East	44.9 feet
thence South 48 Degrees 22 Minutes 30 Seconds East	39.3 feet
thence South 43 Degrees 27 Minutes 32 Seconds East	42.7 feet
thence South 49 Degrees 10 Minutes 48 Seconds East	44.9 feet
thence South 45 Degrees 19 Minutes 36 Seconds East	44.1 feet
thence South 45 Degrees 37 Minutes 36 Seconds East	44.3 feet
thence South 45 Degrees 37 Minutes 36 Seconds East	44.3 feet
thence South 50 Degrees 31 Minutes 16 Seconds East	41 feet
thence South 50 Degrees 31 Minutes 16 Seconds East	43.6 feet
thence South 45 Degrees 37 Minutes 36 Seconds East	44.3 feet
thence South 46 Degrees 52 Minutes 29 Seconds East	42.9 feet
thence South 50 Degrees 31 Minutes 16 Seconds East	41 feet
thence South 47 Degrees 10 Minutes 27 Seconds East	43.2 feet
thence South 45 Degrees 19 Minutes 36 Seconds East	41.8 feet
thence South 52 Degrees 19 Minutes 40 Seconds East	40 feet
thence South 42 Degrees 39 Minutes 49 Seconds East	39.9 feet
thence South 52 Degrees 36 Minutes 56 Seconds East	40.2 feet
thence South 46 Degrees 38 Minutes 36 Seconds East	40.4 feet
thence South 50 Degrees 10 Minutes 59 Seconds East	35.6 feet
thence South 46 Degrees 04 Minutes 49 Seconds East	35.3 feet
thence South 49 Degrees 47 Minutes 15 Seconds East	32.8 feet
thence South 47 Degrees 10 Minutes 27 Seconds East	28.8 feet
thence South 52 Degrees 24 Minutes 00 Seconds East	32 feet
thence South 42 Degrees 04 Minutes 09 Seconds East	28.6 feet
thence South 58 Degrees 19 Minutes 16 Seconds East	24.8 feet
thence South 47 Degrees 21 Minutes 42 Seconds East	91.5 feet
thence South 47 Degrees 40 Minutes 47 Seconds East	16.9 feet
thence South 44 Degrees 36 Minutes 05 Seconds East	18.3 feet
thence South 45 Degrees 53 Minutes 38 Seconds East	23.4 feet
thence South 52 Degrees 13 Minutes 08 Seconds East	21.3 feet
thence South 44 Degrees 21 Minutes 20 Seconds East	27.4 feet
thence South 46 Degrees 43 Minutes 25 Seconds East	28.5 feet
thence South 47 Degrees 10 Minutes 27 Seconds East	28.8 feet
thence South 44 Degrees 52 Minutes 57 Seconds East	29.9 feet
thence South 45 Degrees 19 Minutes 35 Seconds East	32.5 feet

thence South 47 Degrees 26 Minutes 51 Seconds East	31.3 feet
thence South 50 Degrees 09 Minutes 25 Seconds East	33.1 feet
thence South 46 Degrees 04 Minutes 49 Seconds East	35.3 feet
thence South 43 Degrees 51 Minutes 28 Seconds East	36.2 feet
thence South 50 Degrees 31 Minutes 15 Seconds East	35.9 feet
thence South 48 Degrees 13 Minutes 30 Seconds East	36.7 feet
thence South 46 Degrees 38 Minutes 36 Seconds East	40.4 feet
thence South 52 Degrees 08 Minutes 27 Seconds East	37.1 feet
thence South 48 Degrees 33 Minutes 58 Seconds East	36.9 feet
thence South 46 Degrees 38 Minutes 36 Seconds East	40.4 feet
thence South 48 Degrees 13 Minutes 30 Seconds East	36.7 feet
thence South 47 Degrees 10 Minutes 27 Seconds East	43.2 feet
thence South 44 Degrees 38 Minutes 40 Seconds East	39 feet
thence South 50 Degrees 12 Minutes 21 Seconds East	38.2 feet
thence South 45 Degrees 37 Minutes 35 Seconds East	44.3 feet
thence South 45 Degrees 00 Minutes 23 Seconds East	41.5 feet
thence South 48 Degrees 41 Minutes 35 Seconds East	39.5 feet
thence South 48 Degrees 54 Minutes 10 Seconds East	44.6 feet
thence South 45 Degrees 37 Minutes 35 Seconds East	44.3 feet
thence South 50 Degrees 46 Minutes 49 Seconds East	46.4 feet
thence South 48 Degrees 48 Minutes 15 Seconds East	42.1 feet
thence South 46 Degrees 52 Minutes 29 Seconds East	42.9 feet
thence South 47 Degrees 10 Minutes 27 Seconds East	43.2 feet
thence South 47 Degrees 47 Minutes 32 Seconds East	48.5 feet
thence South 47 Degrees 21 Minutes 41 Seconds East	45.7 feet
thence South 49 Degrees 15 Minutes 08 Seconds East	47.4 feet
thence South 45 Degrees 53 Minutes 37 Seconds East	46.9 feet
thence South 47 Degrees 21 Minutes 41 Seconds East	45.7 feet
thence South 45 Degrees 37 Minutes 35 Seconds East	44.3 feet
thence South 47 Degrees 31 Minutes 45 Seconds East	48.3 feet
thence South 51 Degrees 00 Minutes 37 Seconds East	49.2 feet
thence South 47 Degrees 31 Minutes 45 Seconds East	48.3 feet
thence South 49 Degrees 15 Minutes 08 Seconds East	47.4 feet
thence South 50 Degrees 47 Minutes 40 Seconds East	27.3 feet
thence South 50 Degrees 45 Minutes 37 Seconds East	19.1 feet
thence South 19 Degrees 15 Minutes 04 Seconds East	12.1 feet
thence South 69 Degrees 17 Minutes 20 Seconds East	4.6 feet
thence South 32 Degrees 40 Minutes 26 Seconds East	11.7 feet
thence South 69 Degrees 17 Minutes 20 Seconds East	9.1 feet
thence South 45 Degrees 19 Minutes 35 Seconds East	11.6 feet
thence South 52 Degrees 27 Minutes 05 Seconds East	18.7 feet
thence South 47 Degrees 40 Minutes 47 Seconds East	16.9 feet
thence South 46 Degrees 26 Minutes 59 Seconds East	23.7 feet
thence South 48 Degrees 03 Minutes 10 Seconds East	19.5 feet
thence South 49 Degrees 27 Minutes 14 Seconds East	22.6 feet
thence South 46 Degrees 20 Minutes 58 Seconds East	26 feet
thence South 43 Degrees 51 Minutes 27 Seconds East	27.2 feet
thence South 55 Degrees 10 Minutes 20 Seconds East	28.5 feet
thence South 43 Degrees 51 Minutes 27 Seconds East	27.2 feet

thence South 52 Degrees 24 Minutes 00 Seconds East	32 feet
thence South 44 Degrees 52 Minutes 56 Seconds East	29.9 feet
thence South 50 Degrees 09 Minutes 25 Seconds East	33.1 feet
thence South 47 Degrees 40 Minutes 47 Seconds East	33.9 feet
thence South 45 Degrees 19 Minutes 35 Seconds East	32.5 feet
thence South 44 Degrees 13 Minutes 54 Seconds East	36.4 feet
thence South 52 Degrees 15 Minutes 39 Seconds East	34.6 feet
thence South 48 Degrees 33 Minutes 58 Seconds East	36.9 feet
thence South 46 Degrees 38 Minutes 36 Seconds East	40.4 feet
thence South 48 Degrees 13 Minutes 30 Seconds East	36.7 feet
thence South 44 Degrees 38 Minutes 40 Seconds East	39 feet
thence South 50 Degrees 12 Minutes 20 Seconds East	38.2 feet
thence South 47 Degrees 10 Minutes 26 Seconds East	43.2 feet
thence South 48 Degrees 41 Minutes 34 Seconds East	39.5 feet
thence South 46 Degrees 38 Minutes 36 Seconds East	40.4 feet
thence South 47 Degrees 21 Minutes 41 Seconds East	45.7 feet
thence South 50 Degrees 31 Minutes 15 Seconds East	41 feet
thence South 47 Degrees 10 Minutes 26 Seconds East	43.2 feet
thence South 47 Degrees 10 Minutes 26 Seconds East	43.2 feet
thence South 45 Degrees 37 Minutes 35 Seconds East	44.3 feet
thence South 45 Degrees 19 Minutes 35 Seconds East	44.1 feet
thence South 49 Degrees 10 Minutes 47 Seconds East	44.9 feet
thence South 48 Degrees 48 Minutes 15 Seconds East	42.1 feet
thence South 48 Degrees 48 Minutes 15 Seconds East	42.1 feet
thence South 45 Degrees 19 Minutes 35 Seconds East	44.1 feet
thence South 50 Degrees 31 Minutes 15 Seconds East	41 feet
thence South 50 Degrees 47 Minutes 44 Seconds East	43.8 feet
thence South 45 Degrees 37 Minutes 35 Seconds East	44.3 feet
thence South 46 Degrees 52 Minutes 28 Seconds East	42.9 feet
thence South 48 Degrees 48 Minutes 15 Seconds East	42.1 feet
thence South 48 Degrees 54 Minutes 10 Seconds East	44.6 feet
thence South 45 Degrees 37 Minutes 35 Seconds East	44.3 feet
thence South 45 Degrees 37 Minutes 35 Seconds East	44.3 feet
thence South 49 Degrees 15 Minutes 08 Seconds East	47.4 feet
thence South 45 Degrees 19 Minutes 35 Seconds East	44.1 feet
thence South 47 Degrees 21 Minutes 41 Seconds East	45.7 feet
thence South 47 Degrees 10 Minutes 26 Seconds East	43.2 feet
thence South 52 Degrees 29 Minutes 24 Seconds East	42.8 feet
thence South 45 Degrees 00 Minutes 22 Seconds East	41.5 feet
thence South 48 Degrees 54 Minutes 10 Seconds East	44.6 feet
thence South 50 Degrees 31 Minutes 15 Seconds East	41 feet
thence South 45 Degrees 19 Minutes 35 Seconds East	41.8 feet
thence South 45 Degrees 00 Minutes 22 Seconds East	41.5 feet
thence South 50 Degrees 31 Minutes 15 Seconds East	41 feet
thence South 41 Degrees 14 Minutes 27 Seconds East	6.5 feet
thence South 50 Degrees 12 Minutes 20 Seconds East	38.2 feet
thence South 43 Degrees 46 Minutes 41 Seconds East	42.9 feet
thence South 43 Degrees 27 Minutes 31 Seconds East	42.7 feet
thence South 52 Degrees 13 Minutes 07 Seconds East	42.5 feet

thence South 48 Degrees 46 Minutes 40 Seconds East 23.9 feet
 thence South 48 Degrees 50 Minutes 20 Seconds East 18.2 feet
 thence South 47 Degrees 10 Minutes 26 Seconds East 43.2 feet
 thence South 50 Degrees 31 Minutes 15 Seconds East 41 feet
 thence South 47 Degrees 10 Minutes 26 Seconds East 43.2 feet
 thence South 47 Degrees 10 Minutes 26 Seconds East 43.2 feet
 thence South 48 Degrees 22 Minutes 29 Seconds East 39.3 feet
 thence South 47 Degrees 10 Minutes 26 Seconds East 43.2 feet
 thence South 45 Degrees 19 Minutes 35 Seconds East 41.8 feet
 thence South 50 Degrees 13 Minutes 31 Seconds East 40.7 feet
 thence South 46 Degrees 57 Minutes 46 Seconds East 40.6 feet
 thence South 47 Degrees 21 Minutes 41 Seconds East 45.7 feet
 thence South 45 Degrees 00 Minutes 22 Seconds East 41.5 feet
 thence South 46 Degrees 57 Minutes 46 Seconds East 40.6 feet
 thence South 52 Degrees 16 Minutes 45 Seconds East 47.9 feet
 thence South 45 Degrees 00 Minutes 22 Seconds East 41.5 feet
 thence South 46 Degrees 10 Minutes 23 Seconds East 47.1 feet
 thence South 46 Degrees 52 Minutes 28 Seconds East 42.9 feet
 thence South 50 Degrees 31 Minutes 15 Seconds East 41 feet
 thence South 49 Degrees 10 Minutes 47 Seconds East 44.9 feet
 thence South 46 Degrees 38 Minutes 35 Seconds East 40.4 feet
 thence South 48 Degrees 22 Minutes 29 Seconds East 39.3 feet
 thence South 47 Degrees 10 Minutes 26 Seconds East 43.2 feet
 thence South 47 Degrees 38 Minutes 24 Seconds East 46 feet
 thence South 46 Degrees 22 Minutes 50 Seconds East 37.8 feet
 thence South 48 Degrees 48 Minutes 15 Seconds East 42.1 feet
 thence South 45 Degrees 19 Minutes 35 Seconds East 44.1 feet
 thence South 47 Degrees 21 Minutes 41 Seconds East 45.7 feet
 thence South 51 Degrees 02 Minutes 13 Seconds East 46.6 feet
 thence South 48 Degrees 30 Minutes 22 Seconds East 41.8 feet
 thence South 48 Degrees 03 Minutes 09 Seconds East 34.1 feet
 thence South 52 Degrees 45 Minutes 28 Seconds East 10.8 feet
 thence South 48 Degrees 59 Minutes 26 Seconds East 47.2 feet
 thence South 47 Degrees 38 Minutes 24 Seconds East 46 feet
 thence South 45 Degrees 53 Minutes 37 Seconds East 46.9 feet
 thence South 49 Degrees 15 Minutes 08 Seconds East 47.4 feet
 thence South 45 Degrees 19 Minutes 34 Seconds East 44.1 feet
 thence South 49 Degrees 10 Minutes 47 Seconds East 44.9 feet
 thence South 46 Degrees 38 Minutes 35 Seconds East 40.4 feet
 thence South 46 Degrees 38 Minutes 35 Seconds East 40.4 feet
 thence South 48 Degrees 33 Minutes 57 Seconds East 36.9 feet
 thence South 37 Degrees 53 Minutes 41 Seconds East 26.9 feet
 thence South 39 Degrees 36 Minutes 56 Seconds East 23.3 feet
 thence South 38 Degrees 59 Minutes 10 Seconds East 23.1 feet
 thence South 44 Degrees 29 Minutes 45 Seconds East 48 feet more or less to **the ending point**

at: 40 degrees 04 minutes 55.59 seconds North Latitude and -112 degrees 46 minutes 10.01 seconds West Longitude, which can be converted to mapping accuracy State Plane Utah Central Zone NAD 83 feet coordinates of X = 1,285,235.3 feet and Y = 7,201,152.5 feet.