

**Amended Acknowledgment and
Amended Notice of Acknowledgment
of Acceptance of R.S. 2477
Right-of-Way Grant**

Entry 2007014406
Book 1069 Page 229-234 \$0.00
27-DEC-07 12:25
RANDY SIMMONS
RECORDER, UINTAH COUNTY, UTAH
GOVERNOR OF THE STATE OF UTAH
STATE CAPITOL COMPLEX E220 PO BOX 14220
Rec By: TONYA ATWOOD , DEPUTY

THE STATE OF UTAH

Entry 2007014406
Book 1069 Page 229

TO ALL WHOM THESE PRESENTS SHALL COME, Greeting:

Know ye, This is an Amended Acknowledgment and Amended Notice of Acknowledgment made under Utah Code Sections 72-5-309 through 310 inclusive, that the grant of the United States of America of "the right of way for the construction of highways over public lands, not reserved for public uses" under United States Revised Statutes 2477 (43 U.S.C. Section 932 (repealed October 21, 1976, with proviso recognizing the validity of rights-of-way already established)) was accepted for and on behalf of the State of Utah and its political subdivision Uintah County as it pertains to the highway located in Uintah County known as Old Power Plant Road; County Road Number: 2070; State Geographic Information Database (SGID) Road Identification Number: RD242205. Total road length is 1.78 miles more or less.

This Amended Acknowledgment and Amended Notice of Acknowledgment supersedes the information contained in the Acknowledgment recorded at Ent 2006012520, Bk 1007, Beg Pg 240.

The reason for this Amended Acknowledgment and Amended Notice of Acknowledgment includes, but is not limited to, the fact that the road was constructed, mechanically, or by continuous use as a public highway for a period of at least ten years, over public lands not reserved for public uses, prior to the earlier of (a) the October 21, 1976 repeal of R.S. 2477 or (b) the date the servient estate was reserved for public uses.

This Amended Acknowledgment and Amended Notice of Acknowledgment applies only to the segments of the road that traverse land owned by the Bureau of Land Management, United States Department of the Interior, and does not apply to segments of the road that traverse land owned by any other person or entity. The State of Utah and its political subdivisions reserve the right to make further acknowledgments and notices of acknowledgment with regard to road segments that traverse land owned by other entities, including the United States of America, through one or more of its agencies.

A printed copy of a map showing the location of the road in said county is appended hereto as "Attachment 1," a printed copy of representative photos of the road is appended hereto as "Attachment 2," a printed copy of a description of the beginning and ending points of the entire road together with a list of Townships, Ranges and Sections that may be traversed by the road in said county is appended hereto as "Attachment 3," and a printed copy of the Road Centerline Description Cover Page(s) is appended hereto as "Attachment 4." The Appendices listed in "Attachment 4" that contain the actual road centerline descriptions are incorporated herein by reference.

A printed copy of this Amended Acknowledgment and Amended Notice of Acknowledgment, together with its Attachments and Appendices, may be viewed and/or obtained at the office of the Utah State Archives.

An electronic copy of this Amended Acknowledgment and Amended Notice of Acknowledgment, together with its Attachments and Appendices, may be viewed and/or downloaded as read-only PDF (Portable Document Format) files via the Internet at <http://recorded2477roads.utah.gov>.

The owner of the servient estate in the land underlying the road-segments subject to this Amended Acknowledgment and Amended Notice is believed to be the United States of America through one or more of its agencies. Any of such agencies or any other person with a servient ownership claim or a competing dominant estate right-of-way ownership claim, may file a petition in the State District Court for Salt Lake County for a decision regarding the correctness of this Amended Acknowledgment. A claimant shall file a petition within sixty (60) days after receipt of this Notice.

In Witness Whereof, I, John Harja, the official designee of the Governor of the State of Utah, in conformity to the laws of the State (Utah Code Sections 72-5-308 through 310 inclusive), have caused this Amended Acknowledgment and Amended Notice of Acknowledgment to be made.

Signed by my hand in Salt Lake City, Utah, the 7th day of December, 2007.

By the Governor's Designee



John Harja

CERTIFICATION

State of Utah)
 : ss
County of Salt Lake)

I hereby certify that the signer of the foregoing document, John Harja, is personally known by me, has made a voluntary signature and taken an oath stating that he is the official designee of the Governor of the State of Utah and is authorized to sign this document on the Governor's behalf pursuant to Utah Code Section 72-5-309. He further vouched that, based upon information and belief, the facts alleged therein are true.

Dated this 7th day of December, 2007.

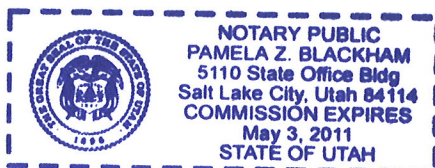



Notary Public

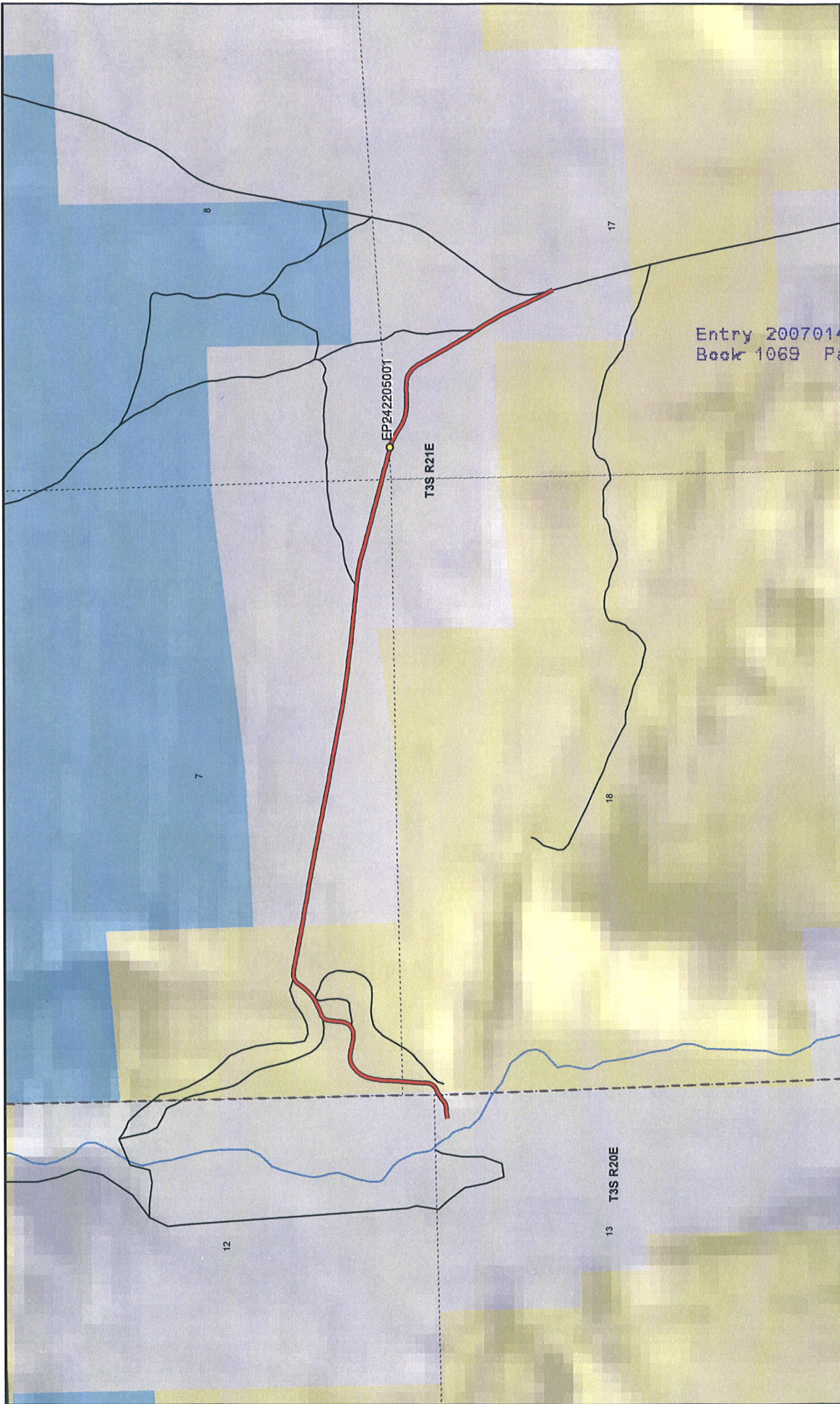

Entry 2007014406
Book 1069 Page 231

Old Power Plant Road - Uintah County
SGID RD_ID RD242205

- Land Ownership Categories**
- BLM
 - Private
 - SITLA, State Trust Land
 - USFS, National Forest
 - State Parks and Recreation
 - Tribal, Indian Reservation
 - NPS, National Park
- Transportation Network**
- Old Power Plant Road
 - Other Roads
 - Title V: Issued Or Under Consideration By BLM
 - Photo Event Point
- Section = 1 Mile

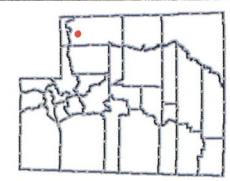

1:14,662
1 inch equals 0.2 miles

Map prepared by the State of Utah
Automated Geographic Reference Center
Room 5130 State Office Building
Salt Lake City, Utah 84114
Nov 07, 2006





Entry 2007014406
Book 1069 Page 232

EP242205001

EP000000000

EP000000000

EP000000000

EP000000000

EP000000000

Old Power Plant Road - Uintah County
SGID RD_ID RD242205

Map prepared by the State of Utah
Automated Geographic Reference Center
Room 5130 State Office Building
Salt Lake City, Utah 84114
October 30, 2006



Attachment 3

Beginning & Ending Points and Township, Range, and Section References For:

Popular Name: Old Power Plant Road

County: Uintah

County Road Number: 2070

State Geographic Information Database (SGID) Road Identification Number: RD242205.

Total Road Length: 1.78 miles more or less.

Beginning at a point on the road centerline located at 40 degrees 33 minutes 48.94 seconds North Latitude and -109 degrees 37 minutes 00.91 seconds West Longitude, which can be converted to mapping accuracy State Plane Utah Central Zone NAD 83 feet coordinates of $X = 2,163,574.3$ feet and $Y = 7,379,537.2$ feet based on the US Survey Foot conversion.

Ending at a point on the road centerline located at 40 degrees 33 minutes 37.97 seconds North Latitude and -109 degrees 35 minutes 22.89 seconds West Longitude, which can be converted to mapping accuracy State Plane Utah Central Zone NAD 83 feet coordinates of $X = 2,171,161.1$ feet and $Y = 7,378,587.7$ feet based on the US Survey Foot conversion.

This road may traverse:

Township 3 South Range 20 East, Section(s) 13, Salt Lake Base & Meridian

Township 3 South Range 21 East, Section(s) 7,17,18, Salt Lake Base & Meridian

See Attachment 1 above for a cartographic depiction of the course of this road.

Attachment 4
Road Centerline Description Cover Page(s)

Popular Name: Old Power Plant Road

County: Uintah

County Road Number: 2070

State Geographic Information Database (SGID) Road Identification Number: RD242205.

Total Road Length: 1.78 miles more or less.

Centerline Descriptions Of Road-Segments That Cross Over Federally Owned Land, Derived From Global Positioning System Data And Cross-checked against USGS Digital Orthophoto Quadrangles Compiled By The Utah Automated Geographic Reference Center And Entered Into The State Geographic Information Database (SGID).

Road-Segments Listed by SGID Road Identification Number (RD_ID)	Road-Segment Numbers	Believed Ownership Of Servient Estate	Approximate Segment Length	See Attached Appendix
RD242205	001	PVT	0.05 Miles	(not shown)
RD242205	002	BLM	0.46 Miles	A
RD242205	003	PVT	1.27 Miles	(not shown)
		Total Road Length	1.78	_____

* Indicates that a Title V permit will be requested, is in process, or has been issued.

† Indicates that road-segments crossing Forest Service land are under consideration by the state and county as of the date of this Amended Acknowledgment and Amended Notice of Acknowledgment.

Appendix A to Attachment 4

Popular Name: Old Power Plant Road

County: Uintah

County Road Number: 2070

State Geographic Information Database (SGID) Road Identification Number: RD242205.

Road-Segment Number: 002

Road-Segment Length: 0.46 miles more or less.

Believed owner of the land underlying this road-segment is: Bureau of Land Management.

The following description is based upon the geographic coordinate system using the NAD83 Datum. The source is GPS mapping grade data as indicated in the metadata and/or the transportation data model of the State of Utah Geographic Information Database (SGID).

The road-segment itself is the monument that is identified by its physical presence on the land. The location of said physical presence is closely approximated by mapping grade Global Positioning System (GPS) data. Said data are checked against the corresponding gray-scale 1-meter Digital Orthophoto Quadrangles published by the United States Geological Survey (USGS) to verify a reasonable degree of accuracy. In circumstances where accurate satellite signal acquisition is not possible, such as deep, narrow canyons or under a canopy of dense foliage, or where very sharp curves in the road make accuracy questionable, such portions of the road were digitized from the corresponding gray-scale 1-meter Digital Orthophoto Quadrangles published by the United States Geological Survey (USGS).

This road-segment may traverse:

Township 3 South Range 21 East, Section(s) 7,18, Salt Lake Base & Meridian

The following description closely approximates the location of the centerline of the physical monument (Old Power Plant Road)-- Segment 002 based on mapping grade Global Positioning System (GPS) data as defined above:

Beginning at a point on the road center line located at 40 degrees 33 minutes 49.79 seconds North Latitude and -109 degrees 36 minutes 57.68 seconds West Longitude, which can be converted to mapping accuracy State Plane Utah Central Zone NAD 83 feet coordinates of X = 2,163,821.3 feet and Y = 7,379,628.1 feet; thence the following courses along the said road center line:

thence North 65 Degrees 51 Minutes 16 Seconds East	15.4 feet
thence North 61 Degrees 04 Minutes 58 Seconds East	28.8 feet
thence North 45 Degrees 14 Minutes 58 Seconds East	23.9 feet
thence North 29 Degrees 06 Minutes 01 Seconds East	20.7 feet
thence North 15 Degrees 59 Minutes 14 Seconds East	22.2 feet
thence North 07 Degrees 43 Minutes 13 Seconds East	25.8 feet
thence North 03 Degrees 27 Minutes 55 Seconds East	29.9 feet
thence North 01 Degrees 33 Minutes 29 Seconds East	70.6 feet
thence North 05 Degrees 06 Minutes 37 Seconds East	38.2 feet
thence North 05 Degrees 45 Minutes 18 Seconds East	37.3 feet
thence North 04 Degrees 07 Minutes 47 Seconds East	38.2 feet

thence North 02 Degrees 59 Minutes 42 Seconds East 17.1 feet
 thence North 04 Degrees 53 Minutes 15 Seconds East 3.6 feet
 thence North 04 Degrees 01 Minutes 32 Seconds East 21.7 feet
 thence North 03 Degrees 03 Minutes 35 Seconds East 22.4 feet
 thence North 02 Degrees 08 Minutes 50 Seconds East 23 feet
 thence North 02 Degrees 08 Minutes 50 Seconds East 23 feet
 thence North 03 Degrees 53 Minutes 55 Seconds East 22.4 feet
 thence North 03 Degrees 06 Minutes 35 Seconds East 22 feet
 thence North 02 Degrees 20 Minutes 08 Seconds East 21.4 feet
 thence North 05 Degrees 56 Minutes 06 Seconds East 21.1 feet
 thence North 05 Degrees 56 Minutes 06 Seconds East 21.1 feet
 thence North 07 Degrees 41 Minutes 52 Seconds East 21.2 feet
 thence North 09 Degrees 26 Minutes 44 Seconds East 21.3 feet
 thence North 11 Degrees 00 Minutes 11 Seconds East 21.8 feet
 thence North 13 Degrees 43 Minutes 46 Seconds East 21.6 feet
 thence North 15 Degrees 38 Minutes 19 Seconds East 21.5 feet
 thence North 18 Degrees 39 Minutes 49 Seconds East 22.2 feet
 thence North 22 Degrees 26 Minutes 39 Seconds East 22.1 feet
 thence North 27 Degrees 45 Minutes 56 Seconds East 22.3 feet
 thence North 36 Degrees 54 Minutes 04 Seconds East 22.2 feet
 thence North 42 Degrees 21 Minutes 21 Seconds East 22.8 feet
 thence North 45 Degrees 50 Minutes 20 Seconds East 23.2 feet
 thence North 49 Degrees 59 Minutes 39 Seconds East 22.6 feet
 thence North 55 Degrees 18 Minutes 46 Seconds East 22.7 feet
 thence North 57 Degrees 56 Minutes 01 Seconds East 24.3 feet
 thence North 72 Degrees 59 Minutes 38 Seconds East 20.6 feet
 thence North 84 Degrees 48 Minutes 29 Seconds East 38.5 feet
 thence South 84 Degrees 41 Minutes 20 Seconds East 40.2 feet
 thence South 78 Degrees 38 Minutes 50 Seconds East 21.1 feet
 thence South 78 Degrees 30 Minutes 15 Seconds East 22.5 feet
 thence South 78 Degrees 30 Minutes 15 Seconds East 22.5 feet
 thence South 78 Degrees 02 Minutes 30 Seconds East 23.2 feet
 thence South 78 Degrees 12 Minutes 42 Seconds East 23.5 feet
 thence South 82 Degrees 23 Minutes 58 Seconds East 23.9 feet
 thence South 86 Degrees 16 Minutes 42 Seconds East 23.4 feet
 thence North 86 Degrees 16 Minutes 36 Seconds East 22 feet
 thence North 77 Degrees 51 Minutes 04 Seconds East 20.8 feet
 thence North 64 Degrees 02 Minutes 02 Seconds East 37.1 feet
 thence North 47 Degrees 27 Minutes 25 Seconds East 33.7 feet
 thence North 26 Degrees 15 Minutes 30 Seconds East 36.7 feet
 thence North 10 Degrees 54 Minutes 29 Seconds East 38.8 feet
 thence North 06 Degrees 14 Minutes 22 Seconds East 20.1 feet
 thence North 04 Degrees 18 Minutes 14 Seconds East 20.4 feet
 thence North 03 Degrees 19 Minutes 34 Seconds East 20.7 feet
 thence North 04 Degrees 18 Minutes 14 Seconds East 20.4 feet
 thence North 05 Degrees 18 Minutes 39 Seconds East 20.1 feet
 thence North 14 Degrees 06 Minutes 50 Seconds East 35.6 feet
 thence North 27 Degrees 27 Minutes 06 Seconds East 28.2 feet
 thence North 54 Degrees 59 Minutes 53 Seconds East 20.8 feet

thence North 53 Degrees 32 Minutes 06 Seconds East 10.6 feet
 thence North 66 Degrees 02 Minutes 07 Seconds East 37.6 feet
 thence North 69 Degrees 02 Minutes 03 Seconds East 21.4 feet
 thence North 68 Degrees 21 Minutes 23 Seconds East 22.5 feet
 thence North 66 Degrees 17 Minutes 19 Seconds East 24 feet
 thence North 62 Degrees 27 Minutes 29 Seconds East 25.1 feet
 thence North 61 Degrees 29 Minutes 30 Seconds East 25.7 feet
 thence North 56 Degrees 23 Minutes 59 Seconds East 26.3 feet
 thence North 51 Degrees 41 Minutes 40 Seconds East 26.7 feet
 thence North 48 Degrees 38 Minutes 18 Seconds East 27 feet
 thence North 44 Degrees 41 Minutes 36 Seconds East 27.4 feet
 thence North 42 Degrees 47 Minutes 03 Seconds East 27.9 feet
 thence North 39 Degrees 13 Minutes 46 Seconds East 26.8 feet
 thence North 35 Degrees 13 Minutes 51 Seconds East 25.4 feet
 thence North 35 Degrees 08 Minutes 20 Seconds East 23.8 feet
 thence North 40 Degrees 28 Minutes 45 Seconds East 22.1 feet
 thence North 51 Degrees 44 Minutes 20 Seconds East 20.8 feet
 thence North 63 Degrees 31 Minutes 54 Seconds East 20.8 feet
 thence North 74 Degrees 52 Minutes 00 Seconds East 11.5 feet
 thence North 74 Degrees 16 Minutes 16 Seconds East 9.9 feet
 thence North 85 Degrees 32 Minutes 55 Seconds East 22.7 feet
 thence South 82 Degrees 23 Minutes 58 Seconds East 23.9 feet
 thence South 81 Degrees 12 Minutes 58 Seconds East 24.9 feet
 thence South 80 Degrees 07 Minutes 52 Seconds East 26 feet
 thence South 80 Degrees 03 Minutes 45 Seconds East 27.7 feet
 thence South 79 Degrees 38 Minutes 46 Seconds East 28.4 feet
 thence South 78 Degrees 44 Minutes 47 Seconds East 29.5 feet
 thence South 78 Degrees 23 Minutes 09 Seconds East 30.2 feet
 thence South 79 Degrees 14 Minutes 11 Seconds East 30.8 feet
 thence South 80 Degrees 03 Minutes 19 Seconds East 31.3 feet
 thence South 79 Degrees 21 Minutes 09 Seconds East 31.1 feet
 thence South 78 Degrees 44 Minutes 47 Seconds East 29.5 feet
 thence South 79 Degrees 21 Minutes 09 Seconds East 31.1 feet
 thence South 80 Degrees 44 Minutes 47 Seconds East 31.6 feet
 thence South 80 Degrees 33 Minutes 46 Seconds East 33 feet
 thence South 80 Degrees 45 Minutes 08 Seconds East 33.6 feet
 thence South 79 Degrees 41 Minutes 13 Seconds East 5.3 feet more or less to **the ending point**

at: 40 degrees 34 minutes 1.8 seconds North Latitude and -109 degrees 36 minutes 37.79 seconds West Longitude, which can be converted to mapping accuracy State Plane Utah Central Zone NAD 83 feet coordinates of X = 2,165,330.7 feet and Y = 7,380,875.6 feet.